

F.A. RTE.	SECTION	COUNTY	TOTAL SHEETS	SHEET NO.
FAP734	98-00480-00-BR 03-00522-00-TL	WINNEBAGO	62	27
STA.		TO STA.		
FED. ROAD DIST. NO. _		ILLINOIS	FED. AID PROJECT	

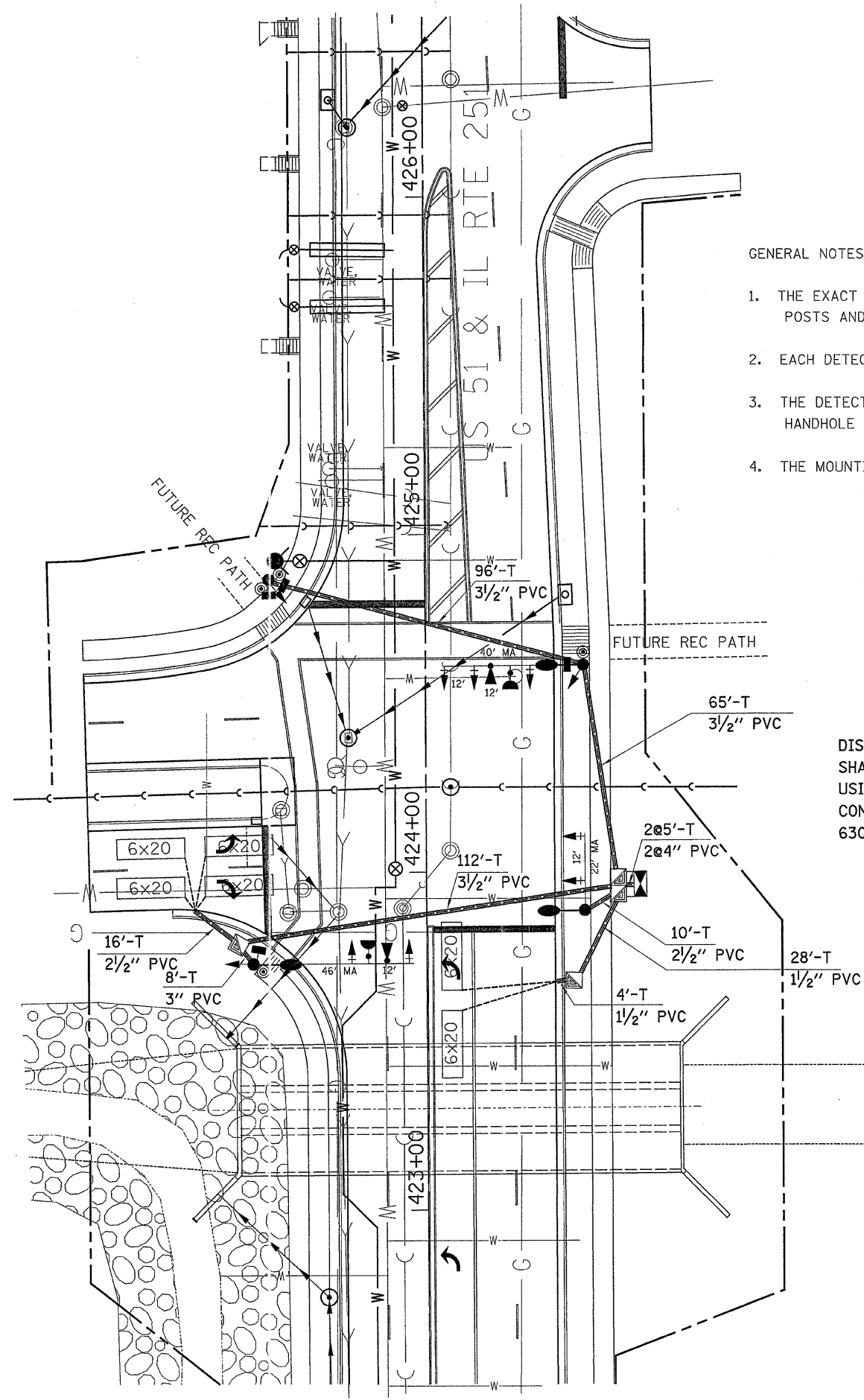

GENERAL NOTES

1. THE EXACT LOCATION OF THE COMBINATION MAST ARM ASSEMBLIES, POSTS AND DETECTOR LOOPS SHALL BE DETERMINED IN THE FIELD BY THE ENGINEER.
2. EACH DETECTOR LOOP SHALL HAVE AN INDIVIDUAL CONDUIT STUB
3. THE DETECTOR LOOP CABLE FROM THE END OF THE SAW CUT TO THE SPLICE IN THE HANDHOLE SHALL BE CONSIDERED INCIDENTAL TO THE COST OF THE DETECTOR LOOP.
4. THE MOUNTING HEIGHT FOR THE LUMINAIRS SHALL BE 35' 0" ON AN 8' 0" ARM.

LEGEND

- EXISTING CONTROLLER
- NEW CONTROLLER
- EXISTING ALUMINUM MAST ARM ASSEMBLY AND POLE
- NEW ALUMINUM MAST ARM ASSEMBLY AND POLE
- EXISTING STEEL MAST ARM ASSEMBLY AND POLE
- NEW STEEL MAST ARM ASSEMBLY AND POLE
- EXISTING SIGNAL HEAD AND POST
- NEW SIGNAL HEAD AND POST
- EXISTING SIGNAL HEAD
- NEW SIGNAL HEAD WITH BACKPLATE
- EXISTING PEDESTRIAN HEAD
- NEW PEDESTRIAN HEAD
- PEDESTRIAN PUSHBUTTON
- EXISTING HANDHOLE
- NEW HANDHOLE
- NEW JUNCTION BOX
- NEW HEAVY-DUTY HANDHOLE
- NEW DOUBLE HANDHOLE
- EMERGENCY VEHICLE LIGHT DETECTOR
- CONFIRMATION BEACON
- EXISTING CONDUIT (LENGTH AND SIZE)
- NEW LUMINAIRE
- NEW GALVANIZED STEEL OR PVC CONDUIT
- UPPER NUMERAL INDICATES LENGTH
- "T" INDICATES CONDUIT IN TRENCH
- "P" INDICATES CONDUIT PUSHED
- LOWER NUMERAL INDICATES SIZE AND TYPE

DISTANCE TO POWER SOURCE SHALL NOT EXCEED 225' USING NO. 6 WIRE 2/C 2" PVC CONTACT COMED (DAVE SCHACHT) 630-437-2129 FOR POST LOCATION

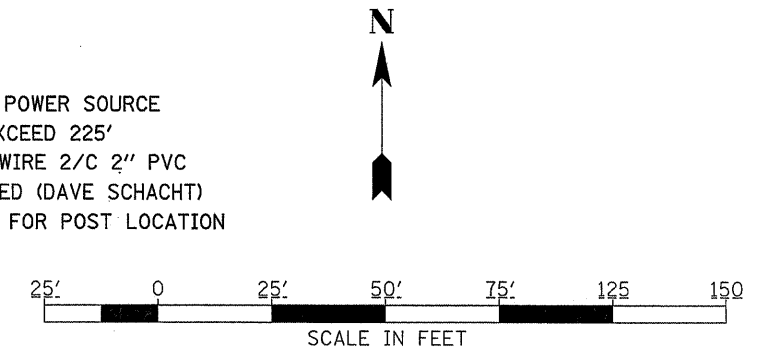

# GENERAL SIGNAL PLAN

REVISIONS	
NAME	DATE

ILLINOIS DEPARTMENT OF TRANSPORTATION

SCALE: VERT. \_\_\_\_\_  
HORIZ. \_\_\_\_\_

DATE \_\_\_\_\_

DRAWN BY \_\_\_\_\_  
CHECKED BY \_\_\_\_\_