

BILL OF MATERIAL - PIERS

BAR	NO.	SIZE	LENGTH	SHAPE
h ₁ (E)	40	#6	25'-0"	—
p ₁ (E)	20	#7	30'-8"	—
u ₃ (E)	40	#6	11'-7"	U
u ₄ (E)	120	#4	5'-6"	U
u ₅ (E)	16	#6	11'-1"	U
v(E)	136	#6	9'-8"	—
CONCRETE STRUCTURES			CU. YD.	53.0
REINFORCEMENT BARS, EPOXY COATED			LBS.	6130
FURNISHING METAL SHELL PILES - 12"Ø			FOOT	664
TEST PILE METAL SHELL PILE - 12"Ø			EACH	2
DRIVING PILES			FOOT	664

REINFORCEMENT BARS INDICATED (E) SHALL BE EPOXY COATED.
* INCLUDES WALERS & CHANNELS

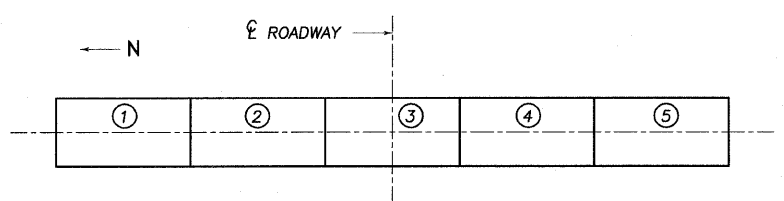

LOCATION	ELEV.	①	②	③	④	⑤
PIER NO. 1		819.027	819.124	819.222	819.320	819.417
PIER NO. 2		819.027	819.124	819.222	819.320	819.417

ELEVATION TOP OF PIER CAP

PILE DATA INFORMATION

TYPE AND SIZE: METAL SHELL 12" DIA. x 0.179 IN. WALLS
 NOMINAL REQUIRED BEARING: 216 KIPS
 ALLOWABLE RESISTANCE AVAILABLE: 72 KIPS

	PIER 1	PIER 2
NO. REQUIRED :	8+1 TEST PILE	8+1
EST. LENGTH:	41'	42'

MIN. PENETRATION 15' BELOW STREAMBED
 METAL SHELL PILES SHALL BE ACCORDING TO ASTM A252 GRADE 3.
 THE TEST PILE SHALL BE DRIVEN TO 110 PERCENT OF THE NOMINAL REQUIRED BEARING INDICATED IN THE PILE DATA INFORMATION.

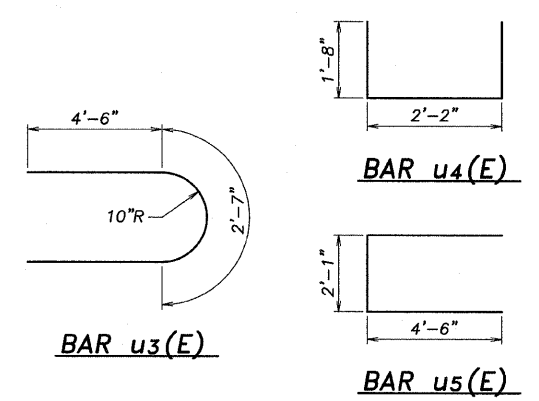

PIERS
SECTION 01-09114-00-BR
NORTH GROVE ROAD
DEKALB COUNTY
S.N. 019-4409