

F.A.U. RTE.	SECTION	COUNTY	TOTAL SHEETS	SHEET NO.
9306	04-00042-01-PV	MONROE	39	11
STA. 32+50		TO STA. 36+99.96		
FED. ROAD DIST. NO.		ILLINOIS FED. AID PROJECT		

PLAN	DATE
BY	
REVISIONS	
NO.	DESCRIPTION

PROFILE	DATE
BY	
REVISIONS	
NO.	DESCRIPTION

PLOT DATE = 7/14/2008
 FILE NAME = #ELEV#
 PLOT SCALE = #SCALE#
 USER NAME = #USER#

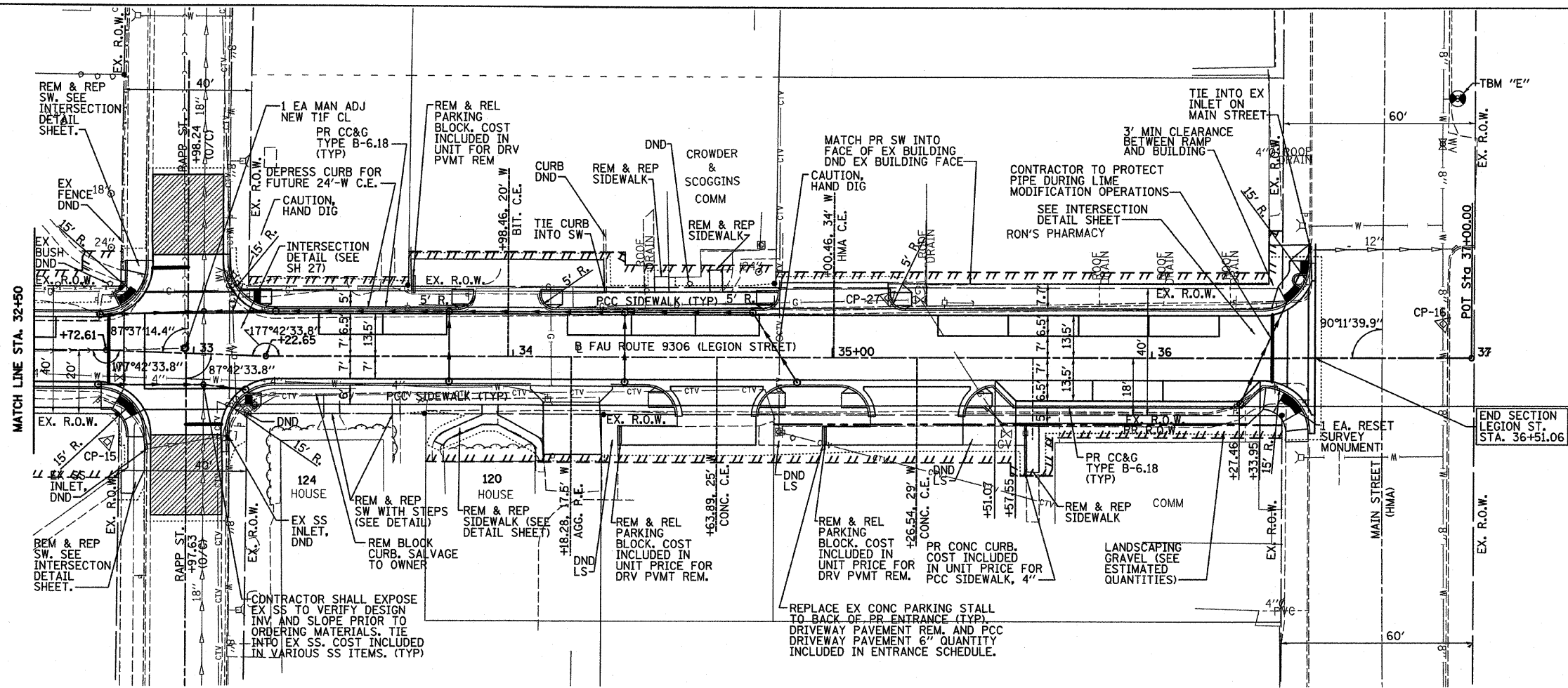

- LEGEND**
- INCIDENTAL HOT-MIX ASPHALT SURFACE, 2"
 - PROPOSED TEMPORARY CONSTRUCTION EASEMENT
 - PROPOSED CONSTRUCTION LIMITS
 - DETECTABLE WARNINGS

