

F.A. RTE.	SECTION	COUNTY	TOTAL SHEETS	SHEET NO.
9306	04-00042-01-PV	MONROE	39	32
STA. 28+10.84		TO STA. 28+65.04		
FED. ROAD DIST. NO. ILLINOIS FED. AID PROJECT				

DATE	
BY	
REVISIONS	
NO.	
DATE	
BY	
REVISIONS	
NO.	
DATE	
BY	
REVISIONS	
NO.	

DATE	
BY	
REVISIONS	
NO.	
DATE	
BY	
REVISIONS	
NO.	

PLOT DATE = 7/14/2008
 PLOT SCALE = 1" = 40'
 REFERENCE = #REF#

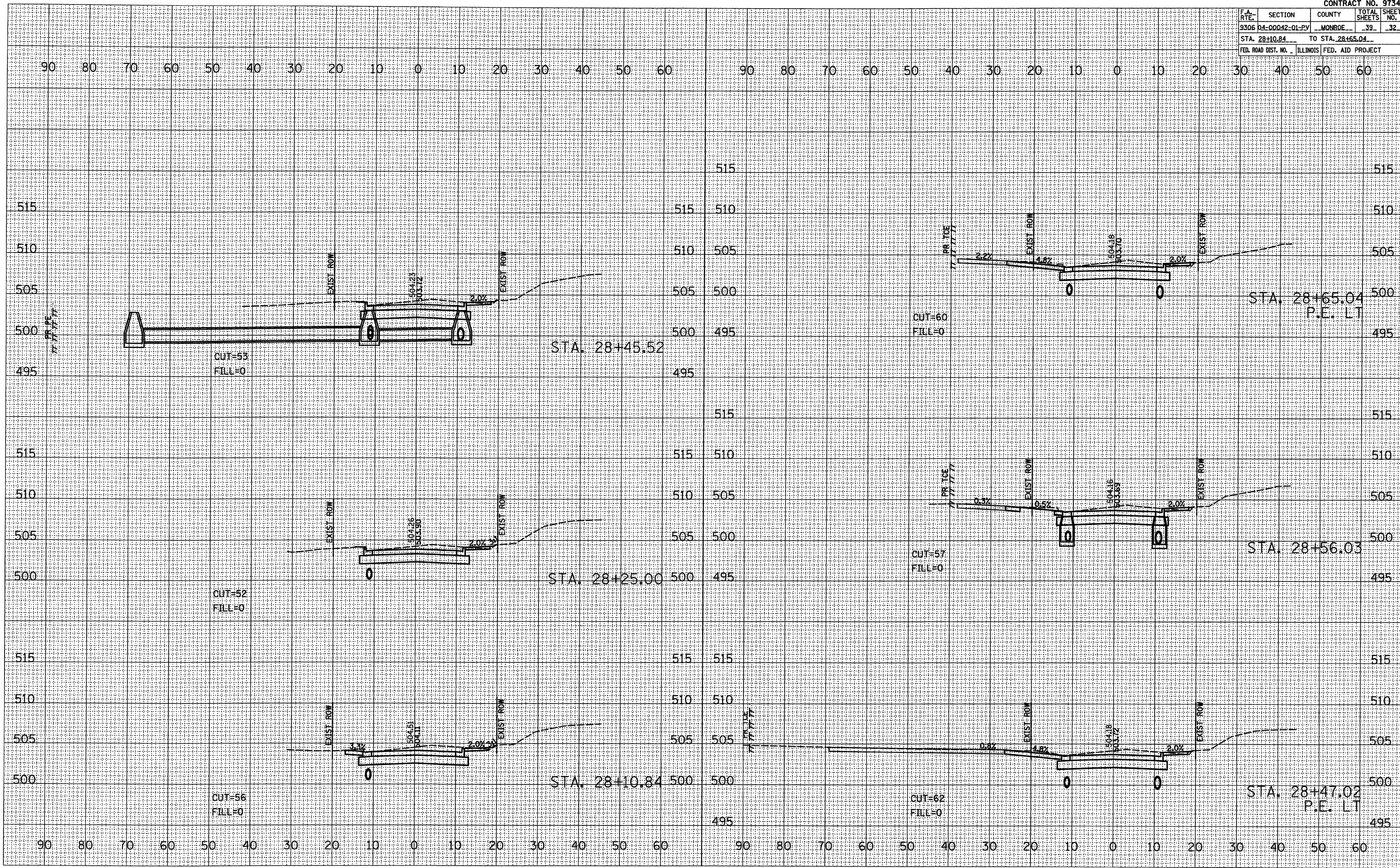

CROSS SECTIONS - LEGION ST.