

F.A. RTE.	SECTION	COUNTY	TOTAL SHEETS	SHEET NO.
9306	04-00042-01-PV	MONROE	39	33
STA. 28+80.22		TO STA. 30+00.00		
FED. ROAD DIST. NO.		ILLINOIS FED. AID PROJECT		

DATE	BY

DATE	BY

PLOT DATE = 7/14/2008
 FILE NAME = #FILE#
 PLOT SCALE = #SCALE#
 REFERENCE = #REF#

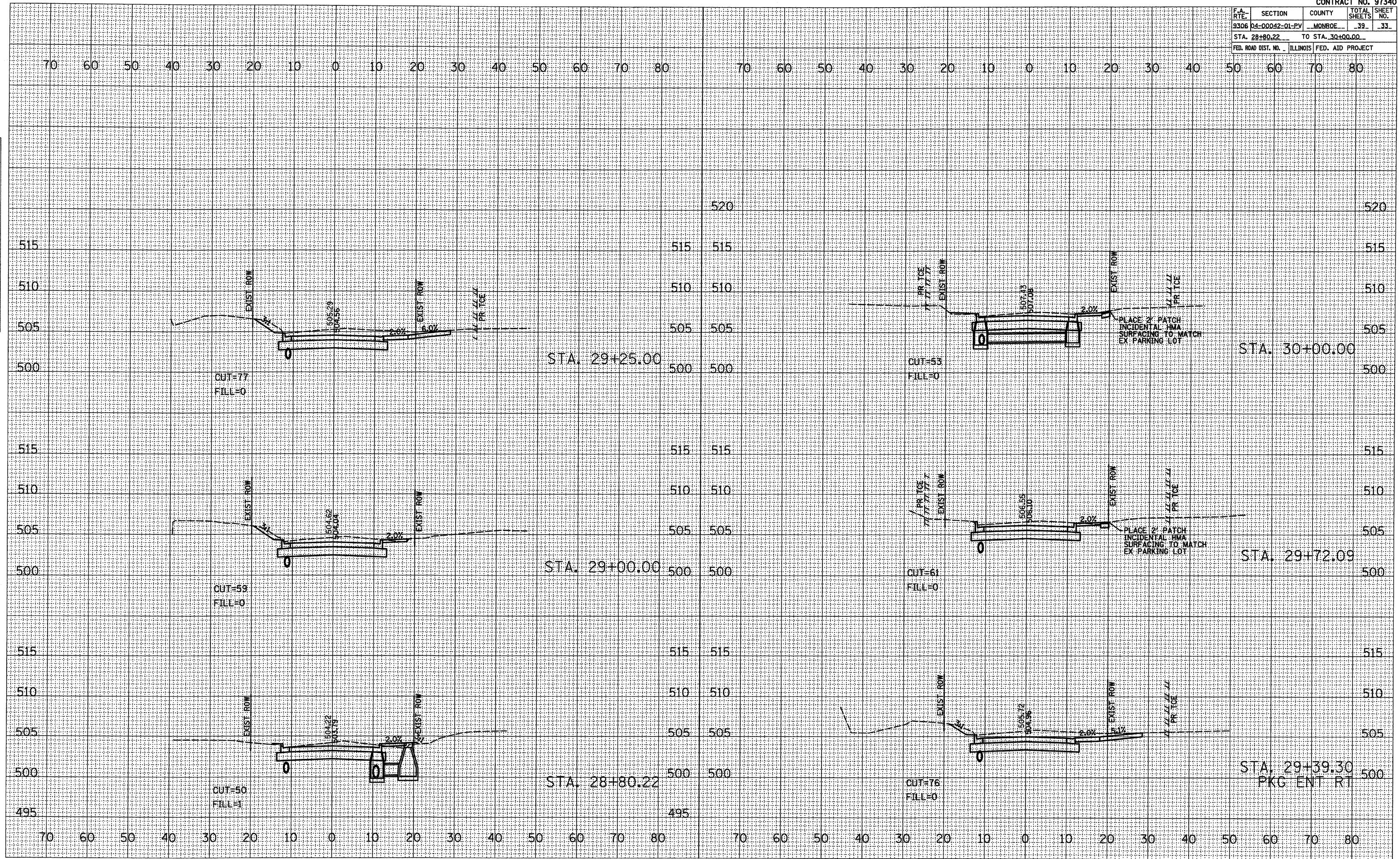

CROSS SECTIONS - LEGION ST.