

| TR                              | SECTION        | COUNTY               | TOTAL SHEETS | SHEET NO. |
|---------------------------------|----------------|----------------------|--------------|-----------|
| 140                             | 07-08135-00-BR | WHITE                | 19           | 3         |
| FED. ROAD DIST. NO. 9 ILLINOIS  |                | LICK CREEK TRIBUTARY |              |           |
| PROJECT # BROS-193136           |                | CONTRACT # 99323     |              |           |
| LEC JOB # H07L009WH & H07L010WH |                |                      |              |           |

323 W. 3RD ST.  
P.O. BOX 160  
MT. CARMEL, IL  
62863  
PHONE:  
(618)-262-8651  
FAX:  
(618)-263-3327

405 W. STATE ST  
SUITE 1  
PRINCETON, IN  
47670  
PHONE:  
(812)-386-7611  
FAX:  
(812)-385-2812



PROFESSIONAL DESIGN FIRM  
LAND SURVEY & PROFESSIONAL ENGINEERING CORPORATION  
184-000887  
(62-032435)(05-002769)

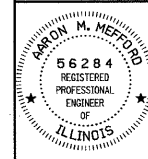

AARON M. MEFFORD  
NAME  
*Aaron Mefford*  
SIGNATURE  
6-23-08  
DATE  
11-30-09  
EXPIRES

TOWNSHIP ROUTE 140  
INDIAN CREEK TOWNSHIP  
WHITE COUNTY, ILLINOIS

SHEET TITLE:

PLAN & PROFILE

SCALE: VARS  
BY: AMM  
DATE: 12/10/07  
REV:

3 OF 19 SHEETS

SHEET NO. 3

NOTE: CONSTRUCTION TRANSITIONS  
STA. 1+00 TO STA 1+50  
STA 7+00 TO STA 7+50  
ALL QUANTITIES ARE INCLUDED IN THE PROPOSAL.

GENERAL NOTES:

THIS SECTION SHALL BE CONSTRUCTED IN ACCORDANCE WITH THE PLANS, SPECIAL PROVISIONS AND "STANDARD SPECIFICATIONS FOR ROAD AND BRIDGE CONSTRUCTION", ADOPTED JANUARY 1, 2007.

THE WORK INVOLVED ON THIS SECTION CONSISTS OF THE REMOVAL OF THE EXISTING STRUCTURE, THE CONSTRUCTION OF A 60 FOOT LONG SINGLE SPAN PRECAST, STRESSING CONCRETE DECK BEAM BRIDGE, EARTH APPROACHES, AGGREGATE SURFACE COURSE AND OTHER MISCELLANEOUS ITEMS NECESSARY TO COMPLETE THIS SECTION.

ALL ELEVATIONS ARE BASED ON U.S.G.S. MEAN SEA LEVEL DATUM.

IT SHALL BE THE CONTRACTOR'S RESPONSIBILITY TO CONTACT ALL THE UTILITIES, AFFECTING THE PROJECT, PRIOR TO CONSTRUCTION.

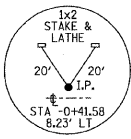

CURVE #1  
P.I. STA= 3+42.07  
Δ= RT. 3°01'40"  
D= 1°25'57"  
R= 4000'  
L= 105.71'  
E= 1.40'  
e= NONE  
T.R.= NONE  
S.E. RUN= NONE  
P.C. STA= 2+36.35  
P.T. STA= 4+47.73

PROPOSED STRUCTURE 097-3262  
BEGINS STA 1+00

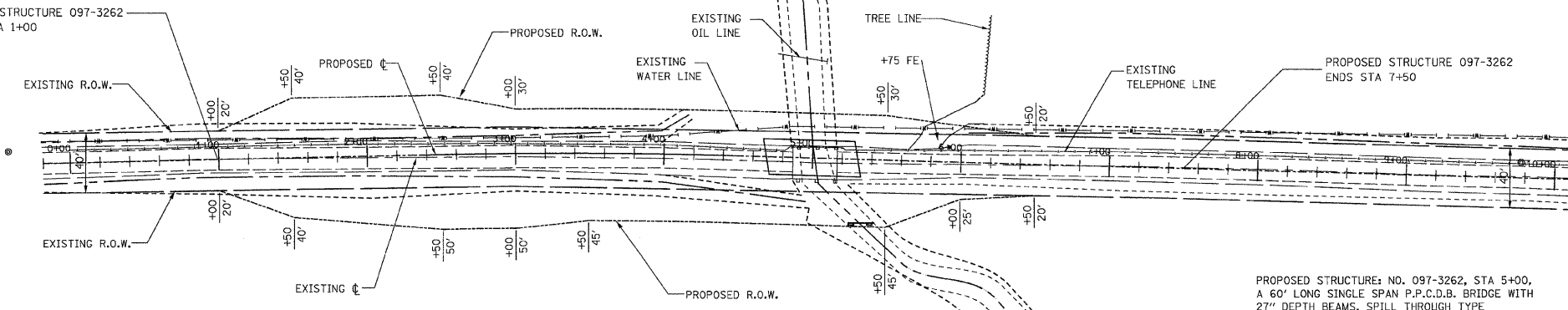

PROPOSED STRUCTURE: NO. 097-3262, STA 5+00,  
A 60' LONG SINGLE SPAN P.P.C.D.B. BRIDGE WITH  
27" DEPTH BEAMS, SPILL THROUGH TYPE  
ABUTMENTS, 24' WIDTH, 4% GRADE, 10° RT. FWD. SKEW.

SEE SHEETS 6,7,13-18 FOR THE DESIGN AND BILL OF MATERIALS.

EXISTING BRIDGE STA 5+01.1; STRUCTURE NUMBER: 097-3070  
A 30' LONG SINGLE SPAN BRIDGE WITH 21" THICK PRECAST  
CONCRETE DECK BEAMS AND 12"x11" CURB WITH WOOD CAP  
ON CONCRETE PILING AND WOOD WINGWALLS & MUDWALLS.

ONE (1) EACH-REMOVAL OF EXISTING STRUCTURES ALLOWED IN  
THIS PROPOSAL.

TYPICAL CROSS SECTION  
PROPOSED

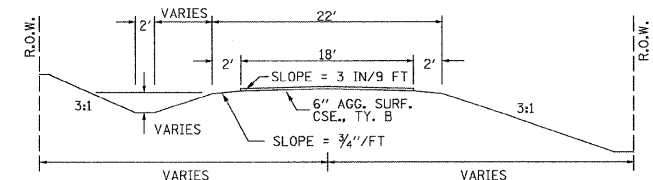

TYPICAL CROSS SECTION  
EXISTING

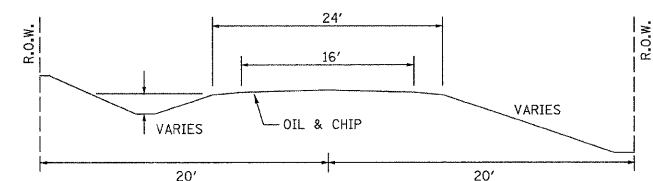

FIELD ENTRANCE DETAIL

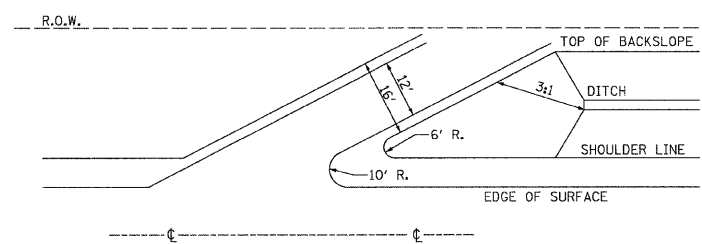

NOTE: CONSTRUCT SPECIAL DITCH  
STA 1+00 TO STA 4+00 LT  
STA 1+00 TO STA 4+78 RT

NOTE: CONSTRUCT STONE RIPRAP DITCH  
STA 1+47 TO STA 1+53 RT & LT (0.62 TON/LIN FT)  
STA 1+97 TO STA 2+03 RT & LT (0.62 TON/LIN FT)  
STA 2+47 TO STA 2+53 RT & LT (0.62 TON/LIN FT)  
STA 2+97 TO STA 3+03 RT & LT (0.62 TON/LIN FT)  
STA 3+47 TO STA 3+53 RT & LT (0.62 TON/LIN FT)  
STA 4+00 TO STA 4+78 RT & LT (0.62 TON/LIN FT)  
134 TON STONE RIPRAP DITCH ALLOWED IN PROPOSAL.

SEE SHEET NO. 19 FOR STONE RIPRAP DITCH DETAIL.

UTILITIES:

JULI.I.E. 1-800-892-0123

VERIZON  
1-618-395-6191

GALLATIN-WHITE WATER DISTRICT  
1-618-962-3265

AGGREGATE DITCH CHECKS  
AGGREGATE (EROSION CONTROL)

0.3 ACRES TREE REMOVAL, ACRES  
0.5 ACRES SEEDING, CLASS 2 SPECIAL REQUIRED

NOTE: FILL NEXT TO BRIDGE TO BE  
AGGREGATE SURFACE COURSE

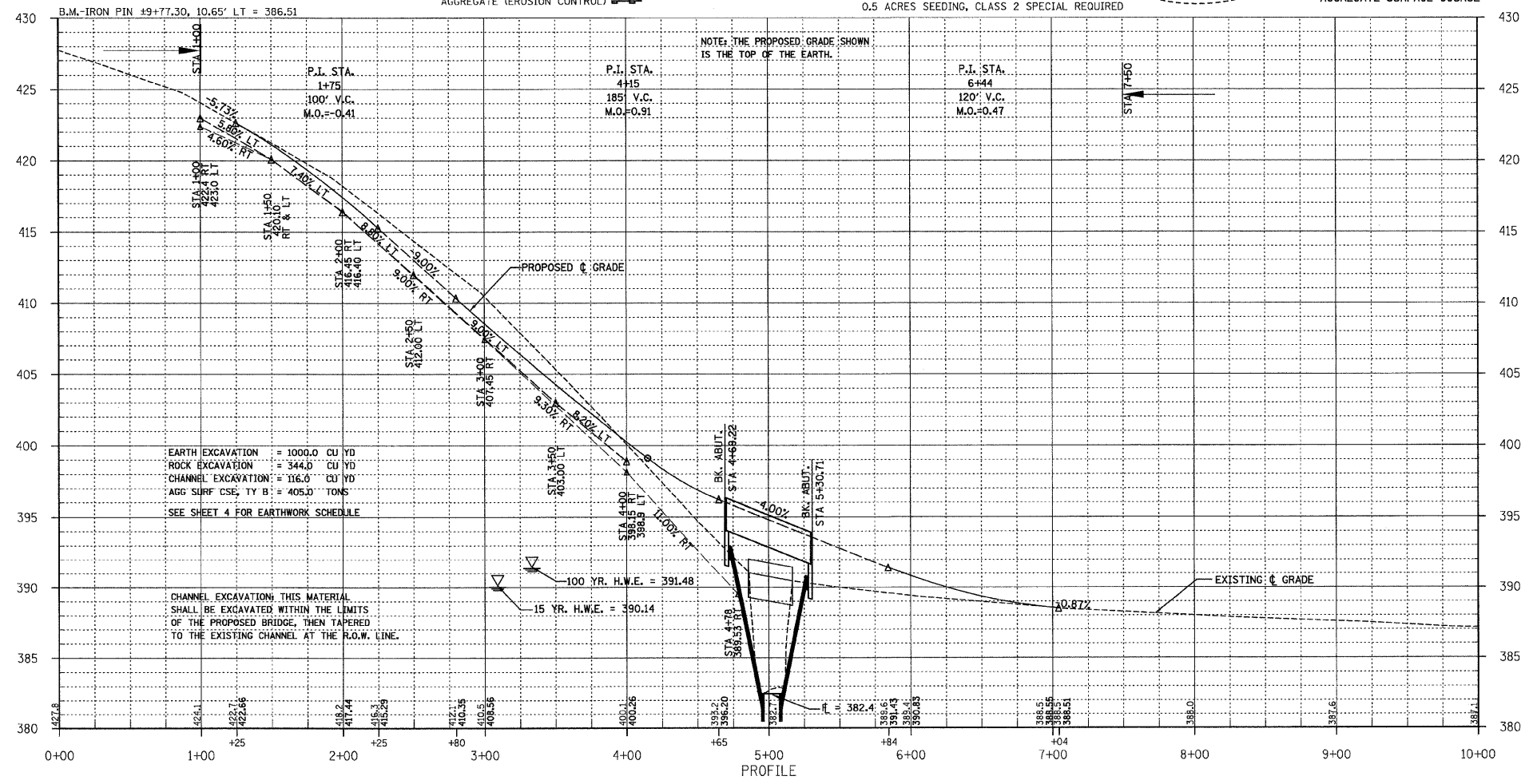

EARTH EXCAVATION = 1000.0 CU YD  
ROCK EXCAVATION = 344.0 CU YD  
CHANNEL EXCAVATION = 116.0 CU YD  
AGG SURF CSE, TY B = 405.0 TONS  
SEE SHEET 4 FOR EARTHWORK SCHEDULE

CHANNEL EXCAVATION THIS MATERIAL  
SHALL BE EXCAVATED WITHIN THE LIMITS  
OF THE PROPOSED BRIDGE, THEN TAPERED  
TO THE EXISTING CHANNEL AT THE R.O.W. LINE.

NOTE: THE PROPOSED GRADE SHOWN  
IS THE TOP OF THE EARTH.

100 YR. H.W.E. = 391.48  
15 YR. H.W.E. = 390.14