

4+65

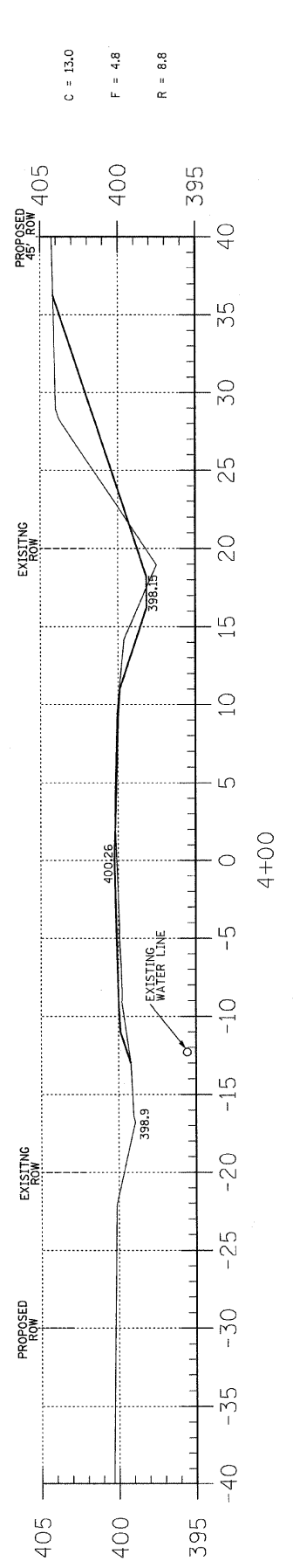

4+00

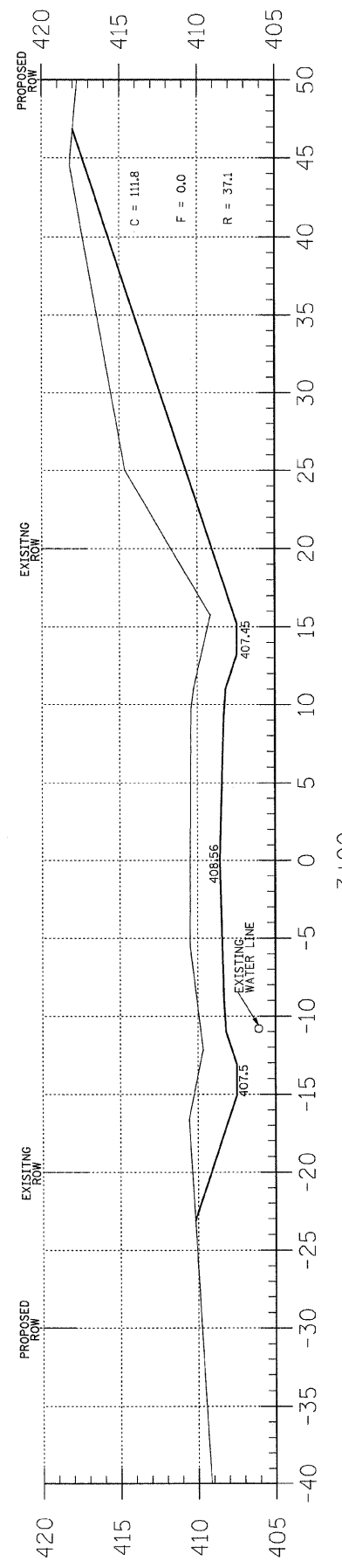

3+00

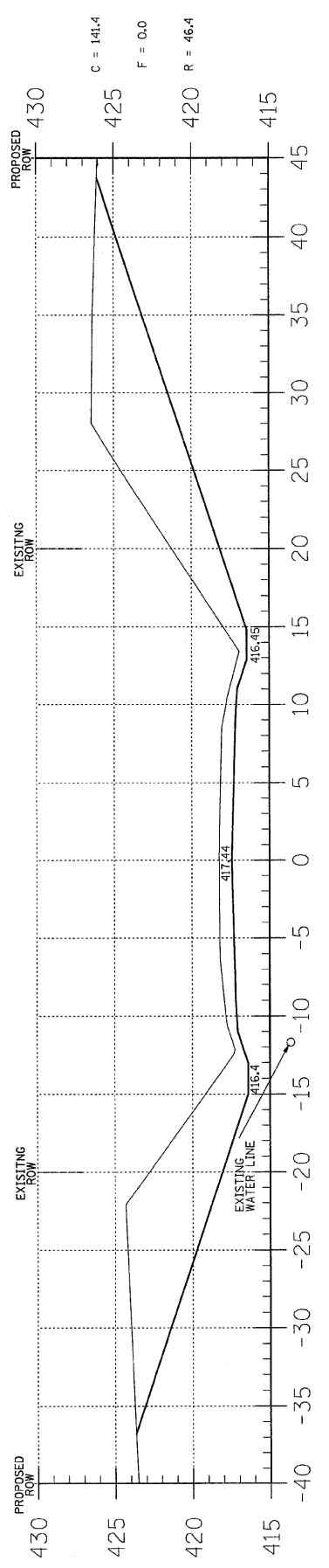

2+00

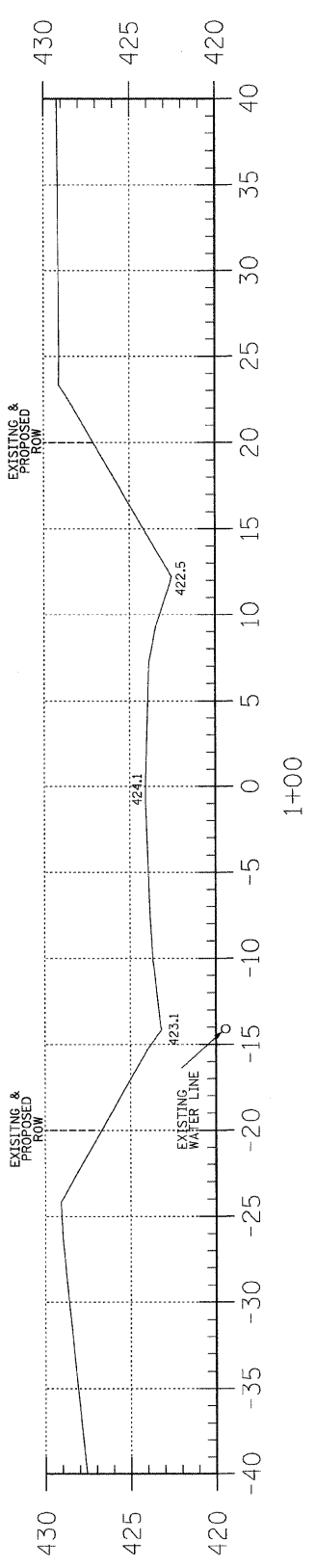

1+00

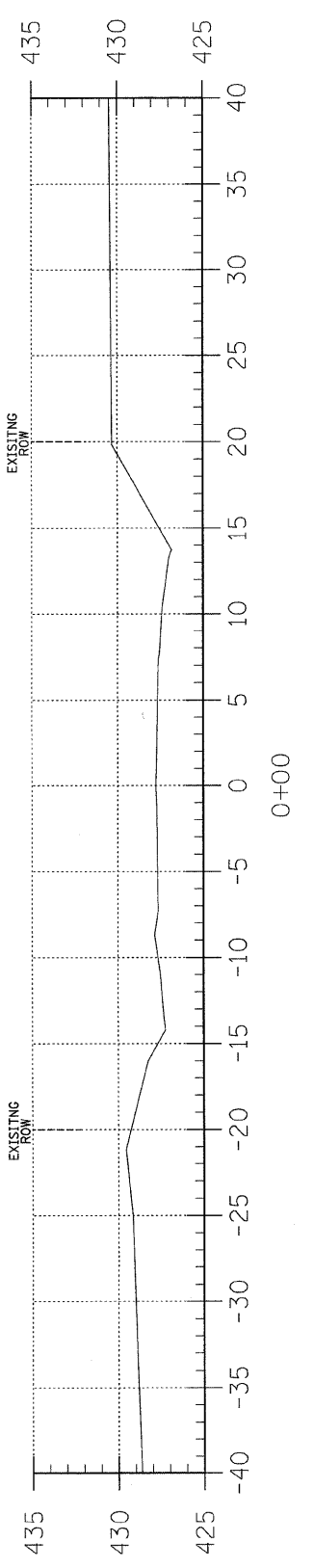

0+00

EARTHWORK SCHEDULE

LOCATION	EARTH EXCAVATION	ROCK EXCAVATION	CHANNEL EXCAVATION	ESTIMATED UNSUITABLE MATERIAL	SUITABLE MATERIAL ADJUSTED FOR SHRINKAGE	EMBANKMENT	EARTHWORK BALANCE WASTE (+) OR SHORTAGE (-)
	CUBIC YARD	CUBIC YARD	CUBIC YARD	CUBIC YARD	CUBIC YARD	CUBIC YARD	CUBIC YARD
STA 0+00 TO 4+69.2	998.6	344.1	0.0	0.0	1007.0	129.0	+878.0
STA 4+69.2 TO 5+30.7	0.0	0.0	115.7	57.8	43.4	0.0	+43.4
STA 5+30.7 TO 10+00	1.1	0.0	0.0	0.0	0.8	330.2	-329.4
1 FIELD ENTRANCE	0.0	0.0	0.0	0.0	0.0	35.9	-35.9
TOTAL	999.7	344.1	115.7	57.8	1051.2	495.1	556.1

T.R.	SECTION	COUNTY	TOTAL SHEETS	SHEET NO.
140	07-08135-00-BR	WHITE	19	4
FED. ROAD DIST. NO. 5 ILLINOIS		LICK CREEK TRIBUTARY		
PROJECT # BROS-19336		CONTRACT # 99323		
LEC JOB # HOTLOO9WH & HOTLOO9H				

323 W. 3RD ST.
P.O. BOX 160
MT. CARMEL, IL 62863
PHONE: (618)-262-8651
FAX: (618)-263-3327

405 W. STATE ST.
SUITE 1
PRINCETON, IN 47670
PHONE: (812)-386-7611
FAX: (812)-385-2812



PROFESSIONAL DESIGN FIRM
LAND SURVEY & PROFESSIONAL ENGINEERING CORPORATION
184-000887
(62-032435)(65-002769)



AARON M. MEFFORD
NAME
Aaron Mefford
SIGNATURE
6-23-08
DATE
11-30-09 EXPIRES

TOWNSHIP ROUTE 140
INDIAN CREEK TOWNSHIP
WHITE COUNTY, ILLINOIS

SHEET TITLE:

CROSS-SECTIONS

SCALE: 1" = 5'
BY: AMM
DATE: 9/2008
REV:

4 OF 19 SHEETS

SHEET NO. 4