

**GENERAL NOTES:**

THIS SECTION SHALL BE CONSTRUCTED IN ACCORDANCE WITH THE PLANS, SPECIAL PROVISIONS AND "STANDARD SPECIFICATIONS FOR ROAD AND BRIDGE CONSTRUCTION", ADOPTED JANUARY 1, 2007.

THE WORK INVOLVED ON THIS SECTION CONSISTS OF THE REMOVAL OF THE EXISTING STRUCTURE, THE CONSTRUCTION OF A 50 FOOT LONG SINGLE SPAN PRECAST, PRESTRESSED CONCRETE DECK BEAM BRIDGE, EARTH APPROACHES, AGGREGATE SURFACE COURSE AND OTHER MISCELLANEOUS ITEMS NECESSARY TO COMPLETE THIS SECTION.

ALL ELEVATIONS ARE BASED ON U.S.G.S. MEAN SEA LEVEL DATUM.

IT SHALL BE THE CONTRACTOR'S RESPONSIBILITY TO CONTACT ALL THE UTILITIES, AFFECTING THE PROJECT, PRIOR TO CONSTRUCTION.

NOTE: CONSTRUCTION TRANSITION  
STA. 12+25 TO STA 12+75  
STA. 17+10 TO STA 17+60  
ALL QUANTITIES ARE INCLUDED IN THE PROPOSAL

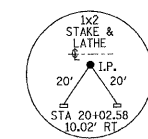
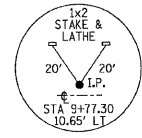

CURVE #1  
P.I. STA= 16+02.11  
Δ= LT. 1°48'49"  
D= 1°08'45"  
R= 5000'  
T= 79.14'  
L= 158.26'  
E= 0.63'  
e= NONE  
T.R.= NONE  
S.E. RUN= NONE  
P.C. STA= 15+22.97  
P.T. STA= 16+81.23

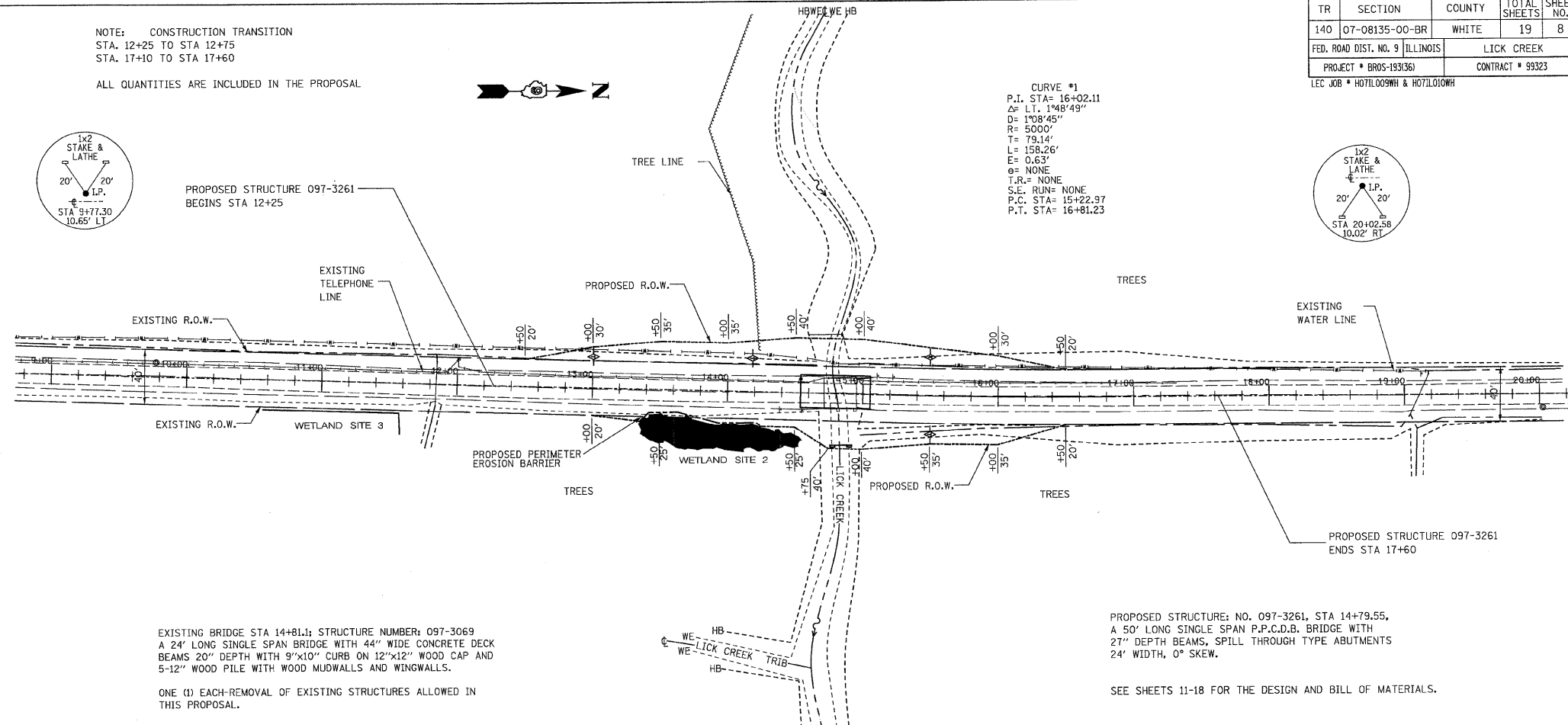

**TYPICAL CROSS SECTION PROPOSED**

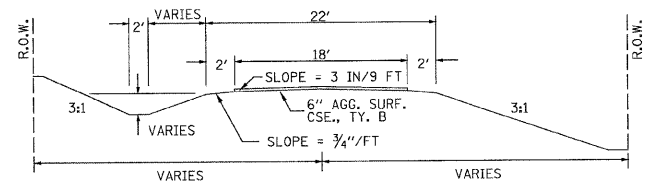

**TYPICAL CROSS SECTION EXISTING**

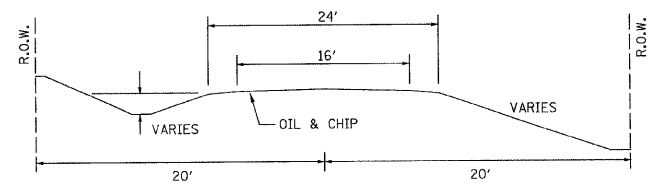

EXISTING BRIDGE STA 14+81.1; STRUCTURE NUMBER: 097-3069  
A 24' LONG SINGLE SPAN BRIDGE WITH 44" WIDE CONCRETE DECK BEAMS 20" DEPTH WITH 9"x10" CURB ON 12"x12" WOOD CAP AND 5-12" WOOD PILE WITH WOOD MUDWALLS AND WINGWALLS.

ONE (1) EACH-REMOVAL OF EXISTING STRUCTURES ALLOWED IN THIS PROPOSAL.

PROPOSED STRUCTURE: NO. 097-3261, STA 14+79.55, A 50' LONG SINGLE SPAN P.P.C.D.B. BRIDGE WITH 27" DEPTH BEAMS, SPILL THROUGH TYPE ABUTMENTS 24' WIDTH, 0° SKEW.

SEE SHEETS 11-18 FOR THE DESIGN AND BILL OF MATERIALS.

**UTILITIES:**

J.U.L.I.E. 1-800-892-0123

VERIZON  
1-618-395-6191

GALLATIN-WHITE WATER DISTRICT  
1-618-962-3265

NOTE: PERIMETER EROSION BARRIER

STA 13+35 TO STA 14+25 RT

SHALL BE PLACED SO AS TO KEEP WETLAND PROTECTED DURING CONSTRUCTION.

NOTE: CONSTRUCT SPECIAL DITCH

STA 12+50 TO STA 14+63 LT  
STA 14+97 TO STA 16+50 RT  
STA 14+97 TO STA 16+50 LT

NOTE: CONSTRUCT STONE RIPRAP DITCH

STA 14+53 TO STA 14+63 LT (0.62 TON/LIN FT)  
STA 14+97 TO STA 15+08 RT (0.62 TON/LIN FT)  
STA 14+97 TO STA 15+08 LT (0.62 TON/LIN FT)  
20 TON STONE RIPRAP DITCH ALLOWED IN PROPOSAL.

SEE SHEET NO. 19 FOR STONE RIPRAP DITCH DETAIL.

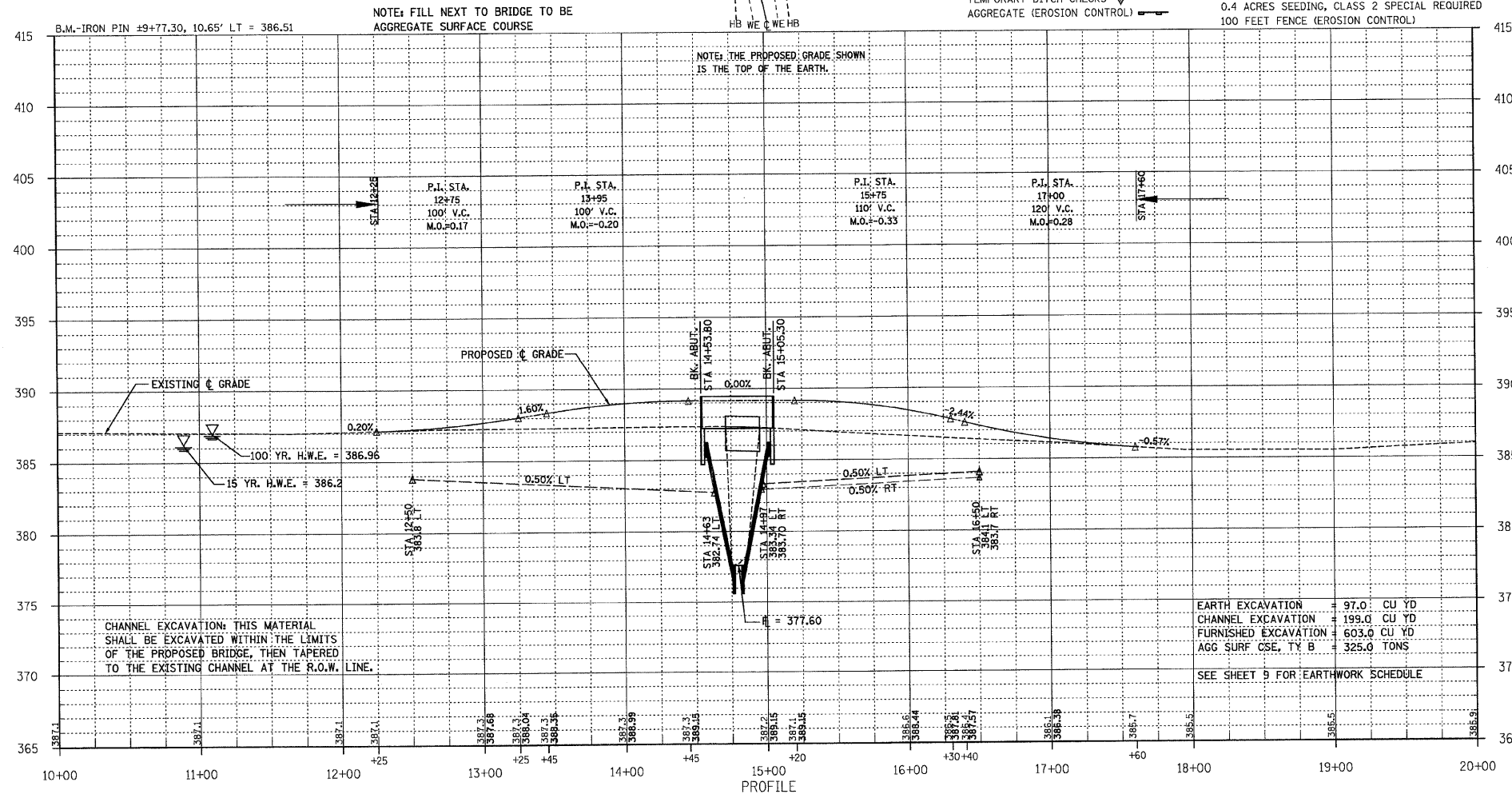

EARTH EXCAVATION = 97.0 CU YD  
CHANNEL EXCAVATION = 199.0 CU YD  
FURNISHED EXCAVATION = 603.0 CU YD  
AGG SURF CSE, TY B = 325.0 TONS  
SEE SHEET 9 FOR EARTHWORK SCHEDULE

TR	SECTION	COUNTY	TOTAL SHEETS	SHEET NO.
140	07-08135-00-BR	WHITE	19	8

323 W. 3RD ST.  
P.O. BOX 160  
MT. CARMEL, IL 62863  
PHONE: (618)-262-8651  
FAX: (618)-263-3327

405 W. STATE ST  
SUITE 1  
PRINCETON, IN 47670  
PHONE: (812)-386-7611  
FAX: (812)-385-2812

PROFESSIONAL DESIGN FIRM  
LAND SURVEY & PROFESSIONAL ENGINEERING CORPORATION  
184-000887  
(62-032435)(35-02769)



AARON M. MEFFORD  
NAME  
SIGNATURE  
DATE  
11-30-09  
EXPIRES

TOWNSHIP ROUTE 140  
INDIAN CREEK TOWNSHIP  
WHITE COUNTY, ILLINOIS

SHEET TITLE:  
PLAN & PROFILE

SCALE: VRIES  
BY: AMM  
DATE: 3/20/08  
REV:

8 OF 19 SHEETS  
SHEET NO. 8