

JUL 25, 2008 9:42 AM VOORHOEDBES  
 I:\AIRPORTS\ST. LOUIS DOWNTOWN\8450TELEC\AIRPORT\SHETS\R-1025IT.DWG - Layout1

SD049

THE LOCATION, SIZE AND TYPE OF MATERIAL OF EXISTING UNDERGROUND UTILITIES INDICATED ON THE PLANS IS NOT REPRESENTED AS BEING ACCURATE, SUFFICIENT OR COMPLETE. IT SHALL BE THE CONTRACTOR'S RESPONSIBILITY TO DETERMINE THE ACTUAL LOCATION OF ALL SUCH FACILITIES, INCLUDING SERVICE CONNECTIONS TO UNDERGROUND UTILITIES. PRIOR TO CONSTRUCTION, THE CONTRACTOR SHALL NOTIFY THE UTILITY COMPANIES OF HIS OPERATIONAL PLANS AND SHALL OBTAIN FROM THE RESPECTIVE UTILITY COMPANIES DETAILED INFORMATION AND ASSISTANCE RELATIVE TO THE LOCATION OF THEIR FACILITIES AND THE WORKING SCHEDULE OF THE COMPANIES FOR REMOVAL OR ADJUSTMENT WHERE REQUIRED. IN THE EVENT AN UNEXPECTED UTILITY INTERFERENCE IS ENCOUNTERED DURING CONSTRUCTION, THE CONTRACTOR SHALL IMMEDIATELY NOTIFY THE UTILITY COMPANY OF JURISDICTION. THE ENGINEER SHALL ALSO BE IMMEDIATELY NOTIFIED. ANY SUCH MAINS AND SERVICES SHALL BE RESTORED TO SERVICE AT ONCE AND PAID FOR BY THE CONTRACTOR AT NO ADDITIONAL COST TO THE CONTRACT.

CALL J.U.L.I.E. FOR UTILITY INFORMATION AT 1-800-892-0123. CONTACT FAA FOR ASSISTANCE IN LOCATING FAA CABLES AND UTILITIES.

**NOTES**

1. SEE SHEET 5 PROPOSED ELECTRICAL SITE PLAN FOR SITE LEGEND.

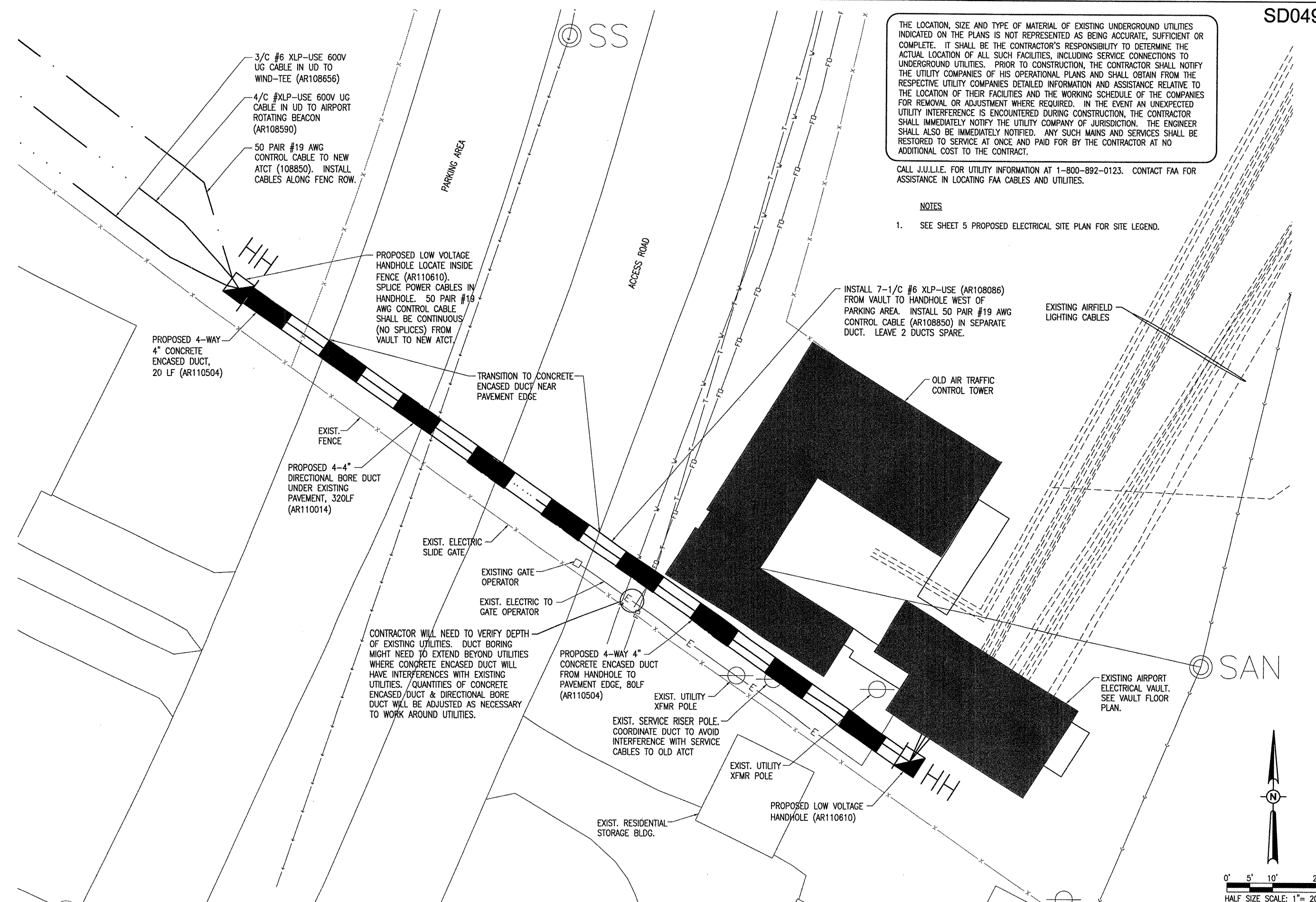

3/C #6 XLP-USE 600V UG CABLE IN UD TO WIND-TEE (AR108656)  
 4/C #XLP-USE 600V UG CABLE IN UD TO AIRPORT ROTATING BEACON (AR108590)  
 50 PAIR #19 AWG CONTROL CABLE TO NEW ATCT (108850). INSTALL CABLES ALONG FENC ROW.

PROPOSED LOW VOLTAGE HANDHOLE LOCATE INSIDE FENCE (AR110610). SPLICE POWER CABLES IN HANDHOLE. 50 PAIR #19 AWG CONTROL CABLE SHALL BE CONTINUOUS (NO SPLICES) FROM VAULT TO NEW ATCT.

PROPOSED 4-WAY 4" CONCRETE ENCASED DUCT, 20 LF (AR110504)

PROPOSED 4-4" DIRECTIONAL BORE DUCT UNDER EXISTING PAVEMENT, 320LF (AR110014)

CONTRACTOR WILL NEED TO VERIFY DEPTH OF EXISTING UTILITIES. DUCT BORING MIGHT NEED TO EXTEND BEYOND UTILITIES WHERE CONCRETE ENCASED DUCT WILL HAVE INTERFERENCES WITH EXISTING UTILITIES. QUANTITIES OF CONCRETE ENCASED DUCT & DIRECTIONAL BORE DUCT WILL BE ADJUSTED AS NECESSARY TO WORK AROUND UTILITIES.

PROPOSED 4-WAY 4" CONCRETE ENCASED DUCT FROM HANDHOLE TO PAVEMENT EDGE, 80LF (AR110504)

INSTALL 7-1/C #6 XLP-USE (AR108086) FROM VAULT TO HANDHOLE WEST OF PARKING AREA. INSTALL 50 PAIR #19 AWG CONTROL CABLE (AR108850) IN SEPARATE DUCT. LEAVE 2 DUCTS SPARE.

DATE	REVISION	BY

**SAINT LOUIS DOWNTOWN AIRPORT**  
 A Division of Bi-State Development Agency  
 I.L. PROJ.: OPS-3708  
 I.L. PROJ.: 3-17-0039-B18

Hanson Project No. 8450TELEC.D.0800	FILENAME R-1025IT.DWG	Scale 1" = 10'	Date 07/16/07
LAYOUT	KNL	05/22/07	07/13/07
DRAWN	BAK	05/22/07	
REVIEWED	CAH		

**HANSON**  
 Hanson Professional Services Inc.  
 4227 Earth City Expressway, Suite 130  
 St. Louis, MO 63045-1308  
 Offices Nationwide

ATCT INTERFACE TO VAULT  
 OLD ATCT SITE DETAIL  
 PLAN