

PLAN	SURVEYED	DATE
	PLOTTED	
	ALIGNED	
	CHECKED	
	FILE NAME	
	NO.	

PROFILE	SURVEYED	DATE
	PLOTTED	
	GRADES CHECKED	
	STRUCTURE	
	NOTATIONS CHECKED	
	NO.	

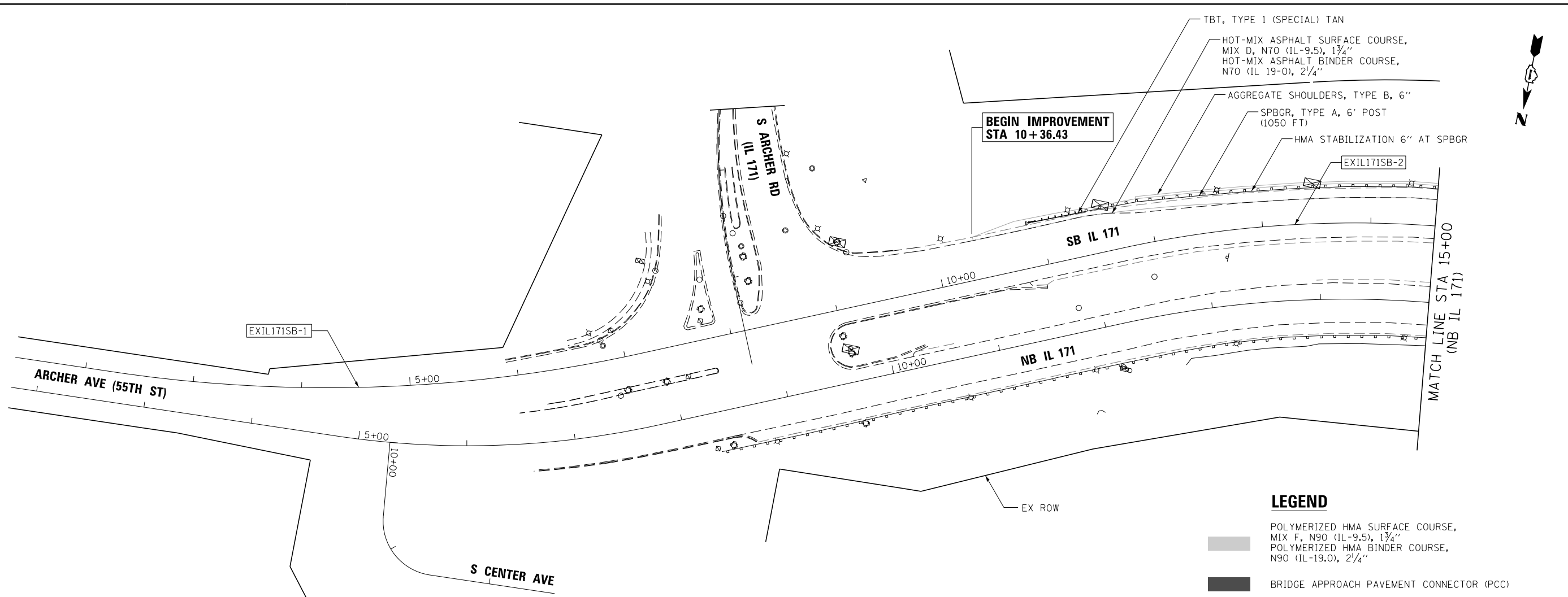

**BEGIN IMPROVEMENT
STA 10+36.43**

EXIL171SB-2

EXIL171SB-1

LEGEND

- POLYMERIZED HMA SURFACE COURSE, MIX F, N90 (IL-9.5), 1 3/4"
- POLYMERIZED HMA BINDER COURSE, N90 (IL-19.0), 2 1/4"
- BRIDGE APPROACH PAVEMENT CONNECTOR (PCC)
- POLYMERIZED HMA SURFACE COURSE, MIX F, N90 (IL-9.5), 2"
- HMA BASE COURSE, 10 3/4"

NOTE: SHOULDER TAPER RATES SHOULD FOLLOW HIGHWAY STANDARD 630301 UNLESS OTHERWISE STATED ON THE PLANS.

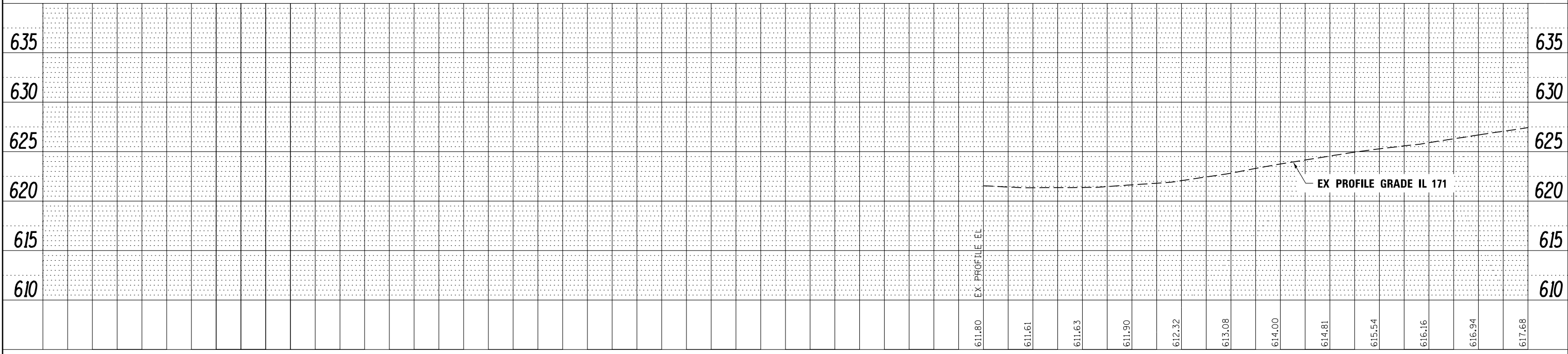

FILE NAME =	DESIGNED - AAA	REVISED -
...\\D160J16-shr-IL171-pln-SB-01.dgn	DRAWN - TMB	REVISED -
USER NAME = tblank	CHECKED - JMM	REVISED -
PLOT DATE = 8/7/2014	DATE - 6/23/2014	REVISED -



**STATE OF ILLINOIS
DEPARTMENT OF TRANSPORTATION**

**ROADWAY PLAN & PROFILE
IL 171**

SCALE: 1"=50' SHEET NO. 1 OF 13 SHEETS STA. 10+36.43 TO STA. 15+00.00

F.A.P. R.E.	SECTION	COUNTY	TOTAL SHEETS	SHEET NO.
372/373	2013-038B-R	COOK	821	49
CONTRACT NO. 60J16			ILLINOIS FED. AID PROJECT	