

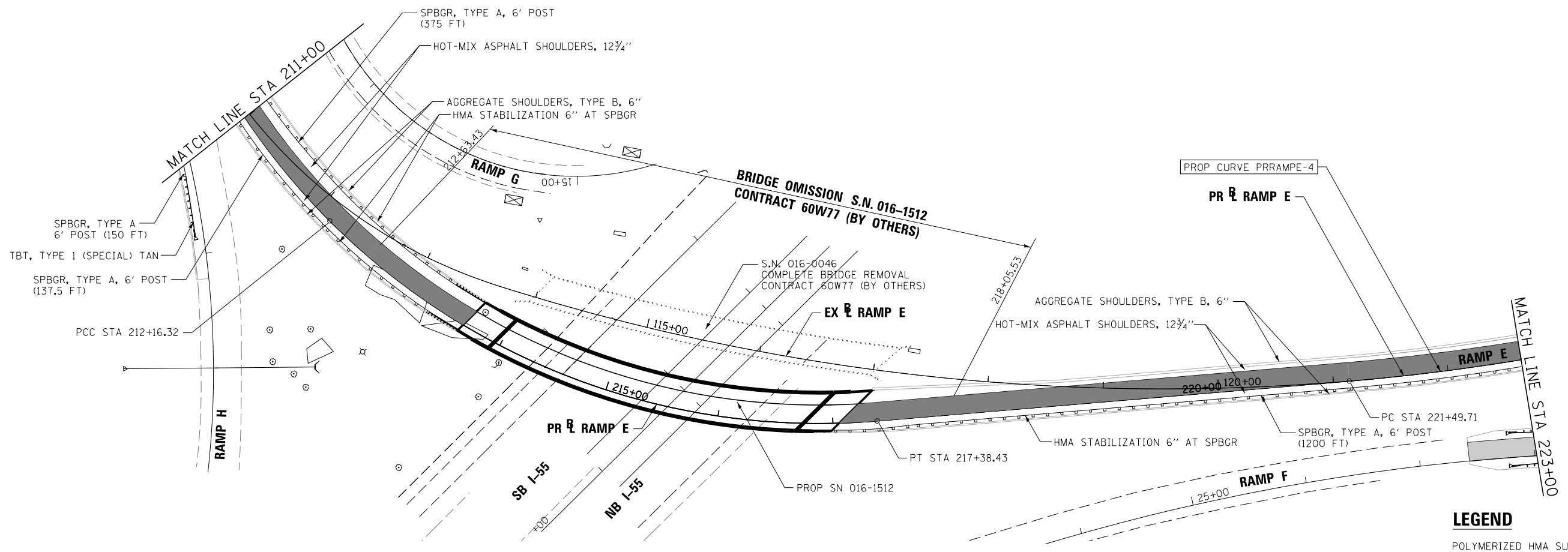

PLAN	SURVEYED	DATE
	PLOTTED	
	NOTE BOOK	
	NO.	
	CHECKED	
	FILE NAME	

PROFILE	SURVEYED	DATE
	PLOTTED	
	GRADES CHECKED	
	NO.	
	STRUCTURE	
	NOTATIONS	



LEGEND

- POLYMERIZED HMA SURFACE COURSE, MIX F, N90 (IL-9.5), 1 3/4"
- POLYMERIZED HMA BINDER COURSE, N90 (IL-19.0), 2 1/4"
- BRIDGE APPROACH PAVEMENT CONNECTOR (PCC)
- POLYMERIZED HMA SURFACE COURSE, MIX F, N90 (IL-9.5), 2" HMA BASE COURSE, 10 3/4"

NOTE: SHOULDER TAPER RATES SHOULD FOLLOW HIGHWAY STANDARD 630301 UNLESS OTHERWISE STATED ON THE PLANS.

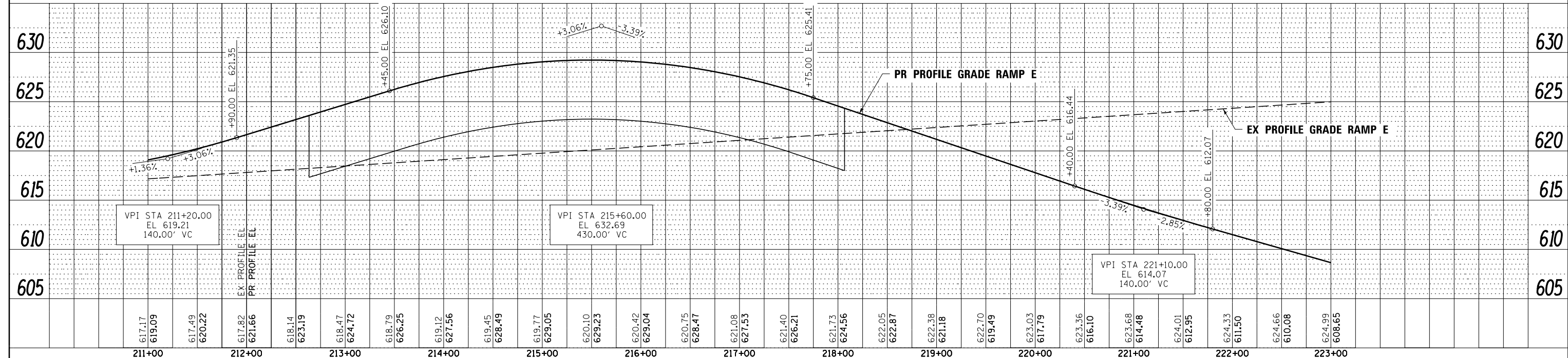

FILE NAME =	DESIGNED - AAA	REVISED -		STATE OF ILLINOIS DEPARTMENT OF TRANSPORTATION		ROADWAY PLAN & PROFILE RAMP E		F.A.P. R.T.E.	SECTION	COUNTY	TOTAL SHEETS	SHEET NO.
...\\D160J16-sh1-ramp_E3-plnprf.dgn	DRAWN - TMB	REVISED -						372/373	2013-038B-R	COOK	821	59
USER NAME = tblank	CHECKED - JMM	REVISED -						CONTRACT NO. 60J16				
PLOT DATE = 8/7/2014	DATE - 6/23/2014	REVISED -						ILLINOIS FED. AID PROJECT				

SCALE: 1"=50' SHEET NO. 11 OF 13 SHEETS STA. 211+00.00 TO STA. 223+00.00