

SCHEDULE OF SIGNS

SIGN NUMBER	SIGN TYPE	TYPE
1	DETOUR AHEAD	W20-2 (0) 48
2	EXIT CLOSED	E5-2a-4836
3	ROAD CLOSED	R11-4 6030
4	DETOUR	M4-10 (0) 4818
5	DETOUR	M4-10 (0) 4818
6	END DETOUR	M4-8a (0) 2418
7	UP	M6-3 2115
8	RIGHT	M5-1R 2115
8A	RIGHT	M5-2R 2115
9	RIGHT	M6-1R 2115
9A	RIGHT	M6-2R 2115
10	LEFT	M5-1L 2115
11	LEFT	M6-1L 2015:30"
12	NO LEFT TURN	R3-2 30"x30" R3-2 30"x30"
13	NO RIGHT TURN	R3-2 30"x30" R3-2 30"x30"
14	NORTH	M3-4 (0) 2412 M3-2 (0) 2412
15	SOUTH	M3-4 (0) 2412
16	DETOUR	M1-7 2412
17	TO	R2-1-1212
18	ILLINOIS 171	M1-5-4536
19	SHIELD 55	M1-1-3636
20	ONLY	M4-5-3618
21	ROAD CONSTRUCTION AHEAD	W20-1103-48

LEGEND

- 48" x 48" (1.2 m x 1.2 m) CONSTRUCTION WARNING SIGN, WITH AMBER FLASHING LIGHT NUMBER DENOTES TYPE
- M1-5 FOR IL-171 SERIES DETOUR SIGN WITH ROAD NAME AND DIRECTION PLATES, NUMBER DENOTES TYPE
- OTHER DETOUR SIGNS, NUMBER DENOTES TYPE
- TYPE III BARRICADE WITH AMBER FLASHING LIGHTS
- DETOUR ROUTE
- RAMP CLOSED
- WORK ZONE
- EXISTING OVERHEAD SIGN TO BE COVERED

NOTES:

1. ALL SIGNAGE ON I-55 TO BE CO-ORDINATED WITH CONTRACT 60W77.
2. FOLLOW TC-21 FOR DETOUR SIGNING.
3. FOLLOW TC-08 FOR RAMP G CLOSURE SIGNING.
4. COVER EXISTING IL 171 SIGNS IF IN CONFLICT WITH DETOUR SIGN.
5. EXACT SIGN LOCATIONS TO BE DETERMINED BY THE ENGINEER.

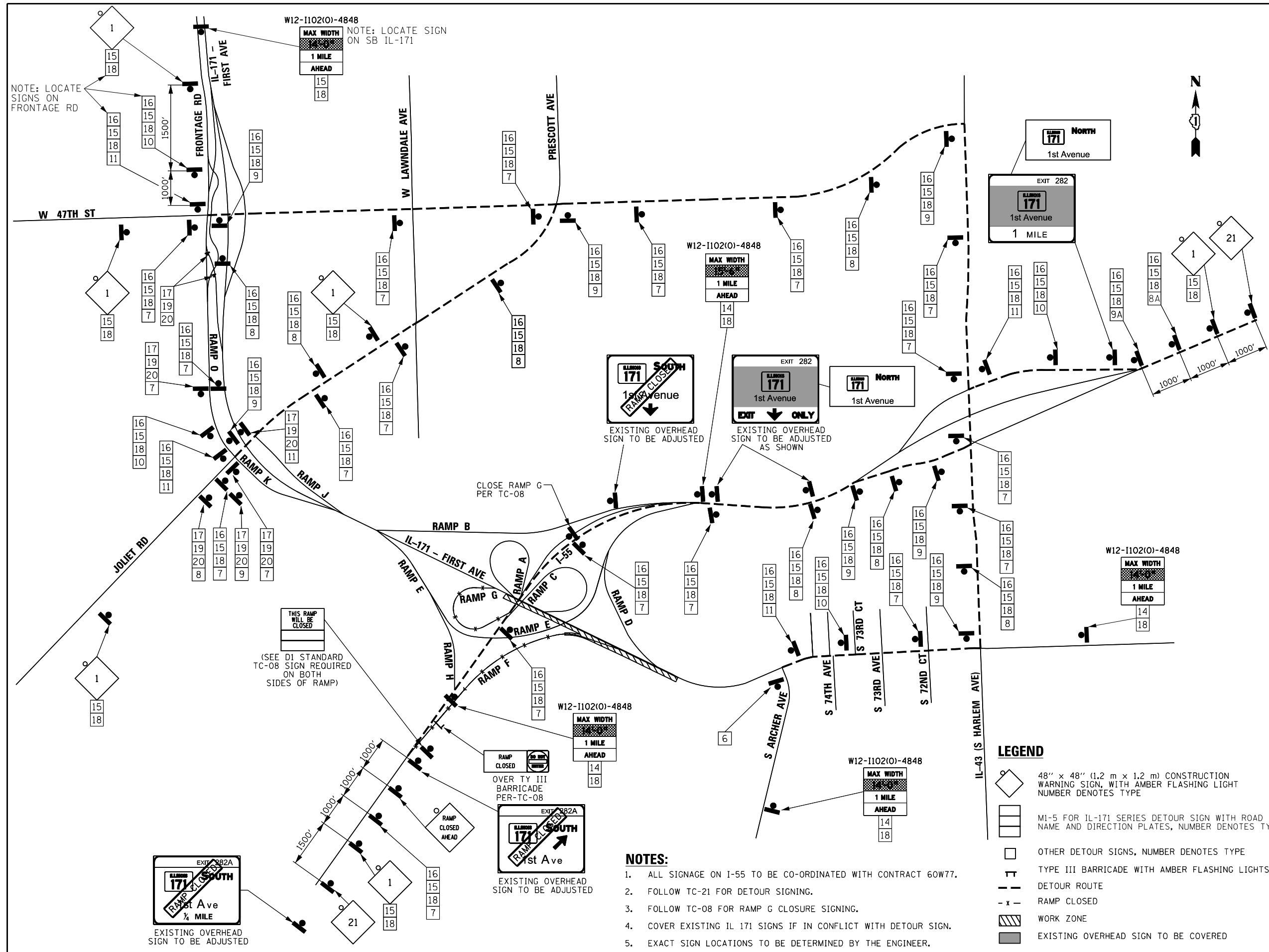

FILE NAME =	DESIGNED - AAA	REVISED -
... \MOT\DI60J16-Detour-1a.dgn	DRAWN - TMB	REVISED -
USER NAME = agibson	CHECKED - JMM	REVISED -
PLOT DATE = 8/20/2014	DATE - 6/23/2014	REVISED -



**STATE OF ILLINOIS
DEPARTMENT OF TRANSPORTATION**

**MAINTENANCE OF TRAFFIC
DETOUR 1A**

SHEET 13 OF 50 SHEETS STA. TO STA.

F.A.P. RFE.	SECTION	COUNTY	TOTAL SHEETS	SHEET NO.
372/373	2013-038B-R	COOK	821	74
CONTRACT NO. 60J16			ILLINOIS FED. AID PROJECT	