

PLAN

- NOTES:**
1. See sheet SC19 of SC35 for Sections C-C & D-D and View E-E. a106(E), a107(E) and a108(E) bar spacings measured along \varnothing Rdwy.
 2. The joint opening shall be determined per Article 520.04 except that on jointless structures, the distance described as the bridge length between the nearest fixed bearings each way from the joint shall be taken as half the bridge length plus the approach slab length. The minimum dimension shall be 1 1/2" for installation purposes.
 3. Bars indicated thus 12x2-#4 etc. indicates 12 lines of bars with 2 lengths per line.

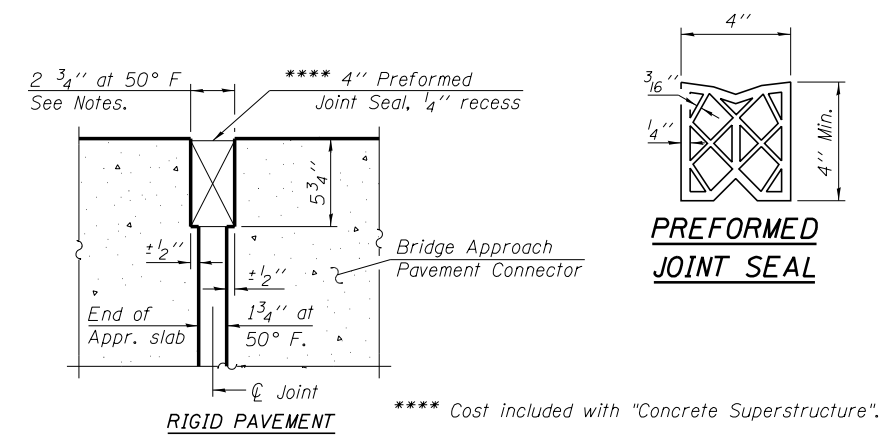

DETAIL A

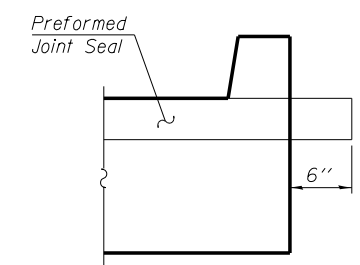

VIEW F-F

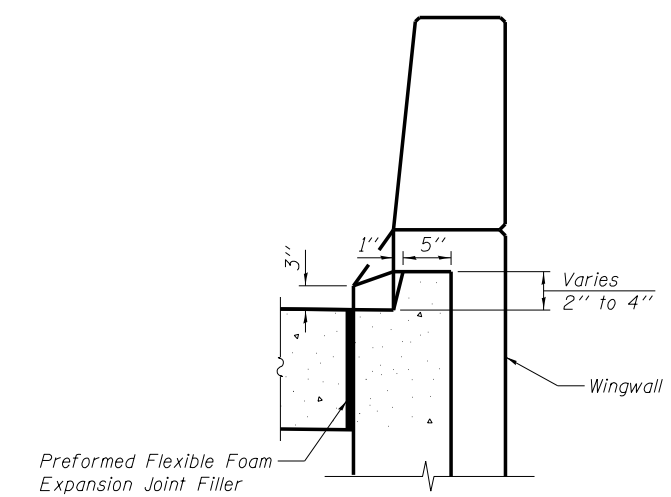

VIEW B-B

MINIMUM BAR LAP (APPROACH)
 #4 bar = 2'-7"
 #5 bar = 3'-3"

- * Tilt #9 b106(E) bars as required to maintain clearance.
- ** Preformed Flexible Foam Expansion Joint Filler according to Article 1051.09 of the Std. Specifications; full depth of slab, full length of parapet. Typ. each parapet. Cost included with "Concrete Superstructure".

benesch
 engineers · scientists · planners
 Alfred Benesch & Company
 205 North Michigan Avenue, Suite 2400
 Chicago, Illinois 60601
 312-565-0450 Job No. 10093

FILE NAME =	USER NAME = jsurber	DESIGNED - JOB	REVISED -
0162455.60J16.018.appslabdet-1.dgn		CHECKED - GJK	REVISED -
		DRAWN - MAK	REVISED -
		CHECKED - JOB	REVISED -

**STATE OF ILLINOIS
 DEPARTMENT OF TRANSPORTATION**

**BRIDGE NORTH APPROACH SLAB DETAILS (1 OF 2)
 STRUCTURE NO. 016-2455**

F.A.P. RTE.	SECTION	COUNTY	TOTAL SHEETS	SHEET NO.
372	2013-038B-R	COOK	821	344
CONTRACT NO. 60J16			ILLINOIS FED. AID PROJECT	

SHEET NO. SC18 OF SC35 SHEETS

X:\1000005\100093\Eng_Docs_Phase_1\11\SN_016_2455_1st_Ave_cover_AT&SF_PRR_Final\0162455-60J16.018.appslabdet-1.dgn 2:11:11 PM 7/11/2014