

REFLECTED ELEVATION
(Looking South)

ELEVATION - UNIT A
(Looking Southwest)

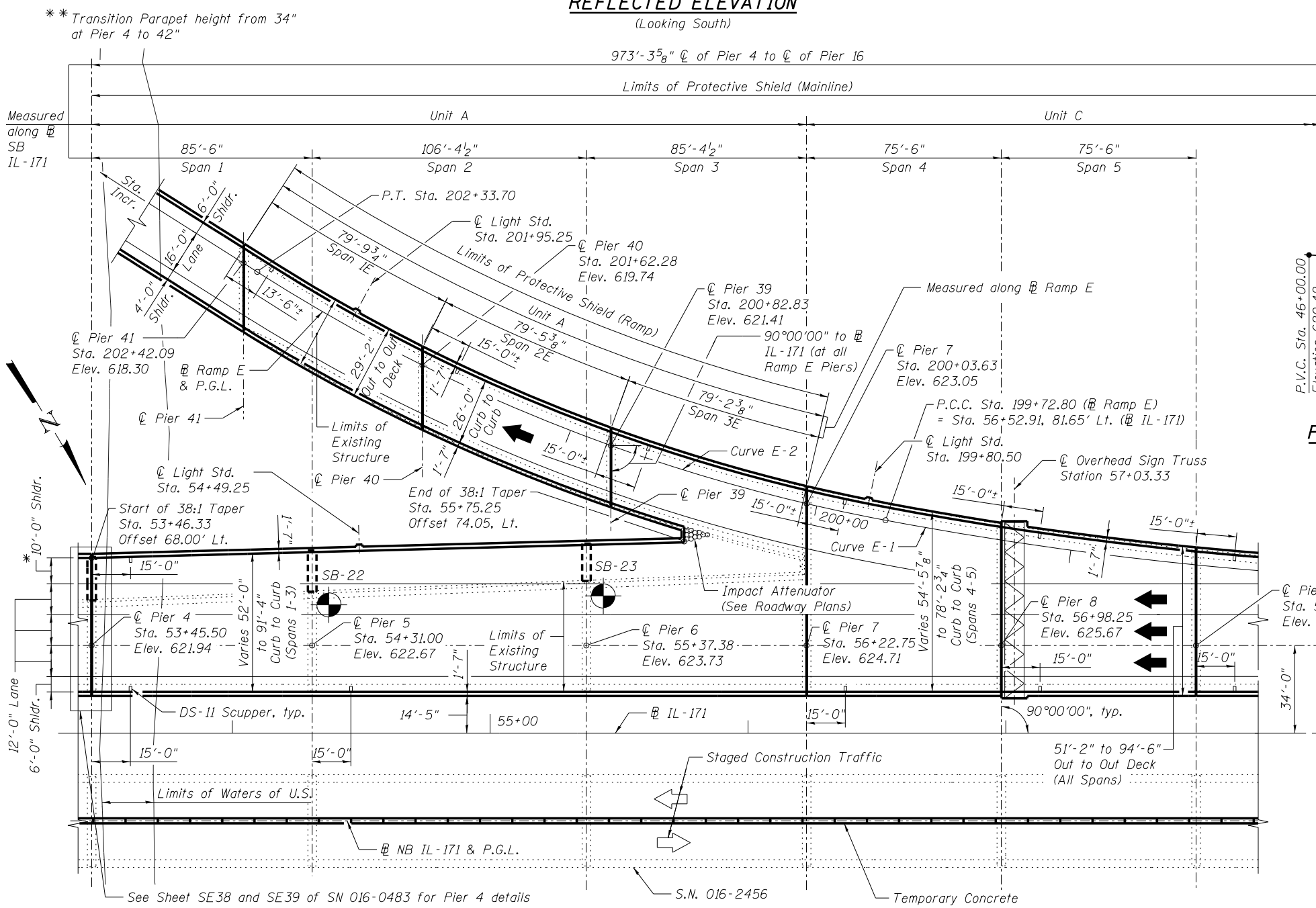

PLAN

CURVE DATA - @ RAMP E

Curve E-1	Curve E-2
P.I. Sta. = 198+45.45	P.I. Sta. = 201+04.82
$\Delta = 10^{\circ}38'33''$ (RT)	$\Delta = 21^{\circ}37'58''$ (RT)
D = 4^{\circ}09'59''	D = 8^{\circ}17'30''
R = 1,375.22'	R = 691.00'
T = 128.09'	T = 132.02'
L = 255.44'	L = 260.90'
E = 5.95'	E = 12.50'
P.C. Sta. = 197+17.36	P.C.C. Sta. = 199+72.80
P.C.C. Sta. = 199+72.80	P.T. Sta. = 202+33.70

S.E. DATA - RAMP E

Normal Crown = Sta. 197+06.62

2.0% to 3.56% S.E. = Sta. 197+06.62 to Sta. 198+21.67

3.56% to 3.95% S.E. = Sta. 198+21.67 to Sta. 198+50.00

3.95% to 4.55% S.E. = Sta. 198+50.00 to Sta. 198+75.00

4.55% to 5.15% S.E. = Sta. 198+75.00 to Sta. 199+00.00

5.15% to 6.2% S.E. = Sta. 199+00.00 to Sta. 199+50.00

6.2% S.E. = Sta. 199+50.00 to Sta. 201+70.00

6.2% S.E. to 2.3% S.E. = Sta. 201+70.00 to 203+00.00

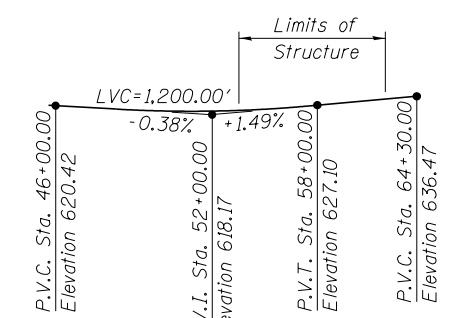

PROFILE GRADE SB IL-171
(Along SB IL-171)

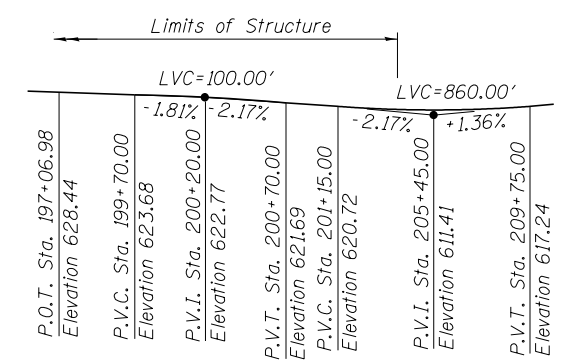

PROFILE GRADE RAMP E
(Along Ramp E)

NOTE:
All elevations in the proposed plans are based on NAVD88 Datum. Elevations in the existing plans are based on the NGVD29 Datum. NGVD29 Elev. 584.50 = NAVD88 Elev. 584.22.

GENERAL PLAN AND ELEVATION
UNIT A & C
SB IL-171 OVER DES PLAINES RIVER VALLEY
FAP 372 - SECTION 2013-038B-R
COOK COUNTY
STATION 58+29.83
STRUCTURE NO. 016-2457

benesch
engineers · scientists · planners

Alfred Benesch & Company
205 North Michigan Avenue, Suite 2400
Chicago, Illinois 60601
312-565-0450 Job No. 10093

FILE NAME = 0162457.60J16.002.gpe.dgn	USER NAME = ksnider	DESIGNED - DTS	REVISIONS -
		CHECKED - AAY	REVISIONS -
		DRAWN - RMG	REVISIONS -
		CHECKED - KJN	REVISIONS -
			REVISIONS -

STATE OF ILLINOIS
DEPARTMENT OF TRANSPORTATION

SHEET NO. S02 OF S083 SHEETS

F.A.P. RTE.	SECTION	COUNTY	TOTAL SHEETS	SHEET NO.
372	2013-038B-R	COOK	821	377
CONTRACT NO. 60J16				

ILLINOIS FED. AID PROJECT