

**PIER 9**  
Looking East

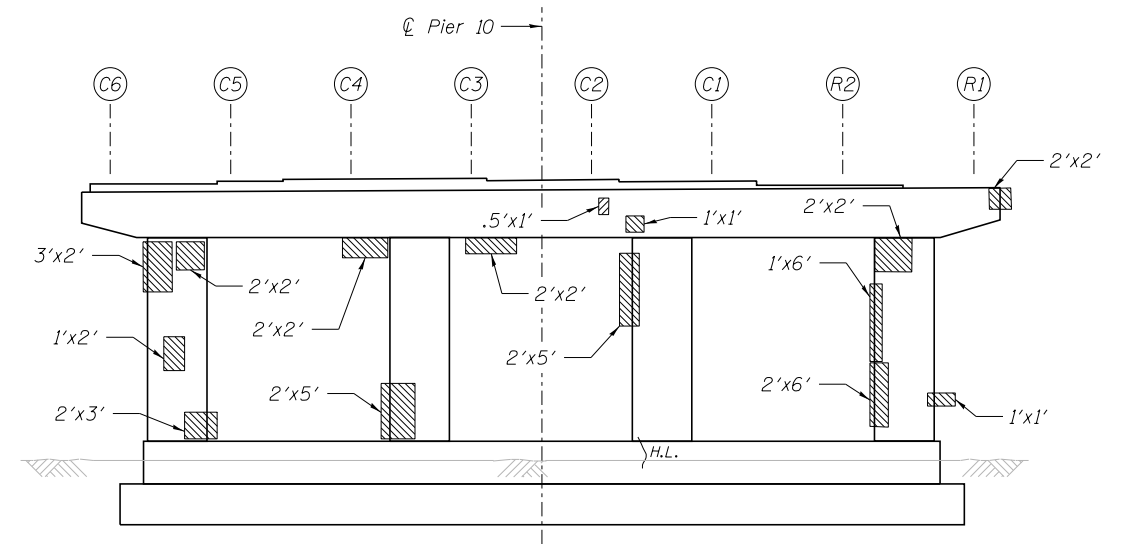

**PIER 10**  
Looking East

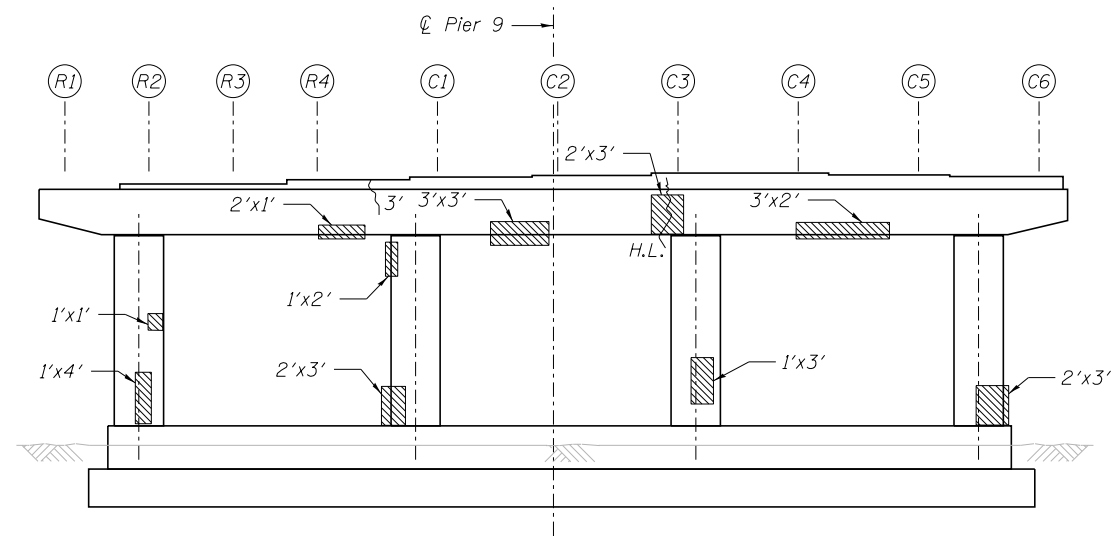

**PIER 9**  
Looking West

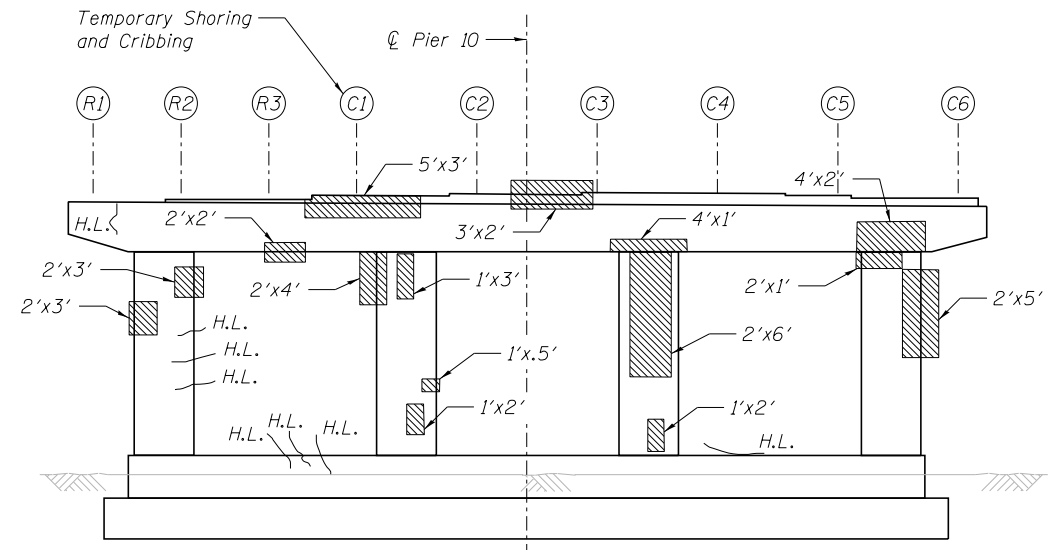

**PIER 10**  
Looking West

**UNFACTORED BEAM REACTIONS (KIPS)**

LOCATION	DEAD LOAD
Girder C1 - Span 6	8.0

Repairs shall be completed when the deck is removed  
Dead Load represents steel weight only

**BILL OF MATERIAL**

ITEM	UNIT	TOTAL
Structural Repair of Concrete (Depth Equal to or Less Than 5 Inches)	Sq. Ft.	250
Epoxy Crack Injection	Foot	15
Temporary Shoring and Cribbing	Each	1

**LEGEND**

- Structural Repair of Concrete (Depth Equal to or Less Than 5 Inches)
- H.L. { Hairline Crack (not to be repaired)
- { Epoxy Crack Injection

**NOTE:**

Actual quantities of repairs shall be approved by the Engineer.

**benesch**  
engineers · scientists · planners

Alfred Benesch & Company  
205 North Michigan Avenue, Suite 2400  
Chicago, Illinois 60601  
312-565-0450 Job No. 10093

FILE NAME = 0162457.60J16.073.pierrepair9-10.dgn	USER NAME = ksnider	DESIGNED - FSM	REVISIONS -
		CHECKED - RMM	REVISIONS -
		DRAWN - FSM	REVISIONS -
		CHECKED - RMM	REVISIONS -
			REVISIONS -

**STATE OF ILLINOIS**  
**DEPARTMENT OF TRANSPORTATION**

**PIERS 9 AND 10 CONCRETE REPAIR DETAILS**  
**STRUCTURE NO. 016-2457**

SHEET NO. SD73 OF SD83 SHEETS

F.A.P. RTE. 372	SECTION 2013-038B-R	COUNTY COOK	TOTAL SHEETS 821	SHEET NO. 448
CONTRACT NO. 60J16			ILLINOIS FED. AID PROJECT	

Y:\chicago\100005\10093\Eng\_Docs\_Phase\_1\1\SN\_016-2456-2457\_1st\_Ave.over\_Des\_Plaines\_River\_Valley\Final\0162457-60J16-073.pierrepair9-10.dgn 3:52:10 PM 8/6/2014