

NOTES:

1. See sheet SG49 for Sections C-C & D-D and View E-E.
2. a503(E), a504(E) and a505(E) bar spacings measured along \perp Rdwy.
3. The joint opening shall be determined per Article 520.04.
4. All dimensions measured along or perpendicular to \perp of Roadway, unless noted otherwise.

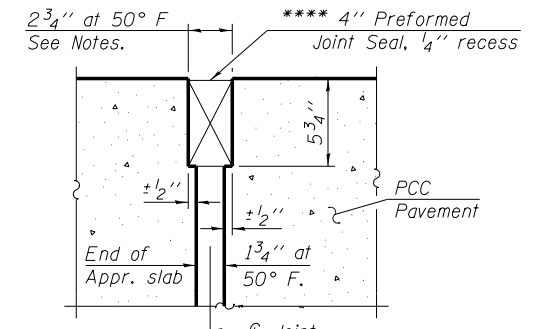

**** Cost included with "Concrete Superstructure".

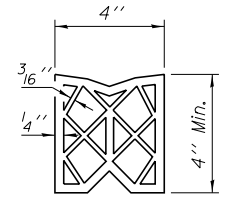

PREFORMED JOINT SEAL

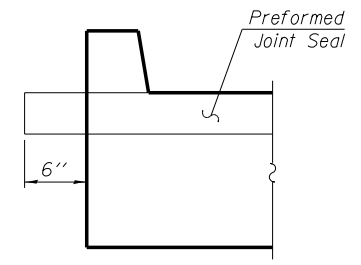

VIEW B-B

MINIMUM BAR LAP (APPROACH)

- #4 bar = 2'-7"
- #5 bar = 3'-3"

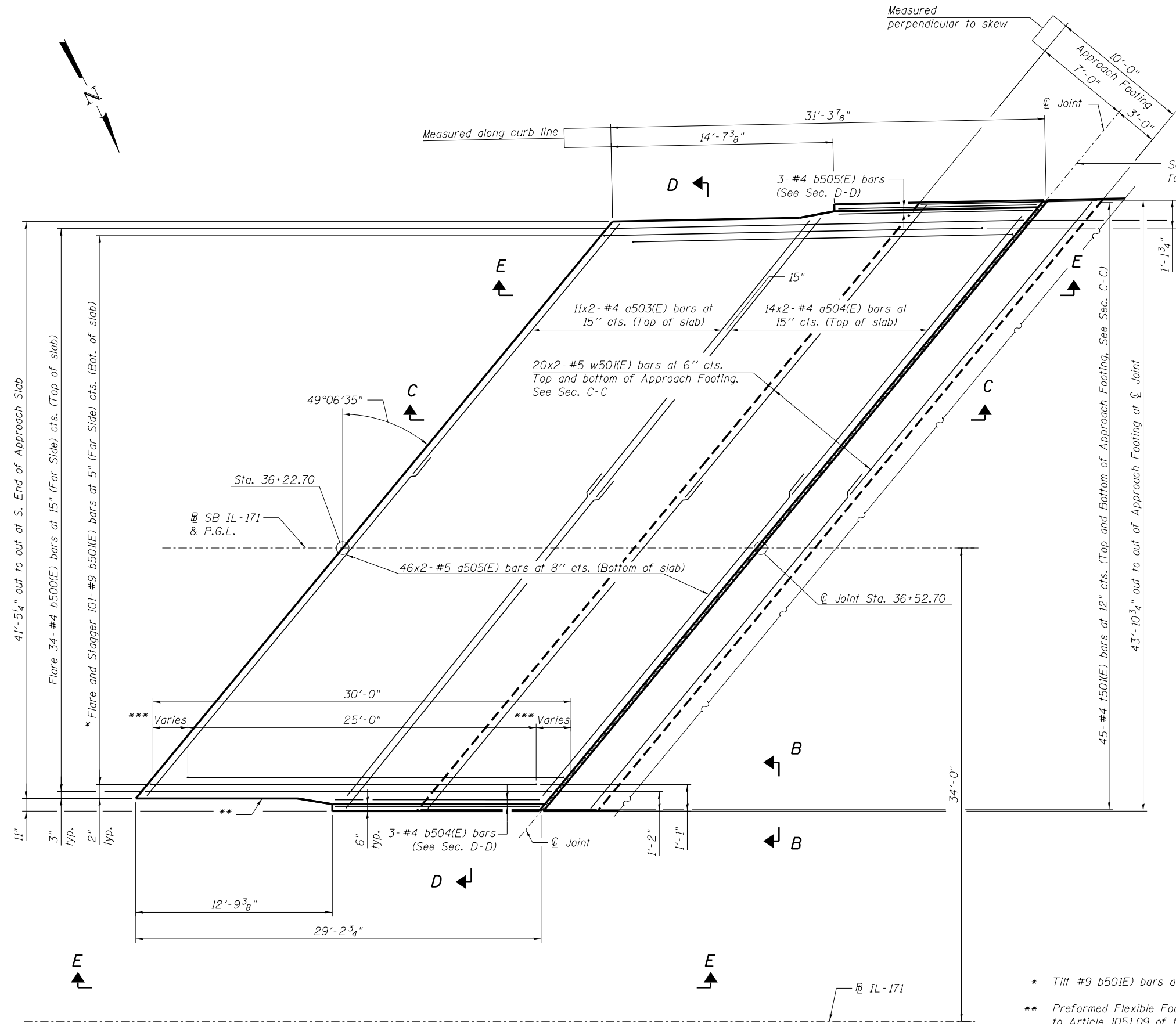

PLAN

- * Tilt #9 b501E bars as required to maintain clearance.
- ** Preformed Flexible Foam Expansion Joint Filler according to Article 1051.09 of the Std. Specifications: Full depth of slab, full length of parapet. Typ. each parapet. Cost included with Concrete Superstructure.
- *** Dimension varies, but stagger shall be symmetric about approach slab.

benesch
engineers · scientists · planners
Alfred Benesch & Company
205 North Michigan Avenue, Suite 2400
Chicago, Illinois 60601
312-565-0450 Job No. 10093

FILE NAME =	USER NAME = jsurber	DESIGNED - JOB	REVISED -
0160486.60J16.048.Npprs1ab.dgn		CHECKED - GJK	REVISED -
		DRAWN - FSM	REVISED -
		CHECKED - GJK/DTS	REVISED -
		PLOT DATE = 8/6/2014	

**STATE OF ILLINOIS
DEPARTMENT OF TRANSPORTATION**

**NORTH BRIDGE APPROACH SLAB PLAN
STRUCTURE NO. 016-0486**

SHEET NO. SG48 OF SG100 SHEETS

F.A.P. RTE.	SECTION	COUNTY	TOTAL SHEETS	SHEET NO.
373	2013-038B-R	COOK	821	638
CONTRACT NO.			60J16	

ILLINOIS FED. AID PROJECT

Y:\chicago\100005\100093\Eng_Docs_Phase_1\1\SN_016_0486_0487_1st_Ave_Over_Canal\Final\0486\0160486_60J16_048.Npprs1ab.dgn 7:30:24 PM 8/6/2014