

**SEC. THRU EXISTING ABUT.**

\* Drill and grout bars according to Article 584 of the Std. Specs. with a minimum embedment of 6". Cost included with Concrete Structures.

**NOTES:**

- Existing reinforcement shall be cleaned and incorporated into the new construction. Any reinforcement bars that are damaged during concrete removal operations shall be repaired or replaced using an approved bar splicer or anchorage system. Cost included with concrete removal.
- Bars indicated thus 6x2-#5 etc. indicates 6 lines of bars with 2 lengths per line.

**MINIMUM BAR LAP**

(Abutment)  
 #5 bar = 3'-3"  
 #6 bar = 3'-10"

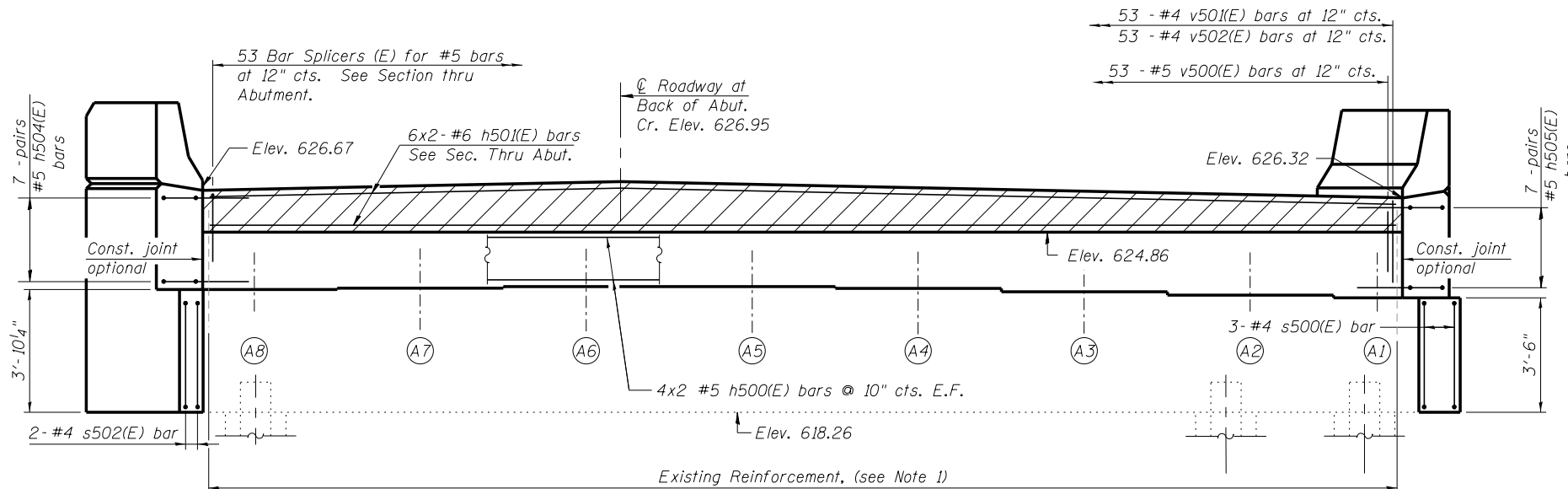

**ELEVATION**

(Looking downstation / East)

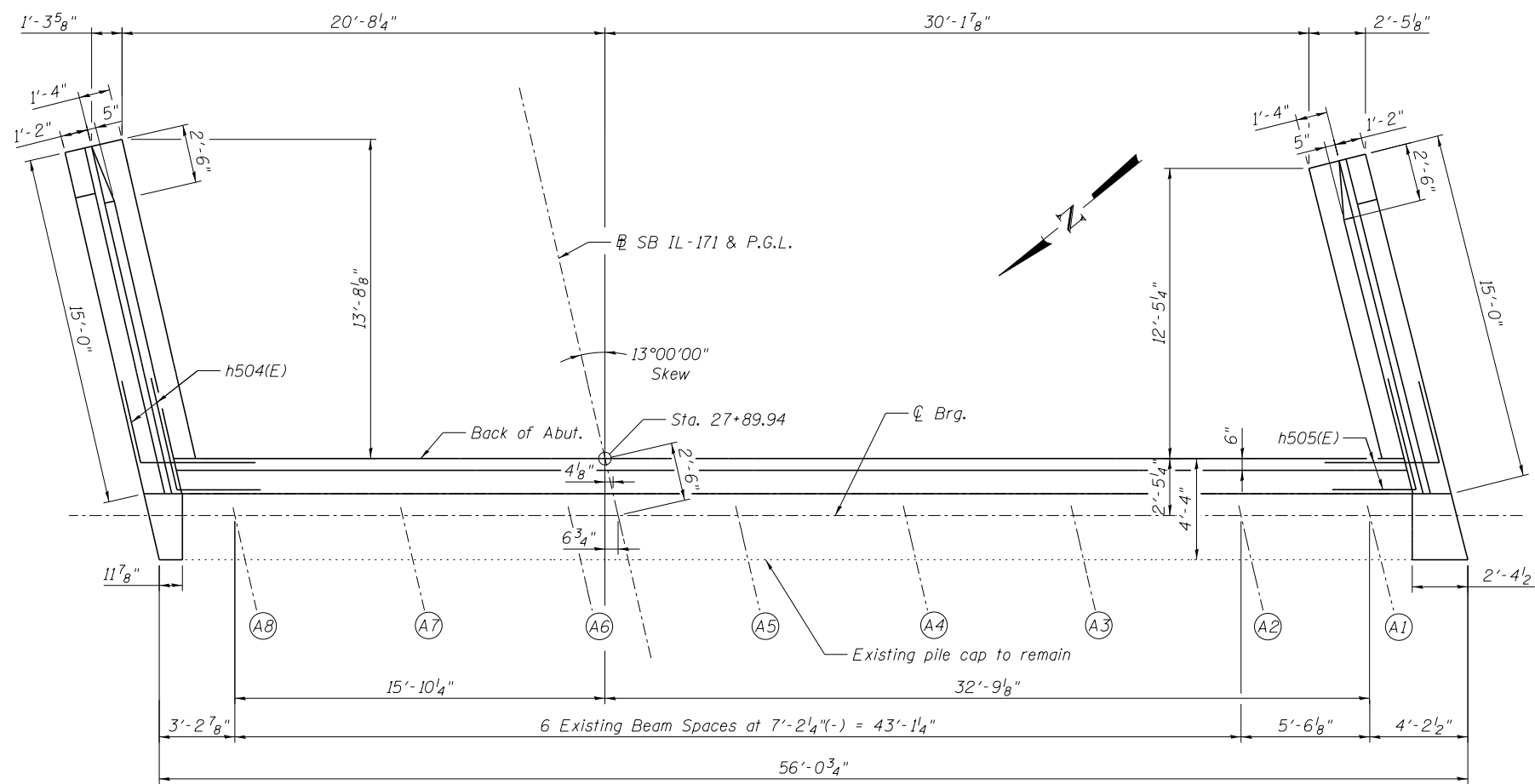

**EAST WINGWALL**

**TOP VIEW**

**WEST WINGWALL**

**benesch**  
 engineers · scientists · planners  
 Alfred Benesch & Company  
 205 North Michigan Avenue, Suite 2400  
 Chicago, Illinois 60601  
 312-565-0450 Job No. 10093

FILE NAME =	USER NAME = jsurber	DESIGNED - AWH	REVISD -
		CHECKED - AJK	REVISD -
		DRAWN - KMS	REVISD -
		CHECKED - AJK	REVISD -

**STATE OF ILLINOIS  
 DEPARTMENT OF TRANSPORTATION**

**SOUTH ABUTMENT WIDENING DETAILS (2 OF 3)  
 STRUCTURE NO. 016-0486**

F.A.P. RTE. 373	SECTION 2013-038B-R	COUNTY COOK	TOTAL SHEETS 821	SHEET NO. 665
CONTRACT NO. 60J16			ILLINOIS FED. AID PROJECT	

SHEET NO. SG75 OF SG100 SHEETS