

SEC. THRU ABUT. WIDENING

*Drill and grout bars according to Article 584 of the Std. Specs. with a minimum embedment of 8". Cost included with Concrete Structures.

NOTES:

1. See Sheet SG81 for abutment elevation backwall details and for wingwall details.

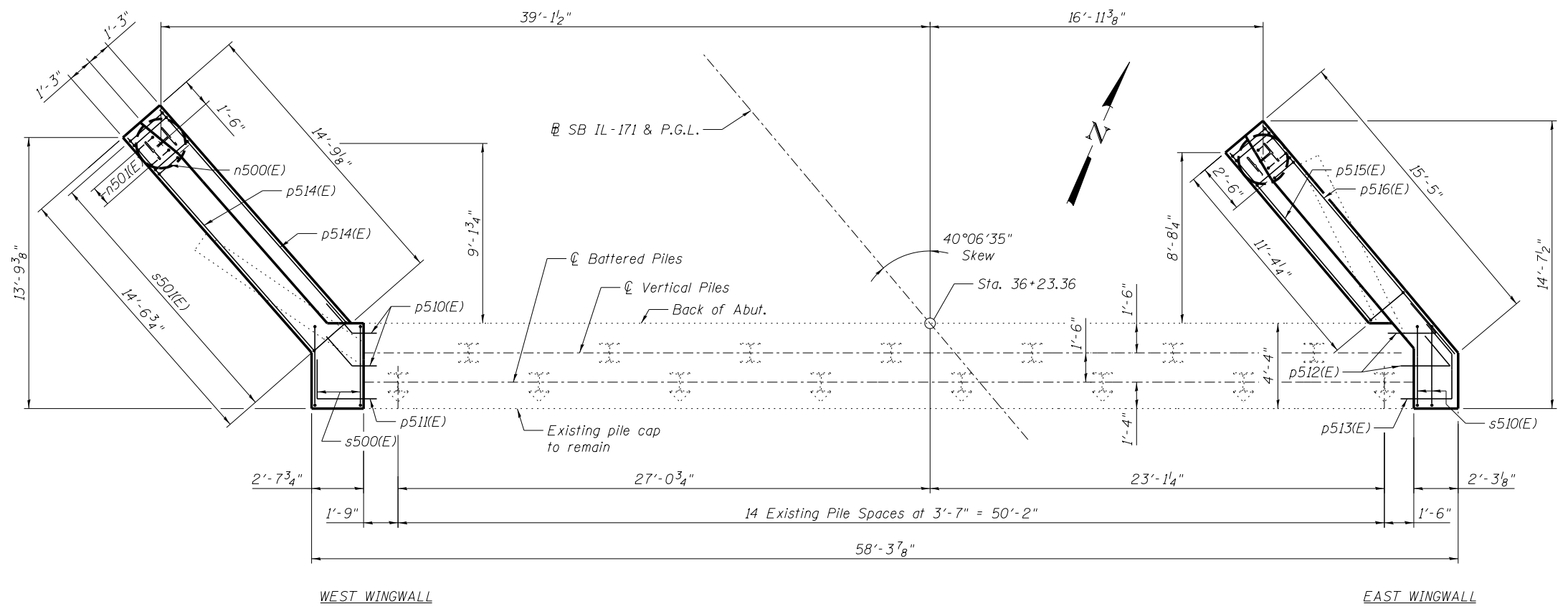

PLAN - PILE CAP

benesch
engineers · scientists · planners
Alfred Benesch & Company
205 North Michigan Avenue, Suite 2400
Chicago, Illinois 60601
312-565-0450 Job No. 10093

FILE NAME =	USER NAME = jsurber	DESIGNED - AWH	REVISED -
		CHECKED - AJK	REVISED -
0160486.60J16.080.N.Abut.Widening.Details-1.dgn	PLT DATE = 8/6/2014	DRAWN - KMS	REVISED -
		CHECKED - AJK	REVISED -

**STATE OF ILLINOIS
DEPARTMENT OF TRANSPORTATION**

**NORTH ABUTMENT WIDENING DETAILS (1 OF 3)
STRUCTURE NO. 016-0486**

F.A.P. RTE.	SECTION	COUNTY	TOTAL SHEETS	SHEET NO.
373	2013-038B-R	COOK	821	670
CONTRACT NO.			60J16	
ILLINOIS FED. AID PROJECT				

SHEET NO. SG80 OF SG100 SHEETS

Y:\chicago\100005\10093\Eng_Docs_Phase_1\1\SN_016_0486_0487_1st_Ave_over_Canal\Final\Final_0486_0160486_60J16_080_N.Abut.Widening_Details-1.dgn 7:31:14 PM 8/6/2014