

FOR DETAILS OF PIERS 7 AND 18 SEE CONTRACT PLANS FOR SECTION 0707-626B

EXISTING GROUND TO BE REMOVED AND REPLACED UNDER SECTION 0707-635A TO SUBGRADE ELEVATION SHOWN

APPROACH PILE DATA		
LOCATION	N.W. ABUT.	S.W. ABUT.
NO. REQUIRED	7	9
EST. LENGTH	28'	28'
CUT OFF ELEV.	621.57	621.24

ELEVATION - E.B. ROADWAY
SCALE: 1" = 20'-0"

TABLE A		
MIN. HORIZ. CLEARANCES (NORMAL TO RAMP 'E')		
DIM. (E.B. RDWY. / W.B. RDWY.)		
A	9'-7 1/2"	9'-10 1/2"
B	10'-11"	12'-4 3/8"

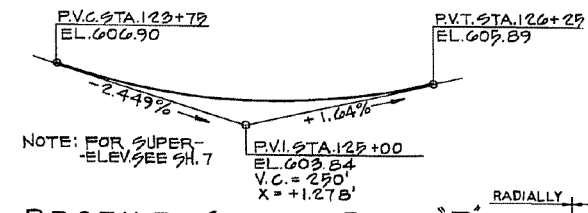
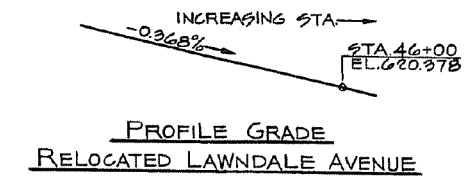

NO.	REV.	DATE	BY	CHKD.	SHEET NO.	SHEETS
13	3	07/07-8/10/88	COOK	29	10	

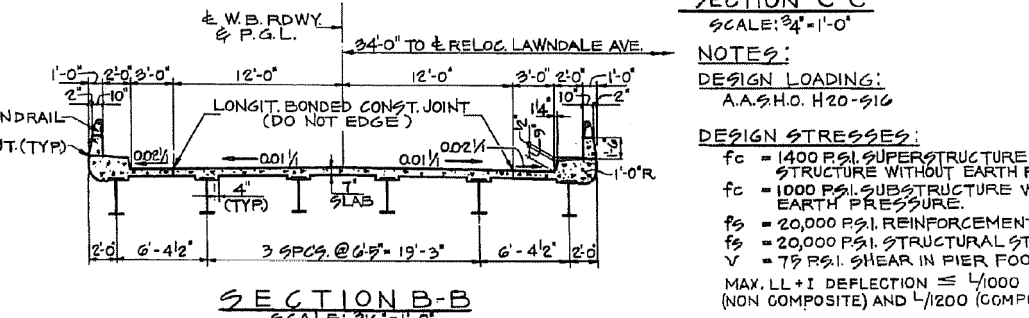
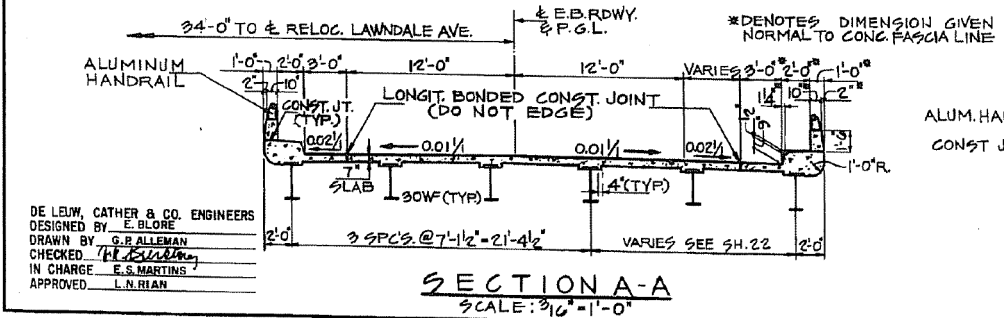
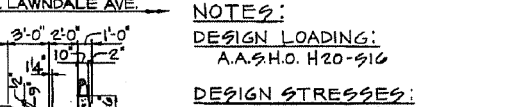
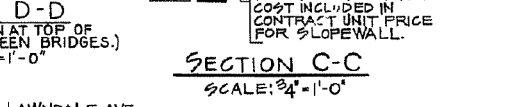
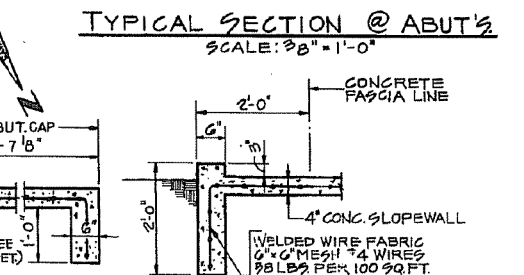
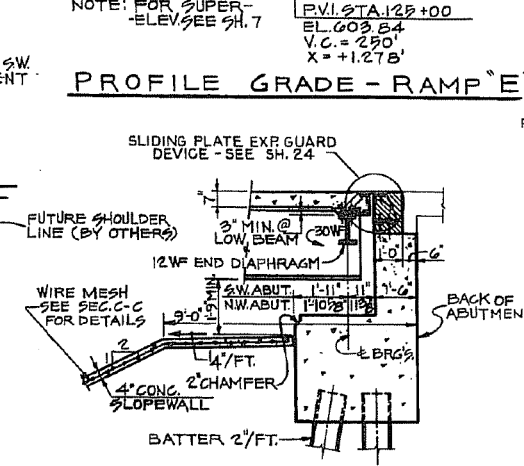
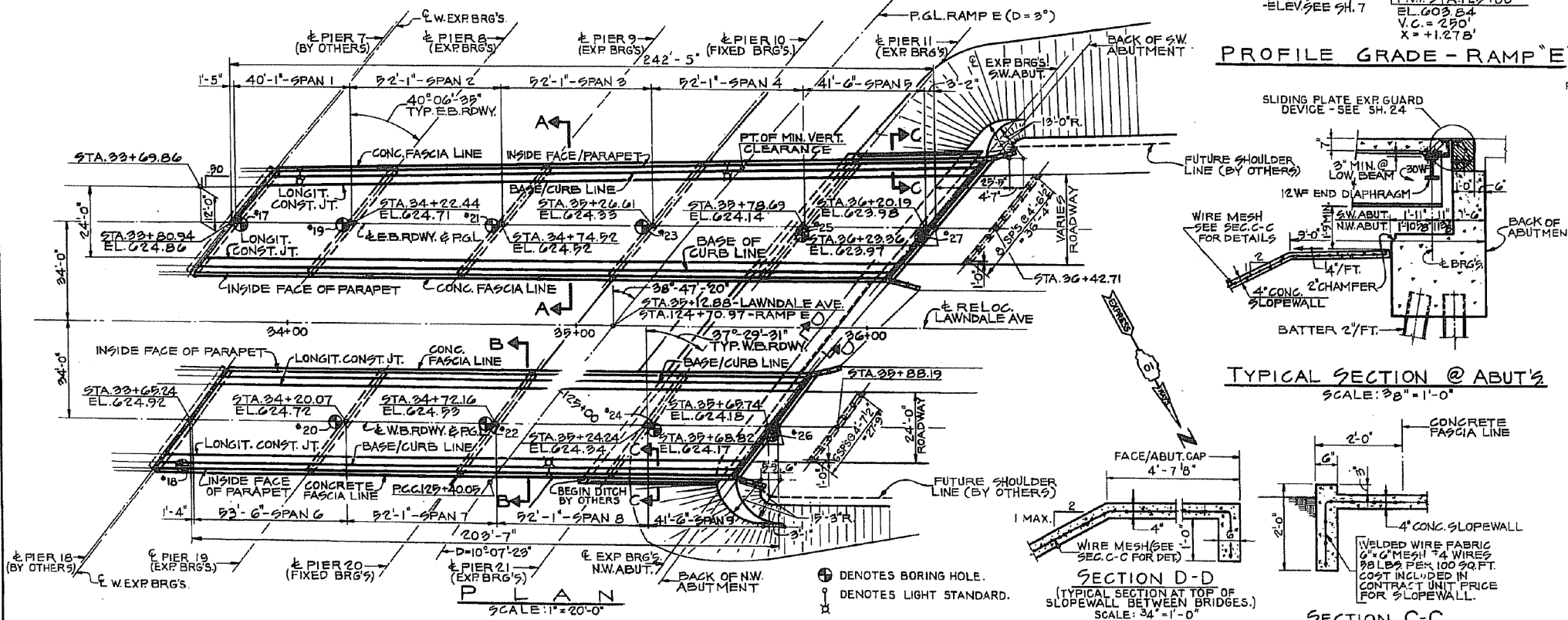
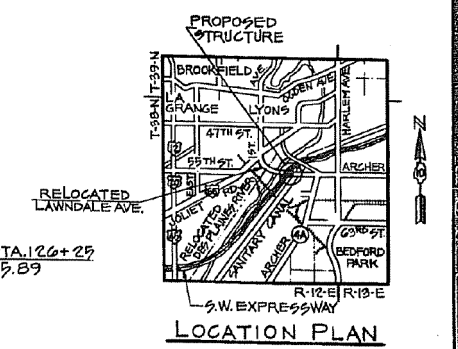

TOTAL BILL OF MATERIAL Section 0707-810 HB				
ITEM	UNIT	SUPER STRUCT.	SUB STRUCT.	TOTAL
CLASS A EXCAVATION FOR STRUCT.	CU YD		69B	69B
CLASS X CONCRETE	CU YD	507.3	473.0	980.3
PROTECTIVE COAT	SQ YD	2,068		2,068
FURNISHING AND ERECTING STRUCTURAL STEEL	POUNDS	369,145		369,145
REINFORCEMENT BARS	POUNDS	123,563	69,149	192,712
FURNISH, CREO. PILES 20.1-38	LIN FT		44B	44B
DRIVING TIMBER PILES	LIN FT		44B	44B
FURNISH STEEL PILES 88P36	LIN FT		3,476	3,476
TEST PILES, (STEEL)	EACH		6	6
DRIVING STEEL PILES	LIN FT		3,476	3,476
SLOPE WALL 4 INCH	SQ YD		621	621
NAME PLATES	EACH		2	2
CONDUIT IN TRENCH, 2" DIA., GALVANIZED STEEL	LIN FT		4C	4C
CONDUIT MOUNTED, 2" DIA., GALVANIZED STEEL	LIN FT	934		934
WIRE MESH 1/2" GALVANIZED STEEL	LIN FT	6		6
CONDUIT IN CONCRETE 1/2" DIA. GALVANIZED STEEL	LIN FT		23	23
TRENCH AND BACKFILL	LIN FT		20	20
HANDRAIL	LIN FT	888		888
EMBANKMENT	CU. YDS.		112	112

DESIGN LOADING: A.A.S.H.O. H20-310

DESIGN STRESSES:
 fc = 1400 PSI SUPERSTRUCTURE AND SUBSTRUCTURE WITHOUT EARTH PRESSURE.
 fc = 1000 PSI SUBSTRUCTURE WITH EARTH PRESSURE.
 fs = 20,000 PSI REINFORCEMENT BARS.
 fs = 20,000 PSI STRUCTURAL STEEL A-36.
 v = 7.5 PSI SHEAR IN PIER FOOTING.
 MAX. LL+I DEFLECTION ≤ L/1000 (NON COMPOSITE) AND L/1200 (COMPOSITE).

ILLINOIS DIVISION OF HIGHWAYS
 SOUTHWEST EXPRESSWAY
 LAWNDALE AVE. OVER RAMP E
 GENERAL PLAN AND ELEVATION

benesch
engineers · scientists · planners

Alfred Benesch & Company
205 North Michigan Avenue, Suite 2400
Chicago, Illinois 60601
312-565-0450 Job No. 10093

FILE NAME	USER NAME	DESIGNED	CHECKED	PLLOT SCALE	PLLOT DATE
0160486.60J16.X04.genplan.8thru12.dgn	tjenicke	FSM	RMM		6/23/2014

DESIGNED	CHECKED	PLLOT SCALE	PLLOT DATE	REVISIONS
FSM	RMM		6/23/2014	

STATE OF ILLINOIS
DEPARTMENT OF TRANSPORTATION

EXISTING PLANS GENERAL PLAN SPANS 8 THRU 12
STRUCTURE NO. 016-0486
SHEET NO. SGX4 OF SGX48 SHEETS

F.A.P. RTE.	SECTION	COUNTY	TOTAL SHEETS	SHEET NO.
373	2013-038B-R	COOK	821	694

CONTRACT NO. 60J16
ILLINOIS FED. AID PROJECT

FOR INFORMATION ONLY

X:\100005\10093\Eng_Docs_Phase_11\SN_016_0486_0487_1st_Ave.cover.dwg; 6/23/2014 2:52:56 PM