

PROJECT NO.	0707-0168	SOUTHWEST	95	56
STA.	TO STA.			
FED. ROAD DIST. NO. 7 ILLINOIS FED. AID PROJECT				

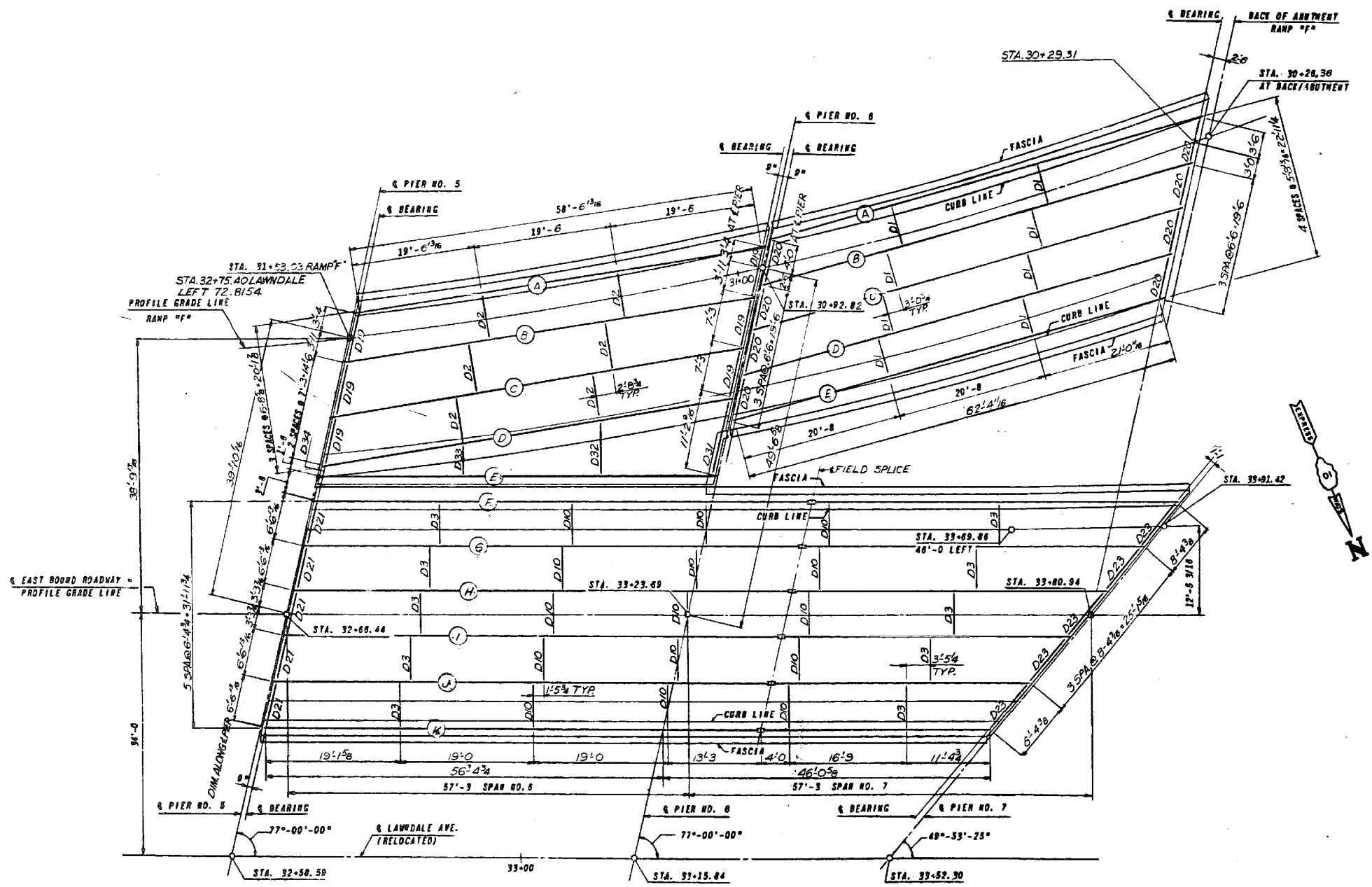

FRAMING PLAN SPANS NO. 6 & NO. 7
EAST BOUND STRUCTURES AND RAMP "F"

ILLINOIS DIVISION OF HIGHWAYS	
SOUTHWEST EXPRESSWAY	
F.A. RT 133	
LAWDALE AVE. STRUCTURE OVER CHICAGO SANITARY AND SHIP CANAL	
SECTION 0707 - 625B	
FRAMING PLAN SPAN 6 & 7 & E.B. & RAMP "F"	
DESIGNED BY	ST.
REVIEWED BY	CWW
SCALE	HORIZ. VERT. DATE 8-5-63
DRAWN BY	J.R.
CHECKED BY	L.D.B.

benesch
engineers · scientists · planners

Alfred Benesch & Company
205 North Michigan Avenue, Suite 2400
Chicago, Illinois 60601
312-565-0450 Job No. 10093

FILE NAME =
0160486.60J16.X20.exist.framing67.dgn

USER NAME = tjenicke
PLOT SCALE =
PLOT DATE = 6/23/2014

DESIGNED -	FSM	REVISED -	
CHECKED -	RMM	REVISED -	
DRAWN -	FSM	REVISED -	
CHECKED -	RMM	REVISED -	

STATE OF ILLINOIS
DEPARTMENT OF TRANSPORTATION

EXISTING PLANS FRAMING PLAN SPANS 6 AND 7
STRUCTURE NO. 016-0486

SHEET NO. SCX20 OF SCX48 SHEETS

FOR INFORMATION ONLY

F.A.P. RTE.	SECTION	COUNTY	TOTAL SHEETS	SHEET NO.
373	2013-038B-R	COOK	821	710
CONTRACT NO.			60J16	
ILLINOIS FED. AID PROJECT				

X:\1000005\10093\Eng_Docs_Phase_1\11\SN_016_0486_0487_1st.Ave.cover_Canal\Final\Final_0486_0160486_60J16.X20.exist.framing67.dgn 6/23/2014 2:57:03 PM