

F.A. R.T.E.	SECTION	EXPRESSWAYS	TOTAL SHEETS	SHEET NO.
133	0707-626B	SOUTHWEST	99	68
STA.	TO STA.			
PRJ. NAME	NO. 7	PLAN	PRJ. NO. PROJECT	

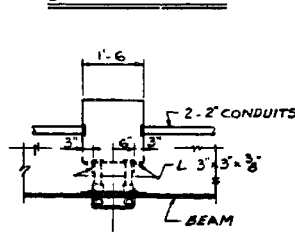
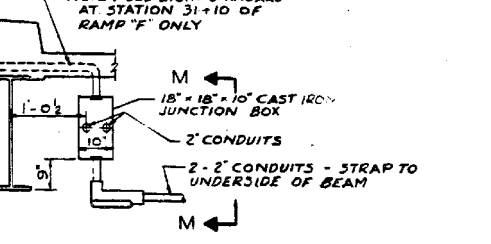
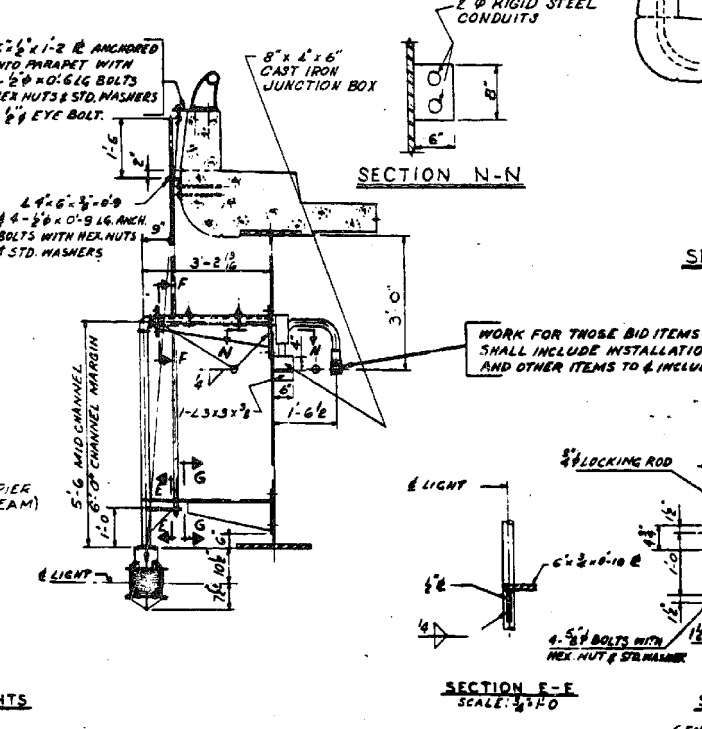
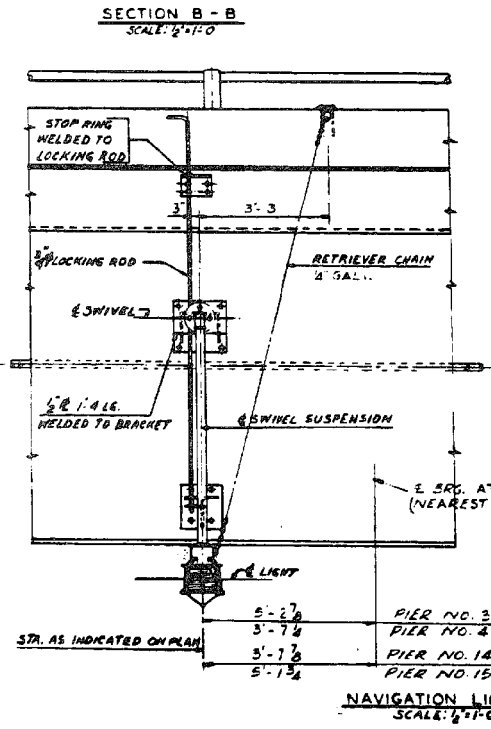
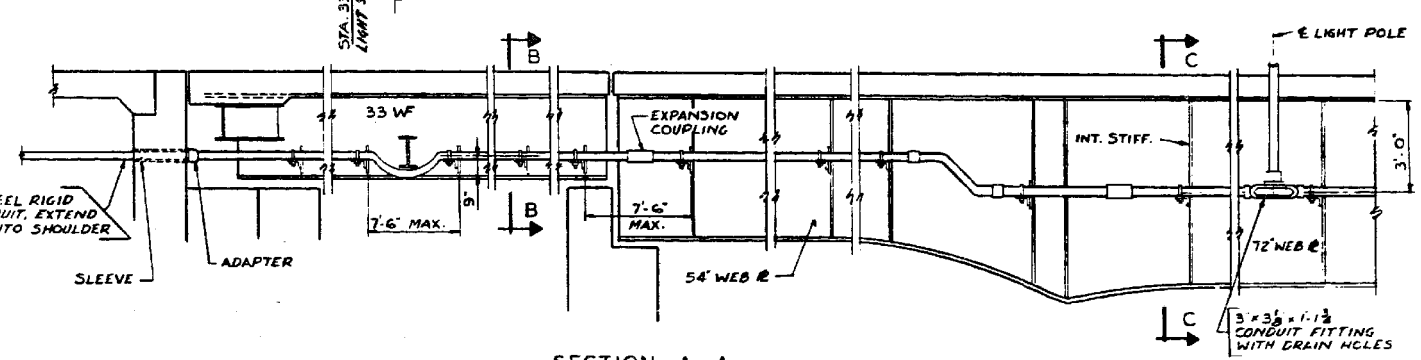
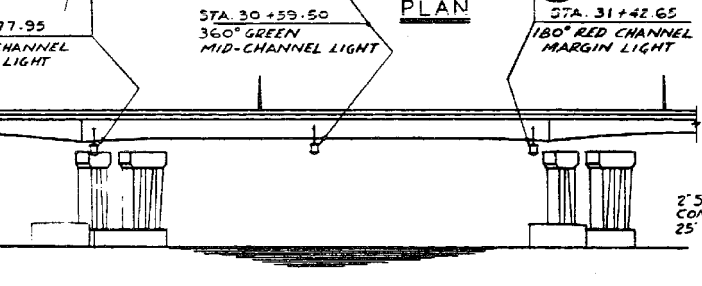
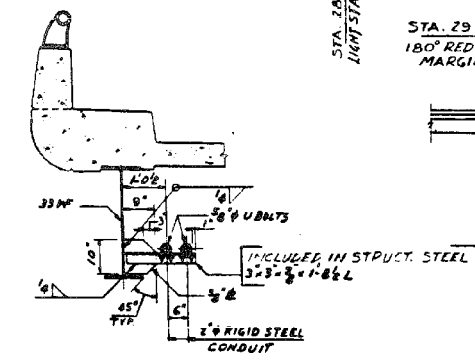
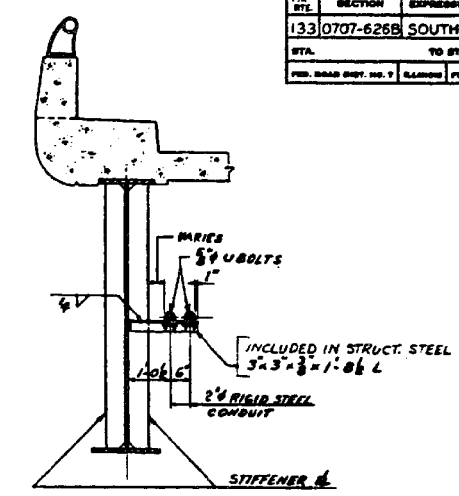
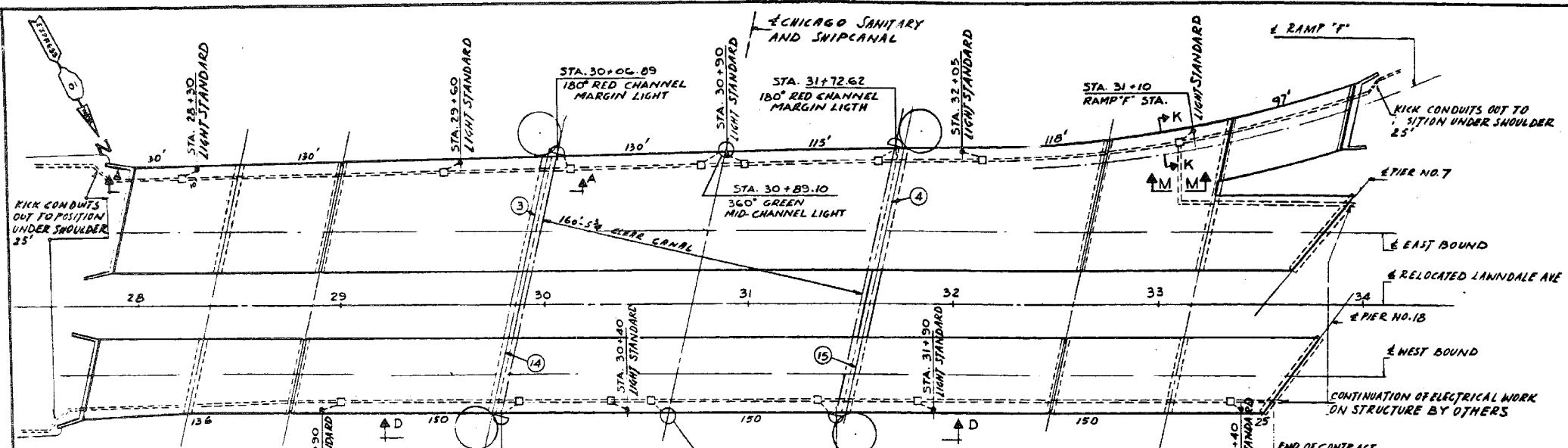

BILL OF MATERIAL		
ITEM	UNIT	QUANTITY
CONDUIT IN TRENCH 2" DIA. GALV. STEEL	LIN. FT.	50
CONDUIT ATTACHED TO STRUCTURE 1 1/2" GALV. STEEL	LIN. FT.	30
CONDUIT ATTACHED TO STRUCTURE 2" GALV. STEEL	LIN. FT.	2750
CONDUIT IN CONCRETE 1 1/2" GALV. STEEL	LIN. FT.	45
TRENCH & BACKFILL	LIN. FT.	75
NAVIGATIONAL LIGHT 360 GREEN MID-CHANNEL	EACH	2
NAVIGATIONAL LIGHT 180 REC CHANNEL MARGIN	EACH	4
POLE FOUNDATION, SPECIAL	EACH	3
CONDUIT IN CONCRETE 2" DIA. GALV. STEEL	LIN. FT.	12
JUNCTION BOX 18x18x10" CAST IRON	EACH	1

NOTE:
 - POLE FOUNDATION SPECIAL INCLUDES THE COMPLETE INSTALLATION OF 4-1 1/2" X 2'-6" LONG ANCHOR BOLTS AT EACH LIGHT POLE.
 - SEE LIGHT STANDARD BASE DETAILS ON SHEET "PARAPET AND HANDRAIL DETAILS"
 - PRICE PER UNIT FOOT OF CONDUIT SHALL INCLUDE ALL COUPLINGS, ELBOWS, FITTINGS ETC. NECESSARY TO COMPLETE INSTALLATION.

ILLINOIS DIVISION OF HIGHWAYS	
SOUTHWEST EXPRESSWAY	
F.A. RT. 133	
LAWDALE AVE STRUCTURE OVER CHICAGO SANITARY AND SHIP CANAL SECTION 07C7-626B	
ELECTRICAL DETAILS	
DESIGNED	ST.
CHECKED	ST.
SCALE: HORIZ. VERT. DATE: 6-6-83	
DRAWN BY J.S. CHECKED BY L.D.B.	

benesch
 engineers · scientists · planners
 Alfred Benesch & Company
 205 North Michigan Avenue, Suite 2400
 Chicago, Illinois 60601
 312-565-0450 Job No. 10093

FILE NAME =	USER NAME =	DESIGNED -	REVISIONS
0160486.60J16.X29.exist.elecdet.dgn	tjenicke	FSM	
		CHECKED -	REVISIONS
		RMM	
		DRAWN -	REVISIONS
		FSM	
		CHECKED -	REVISIONS
		RMM	
		REVISIONS	

STATE OF ILLINOIS
 DEPARTMENT OF TRANSPORTATION

EXISTING PLANS ELECTRICAL DETAILS
 STRUCTURE NO. 016-0486

FOR INFORMATION ONLY

F.A.P. R.T.E.	SECTION	COUNTY	TOTAL SHEETS	SHEET NO.
373	2013-038B-R	COOK	821	719
			CONTRACT NO. 60J16	
ILLINOIS FED. AID PROJECT				

SHEET NO. SGX29 OF SGX48 SHEETS

X:\100005\10093\Eng_Docs_Phase_1\11\SN_016_0486_0487_1st_Ave_cover_Canal\Final\Final_0486\0160486_60J16.X29.exist.elecdet.dgn