

Notes:  
See sheet SH18 for Sections C-C & D-D and View E-E.  
a602(E) and a603(E) bar spacings measured along  $\phi$  Rdwy.

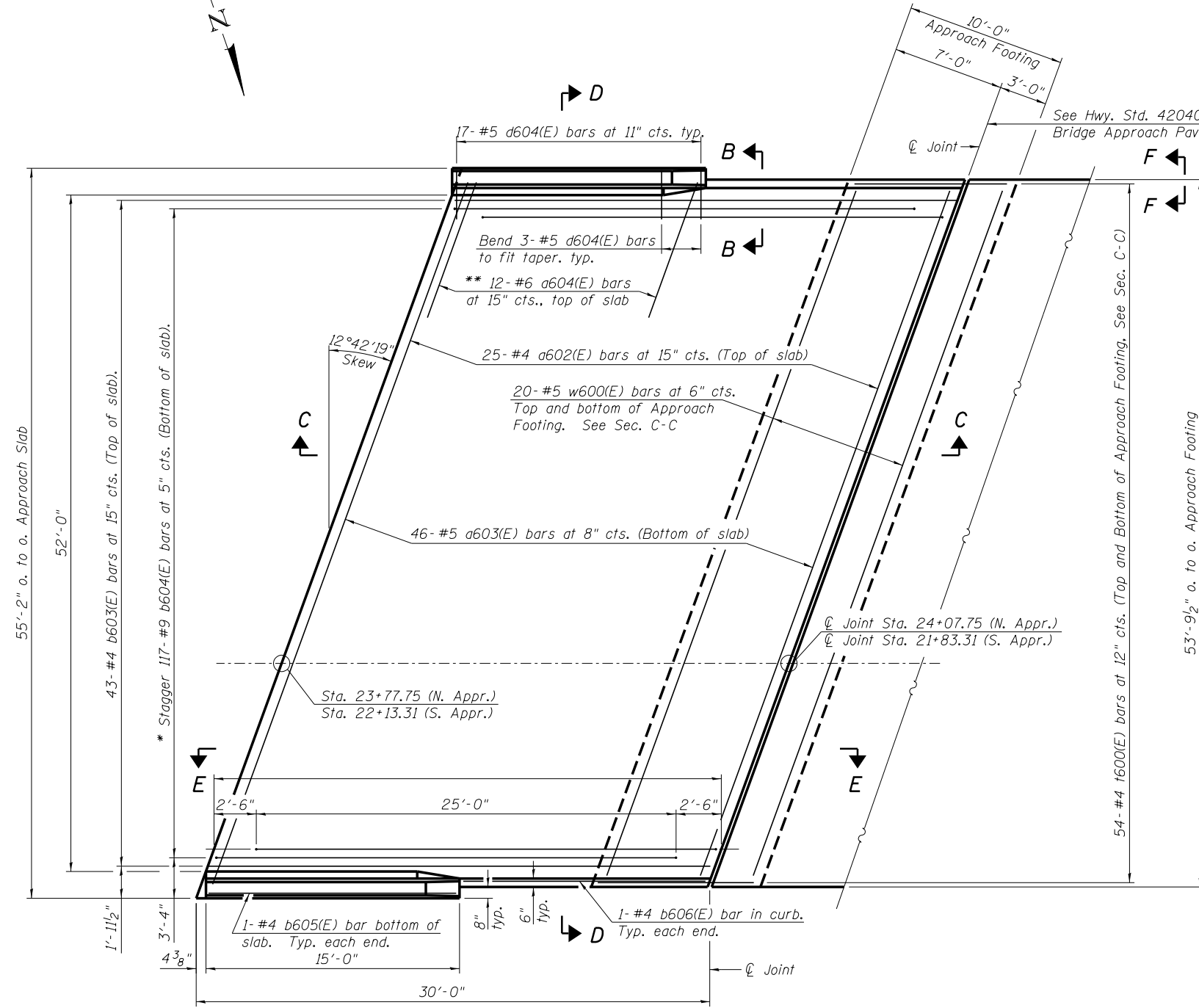

**PLAN**  
(North Approach Slab shown, South Approach Slab similar)

\* Tilt #9 b604(E) bars as required to maintain clearance.  
\*\* Space between a602(E) bars. typ. each parapet.

\*\*\* Cost included with Concrete Superstructure.

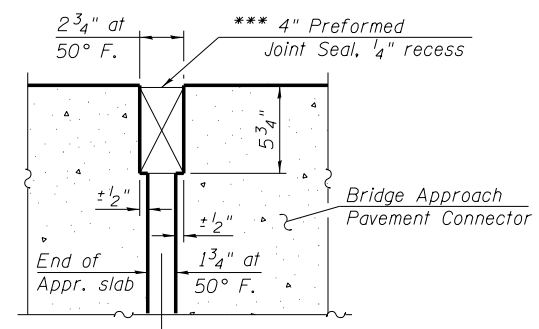

**DETAIL A**

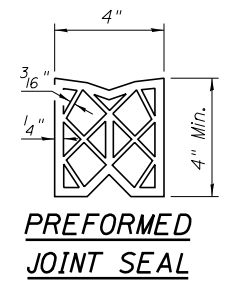

**PREFORMED JOINT SEAL**

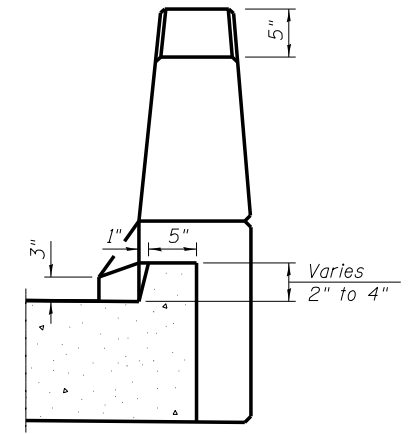

**VIEW B-B**

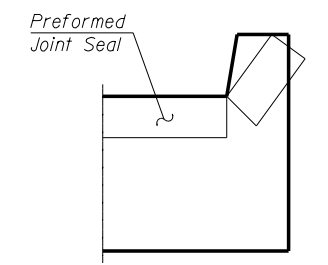

**VIEW F-F**

Angle Preformed Joint Seal at 45° at curbs when req'd for drainage.

|   |                           |                |           |
|---|---------------------------|----------------|-----------|
| FILE NAME =                             | USER NAME = jsurber       | DESIGNED - CMK | REVISED - |
| 016-0488-60J16-017-Bridge Approach Slab | DATE PLOTTED = 12/20/2013 | CHECKED - JAW  | REVISED - |
|   |                           | DRAWN - CMK    | REVISED - |
|   |                           | CHECKED - JAW  | REVISED - |

| F.A.P. RTE.               | SECTION     | COUNTY | TOTAL SHEETS       | SHEET NO. |
|---------------------------|-------------|--------|--------------------|-----------|
| 373                       | 2013-038B-R | COOK   | 821                | 755       |
| ILLINOIS FED. AID PROJECT |             |        | CONTRACT NO. 60J16 |           |