

ORIGINAL SURVEY	SURVEYED	BY	DATE
NOTE BOOK	PLOTTED		
	TEMPLATE		
	AREAS		
	CHECKED		
NO.			

FINAL SURVEY	SURVEYED	BY	DATE
NOTE BOOK	PLOTTED		
	TEMPLATE		
	AREAS		
	CHECKED		
NO.			

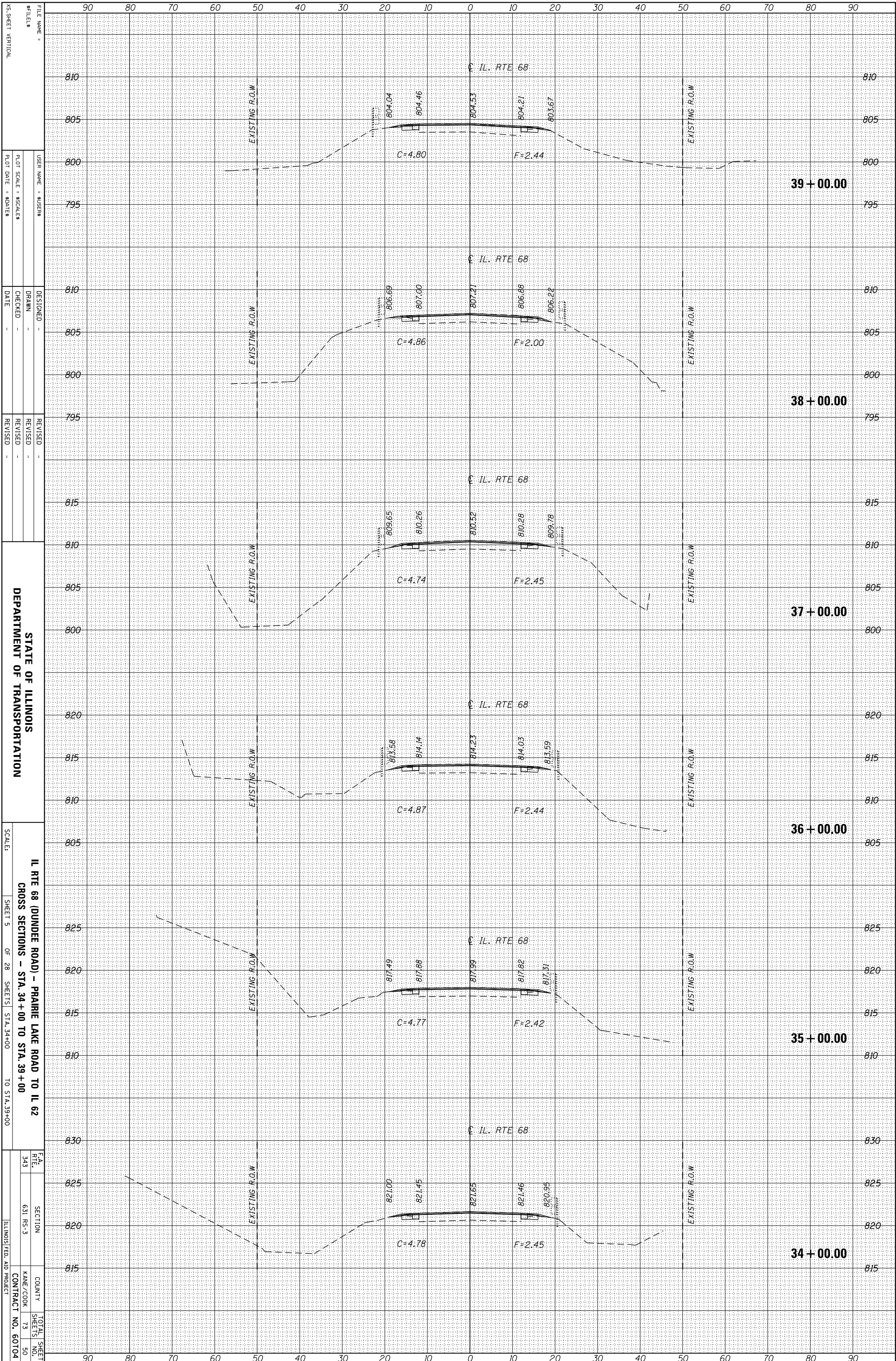

FILE NAME =
 #FILES
 USER NAME = SUSENS
 DESIGNED -
 DRAWN -
 CHECKED -
 DATE -
 REVISED -
 REVISED -
 REVISED -
 REVISED -

STATE OF ILLINOIS
 DEPARTMENT OF TRANSPORTATION

IL RTE 68 (DUNDEE ROAD) - PRAIRIE LAKE ROAD TO IL 62
 CROSS SECTIONS - STA. 34+00 TO STA. 39+00
 SCALE:
 SHEET 5 OF 28 SHEETS STA. 34+00 TO STA. 39+00

F.A. RTE. 343
 SECTION 631 RS-3
 COUNTY KANE/COOK
 CONTRACT NO. 60104
 TOTAL SHEET 73
 SHEETS NO. 50