

ORIGINAL SURVEY	SURVEYED	BY	DATE
NOTE BOOK	PLOTTED		
	TEMPLATE		
	AREAS		
	AREAS CHECKED		

FINAL SURVEY	SURVEYED	BY	DATE
NOTE BOOK	PLOTTED		
	TEMPLATE		
	AREAS		
	AREAS CHECKED		

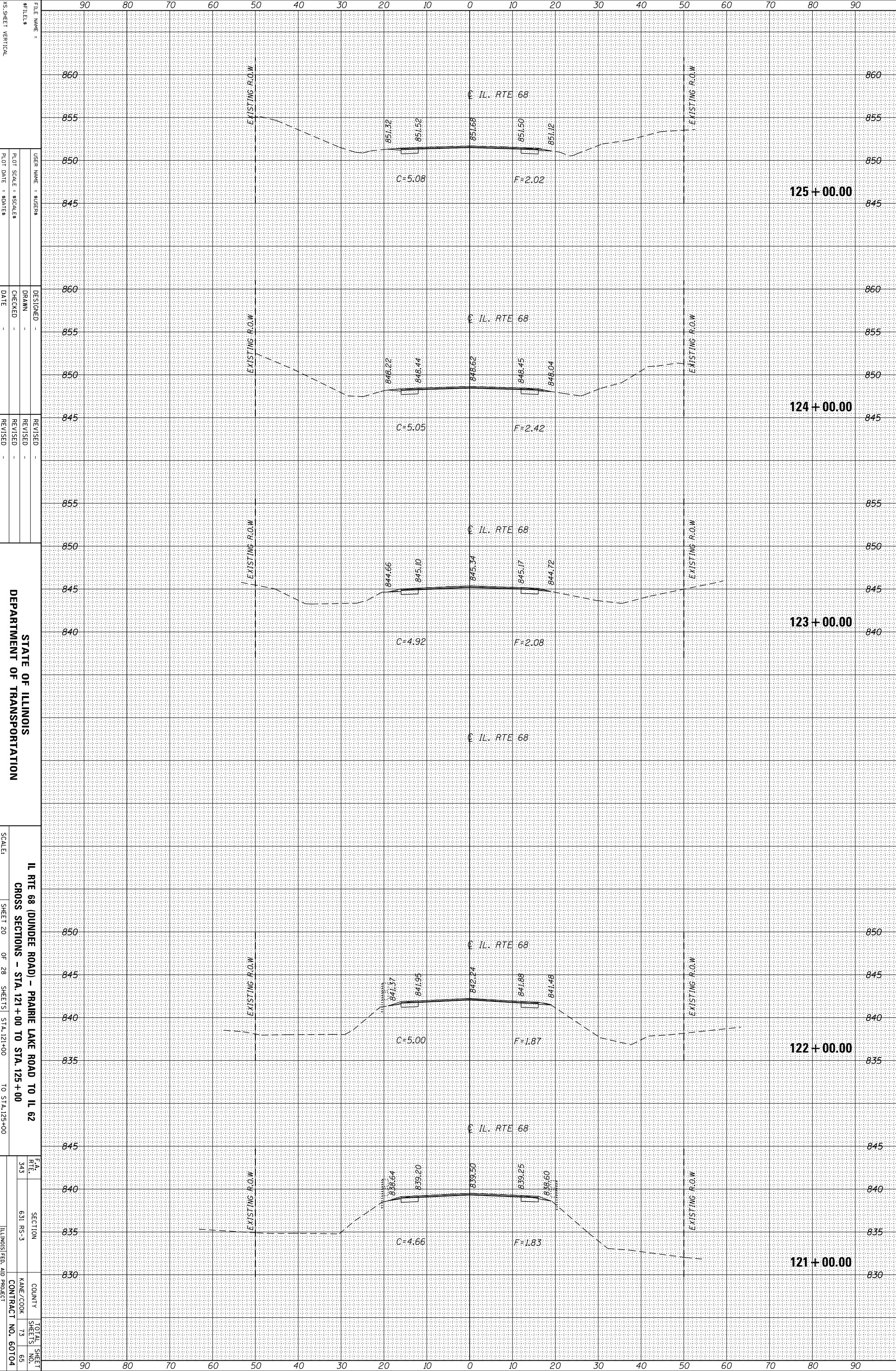

FILE NAME =
 #FILES
 USER NAME = SUSENS
 DRAWN
 CHECKED
 DATE
 DESIGNED
 REVISIONS
 REVISIONS
 REVISIONS
 REVISIONS

STATE OF ILLINOIS
 DEPARTMENT OF TRANSPORTATION

IL RTE 68 (DUNDEE ROAD) - PRAIRIE LAKE ROAD TO IL 62
 CROSS SECTIONS - STA. 121+00 TO STA. 125+00
 SCALE: SHEET 20 OF 28 SHEETS STA. 121+00 TO STA. 125+00

F.A. RTE. SECTION COUNTY TOTAL SHEET NO.
 343 631 RS-3 KANE/COOK 73
 CONTRACT NO. 60104 ILLINOIS FED. AID PROJECT