

ORIGINAL SURVEY	SURVEYED	BY	DATE
NOTE BOOK	PLOTTED		
	TEMPLATE		
	AREAS		
	CHECKED		

FINAL SURVEY	SURVEYED	BY	DATE
NOTE BOOK	PLOTTED		
	TEMPLATE		
	AREAS		
	CHECKED		

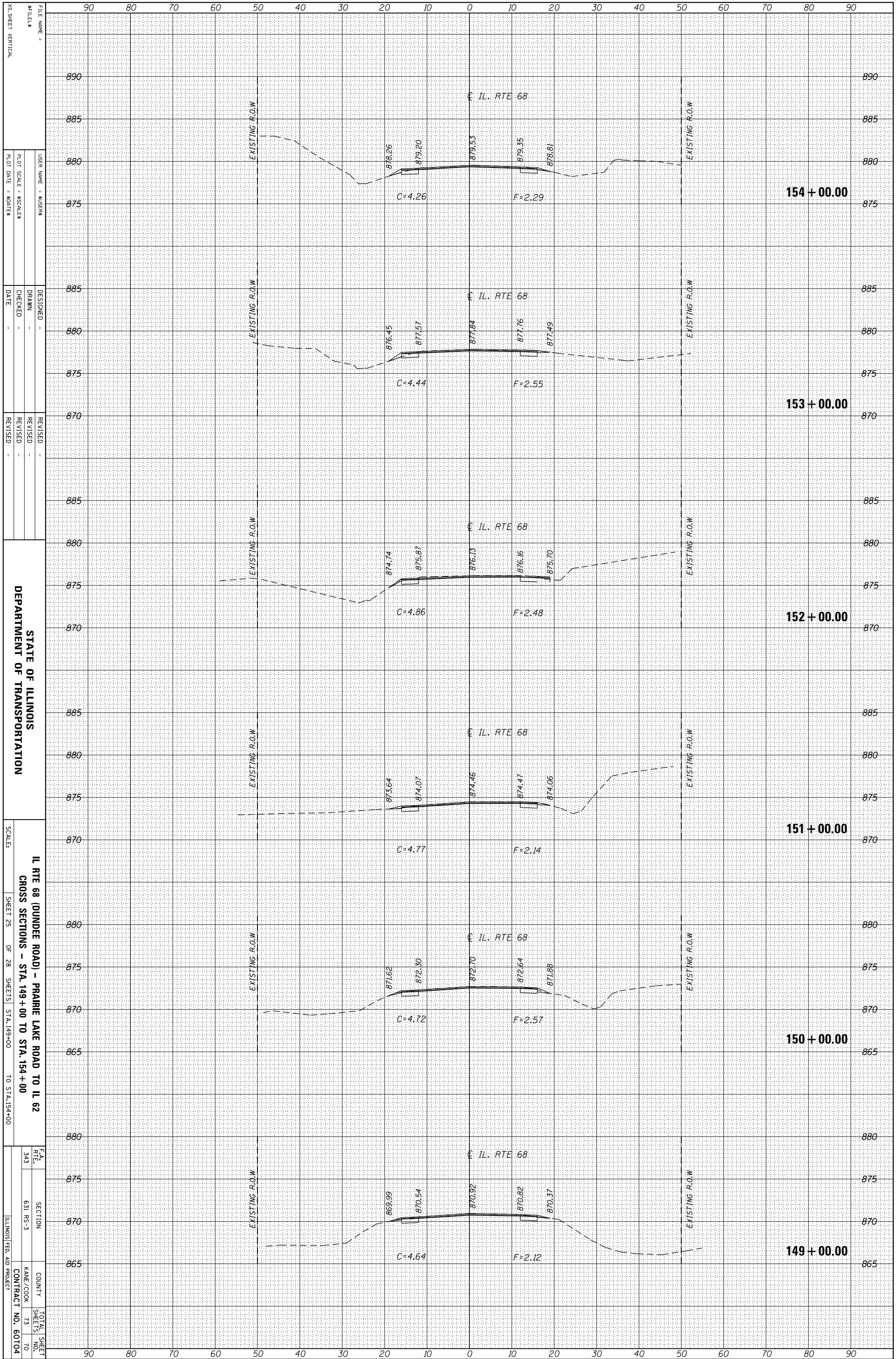

STATE OF ILLINOIS
DEPARTMENT OF TRANSPORTATION

IL RTE 68 (DUNDEE ROAD) - PRAIRIE LAKE ROAD TO IL 62
CROSS SECTIONS - STA. 149+00 TO STA. 154+00

FILE NAME	DESIGNED	REVISOR
USER NAME	DRAWN	REVISION
PLT SCALE	CHECKED	DATE
PLT DATE	REVISOR	

SCALE: SHEET 25 OF 28 SHEETS STA. 149+00 TO STA. 154+00

SECTION 631 RS-3 COUNTY COOK CONTRACT NO. 60704 TOTAL SHEET NO. 73 TO