

- ① PROP. SIDEWALK REMOVAL
- PROP. PCC SIDEWALK RAMP (SEE HWY STD. ON SHEET 2)
- PROP. DETECTABLE WARNINGS

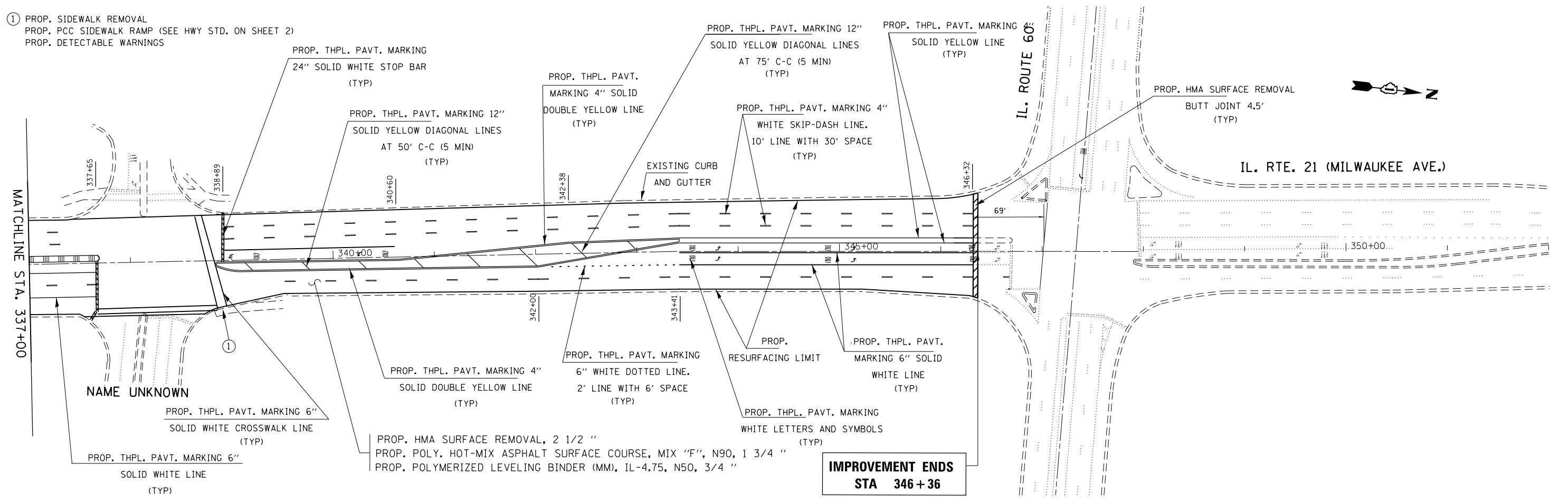

**IMPROVEMENT ENDS**  
**STA 346 + 36**

FILE NAME =	USER NAME = hardnettbr	DESIGNED -	REVISED -
c:\pwwork\pwwork\hardnettbr\d0337694\051012-sh1-plan.dgn		DRAWN -	REVISED -
Default	PLOT SCALE = 100.0000' / in.	CHECKED -	REVISED -
	PLOT DATE = 7/16/2014	DATE -	REVISED -

**STATE OF ILLINOIS**  
**DEPARTMENT OF TRANSPORTATION**

**PROPOSED ROADWAY PLAN**  
**IL. RTE. 21 (MILWAUKEE RD.)**

SCALE: SHEET OF SHEETS STA. TO STA.

F.A.P. RTE.	SECTION	COUNTY	TOTAL SHEETS	SHEET NO.
330	(1&1)RS-3	LAKE	60	20
CONTRACT NO. 60V03				
ILLINOIS FED. AID PROJECT				