

ELEVATION

NOTE:
The MSE wall supplier's internal stability design shall account for the T-type retaining wall's bearing pressure surcharge of 3.0 ksf and horizontal sliding force of 3.2 kips/ft of wall.

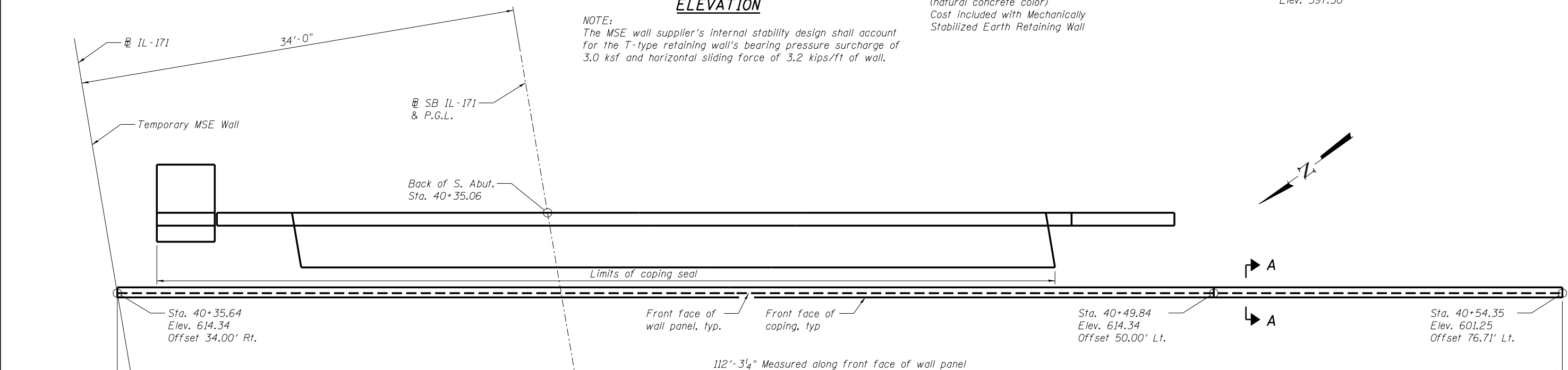

PLAN

NOTES:
1. See sheet SA33 for Section A-A.
2. MSE Wall stations and offsets are measured from the @ SB IL-171 to the front face of precast panels.

BILL OF MATERIAL

ITEM	UNIT	TOTAL
Structure Excavation	Cu. Yd.	1103
Temporary Mechanically Stabilized Earth Retaining Wall	Sq. Ft.	336
Mechanically Stabilized Earth Retaining Wall	Sq. Ft.	1898
Concrete Sealer	Sq. Ft.	2146

benesch
engineers · scientists · planners
Alfred Benesch & Company
205 North Michigan Avenue, Suite 2400
Chicago, Illinois 60601
312-565-0450 Job No. 10093

FILE NAME =	USER NAME = ksnider	DESIGNED - SLV	REVISED -
0161510.60W77.032.S.Abut.MSE.dgn		CHECKED - KWS	REVISED -
	PLOT SCALE =	DRAWN - KMS	REVISED -
	PLOT DATE = 6/23/2014	CHECKED - KWS	REVISED -

STATE OF ILLINOIS
DEPARTMENT OF TRANSPORTATION

SOUTH ABUTMENT MSE WALL
STRUCTURE NO. 016-1510

SHEET NO. SA32 OF SA43 SHEETS

F.A.P. RTE.	SECTION	COUNTY	TOTAL SHEETS	SHEET NO.
373	(0707-608&611)HB-B	COOK	177	97
CONTRACT NO. 60W77			ILLINOIS FED. AID PROJECT	

X:\10000S\10093\Eng-Docs-Phase-11\SN-016-1510-1511-1st-Ave-cover-155\Final\1510-Final\0161510-60W77-032-S.Abut.MSE.dgn 10:57:05 AM 6/23/2014