

**PAVEMENT MARKING LEGEND**

- ① THPL PAVT MK, 4" DOUBLE YELLOW LINE, 11" C-C (TYP.)
- ② THPL PAVT MK, 4" YELLOW LINE (TYP.)
- ③ THPL PAVT MK, 4" SKIP DASH LINE (30' SKIP 10' DASH) (TYP.)
- ④ THPL PAVT MK, 6" WHITE LINE (TYP.)
- ④A THPL PAVT MK, 6" DOTTED LINE (TYP.)
- ⑤ THPL PAVT MK, 6" CROSSWALK (TYP.)
- ⑤A THPL PAVT MK, 12" SCHOOL CROSSWALK (TYP.)
- ⑥ THPL PAVT MK, 12" YELLOW DIAGONAL LINE (TYP.)
- ⑦ THPL PAVT MK, 24" WHITE STOP BAR (TYP.)
- ⑧ THPL PAVT MK, LETTERS & SYMBOLS (TYP.)

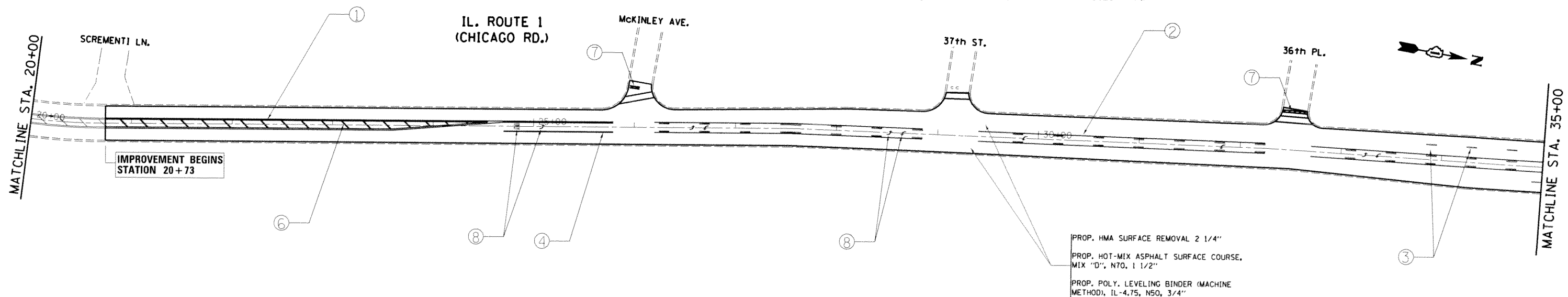

PROP. HMA SURFACE REMOVAL 2 1/4"  
 PROP. HOT-MIX ASPHALT SURFACE COURSE,  
 MIX "D", N70, 1 1/2"  
 PROP. POLY. LEVELING BINDER (MACHINE  
 METHOD), IL-4.75, N50, 3/4"

FILE NAME =	USER NAME = galbanjr	DESIGNED -	REVISED -
ct:\pw_work\pvidot\galbanjr\d0353169\0141	13-sht-plan.dgn	DRAWN -	REVISED -
Default	PLOT SCALE = 100.0000' / in.	CHECKED -	REVISED -
	PLOT DATE = 6/14/2014	DATE -	REVISED -

**STATE OF ILLINOIS  
 DEPARTMENT OF TRANSPORTATION**

**ROADWAY AND PAVEMENT MARKING PLAN  
 IL. ROUTE 1/CHICAGO RD. (JOE ORR RD. TO UNION AVE.)**

SCALE: 1"=50'    SHEET    OF    SHEETS    STA.    TO    STA.

F.A.U. RTE.	SECTION	COUNTY	TOTAL SHEETS	SHEET NO.
2860	(161Y-1&H) RS-4	WILL/COOK	34	7
CONTRACT NO. 60X03				