

GENERAL NOTES

- IT SHALL BE THE CONTRACTOR'S RESPONSIBILITY TO VERIFY ALL DIMENSIONS AND CONDITIONS EXISTING IN THE FIELD PRIOR TO ORDERING MATERIALS AND BEGINNING CONSTRUCTION. THIS SHALL INCLUDE LOCATING THE MAST ARM FOUNDATIONS AND VERIFYING THE MAST ARM LENGTHS.
- THE EXACT LOCATION OF ALL UTILITIES SHALL BE FIELD VERIFIED BY THE CONTRACTOR BEFORE ORDERING ANY MATERIALS AND STARTING ANY WORK. FOR LOCATIONS OF UTILITIES, LOCALLY OWNED EQUIPMENT, LEASED ENFORCEMENT CAMERA SYSTEM FACILITIES AND IDOT UNDERGROUND FACILITIES, CONTACT THE LOCAL COUNTIES, MUNICIPALITIES AND IDOT FOR LOCATES. THE CONTRACTOR SHALL CALL "JULIE" AT (800) 892-0123 OR 811, IN THE CITY OF CHICAGO CONTACT DIGGER AT (312) 744-7000 FOR FIELD LOCATIONS OF BURIED UTILITIES (48 HOURS NOTIFICATION REQUIRED).
- THE CONTRACTOR SHALL CHECK THE PROPOSED TRAFFIC SIGNAL EQUIPMENT LOCATIONS FOR OVERHEAD UTILITY CONFLICTS. THE CONTRACTOR SHALL COORDINATE ANY CONFLICTS WITH THE UTILITY COMPANIES AND THE RESIDENT ENGINEER BEFORE ORDERING MATERIALS.
- THE CONTRACTOR SHALL COORDINATE CONSTRUCTION ACTIVITIES WITH UTILITY COMPANIES, LOCAL GOVERNMENT AGENCIES AND IDOT.

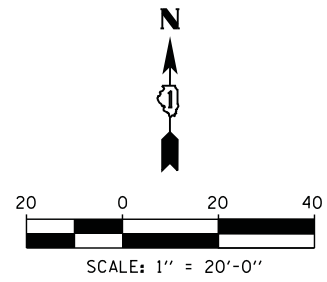

(A) REMOVE EXISTING DEPRESSED B-6.12 CURB & GUTTER AND REPLACE WITH NEW STANDARD B-6.12 CURB AND GUTTER. THIS WORK SHALL BE INCLUDED IN THE COST OF PAY ITEM #44000500, AND #60603800.

(B) REMOVE EXISTING DRIVEWAY AND RESTORE WITH NEW TOPSOIL AND SOD. THIS WORK SHALL BE INCLUDED IN THE COST OF PAY ITEM #21101625, #25200100, AND #44000200.

DRIVEWAY AND CURB & GUTTER REPLACEMENT QUANTITIES ARE APPROXIMATE. REMOVAL AND REPLACEMENT SHALL BE FIELD VERIFIED BY THE CONTRACTOR AND APPROVED BY THE ENGINEER.

W11-7
2 REQUIRED
36"X36"
SIGN PANEL TYPE 1
ⓐ

W16-7P
1 REQUIRED
24"X12"
SIGN PANEL TYPE 1
ⓑ

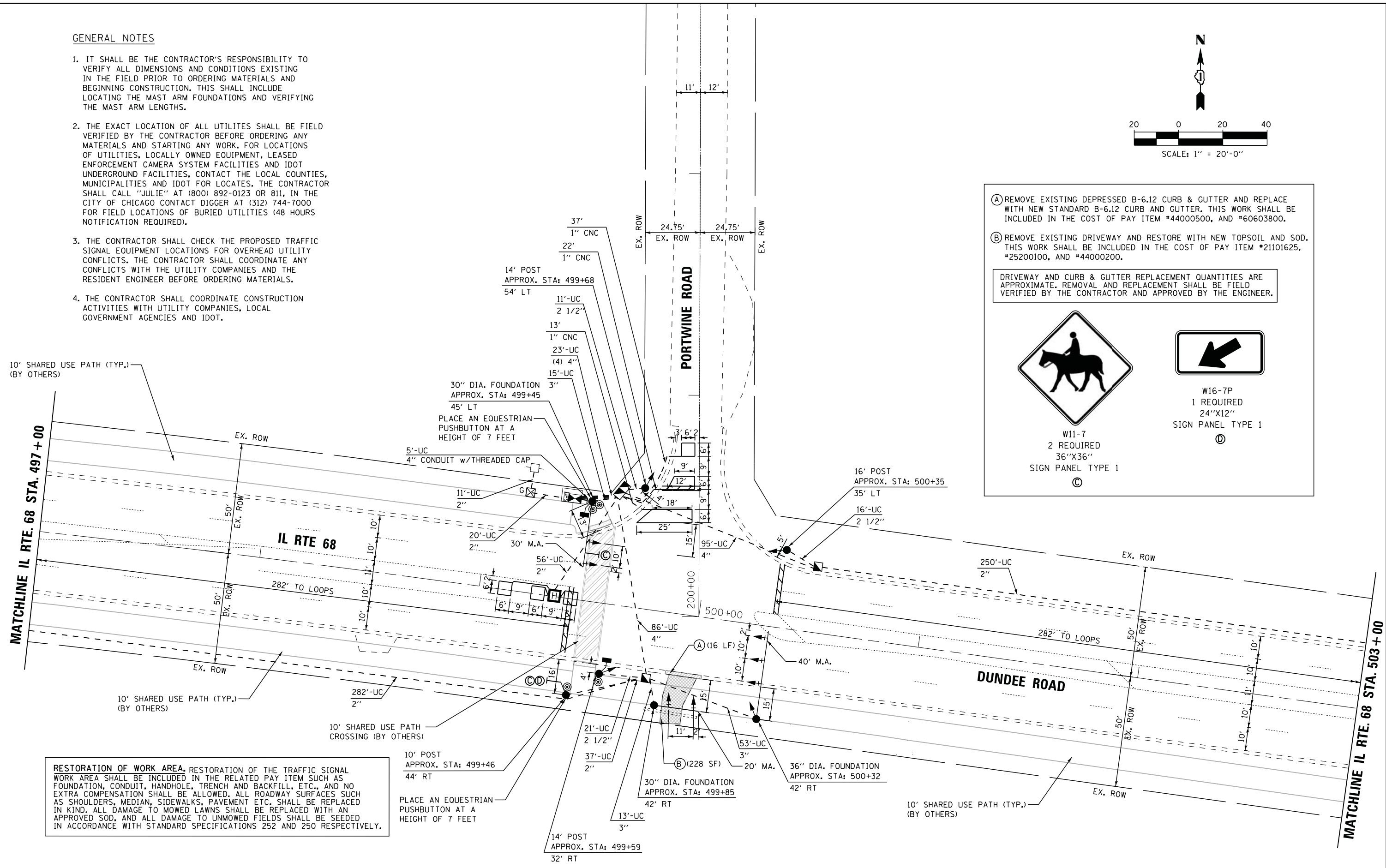

RESTORATION OF WORK AREA. RESTORATION OF THE TRAFFIC SIGNAL WORK AREA SHALL BE INCLUDED IN THE RELATED PAY ITEM SUCH AS FOUNDATION, CONDUIT, HANDHOLE, TRENCH AND BACKFILL, ETC., AND NO EXTRA COMPENSATION SHALL BE ALLOWED. ALL ROADWAY SURFACES SUCH AS SHOULDERS, MEDIAN, SIDEWALKS, PAVEMENT ETC. SHALL BE REPLACED IN KIND. ALL DAMAGE TO MOWED LAWNS SHALL BE REPLACED WITH AN APPROVED SOD, AND ALL DAMAGE TO UNMOWED FIELDS SHALL BE SEEDED IN ACCORDANCE WITH STANDARD SPECIFICATIONS 252 AND 250 RESPECTIVELY.

FILE NAME =	USER NAME = _USERNAME_	DESIGNED - DW	REVISED -	STATE OF ILLINOIS DEPARTMENT OF TRANSPORTATION	TRAFFIC SIGNAL MODERNIZATION PLAN ILLINOIS ROUTE 68 (DUNDEE ROAD) AND PORTWINE ROAD	F.A. RTE.	SECTION	COUNTY	TOTAL SHEETS	SHEET NO.
N:\Projects\3\0881-2039-00 IDOT PTB 148-04\13010 IL68 @ Portwine Rd\Design\CAD\Sheet F1\DRAWN14.TS-IL68-PORTWINE.dgn		CHECKED - KMM	REVISED -			1618TS	COOK	16	13	
PLOT SCALE = 20.0000' / in.		DATE -	REVISED -			CONTRACT NO. 60X14				
PLOT DATE = \$DATE\$			REVISED -			ILLINOIS FED. AID PROJECT				
					SCALE:	SHEET NO. 1 OF 2 SHEETS	STA.	TO STA.		