

81

McLEAN BLVD

82

83

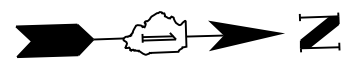

200+00

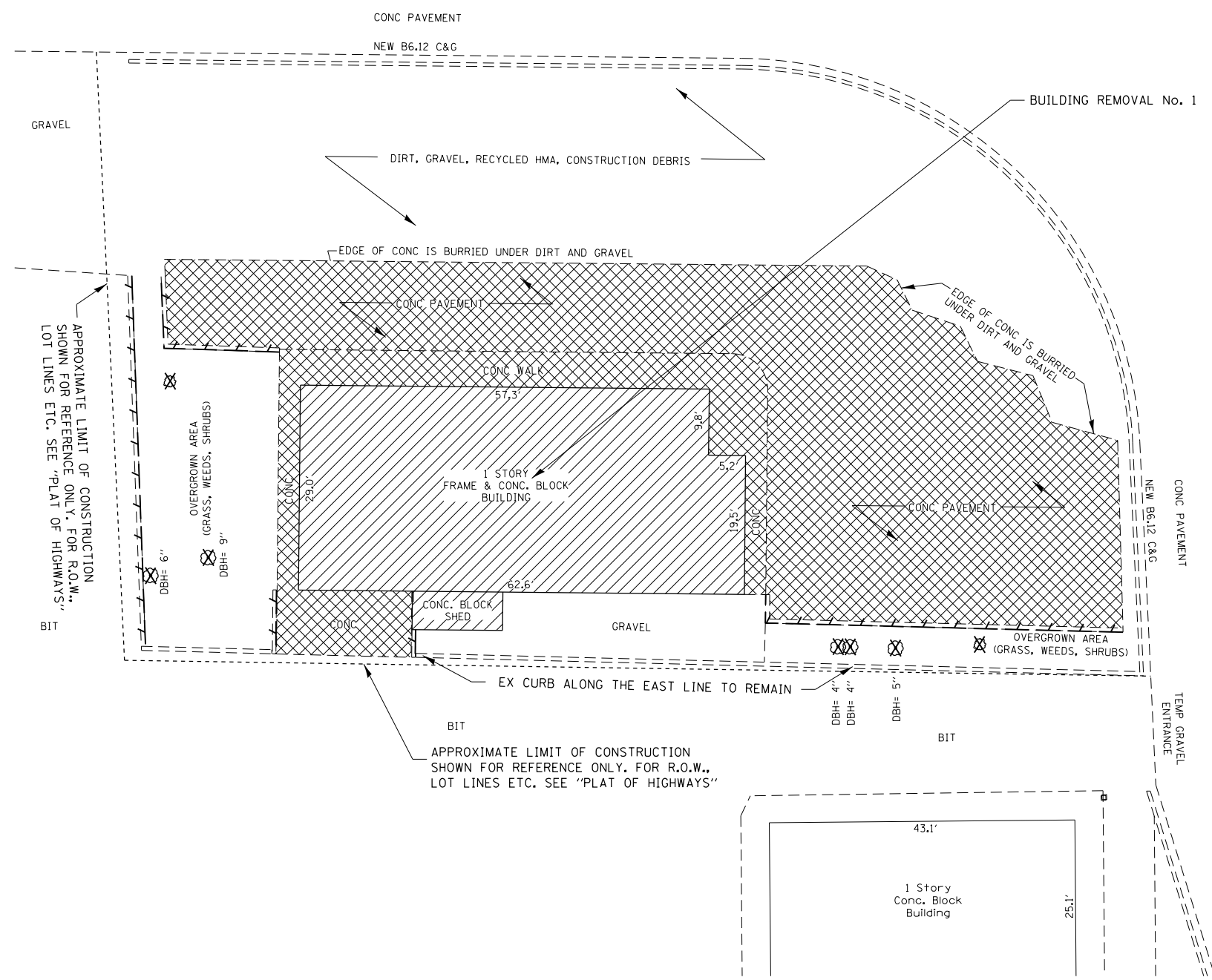

LILLIAN ST



APPROXIMATE LIMIT OF CONSTRUCTION SHOWN FOR REFERENCE ONLY. FOR R.O.W., LOT LINES ETC. SEE "PLAT OF HIGHWAYS"

APPROXIMATE LIMIT OF CONSTRUCTION SHOWN FOR REFERENCE ONLY. FOR R.O.W., LOT LINES ETC. SEE "PLAT OF HIGHWAYS"

**LEGEND**

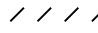
-  BUILDING REMOVAL
-  CONCRETE REMOVAL (PAID AS PAVEMENT REMOVAL)
-  REMOVAL ITEM
-  CURB REMOVAL

FILE NAME =	USER NAME = Velichkovv	DESIGNED -	REVISED -
ei:\pw\work\pilot\velichkovv\d0400762\141814-sht-plan.dgn		DRAWN -	REVISED -
Default	PLOT SCALE = 20.0000' / in.	CHECKED -	REVISED -
	PLOT DATE = 8/6/2014	DATE -	REVISED -

**STATE OF ILLINOIS  
DEPARTMENT OF TRANSPORTATION**

<b>US 20 (LAKE ST) over McLEAN BLVD (McLEAN &amp; LILLIAN ST)</b>			
<b>REMOVAL PLAN</b>			
SCALE:	SHEET	OF SHEETS	STA. TO STA.

F.A.P. RTE.	SECTION	COUNTY	TOTAL SHEETS	SHEET NO.
345	(8R&R)DM	KANE	7	4
CONTRACT NO. 60Y51				
ILLINOIS FED. AID PROJECT				