

STATE OF ILLINOIS
DEPARTMENT OF TRANSPORTATION
DIVISION OF HIGHWAYS

F.A.P. RTE.	SECTION	COUNTY	TOTAL SHEETS	SHEET NO.
335	1105&120)RS-8	McHENRY	21	1

*21-1-20

FOR INDEX OF SHEETS, SEE SHEET NO. 2

IMPROVEMENT IS LOCATED IN THE CITY OF WOODSTOCK AND THE CITY OF CRYSTAL LAKE

TRAFFIC DATA

ADT (2013) = 12,400
POSTED SPEED LIMIT = 35 MPH - 55 MPH

PROPOSED
HIGHWAY PLANS

FAP ROUTE 335: IL ROUTE 176
IL ROUTE 47 TO US ROUTE 14 (VIRGINIA ST.)
SECTION (105&120)RS-8
RESURFACING

McHENRY COUNTY

C-91-431-14

3rd PM

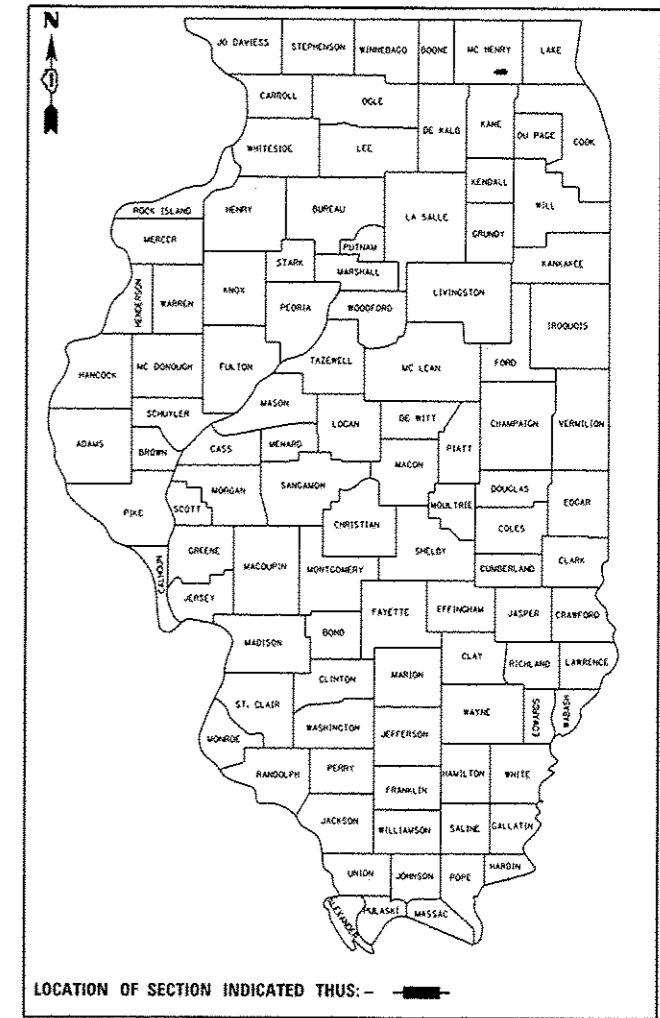

LOCATION OF SECTION INDICATED THUS: -

IMPROVEMENT BEGINS
STA. 507 + 56.00

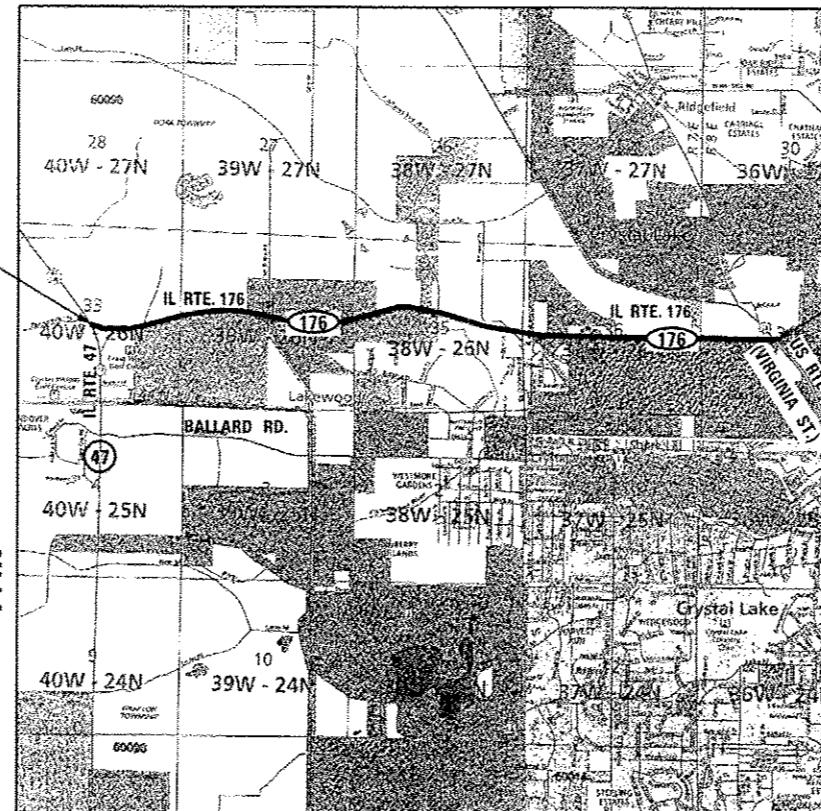

IMPROVEMENT ENDS
STA. 701 + 73.85

OMISSIONS:
STA. 605 + 95 TO STA. 607 + 06
STA. 622 + 43 TO STA. 641 + 90

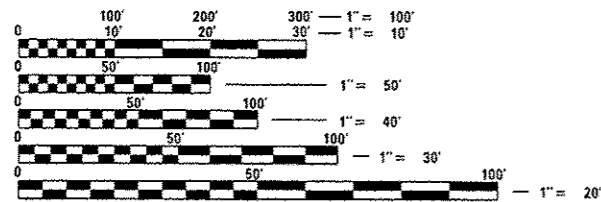

FULL SIZE PLANS HAVE BEEN PREPARED USING STANDARD ENGINEERING SCALES. REDUCED SIZED PLANS WILL NOT CONFORM TO STANDARD SCALES. IN MAKING MEASUREMENTS ON REDUCED PLANS, THE ABOVE SCALES MAY BE USED.

J.U.L.I.E.
JOINT UTILITY LOCATION INFORMATION FOR EXCAVATION
1-800-892-0123
OR 811

PROJECT ENGINEER: MR. ROBERT BORO, P.E. (847) 705-4237
PROJECT MANAGER: MR. ISSAM RAYYAN, P.E. (847) 705-4178

R7E/R8E LOCATION MAP NOT TO SCALE
DORR TOWNSHIP

GROSS LENGTH OF IMPROVEMENT = 19,419 FT = 3.68 MILES
NET LENGTH OF IMPROVEMENT = 17,358 FT = 3.29 MILES



DATE SIGNED: 7/14/14
EXP. DATE: 11/30/15

STATE OF ILLINOIS
DEPARTMENT OF TRANSPORTATION
DIVISION OF HIGHWAYS

SUBMITTED July 14 2014
John Forthman
DEPUTY DIRECTOR OF HIGHWAYS, REGION ENGINEER

Aug 15 2014
John D. Baranzelle P.E.
acting ENGINEER OF DESIGN AND ENVIRONMENT

Aug 15 2014
Omer Osman P.E.
DIRECTOR OF HIGHWAYS, CHIEF ENGINEER

PRINTED BY THE AUTHORITY
OF THE STATE OF ILLINOIS

CONTRACT NO. 60Y59

Accurate
GROUP, INC.

WWW.ACCGI.COM
101 SCHELTER RD., SUITE 6-200
LINCOLNSHIRE, ILLINOIS 60069
T (847) 613-1100 F (847) 613-1105
ILLINOIS PROFESSIONAL DESIGN FIRM NO. 184.002053

INDEX OF SHEETS

SHEET NO.	DESCRIPTION
1	TITLE SHEET
2	INDEX OF SHEETS, STATE HIGHWAY STANDARDS & GENERAL NOTES
3-4	SUMMARY OF QUANTITIES
5	EXISTING AND PROPOSED TYPICAL SECTIONS
6-13	ROADWAY AND PAVEMENT MARKING PLAN
14	PAVEMENT PATCHING FOR HMA SURFACED PAVEMENT (BD-22)
15	BUTT JOINT AND HMA TAPER DETAILS (BD-32)
16	TRAFFIC CONTROL AND PROTECTION FOR SIDE ROADS, INTERSECTIONS, AND DRIVEWAYS (TC-10)
17	TYPICAL APPLICATIONS RAISED REFLECTIVE PAVEMENT MARKERS (SNOW PLOW RESISTANT) (TC-11)
18	DISTRICT ONE TYPICAL PAVEMENT MARKING (TC-13)
19	TRAFFIC CONTROL AND PROTECTION AT TURN BAYS (TO REMAIN OPEN TO TRAFFIC) (TC-14)
20	PAVEMENT MARKING LETTERS AND SYMBOLS FOR TRAFFIC STAGING (TC-16)
21	ARTERIAL ROAD INFORMATION SIGN (TC-22)

STATE HIGHWAY STANDARDS

STANDARD NO.	DESCRIPTION
442201-03	CLASS C AND D PATCHES
701006-05	OFF-RD MOVING OPERATIONS, 2L, 2W, 15' TO 24" FROM PAVEMENT EDGE
701011-04	OFF-RD MOVING OPERATIONS, 2L, 2W, DAY ONLY
701201-04	LANE CLOSURE, 2L, 2W, DAY ONLY
701301-04	LANE CLOSURE, 2L, 2W, SHORT TIME OPERATIONS
701306-03	LANE CLOSURE, 2L, 2W, SLOW MOVING OPERATIONS, DAY ONLY FOR SPEEDS ≥ 45 MPH
701311-03	LANE CLOSURE, 2L, 2W, MOVING OPERATIONS, DAY ONLY
701336-06	LANE CLOSURE, 2L, 2W, WORK AREAS IN SERIES, FOR SPEEDS ≥ 45 MPH
701901-03	TRAFFIC CONTROL DEVICES
701502-06	
701701-09	

GENERAL NOTES:

- BEFORE STARTING ANY EXCAVATION, THE CONTRACTOR SHALL CALL "J.U.L.I.E." AT (800) 892-0213 OR 811 FOR FIELD LOCATIONS OF BURIED ELECTRIC, TELEPHONE AND GAS FACILITIES. (48 HOUR NOTIFICATION IS REQUIRED).
- THE CONTRACTOR SHALL COORDINATE CONSTRUCTION ACTIVITIES WITH UTILITY COMPANIES, THE CITY OF WOODSTOCK AND THE CITY OF CRYSTAL LAKE.
- THE CONTRACTOR WILL NOT BE ALLOWED TO SET UP A YARD OR FIELD OFFICE ON STATE PROPERTY WITHOUT WRITTEN PERMISSION FROM THE DEPARTMENT.
- THE *CONTRACTOR* SHALL CONTACT THE TRAFFIC CONTROL SUPERVISOR AT (847) 705-4470 A MINIMUM OF 72 HOURS PRIOR TO THE INSTALLATION OF ANY TEMPORARY TRAFFIC CONTROL DEVICES.
- ALL DAMAGE TO EXISTING PAVEMENT MARKINGS OR RAISED REFLECTIVE PAVEMENT MARKERS OUTSIDE THE REMOVAL LINE SHOWN ON THE PLANS SHALL BE REPLACED AT THE CONTRACTOR'S EXPENSE.
- BEFORE BEGINNING ANY WORK, THE CONTRACTOR SHALL RETAIN AND RECORD FOR FUTURE REFERENCE, ALL EXISTING PAVEMENT MARKING LINES (AND RAISED REFLECTIVE PAVEMENT MARKERS) IN ORDER THAT THESE LOCATIONS CAN BE RE-ESTABLISHED FOR STRIPING. EXACT LOCATIONS OF ALL PAVEMENT MARKINGS SHALL BE AS DIRECTED BY THE ENGINEER.
- IT SHALL BE THE CONTRACTOR'S RESPONSIBILITY TO VERIFY ALL DIMENSIONS AND CONDITIONS EXISTING IN THE FIELD PRIOR TO CONSTRUCTION AND ORDERING OF MATERIALS.
- FRAMES AND GRATES ADJUSTMENT OF PRIVATE UTILITIES WITHIN THE LIMITS OF THE IMPROVEMENTS SHALL BE DONE BY THEIR RESPECTIVE OWNERS AND ARE NOT PART OF THIS CONTRACT.
- THE CONTRACTOR SHALL CONTACT THE DISTRICT ONE TRAFFIC CONTROL SUPERVISOR AT (847) 705-4470 A MINIMUM OF 72 HOURS IN ADVANCE OF BEGINNING WORK.
- THE RESIDENT ENGINEER SHALL CONTACT *W. CZARNY*, ARTERIAL *FIELD* OPERATIONS ENGINEER, AT (847) 715-8419 A MINIMUM OF TWO (2) WEEKS PRIOR TO THE PLACEMENT OF PERMANENT PAVEMENT MARKINGS.
- DO NOT SCALE PLANS FOR CONSTRUCTION DIMENSIONS.
- WHEN MILLED PAVEMENT IS OPEN TO TRAFFIC, THE MAXIMUM GRADE DIFFERENTIAL BETWEEN PASSES OF THE MILLING MACHINE SHALL NOT EXCEED 1/2 INCHES WHERE THE SPEED LIMIT IS 45 MPH OR LESS AND 1 INCH WHERE THE SPEED LIMIT IS 45 MPH, WITH WRITTEN APPROVAL FROM THE RESIDENT ENGINEER. A MAXIMUM GRADE DIFFERENTIAL OF 3 INCHES MAY BE ALLOWED IF THE EDGE OF THE MILLING IS SLOPED A MINIMUM OF 1:3 (V:H).
- ALL PAVEMENT PATCHING LOCATIONS WILL BE DETERMINED IN THE FIELD BY THE ENGINEER.
- BUTT JOINTS WILL BE INSTALLED AT THE ENDS OF ALL RESURFACING (WHERE RESURFACING MEETS EXISTING PAVEMENT) ACCORDING TO THE "BUTT JOINT AND HOT-MIX ASPHALT TAPER DETAILS" SHEET INCLUDED IN THE PLANS, UNLESS OTHERWISE SPECIFIED.
- THE CONTRACTOR SHALL BE REQUIRED TO PROVIDE ACCESS TO ABUTTING PROPERTY AT ALL TIMES DURING THE CONSTRUCTION OF THIS PROJECT.
- ALL PAVEMENT MARKINGS SHALL BE PLACED THROUGHOUT THE IMPROVEMENT ACCORDING TO DISTRICT 1 TYPICAL PAVEMENT MARKING.
- THE THICKNESS OF THE HMA MIXTURE SHOWN ON THE PLANS IS THE NOMINAL THICKNESS. DEVIATIONS FROM THE NOMINAL THICKNESS WILL BE PERMITTED WHEN SUCH DEVIATIONS OCCUR DUE TO IRREGULARITIES IN THE EXISTING SURFACE OR BASE ON WHICH THE HMA MIXTURE IS PLACED.
- PAVEMENT MARKING TAPE, TYPE III SHALL BE USED FOR SHORT TERM PAVEMENT MARKINGS ON ALL FINAL SURFACES.

FILE NAME: 1-FILES



USER NAME: Pprothapan	DESIGNED: JMT	REVISED: -
PLOT SCALE: 2.0000' / 1"	DRAWN: JN	REVISED: -
PLOT DATE: 7/17/2014	CHECKED: TM	REVISED: -
	DATE: 07/14/2014	REVISED: -

STATE OF ILLINOIS
DEPARTMENT OF TRANSPORTATION

IL RTE. 176 FROM IL RTE. 47 TO US RTE. 14 (VIRGINIA ST.)
INDEX OF SHEETS, STATE STANDARDS & GENERAL NOTES

SCALE: SHEET OF SHEETS STA. TO STA.

F.A.P. RTE.	SECTION	COUNTY	TOTAL SHEETS	SHEET NO.
335	1105&120RS-B	McHENRY	21	2
				CONTRACT NO. 60Y59
ILLINOIS FED. AID PROJECT				

Rev.

CODE NO.	ITEM	UNIT	TOTAL QUANTITY	CONSTR. CODE
				100% STATE ROADWAY 0005 URBAN
40600400	MIXTURE FOR CRACKS, JOINTS, AND FLANGEWAYS	TON	102	102
40600827	POLYMERIZED LEVELING BINDER (MACHINE METHOD), IL-4.75, N50	TON	2609	2609
40600895	CONSTRUCTING TEST STRIP	EACH	1	1
40600982	HOT-MIX ASPHALT SURFACE REMOVAL - BUTT JOINT	SQ YD	218	218
40603340	HOT-MIX ASPHALT SURFACE COURSE, MIX "D", N70	TON	5110	5110
44000158	HOT-MIX ASPHALT SURFACE REMOVAL, 2 1/4"	SQ YD	60773	60773
442017 89	CLASS D PATCHES, TYPE II, 1/2 INCH	SQ YD	775	775
442017 94	CLASS D PATCHES, TYPE III, 1/2 INCH	SQ YD	465	465
442017 96	CLASS D PATCHES, TYPE IV, 1/2 INCH	SQ YD	1860	1860
48102100	AGGREGATE WEDGE SHOULDER, TYPE B	TON	708	708
67000500	ENGINEER'S FIELD OFFICE, TYPE B	CAL MO	3	3
67100100	MOBILIZATION	L SUM	1	1
70100450	TRAFFIC CONTROL AND PROTECTION, STANDARD 701201	L SUM	1	1
70100460	TRAFFIC CONTROL AND PROTECTION, STANDARD 701306	L SUM	1	1

* SPECIALTY ITEMS

CODE NO.	ITEM	UNIT	TOTAL QUANTITY	CONSTR. CODE
				100% STATE ROADWAY 0005 URBAN
70100600	TRAFFIC CONTROL AND PROTECTION, STANDARD 701336	L SUM	1	1
70102022	TRAFFIC CONTROL AND PROTECTION, STANDARD 701502	L SUM	1	1
70300100	SHORT TERM PAVEMENT MARKING	FOOT	7076	7076
70102635	TRAFFIC CONTROL AND PROTECTION, STANDARD 701701	L SUM	1	1
70300210	TEMPORARY PAVEMENT MARKING LETTERS AND SYMBOLS	SQ FT	109	109
70300220	TEMPORARY PAVEMENT MARKING - LINE 4"	FOOT	58889	58889
70300240	TEMPORARY PAVEMENT MARKING - LINE 6"	FOOT	485	485
70300260	TEMPORARY PAVEMENT MARKING - LINE 12"	FOOT	380	380
70300280	TEMPORARY PAVEMENT MARKING - LINE 24"	FOOT	98	98
70301000	WORK ZONE PAVEMENT MARKING REMOVAL	SQ FT	1180	1180
* 78000100	THERMOPLASTIC PAVEMENT MARKING - LETTERS AND SYMBOLS	SQ FT	109	109
* 78000200	THERMOPLASTIC PAVEMENT MARKING - LINE 4"	FOOT	59,008	59,008
* 78000400	THERMOPLASTIC PAVEMENT MARKING - LINE 6"	FOOT	485	485
* 78000600	THERMOPLASTIC PAVEMENT MARKING - LINE 12"	FOOT	380	380
* 78000650	THERMOPLASTIC PAVEMENT MARKING - LINE 24"	FOOT	153	153
* 78100100	RAISED REFLECTIVE PAVEMENT MARKER	EACH	586	586

14

FILE NAME: WFILE



USER NAME: John	DESIGNED: JMT	REVISED:
DRAWN: JMT	CHECKED: TM	REVISED:
PLOT SCALE: 2.0000' / 1" =	DATE: 07/14/2014	REVISED:
PLOT DATE: 7/13/2014		

STATE OF ILLINOIS
DEPARTMENT OF TRANSPORTATION

IL RTE. 176 FROM IL RTE. 47 TO US RTE. 14 (VIRGINIA ST.)
SUMMARY OF QUANTITIES

SCALE: SHEET OF SHEETS STA. TO STA.

F.A.P. RTE. 335	SECTION 1105&1201R5-B	COUNTY MOHENEY	TOTAL SHEETS 21	SHEET NO. 3
CONTRACT NO. 60Y59				

ILLINOIS FED. AID PROJECT

Rev.

CODE NO.	ITEM	UNIT	TOTAL QUANTITY	CONSTR. CODE
				100% STATE ROADWAY 0005 URBAN
78300200	RAISED REFLECTIVE PAVEMENT MARKER REMOVAL	EACH	585	585
X2020110	GRADING AND SHAPING SHOULDERS	UNIT	340	340
X4060110	BITUMINOUS MATERIALS (PRIME COAT)	POUND	41022	41022
Z0030850	TEMPORARY INFORMATION SIGNING	SQ FT	156	156

4

* SPECIALTY ITEMS

FILE NAME = #FILEL#



USER NAME * John	DESIGNED - JMT	REVISED -
JMT	DRAWN -	REVISED -
PLOT SCALE * 2.0000' / 1"	CHECKED - TM	REVISED -
PLOT DATE * 7/13/2014	DATE - 07/14/2014	REVISED -

STATE OF ILLINOIS
DEPARTMENT OF TRANSPORTATION

IL RTE. 176 FROM IL RTE. 47 TO US RTE. 14 (VIRGINIA ST.)
SUMMARY OF QUANTITIES

SCALE: SHEET OF SHEETS STA. TO STA.

F.A.P. RTE.	SECTION	COUNTY	TOTAL SHEETS	SHEET NO.
335	1105&1201RS-B	MCHENRY	21	4
CONTRACT NO. GOY59			ILLINOIS FED. AID PROJECT	

Rev

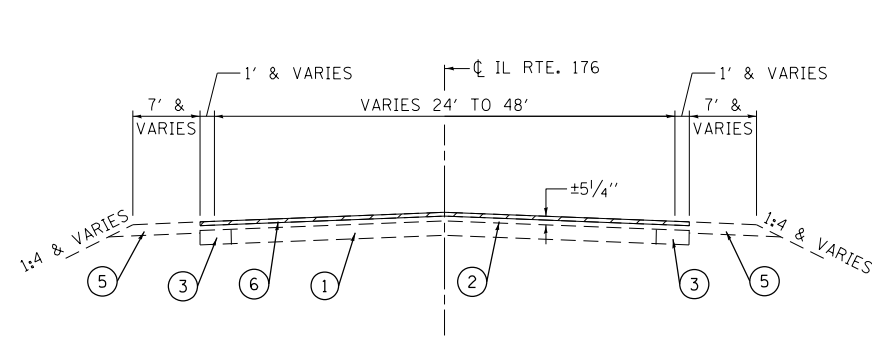

EXISTING TYPICAL SECTION
STA. 507+56 TO STA. 701+75

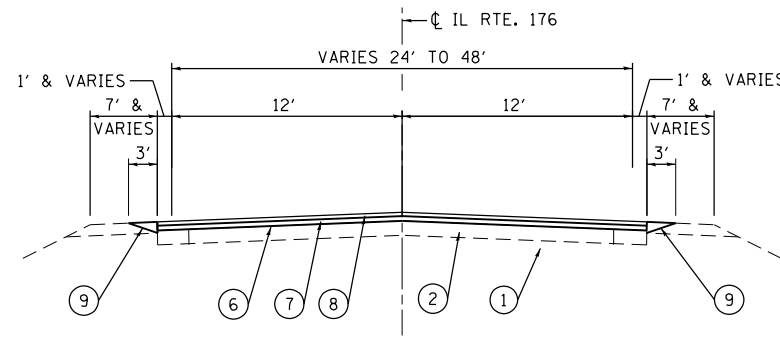

PROPOSED TYPICAL SECTION
STA. 507+56 TO STA. 701+75

LEGEND

- REMOVAL
- ① EXISTING PCC PAVEMENT (9'-7"-9')
- ② EXISTING HMA SURFACE COURSE (±5/4")
- ③ EXISTING PCC BASE COURSE WIDENING (±9')
- ④ EXISTING STABILIZED SHOULDER (±8'')**
- ⑤ EXISTING AGGREGATE SHOULDER (±7')
- ⑥ PROPOSED HMA SURFACE REMOVAL, 2 1/4"
- ⑦ PROPOSED POLYMERIZED LEVELING BINDER (MACHINE METHOD), IL-4.75, N50, 3/4"
- ⑧ PROPOSED HOT MIX ASPHALT SURFACE COURSE, MIX "D", N70, 1 1/2"
- ⑨ PROPOSED AGGREGATE WEDGE SHOULDER, TYPE B

**STA. 601+93 TO STA. 605+95
STA. 607+06 TO STA. 610+93

HMA MIXTURE REQUIREMENTS CHART

OPERATION	MIXTURE TYPE	AIR VOIDS (%) @ Ndes	QUALITY MANAGEMENT PROGRAM (OMP)
PAVEMENT RESURFACING	HOT-MIX ASPHALT SURFACE COURSE, MIX "D", N70 (IL 9.5mm), 1 1/2"	4% @ 70 GYR.	OCP
	POLYMERIZED LEVELING BINDER (MACHINE METHOD), IL-4.75, N50, 3/4"	3.5% @ 50 GYR.	OCP
PATCHING	CLASS D PATCHES - (HMA BINDER IL-19 mm)	4% @ 70 GYR.	OCP

OMP DESIGNATION: QUALITY CONTROL FOR PERFORMANCE (OCP)

- NOTE: 1. THE UNIT WEIGHT USED TO CALCULATE ALL HMA MIXTURE QUANTITIES IS 112 LBS/SQ YD/IN
2. THE "AC TYPE" FOR POLYMERIZED HMA MIXES SHALL BE "SBS/SBR PG 76-22" AND FOR NON-POLYMERIZED HMA THE "AC TYPE" SHALL BE "PG 64-22" UNLESS MODIFIED BY DISTRICT ONE SPECIAL PROVISIONS.
3. FOR USE OF RECYCLED MATERIALS SEE SPECIAL PROVISIONS.
4. QUALITY MANAGEMENT PROGRAM (OMP) IDENTIFIES THE PARTICULAR QUALITY CONTROL SPECIFICATION THAT APPLIES TO THE HMA MIXTURE

NOTE:
CONTRACTOR SHALL MILL FIRST BEFORE PATCHING

FILE NAME = \$FILEL\$



USER NAME = Pprathapan	DESIGNED - JMT	REVISED -
	DRAWN - JN	REVISED -
PLOT SCALE = 20.0000' / in.	CHECKED - TM	REVISED -
PLOT DATE = 7/16/2014	DATE - 07/14/2014	REVISED -

**STATE OF ILLINOIS
DEPARTMENT OF TRANSPORTATION**

**IL RTE. 176 FROM IL RTE. 47 TO US RTE. 14 (VIRGINIA ST.)
EXISTING AND PROPOSED TYPICAL SECTIONS**

SCALE: SHEET OF SHEETS STA. TO STA.

F.A.P. RTE.	SECTION	COUNTY	TOTAL SHEETS	SHEET NO.
335	(105&120)RS-8	McHENRY	21	5
CONTRACT NO. 60Y59			ILLINOIS FED. AID PROJECT	

IL RTE. 47

**IMPROVEMENT BEGINS
STATION 507 + 56.00**

IL RTE. 176

PROP. HMA SURFACE REMOVAL, 2 1/4"
PROP. POLY. LEVELING BINDER (MM), IL-4.75, N50, 3/4"
PROP. HMA SURFACE COURSE, MIX "D", N70, 1 1/2"

MATCH LINE STA. 514+25

500+00 505+00 510+00

PROP. HMA SURFACE REMOVAL
BUTT JOINT (4.5') (TYP.)

- ① PROP. THERMOPLASTIC PVMT. MARKING 4", LINE, WHITE (TYP.)
- ② PROP. THERMOPLASTIC PVMT. MARKING 4", LINE, YELLOW (TYP.)
- ③ PROP. THERMOPLASTIC PVMT. MARKING 4", 10' LINE - 30' SPACE, YELLOW (TYP.)
- ④ PROP. THERMOPLASTIC PVMT. MARKING 4", DOUBLE YELLOW (TYP.)
- ⑤ PROP. THERMOPLASTIC PVMT. MARKING 6", LINE, WHITE (TYP.)
- ⑥ PROP. THERMOPLASTIC PVMT. MARKING 12", DIAGONALS, YELLOW (TYP.), SEE DISTRICT DETAIL TC-13 FOR PROPER SPACING
- ⑦ PROP. THERMOPLASTIC PVMT. MARKING 12", DIAGONALS, WHITE (TYP.), SEE DISTRICT DETAIL TC-13 FOR PROPER SPACING
- ⑧ PROP. THERMOPLASTIC PVMT. MARKING 24", STOP BAR, WHITE (TYP.)
- ⑨ PROP. THERMOPLASTIC PVMT. MARKING LETTERS & SYMBOLS, WHITE (TYP.)
- ⑩ PROP. RAISED REFLECTIVE MARKERS (TYP.)
- ⑪ PROP. THERMOPLASTIC PVMT. MARKING 6", 2' LINE - 6' SPACE, WHITE

MATCH LINE STA. 514+25

IL RTE. 176

PROP. HMA SURFACE REMOVAL, 2 1/4"
PROP. POLY. LEVELING BINDER (MM), IL-4.75, N50, 3/4"
PROP. HMA SURFACE COURSE, MIX "D", N70, 1 1/2"

MATCH LINE STA. 529+00

515+00 520+00 525+00

FILE NAME = \$FILEL\$



USER NAME = TMiller	DESIGNED - JMT	REVISED -
DRAWN - CC	REVISIONS -	
PLOT SCALE = 100.0000' / in.	CHECKED - TM	REVISED -
PLOT DATE = 8/7/2014	DATE - 07/14/2014	REVISED -

**STATE OF ILLINOIS
DEPARTMENT OF TRANSPORTATION**

**IL RTE. 176 FROM IL RTE. 47 TO US RTE. 14 (VIRGINIA ST.)
ROADWAY AND PAVEMENT MARKING PLAN**

SCALE: SHEET 1 OF 8 SHEETS STA. 507+56 TO STA. 529+00

F.A.P. RTE.	SECTION	COUNTY	TOTAL SHEETS	SHEET NO.
335	(105&120)RS-8	McHENRY	21	6
CONTRACT NO. 60Y59				
ILLINOIS FED. AID PROJECT				

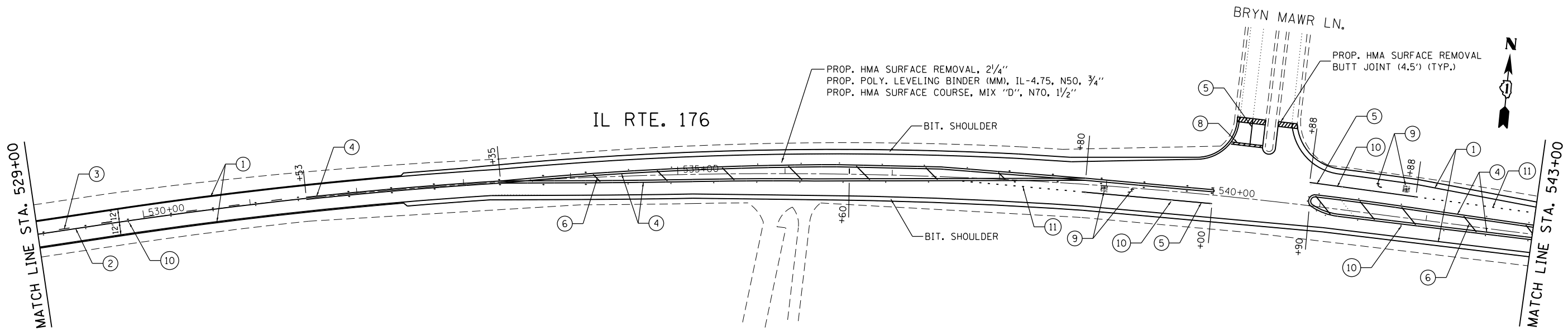

- ① PROP. THERMOPLASTIC PVMT. MARKING 4", LINE, WHITE (TYP.)
- ② PROP. THERMOPLASTIC PVMT. MARKING 4", LINE, YELLOW (TYP.)
- ③ PROP. THERMOPLASTIC PVMT. MARKING 4", 10' LINE - 30' SPACE, YELLOW (TYP.)
- ④ PROP. THERMOPLASTIC PVMT. MARKING 4", DOUBLE YELLOW (TYP.)
- ⑤ PROP. THERMOPLASTIC PVMT. MARKING 6", LINE, WHITE (TYP.)
- ⑥ PROP. THERMOPLASTIC PVMT. MARKING 12", DIAGONALS, YELLOW (TYP.), SEE DISTRICT DETAIL TC-13 FOR PROPER SPACING
- ⑦ PROP. THERMOPLASTIC PVMT. MARKING 12", DIAGONALS, WHITE (TYP.), SEE DISTRICT DETAIL TC-13 FOR PROPER SPACING
- ⑧ PROP. THERMOPLASTIC PVMT. MARKING 24", STOP BAR, WHITE (TYP.)
- ⑨ PROP. THERMOPLASTIC PVMT. MARKING LETTERS & SYMBOLS, WHITE (TYP.)
- ⑩ PROP. RAISED REFLECTIVE MARKERS (TYP.)
- ⑪ PROP. THERMOPLASTIC PVMT. MARKING 6", 2' LINE - 6' SPACE, WHITE (TYP.)

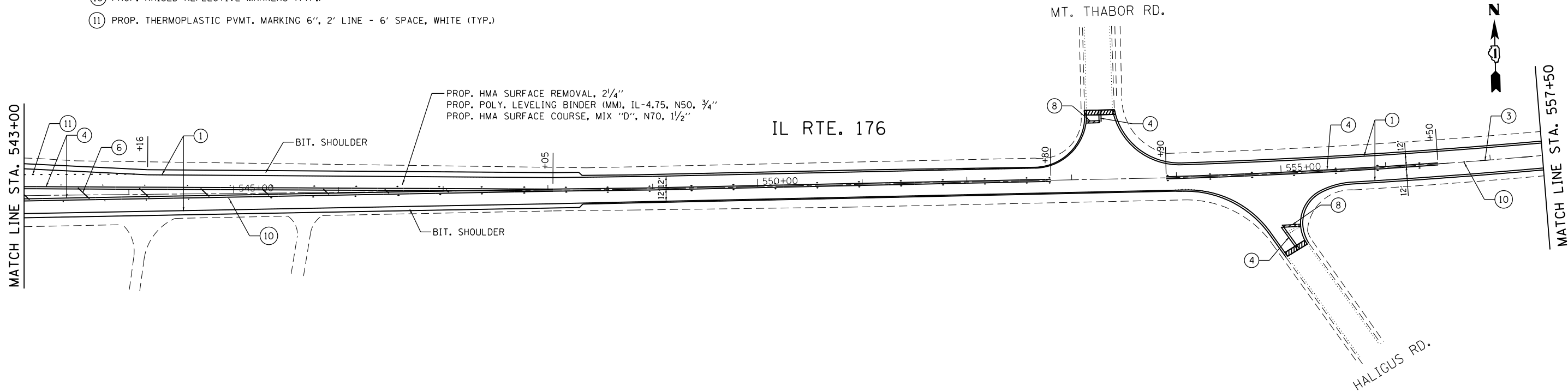

FILE NAME = #FILEL\$



USER NAME = TMiller	DESIGNED - JMT	REVISED -
DRAWN - CC	REVISED -	
PLOT SCALE = 100.0000' / in.	CHECKED - TM	REVISED -
PLOT DATE = 8/19/2014	DATE - 07/14/2014	REVISED -

**STATE OF ILLINOIS
DEPARTMENT OF TRANSPORTATION**

IL RTE. 176 FROM IL RTE. 47 TO US RTE. 14 (VIRGINIA ST.) ROADWAY AND PAVEMENT MARKING PLAN	
SCALE:	SHEET 2 OF 8 SHEETS STA. 529+00 TO STA. 557+50

F.A.P. RTE.	SECTION	COUNTY	TOTAL SHEETS	SHEET NO.
335	(105&120)RS-8	McHENRY	21	7
CONTRACT NO. 60Y59				
ILLINOIS FED. AID PROJECT				

MATCH LINE STA. 557+50

MATCH LINE STA. 571+60

IL RTE. 176

PROP. HMA SURFACE REMOVAL, 2 1/4"
 PROP. POLY. LEVELING BINDER (MM), IL-4.75, N50, 3/4"
 PROP. HMA SURFACE COURSE, MIX "D", N70, 1 1/2"

- ① PROP. THERMOPLASTIC PVMT. MARKING 4", LINE, WHITE (TYP.)
- ② PROP. THERMOPLASTIC PVMT. MARKING 4", LINE, YELLOW (TYP.)
- ③ PROP. THERMOPLASTIC PVMT. MARKING 4", 10' LINE - 30' SPACE, YELLOW (TYP.)
- ④ PROP. THERMOPLASTIC PVMT. MARKING 4", DOUBLE YELLOW (TYP.)
- ⑤ PROP. THERMOPLASTIC PVMT. MARKING 6", LINE, WHITE (TYP.)
- ⑥ PROP. THERMOPLASTIC PVMT. MARKING 12", DIAGONALS, YELLOW (TYP.), SEE DISTRICT DETAIL TC-13 FOR PROPER SPACING
- ⑦ PROP. THERMOPLASTIC PVMT. MARKING 12", DIAGONALS, WHITE (TYP.), SEE DISTRICT DETAIL TC-13 FOR PROPER SPACING
- ⑧ PROP. THERMOPLASTIC PVMT. MARKING 24", STOP BAR, WHITE (TYP.)
- ⑨ PROP. THERMOPLASTIC PVMT. MARKING LETTERS & SYMBOLS, WHITE (TYP.)
- ⑩ PROP. RAISED REFLECTIVE MARKERS (TYP.)
- ⑪ PROP. THERMOPLASTIC PVMT. MARKING 6", 2' LINE - 6' SPACE, WHITE (TYP.)

MATCH LINE STA. 571+60

MATCH LINE STA. 586+00

IL RTE. 176

PROP. HMA SURFACE REMOVAL, 2 1/4"
 PROP. POLY. LEVELING BINDER (MM), IL-4.75, N50, 3/4"
 PROP. HMA SURFACE COURSE, MIX "D", N70, 1 1/2"

FILE NAME = \$FILEL\$



USER NAME = TMiller	DESIGNED - JMT	REVISED -
PLOT SCALE = 100.0000' / in.	DRAWN - CC	REVISED -
PLOT DATE = 8/7/2014	CHECKED - TM	REVISED -
	DATE - 07/14/2014	REVISED -

STATE OF ILLINOIS
 DEPARTMENT OF TRANSPORTATION

IL RTE. 176 FROM IL RTE. 47 TO US RTE. 14 (VIRGINIA ST.)
 ROADWAY AND PAVEMENT MARKING PLAN

SCALE: SHEET 3 OF 8 SHEETS STA. 557+50 TO STA. 586+00

F.A.P. RTE.	SECTION	COUNTY	TOTAL SHEETS	SHEET NO.
335	(105&120)RS-8	McHENRY	21	8
CONTRACT NO. 60Y59				
ILLINOIS FED. AID PROJECT				

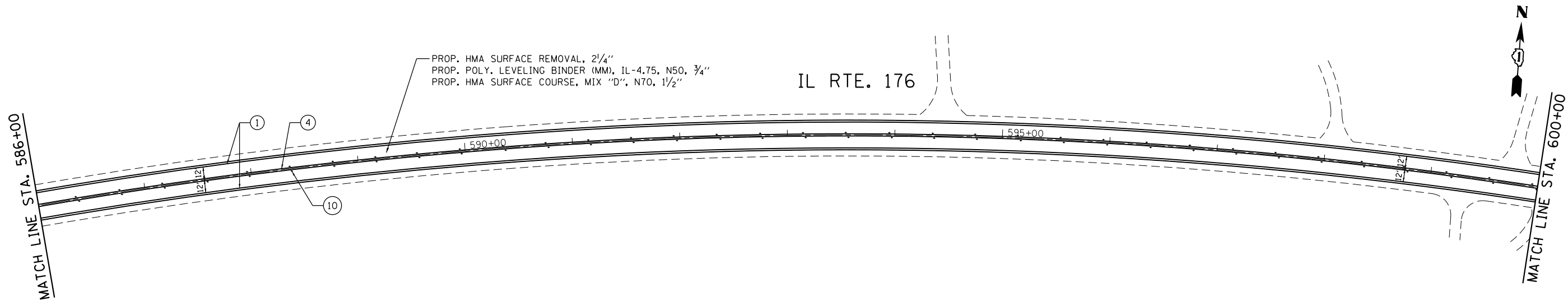

- ① PROP. THERMOPLASTIC PVMT. MARKING 4", LINE, WHITE (TYP.)
- ② PROP. THERMOPLASTIC PVMT. MARKING 4", LINE, YELLOW (TYP.)
- ③ PROP. THERMOPLASTIC PVMT. MARKING 4", 10' LINE - 30' SPACE, YELLOW (TYP.)
- ④ PROP. THERMOPLASTIC PVMT. MARKING 4", DOUBLE YELLOW (TYP.)
- ⑤ PROP. THERMOPLASTIC PVMT. MARKING 6", LINE, WHITE (TYP.)
- ⑥ PROP. THERMOPLASTIC PVMT. MARKING 12", DIAGONALS, YELLOW (TYP.), SEE DISTRICT DETAIL TC-13 FOR PROPER SPACING
- ⑦ PROP. THERMOPLASTIC PVMT. MARKING 12", DIAGONALS, WHITE (TYP.), SEE DISTRICT DETAIL TC-13 FOR PROPER SPACING
- ⑧ PROP. THERMOPLASTIC PVMT. MARKING 24", STOP BAR, WHITE (TYP.)
- ⑨ PROP. THERMOPLASTIC PVMT. MARKING LETTERS & SYMBOLS, WHITE (TYP.)
- ⑩ PROP. RAISED REFLECTIVE MARKERS (TYP.)
- ⑪ PROP. THERMOPLASTIC PVMT. MARKING 6", 2' LINE - 6' SPACE, WHITE (TYP.)

BRIDGE OMISSION - S.N. 056-0069
STA. 605+95 TO STA. 607+06

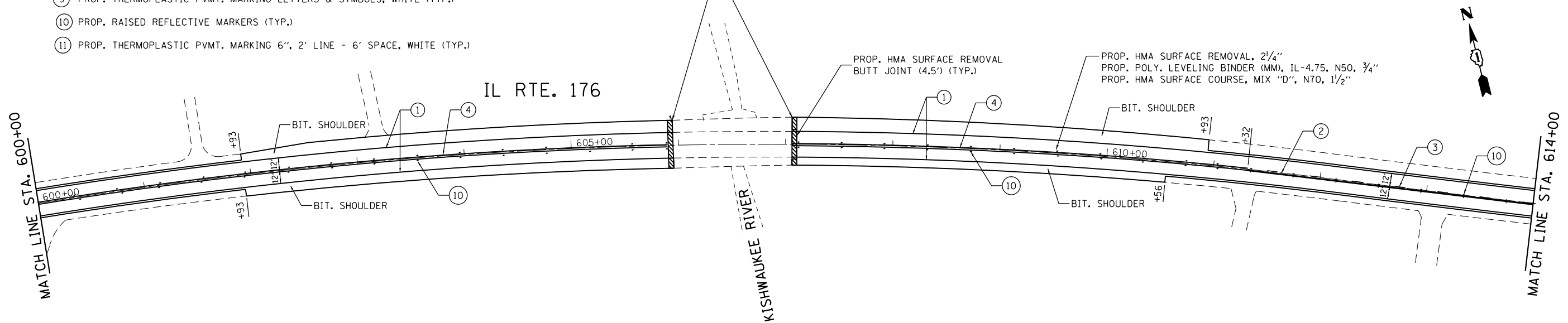

FILE NAME = #FILEL\$



USER NAME = TMiller	DESIGNED - JMT	REVISED -
DRAWN - CC	REVISIONS -	
PLOT SCALE = 100.0000' / in.	CHECKED - TM	REVISED -
PLOT DATE = 8/7/2014	DATE - 07/14/2014	REVISED -

**STATE OF ILLINOIS
DEPARTMENT OF TRANSPORTATION**

**IL RTE. 176 FROM IL RTE. 47 TO US RTE. 14 (VIRGINIA ST.)
ROADWAY AND PAVEMENT MARKING PLAN**

SCALE: SHEET 4 OF 8 SHEETS STA. 586+00 TO STA. 614+00

F.A.P. RTE.	SECTION	COUNTY	TOTAL SHEETS	SHEET NO.
335	(105&120)RS-8	McHENRY	21	9
CONTRACT NO. 60Y59				
ILLINOIS FED. AID PROJECT				



MATCH LINE STA. 614+00

MATCH LINE STA. 628+50

IL RTE. 176

PROP. HMA SURFACE REMOVAL, 2 1/4"
PROP. POLY. LEVELING BINDER (MM), IL-4.75, N50, 3/4"
PROP. HMA SURFACE COURSE, MIX "D", N70, 1 1/2"

OMISSION BEGINS: STA.622+43

PROP. HMA SURFACE REMOVAL
BUTT JOINT (4.5') (TYP.)

- ① PROP. THERMOPLASTIC PVMT. MARKING 4", LINE, WHITE (TYP.)
- ② PROP. THERMOPLASTIC PVMT. MARKING 4", LINE, YELLOW (TYP.)
- ③ PROP. THERMOPLASTIC PVMT. MARKING 4", 10' LINE - 30' SPACE, YELLOW (TYP.)
- ④ PROP. THERMOPLASTIC PVMT. MARKING 4", DOUBLE YELLOW (TYP.)
- ⑤ PROP. THERMOPLASTIC PVMT. MARKING 6", LINE, WHITE (TYP.)
- ⑥ PROP. THERMOPLASTIC PVMT. MARKING 12", DIAGONALS, YELLOW (TYP.), SEE DISTRICT DETAIL TC-13 FOR PROPER SPACING
- ⑦ PROP. THERMOPLASTIC PVMT. MARKING 12", DIAGONALS, WHITE (TYP.), SEE DISTRICT DETAIL TC-13 FOR PROPER SPACING
- ⑧ PROP. THERMOPLASTIC PVMT. MARKING 24", STOP BAR, WHITE (TYP.)
- ⑨ PROP. THERMOPLASTIC PVMT. MARKING LETTERS & SYMBOLS, WHITE (TYP.)
- ⑩ PROP. RAISED REFLECTIVE MARKERS (TYP.)
- ⑪ PROP. THERMOPLASTIC PVMT. MARKING 6", 2' LINE - 6' SPACE, WHITE (TYP.)

BRIARWOOD RD.

MATCH LINE STA. 628+50

IL RTE. 176

OMISSION ENDS: STA.641+90

MATCH LINE STA. 642+50

PROP. HMA SURFACE REMOVAL, 2 1/4"
PROP. POLY. LEVELING BINDER (MM), IL-4.75, N50, 3/4"
PROP. HMA SURFACE COURSE, MIX "D", N70, 1 1/2"

BRIARWOOD RD.



FILE NAME = \$FILEL\$



USER NAME = TMiller	DESIGNED - JMT	REVISED -
DRAWN - CC	REVISOR -	
PLOT SCALE = 100.0000' / in.	CHECKED - TM	REVISED -
PLOT DATE = 8/7/2014	DATE - 07/14/2014	REVISED -

STATE OF ILLINOIS
DEPARTMENT OF TRANSPORTATION

IL RTE. 176 FROM IL RTE. 47 TO US RTE. 14 (VIRGINIA ST.)
ROADWAY AND PAVEMENT MARKING PLAN

SCALE: SHEET 5 OF 8 SHEETS STA. 614+00 TO STA. 642+50

F.A.P. RTE.	SECTION	COUNTY	TOTAL SHEETS	SHEET NO.
335	(105&120)RS-8	McHENRY	21	10
CONTRACT NO. 60Y59				
ILLINOIS FED. AID PROJECT				



MATCH LINE STA. 642+50

MATCH LINE STA. 657+00

IL RTE. 176

PROP. HMA SURFACE REMOVAL, 2 1/4"
PROP. POLY. LEVELING BINDER (MM), IL-4.75, N50, 3/4"
PROP. HMA SURFACE COURSE, MIX "D", N70, 1 1/2"

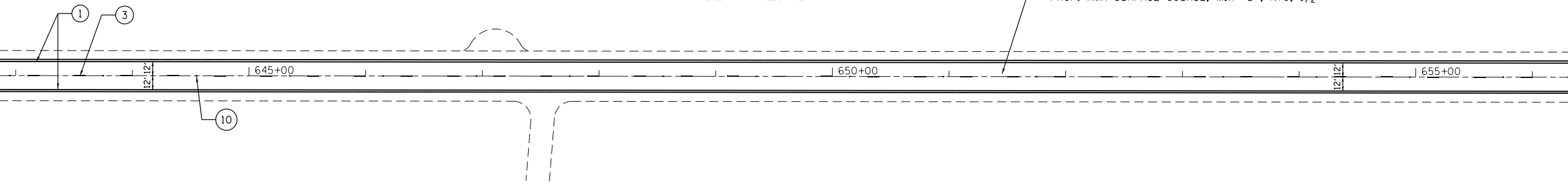

- ① PROP. THERMOPLASTIC PVMT. MARKING 4", LINE, WHITE (TYP.)
- ② PROP. THERMOPLASTIC PVMT. MARKING 4", LINE, YELLOW (TYP.)
- ③ PROP. THERMOPLASTIC PVMT. MARKING 4", 10' LINE - 30' SPACE, YELLOW (TYP.)
- ④ PROP. THERMOPLASTIC PVMT. MARKING 4", DOUBLE YELLOW (TYP.)
- ⑤ PROP. THERMOPLASTIC PVMT. MARKING 6", LINE, WHITE (TYP.)
- ⑥ PROP. THERMOPLASTIC PVMT. MARKING 12", DIAGONALS, YELLOW (TYP.), SEE DISTRICT DETAIL TC-13 FOR PROPER SPACING
- ⑦ PROP. THERMOPLASTIC PVMT. MARKING 12", DIAGONALS, WHITE (TYP.), SEE DISTRICT DETAIL TC-13 FOR PROPER SPACING
- ⑧ PROP. THERMOPLASTIC PVMT. MARKING 24", STOP BAR, WHITE (TYP.)
- ⑨ PROP. THERMOPLASTIC PVMT. MARKING LETTERS & SYMBOLS, WHITE (TYP.)
- ⑩ PROP. RAISED REFLECTIVE MARKERS (TYP.)
- ⑪ PROP. THERMOPLASTIC PVMT. MARKING 6", 2' LINE - 6' SPACE, WHITE (TYP.)



MATCH LINE STA. 657+00

MATCH LINE STA. 671+75

IL RTE. 176

PROP. HMA SURFACE REMOVAL, 2 1/4"
PROP. POLY. LEVELING BINDER (MM), IL-4.75, N50, 3/4"
PROP. HMA SURFACE COURSE, MIX "D", N70, 1 1/2"

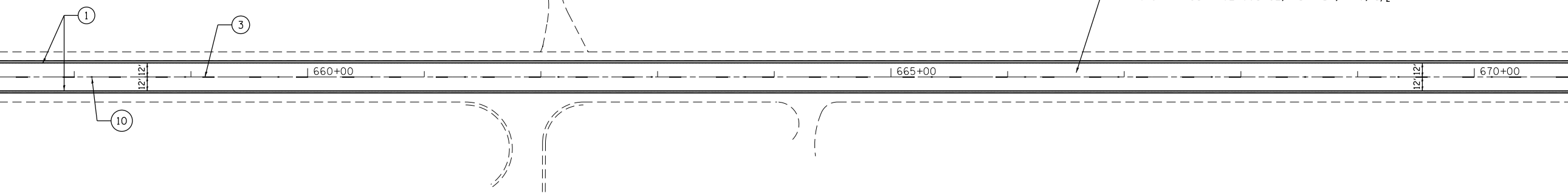

LIPPOLD PARK
WEST ENTRANCE

FILE NAME = \$FILEL\$



USER NAME = TMiller	DESIGNED - JMT	REVISED -
	DRAWN - CC	REVISED -
PLOT SCALE = 100.0000' / 1"	CHECKED - TM	REVISED -
PLOT DATE = 8/7/2014	DATE - 07/14/2014	REVISED -

STATE OF ILLINOIS
DEPARTMENT OF TRANSPORTATION

IL RTE. 176 FROM IL RTE. 47 TO US RTE. 14 (VIRGINIA ST.)
ROADWAY AND PAVEMENT MARKING PLAN

SCALE: SHEET 6 OF 8 SHEETS STA. 642+50 TO STA. 671+75

F.A.P. RTE.	SECTION	COUNTY	TOTAL SHEETS	SHEET NO.
335	(105&120)RS-8	McHENRY	21	11
CONTRACT NO. 60Y59				

ILLINOIS FED. AID PROJECT

MATCH LINE STA. 671+75

MATCH LINE STA. 686+50

IL RTE. 176



PROP. HMA SURFACE REMOVAL, 2 1/4"
PROP. POLY. LEVELING BINDER (MM), IL-4.75, N50, 3/4"
PROP. HMA SURFACE COURSE, MIX "D", N70, 1 1/2"

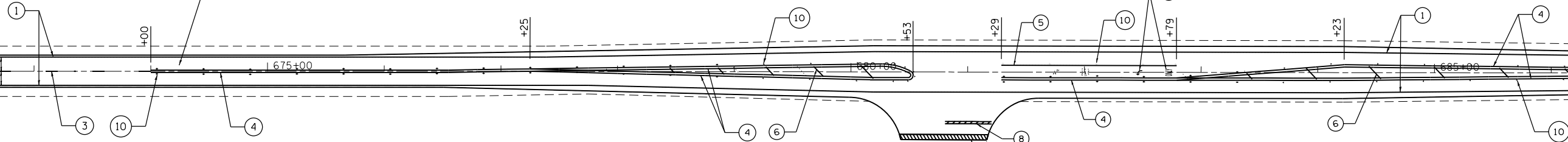

- ① PROP. THERMOPLASTIC PVMT. MARKING 4", LINE, WHITE (TYP.)
- ② PROP. THERMOPLASTIC PVMT. MARKING 4", LINE, YELLOW (TYP.)
- ③ PROP. THERMOPLASTIC PVMT. MARKING 4", 10' LINE - 30' SPACE, YELLOW (TYP.)
- ④ PROP. THERMOPLASTIC PVMT. MARKING 4", DOUBLE YELLOW (TYP.)
- ⑤ PROP. THERMOPLASTIC PVMT. MARKING 6", LINE, WHITE (TYP.)
- ⑥ PROP. THERMOPLASTIC PVMT. MARKING 12", DIAGONALS, YELLOW (TYP.), SEE DISTRICT DETAIL TC-13 FOR PROPER SPACING
- ⑦ PROP. THERMOPLASTIC PVMT. MARKING 12", DIAGONALS, WHITE (TYP.), SEE DISTRICT DETAIL TC-13 FOR PROPER SPACING
- ⑧ PROP. THERMOPLASTIC PVMT. MARKING 24", STOP BAR, WHITE (TYP.)
- ⑨ PROP. THERMOPLASTIC PVMT. MARKING LETTERS & SYMBOLS, WHITE (TYP.)
- ⑩ PROP. RAISED REFLECTIVE MARKERS (TYP.)
- ⑪ PROP. THERMOPLASTIC PVMT. MARKING 6", 2' LINE - 6' SPACE, WHITE (TYP.)

PROP. HMA SURFACE REMOVAL
BUTT JOINT (4.5') (TYP.)

LIPPOLD PARK
EAST ENTRANCE

MATCH LINE STA. 686+50

MATCH LINE STA. 701+25

IL RTE. 176



PROP. HMA SURFACE REMOVAL, 2 1/4"
PROP. POLY. LEVELING BINDER (MM), IL-4.75, N50, 3/4"
PROP. HMA SURFACE COURSE, MIX "D", N70, 1 1/2"

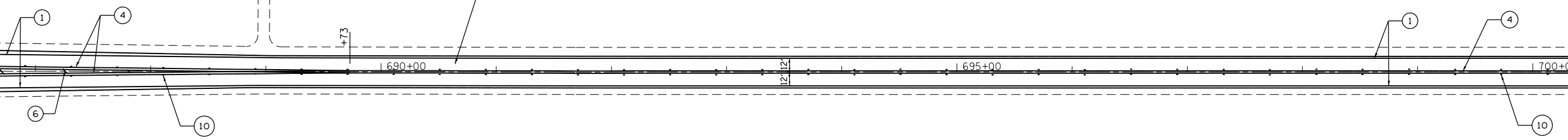

FILE NAME = \$FILEL\$



USER NAME = ccase	DESIGNED - JMT	REVISED -
DRAWN - CC	REVISED -	
PLOT SCALE = 100.0000' / 1" =	CHECKED - TM	REVISED -
PLOT DATE = 8/19/2014	DATE - 07/14/2014	REVISED -

STATE OF ILLINOIS
DEPARTMENT OF TRANSPORTATION

IL RTE. 176 FROM IL RTE. 47 TO US RTE. 14 (VIRGINIA ST.)
ROADWAY AND PAVEMENT MARKING PLAN

SCALE: SHEET 7 OF 8 SHEETS STA. 671+75 TO STA. 701+25

F.A.P. RTE.	SECTION	COUNTY	TOTAL SHEETS	SHEET NO.
335	(105&120)RS-8	McHENRY	21	12
CONTRACT NO. 60Y59				
ILLINOIS FED. AID PROJECT				

US RTE. 14
(VIRGINIA ST.)



IL RTE. 176

**IMPROVEMENT ENDS
STATION 701+73.85**

PROP. HMA SURFACE REMOVAL, 2 1/4"
PROP. POLY. LEVELING BINDER (MM), IL-4.75, N50, 3/4"
PROP. HMA SURFACE COURSE, MIX "D", N70, 1 1/2"

MATCH LINE STA. 701+25

PROP. HMA SURFACE REMOVAL
BUTT JOINT (4.5')

- ① PROP. THERMOPLASTIC PVMT. MARKING 4", LINE, WHITE (TYP.)
- ② PROP. THERMOPLASTIC PVMT. MARKING 4", LINE, YELLOW (TYP.)
- ③ PROP. THERMOPLASTIC PVMT. MARKING 4", 10' LINE - 30' SPACE, YELLOW (TYP.)
- ④ PROP. THERMOPLASTIC PVMT. MARKING 4", DOUBLE YELLOW (TYP.)
- ⑤ PROP. THERMOPLASTIC PVMT. MARKING 6", LINE, WHITE (TYP.)
- ⑥ PROP. THERMOPLASTIC PVMT. MARKING 12", DIAGONALS, YELLOW (TYP.), SEE DISTRICT DETAIL TC-13 FOR PROPER SPACING
- ⑦ PROP. THERMOPLASTIC PVMT. MARKING 12", DIAGONALS, WHITE (TYP.), SEE DISTRICT DETAIL TC-13 FOR PROPER SPACING
- ⑧ PROP. THERMOPLASTIC PVMT. MARKING 24", STOP BAR, WHITE (TYP.)
- ⑨ PROP. THERMOPLASTIC PVMT. MARKING LETTERS & SYMBOLS, WHITE (TYP.)
- ⑩ PROP. RAISED REFLECTIVE MARKERS (TYP.)
- ⑪ PROP. THERMOPLASTIC PVMT. MARKING 6", 2' LINE - 6' SPACE, WHITE (TYP.)

FILE NAME = #FILEL\$



USER NAME = TMiller	DESIGNED - JMT	REVISED -
	DRAWN - CC	REVISED -
PLOT SCALE = 100.0000' / 1"	CHECKED - TM	REVISED -
PLOT DATE = 8/7/2014	DATE - 07/14/2014	REVISED -

**STATE OF ILLINOIS
DEPARTMENT OF TRANSPORTATION**

**IL RTE. 176 FROM IL RTE. 47 TO US RTE. 14 (VIRGINIA ST.)
ROADWAY AND PAVEMENT MARKING PLAN**

SCALE: SHEET 8 OF 8 SHEETS STA. 701+25 TO STA. 701+75

F.A.P. RTE.	SECTION	COUNTY	TOTAL SHEETS	SHEET NO.
335	(105&120)RS-8	McHENRY	21	13
CONTRACT NO. 60Y59				
ILLINOIS FED. AID PROJECT				

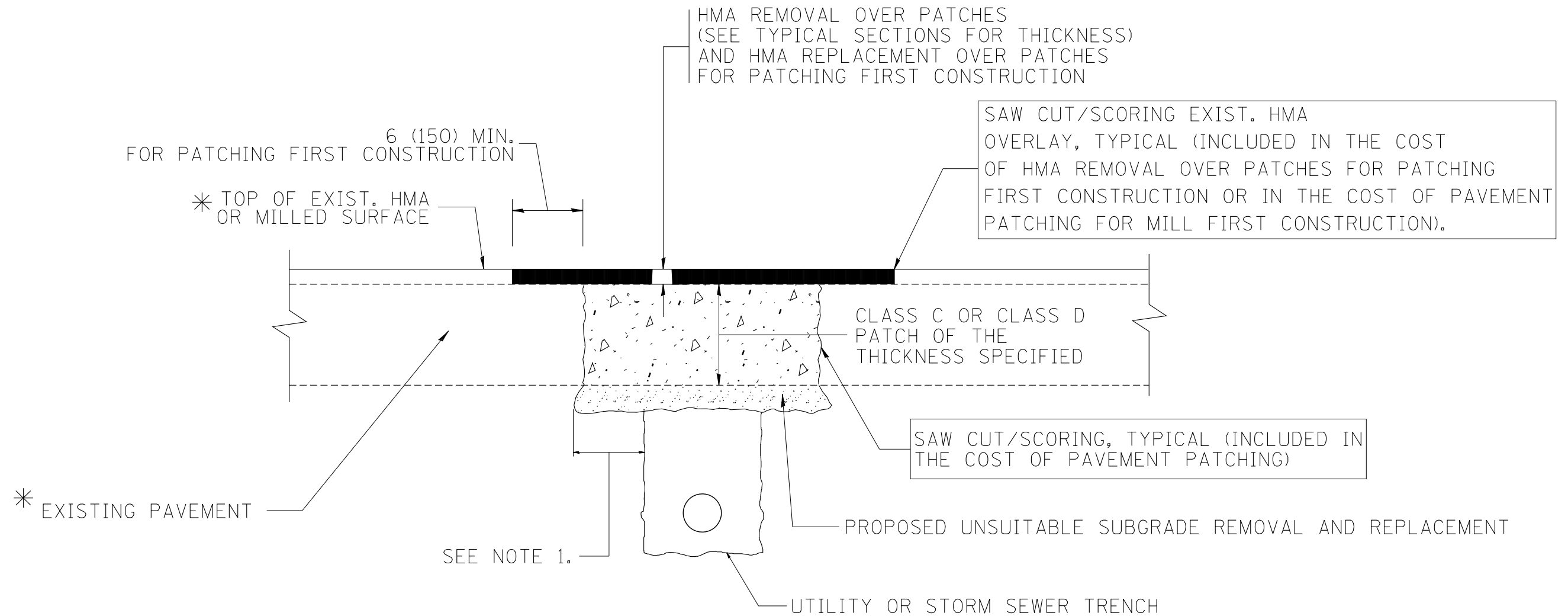

* SEE TYPICAL SECTIONS FOR THICKNESS AND MATERIALS

NOTES:

1. THE WIDTH OF THE FULL DEPTH PATCH OVER A TRENCH SHALL BE 12 (300) WIDER ON EACH SIDE OF THE TRENCH.
2. FOR METHOD OF MEASUREMENT AND BASIS OF PAYMENT, SEE RECURRING SPECIAL PROVISION "PATCHING WITH HOT-MIX ASPHALT OVERLAY REMOVAL".

SEQUENCE OF CONSTRUCTION (PATCHING FIRST)

1. REMOVE THE EXISTING HMA MATERIAL OVER THE AREA TO BE PATCHED.
2. REMOVE AND REPLACE WITH CLASS C OR D PATCH.
3. REPLACE HMA MATERIAL OVER THE AREA TO BE PATCHED.

SEQUENCE OF CONSTRUCTION (MILLING FIRST)

1. MILL HMA FIRST IF THERE IS AT LEAST 4 1/2 INCHES OR MORE OF HMA MATERIAL ON TOP OF THE EXISTING PAVEMENT OR IF THE PAVEMENT IS FULL DEPTH HMA. A MINIMUM OF 2 INCHES OF HMA MATERIAL SHALL BE IN PLACE AFTER MILLING.
2. REMOVE AND REPLACE WITH FULL DEPTH CLASS D PATCHES TO TOP OF MILLED SURFACE.

ALL DIMENSIONS ARE IN INCHES (MILLIMETERS) UNLESS OTHERWISE SHOWN.

FILE NAME = c:\projects\diststd22x34\bd22.dgn	USER NAME = bauerdl	DESIGNED - R. SHAH	REVISED - A. ABBAS 04-27-98
		DRAWN -	REVISED - R. BORO 01-01-07
		PLOT SCALE = 50.000' / IN.	REVISED - R. BORO 09-04-07
		PLOT DATE = 10/27/2008	REVISED - K. ENG 10-27-08

**STATE OF ILLINOIS
DEPARTMENT OF TRANSPORTATION**

**PAVEMENT PATCHING FOR
HMA SURFACED PAVEMENT**

SCALE: NONE SHEET NO. 1 OF 1 SHEETS STA. TO STA.

F.A.P. RTE.	SECTION	COUNTY	TOTAL SHEETS	SHEET NO.
335	(105&120) RS-8	McHENRY	21	14
BD400-04 (BD-22)			CONTRACT NO. 60Y59	
FED. ROAD DIST. NO. 1 ILLINOIS FED. AID PROJECT				

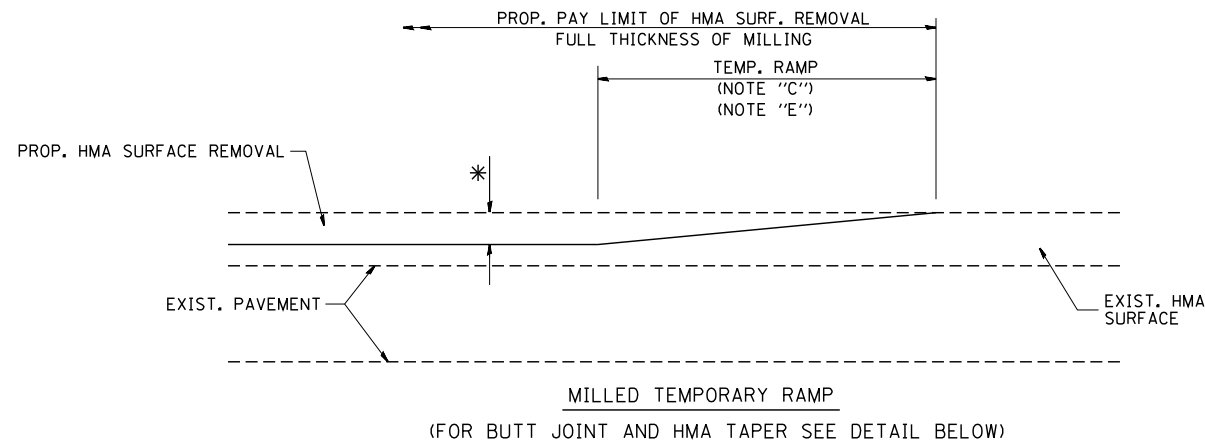

OPTION 1

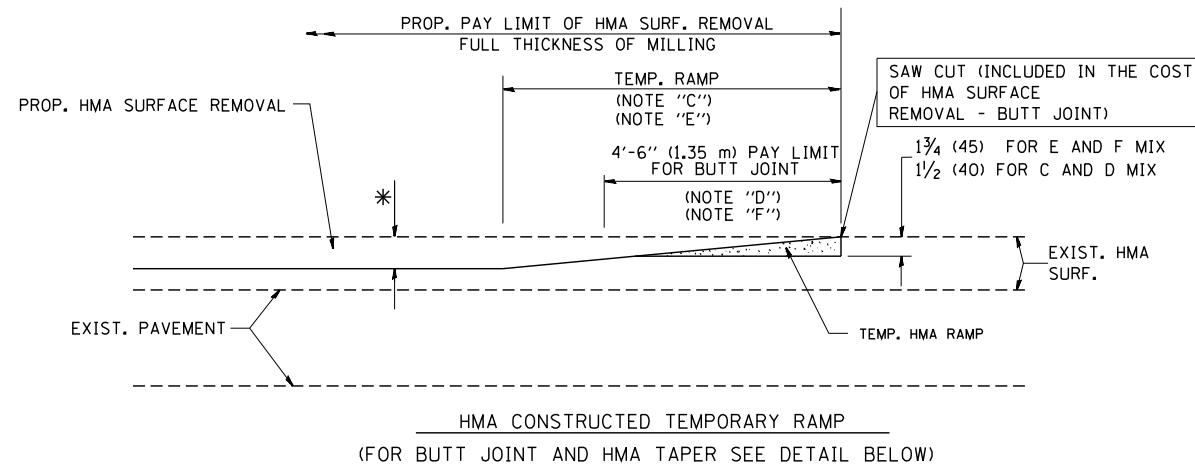

OPTION 2

TYPICAL TEMPORARY RAMP

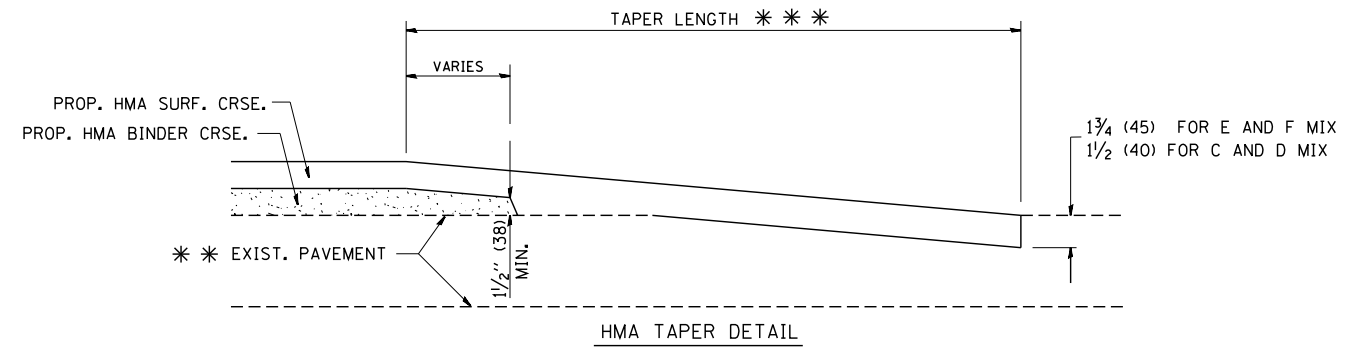
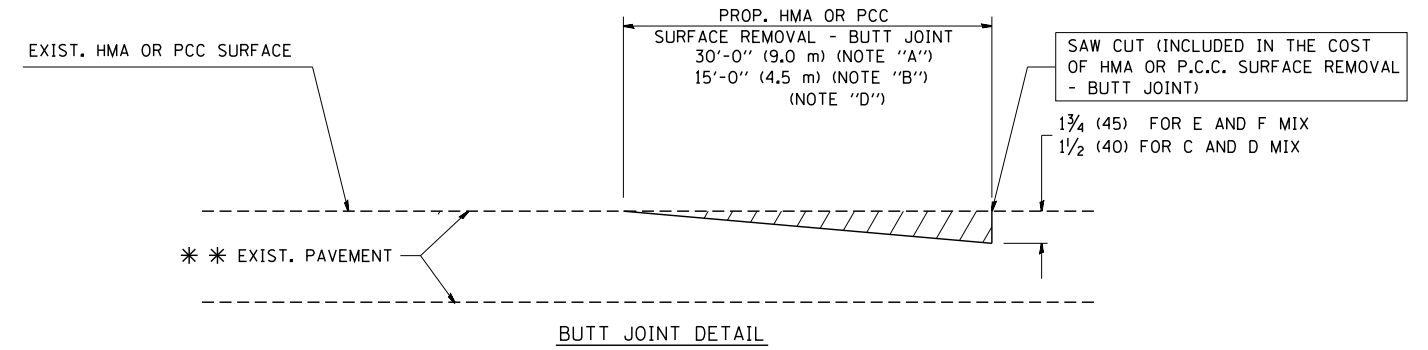

TYPICAL BUTT JOINT AND HMA TAPER FOR RESURFACING ONLY

*** PC CONCRETE, HMA OR HMA RESURFACED PAVEMENT.

NOTES

- A: MAINLINE ROADWAYS AND MAJOR SIDE ROADS.
 - B: MINOR SIDE ROADS.
 - C: THE TEMP. RAMP SHALL BE CONSTRUCTED IMMEDIATELY UPON REMOVAL OF THE EXISTING HMA SURFACE.
 - D: THE BUTT JOINT SHALL BE CONSTRUCTED IMMEDIATELY PRIOR TO PLACING THE PROPOSED HMA COURSES.
 - E: TAPER THE TEMP. RAMP AT A RATE OF 3'-0" (900 mm) PER 1 INCH (25 mm) OF MILLING THICKNESS.
 - F: INSTALLATION AND REMOVAL OF THE 4'-6" (1.35 m) TEMP. RAMP IS INCLUDED IN COST OF HMA SURFACE REMOVAL - BUTT JOINT
 - G: SEE ARTICLE 406.08 AND 406.14 OF THE STANDARD SPECIFICATIONS FOR "HMA AND/OR PCC SURFACE REMOVAL, BUTT JOINT".
- * SEE TYPICAL SECTIONS FOR MILLING THICKNESS.
- *** 20'-0" (6.1 m) PER 1 (25) RESURFACING (NOTE "A")
10'-0" (3.0 m) PER 1 (25) RESURFACING (NOTE "B")

BASIS OF PAYMENT:

THE BUTT JOINT WILL BE PAID FOR AT THE CONTRACT UNIT PRICE PER SQUARE YARD (SQUARE METER) FOR "HOT-MIX ASPHALT SURFACE REMOVAL - BUTT JOINT" OR FOR "PORTLAND CEMENT CONCRETE SURFACE REMOVAL - BUTT JOINT".

ALL DIMENSIONS ARE IN INCHES (MILLIMETERS) UNLESS OTHERWISE SHOWN.

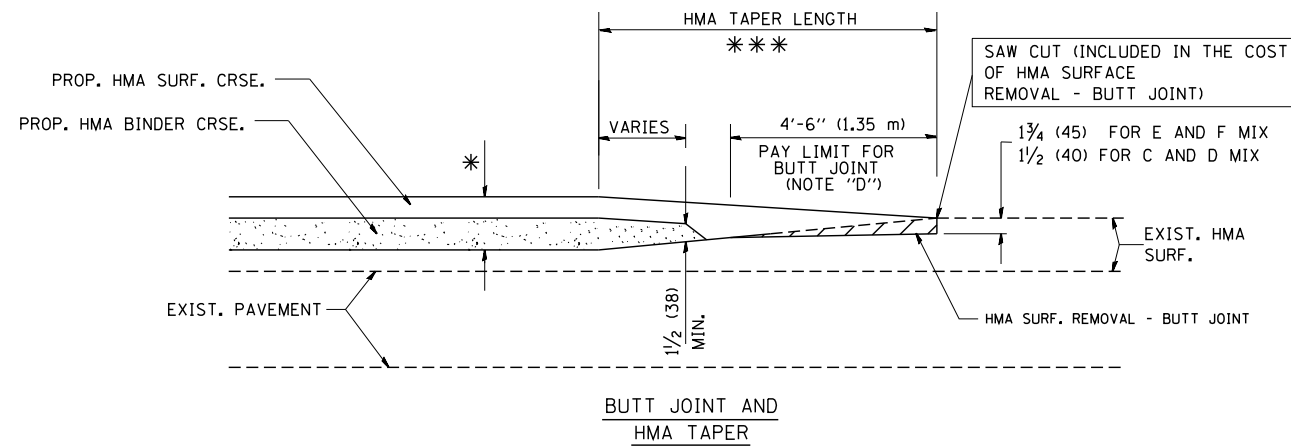

TYPICAL BUTT JOINT AND HMA TAPER FOR MILLING AND RESURFACING

FILE NAME = W:\diststd\22x34\bd32.dgn

USER NAME = gaglionobt
PLOT SCALE = 50.0000' / IN.
PLOT DATE = 1/4/2008

DESIGNED - M. DE YONG
DRAWN -
CHECKED -
DATE - 06-13-90

REVISED - R. SHAH 10-25-94
REVISED - A. ABBAS 03-21-97
REVISED - M. GOMEZ 04-06-01
REVISED - R. BORO 01-01-07

**STATE OF ILLINOIS
DEPARTMENT OF TRANSPORTATION**

**BUTT JOINT AND
HMA TAPER DETAILS**

SCALE: NONE SHEET NO. 1 OF 1 SHEETS STA. TO STA.

F.A.P. RTE.	SECTION	COUNTY	TOTAL SHEETS	SHEET NO.
335	(105&120) RS-8	McHENRY	21	15
BD400-05 BD32		CONTRACT NO. 60Y59		
FED. ROAD DIST. NO. 1 ILLINOIS FED. AID PROJECT				

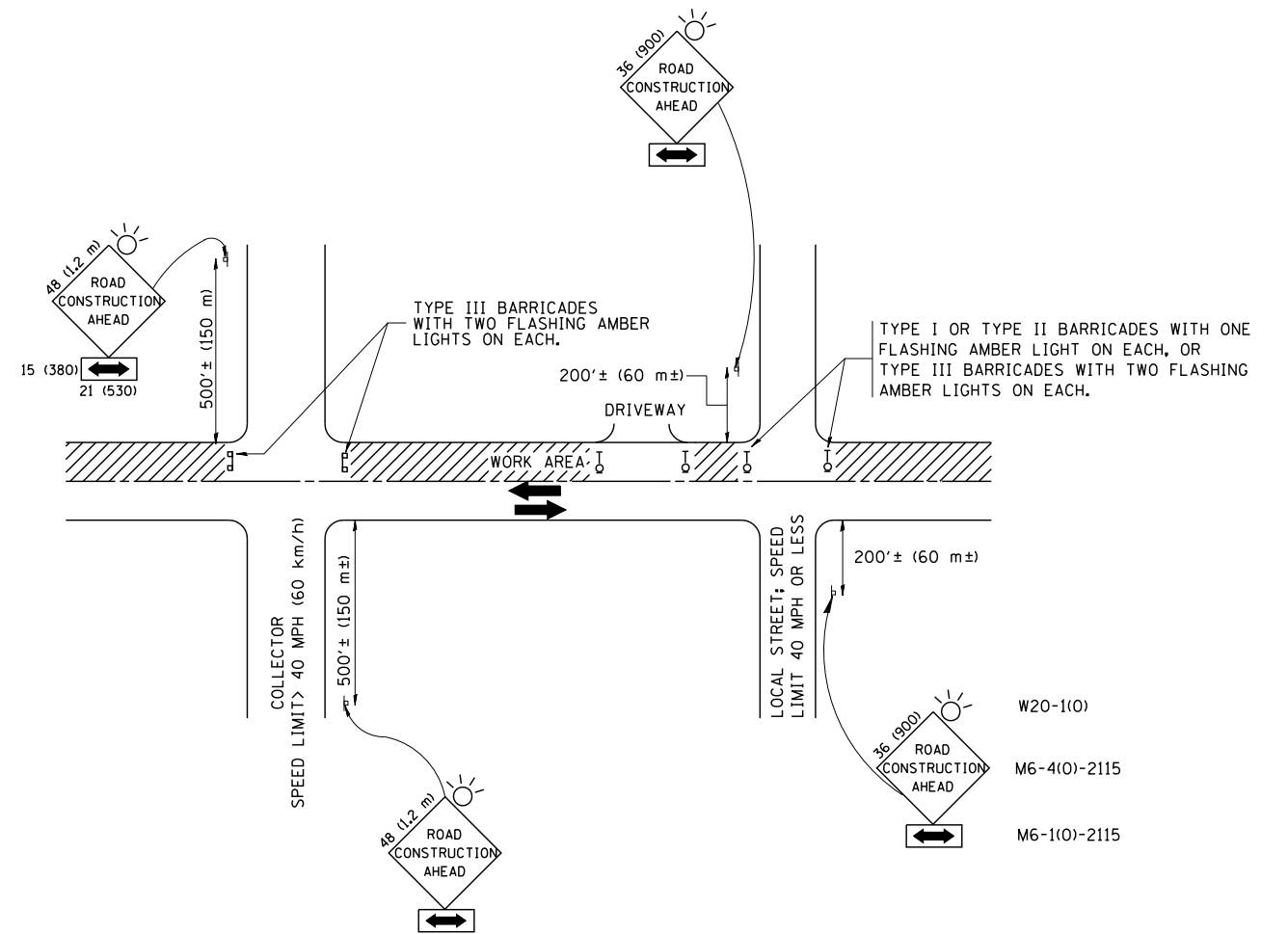

TRAFFIC CONTROL AND PROTECTION FOR SIDE ROADS, INTERSECTIONS, AND DRIVEWAYS

NOTES:

- A. FOR NO LANE RESTRICTION ON THE SIDE ROAD OR DRIVEWAYS
- SIDE ROAD WITH A SPEED LIMIT OF 40 MPH (60 km/h) OR LESS AS SHOWN ON THE DRAWING AND AS DIRECTED BY THE ENGINEER:
 - ONE **ROAD CONSTRUCTION AHEAD** SIGN 36 x 36 (900x900) WITH A FLASHER AND FLAG MOUNTED ON IT APPROXIMATELY 200' (60 m) IN ADVANCE OF THE MAIN ROUTE.
 - THE CLOSED PORTION OF THE MAIN ROUTE SHALL BE PROTECTED BY BLOCKING WITH TYPE I, TYPE II OR TYPE III BARRICADES, 1/3 OF THE CROSS SECTION OF THE CLOSED PORTION.
 - SIDE ROAD WITH A SPEED LIMIT GREATER THAN 40 MPH (60 km/h) AS SHOWN ON THE DRAWING AND AS DIRECTED BY THE ENGINEER:
 - ONE **ROAD CONSTRUCTION AHEAD** SIGN 48 x 48 (1.2 m x 1.2 m) WITH A FLASHER MOUNTED ON IT APPROXIMATELY 500' (150 m) IN ADVANCE OF THE MAIN ROUTE.
 - THE CLOSED PORTION OF THE MAIN ROUTE SHALL BE PROTECTED BY BLOCKING WITH TYPE III BARRICADES, 1/2 OF THE CROSS SECTION OF THE CLOSED PORTION.
3. WHEN THE SIDE ROAD LIES BETWEEN THE BEGINNING OF THE MAINLINE SIGNING AND THE WORK ZONE, A SINGLE HEADED ARROW (M6-1) SHALL BE USED IN LIEU OF THE DOUBLE HEADED ARROW (M6-4).
- B. FOR A LANE CLOSURE ON A SIDE ROAD OR DRIVEWAY:
- USE APPLICABLE PORTIONS OF THE TYPICAL APPLICATION OF TRAFFIC CONTROL DEVICES (STD. 701501, STD. 701606 OR THE APPROPRIATE STANDARD). THE SPACING OF SIGNS AND BARRICADES SHALL BE ADJUSTED FOR FIELD CONDITIONS AS DIRECTED BY THE ENGINEER. THE DIRECTIONAL ARROW SHALL BE COVERED OR REMOVED WHEN NO LONGER CONSISTENT WITH THE SIDE ROAD LANE CLOSURE.
- C. ADVANCE WARNING SIGNS ARE TO BE OMITTED ON DRIVEWAY UNLESS OTHERWISE NOTED.
- D. THE TRAFFIC CONTROL AND PROTECTION FOR SIDE ROADS, INTERSECTIONS, AND DRIVEWAYS SHALL BE INCIDENTAL TO THE COST OF SPECIFIED TRAFFIC CONTROL STANDARDS OR ITEMS.

All dimensions are in millimeters (inches) unless otherwise shown.

FILE NAME = W:\diststd\22x34\tc10.dgn	USER NAME = gegl10nbt	DESIGNED - LHA	REVISED - J. OBERLE 10-18-95
		DRAWN -	REVISED - A. HOUSEH 03-06-96
	PLOT SCALE = 50.000' / IN.	CHECKED -	REVISED - A. HOUSEH 10-15-96
	PLOT DATE = 1/4/2008	DATE - 06-89	REVISED - T. RAMMACH 01-06-00

STATE OF ILLINOIS
DEPARTMENT OF TRANSPORTATION

TRAFFIC CONTROL AND PROTECTION FOR
SIDE ROADS, INTERSECTIONS, AND DRIVEWAYS

SCALE: NONE SHEET NO. 1 OF 1 SHEETS STA. TO STA.

F.A.P. RTE.	SECTION	COUNTY	TOTAL SHEETS	SHEET NO.
335	(105&120) RS-8	McHENRY	21	16
TC-10			CONTRACT NO. 60Y59	
FED. ROAD DIST. NO. 1 ILLINOIS FED. AID PROJECT				

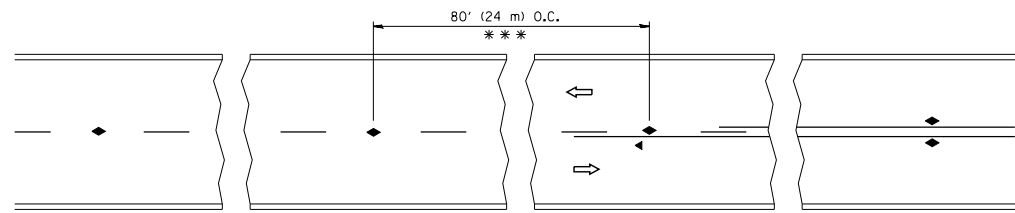

*** REDUCE TO 40' (12 m) O.C. ON CURVES WITH POSTED OR ADVISORY SPEED 45 M.P.H. (70 km/h) OR LESS.

TWO-LANE/TWO-WAY

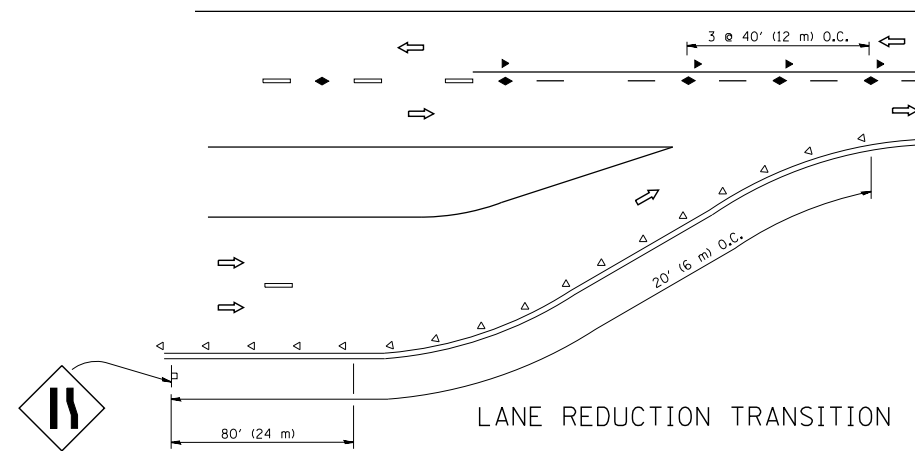

LANE REDUCTION TRANSITION

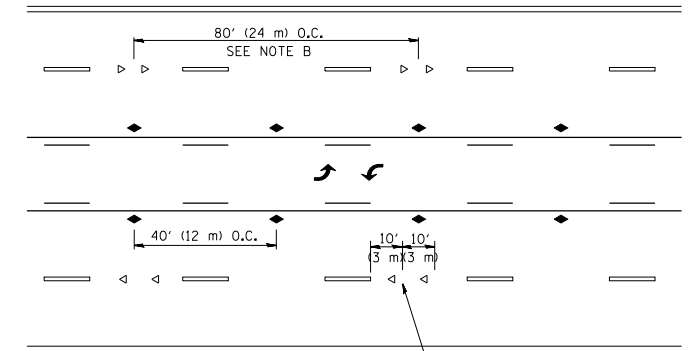

TWO-WAY LEFT TURN

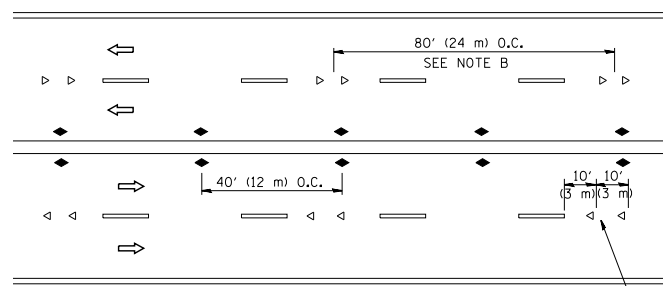

MULTI-LANE/UNDIVIDED

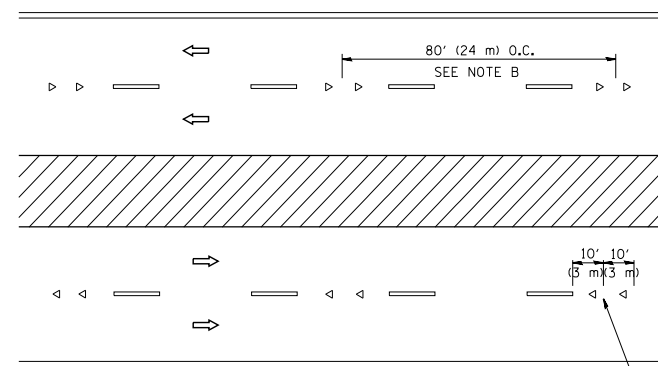

MULTI-LANE/DIVIDED

GENERAL NOTES

1. MARKERS USED WITH DASHED LINES SHALL BE CENTERED IN THE GAP BETWEEN SEGMENTS.
2. MARKERS USED ADJACENT TO SOLID LINES SHALL BE OFFSET 2 TO 3 (50 TO 75) TOWARD TRAFFIC AS SHOWN.
3. MARKERS THROUGH TANGENTS LESS THAN 500' (150 m) IN LENGTH BETWEEN CURVES SHALL BE INSTALLED AT THE LESSER OF THE TWO CURVE SPACINGS.

SYMBOLS

- YELLOW STRIPE
- WHITE STRIPE
- ◀ ONE-WAY AMBER MARKER
- ◁ ONE-WAY CRYSTAL MARKER (W/O)
- ◆ TWO-WAY AMBER MARKER

LANE MARKER NOTES

- A. USE DOUBLE LANE LINE MARKERS SPACED AS SHOWN.
- B. REDUCE TO 40' (12 m) O.C. ON CURVES WHERE ADVISORY SPEEDS ARE 10 M.P.H (20 km/h) LOWER THAN POSTED SPEEDS.

DESIGN NOTES

1. DOUBLE LANE LINE MARKERS SHALL BE USED UNLESS SPECIFIED OTHERWISE.
2. EXCEPT AS SHOWN ON THE LANE REDUCTION TRANSITION AND FREEWAY EXIT RAMP DETAIL, MARKERS ARE NOT TO BE SPECIFIED ON RIGHT EDGE LINES.
3. THE EXACT MARKER LIMITS, SPACING, AND COLOR SHALL BE INCLUDED IN THE PLANS WHEN STANDARD SPECIFICATIONS ARE NOT BEING USED.
4. MARKERS SHOULD NOT BE USED ALONGSIDE CURBS EXCEPT FOR EXTREMELY SHORT SECTIONS OF CURBS WHERE NOT MORE THAN TWO MARKERS WOULD BE INVOLVED.

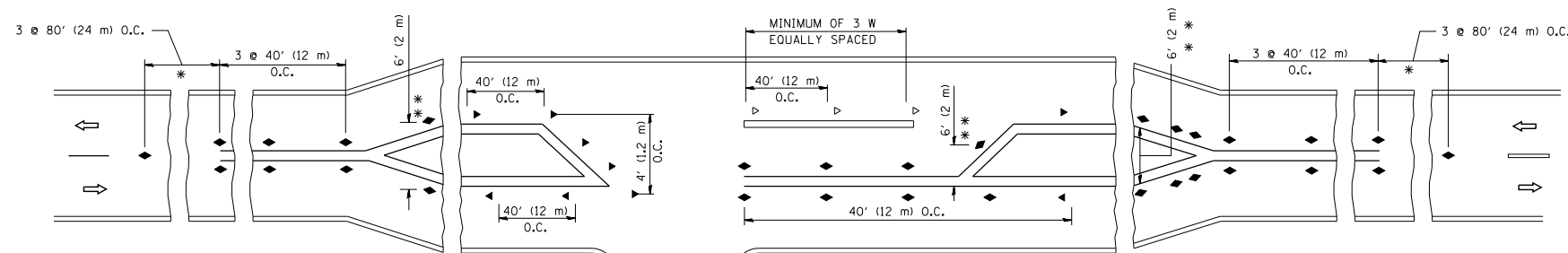

LEFT TURN

* SEE TWO-LANE/TWO-WAY WHERE MARKERS CONTINUE
 ** WHERE THE MEDIAN WIDTH IS 6' (2 m) OR LESS USE TWO-WAY MARKERS.

All dimensions are in inches (millimeters) unless otherwise shown.

FILE NAME =	USER NAME = lryso	DESIGNED -	REVISED - T. RAMMACHER 09-19-94
ct:\pw\work\p\dot\lryso\d0108315\l1.dgn		DRAWN -	REVISED - T. RAMMACHER 03-12-99
	PLOT SCALE = 50.000' / IN.	CHECKED -	REVISED - T. RAMMACHER 01-06-00
	PLOT DATE = 3/2/2011	DATE -	REVISED - C. JUCIUS 09-09-09

STATE OF ILLINOIS
 DEPARTMENT OF TRANSPORTATION

TYPICAL APPLICATIONS
 RAISED REFLECTIVE PAVEMENT MARKERS (SNOW-PLOW RESISTANT)

SCALE: NONE SHEET NO. 1 OF 1 SHEETS STA. TO STA.

F.A.P. RTE.	SECTION	COUNTY	TOTAL SHEETS	SHEET NO.
335	(105&120)RS-8	McHENRY	21	17
TC-11		CONTRACT NO. 60Y59		
FED. ROAD DIST. NO. 1 ILLINOIS FED. AID PROJECT				

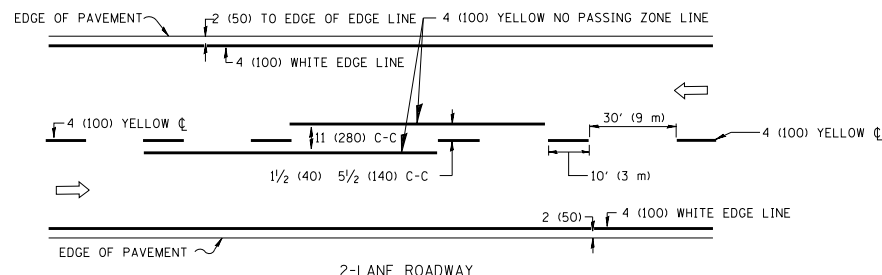

2-LANE ROADWAY

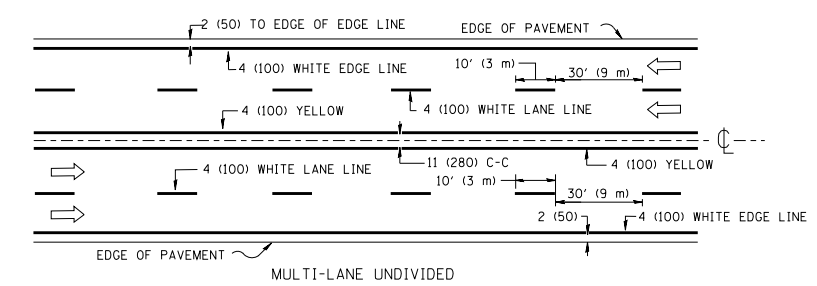

MULTI-LANE UNDIVIDED

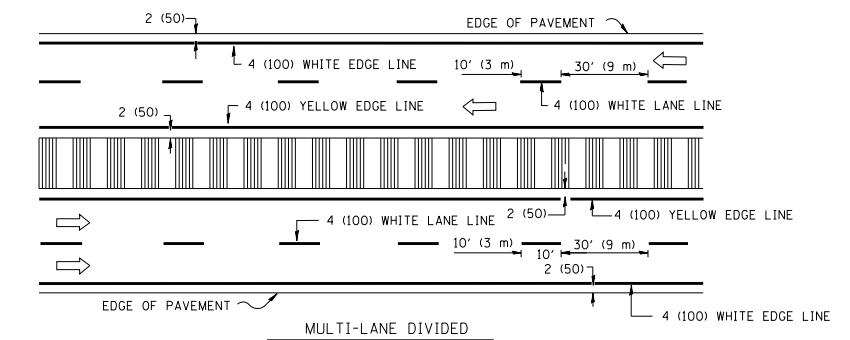

MULTI-LANE DIVIDED WITH MOUNTABLE MEDIAN

NOTE: MEDIANS WITH BARRIER CURB DO NOT REQUIRE AN EDGE LINE

TYPICAL LANE AND EDGE LINE MARKING

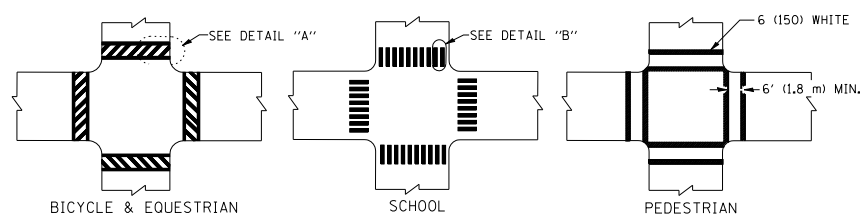

TYPICAL CROSSWALK MARKING

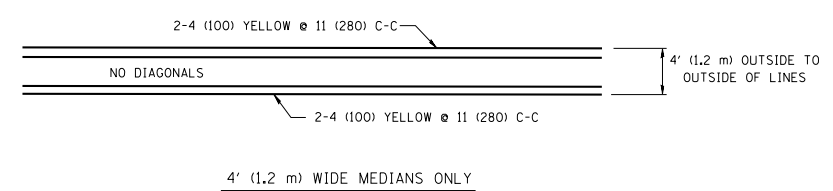

4' (1.2 m) WIDE MEDIANS ONLY

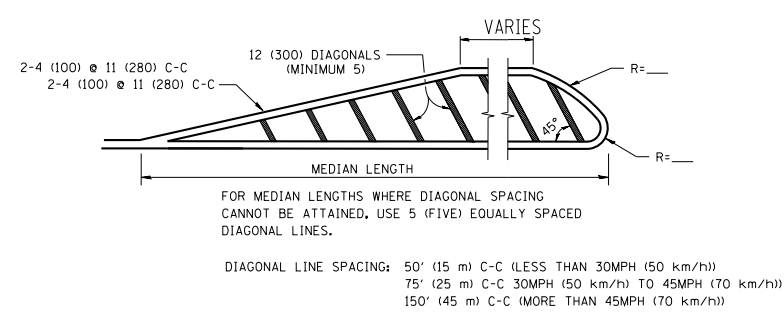

MEDIANS OVER 4' (1.2 m) WIDE

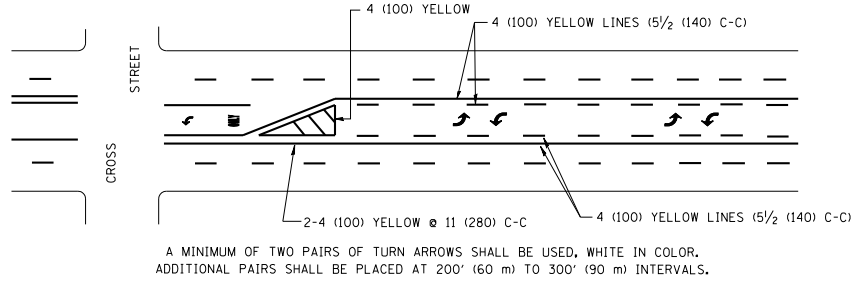

TYPICAL PAINTED MEDIAN MARKING

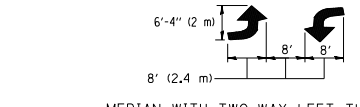

MEDIAN WITH TWO-WAY LEFT TURN LANE

TYPICAL LEFT (OR RIGHT) TURN LANE

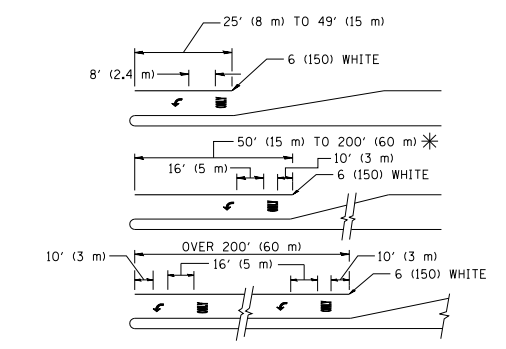

TYPICAL TURN LANE MARKING

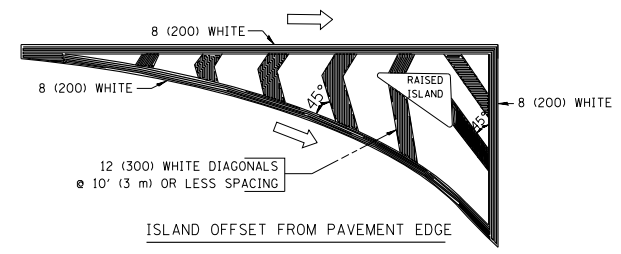

ISLAND OFFSET FROM PAVEMENT EDGE

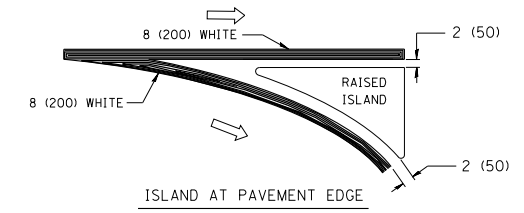

ISLAND AT PAVEMENT EDGE

TYPICAL ISLAND MARKING

TYPE OF MARKING	WIDTH OF LINE	PATTERN	COLOR	SPACING / REMARKS
CENTERLINE ON 2 LANE PAVEMENT	4 (100)	SKIP-DASH	YELLOW	10' (3 m) LINE WITH 30' (9 m) SPACE
CENTERLINE ON MULTI-LANE UNDIVIDED PAVEMENT	2 @ 4 (100)	SOLID	YELLOW	11 (280) C-C
NO PASSING ZONE LINES: FOR ONE DIRECTION	4 (100)	SOLID	YELLOW	5/2 (140) C-C FROM SKIP-DASH CENTERLINE
NO PASSING ZONE LINES: FOR BOTH DIRECTIONS	2 @ 4 (100)	SOLID	YELLOW	11 (280) C-C OMIT SKIP-DASH CENTERLINE BETWEEN
LANE LINES	4 (100) 5 (125) ON FREEWAYS	SKIP-DASH SKIP-DASH	WHITE WHITE	10' (3 m) LINE WITH 30' (9 m) SPACE
DOTTED LINES (EXTENSIONS OF CENTER, LANE OR TURN LANE MARKINGS)	SAME AS LINE BEING EXTENDED	SKIP-DASH	SAME AS LINE BEING EXTENDED	2' (600) LINE WITH 6' (1.8 m) SPACE
EDGE LINES	4 (100)	SOLID	YELLOW-LEFT WHITE-RIGHT	OUTLINE MOUNTABLE MEDIANS IN YELLOW; EDGE LINES ARE NOT USED NEXT TO BARRIER CURB
TURN LANE MARKINGS	6 (150) LINE; FULL SIZE LETTERS & SYMBOLS (8' (2.4m))	SOLID	WHITE	SEE TYPICAL TURN LANE MARKING DETAIL
TWO WAY LEFT TURN MARKING	2 @ 4 (100) EACH DIRECTION	SKIP-DASH AND SOLID	YELLOW	10' (3 m) LINE WITH 30' (9 m) SPACE FOR SKIP-DASH; 5/2 (140) C-C BETWEEN SOLID LINE AND SKIP-DASH LINE
	8' (2.4m) LEFT ARROW	IN PAIRS	WHITE	SEE TYPICAL TWO-WAY LEFT TURN MARKING DETAIL
CROSSWALK LINES (PEDESTRIAN) A. DIAGONALS (BIKE & EQUESTRIAN) B. LONGITUDINAL BARS (SCHOOL)	2 @ 6 (150) 12 (300) @ 45° 12 (300) @ 90°	SOLID SOLID SOLID	WHITE WHITE WHITE	NOT LESS THAN 6' (1.8 m) APART 2' (600) APART 2' (600) APART SEE TYPICAL CROSSWALK MARKING DETAILS.
STOP LINES	24 (600)	SOLID	WHITE	PLACE 4' (1.2 m) IN ADVANCE OF AND PARALLEL TO CROSSWALK, IF PRESENT. OTHERWISE, PLACE AT DESIRED STOPPING POINT, PARALLEL TO CROSSROAD CENTERLINE, WHERE POSSIBLE
PAINTED MEDIANS	2 @ 4 (100) WITH 12 (300) DIAGONALS @ 45°	SOLID	YELLOW; TWO WAY TRAFFIC WHITE; ONE WAY TRAFFIC	11 (280) C-C FOR THE DOUBLE LINE SEE TYPICAL PAINTED MEDIAN MARKING.
GORE MARKING AND CHANNELIZING LINES	8 (200) WITH 12 (300) DIAGONALS @ 45°	SOLID	WHITE	DIAGONALS: 15' (4.5 m) C-C (LESS THAN 30MPH (50 km/h)) 20' (6 m) C-C (30MPH (50 km/h) TO 45MPH (70 km/h)) 30' (9 m) C-C (OVER 45MPH (70 km/h))
RAILROAD CROSSING	24 (600) TRANSVERSE LINES; "RR" 15' (4.5 m) LETTERS; 16 (400) LINE FOR "X"	SOLID	WHITE	SEE STATE STANDARD 780001 AREA OF: "R"=3.6 SQ. FT. (0.33 m ²) EACH "X"=54.0 SQ. FT. (5.0 m ²)
SHOULDER DIAGONALS	12 (300) @ 45°	SOLID	WHITE - RIGHT YELLOW - LEFT	50' (15 m) C-C (LESS THAN 30MPH (50 km/h)) 75' (25 m) C-C (30 MPH (50 km/h) TO 45MPH (70 km/h)) 150' (45 m) C-C (OVER 45MPH (70 km/h))

FOR FURTHER DETAILS ON PAVEMENT MARKING REFER TO STANDARD SPECIFICATIONS FOR ROAD AND BRIDGE CONSTRUCTION AND STATE STANDARD 780001.

All dimensions are in inches (millimeters) unless otherwise shown.

FILE NAME =	USER NAME = drivakosgn	DESIGNED - EVERS	REVISED - T. RAMMACHER 10-27-94
ca:\pwork\work\p1dot\drivakosgn\d0108315\to3.dgn		DRAWN -	REVISED - C. JUCIUS 09-09-09
	PLOT SCALE = 50.000' / IN.	CHECKED -	REVISED -
	PLOT DATE = 9/9/2009	DATE - 03-19-90	REVISED -

STATE OF ILLINOIS
DEPARTMENT OF TRANSPORTATION

DISTRICT ONE			
TYPICAL PAVEMENT MARKINGS			
SCALE: NONE	SHEET NO. 1 OF 1 SHEETS	STA.	TO STA.

F.A.P. RTE.	SECTION	COUNTY	TOTAL SHEETS	SHEET NO.
335	(105&120)RS-8	McHENRY	21	18
TC-13		CONTRACT NO. 60Y59		
FED. ROAD DIST. NO. 1 ILLINOIS FED. AID PROJECT				

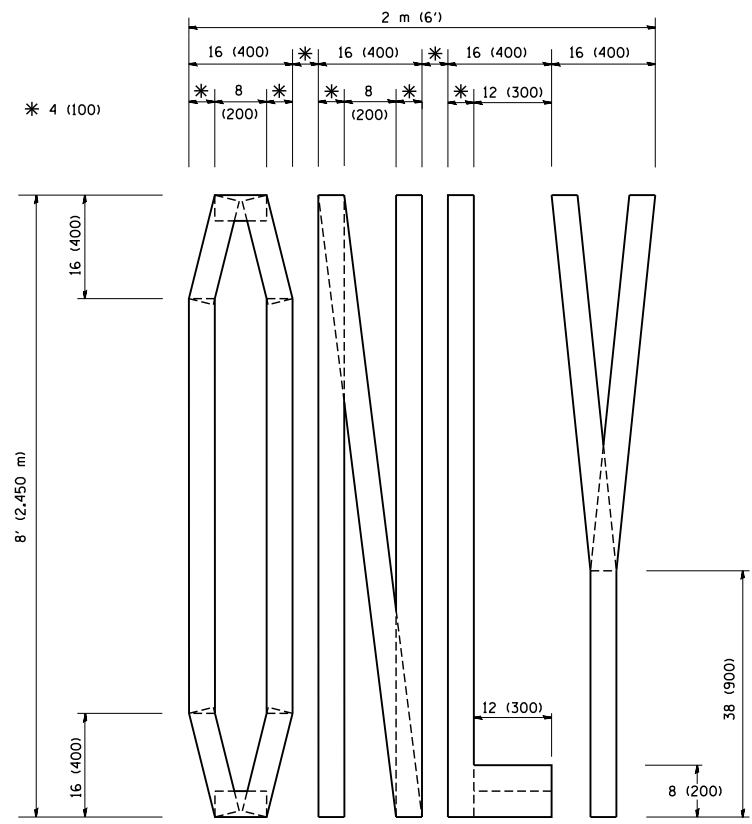

QUANTITY
 4 (100) LINE = 64.1 ft. (19.7 m)
 21.1 sq. ft. (1.97 sq. m)

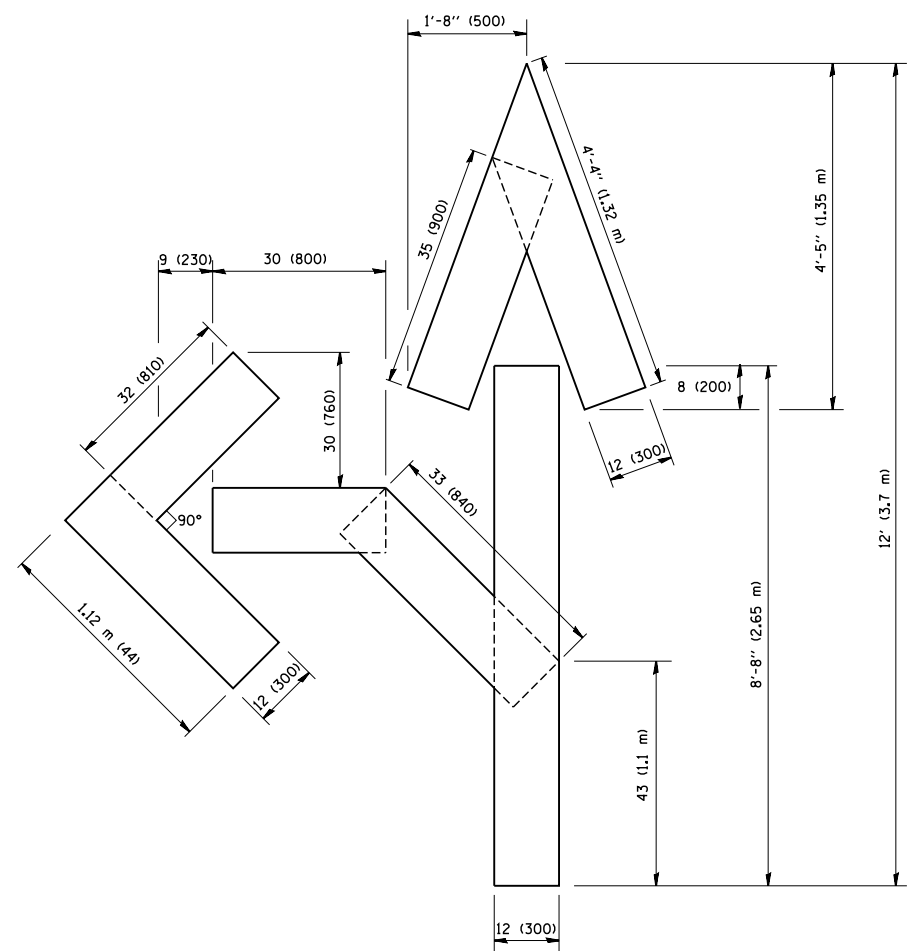

QUANTITY
 4 (100) LINE = 82.5 ft. (25.3 m)
 27.5 sq. ft. (2.53 sq. m)

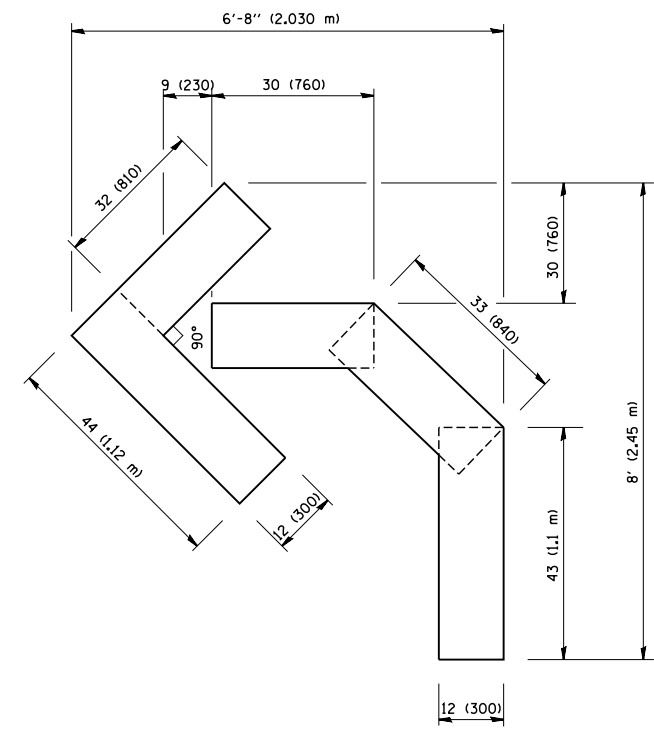

QUANTITY
 4 (100) LINE = 45.5 ft. (13.9 m)
 15.2 sq. ft. (1.39 sq. m)

All dimensions are in inches (millimeters) unless otherwise shown.

FILE NAME = W:\diststd\22x34\c16.dgn	USER NAME = gaglianobt	DESIGNED - DRAWN -	REVISED -T. RAMMACHER 06-05-96 REVISED -T. RAMMACHER 11-04-97
	PLOT SCALE = 50.0000' / IN.	CHECKED -	REVISED -T. RAMMACHER 03-02-98
	PLOT DATE = 1/4/2008	DATE - 09-18-94	REVISED -E. GOMEZ 08-28-00

**STATE OF ILLINOIS
 DEPARTMENT OF TRANSPORTATION**

PAVEMENT MARKING LETTERS AND SYMBOLS FOR TRAFFIC STAGING			
SCALE: NONE	SHEET NO. 1 OF 1 SHEETS	STA.	TO STA.

F.A.P. RTE.	SECTION	COUNTY	TOTAL SHEETS	SHEET NO.
335	(105&120)RS-8	McHENRY	21	20
TC-16			CONTRACT NO. 60Y59	
FED. ROAD DIST. NO. 1 ILLINOIS FED. AID PROJECT				

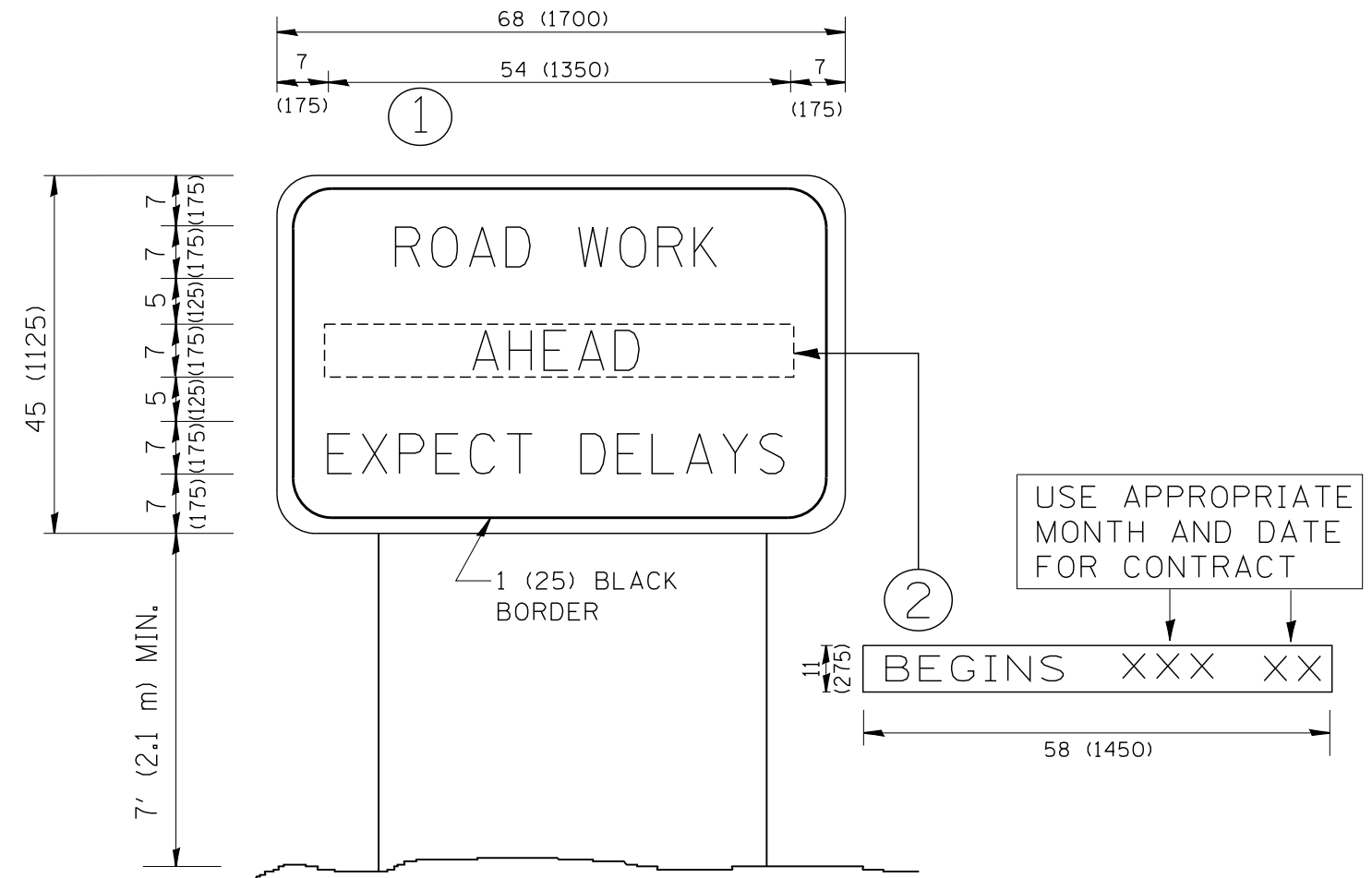

NOTES:

1. USE BLACK LETTERING ON ORANGE BACKGROUND.
2. ERECT SIGNS IN ADVANCE OF THE LOCATION FOR THE "ROAD CONSTRUCTION AHEAD" SIGN AT LOCATIONS AS DIRECTED BY THE ENGINEER.
3. ERECT SIGN ① WITH INSTALLED PANEL ② ONE WEEK PRIOR TO THE START OF CONSTRUCTION.
4. REMOVE PANEL ② SOON AFTER THE START OF CONSTRUCTION.
5. SEE SPECIAL PROVISION FOR "TEMPORARY INFORMATION SIGNING" FOR ADDITIONAL INFORMATION.
6. ONE SIGN ASSEMBLY EQUALS 25.70 SQ. FT. (2.3 SQ. M.)
7. SHALL BE PAID FOR AS TEMPORARY INFORMATION SIGNING.

ALL DIMENSIONS ARE IN INCHES (MILLIMETERS) UNLESS OTHERWISE SHOWN.

FILE NAME = W:\diststd\22x34\tc22.dgn	USER NAME = gegltonbt	DESIGNED - DRAWN -	REVISED - R. MIRS 09-15-97 REVISED - R. MIRS 12-11-97	STATE OF ILLINOIS DEPARTMENT OF TRANSPORTATION	ARTERIAL ROAD INFORMATION SIGN			F.A.P. RTE. 335	SECTION (105&120)RS-8	COUNTY McHENRY	TOTAL SHEETS 21	SHEET NO. 21
	PLOT SCALE = 50.000' / IN.	CHECKED -	REVISED - T. RAMMACHER 02-02-99		SCALE: NONE	SHEET NO. 1 OF 1 SHEETS	STA.	TO STA.	TC-22		CONTRACT NO. 60Y59	
	PLOT DATE = 1/4/2008	DATE -	REVISED - C. JUCIUS 01-31-07		FED. ROAD DIST. NO. 1 ILLINOIS FED. AID PROJECT							