

**NOTE:**

1. GROOVING SHALL NOT BE ALLOWED ON STRUCTURES' CONCRETE DECK.
2. MODIFIED URETHANE PAVEMENT MARKING - LINE 5" SHALL BE USED FOR SKIP DASHES AND EDGE LINES ON STRUCTURES' CONCRETE DECK.

PAVEMENT MARKING LEGEND		
①	MODIFIED URETHANE PAVEMENT MARKING - LINE 5"	(SOLID WHITE LINE)
②	MODIFIED URETHANE PAVEMENT MARKING - LINE 5"	(SOLID YELLOW LINE)
③	MODIFIED URETHANE PAVEMENT MARKING - LINE 5"	(WHITE SKIP-DASH)
④	PREFORMED PLASTIC PAVEMENT MARKING, TYPE B - INLAID - LINE 5"	(WHITE SKIP-DASH)
⑤	PREFORMED PLASTIC PAVEMENT MARKING, TYPE B - INLAID - LINE 5"	(WHITE SHORT-DASH)
⑥	PREFORMED PLASTIC PAVEMENT MARKING, TYPE B - INLAID - LINE 8"	(SOLID WHITE LINE)
⑦	PREFORMED PLASTIC PAVEMENT MARKING, TYPE B - INLAID - LINE 12"	(SOLID WHITE LINE)
⑧	PREFORMED PLASTIC PAVEMENT MARKING, TYPE B - INLAID - LINE 24"	(SOLID WHITE LINE)
⑨	PREFORMED PLASTIC PAVEMENT MARKING, TYPE B - INLAID - LINE 24"	(SOLID YELLOW LINE)
⑩	PREFORMED PLASTIC PAVEMENT MARKING, TYPE B - INLAID - LETTERS & SYMBOLS	
⑪	GROOVING FOR RECESSED PAVEMENT MARKING 6"	

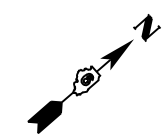
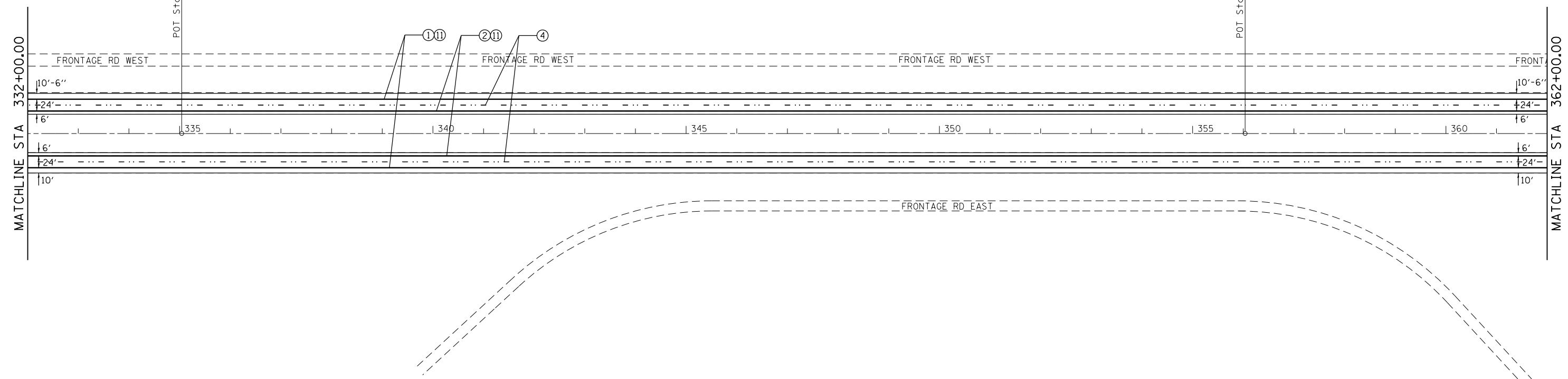

FILE NAME =	USER NAME = sparksgw	DESIGNED -	REVISED -	<b>STATE OF ILLINOIS DEPARTMENT OF TRANSPORTATION</b>	<b>F.A.I. ROUTE 55 PAVEMENT MARKING PLAN SHEET</b>	F.A.I. RTE.	SECTION	COUNTY	TOTAL SHEETS	SHEET NO.	
		DRAWN -	REVISED -					**	LOGAN	108	81
		CHECKED -	REVISED -			CONTRACT NO. 72D41					
Default	PLOT DATE = Jul-14-2014 03:37:47PM	DATE -	REVISED -			ILLINOIS FED. AID PROJECT					