

**WEST EDGE OF SHOULDER**

Location	Station	Offset	Theoretical Grade Elevations
S. End S. Appr. Slab	899+31.90	-16.50	677.05
A	899+41.90	-16.50	677.09
B	899+51.90	-16.50	677.12
N. End S. Appr. Slab	899+61.90	-16.50	677.17

**WEST EDGE OF PAVEMENT**

Location	Station	Offset	Theoretical Grade Elevations
S. End S. Appr. Slab	899+30.68	-12.00	677.14
A	899+40.68	-12.00	677.17
B	899+50.68	-12.00	677.21
N. End S. Appr. Slab	899+60.68	-12.00	677.25

**ROADWAY, PROFILE GRADE LINE & STAGE CONSTRUCTION JOINT**

Location	Station	Offset	Theoretical Grade Elevations
S. End S. Appr. Slab	899+27.48	0.00	677.32
A	899+37.48	0.00	677.35
B	899+47.48	0.00	677.39
N. End S. Appr. Slab	899+57.48	0.00	677.43

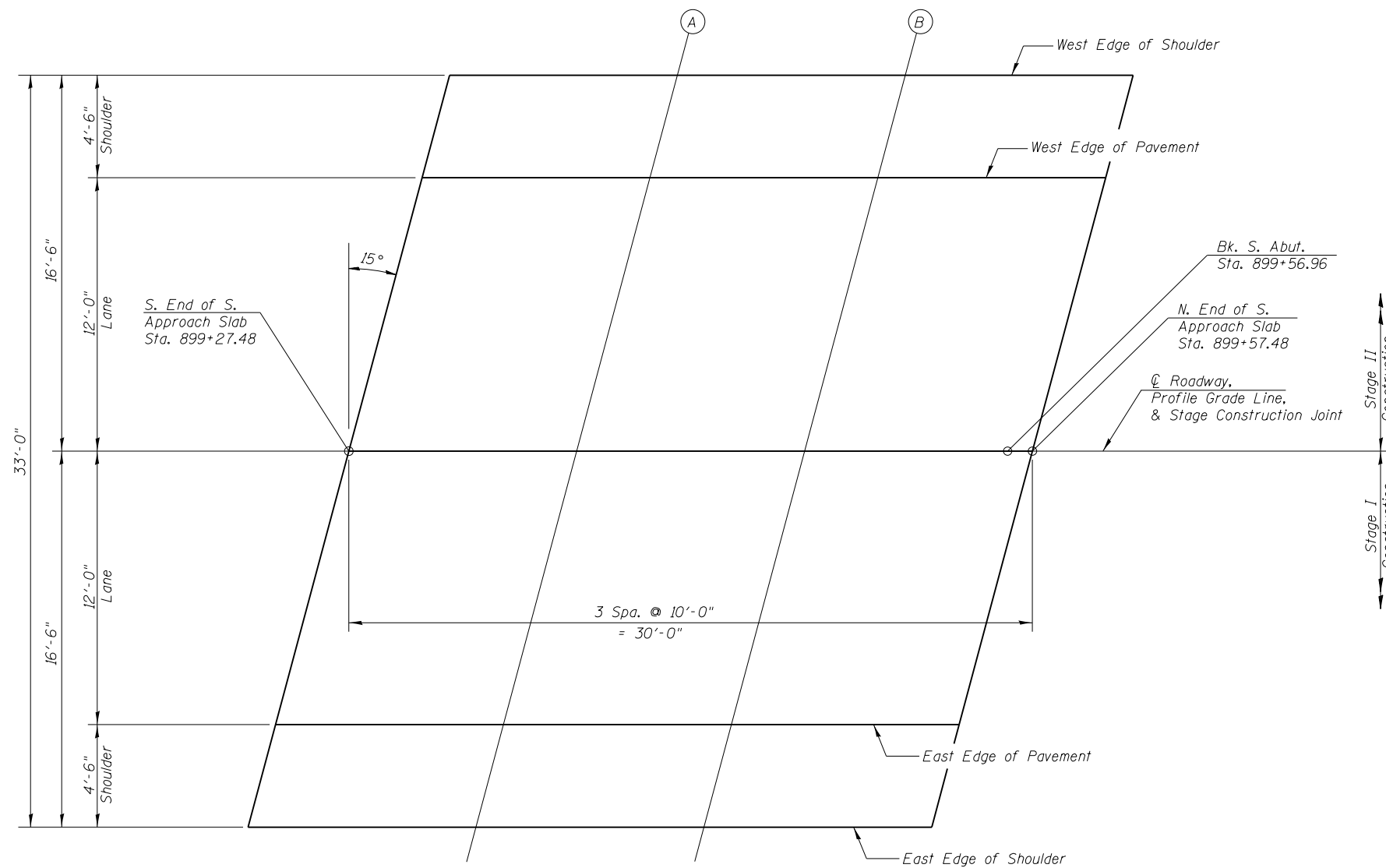

**PLAN - SOUTH APPROACH**

**EAST EDGE OF PAVEMENT**

Location	Station	Offset	Theoretical Grade Elevations
S. End S. Appr. Slab	899+24.28	12.00	677.12
A	899+34.28	12.00	677.15
B	899+44.28	12.00	677.18
N. End S. Appr. Slab	899+54.28	12.00	677.22

**EAST EDGE OF SHOULDER**

Location	Station	Offset	Theoretical Grade Elevations
S. End S. Appr. Slab	899+23.06	16.50	677.03
A	899+33.06	16.50	677.06
B	899+43.06	16.50	677.09
N. End S. Appr. Slab	899+53.06	16.50	677.13

E-AS

7-1-10

**CEC** Cummins Engineering Corporation  
Civil and Structural Engineering

JOB = 2223.7  
FILE = 0150065-74167-07-08-TopofApproach.dgn  
DATE = 7/24/2014

DESIGNED - AAN  
CHECKED - MDC  
DRAWN - SJS  
CHECKED - MDC

REVISED -  
REVISED -  
REVISED -  
REVISED -

**STATE OF ILLINOIS  
DEPARTMENT OF TRANSPORTATION**

**TOP OF SOUTH APPROACH SLAB ELEVATIONS  
STRUCTURE NO. 015-0065**

SHEET NO. 7 OF 17 SHEETS

F.A.S. RTE.	SECTION	COUNTY	TOTAL SHEETS	SHEET NO.
673	2BR	COLES	24	14
CONTRACT NO. 74167				

ILLINOIS FED. AID PROJECT