

STATE OF ILLINOIS  
DEPARTMENT OF TRANSPORTATION  
DIVISION OF HIGHWAYS

**PROPOSED  
HIGHWAY PLANS**

FAU 8379 (US RTE 45)

SECTION (12R)N

PROJECT: AC M-8379(001)

RESURFACING AND RIGHT TURN LANE  
EFFINGHAM COUNTY

C-97-001-08

F.A.U. RTE.	SECTION	COUNTY	TOTAL SHEETS	SHEET NO.
8379	12R(N)	Effingham	36	1
ILLINOIS CONTRACT NO. 74282				

FOR INDEX OF SHEETS, SEE SHEET NO. 2

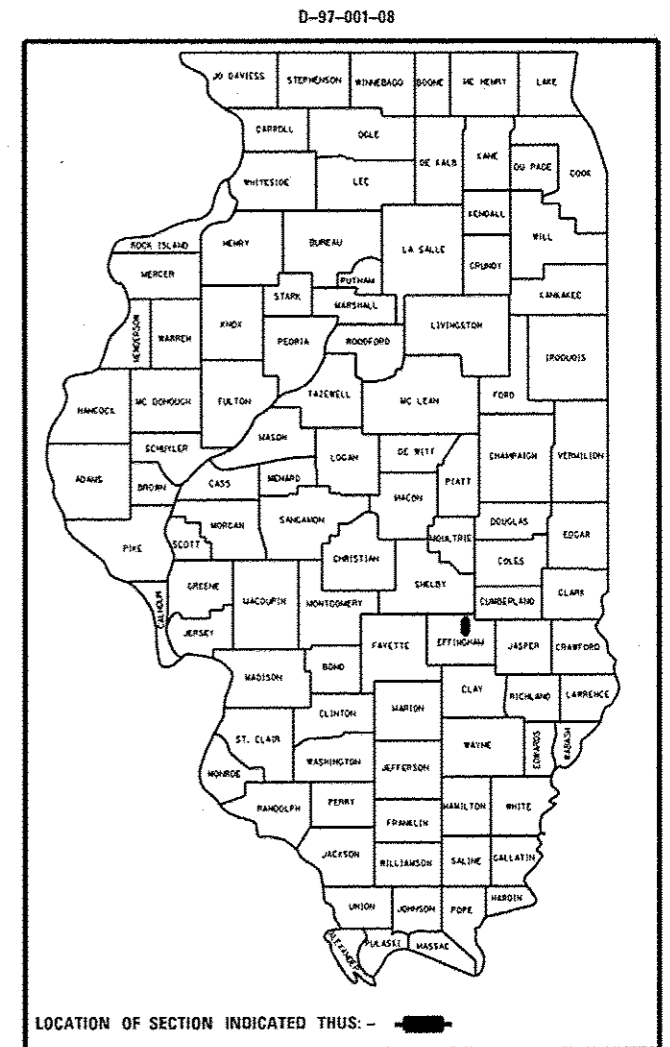

ADT 2009 = 12,000

LOCATION OF PROPOSED IMPROVEMENT

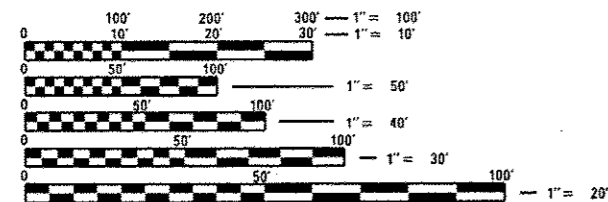

FULL SIZE PLANS HAVE BEEN PREPARED USING STANDARD ENGINEERING SCALES. REDUCED SIZED PLANS WILL NOT CONFORM TO STANDARD SCALES. IN MAKING MEASUREMENTS ON REDUCED PLANS, THE ABOVE SCALES MAY BE USED.

J.U.L.I.E.  
JOINT UTILITY LOCATION INFORMATION FOR EXCAVATION  
1-800-892-0123  
OR 811

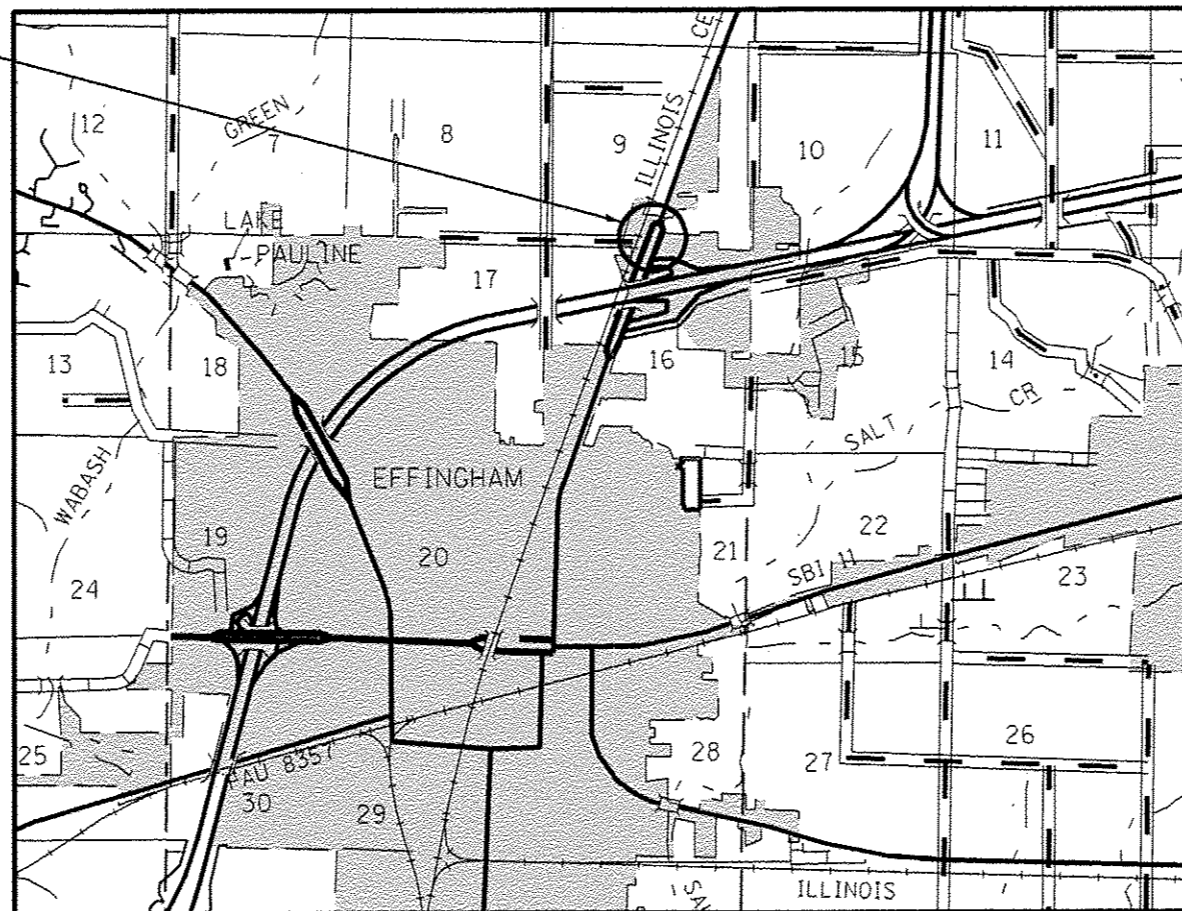

GROSS LENGTH = 1,045 FT. = 0.2 MILE  
NET LENGTH = 1,045 FT. = 0.2 MILE

PROJECT ENGINEER: MARK DAUGHERTY  
PROJECT MANAGER: BRIAN LEWIS

CONTRACT NO. 74282

STATE OF ILLINOIS  
DEPARTMENT OF TRANSPORTATION  
DIVISION OF HIGHWAYS

SUBMITTED May 07 20 14  
Roger L. Dinkel  
DEPUTY DIRECTOR OF HIGHWAYS, REGION ENGINEER

June 27 20 14  
John D. Baranec, P.E./pc  
ENGINEER OF DESIGN AND ENVIRONMENT

June 27 20 14  
Omer Osman, P.E./pc  
DIRECTOR OF HIGHWAYS, CHIEF ENGINEER

PRINTED BY THE AUTHORITY  
OF THE STATE OF ILLINOIS

**GENERAL NOTES**

THIS SECTION SHALL BE CONSTRUCTED IN ACCORDANCE WITH THE PLANS, THE "STANDARD SPECIFICATIONS FOR ROAD AND BRIDGE CONSTRUCTION" ADOPTED JANUARY 1, 2012, THE "SUPPLEMENTAL SPECIFICATIONS AND RECURRING SPECIAL PROVISIONS" INDICATED ON THE CHECK SHEET, AND THE SPECIAL PROVISIONS INCLUDED IN THE PROPOSAL.

THE WORK INCLUDED IN THIS SECTION CONSISTS OF CONSTRUCTION OF PCC PAVEMENT, CURB & GUTTER, STORM SEWER, HMA SURFACE REMOVAL, HMA SURFACE COURSE, THERMOPLASTIC PAVEMENT MARKING, AND ANY OTHER WORK NECESSARY TO COMPLETE THIS SECTION.

SHORT TERM PAVEMENT MARKING ON THE MILLED SURFACE SHALL BE PAINT. ALL OTHER SHORT TERM PAVEMENT MARKINGS SHALL BE TAPE.

COST OF REMOVAL OF ALL FOUNDATIONS, POSTS, PARKING BLOCKS, VALVE VAULTS, CASTINGS, ETC. WITHIN THE LIMITS OF THE AREAS OF DRIVEWAY PAVEMENT REMOVAL SHALL BE INCLUDED IN THE BID PRICE FOR DRIVEWAY PAVEMENT REMOVAL.

THE WORK IN THIS CONTRACT ABUTS WORK ON ANOTHER CONTRACT CURRENTLY IN PROGRESS. THE CONTRACTOR SHALL COORDINATE CONSTRUCTION ACTIVITIES WITH THE CONTRACTOR PERFORMING THE WORK ON THE ABUTTING PROJECT. SEE ARTICLE 105.08 OF THE STANDARD SPECIFICATIONS.

STORM SEWER TEES WILL NOT BE PAID FOR SEPARATELY BUT WILL BE MEASURED IN PLACE SAME AS REGULAR STORM SEWER AND NO ADDITIONAL COMPENSATION WILL BE ALLOWED.

THE SIDEWALK SHALL BE CONSTRUCTED AT THE LOCATIONS SHOWN IN ORDER TO ALLOW FOR THE CONSTRUCTION OF A FUTURE MULTI-USE PATH. LIMITS OF ADDITIONAL SIDEWALK WIDTH FOR FUTURE CONSTRUCTION ARE ALSO SHOWN ON THE PLANS USING DASHED LINES.

CURB REMOVAL IS FOR THE PURPOSE OF ENLARGING THE OPENING FOR THE PROPOSED SIDEWALK RAMP IN THE NORTHEAST QUADRANT OF THE RICKELMAN AND US 45 INTERSECTION TO THE WIDTH OF FIVE FEET. THIS WORK SHALL BE ACCOMPLISHED BY SAWING, CHIPPING AND GRINDING OF THE EXISTING CURB AND SHALL BE PERFORMED SO THAT THE RESULTING SURFACE OF THE REMAINING CONCRETE IS REASONABLY SMOOTH.

ALL DISTURBED AREAS WITHIN THE CONSTRUCTION LIMITS SHALL BE FERTILIZED AND SEEDED. SEEDING SHALL BE CLASS 2 (SPECIAL) IN ACCORDANCE WITH THE SPECIAL PROVISIONS AND THE APPLICABLE ARTICLES OF SECTION 250 OF THE STANDARD SPECIFICATIONS.

THE LOCATIONS AND/OR DEPTHS OF UNDERGROUND UTILITIES SHOWN HAVE BEEN TAKEN FROM INFORMATION FURNISHED BY THE UTILITY OWNERS AND MUST BE CONSIDERED APPROXIMATE. FIELD MARKINGS OF UTILITIES IN CRITICAL AREAS MAY BE OBTAINED BY PROVIDING A MINIMUM OF 96 HOURS ADVANCE NOTICE THROUGH THE J.U.L.I.E. SYSTEM BY CALLING 800-892-0123.

RIGHT-OF-WAY MARKERS SHALL BE ERECTED WITH THE BACK FACE OF THE MARKER ON THE RIGHT-OF-WAY LINE UNLESS THE NEW RIGHT-OF-WAY LINE HAS BEEN SURVEYED AND PINNED, IN WHICH INSTANCE THE RIGHT-OF-WAY MARKER WILL BE ERECTED 12 INCHES INSIDE THE NEW RIGHT-OF-WAY LINE.

THE CONTRACTOR SHALL PROVIDE INTERNET ACCESS TO THE BITUMINOUS PLANT QUALITY CONTROL LAB SO THAT BITUMINOUS PLANT REPORTS CAN BE E-MAILED TO THE DISTRICT HEADQUARTERS. THIS WORK WILL NOT BE PAID FOR SEPARATELY BUT SHALL BE INCLUDED IN THE UNIT PRICES FOR OTHER ITEMS IN THE CONTRACT.

THE RESIDENT ENGINEER SHALL BE THE SOLE JUDGE CONCERNING THE CURING TIME FOR THE BITUMINOUS SURFACE COURSE.

COST OF REMOVAL OF TEMPORARY RAMP SHALL BE INCLUDED IN THE UNIT PRICE FOR TEMPORARY RAMP.

RUBBER TIERED ROLLERS SHALL NOT BE USED ON THIS PROJECT.

THE FOLLOWING MIXTURE REQUIREMENTS ARE APPLICABLE TO THIS PROJECT:

APPLICATION	AC/PG	DESIGN AIR VOIDS	MIXTURE COMPOSITION	FRICTION AGGREGATE
POLYMERIZED BIT CONC SURFACE COURSE MIX "D" N90	SBS PG 76-22	4.0% @ N=90	IL - 9.5	MIXTURE D

**INDEX OF SHEETS**

SHEET NO	TITLE
1	COVER SHEET
2	GENERAL NOTES, INDEX OF SHEETS
3-6	SUMMARY OF QUANTITIES
7-8	TYPICAL SECTIONS
9	REMOVAL ITEMS
10	QUANTITY SCHEDULES
11-12	PLAN AND PROFILE SHEETS
13	STORM SEWER DETAILS
14	RIGHT OF WAY PLANS
15-19	PAVEMENT MARKING DETAILS
20-25	TRAFFIC SIGNAL SHEETS
26	MEDIAN DETAILS
27-36	CROSS SECTIONS

THE FOLLOWING STANDARDS ARE A PART OF THESE PLANS AND ARE INCLUDED FOLLOWING THE LAST NUMBERED SHEET OF THE PLANS.

000001-06	STANDARD SYMBOLS, ABBREVIATIONS, AND PATTERNS
280001-07	TEMPORARY EROSION CONTROL SYSTEMS
420001-07	PAVEMENT JOINTS
420101-04	24' JOINTED PCC PAVEMENT
424006-01	DIAGONAL CURB RAMPS FOR SIDEWALK
542301-03	PRECAST REINFORCED CONCRETE FLARED END SECTION
542606-02	REINFORCED CONCRETE PIPE TEE
602301-04	INLET, TYPE A
602401-03	MANHOLE, TYPE A
602601-03	PRECAST REINFORCED CONCRETE FLAT SLAB TOP
602701-02	MANHOLE STEPS
604001-03	FRAME AND LIDS, TYPE 1
604006-04	FRAME AND GRATE, TYPE 3
606001-05	CONCRETE CURB TYPE B AND COMBINATION CONCRETE CURB AND GUTTER
606006-02	OUTLET FOR CONCRETE CURB AND GUTTER, TYPE B-6.24
606301-04	PC CONCRETE ISLANDS AND MEDIANS
701006-05	OFF-ROAD OPERATIONS, 2L, 2W, 15' TO 24" FROM PAVEMENT EDGE
701502-06	URBAN LANE CLOSURE, 2L 2W, WITH BIDIRECTIONAL LEFT TURN LANE
701701-09	URBAN LANE CLOSURE, MULTILANE INTERSECTION
701901-03	TRAFFIC CONTROL DEVICES
780001-04	TYPICAL PAVEMENT MARKINGS
781001-03	TYPICAL APPLICATIONS RAISED REFLECTIVE PAVEMENT MARKERS
782001	PRISMATIC CURB REFLECTORS
805001-01	ELECTRICAL SERVICE INSTALLATION DETAILS
814001-02	HANDHOLES
876001-03	PEDESTRIAN PUSH BUTTON POST
878001-09	CONCRETE FOUNDATION DETAILS
880006-01	TRAFFIC SIGNAL MOUNTING DETAILS
886001-01	DETECTOR LOOP INSTALLATIONS
886006-01	TYPICAL LAYOUT FOR DETECTION LOOPS

FILE NAME =	USER NAME = stoffenn	DESIGNED -	REVISED -	<b>STATE OF ILLINOIS DEPARTMENT OF TRANSPORTATION</b>	<b>GENERAL NOTES &amp; INDEX OF SHEETS</b>	F.A.U. R.T.E.	SECTION	COUNTY	TOTAL SHEETS	SHEET NO.
c:\pwork\p\10401\steffenn\10107603\07	4282-wt-gannote.dgn	DRAWN -	REVISED -			8379	12RN	Effingham	36	2
Default	PLOT SCALE = 100.0000 / in	CHECKED -	REVISED -			CONTRACT NO. 74282				
	PLOT DATE = 5/9/2014	DATE -	REVISED -			ILLINOIS FED. AID PROJECT				

URBAN

SUMMARY OF QUANTITIES			TOTAL QUANTITIES	CONSTRUCTION TYPE CODE		
CODE NO	ITEM	UNIT		0005 80% FEDERAL 20% STATE	0021 80% FEDERAL 20% STATE	0021 100% CITY
20200100	EARTH EXCAVATION	CU YD	236	236		
20400800	FURNISHED EXCAVATION	CU YD	181	181		
20800150	TRENCH BACKFILL	CU YD	389	389		
21101615	TOPSOIL FURNISH AND PLACE, 4"	SO YD	985	985		
28000500	INLET AND PIPE PROTECTION	EACH	9	9		
30300112	AGGREGATE SUBGRADE IMPROVEMENT 12"	SO YD	718	718		
40600990	TEMPORARY RAMP	SO YD	151	151		
40603545	POLYMERIZED HOT-MIX ASPHALT SURFACE COURSE, MIX "D", N90	TON	460	460		
42000501	PORTLAND CEMENT CONCRETE PAVEMENT 10" (JOINTED)	SO YD	564	564		
42400100	PORTLAND CEMENT CONCRETE SIDEWALK 4 INCH	SO FT	3489	3489		
42400800	DETECTABLE WARNINGS	SO FT	38	38		
44000100	PAVEMENT REMOVAL	SO YD	88	88		
44000155	HOT-MIX ASPHALT SURFACE REMOVAL, 1 1/2"	SO YD	5472	5472		

URBAN

SUMMARY OF QUANTITIES			TOTAL QUANTITIES	CONSTRUCTION TYPE CODE		
CODE NO	ITEM	UNIT		0005 80% FEDERAL 20% STATE	0021 80% FEDERAL 20% STATE	0021 100% CITY
44000200	DRIVEWAY PAVEMENT REMOVAL	SO YD	856	856		
44000300	CURB REMOVAL	FOOT	5	5		
44000500	COMBINATION CURB AND GUTTER REMOVAL	FOOT	666	666		
44000600	SIDEWALK REMOVAL	SO FT	415	415		
44003100	MEDIAN REMOVAL	SO FT	330	330		
44004250	PAVED SHOULDER REMOVAL	SO YD	188	188		
54213660	PRECAST REINFORCED CONCRETE FLARED END SECTIONS 15"	EACH	1	1		
550A0070	STORM SEWERS, CLASS A, TYPE 1 15"	FOOT	568	568		
55100700	STORM SEWER REMOVAL 15"	FOOT	601	601		
60218400	MANHOLES, TYPE A, 4' -DIAMETER, TYPE 1 FRAME, CLOSED LID	EACH	3	3		
60235700	INLETS, TYPE A, TYPE 3 FRAME AND GRATE	EACH	6	6		
60500040	REMOVING MANHOLES	EACH	1	1		
60500060	REMOVING INLETS	EACH	6	6		

\* SPECIALTY ITEMS

FILE NAME =	USER NAME = steffennk	DESIGNED -	REVISED -	<b>STATE OF ILLINOIS DEPARTMENT OF TRANSPORTATION</b>	<b>SUMMARY OF QUANTITIES</b>	F.A.W. RTE.	SECTION	COUNTY	TOTAL SHEETS	SHEET NO.
ct:\pvc\work\pvidat\steffennk\08157683\1074282-ent-soq.dgn	DRAWN -	REVISED -	8379			(12)RIN	Effingham	36	3	
PLOT SCALE = 1/8" = 1'-0"	CHECKED -	REVISED -	CONTRACT NO. 74282							
PLOT DATE = 5/8/2014	DATE -	REVISED -	ILLINOIS FED. AID PROJECT							
Default				SCALE:	SHEET OF SHEETS	STA.	TO STA.			

URBAN

URBAN

SUMMARY OF QUANTITIES			CONSTRUCTION TYPE CODE			
CODE NO	ITEM	UNIT	TOTAL QUANTITIES	0005 80% FEDERAL 20% STATE	0021 80% FEDERAL 20% STATE	0021 100% CITY
60605000	COMBINATION CONCRETE CURB AND GUTTER, TYPE B-6.24	FOOT	637	637		
66600105	FURNISHING AND ERECTING RIGHT OF WAY MARKERS	EACH	1	1		
*66900200	NON-SPECIAL WASTE DISPOSAL	CU YD	50	50		
67100100	MOBILIZATION	L SUM	1	1		
*66900450	SPECIAL WASTE PLANS AND REPORTS	L SUM	1	1		
70102622	TRAFFIC CONTROL AND PROTECTION, STANDARD 701502	L SUM	1	1		
*66900530	SOIL DISPOSAL ANALYSIS	EACH	2	2		
70102635	TRAFFIC CONTROL AND PROTECTION, STANDARD 701701	L SUM	1	1		
70300100	SHORT TERM PAVEMENT MARKING	FOOT	2629	2629		
70301000	WORK ZONE PAVEMENT MARKING REMOVAL	SQ FT	292	292		
78009000	MODIFIED URETHANE PAVEMENT MARKING - LETTERS AND SYMBOLS	SQ FT	249.6	249.6		
*78009004	MODIFIED URETHANE PAVEMENT MARKING - LINE 4"	FOOT	2920	2920		
*78009006	MODIFIED URETHANE PAVEMENT MARKING - LINE 6"	FOOT	926	926		
*78009008	MODIFIED URETHANE PAVEMENT MARKING - LINE 8"	FOOT	356	356		
*78009012	MODIFIED URETHANE PAVEMENT MARKING - LINE 12"	FOOT	77	77		

SUMMARY OF QUANTITIES			CONSTRUCTION TYPE CODE			
CODE NO	ITEM	UNIT	TOTAL QUANTITIES	0005 80% FEDERAL 20% STATE	0021 80% FEDERAL 20% STATE	0021 100% CITY
78009024	MODIFIED URETHANE PAVEMENT MARKING - LINE 24"	FOOT	110	110		
*78100100	RAISED REFLECTIVE PAVEMENT MARKER	EACH	47	47		
*78200300	PRISMATIC CURB REFLECTOR	EACH	58	58		
78300100	PAVEMENT MARKING REMOVAL	SQ FT	220	220		
*81028310	UNDERGROUND CONDUIT, PVC, 3/4" DIA.	FOOT	22		22	
*81028340	UNDERGROUND CONDUIT, PVC, 1 1/2" DIA.	FOOT	425		425	
*81028350	UNDERGROUND CONDUIT, PVC, 2" DIA.	FOOT	149		149	
*81400100	HANDHOLE	EACH	1		1	
*81500100	GULFBOX JUNCTION	EACH	2		2	
*87301225	ELECTRIC CABLE IN CONDUIT, SIGNAL NO. 14 3C	FOOT	424		424	
*87301255	ELECTRIC CABLE IN CONDUIT, SIGNAL NO. 14 7C	FOOT	679		679	
*87301305	ELECTRIC CABLE IN CONDUIT, LEAD-IN, NO. 14 1 PAIR	FOOT	2127		2127	
*87502700	TRAFFIC SIGNAL POST, ALUMINUM 16 FT.	EACH	1		1	

\* SPECIALTY ITEMS

\* SPECIALTY ITEMS

FILE NAME :	USER NAME : gstaffennb	DESIGNED -	REVISED -	<b>STATE OF ILLINOIS DEPARTMENT OF TRANSPORTATION</b>	<b>SUMMARY OF QUANTITIES</b>			F.A.U. RTE.	SECTION	COUNTY	TOTAL SHEETS	SHEET NO.
c:\pwwork\pwwork\staffennb\02157823\074282\ent\soq.dgn	DRAWN -	REVISED -	8379					02RIN	Effingham	36	4	
Default	PLOT SCALE = 1/8" = 100'-0" / 1" = 100'	CHECKED -	REVISED -		SCALE: SHEET OF SHEETS STA. TO STA.			CONTRACT NO. 74282				
	PLOT DATE = 5/8/2014	DATE -	REVISED -		ILLINOIS FED. AID PROJECT							

URBAN

URBAN

SUMMARY OF QUANTITIES			TOTAL QUANTITIES	CONSTRUCTION TYPE CODE		
CODE NO	ITEM	UNIT		0005 80% FEDERAL 20% STATE	0021 80% FEDERAL 20% STATE	0021 100% CITY
* 87602000	PEDESTRIAN PUSH-BUTTON POST	EACH	2		2	
* 87800100	CONCRETE FOUNDATION, TYPE A	FOOT	3		3	
* 87900200	DRILL EXISTING HANDHOLE	EACH	4		4	
* 88040160	SIGNAL HEAD, POLYCARBONATE, LED, 1-FACE, 5-SECTION, MAST ARM MOUNTED	EACH	1		1	
* 88040290	SIGNAL HEAD, POLYCARBONATE, LED, 2-FACE, 5-SECTION, BRACKET MOUNTED	EACH	1		1	
* 88200410	TRAFFIC SIGNAL BACKPLATE, LOUVERED, FORMED PLASTIC	EACH	3		3	
* 88600100	DETECTOR LOOP, TYPE I	FOOT	812		812	
* 88700200	LIGHT DETECTOR	EACH	4			4
* 88700300	LIGHT DETECTOR AMPLIFIER	EACH	1			1
* 88800100	PEDESTRIAN PUSH-BUTTON	EACH	2		2	
* 89100400	ILLUMINATED SIGN, LED	EACH	4		4	
* 89502210	MODIFY EXISTING CONTROLLER CABINET	EACH	1		1	

SUMMARY OF QUANTITIES			TOTAL QUANTITIES	CONSTRUCTION TYPE CODE		
CODE NO	ITEM	UNIT		0005 80% FEDERAL 20% STATE	0021 80% FEDERAL 20% STATE	0021 100% CITY
* 89502300	REMOVE ELECTRIC CABLE FROM CONDUIT	FOOT	852			852
* 89502375	REMOVE EXISTING TRAFFIC SIGNAL EQUIPMENT	EACH	1			1
* 89502380	REMOVE EXISTING HANDHOLE	EACH	2			2
* 89502385	REMOVE EXISTING CONCRETE FOUNDATION	EACH	2			2
* X0323071	SPARE FULL ACTUATED CONTROLLER, SPECIAL	EACH	1			1
X2501000	SEEDING, CLASS 2 (SPECIAL)	ACRE	0.2	0.2		
40600275	BITUMINOUS MATERIALS (PRIME COAT)	POUND	2462	2462		
X6061300	CONCRETE MEDIAN, TYPE SB-6.06 (DOWELLED)	SQ FT	2776	2776		
X7015005	CHANGEABLE MESSAGE SIGN	CAL DA	28	28		
* X7830060	GROOVING FOR RECESSED PAVEMENT MARKING, LETTERS AND SYMBOLS	SQ FT	249.6	249.6		
* X7830070	GROOVING FOR RECESSED PAVEMENT MARKING 5"	FOOT	2920	2920		
* X7830074	GROOVING FOR RECESSED PAVEMENT MARKING 7"	FOOT	926	926		
* X7830076	GROOVING FOR RECESSED PAVEMENT MARKING 9"	FOOT	356	356		

\* SPECIALTY ITEMS



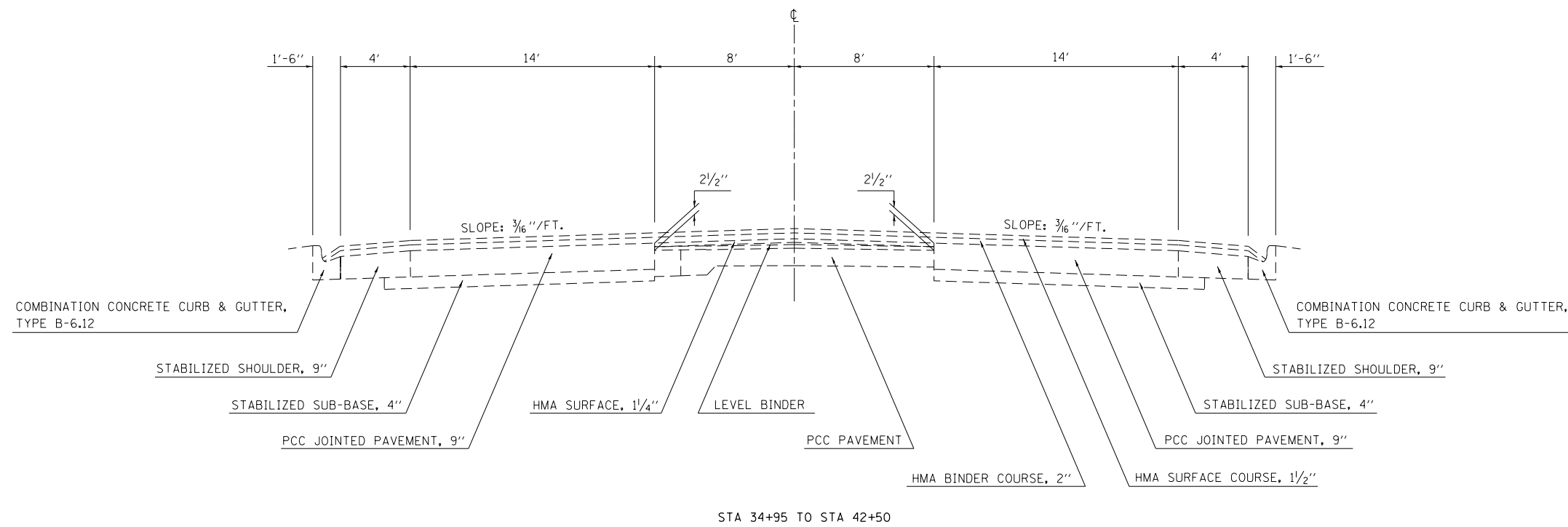
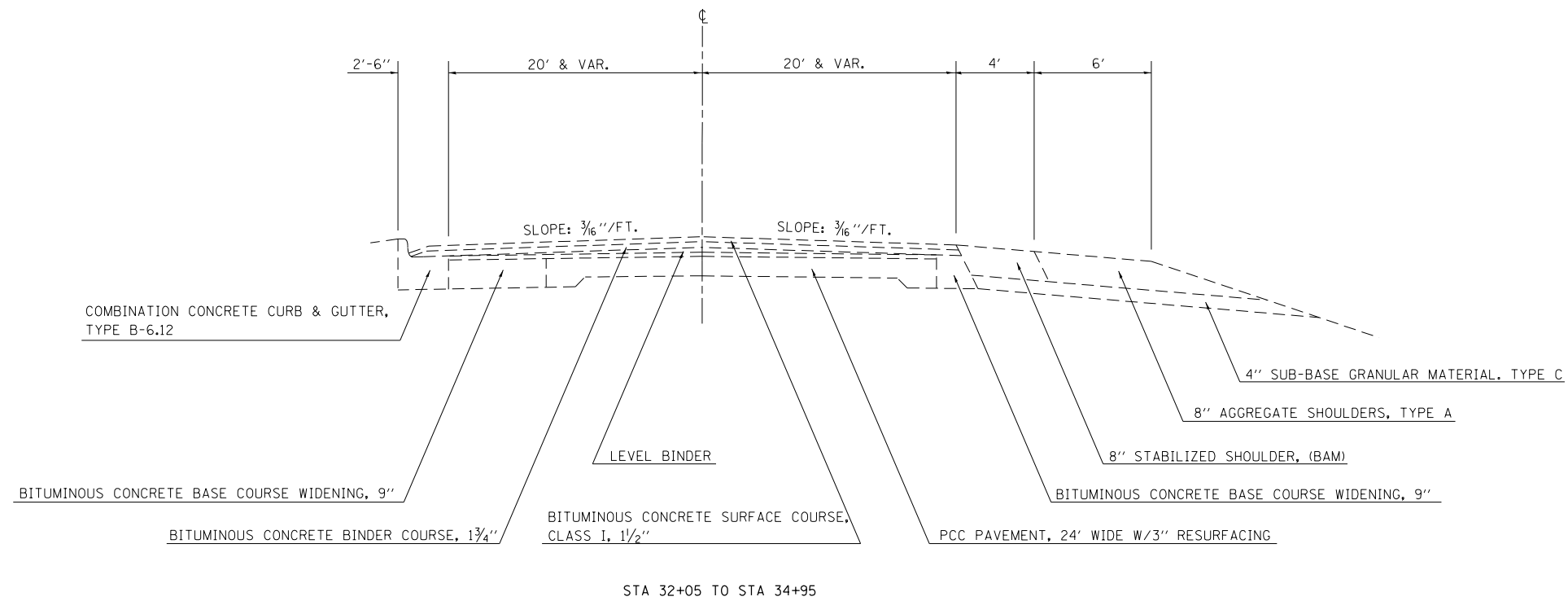

FILE NAME =	USER NAME = steffenmk	DESIGNED -	REVISED -
c:\pwork\pwork\stefjenmk\d0157803\074282-sh-typicals.dgn		DRAWN -	REVISED -
Default	PLOT SCALE = 100.0000' / in.	CHECKED -	REVISED -
	PLOT DATE = 5/8/2014	DATE -	REVISED -

**STATE OF ILLINOIS  
DEPARTMENT OF TRANSPORTATION**

**EXISTING TYPICALS**

SCALE: SHEET OF SHEETS STA. TO STA.

F.A.U. RTE.	SECTION	COUNTY	TOTAL SHEETS	SHEET NO.
8379	12RIN	Effingham	36	7
CONTRACT NO. 74282			ILLINOIS FED. AID PROJECT	

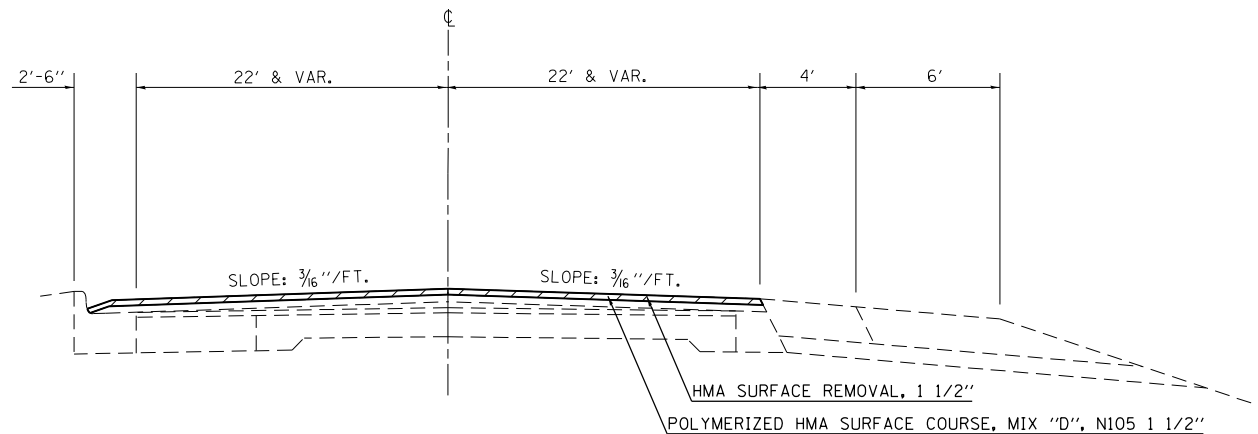

STA 32+05 TO STA 34+95

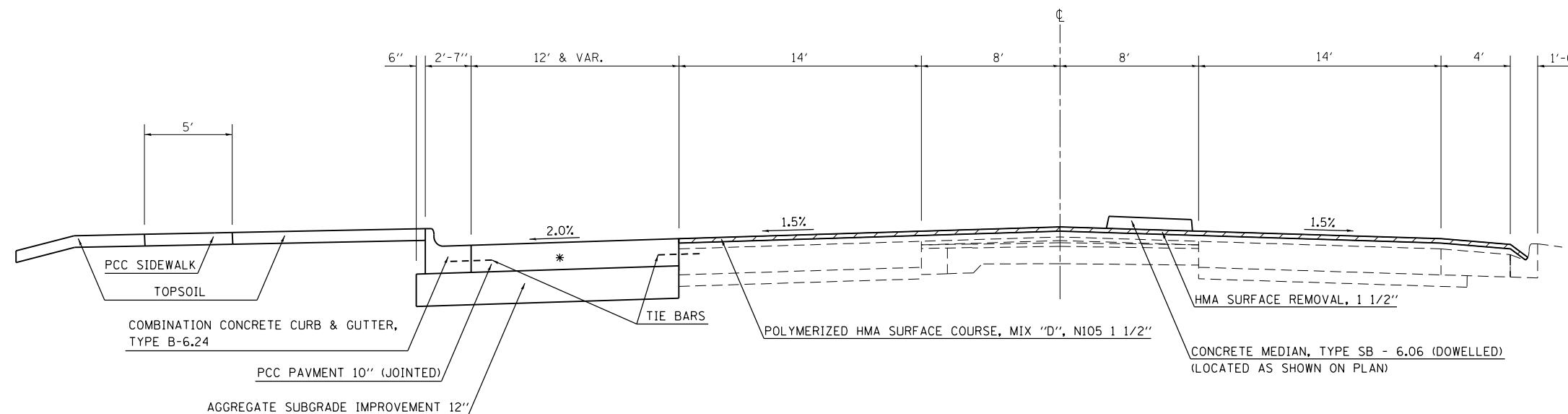

STA 34+95 TO STA 42+50  
 \* (NEW PAVEMENT STA 36+13 TO STA 40+69)

FILE NAME =	USER NAME = steffenmk	DESIGNED -	REVISED -
ci:\pw\work\p\idot\steffenmk\d0157803\074282-sh-typicals.dgn		DRAWN -	REVISED -
Default	PLOT SCALE = 100.0000' / in.	CHECKED -	REVISED -
	PLOT DATE = 5/8/2014	DATE -	REVISED -

**STATE OF ILLINOIS  
 DEPARTMENT OF TRANSPORTATION**

**PROPOSED TYPICALS**

SCALE: SHEET OF SHEETS STA. TO STA.

F.A.U. RTE.	SECTION	COUNTY	TOTAL SHEETS	SHEET NO.
8379	(12RIN)	Effingham	36	8
CONTRACT NO. 74282			ILLINOIS FED. AID PROJECT	



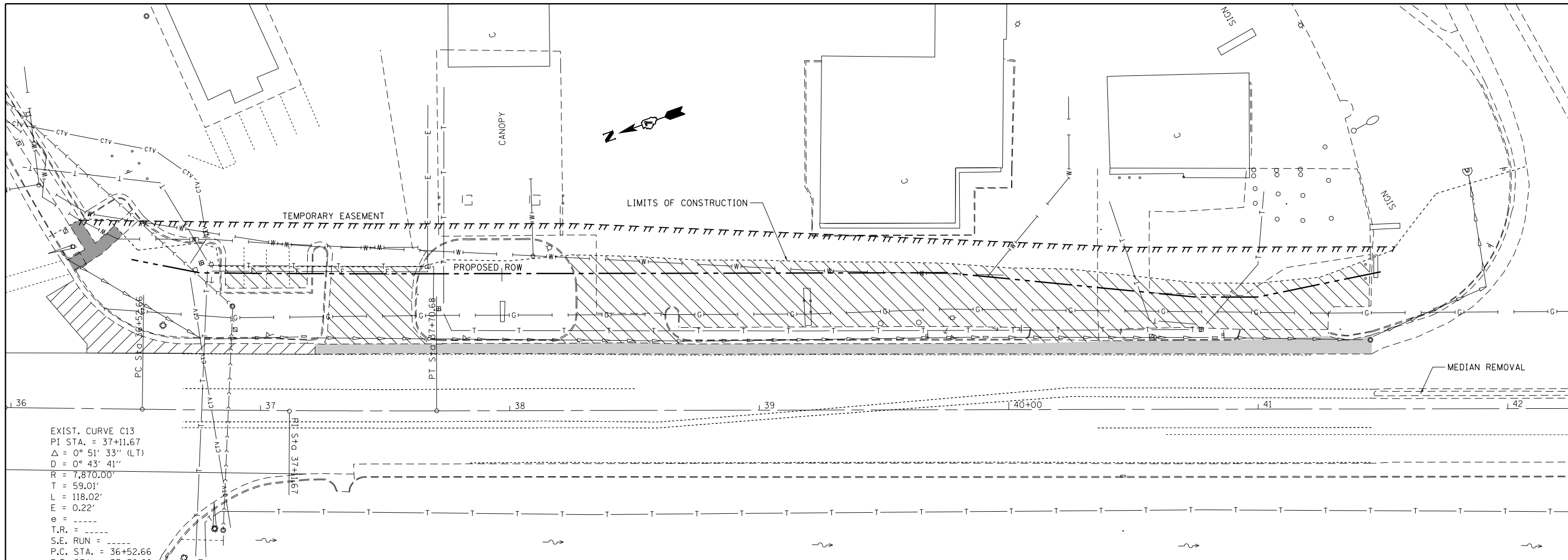

EXIST. CURVE C13  
 PI STA. = 37+11.67  
 $\Delta = 0^\circ 51' 33''$  (LT)  
 $D = 0^\circ 43' 41''$   
 $R = 7,870.00'$   
 $T = 59.01'$   
 $L = 118.02'$   
 $E = 0.22'$   
 $e = \text{---}$   
 $T.R. = \text{---}$   
 $S.E. \text{ RUN} = \text{---}$   
 $P.C. \text{ STA.} = 36+52.66$

- PAVEMENT REMOVAL
- PAVED SHOULDER REMOVAL
- DRIVEWAY PAVEMENT REMOVAL
- SIDEWALK REMOVAL

COMB. CURB & GUTTER REMOVAL LT. STA. 36+16 TO 42+08      666 FEET	MEDIAN REMOVAL STA. 41+45 TO 42+32      330 S. F.	REMOVING MANHOLES 28' LT. STA. 41+45      1 EACH
PAVEMENT REMOVAL LT. STA. 36+13 TO 37+22      88 S. Y.	PAVED SHOULDER REMOVAL LT. STA. 37+22 TO 41+45      188 S. Y.	REMOVING INLETS LT. STA. 36+20      1 EACH LT. STA. 36+78      1 EACH LT. STA. 37+17      1 EACH LT. STA. 38+76      1 EACH LT. STA. 39+91      1 EACH LT. STA. 40+83      1 EACH
SIDEWALK REMOVAL LT. STA. 34+99 TO 35+32      237 S. F. LT. STA. 36+22 TO 36+43      178 S. F.	STORM SEWER REMOVAL 15" LT. STA. 36+21 TO 41+84      601 FEET	

FILE NAME =	USER NAME = steffenmk	DESIGNED -	REVISED -
ci:\pw\work\p\dot\steffenmk\d0157803\074282-sh-t-plan.dgn		DRAWN -	REVISED -
Default	PLOT SCALE = 40.0000' / in.	CHECKED -	REVISED -
	PLOT DATE = 5/8/2014	DATE -	REVISED -

**STATE OF ILLINOIS  
 DEPARTMENT OF TRANSPORTATION**

<b>REMOVAL ITEMS</b>			
SCALE:	SHEET	OF SHEETS	STA. TO STA.

F.A.U. RTE.	SECTION	COUNTY	TOTAL SHEETS	SHEET NO.
8379	12RIN	Effingham	36	9
ILLINOIS FED. AID PROJECT			CONTRACT NO. 74282	

PAVEMENT MARKING SCHEDULE

LENGTH				SHORT TERM PAVEMENT MARKING	WORK ZONE PAVEMENT MARKING REMOVAL	PAVEMENT MARKING REMOVAL	GROOVING FOR RECESSED PAVEMENT MARKING, LETTERS, NUMBERS AND SYMBOLS	MODIFIED URETHANE PAVEMENT MARKING - LETTERS AND SYMBOLS	GROOVING FOR RECESSED PAVEMENT MARKING 5"	MODIFIED URETHANE PAVEMENT MARKING - LINE 4"	GROOVING FOR RECESSED PAVEMENT MARKING 7"	MODIFIED URETHANE PAVEMENT MARKING - LINE 6"	GROOVING FOR RECESSED PAVEMENT MARKING 9"	MODIFIED URETHANE PAVEMENT MARKING - LINE 8"	GROOVING FOR RECESSED PAVEMENT MARKING 13"	MODIFIED URETHANE PAVEMENT MARKING - LINE 12"	GROOVING FOR RECESSED PAVEMENT MARKING 25"	MODIFIED URETHANE PAVEMENT MARKING - LINE 24"	RAISED REFLECTIVE PAVEMENT MARKER	PRISMATIC CURB REFLECTORS	
STATION		STATION	FEET	FT.	SO. FT.	SO. FT.	SO. FT.	SO. FT.	FT.	FT.	FT.	FT.	FT.	FT.	FT.	FT.	FT.	FT.	EACH	EACH	
32+05	TO	33+61	156	109	12				780	780			32	32	44	44			10		
33+61	TO	35+25	164	796	88		46.8	46.8	491	491			324	324	33	33	33	33	20		
35+25	TO	36+71	146																		
36+71	TO	38+96	225	939	104		109.2	109.2	618	618	448	448					36	36	14	24	
38+96	TO	39+71	75	74	8		31.2	31.2	225	225	75	75							3	6	
39+71	TO	42+50	279	711	80		62.4	62.4	806	806	223	223								28	
EAST LEG OF RICKELMAN						220					180	180					41	41			
PROJECT TOTALS				1,045	2,629	292	220	249.6	249.6	2,920	2,920	926	926	356	356	77	77	110	110	47	58



PAVING SCHEDULE

						BITUMINOUS MATERIALS (PRIME COAT)	HOT MIX ASPHALT SURFACE REMOVAL 1 1/2"	POLYMERIZED HOT MIX ASPHALT SURFACE COURSE, MIX "D", N90	TEMPORARY RAMP
STATION	TO	STATION	LENGTH FEET	WIDTH FEET	AREA SQ YD				
32+05	TO	42+50	1,045	VAR.	5,472	2,462	5,472	460	151

EARTHWORK SCHEDULE

LOCATION	EARTH EXCAVATION CU. YD.	EXCAVATION TO BE USED IN EMBANKMENT ADJUSTED FOR SHRINKAGE CU. YD.	EMBANKMENT CU. YD.	EARTHWORK BALANCE	TOPSOIL FURNISH AND PLACE 4"
				WASTE(+) SHORTAGE(-) CU. YD.	SQ. YD.
LT. STA. 36+15 TO 42+10	236	175	356	-181	985

FURNISHING AND ERECTING RIGHT OF WAY MARKERS  
55.00' LT. STA. 41+49.20 1 EACH

PCC PAVEMENT 10"  
LT. STA. 36+13 TO 40+69 564 S. Y.

PROTECTING OR RESETTING SURVEY MARKERS  
60.00' LT. STA. 36+47.56 1 EACH  
55.00' LT. STA. 36+75.00 1 EACH  
55.00' LT. STA. 37+70.68 1 EACH  
55.00' LT. STA. 39+75.00 1 EACH  
45.00' LT. STA. 40+75.00 1 EACH  
45.00' LT. STA. 41+00.00 1 EACH

COMB. CONC. CURB & GUTTER, TYPE B6.24  
LT. STA. 36+15 TO 42+07 637 FEET

CONC. MEDIAN, TYPE SB-6.06 (DOWELLED)  
STA. 36+71.5 TO 42+30.1 2776 S.F.



PLAN	SURVEYED	BY	DATE
	PLOTTED		
	ALIGNED		
	CHECKED		
	DESIGNED		
	FILE NAME		
	NO.		

PROFILE	SURVEYED	BY	DATE
	PLOTTED		
	GRADES		
	CHECKED		
	STRUCTURE		
	NOTATIONS		
	CHKD		
	NO.		

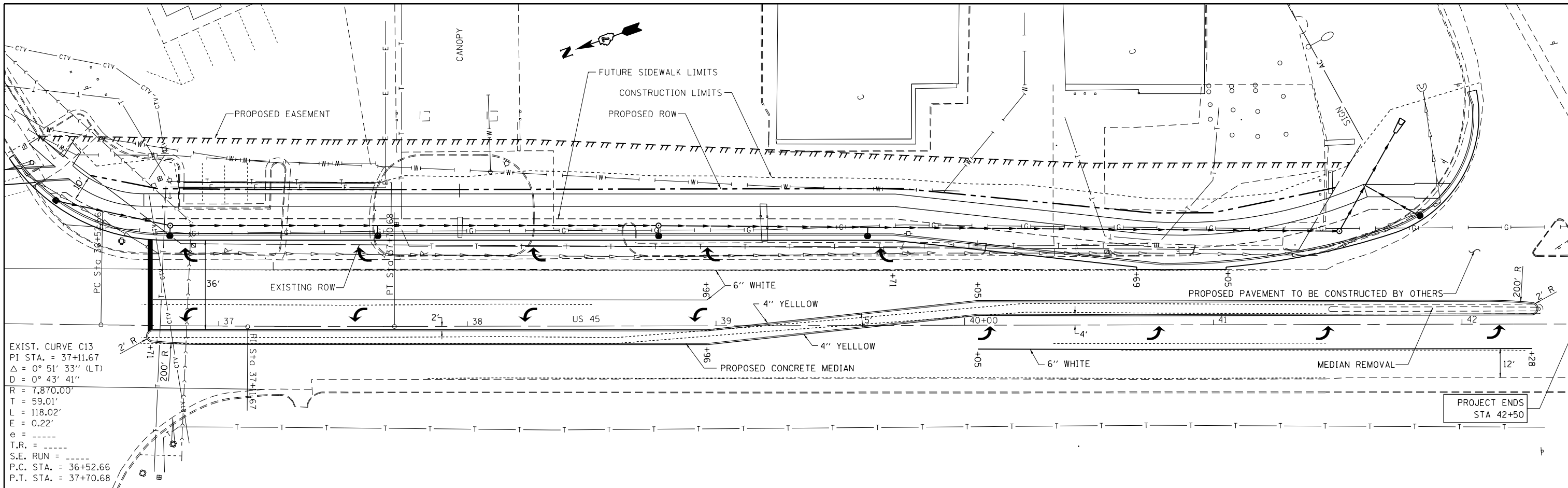

EXIST. CURVE C13  
 PI STA. = 37+11.67  
 $\Delta = 0^\circ 51' 33''$  (LT)  
 $D = 0^\circ 43' 41''$   
 $R = 7,870.00'$   
 $T = 59.01'$   
 $L = 118.02'$   
 $E = 0.22'$   
 $e =$   
 $T.R. =$   
 $S.E. RUN =$   
 P.C. STA. = 36+52.66  
 P.T. STA. = 37+70.68

PROJECT ENDS  
 STA 42+50

- SUGGESTED SEQUENCE OF OPERATIONS:
1. CONSTRUCT PROPOSED STORM SEWER SYSTEM AND MAKE PROPOSED CHANGES TO TRAFFIC SIGNALS.
  2. REMOVE EXISTING MEDIAN TO LEVEL OF EXISTING SURROUNDING PAVEMENT.
  3. REMOVE EXISTING CURB & GUTTER, DRIVEWAY PAVEMENT, PAVED SHOULDER, PAVEMENT, ETC.
  4. CONSTRUCT PROPOSED PCC PAVEMENT AND CURB & GUTTER.
  5. PERFORM HMA SURFACE REMOVAL.
  6. CONSTRUCT PROPOSED DOWELLED MEDIAN.
  7. CONSTRUCT PROPOSED HMA SURFACE COURSE AND PAVEMENT MARKINGS.

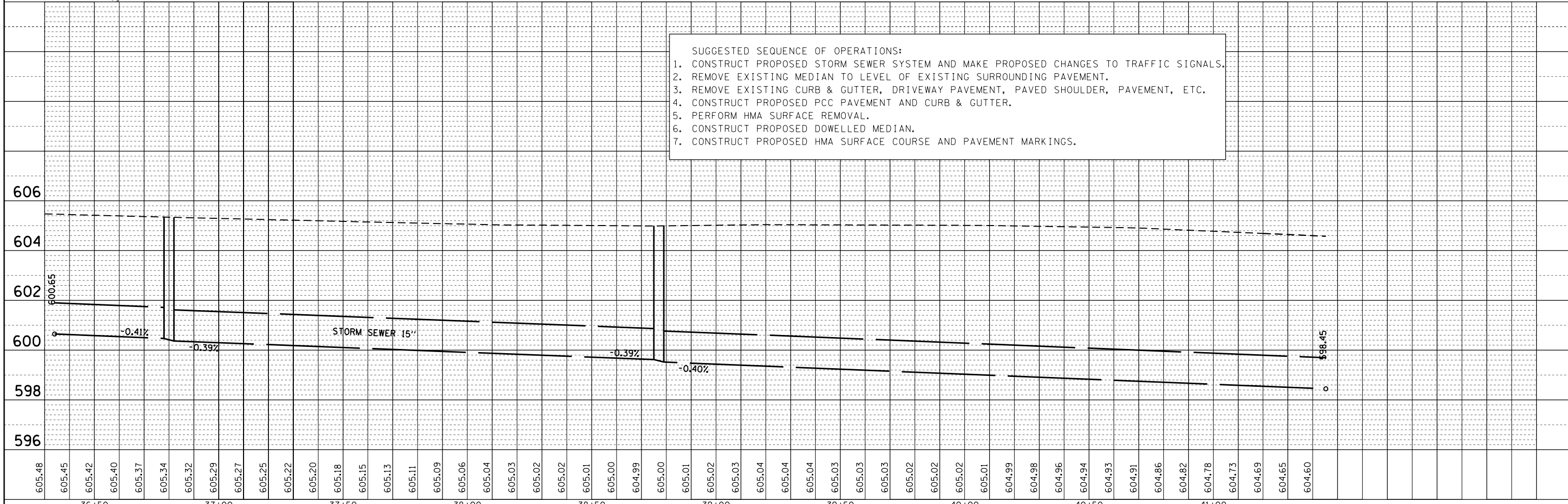

FILE NAME =	USER NAME = steffennk	DESIGNED -	REVISED -
c:\pwork\pwork\stefennk\d0157803\077282-sht-plan.dgn		DRAWN -	REVISED -
Default	PLOT SCALE = 40.0000' / in.	CHECKED -	REVISED -
	PLOT DATE = 5/8/2014	DATE -	REVISED -

STATE OF ILLINOIS  
 DEPARTMENT OF TRANSPORTATION

PLAN AND PROFILE SHEET  
 STA 36+00 TO 42+00

SCALE: SHEET OF SHEETS STA. TO STA.

F.A.U. R.E.	SECTION	COUNTY	TOTAL SHEETS	SHEET NO.
8379	(12)R/N	Effingham	36	12
CONTRACT NO. 74282			ILLINOIS FED. AID PROJECT	

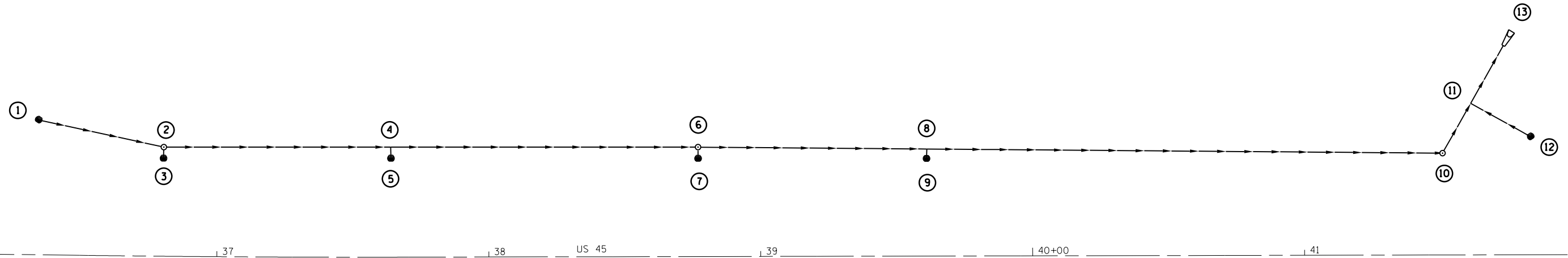

PT. TO PT.	TYPE 1 15"	TRENCH BACKFILL
	LIN FT	CU YD
1-2	45	18
3-2	2	
2-6	188	127
5-4	2	
7-6	2	
6-10	271	202
9-8	2	
10-13	35	28
12-11	21	14
TOTALS	568	389

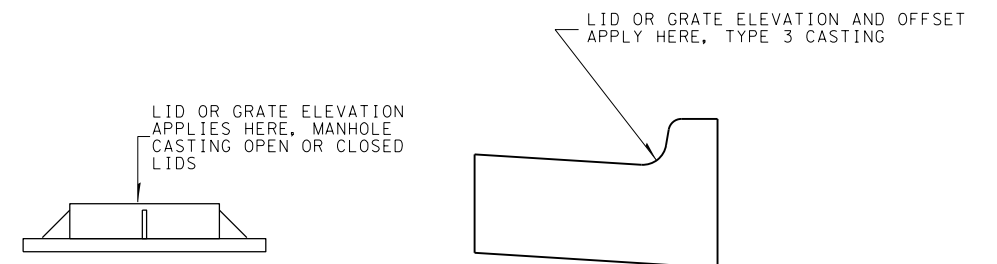

PT	LOCATION	DESCRIPTION	LID OR GRATE	INLET INVERT	OUTLET INVERT	SYM
1	50.0' LT STA 36+34.0	INLETS TA T3F&G	604.54		600.65	●
2	40.5' LT STA 36+80.0	MH TA 4' DIA T1F&CL	605.18	600.47 N&W	600.37	○
3	36.4' LT STA 36+80.0	INLETS TA T3F&G	604.55		600.57	●
5	36.7' LT STA 37+64.0	INLETS TA T3F&G	604.34		600.15	●
6	40.5' LT STA 38+77.0	MH TA 4' DIA T1F&CL	604.80	599.62 N&W	599.52	○
7	36.4' LT STA 38+77.0	INLETS TA T3F&G	604.20		599.72	●
9	36.2' LT STA 39+61.0	INLETS TA T3F&G	604.24		599.30	●
10	40.5' LT STA 41+51.0	MH TA 4' DIA T1F&CL	604.25	598.43	598.33	○
12	43.8' LT STA 41+83.1	INLETS TA T3F&G	603.62		599.10	●
13	77.0' LT STA 41+73.2	PRC FLAR END SEC 15"			598.15	▢

NOTE: POINTS 4, 8, & 11 ARE TEES.

# T.8N.-R.6E., 3rd P.M., DOUGLAS TWP.

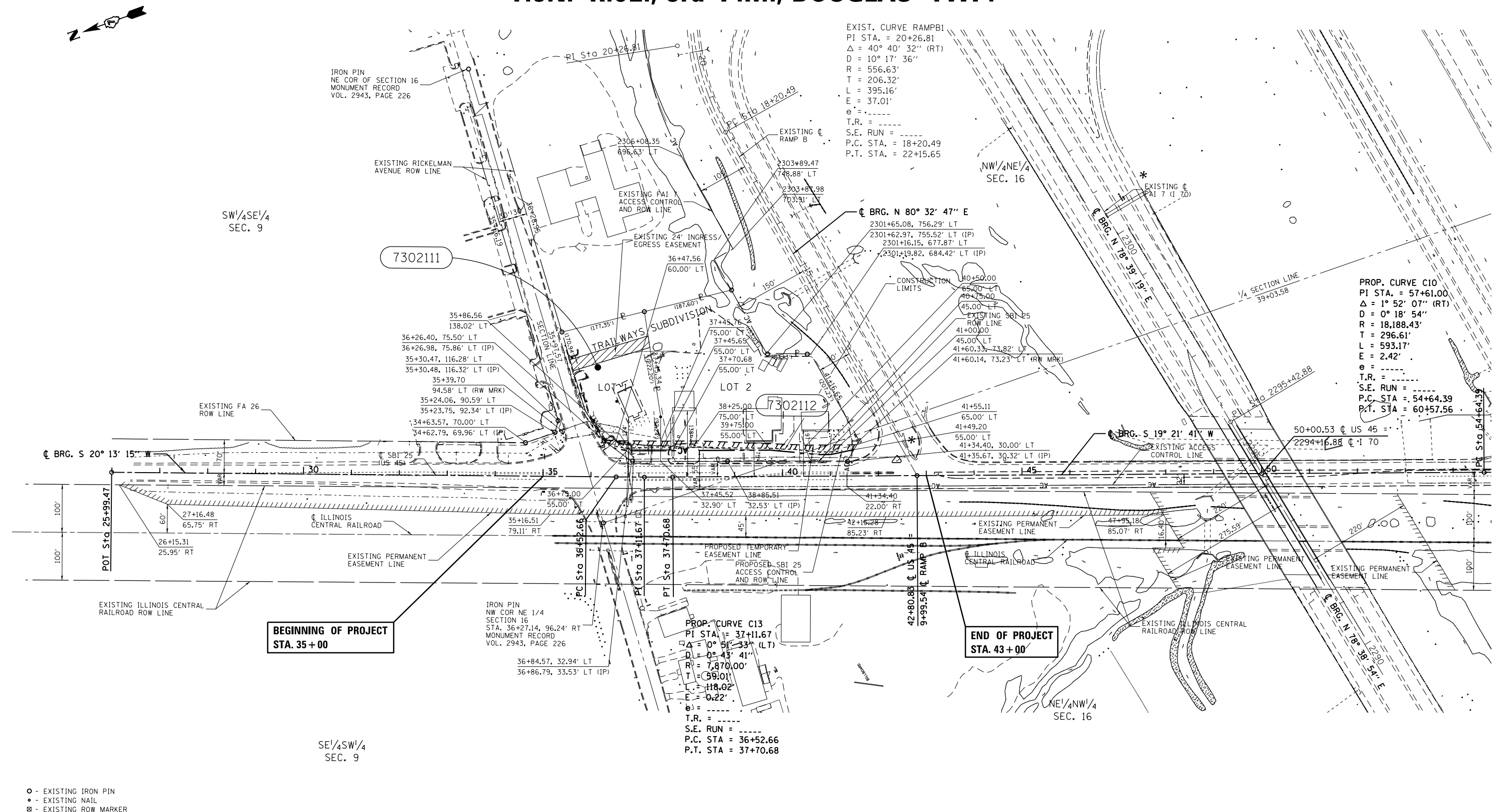

**BEGINNING OF PROJECT  
STA. 35+00**

**END OF PROJECT  
STA. 43+00**

- - EXISTING IRON PIN
- - EXISTING NAIL
- - EXISTING ROW MARKER
- (R) RECORDED DISTANCE

NOTE:  
BEARINGS ARE REFERENCED TO THE ILLINOIS STATE PLANE COORDINATE SYSTEM EAST ZONE DATUM OF 1983(86)  
TEMPORARY EASEMENTS NEEDED FOR A WORK AREA

PARCEL	OWNER	AREA TAKEN		EASEMENT	AREA REM	INST	RECORDED				EXCESS		
		ADD	EXIST				MICRO FILM NO	DATE	BOOK	PAGE	AREA	SOLD	
7302111	ELVAN D. AND A. CAROLYN WALLACE	0.039 AC.	0.000 AC.	0.048 AC.	0.965 AC.								
7302112	RHODES DEVELOPMENT GROUP, LLC	0.191 AC.	0.000 AC.	0.160 AC.	2.315 AC.								

FILE NAME D774282-sht-rowplan.dgn	USER NAME = steffernk	DESIGNED - JMD	REVISED -
		DRAWN - JMD	REVISED -
		CHECKED - JMD	REVISED -
		DATE - 04/26/13	REVISED -

**STATE OF ILLINOIS  
DEPARTMENT OF TRANSPORTATION**

RIGHT OF WAY PLANS	
PROJECT	JOB NO. R-97-002-13
SCALE: 1" = 100'	STA. 35+00.00 TO STA. 43+00.00
SHEET NO. 2 OF 2 SHEETS	

F.A.U. RTE.	SECTION	COUNTY	TOTAL SHEETS	SHEET NO.
8379	(12)RIN	EFFINGHAM	36	14
CONTRACT NO. 74282				
FED. ROAD DIST. NO. ILLINOIS FED. AID PROJECT				

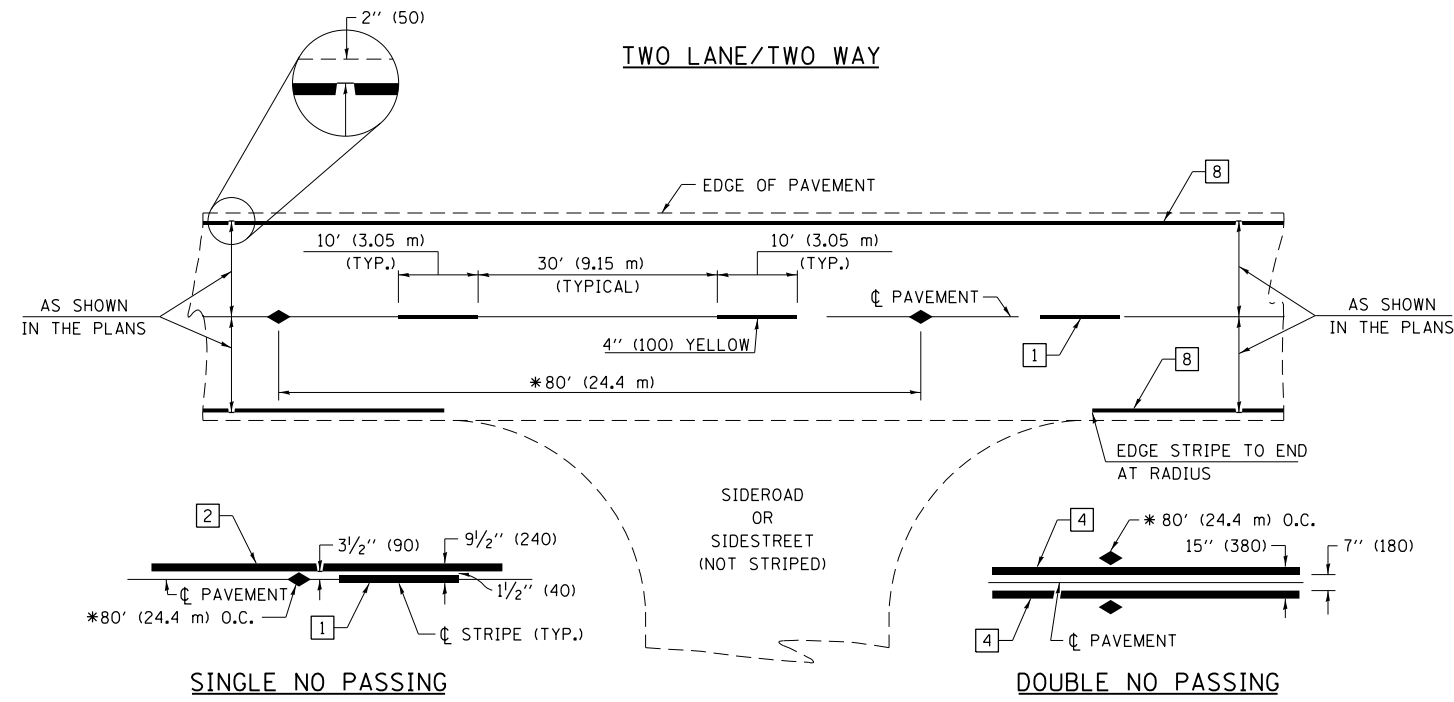

\* REDUCE TO 40' (12.2 m) O.C. ON CURVES WITH POSTED OR ADVISORY SPEEDS OF 45 mph (70 km/h) OR LESS.

**PAVEMENT MARKING LEGEND**

- 1 4" (100) SKIP-DASH (YELLOW)
  - 2 4" (100) SOLID (YELLOW)
  - 3 12" (300) DIAGONAL (YELLOW)
  - 4 4" (100) DOUBLE YELLOW (NARROW)
  - 5 12" (300) SOLID WHITE
  - 6 RESERVED
  - 7 6" (150) SKIP-DASH (WHITE)
  - 8 4" (100) SOLID (WHITE)
  - 9 12" (300) DIAGONAL (WHITE)
  - 10 6" (150) SOLID (WHITE)
  - 11 24" (600) STOP BAR (WHITE)
  - 12 8" (200) SOLID (WHITE)
  - 13 4" (100) PARKING WHITE
- 

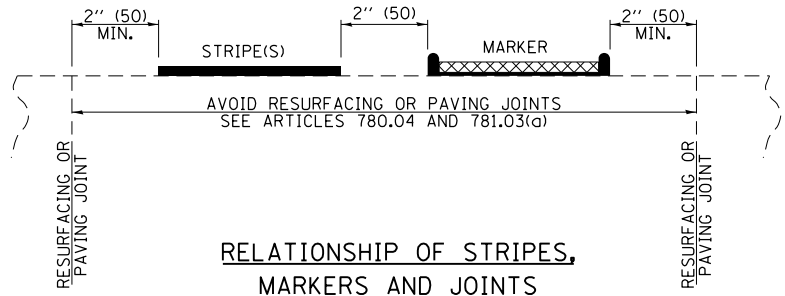

**TYPICAL PAVEMENT MARKERS LEGEND**

- ◆ TWO-WAY AMBER MARKER
- ▶ ONE-WAY AMBER MARKER
- ▷ ONE-WAY CRYSTAL MARKER

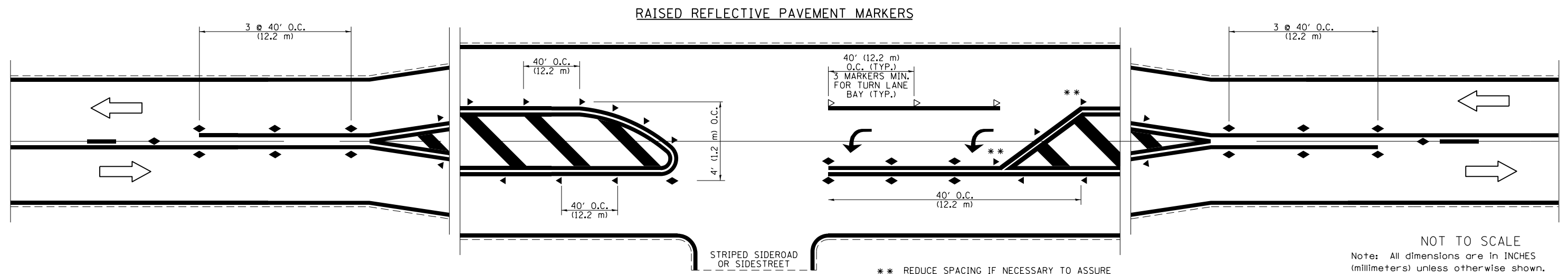

\*\* REDUCE SPACING IF NECESSARY TO ASSURE MARKERS AT CORNER POINTS.

NOT TO SCALE  
Note: All dimensions are in INCHES (millimeters) unless otherwise shown.

**DISTRICT 7 DETAIL NO. 7800001**

FILE NAME =	USER NAME = steffenmk	DESIGNED -	REVISED -	<b>STATE OF ILLINOIS DEPARTMENT OF TRANSPORTATION</b>	<b>PAVEMENT MARKING AND RAISED REFLECTIVE PAVEMENT MARKERS (RURAL &amp; URBAN APPLICATIONS)</b>	F.A.U. RTE.	SECTION	COUNTY	TOTAL SHEETS	SHEET NO.
ci:\pw\work\p\idot\steffenmk\d0157803\074282-sh1-details.dgn		DRAWN -	REVISED -			8379	(12)RIN	Effingham	36	15
PLOT SCALE = 100.0000' / in.		CHECKED -	REVISED -			CONTRACT NO. 74282				
PLOT DATE = 5/8/2014		DATE -	REVISED -			ILLINOIS FED. AID PROJECT				

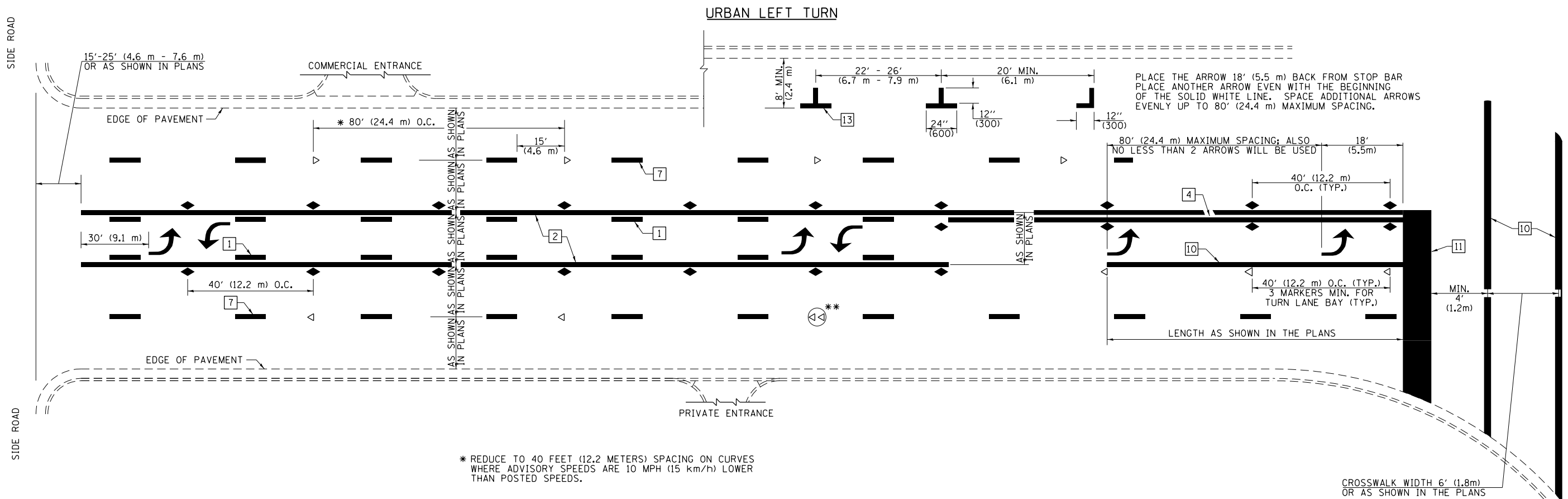

- \* REDUCE TO 40 FEET (12.2 METERS) SPACING ON CURVES WHERE ADVISORY SPEEDS ARE 10 MPH (15 km/h) LOWER THAN POSTED SPEEDS.
- \*\* DOUBLE LANE LINE MARKERS SHALL BE SPECIFIED AND SPACED AS SHOWN IN HIGHWAY STANDARD 781001 FOR MULTI-LANE DIVIDED AND UNDIVIDED HIGHWAYS.

**PAVEMENT MARKING LEGEND**

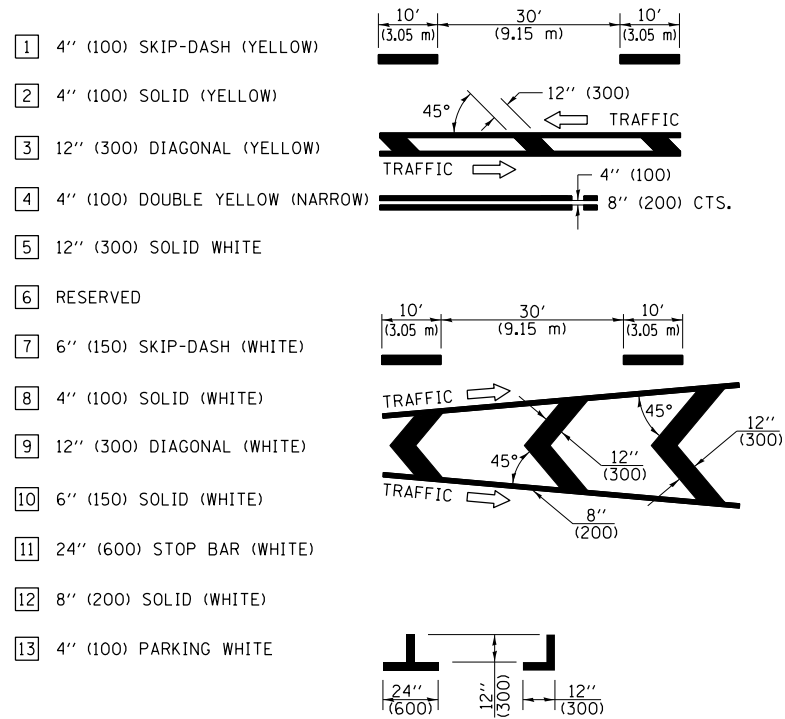

**GENERAL NOTES**

1. TURN ARROW PAIRS SHALL BE PLACED AT 250' (75 m) INTERVALS AND SHALL BE EVENLY SPACED BETWEEN BOTH ENDS OF THE BIDIRECTIONAL LEFT TURN LANE. USE A MINIMUM OF TWO PAIRS PER BLOCK.
2. THE SOLID YELLOW PAVEMENT MARKINGS [2] SHOULD GENERALLY START OR END NEAR THE RADIUS POINT OF EACH STREET RETURN EXCEPT WHERE ONE OR BOTH ENDS WOULD INCLUDE STOP BARS.
3. THE SKIP-DASH PAVEMENT MARKINGS [1] OR [7] SHOULD BE CENTERED BETWEEN BOTH ENDS OF EACH CITY BLOCK AND SHALL BE PLACED SO THEY LINE UP ACROSS FROM EACH OTHER.
4. USE LARGE ARROW SIZE FOR BOTH RURAL AND URBAN LOCATIONS. (SEE LAST PAGE OF SECTION 780x FOR SYMBOLS TABLE)
5. LANE LINE EXTENSIONS SHALL BE THE SAME COLOR AND WIDTH AS THE LANE LINE BEING EXTENDED.

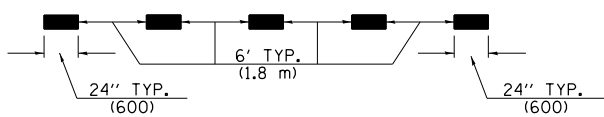

**LANE LINE EXTENSIONS**

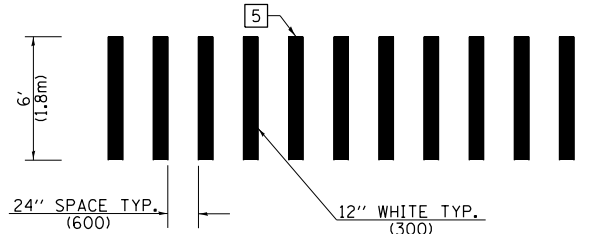

**CROSSWALK DETAIL (DECATUR CITY LIMITS ONLY)**

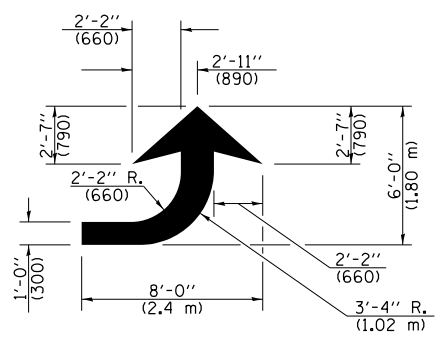

**LEFT ARROW**

REVERSE FOR RIGHT ARROW  
AREA = 15.6 SQ. FT. (1.47 m<sup>2</sup>)  
(WHITE)

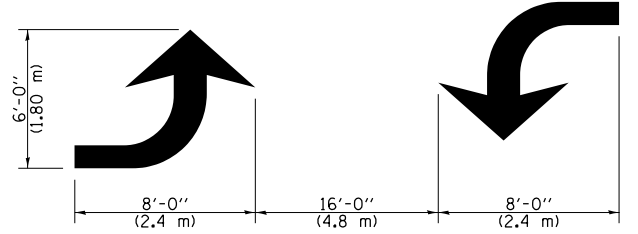

**TYPICAL DOUBLE TURN ARROWS (WHITE)**

NOT TO SCALE

Note: All dimensions are in INCHES (millimeters) unless otherwise shown.

**DISTRICT 7 DETAIL NO. 7800001**

FILE NAME =	USER NAME = steffenmk	DESIGNED -	REVISED -	<b>STATE OF ILLINOIS DEPARTMENT OF TRANSPORTATION</b>	<b>PAVEMENT MARKING AND RAISED REFLECTIVE PAVEMENT MARKERS (RURAL &amp; URBAN APPLICATIONS)</b>		F.A.U. RTE.	SECTION	COUNTY	TOTAL SHEETS	SHEET NO.
ei:\pw\work\p\d01dot\steffenmk\d0157803\074282-sh1-details.dgn	PLOT SCALE = 100.0000' / 1in.	DRAWN -	REVISED -				8379	12RIN	Effingham	36	16
	PLOT DATE = 5/8/2014	CHECKED -	REVISED -				CONTRACT NO. 74282				
		DATE -	REVISED -				ILLINOIS FED. AID PROJECT				



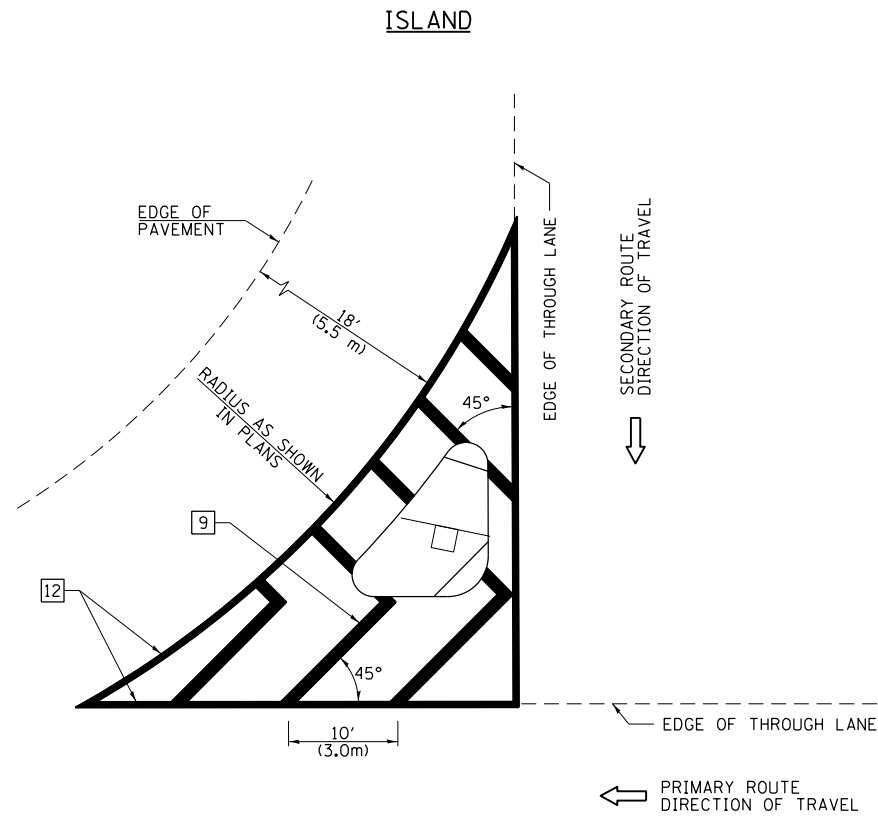

**GENERAL NOTES**

1. RAISED AND CORRUGATED MEDIANS SHALL BE OUTLINED WITH [2] IF PRESENT.
2. SOME OF THE INFORMATION INCLUDED WITH THIS DETAIL MAY NOT BE APPLICABLE TO THIS IMPROVEMENT.
3. PAVEMENT MARKINGS ARE TO BE EXTENDED THROUGH OMISSIONS WHEN APPLICABLE.
4. FINAL PAVEMENT MARKINGS SHALL BE IN PLACE PRIOR TO PLACING ANY RAISED REFLECTIVE PAVEMENT MARKERS.
5. THE FOLLOWING CRITERIA SHALL BE USED FOR SELECTING THE DIAGONAL PAVEMENT MARKING SPACING:

< 30 MPH (< 50 km/h)	15' (4.5 m)
30-45 MPH (50-75 km/h)	20' (6.0 m)
> 45 MPH (> 75 km/h)	30' (9.0 m)

**PAVEMENT MARKING LEGEND**

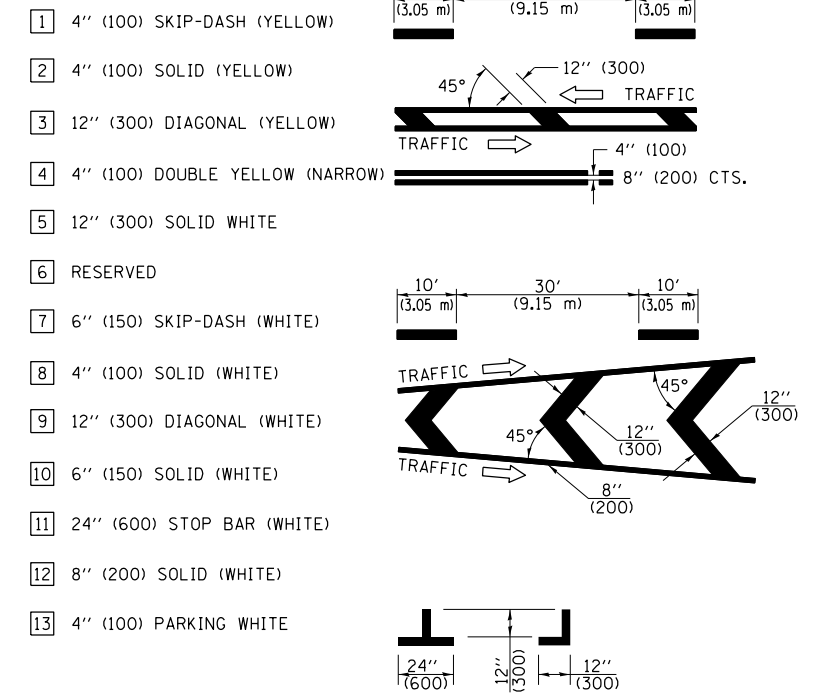

**RURAL LEFT TURN STRIPING**

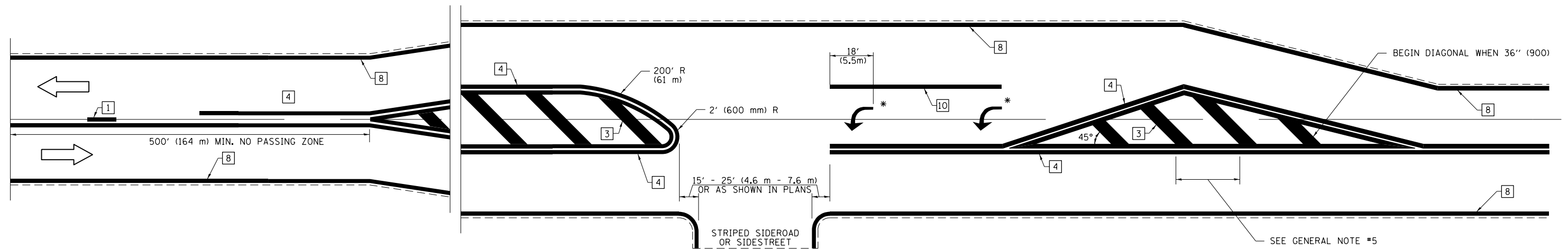

\* PLACE AN ARROW 18' (5.5 m) BACK FROM STOP BAR. PLACE ANOTHER ARROW EVEN WITH THE BEGINNING OF THE SOLID WHITE LINE. SPACE ADDITIONAL ARROWS EVENLY UP TO 80' (24.4 m) MAXIMUM SPACING. USE MINIMUM OF 2 ARROWS.

NOT TO SCALE  
Note: All dimensions are in INCHES (millimeters) unless otherwise shown.

**DISTRICT 7 DETAIL NO. 7800001**

FILE NAME =	USER NAME = steffenmk	DESIGNED -	REVISED -
ci:\pw\work\p\idot\steffenmk\d0157803\074282-sh1-detail1.dgn		DRAWN -	REVISED -
	PLOT SCALE = 100.0000' / 1in.	CHECKED -	REVISED -
	PLOT DATE = 5/8/2014	DATE -	REVISED -

**STATE OF ILLINOIS  
DEPARTMENT OF TRANSPORTATION**

**PAVEMENT MARKING AND RAISED REFLECTIVE PAVEMENT MARKERS  
(RURAL & URBAN APPLICATIONS)**

SCALE: SHEET NO. 3 OF 4 SHEETS STA. TO STA.

F.A.U. RTE.	SECTION	COUNTY	TOTAL SHEETS	SHEET NO.
8379	(12)RIN	Effingham	36	17
				CONTRACT NO. 74282
ILLINOIS FED. AID PROJECT				

PAVEMENT MARKINGS AT RAILROAD-HIGHWAY GRADE CROSSING

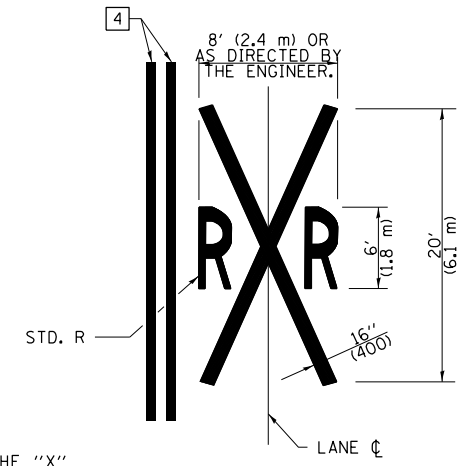
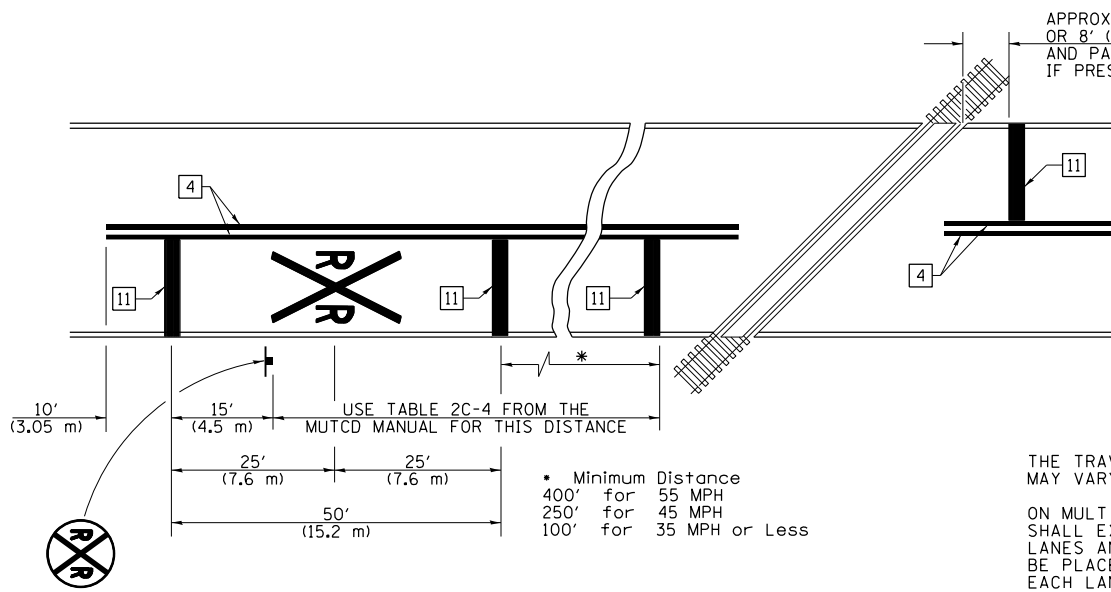

NOTES

THE TRAVERSE SPREAD OF THE "X" MAY VARY ACCORDING TO LANE WIDTH.

ON MULTI-LANE ROADS, THE STOP LINES SHALL EXTEND ACROSS ALL APPROACH LANES AND SEPARATE R X R SYMBOLS SHALL BE PLACED ADJACENT TO EACH OTHER IN EACH LANE.

WHEN THE PAVEMENT MARKING SYMBOL IS USED, A PORTION OF THE SYMBOL SHOULD BE LOCATED DIRECTLY ADJACENT TO THE ADVANCE WARNING SIGN (W10-1) AS PLACED BY TABLE II-1, CONDITION B OF THE MUTCD.

PAVEMENT MARKING LEGEND

- 1 4" (100) SKIP-DASH (YELLOW)
  - 2 4" (100) SOLID (YELLOW)
  - 3 12" (300) DIAGONAL (YELLOW)
  - 4 4" (100) DOUBLE YELLOW (NARROW)
  - 5 12" (300) SOLID WHITE
  - 6 RESERVED
  - 7 6" (150) SKIP-DASH (WHITE)
  - 8 4" (100) SOLID (WHITE)
  - 9 12" (300) DIAGONAL (WHITE)
  - 10 6" (150) SOLID (WHITE)
  - 11 24" (600) STOP BAR (WHITE)
  - 12 8" (200) SOLID (WHITE)
  - 13 4" (100) PARKING WHITE
- 

RAILROAD CROSSING WITH INTERCONNECT ONLY

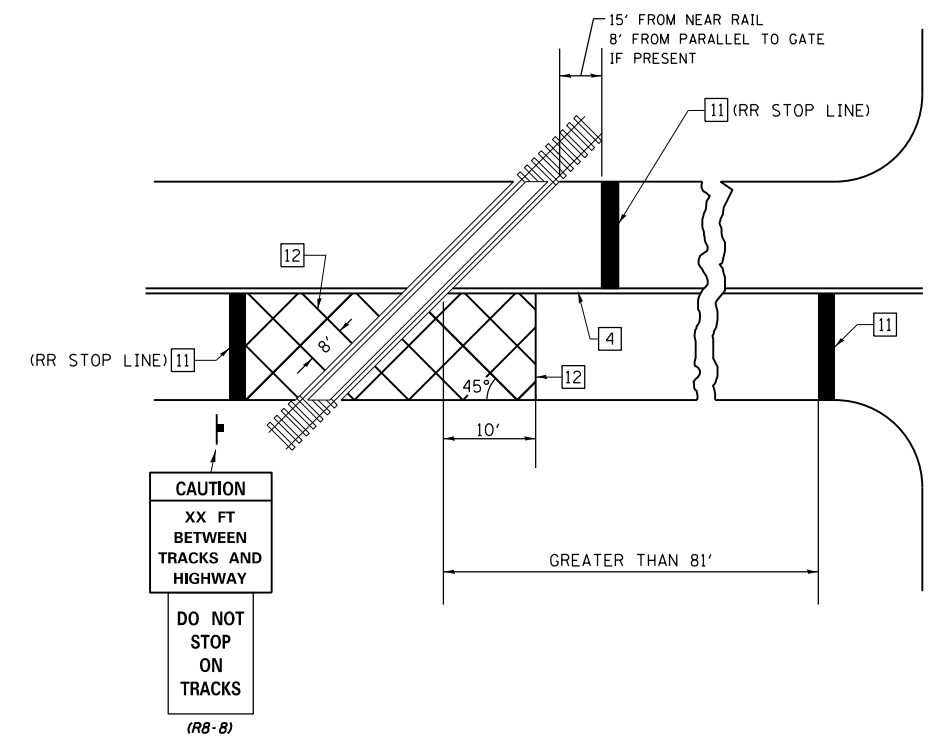

RAILROAD CROSSING WITH INTERCONNECT AND PRE-SIGNALS

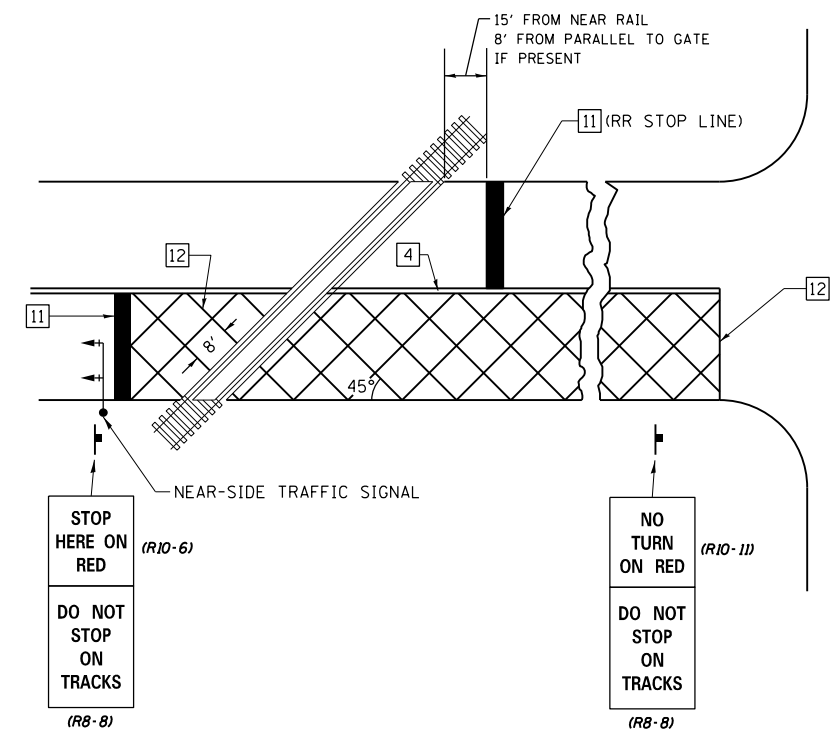

GENERAL NOTES

- SUPPLEMENTAL PAVEMENT MARKINGS TO BE INSTALLED ONLY ON APPROACHES TO INTERSECTIONS CONTROLLED BY TRAFFIC SIGNALS WHICH ARE INTERCONNECTED WITH THE RAILROAD WARNING SIGNALS.
- EXTEND PAVEMENT MARKINGS TO THE INTERSECTION ONLY WHERE NEAR-SIDE TRAFFIC SIGNALS ARE USED.

SUPPLEMENTAL PAVEMENT MARKING TREATMENT FOR RAILROAD-HIGHWAY GRADE CROSSING

NOT TO SCALE

Note: All dimensions are in INCHES (millimeters) unless otherwise shown.

DISTRICT 7 DETAIL NO. 7800001

FILE NAME =	USER NAME = steffenmk	DESIGNED -	REVISED -	<b>STATE OF ILLINOIS DEPARTMENT OF TRANSPORTATION</b>	<b>PAVEMENT MARKING AND RAISED REFLECTIVE PAVEMENT MARKERS (RURAL &amp; URBAN APPLICATIONS)</b>	F.A.U. RTE.	SECTION	COUNTY	TOTAL SHEETS	SHEET NO.	
c:\pwork\pwork\stevfenmk\d0157803\074282-sh1-details.dgn	PLOT SCALE = 100.0000' / 1" =	DRAWN -	REVISED -			8379	12RIN	Effingham	36	18	
PLOT DATE = 5/8/2014	DATE -	CHECKED -	REVISED -			CONTRACT NO. 74282		ILLINOIS FED. AID PROJECT			
		DATE -	REVISED -			SCALE:	SHEET NO. 4 OF 4 SHEETS	STA.	TO STA.		

TYPICAL PLACEMENT OF PRISMATIC CURB REFLECTORS

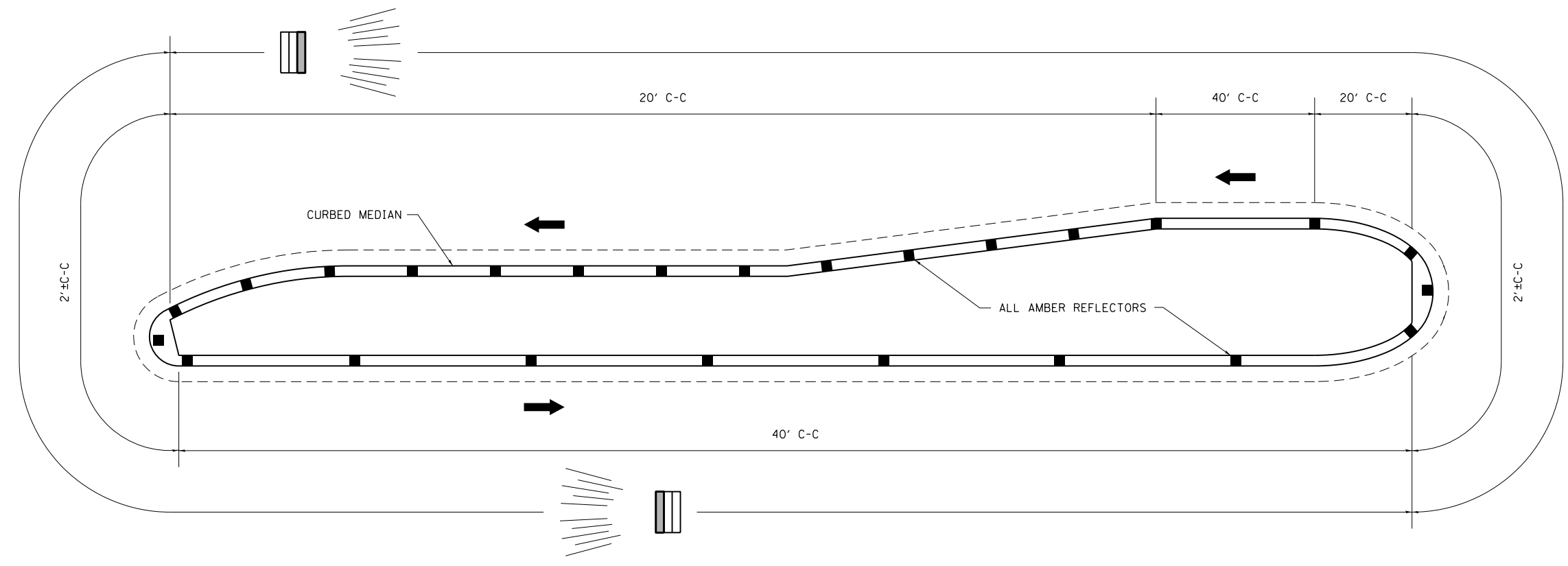

1. PRISMATIC REFLECTORS SHALL BE MONO-DIRECTIONAL AND POSITIONED SO THAT THE REFLECTIVE FACE IS FACING THE APPROACHING TRAFFIC.
2. PRISMATIC REFLECTORS SHALL BE SECURED IN PLACE WITH AN EPOXY ADHESIVE.
3. PRISMATIC REFLECTORS SHALL BE EITHER AMBER OR CRYSTAL IN COLOR.
4. REFER TO SCHEDULES FOR PRISMATIC REFLECTOR QUANTITIES.
5. USE A MINIMUM OF 3 REFLECTORS ON ISLAND NOSES.

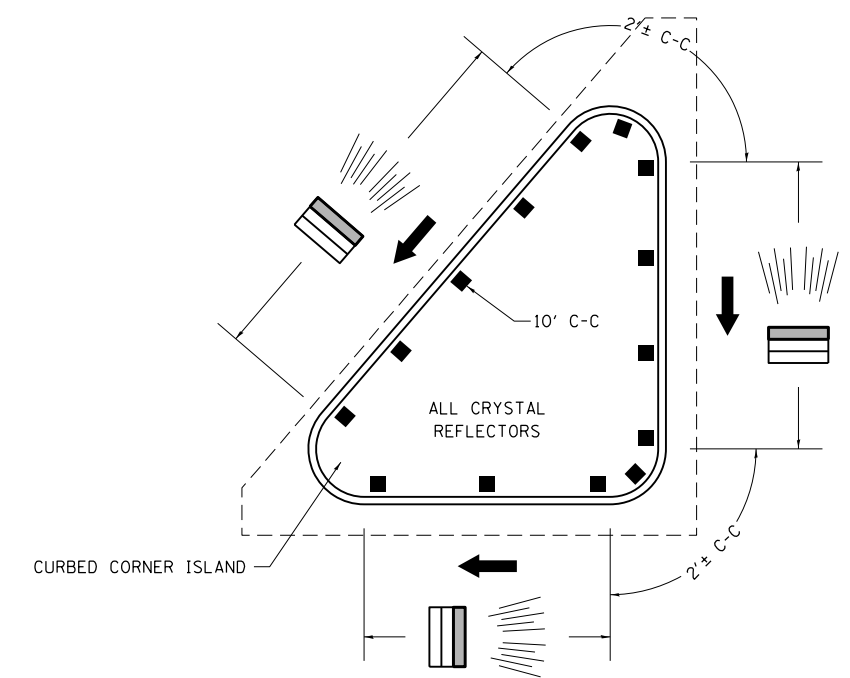

**LEGEND**

➔ DIRECTION OF TRAFFIC

■ PRISMATIC REFLECTOR

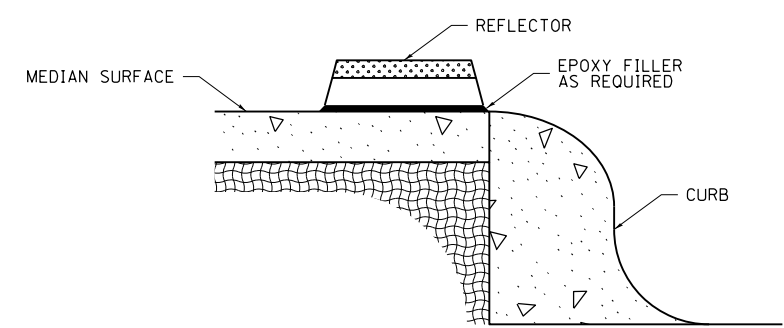

SECTION VIEW

NOT TO SCALE

FILE NAME =	USER NAME = steffenmk	DESIGNED -	REVISED -
c:\pw\work\p\idot\steffenmk\d0157803\074282-shr-details.dgn		DRAWN -	REVISED -
Default	PLOT SCALE = 100.0000' / 1in.	CHECKED -	REVISED -
	PLOT DATE = 5/8/2014	DATE -	REVISED -

STATE OF ILLINOIS  
DEPARTMENT OF TRANSPORTATION

PRISMATIC CURB REFLECTOR

SCALE: SHEET OF SHEETS STA. TO STA.

DISTRICT 7 DETAIL NO. 78200300				
F.A.U. RTE.	SECTION	COUNTY	TOTAL SHEETS	SHEET NO.
8379	112RIN	Effingham	36	19
			CONTRACT NO. 74282	
ILLINOIS FED. AID PROJECT				

TRAFFIC SIGNAL GENERAL NOTES

THE TRAFFIC SIGNAL PORTION OF THIS PROJECT CONSISTS OF MODIFICATION OF TRAFFIC SIGNALS AT THE INTERSECTION OF US 45 & RICKELMAN AVENUE, EFFINGHAM COUNTY.

THE EXISTING UTILITY LINES ARE SHOWN ON THE PLANS TO INDICATE THEIR PRESENCE AND APPROXIMATE LOCATION. THE CONTRACTOR SHALL VERIFY THE EXACT LOCATION OF ALL UNDERGROUND UTILITIES PRIOR TO BEGINNING CONSTRUCTION. CALL J.U.L.I.E. AT 1-800-892-0123. THE TRAFFIC SIGNAL UTILITY LINES WILL BE LOCATED BY IDOT, CALL 217-342-3951.

THE TRAFFIC SIGNAL ENGINEER AT THE ILLINOIS DEPARTMENT OF TRANSPORTATION SHALL BE NOTIFIED AT 217-342-8291 AT LEAST 72 HOURS PRIOR TO TURNING ON ANY FLASHER OR CONTROLLER UNIT.

THE CONTRACTOR SHALL ARRANGE FOR A FACTORY OR SUPPLIER REPRESENTATIVE TO BE PRESENT AT THE INTERSECTION WHEN THE SIGNALS ARE TURNED ON. THE REPRESENTATIVE SHALL MAKE CERTAIN THAT ALL EQUIPMENT OPERATES TO THE SATISFACTION OF THE ENGINEER.

A 2 FOOT MINIMUM, 6 FOOT DESIRABLE, HORIZONTAL CLEARANCE SHALL BE MAINTAINED FROM THE BACK OF CURB TO THE EDGE OF HANDHOLES, JUNCTION BOXES AND SIGNAL POST FOUNDATIONS.

ALL HARDWARE SHALL BE TIGHTENED AND WELL SECURED. CABLES SHALL BE NEATLY WOUND IN HANDHOLES. CABLES SHALL BE NEATLY TRAINED IN THE CONTROLLER CABINET.

ALL THREADS OF BOLTS USED IN ASSEMBLY OF TRAFFIC SIGNAL COMPONENTS SHALL BE COATED WITH A NON-LEAD BASED ANTI-SEIZE COMPOUND, SIMILAR TO LEAD PLATE, PRIOR TO ASSEMBLY.

NO ADDITIONAL COMPENSATION WILL BE ALLOWED FOR PLACING CONDUIT AT GREATER THAN 2 FOOT MINIMUM DEPTH TO AVOID OBSTACLES SUCH AS UNDERGROUND UTILITIES.

THE CONTRACTOR IS RESPONSIBLE FOR UNCOVERING OR HAND DIGGING AROUND UTILITIES AS NECESSARY. THE COST OF THIS WORK SHALL BE INCLUDED WITH THE UNDERGROUND CONDUIT PAY ITEM.

THE NUMBER OF CONDUCTORS FOR ELECTRIC CABLES AS SHOWN ON THE PLANS SHALL BE THE MINIMUM NUMBER OF CONDUCTORS FURNISHED FOR EACH LOCATION. THE CONTRACTOR MAY SUBSTITUTE AN ELECTRIC CABLE WITH MORE CONDUCTORS THAN SPECIFIED BUT NO ADDITIONAL COMPENSATION WILL BE MADE FOR THE EXTRA CONDUCTORS.

ALL NEW TRAFFIC SIGNAL WIRING SHALL EXTEND FROM CONTROLLER TO SIGNAL. SPLICES IN HANDHOLES WILL NOT BE ALLOWED.

ALL MAST ARM MOUNTED SIGNAL HEADS ON AN INDIVIDUAL MAST ARM SHALL BE MOUNTED SO THAT THE RED INDICATIONS ARE LEVEL WITH EACH OTHER.

ALL MAST ARM MOUNTED SIGNAL HEADS SHALL BE MOUNTED AS TO ALIGN WITH THE CENTER OF THE LANE.

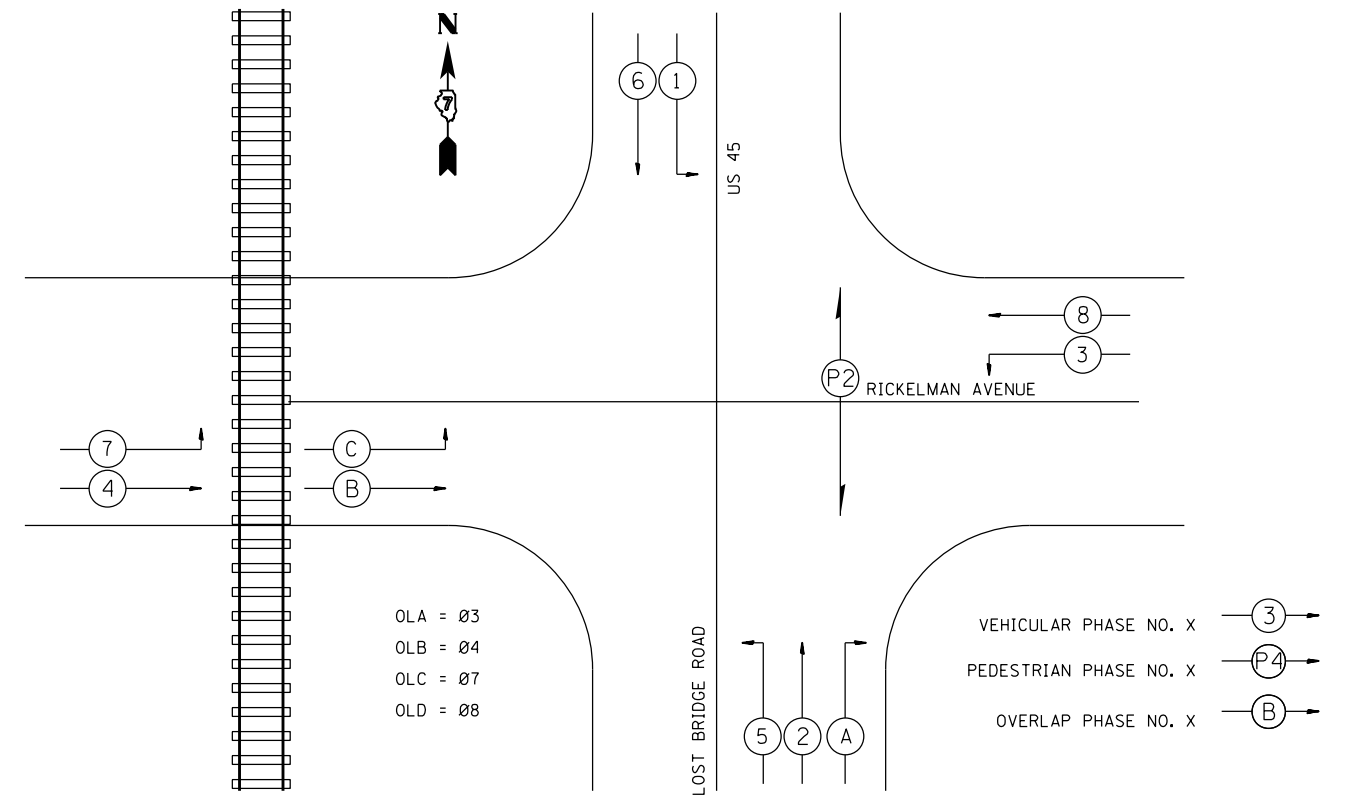

PHASE DESIGNATION DIAGRAM

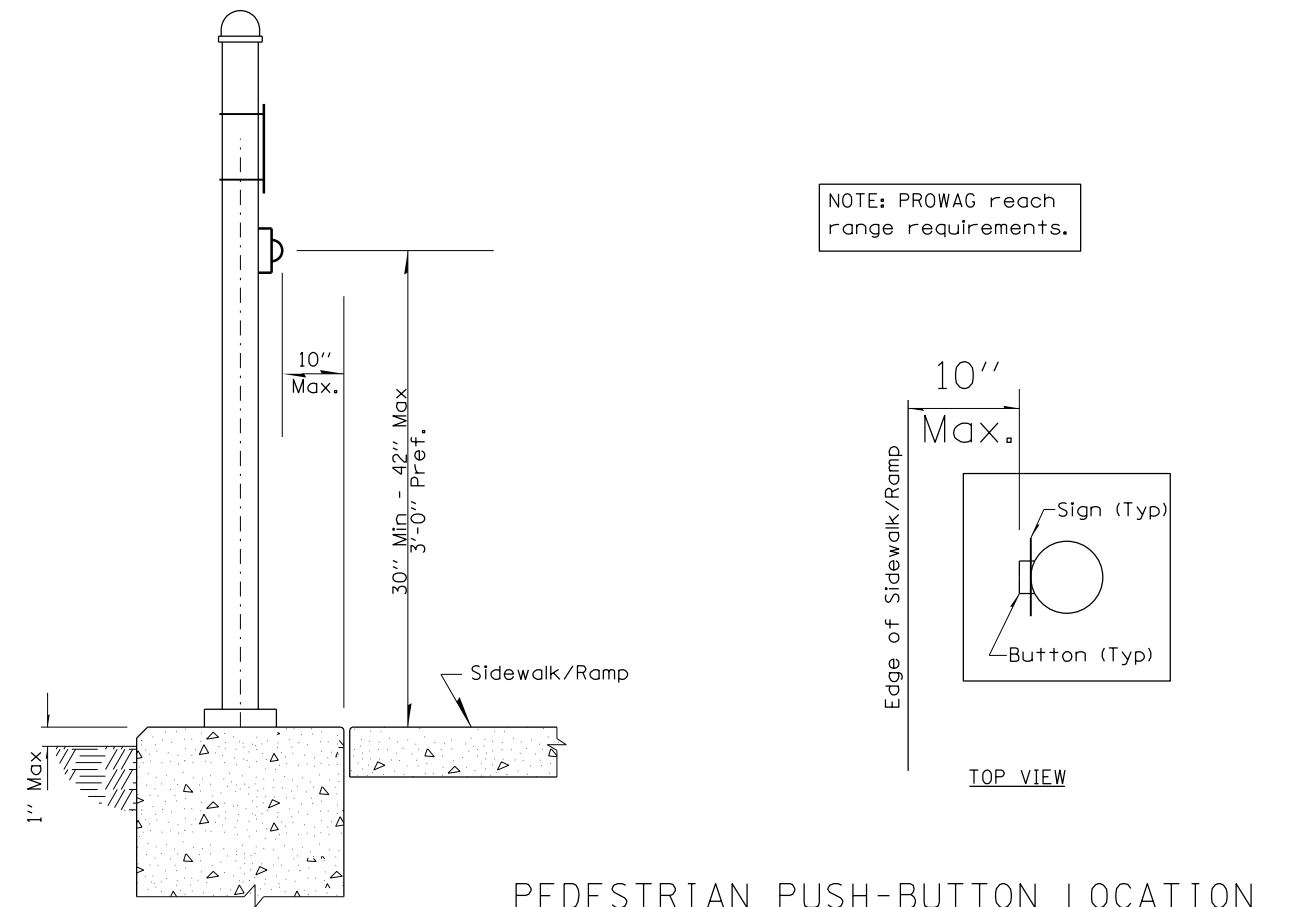

PEDESTRIAN PUSH-BUTTON LOCATION

NOTE:  
 A Total of Two (2) "No Right Turn" symbol signs (both bracket mounted) and Two (2) "No Left Turn" symbol signs (one bracket mounted and one mast arm mounted shall be furnished and installed.

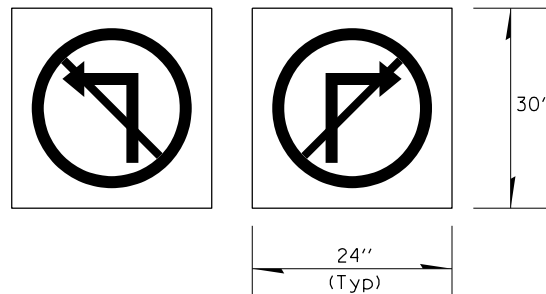

ILLUMINATED SIGN, LED

LED BLANK OUT, RAILROAD PRE-EMPTIVE ACTIVATION

FILE NAME =	USER NAME = steffenmk	DESIGNED -	REVISED -
ei:\pw\work\p\idot\steffenmk\d0157803\074282-sh-t-TS.dgn		DRAWN -	REVISED -
Default	PLOT SCALE = 40.0000' / in.	CHECKED -	REVISED -
	PLOT DATE = 5/8/2014	DATE -	REVISED -

**STATE OF ILLINOIS  
 DEPARTMENT OF TRANSPORTATION**

**TRAFFIC SIGNALS  
 GENERAL NOTES & DETAILS**

SCALE: SHEET 1 OF 5 SHEETS STA. TO STA.

F.A.U. RTE.	SECTION	COUNTY	TOTAL SHEETS	SHEET NO.
8379	12RIN	Effingham	36	20
CONTRACT NO. 74282			ILLINOIS FED. AID PROJECT	

BILL OF MATERIALS - US 45 & RICKELMAN AVENUE

ITEM	UNIT	QUANTITY
UNDERGROUND CONDUIT, PVC, 3/4 " DIA.	FOOT	10.0
UNDERGROUND CONDUIT, PVC, 1 1/2 " DIA.	FOOT	272.0
UNDERGROUND CONDUIT, PVC 2" DIA.	FOOT	149.0
HANDHOLE	EACH	1.0
GULFBOX JUNCTION	EACH	2.0
ELECTRIC CABLE IN CONDUIT, SIGNAL NO. 14 3C	FOOT	424.0
ELECTRIC CABLE IN CONDUIT, SIGNAL NO. 14 7C	FOOT	679.0
ELECTRIC CABLE IN CONDUIT, LEAD-IN NO. 14 1 PAIR	FOOT	2127.0
TRAFFIC SIGNAL POST, ALUMINUM 16 FT.	EACH	1.0
PEDESTRIAN PUSH-BUTTON POST	EACH	2.0
CONCRETE FOUNDATION, TYPE A	FOOT	3.0
DRILL EXISTING HANDHOLE	EACH	4.0
SIGNAL HEAD, POLYCARBONATE, LED, 1-FACE, 5-SECTION, MAST ARM MOUNTED	EACH	1.0
SIGNAL HEAD, POLYCARBONATE, LED, 2-FACE, 5 SECTION, BRACKET MOUNTED	EACH	1.0
TRAFFIC SIGNAL BACKPLATE, LOUVERED, FORMED PLASTIC	EACH	3.0
DETECTOR LOOP, TYPE 1	FOOT	812.0
LIGHT DETECTOR	EACH	4.0
LIGHT DETECTOR AMPLIFIER	EACH	1.0
PEDESTRIAN PUSH-BUTTON	EACH	2.0
ILLUMINATED SIGN, LED	EACH	4.0
MODIFY EXISTING CONTROLLER CABINET	EACH	1.0
REMOVE ELECTRIC CABLE FROM CONDUIT	FOOT	852.0
REMOVE EXISTING TRAFFIC SIGNAL EQUIPMENT	EACH	1.0
REMOVE EXISTING HANDHOLE	EACH	2.0
REMOVE EXISTING CONCRETE FOUNDATION	EACH	2.0
SPARE FULL ACTUATED CONTROLLER, SPECIAL	EACH	1.0
FULL-ACTUATED CONTROLLER IN EXISTING CABINET	EACH	1.0
ELECTRIC CABLE IN CONDUIT NO. 20 3/C, TWISTED, SHIELDED	FOOT	1123.0



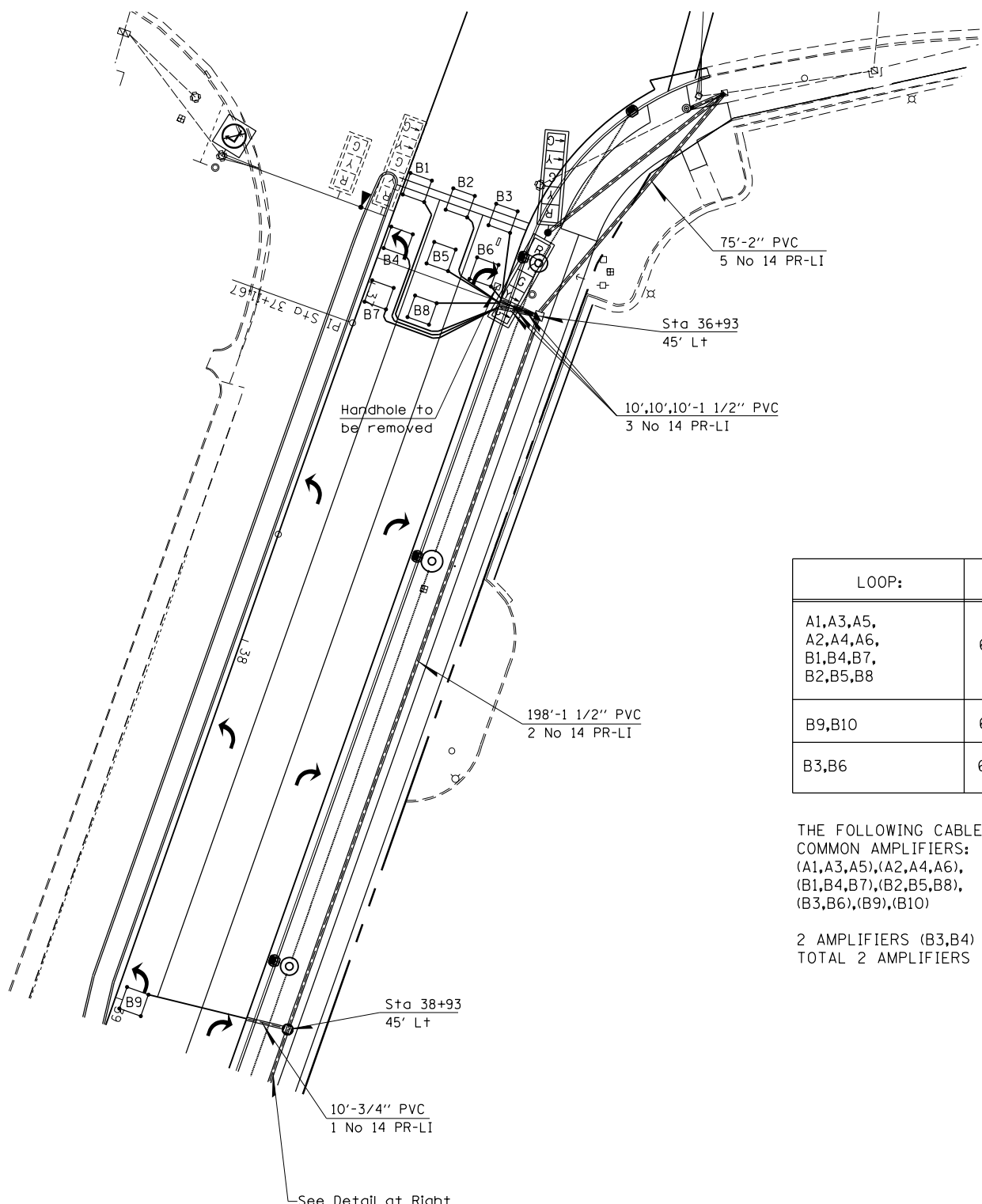

NUMBER OF TURNS REQUIRED  
IN DETECTOR LOOPS

6 X 6	LOOP SIZE
	2 TURNS
	3 TURNS
0 545	4 TURNS
546 818	5 TURNS
819 1145	6 TURNS
1146 1527	7 TURNS
1528 1964	8 TURNS
1965 2455	9 TURNS
2456 3000	10 TURNS

THE NUMBERS IN THE TABLE REPRESENT THE LENGTH OF ELECTRIC CABLE FROM THE LOOP TO THE CABINET

LOOP:	SIZE:	MODE:	QUADRA-POLE:	DELAY:
A1,A3,A5, A2,A4,A6, B1,B4,B7, B2,B5,B8	6' X 6'	NORMAL	NO	0
B9,B10	6' X 6'	EXTENDED	NO	0
B3,B6	6' X 6'	DELAY	NO	15

THE FOLLOWING CABLES SHALL BE WIRED TO COMMON AMPLIFIERS:  
(A1,A3,A5),(A2,A4,A6),  
(B1,B4,B7),(B2,B5,B8),  
(B3,B6),(B9),(B10)  
2 AMPLIFIERS (B3,B4) & (B9)  
TOTAL 2 AMPLIFIERS

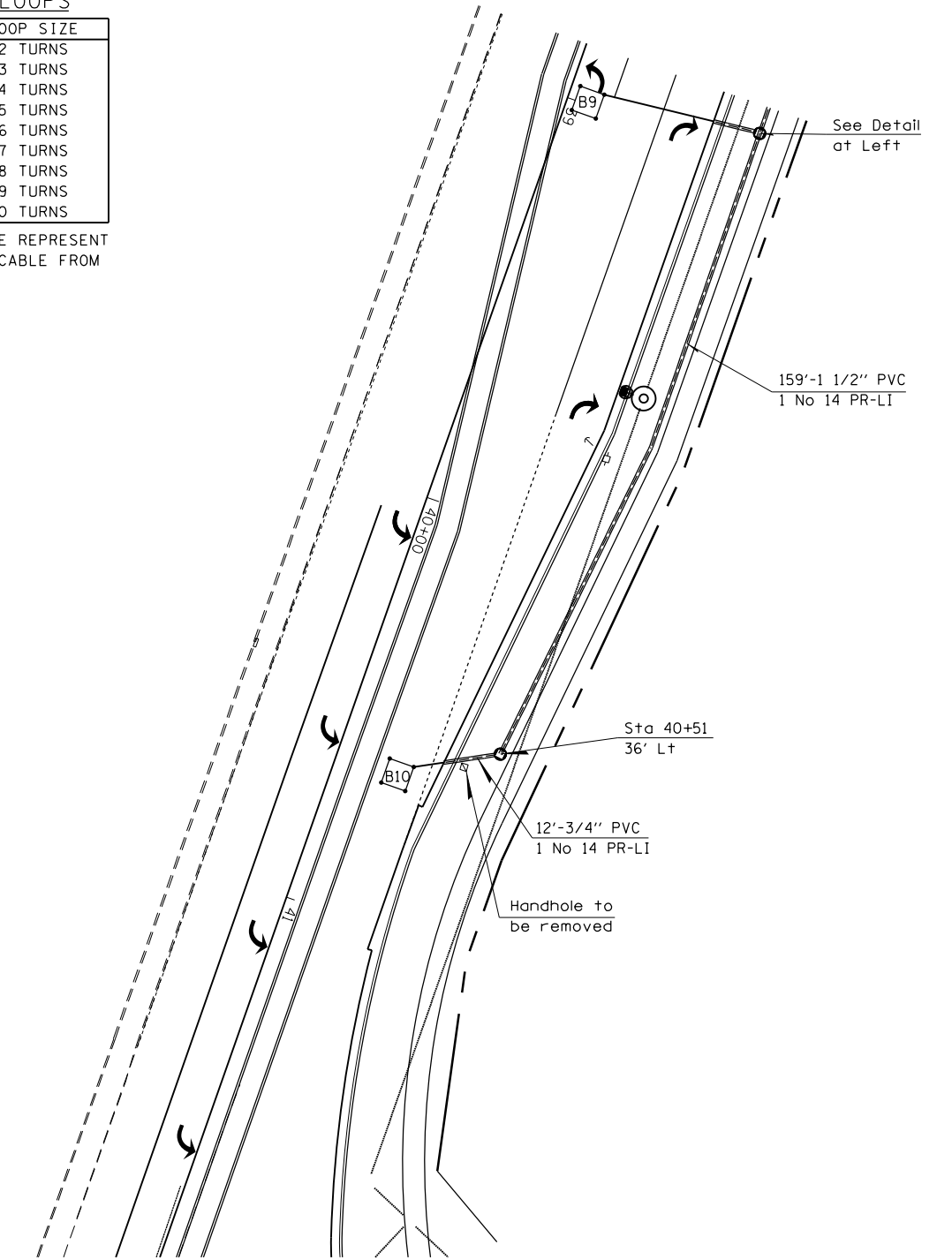

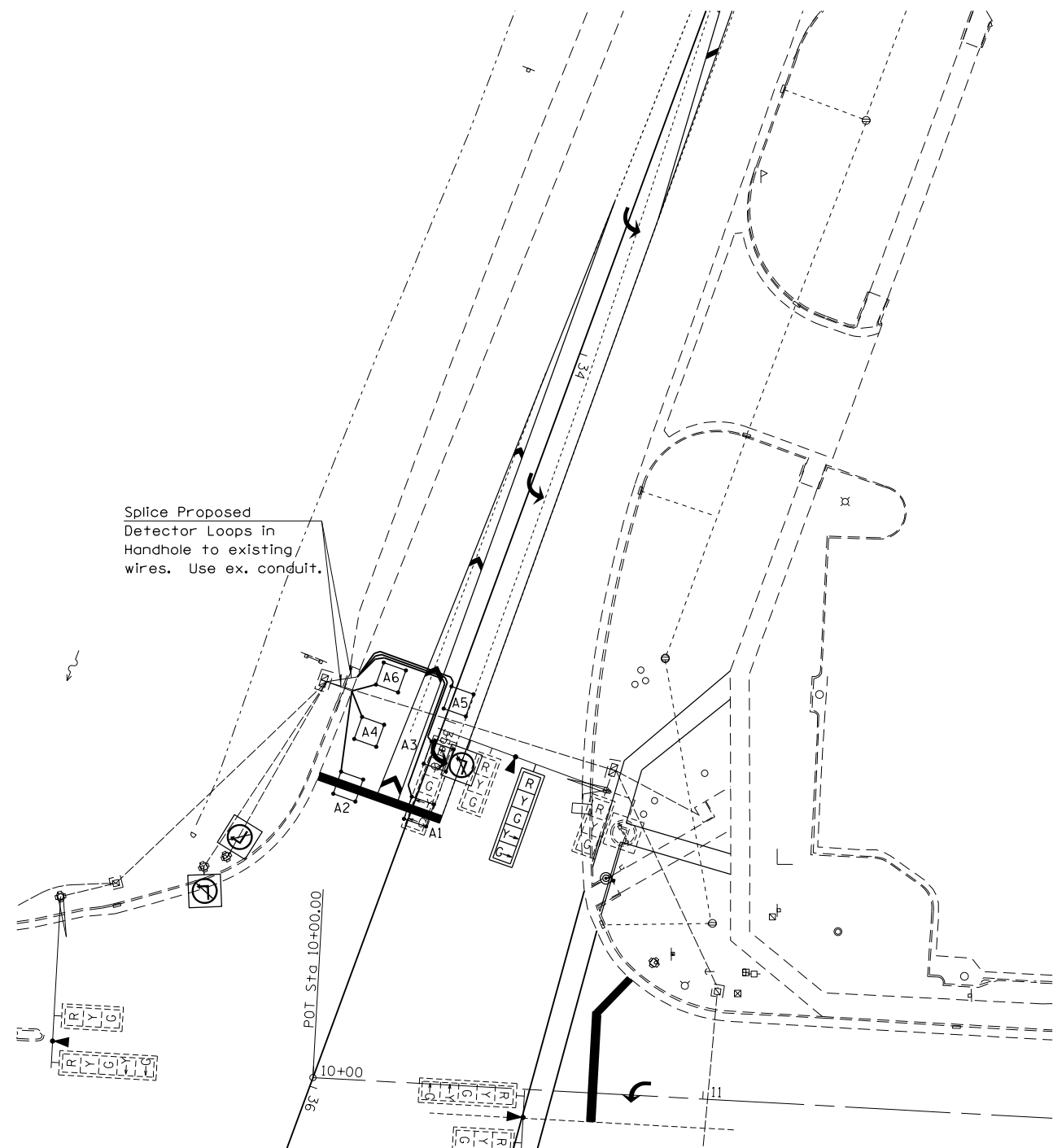

NUMBER OF TURNS REQUIRED

IN DETECTOR LOOPS

6 X 6		LOOP SIZE
		2 TURNS
		3 TURNS
0	545	4 TURNS
546	818	5 TURNS
819	1145	6 TURNS
1146	1527	7 TURNS
1528	1964	8 TURNS
1965	2455	9 TURNS
2456	3000	10 TURNS

THE NUMBERS IN THE TABLE REPRESENT THE LENGTH OF ELECTRIC CABLE FROM THE LOOP TO THE CABINET

Splice Proposed  
Detector Loops in  
Handhole to existing  
wires. Use ex. conduit.

FILE NAME =	USER NAME = steffenmk	DESIGNED -	REVISED -
ct:\pw\work\p\dot\stef\enmk\d0157803\074282-sh-t-TS.dgn		DRAWN -	REVISED -
Default	PLOT SCALE = 40.0000' / in.	CHECKED -	REVISED -
	PLOT DATE = 5/8/2014	DATE -	REVISED -

STATE OF ILLINOIS  
DEPARTMENT OF TRANSPORTATION

TRAFFIC SIGNALS  
DETECTOR LOOP LAYOUT-NORTH LEG

SCALE: SHEET 5 OF 5 SHEETS STA. TO STA.

F.A.U. RTE.	SECTION	COUNTY	TOTAL SHEETS	SHEET NO.
8379	112RIN	Effingham	36	24
ILLINOIS FED. AID PROJECT			CONTRACT NO. 74282	



# TYPICAL APPLICATION OF DETECTOR LOOPS

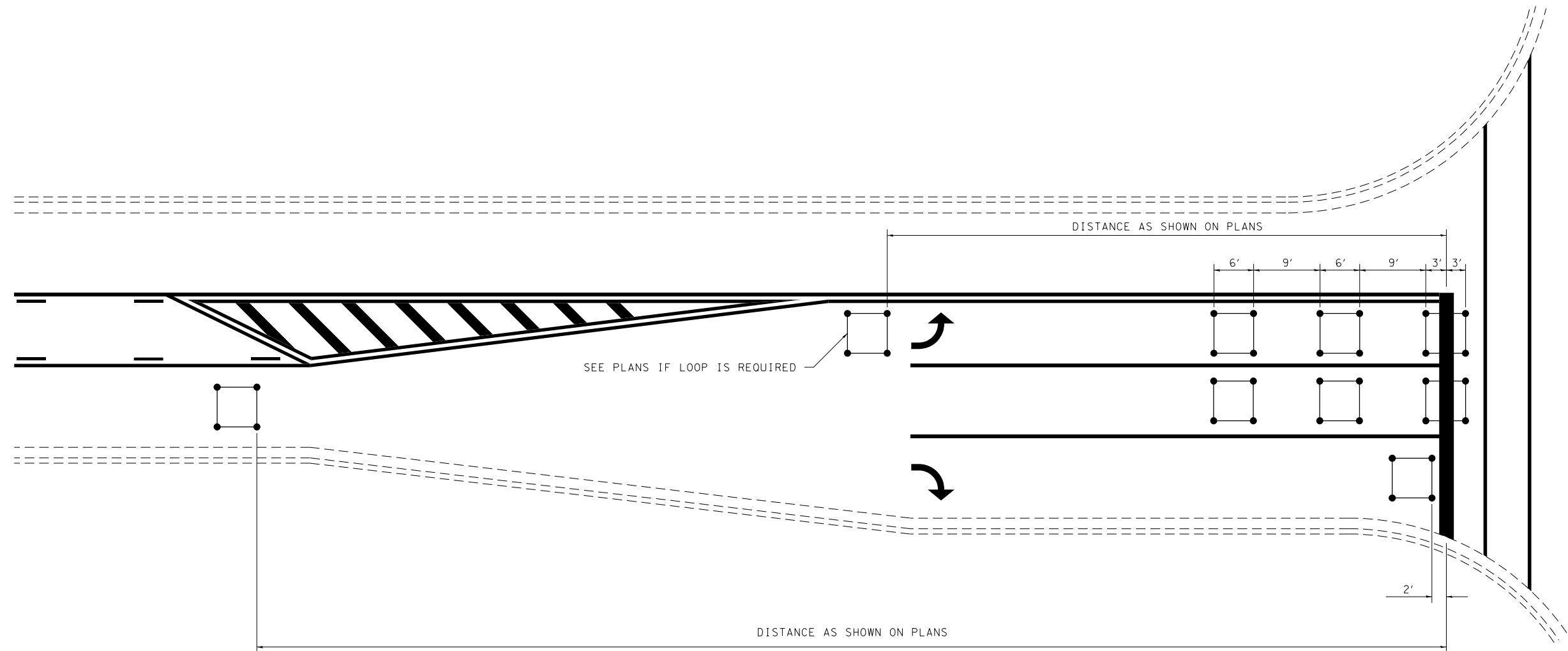

**NOTE:**

1. EACH LOOP SHALL HAVE ITS OWN HOMERUN TO THE GULFBOX/HANDHOLE.
2. LOOPS SHOULD BE CENTERED IN EACH LANE.
3. USE 6' BY 6' LOOPS FOR LANE WIDTHS OF 11' OR GREATER.
4. USE 5' BY 5' LOOPS IF LANE WIDTH IS LESS THAN 11'.

NOT TO SCALE

**DISTRICT 7 DETAIL NO. 88600100**

FILE NAME =	USER NAME = steffenmk	DESIGNED -	REVISED - MKS 4-08
ct:\pw\work\p\dot\stefjenmk\d0157803\074282-sh1-TS.dgn		DRAWN -	REVISED -
	PLOT SCALE = 40.0000' / in.	CHECKED -	REVISED -
	PLOT DATE = 5/8/2014	DATE -	REVISED -

**STATE OF ILLINOIS  
DEPARTMENT OF TRANSPORTATION**

**TYPICAL APPLICATIONS OF DETECTOR LOOPS**

SCALE: SHEET NO. OF SHEETS STA. TO STA.

F.A.U. RTE.	SECTION	COUNTY	TOTAL SHEETS	SHEET NO.
8379	(12)RIN	Effingham	36	25
FED. ROAD DIST. NO. ILLINOIS FED. AID PROJECT			CONTRACT NO. 74282	

# DETAIL OF CONCRETE MEDIAN, TYPE SB-6.06 (DOWELLED)

## GENERAL NOTES

1. THE GENERAL NOTES FOR STANDARD 606301 SHALL APPLY.
2. SECTION G-G SHALL BE THE SAME AS SHOWN ON STANDARD 606301.
3. DOWEL BARS @ 36" CTS. OR AS DIRECTED BY THE ENGINEER.

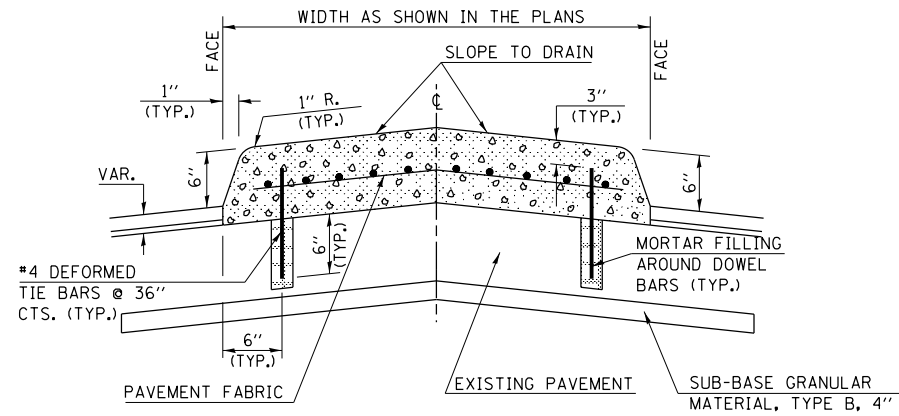

SECTION A-A

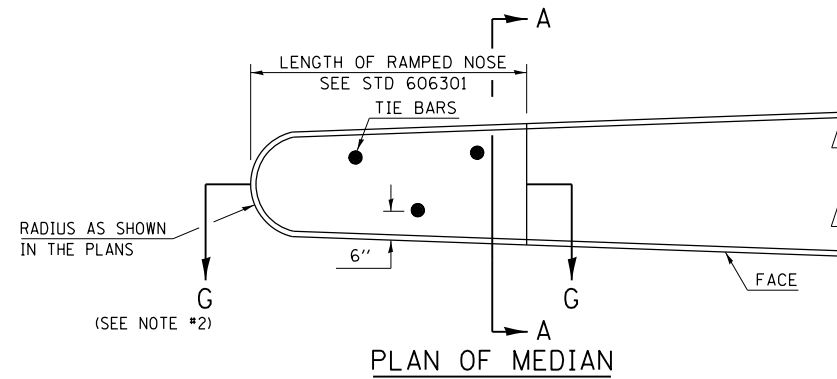

PLAN OF MEDIAN

ALL DIMENSIONS ARE IN INCHES  
UNLESS OTHERWISE SHOWN.

FILE NAME =	USER NAME = steffenmk	DESIGNED -	REVISED -
c:\pw\work\p\dot\steffenmk\d0157803\074282-sht-details.dgn		DRAWN -	REVISED -
Default	PLOT SCALE = 100.0000' / 1"	CHECKED -	REVISED -
	PLOT DATE = 5/8/2014	DATE -	REVISED -

STATE OF ILLINOIS  
DEPARTMENT OF TRANSPORTATION

DETAIL OF CONCRETE MEDIAN, TYPE SB-6.06 (DOWELLED)

SCALE: SHEET OF SHEETS STA. TO STA.

F.A.U. RTE.	SECTION	COUNTY	TOTAL SHEETS	SHEET NO.
8379	112RIN	Effingham	36	26
CONTRACT NO. 74282			ILLINOIS FED. AID PROJECT	

FINAL SURVEY	SURVEYED	BY	DATE
NOTE BOOK	PLOTTED		
NO.	TEMPLATE		
	AREAS CHECKED		

ORIGINAL SURVEY	SURVEYED	BY	DATE
NOTE BOOK	PLOTTED		
NO.	TEMPLATE		
	AREAS CHECKED		

