

NOTE: EXISTING PAVEMENT IS 26' E-E.

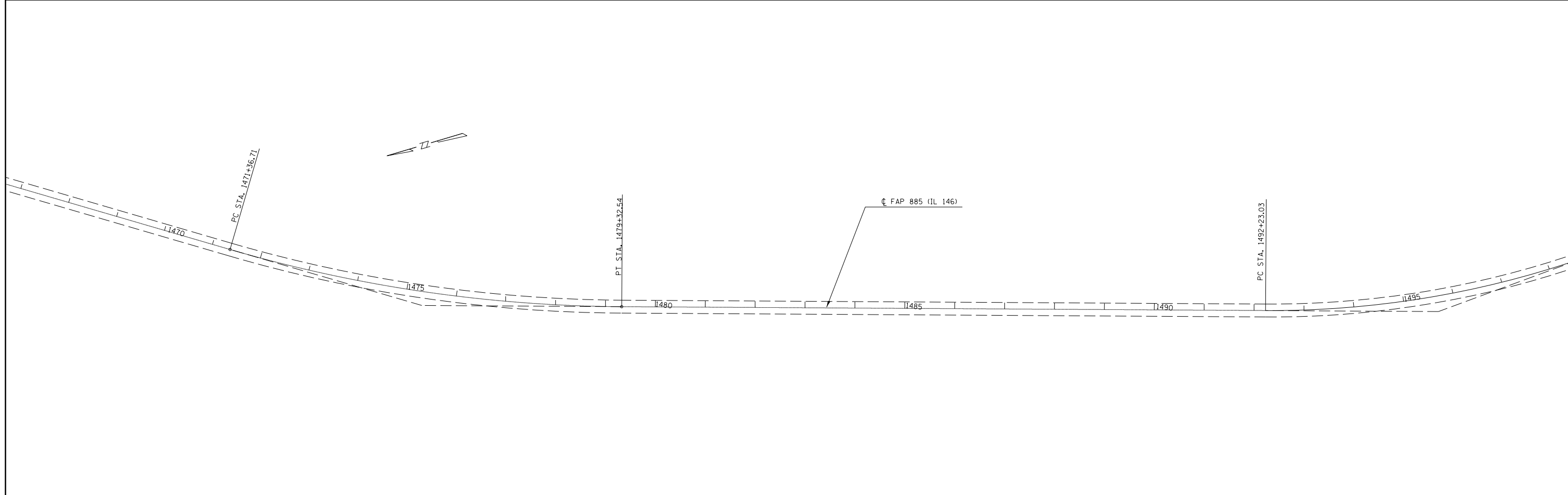
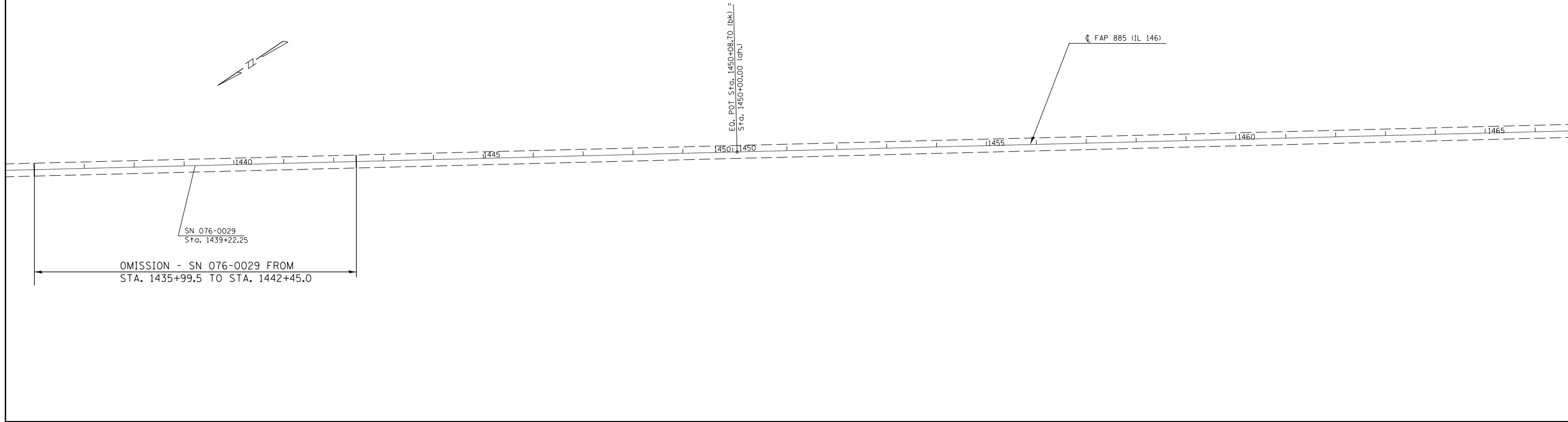

FILE NAME =	USER NAME = mccordkr	DESIGNED -	REVISED -	STATE OF ILLINOIS DEPARTMENT OF TRANSPORTATION	PLAN LAYOUT #5			F.A.P. RTE.	SECTION	COUNTY	TOTAL SHEETS	SHEET NO.
c:\pwork\pwork\mccordkr\0402536\78339-sh1-plan.dgn	DRAWN -	REVISED -	885					7RS-3,6RS-7	POPE/HARDIN	28	21	
Default	PLOT SCALE = 200.0000' / in.	CHECKED -	REVISED -		SCALE: SHEET OF SHEETS STA. TO STA.			CONTRACT NO. 78339				
	PLOT DATE = 6/27/2014	DATE -	REVISED -		ILLINOIS FED. AID PROJECT							