

STATE OF ILLINOIS
 DEPARTMENT OF TRANSPORTATION
 DIVISION OF HIGHWAYS
**PROPOSED
 HIGHWAY PLANS**

F.A.P. RTE.	SECTION	COUNTY	TOTAL SHEETS	SHEET NO.
885	7RS-3,6RS-7	POPE/HARDIN	28	1
		ILLINOIS	CONTRACT NO. 78339	

FOR INDEX OF SHEETS, SEE SHEET NO. 3

ADT - 1617 (2014)
 PV = 1434
 MU = 31
 SU = 152
 TRUCK = 11%

EQUATION STATIONS:

- Eq. Sta. 11+05.80 (BK) = Sta. 1188+43.20 (AH)
- Eq. Sta. 1236+95.78 (BK) = Sta. 1240+34.48 (AH)
- Eq. Sta. 1254+76.55 (BK) = Sta. 1254+66.55 (AH)
- Eq. Sta. 1274+14.98 (BK) = Sta. 1274+02.49 (AH)
- Eq. Sta. 1292+05.50 (BK) = Sta. 1292+20.63 (AH)
- Eq. Sta. 1312+98.58 (BK) = Sta. 1312+94.18 (AH)
- Eq. Sta. 1367+91.97 (BK) = Sta. 1367+92.48 (AH)
- Eq. Sta. 1386+99.52 (BK) = Sta. 1387+09.36 (AH)
- Eq. POT Sta. 1450+08.70 (BK) = Sta. 1450+00.0 (AH)
- Eq. Sta. 1499+08.35 (BKK) = Sta. 1499+11.44 (AH)
- Eq. POT Sta. 1622+09.07 (BK) = Sta. 1604A+60.25 (AH)
- Eq. POT Sta. 1623A+00.0 (BK) = Sta. 1623+00.0 (AH)
- Eq. Sta. 1625+29.34 (BK) = Sta. 1625+31.55 (AH)
- Eq. Sta. 1643+40.63 (BK) = Sta. 1643+63.79 (AH)
- Eq. Sta. 1653+03.96 (BK) = Sta. 1652+88.05 (AH)
- Eq. Sta. 1665+62.18 (BK) = Sta. 1667+09.59 (AH)
- Eq. Sta. 1674+17.61 (BK) Adams St./IL 146 =
- Sta. 1266+34.00 (AH) Main St./IL 146 =

FAP ROUTE 885 (IL 146)
 SECTION 7RS-3,6RS-7

3P RESURFACING
 POPE & HARDIN COUNTIES

C-99-015-13

D-99-013-13

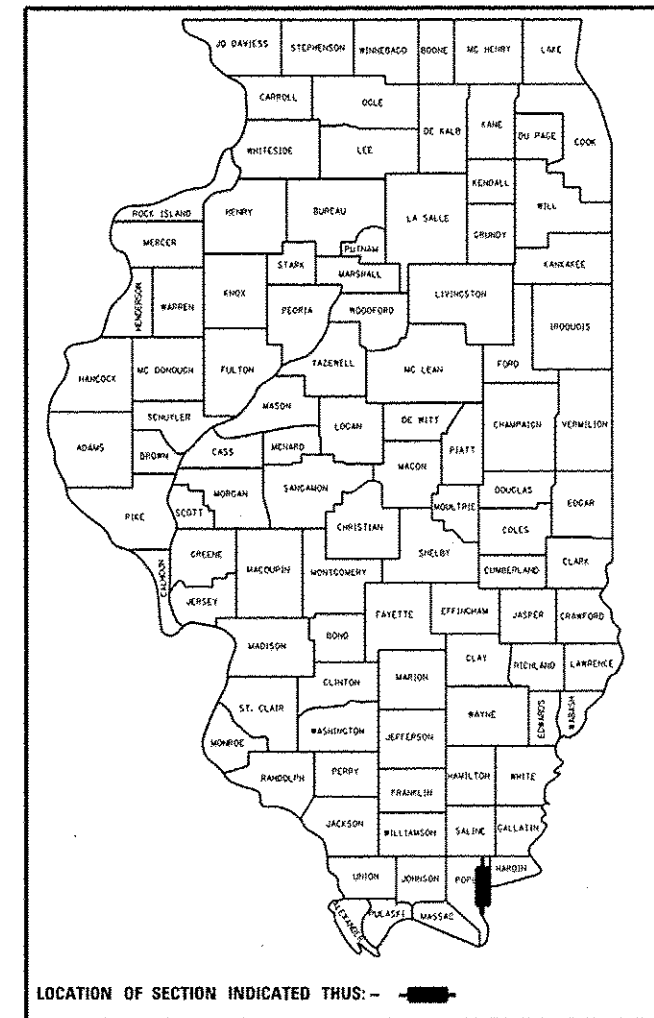

PROPOSED PROJECT ENDS
 STA. 1266+10 (BUTT JOINT)

PROPOSED PROJECT BEGINS
 STA. 9+79.61 (BUTT JOINT)

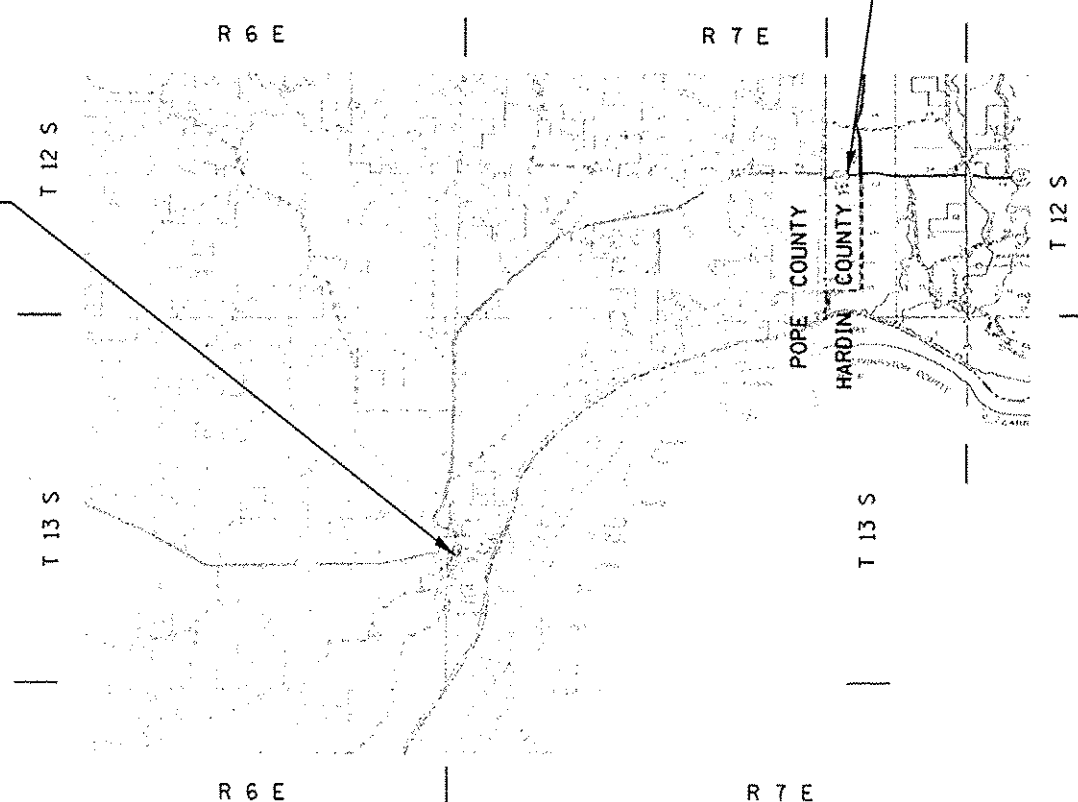

TOWNSHIPS: GOLCONDA, COLUMBUS & WEBSTER

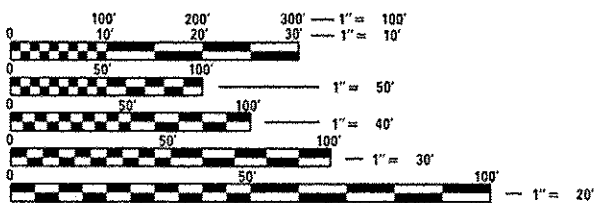

FULL SIZE PLANS HAVE BEEN PREPARED USING STANDARD ENGINEERING SCALES. REDUCED SIZED PLANS WILL NOT CONFORM TO STANDARD SCALES. IN MAKING MEASUREMENTS ON REDUCED PLANS, THE ABOVE SCALES MAY BE USED.

J.U.L.I.E.
 JOINT UTILITY LOCATION INFORMATION FOR EXCAVATION
 1-800-892-0123
 OR 811

PROJECT ENGINEER: CHARLES STEIN (618)351-5210
 PROJECT MANAGER: KATHI MCCORD (618)351-5319

GROSS LENGTH = 49,984.87 FT. = 9.47 MILE
 NET LENGTH = 48,244.33 FT. = 9.14 MILE

CONTRACT NO. 78339

STATE OF ILLINOIS
 DEPARTMENT OF TRANSPORTATION
 DIVISION OF HIGHWAYS

SUBMITTED June 26, 2014

Jeffrey L. Keen
 DEPUTY DIRECTOR OF HIGHWAYS, REGION ENGINEER

Aug 15, 2014
John D. Baranzelli, PE
 ENGINEER OF DESIGN AND ENVIRONMENT

Aug 15, 2014
Omer Osman, PE
 DIRECTOR OF HIGHWAYS, CHIEF ENGINEER

PRINTED BY THE AUTHORITY
 OF THE STATE OF ILLINOIS

Prepared By: Joe Zdaniewicz
DISTRICT STUDIES & PLANS ENGINEER

Examined By: J.P.S.
DISTRICT LAND ACQUISITION ENGINEER

Examined By: Carrie Nels
DISTRICT PROGRAM DEVELOPMENT ENGINEER

Examined By: Kevin Kelly
DISTRICT OPERATIONS ENGINEER

Examined By: K.R.S.
DISTRICT PROJECT IMPLEMENTATION ENGINEER

Examined By: Douglas Helfrich
DISTRICT CONSTRUCTION ENGINEER

Examined By: Brian Tucker
DISTRICT MATERIALS ENGINEER

FILE NAME *	USER NAME = mcoorckr	DESIGNED -	REVISED -
c:\pwwork\pwwork\mcoorckr\10482536\7032\pwwork\plan.dgn		DRAWN -	REVISED -
#MODEL NAME#	PLOT SCALE = 200.0000 / 1" =	CHECKED -	REVISED -
	PLOT DATE = 6/23/2014	DATE -	REVISED -

STATE OF ILLINOIS
DEPARTMENT OF TRANSPORTATION

SCALE:	SHEET	OF	SHEETS	STA.	TO	STA.	F.A.P. RTE. 885	SECTION TRS-3,6RS-7	COUNTY POPE/HARDIN	TOTAL SHEETS 2	SHEET NO. 2
ILLINOIS FED. AID PROJECT											

INDEX OF SHEETS

Sheet No.	Description
1	Cover Sheet
2	Signature Sheet
3	Index of Sheets, General Notes, Standards
4	Mixture Requirements, MTD Crossing Restrictions
5 - 6	Summary of Quantities
7 - 9	Typicals for FAP 885 (IL 146)
10 - 12	Pavement Resurfacing Schedule
13 - 16	Pavement Marking Schedule
17 - 24	Plan Layout for FAP 885 (IL 146)
25	Plan Layout for FAP 885 (IL 146); Detail for New Ramps at IL 146/Main St. Intersection in Golconda.
26	Detail: Butt Joint at Beginning and End of Project and at Structures.
27 - 28	District Standard Details: Temp. Hot-Mix Asphalt Transitions, Uneven Pavement Sign, Rough Grooved Surface Sign

STANDARDS:

- 424001-07
- 442201-03
- 701001-02
- 701006-05
- 701011-04
- 701301-04
- 701306-03
- 701311-03
- 701336-06
- 701901-03
- 780001-04
- 781001-03

GENERAL NOTES

THE THICKNESS OF HOT-MIX ASPHALT MIXTURE SHOWN ON THE PLANS IS THE NOMINAL THICKNESS. DEVIATIONS FROM THE NOMINAL THICKNESS WILL BE PERMITTED WHEN SUCH DEVIATIONS OCCUR DUE TO IRREGULARITIES IN THE EXISTING SURFACE OR BASE ON WHICH THE HOT-MIX ASPHALT MIXTURE IS PLACED.

FACTORS USED FOR ESTIMATING PLAN QUANTITIES ARE AS FOLLOWS AND SHALL NOT BE USED FOR THE BASIS OF FINAL QUANTITIES:

ALL HOT MIX ASPHALT:	2.016 TONS / CU. YD.
ALL AGGREGATE:	2.05 TONS/ CU. YD.

AT ALL LOCATIONS WHERE THE PROPOSED HOT MIX ASPHALT OR CONCRETE PAVEMENT JOINS AN EXISTING HOT MIX ASPHALT OR CONCRETE PAVEMENT, A FULL DEPTH SAWED JOINT SHALL BE CONSTRUCTED. THE COST OF THIS JOINT WILL BE INCLUDED IN THE COST OF THE TYPE OF PAVEMENT BEING CONSTRUCTED.

THE CONTRACTOR SHALL STAMP STATIONING IN THE PROPOSED HOT MIX ASPHALT SURFACE AT 100 m (300 FT.) INTERVALS ON ALTERNATING SIDES OF THE PAVEMENT AND AS DIRECTED BY THE ENGINEER. THE STATION SYMBOL STAMPS USED SHALL BE FURNISHED BY THE CONTRACTOR. THEY SHALL BE 140 mm (5 IN.) TALL, OF A DESIGN APPROVED BY THE ENGINEER, AND SHALL REMAIN THE PROPERTY OF THE CONTRACTOR.

THE QUANTITIES SHOWN IN THE PLANS FOR PATCHING ARE ESTIMATES. THE ACTUAL AMOUNT OF PATCHING REQUIRED SHALL BE DETERMINED BY THE ENGINEER IN THE FIELD. PATCHING SURVEY WAS DONE JUNE 6, 2014.

THE QUANTITY FOR PRIME COAT WAS CALCULATED IN TWO LAYERS. ONE APPLICATION AFTER MILLING THE EXISTING SURFACE AND ONE APPLICATION AFTER PLACING THE BINDER COURSE AND SHALL BE USED AS DIRECTED BY THE ENGINEER.

THE QUANTITY OF SHORT-TERM PAVEMENT MARKING SHOWN IN THE PLANS IS BASED ON ONE APPLICATION EACH FOR THE HMA SURFACE REMOVAL, SURFACE COURSE AND BINDER COURSE.

BITUMINOUS RESURFACING SHALL BE PLACED IN A SEQUENCE THAT WILL MINIMIZE THE TIME THE CENTERLINE EDGE IS EXPOSED TO TRAFFIC. WHEN AT THE END OF A DAY'S OPERATION THE EXPOSED CENTERLINE EDGE IS GREATER THAN 600 METERS (2,000 FT.), THE CONTRACTOR SHALL BE REQUIRED TO PAVE IN THE ADJACENT LANE ON THE FOLLOWING WORK DAY.

THE CONTRACTOR SHALL COMPLETE ALL PATCHING PRIOR TO THE BITUMINOUS SURFACE REMOVAL.

COMMITMENTS: NONE

FILE NAME =	USER NAME = moardkr	DESIGNED -	REVISED -	STATE OF ILLINOIS DEPARTMENT OF TRANSPORTATION	INDEX OF SHEETS, GENERAL NOTES & HIGHWAY STANDARDS	F.A.P. RTE.	SECTION	COUNTY	TOTAL SHEETS	SHEET NO.	
c:\pwork\pvidat\moardkr\2482536\783	39-shs-plan.dgn	DRAWN -	REVISED -			885	TRS-3,GRS-T	POPE/HARDIN	28	3	
PLOT SCALE = 280.0000' / in.	CHECKED -	REVISED -	CONTRACT NO. 78339								
PLOT DATE = 8/27/2014	DATE -	REVISED -	ILLINOIS FED. AID PROJECT								
Defaults					SCALE:	SHEET	OF	SHEETS	STA.	TO STA.	

HMA MIXTURE TABLE

Location(s):	Hot-Mix Asphalt Surface Course
Mixture Use(s):	Hot-Mix Asphalt Surface Course, Mix C, N90
AC/PG:	PG64-22
ABR % (Max):	See BDE Special Provisions
Design Air Voids:	4.0 %, 90 Gyration Design
Mixture (Gradation Mixture):	IL-9.5 mm
Friction Aggregate:	C Surface
Quality Management Program:	OCP

Location(s):	Hot-Mix Asphalt Leveling Binder Course
Mixture Use(s):	Hot-Mix Asphalt Leveling Binder, N90, IL-9.5 Fine Grade
AC/PG:	PG64-22
ABR % (Max):	See BDE Special Provisions
Design Air Voids:	4.0 %, 90 Gyration Design
Mixture (Gradation Mixture):	IL-9.5mm Fine Grade
Friction Aggregate:	None
Quality Management Program:	OCP

Location(s):	Class D Patching
Mixture Use(s):	Hot-Mix Asphalt Binder Course, N90, IL-19.0mm Fine Grade
AC/PG:	PG 64-22
ABR % (Max):	See Special Provisions
Design Air Voids:	4.0%, 90 Gyration Design
Mixture (Gradation Mixture):	IL-19.0mm Fine Grade
Friction Aggregate:	None
Quality Management Program:	OC/OA

MTD CROSSING RESTRICTIONS TABLE

SN & CENTERLINE STATION ROUTE FAP 885 (IL 146)	EXISTING FILL HEIGHT OVER BOX CULVERT	THICKNESS OF EXISTING PAVEMENT OVER BOX CULVERT	MTD CROSSING RESTRICTIONS
	FOOT	FOOT	
SN 076-7013	1.0'	1'	Pending
SN 076-7014	2.5'	1'	Loaded
SN 076-7015	3.0'	1'	Loaded
SN 076-7016	3.0'	1'	Loaded
SN 076-7017	0.5'	1'	Pending
SN 076-7018	19.7'	1'	Loaded
SN 076-7019	2.0'	1'	Pending
SN 076-7020	15.0'	1'	Loaded
SN 035-7028 (Hardin Co.)	7.4'	1'	Loaded
SN 076-0005 (STA. 1659+41.97)			Pending
SN 076-0029 (STA. 1439+22.25)			Pending
SN 076-0030 (STA. 1373+26.00)			Pending
SN 076-0031 (STA. 1259+03.51)			Pending

SUMMARY OF QUANTITIES

FAP 885 (IL 146)	
100% STATE	
3P RESURFACING	
HARDIN CO.	POPE CO.
CONSTRUCTION TYPE CODE 0005	

CODE NUMBER	ITEM DESCRIPTION	UNIT	TOTAL QUANTITY	QUANTITY	QUANTITY
20034105	MATERIAL TRANSFER DEVICE	TON	17,669	859	16810
40600275	BITUMINOUS MATERIALS (PRIME COAT)	POUND	94,078	4570	89508
40600647	LEVELING BINDER (MACHINE METHOD), IL-9.5mm FG, N90	TON	5895	287	5608
40600990	TEMPORARY RAMP	SQ YD	205	15	190
40603320	HOT-MIX ASPHALT SURFACE COURSE, MIXTURE C, N90	TON	11,774	572	11202
42400400	PORTLAND CEMENT CONCRETE SIDEWALK 7 INCH	SQ FT	561		561
42400800	DETECTABLE WARNINGS	SQ FT	96		96
44000158	HOT-MIX ASPHALT SURFACE REMOVAL 2 1/4"	SQ YD	139,359	6771	132588
44000600	SIDEWALK REMOVAL	SQ FT	561		561
44201789	CLASS D PATCHES, TYPE II, 12 INCH	SQ YD	422	42	380
44201794	CLASS D PATCHES, TYPE III, 12 INCH	SQ YD	18	5	13
44201796	CLASS D PATCHES, TYPE IV, 12 INCH	SQ YD	148	15	133
44300200	STRIP REFLECTIVE CRACK CONTROL TREATMENT	FOOT	88,175	1496	86679
48102100	AGGREGATE WEDGE SHOULDERS, TYPE B	TON	1375.0	67	1308
67000400	ENGINEER'S FIELD OFFICE, TYPE A	CAL MO	3	1	2

FILE NAME =	USER NAME = macardr	DESIGNED -	REVISED -	STATE OF ILLINOIS DEPARTMENT OF TRANSPORTATION	SUMMARY OF QUANTITIES	F.A.P. RTE.	SECTION	COUNTY	TOTAL SHEETS	SHEET NO.	
er:\p\work\p\idot\macardr\08402036\78339-eh-plot.dgn		DRAWN -	REVISED -			885	7RS-3,6RS-7	POPE/HARDIN	28	5	
PLOT SCALE = 200.0000' / in.		CHECKED -	REVISED -			CONTRACT NO. 78339					
PLOT DATE = 6/27/2014		DATE -	REVISED -			SCALE:	SHEET	OF	SHEETS	STA.	TO STA.

SUMMARY OF QUANTITIES

FAP 885 (IL 146)	
100% STATE	
3P RESURFACING	
HARDIN CO.	POPE CO.
CONSTRUCTION TYPE CODE 0005	

CODE NUMBER	ITEM DESCRIPTION	UNIT	TOTAL QUANTITY	QUANTITY	QUANTITY
67100100	MOBILIZATION	L SUM	1	0.5	0.5
70100460	TRAFFIC CONTROL AND PROTECTION, STANDARD 701306	L SUM	1	0.5	0.5
70100600	TRAFFIC CONTROL AND PROTECTION, STANDARD 701336	L SUM	1	0.5	0.5
70106800	CHANGEABLE MESSAGE SIGN	CAL MD	4	2	2
70300100	SHORT- TERM PAVEMENT MARKING	FOOT	15,008	703	14305
70300220	TEMPORARY PAVEMENT MARKING, LINE 4"	FOOT	168,043	7491	160552
70300240	TEMPORARY PAVEMENT MARKING, LINE 6"	FOOT	304		304
70300280	TEMPORARY PAVEMENT MARKING, LINE 24"	FOOT	48		48
70301000	WORK ZONE PAVEMENT MARKING REMOVAL	SO FT	60,408	2704	57704
* 78000200	THERMOPLASTIC PAVEMENT MARKING - LINE 4"	FOOT	168,043	7491	160552
* 78000400	THERMOPLASTIC PAVEMENT MARKING - LINE 6"	FOOT	304		304
* 78000650	THERMOPLASTIC PAVEMENT MARKING - LINE 24"	FOOT	48		48
* 78100100	RAISED REFLECTIVE PAVEMENT MARKER	EACH	612	30	582
78300200	RAISED REFLECTIVE PAVEMENT MARKER REMOVAL	EACH	612	30	582

111

* SPECIALTY ITEMS

TYPICAL SECTION #1
HARDIN CO.

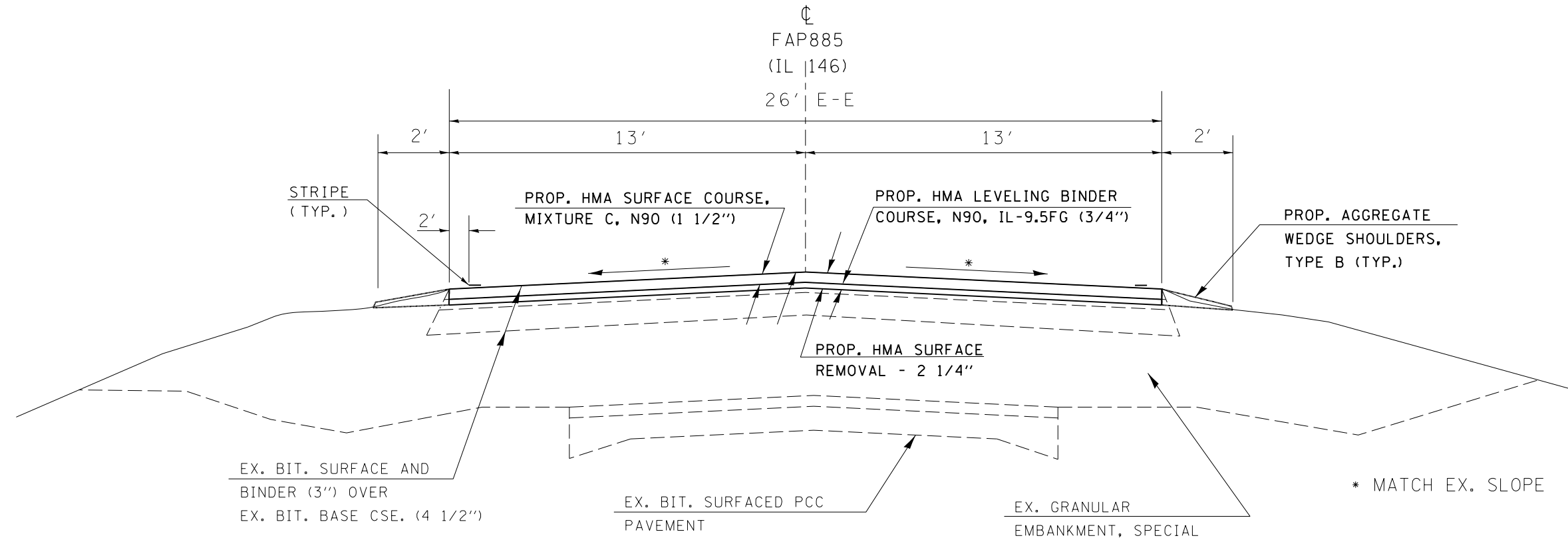

TO BE USED:
STA. 9+79.61 TO STA. 1203+12**

TYPICAL SECTION #2
HARDIN CO.

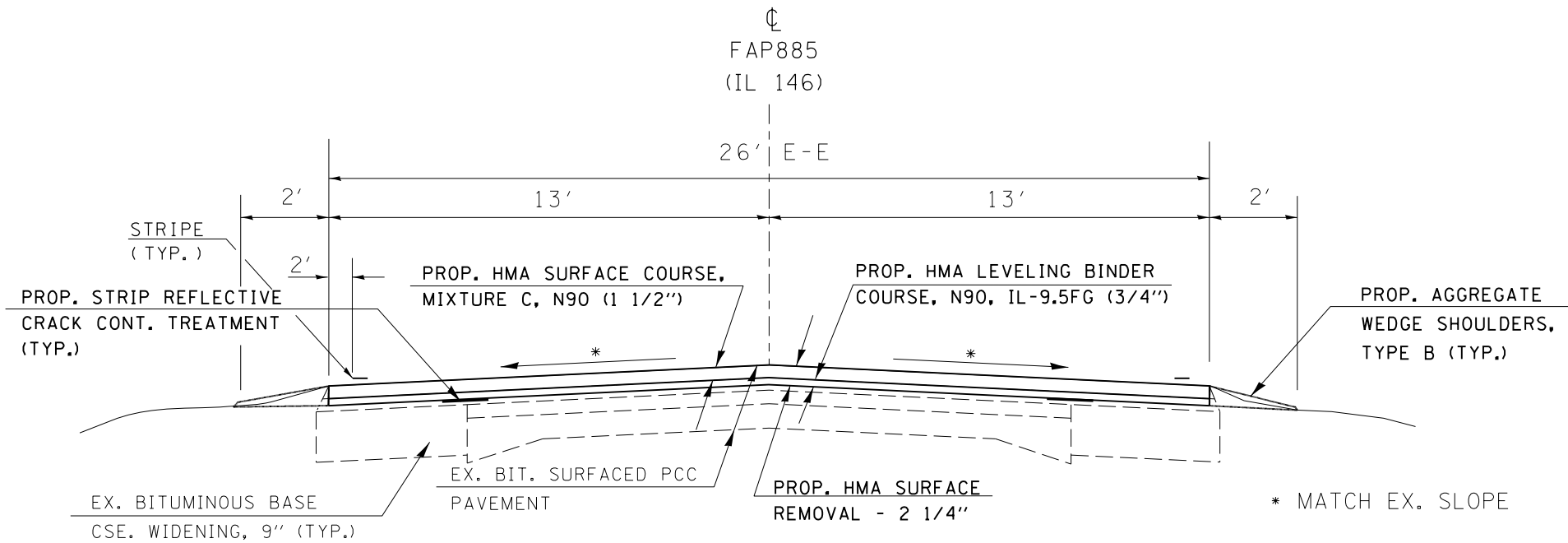

TO BE USED:
STA. 1203+12 TO STA. 1210+60 (POPE C.L.)

**EQ. STA. 11+05.80 (BK.) =
STA. 1188+43.20 (AH.)

FILE NAME =	USER NAME = mccordkr	DESIGNED -	REVISED -	STATE OF ILLINOIS DEPARTMENT OF TRANSPORTATION	TYPICAL SECTIONS #1 & #2			F.A.P. RTE.	SECTION	COUNTY	TOTAL SHEETS	SHEET NO.
Default	Plot Scale = 200.0000' / in.	DRAWN -	REVISED -					885	7RS-3,6RS-7	POPE/HARDIN	28	7
	PLOT DATE = 6/27/2014	CHECKED -	REVISED -		SCALE: SHEET OF SHEETS STA. TO STA.			CONTRACT NO. 78339				
		DATE -	REVISED -		ILLINOIS FED. AID PROJECT							

TYPICAL SECTION #3
POPE CO.

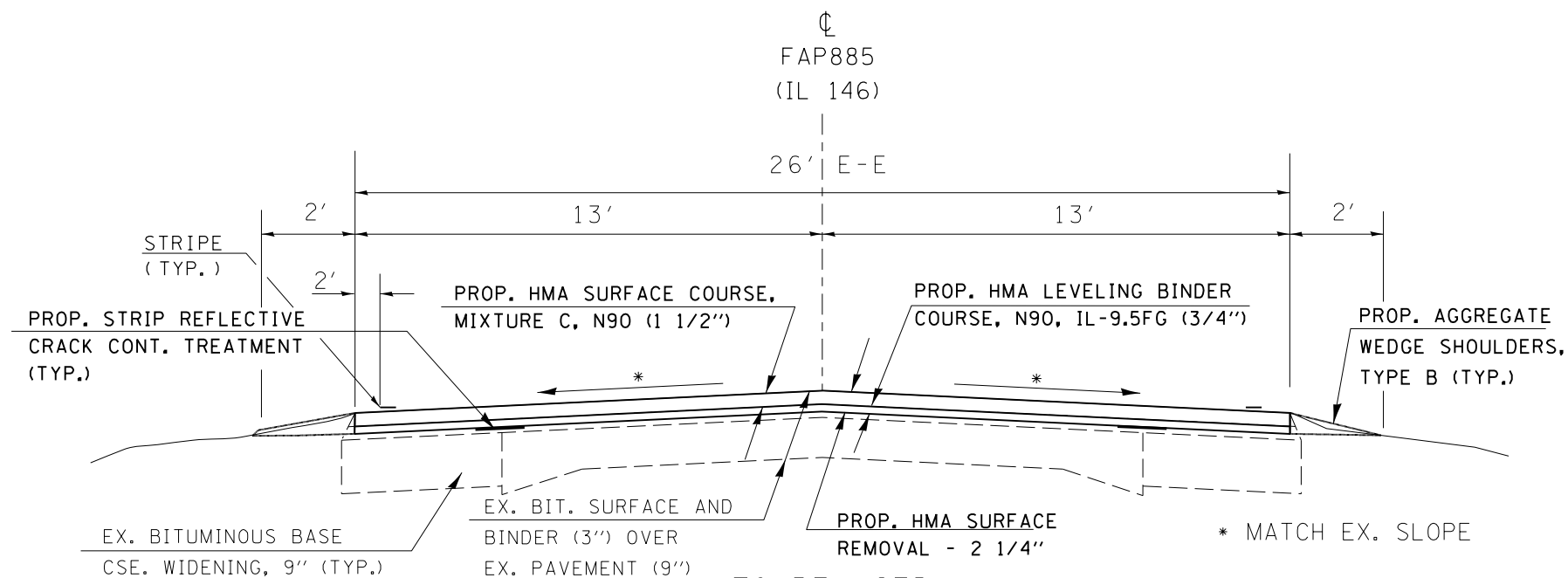

TO BE USED:

STA. 1210+60 (POPE C.L.) TO STA. 1211+34
 STA. 1240+34.48 TO STA. 1674+17.61 (MAIN ST. INTERSECTION)
 STA. 1266+34 TO STA. 1266+10 (END BUTT JT.)
 SEE EQUATION STATIONS AT RIGHT.

STRUCTURES TO BE OMITTED:

OMIT SN 076-0031 - STA 1257+67 TO STA 1262+55
 OMIT SN 076-0030 - STA 1372+42.50 TO STA 1374+09.50
 OMIT SN 076-0029 - STA 1435+99.5 TO STA 1442+45.0
 OMIT SN 076-0005 - STA 1657+49.13 TO STA 1661+37.17
 OMIT EX LEVEE - STA 1664+59 to Sta. 1665+11

EQUATION STATIONS:

Eq. Sta. 1254+76.55 (BK) = Sta. 1254+66.55 (AH)
 Eq. Sta. 1274+14.98 (BK) = Sta. 1274+02.49 (AH)
 Eq. Sta. 1292+05.50 (BK) = Sta. 1292+20.63 (AH)
 Eq. Sta. 1312+98.58 (BK) = Sta. 1312+94.18 (AH)
 Eq. Sta. 1367+91.97 (BK) = Sta. 1367+92.48 (AH)
 Eq. Sta. 1386+99.52 (BK) = Sta. 1387+09.36 (AH)
 Eq. POT Sta. 1450+08.70 (BK) = Sta. 1450+00.0 (AH)
 Eq. Sta. 1499+08.35 (BK) = Sta. 1499+11.44 (AH)
 Eq. POT Sta. 1622+09.07 (BK) = Sta. 1604A+60.25 (AH)
 Eq. POT Sta. 1623A+00.0 (BK) = Sta. 1623+00.0 (AH)
 Eq. Sta. 1625+29.34 (BK) = Sta. 1625+31.55 (AH)
 Eq. Sta. 1643+40.63 (BK) = Sta. 1643+63.79 (AH)
 Eq. Sta. 1653+03.96 (BK) = Sta. 1652+88.05 (AH)
 Eq. Sta. 1665+62.18 (BK) = Sta. 1667+09.59 (AH)
 Eq. Sta. 1674+17.61 (BK) Adams St./IL 146 =
 Sta. 1266+34.00 (AH) Main St./IL 146

FILE NAME =	USER NAME = mccordkr	DESIGNED -	REVISED -	STATE OF ILLINOIS DEPARTMENT OF TRANSPORTATION	TYPICAL SECTION #3			F.A.P. RTE.	SECTION	COUNTY	TOTAL SHEETS	SHEET NO.
et:\pw\work\p1dot\mccordkr\0402536\78339-sh1-plan.dgn	DRAWN -	REVISED -	885					7RS-3,6RS-7	POPE/HARDIN	28	8	
Default	PLOT SCALE = 200.0000' / in.	CHECKED -	REVISED -		SCALE: SHEET OF SHEETS STA. TO STA.			CONTRACT NO. 78339		ILLINOIS FED. AID PROJECT		
	PLOT DATE = 6/27/2014	DATE -	REVISED -									

TYPICAL SECTION #4
POPE CO.

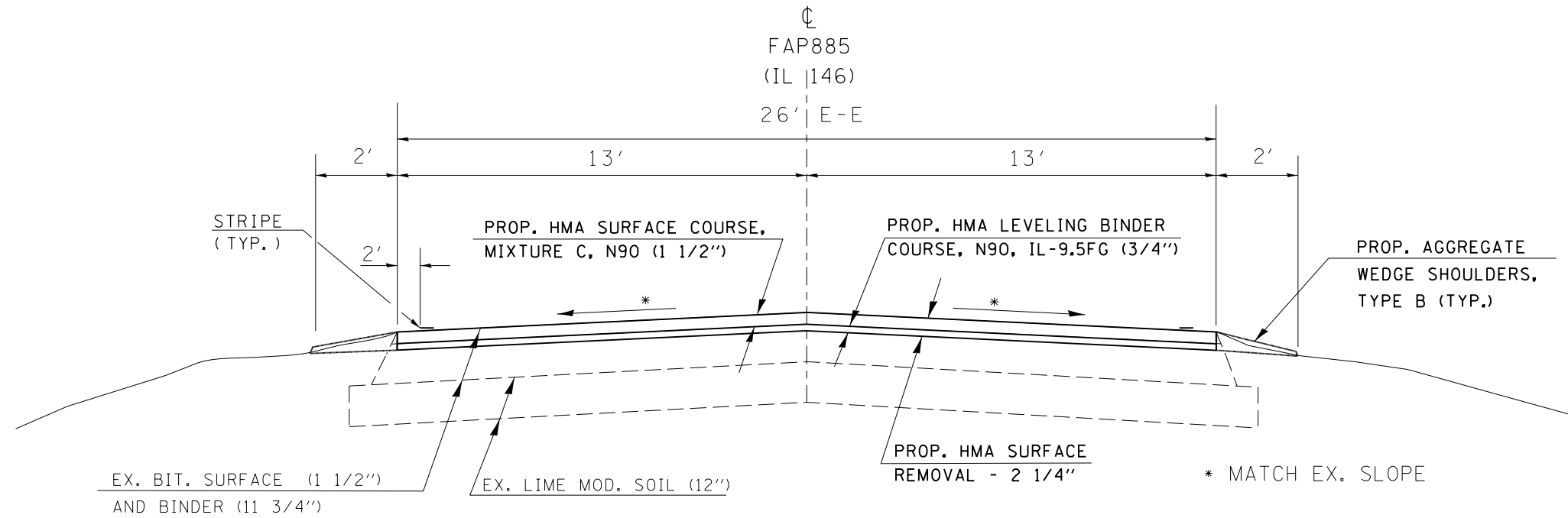

TO BE USED:
STA. 1211+34 TO STA. 1240+34.47**

**EQ. STA. 1236+96.78(BK) = STA. 1240+34.48(AH)

FILE NAME =	USER NAME = mccordkr	DESIGNED -	REVISED -	STATE OF ILLINOIS DEPARTMENT OF TRANSPORTATION	TYPICAL SECTION #4				F.A.P. RTE.	SECTION	COUNTY	TOTAL SHEETS	SHEET NO.
et:\pw\work\p\idot\mccordkr\0402536\78339-sh1-plan.dgn		DRAWN -	REVISED -		885	7RS-3,6RS-7	POPE/HARDIN	28	9				
Default	PLOT SCALE = 200.0000' / in.	CHECKED -	REVISED -		SCALE: SHEET OF SHEETS STA. TO STA.				CONTRACT NO. 78339				
	PLOT DATE = 6/27/2014	DATE -	REVISED -		ILLINOIS FED. AID PROJECT								

FAP 885 (IL 146) PAVEMENT RESURFACING SCHEDULE

LOCATION	STATION TO STATION		LENGTH	ROADWAY WIDTH	ROADWAY AREA	HOT-MIX ASP. SURF. REMOV. 2 1/4"	TEMP RAMP	HOT-MIX ASP. SUR. CSE., MIX C, N 90 (1 1/2"	LEVELING BINDER (MM), 1L-9.5mm, N90 (1"	BIT. MAT. (PRIME COAT)		
			FOR INFORMATIONAL PURPOSE ONLY									
			(FT)	(FT)	(SQ YD)	(SQ YD)	(SQ YD)	(TON)	(TON)	(LBS)		
FAP 885 (IL 146) - STA. 593+00 to STA. 1266+10												
	9+79.61	TO	11+05.80	126.19	26	365	365	15	31	16	246	
EQ STA 11+05.80 (BK) = STA 1188+43.20 (AH)												
	1188+43.20	TO	1210+60.52	2217	26	6406	6406		541	271	4324	
HARDIN/POPE COUNTY LINE - STA. 1210+60.52												
	1210+60.52	TO	1236+95.78	2635	26	7613	7613		643	322	5145	
EQ STA 1236+95.78 (BK) = STA 1240+34.48 (AH)												
	1240+34.48	TO	1254+76.55	1442	26	4166	4166		352	176	2813	
EQ STA 1254+76.55 (BK) = STA 1254+66.55 (AH)												
	1254+66.55	TO	1257+67.00	300	26	868	868	15	74	37	586	
OMIT SN 076-0031 - STA 1257+67 TO STA 1262+55												
	1262+55.00	TO	1274+14.98	1160	26	3351	3351	15	283	142	2262	
EQ STA 1274+14.98 (BK) = STA 1274+02.49 (AH)												
	1274+02.49	TO	1292+05.50	1803	26	5209	5209		440	221	3516	
EQ STA 1292+05.50 (BK) = STA 1292+20.63 (AH)												
	1292+20.63	TO	1312+98.58	2078	26	6003	6003		507	254	4053	
EQ STA 1312+98.58 (BK) = STA 1312+94.18 (AH)												
	1312+94.18	TO	1367+91.97	5498	26	15883	15883		1341	671	10721	
EQ STA 1367+91.97 (BK) = STA 1367+92.48 (AH)												
	1367+92.48	TO	1372+42.50	450	26	1300	1300	15	110	55	876	
OMIT SN 076-0030 - STA 1372+42.50 TO STA 1374+09.50												

FAP 885 (IL 146) PAVEMENT RESURFACING SCHEDULE
CONTINUED

LOCATION STATION TO STATION			LENGTH	ROADWAY WIDTH	ROADWAY AREA	HOT-MIX ASP. SURF. REMOV. 2 1/4"	TEMP RAMP	HOT-MIX ASP. SUR. CSE., MIX C. N 90 (1 1/2")	LEVELING BINDER (MM), IL-9.5mm, N90 (1")	BIT. MAT. (PRIME COAT)	
			FOR INFORMATIONAL PURPOSE ONLY								
			(FT)	(FT)	(SQ YD)	(SQ YD)	(SQ YD)	(TON)	(TON)	(LBS)	
	1374+09.50	TO	1386+99.52	1290	26	3727	3727	15	315	158	2516
EQ STA 1386+99.52 (BK) = STA 1387+09.36 (AH)											
	1387+09.36	TO	1435+99.50	4890	26	14127	14127	15	1193	597	9536
OMIT SN 076-0029 - STA 1435+99.5 TO STA 1442+45.0											
	1442+45.00	TO	1450+08.70	764	26	2206	2206	15	187	94	1490
EQ POT STA 1450+08.70 (BK) = STA 1450+00.00 (AH)											
	1450+00.00	TO	1499+08.35	4908	26	14180	14180		1197	599	9572
EQ STA 1499+08.35 (BK) = STA 1499+11.44 (AH)											
	1499+11.44	TO	1622+09.07	12298	26	35526	35526		2999	1501	23981
EQ POT STA 1622+09.07 (BK) = STA 1604A+60.25 (AH)											
	1604A+60.25	TO	1623A+00	1840	26	5316	5316		449	224	3588
EQ POT STA 1623A+00.00 (BK) = STA 1623+00.00 (AH)											
	1623+00.00	TO	1625+29.34	229	26	663	663		56	28	447
EQ STA 1625+29.34 (BK) = STA 1625+31.55 (AH)											
	1625+31.55	TO	1643+40.63	1809	26	5226	5226		442	221	3528
EQ STA 1643+40.63 (BK) = STA 1643+63.79 (AH)											
	1643+63.79	TO	1653+03.96	940	26	2716	2716		230	115	1833
EQ STA 1653+03.96 (BK) = STA 1652+88.05 (AH)											
	1652+88.05	TO	1654+09.72	122	26	351	351		30	15	237

FAP 885 (IL 146) PAVEMENT RESURFACING SCHEDULE
CONTINUED

LOCATION STATION TO STATION				LENGTH	ROADWAY WIDTH	ROADWAY AREA	HOT-MIX ASP. SURF. REMOV. 2 1/4"	TEMP RAMP	HOT-MIX ASP. SUR. CSE., MIX C, N 90 (1 1/2")	LEVELING BINDER (MM), IL-9.5mm, N90 (1")	BIT. MAT. (PRIME COAT)
				FOR INFORMATIONAL PURPOSE ONLY							
				(FT)	(FT)	(SQ YD)					
1654+09.72	TO	1657+49.13	339	24	905	905	14	77	39	611	
OMIT SN 076-0005 - STA 1657+49.13 TO STA 1661+37.17											
1661+37.17	TO	1663+18.00	181	24	482	482	14	41	21	326	
CITY LIMITS - STA 1663+18											
1663+18.00	TO	1664+59.00	141	24	376	376	14	32	16	254	
OMIT EX LEVEE - STA 1664+59 TO STA 1665+11											
1665+11.00	TO	1665+62.18	51	24	136	136	14	12	6	93	
EQ STA 1665+62.18 (BK) = STA 1667+09.59 (AH)											
1667+09.59	TO	1673+73.00	663	24	1769	1769		150	75	1194	
EQ STA 1674+17.61 (BK) = STA 1266+34.00 (AH) INTERSECTION OF IL 146 WITH MAIN ST. IN GOLCONDA.											
	1673+73.00	TO	1266+10.00			489	489	15	42	21	330
LT.	1674+17.61							15			
LT.	1266+34.00							14			
TOTALS							139,358	205	11774	5895	94,078

IL 146 PAVEMENT MARKING SCHEDULE CONTINUED

STATION TO STATION				THERMOPLASTIC PAVEMENT MARKING					TEMPORARY			SHORT-TERM PAVEMENT MARKING	NOTES
				4 INCH WHITE (EDGE LINE)	4 INCH YELLOW (SKIP-DASH)	4 INCH YELLOW (NPZ OR DBL)	6 INCH (CROSSWALK)	24 INCH (STOP BARS)	4 INCH	6 INCH	24 INCH		
				FOOT	FOOT	FOOT	FOOT	FOOT	FOOT	FOOT	FOOT	FOOT	
EO STA 1312+98.58 (BK) = STA. 1312+94.18 (AH)													
LT & RT	1312+94.2	TO	1367+92.0	10996					10996			1649	
RT	1312+94.2	TO	1321+00.0		202				202				
LT	1312+94.2	TO	1323+00.0			1006			1006				
RT	1321+00.0	TO	1337+00.0			1600			1600				
LT	1323+00.0	TO	1331+80.0		220				220				
RT	1337+00.0	TO	1344+60.0		190				190				
LT	1331+80.0	TO	1344+60.0			1280			1280				
LT & RT	1344+60.0	TO	1345+00.0			80			80				
RT	1345+00.0		1355+30.0			1030			1030				
LT	1345+00.0	TO	1355+30.0		258				258				
LT & RT	1355+30.0	TO	1367+92.0			2524			2524				
EO STA 1367+91.97 (BK) = STA. 1367+92.48 (AH)													
LT & RT	1367+92.5	TO	1372+42.5	902					902			135	
LT & RT	1367+92.5	TO	1372+42.5			902			902				
OMISSION - SN 076-0030 STA. 1372+42.50 TO STA. 1374+09.50													
LT & RT	1374+09.5	TO	1386+99.5	2582					2582			387	
LT & RT	1374+09.5	TO	1386+99.5			2582			2582				
EO STA 1386+99.52 (BK) = STA. 1387+09.36 (AH)													
LT & RT	1387+09.4	TO	1435+99.5	9782					9782			1467	
LT & RT	1387+09.4	TO	1396+20.0			1822			1822				
	1396+20.0	TO	1426+10.0		748				748				
LT	1396+20.0	TO	1406+20.0			1000			1000				
RT	1410+94.0	TO	1431+00.0			2006			2006				
LT	1426+10.0	TO	1435+99.0			989			989				
	1431+00.0	TO	1435+99.0		125				125				
OMISSION - SN 076-0029 STA. 1435+99.5 TO STA. 1442+45.0 (BK)													
LT & RT	1442+45.0	TO	1450+08.7	1528					1528			229	
	1442+45.0	TO	1450+08.7		191				191				
RT	1442+45.0	TO	1447+80.0			535			535				
LT	1449+40.0	TO	1450+08.7			69			69				

IL 146 PAVEMENT MARKING SCHEDULE CONTINUED

STATION TO STATION	THERMOPLASTIC PAVEMENT MARKING					TEMPORARY			SHORT-TERM PAVEMENT MARKING	NOTES			
	4 INCH WHITE (EDGE LINE)	4 INCH YELLOW (SKIP-DASH)	4 INCH YELLOW (NPZ OR DBL)	6 INCH (CROSSWALK)	24 INCH (STOP BARS)	4 INCH	6 INCH	24 INCH					
	FOOT	FOOT	FOOT	FOOT	FOOT	FOOT	FOOT	FOOT					
EO STA 1450+08.70 (BK) = STA. 1450+00.00 (AH)													
LT & RT	1450+00.0	TO	1499+08.4	9818					9818			1473	
	1450+00.0	TO	1475+20.0		630				630				
LT	1450+00.0	TO	1458+20.0			820			820				
RT	1464+20.0	TO	1475+20.0			1100			1100				
LT & RT	1475+20.0	TO	1499+08.4			4778			4778				
EO STA 1499+08.35 (BK) = STA. 1499+11.44 (AH)													
LT & RT	1499+11.4	TO	1622+09.1	24596					24596			3689	
	1499+11.4	TO	1525+60.0		663				663				
LT	1499+11.4	TO	1510+00.0			1089			1089				
RT	1516+30.0	TO	1525+60.0			930			930				
LT & RT	1525+60.0	TO	1545+21.0			3922			3922				
	1545+21.0	TO	1572+30.0		678				678				
LT	1545+21.0	TO	1554+40.0			919			919				
RT	1557+21.0	TO	1572+30.0			1509			1509				
LT & RT	1572+30.0	TO	1576+20.0			780			780				
RT	1576+20.0	TO	1583+20.0		175	700			875				
LT & RT	1583+20.0	TO	1597+00.0			2760			2760				
LT	1597+00.0	TO	1605+00.0		200	800			1000				
LT & RT	1605+00.0	TO	1606+20.0			240			240				
RT	1606+20.0	TO	1615+00.0		220	880			1100				
LT & RT	1615+00.0	TO	1618+20.0			640			640				
LT	1618+20.0	TO	1622+09.1		98	390			488				
EO POT STA 1622+09.07 (BK) = STA. 1604A+60.25 (AH)													
LT & RT	1604A+60.25	TO	1623A+00	3680					3680			1,104	
LT	1604A+60.25	TO	1609A+00		110	440			550				
RT	1609A+00	TO	1619A+07		252	1007			1259				
LT & RT	1619A+07	TO	1623A+00			786			786				
EO STA 1623A+00.00 (BK) = STA. 1623+00.00 (AH)													
LT & RT	1623+00.0	TO	1625+29.3	460		460			920			69	

IL 146 PAVEMENT MARKING SCHEDULE CONTINUED

STATION TO STATION	THERMOPLASTIC PAVEMENT MARKING					TEMPORARY			SHORT-TERM PAVEMENT MARKING	NOTES		
	4 INCH WHITE (EDGE LINE)	4 INCH YELLOW (SKIP-DASH)	4 INCH YELLOW (NPZ OR DBL)	6 INCH (CROSSWALK)	24 INCH (STOP BARS)	4 INCH	6 INCH	24 INCH				
	FOOT	FOOT	FOOT	FOOT	FOOT	FOOT	FOOT	FOOT				
EQ STA 1625+29.34 (BK) = STA. 1625+31.55 (AH)												
LT & RT	1625+31.6	TO	1643+40.6	3620		3620			7240		543	
EQ STA 1643+40.63 (BK) = STA. 1643+63.79 (AH)												
LT & RT	1643+63.8	TO	1653+04.0	1882		1882			3764		282	
EQ STA 1653+03.96 (BK) = STA. 1652+88.05 (AH)												
LT & RT	1652+88.1	TO	1657+49.1	924		924			1848		138	
OMISSION - SN 076-0005 STA. 1657+49.13 TO STA. 1661+37.17												
LT & RT	1661+37.2	TO	1664+59.0	644		644			1288		97	
OMISSION - EX. LEVEE STA. 1664+59 TO STA. 1665+11												
LT & RT	1665+11.0	TO	1665+62.2	104	13				117		15	
LT	1665+11.0	TO	1665+62.2			52			52			
EQ STA 1665+62.18 (BK) = STA. 1667+09.59 (AH)												
LT & RT	1667+09.6	TO	1673+85.0	1352	169				1521		203	
LT	1667+09.6	TO	1673+85.0			676			676			
RT	1673+85.0						12			12	STOP BAR	
RT	1266+30.0						12			12	STOP BAR	
	MAIN ST.						12			12	STOP BAR	
	ADAMS ST.						12			12	STOP BAR	
	1673+87.0					80		80			CROSSWALK	
	1266+32.0					72		72			CROSSWALK	
	MAIN ST.					80		80			CROSSWALK	
	ADAMS ST.					72		72			CROSSWALK	
SUBTOTALS				96,404	6,847	64,792	304	48	168,043	304	48	15,008
TOTALS				168,043			304	48	168,043	304	48	15,008

NOTE: EXISTING PAVEMENT IS 26' E-E.

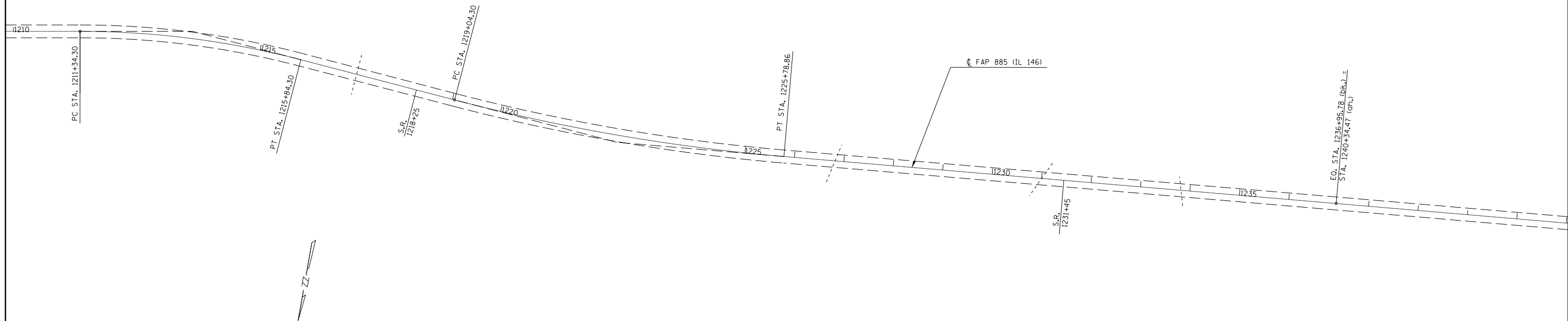
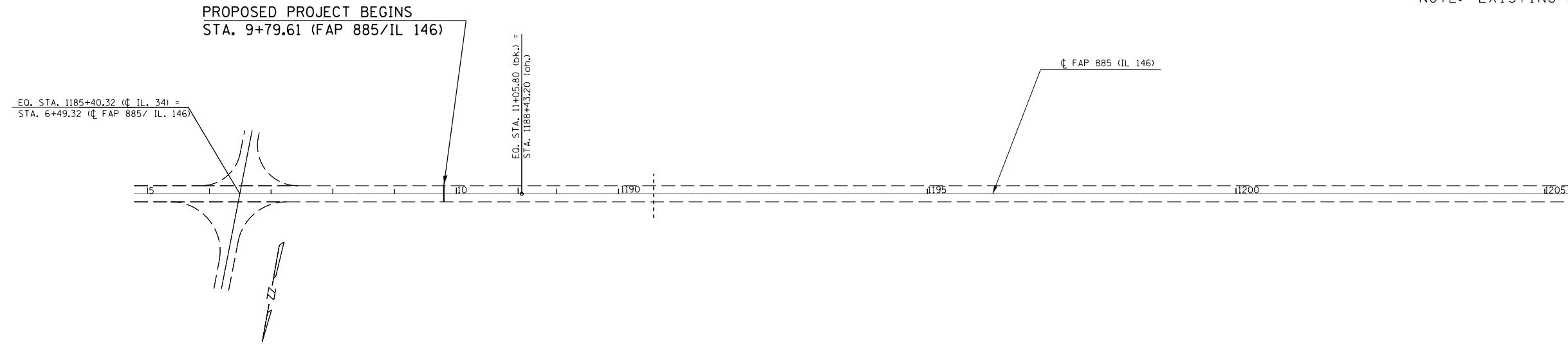

FILE NAME =	USER NAME = mccordkr	DESIGNED -	REVISED -
c:\pw\work\pwidot\mccordkr\0402536\78339-sh1-plan.dgn		DRAWN -	REVISED -
Default	PLOT SCALE = 200.0000' / in.	CHECKED -	REVISED -
	PLOT DATE = 6/27/2014	DATE -	REVISED -

STATE OF ILLINOIS
DEPARTMENT OF TRANSPORTATION

PLAN LAYOUT #1			
SCALE:	SHEET	OF SHEETS	STA. TO STA.

F.A.P. RTE.	SECTION	COUNTY	TOTAL SHEETS	SHEET NO.
885	7RS-3,6RS-7	POPE/HARDIN	28	17
CONTRACT NO. 78339				
ILLINOIS FED. AID PROJECT				

NOTE: EXISTING PAVEMENT IS 26' E-E.

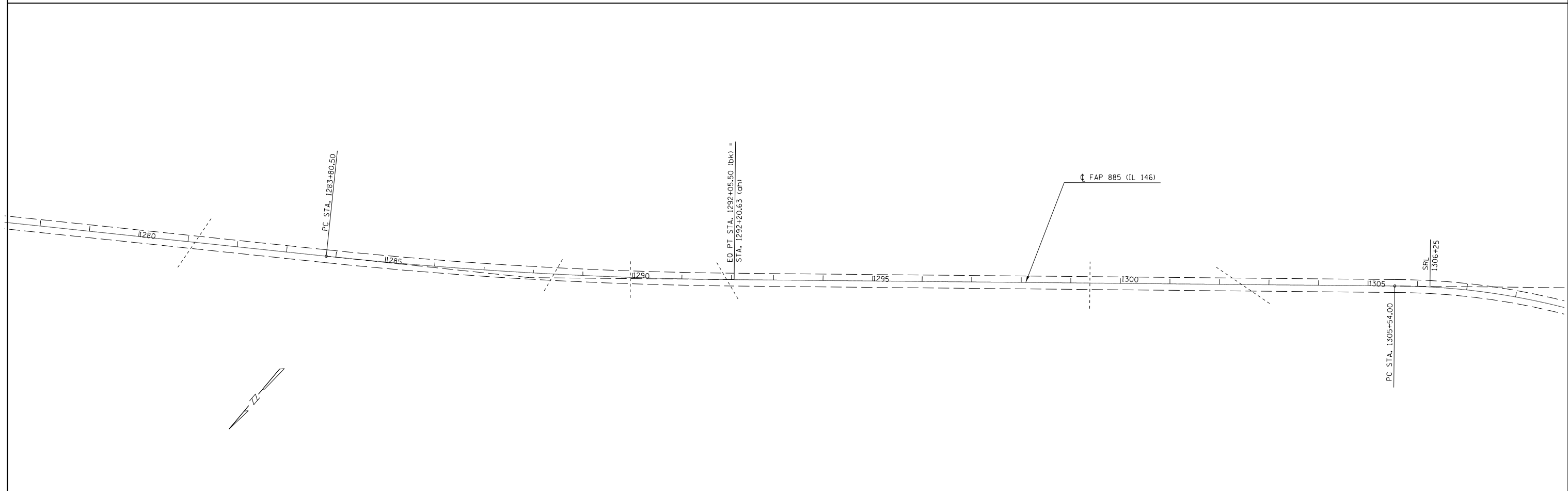
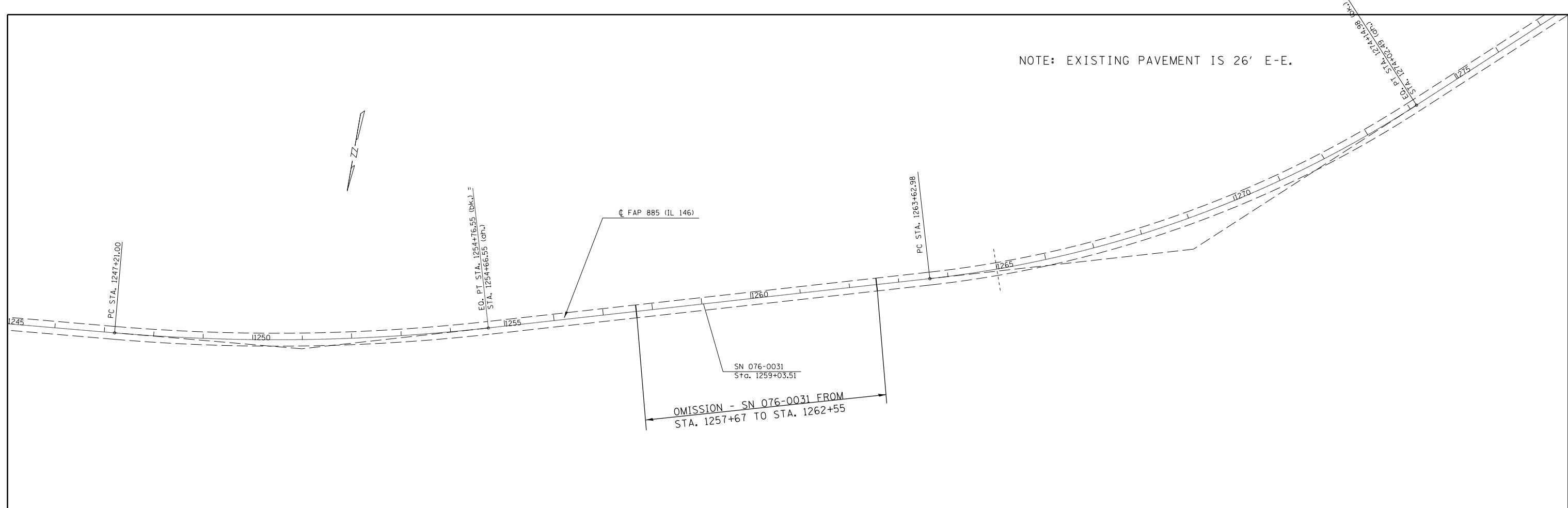

FILE NAME =	USER NAME = mccordkr	DESIGNED -	REVISED -
c:\pw\work\p1dot\mccordkr\d0402536\78339-sh1-plan.dgn		DRAWN -	REVISED -
Default	PLOT SCALE = 200.0000' / in.	CHECKED -	REVISED -
	PLOT DATE = 6/27/2014	DATE -	REVISED -

**STATE OF ILLINOIS
DEPARTMENT OF TRANSPORTATION**

PLAN LAYOUT #2			
SCALE:	SHEET	OF SHEETS	STA. TO STA.

F.A.P. RTE.	SECTION	COUNTY	TOTAL SHEETS	SHEET NO.
885	7RS-3,6RS-7	POPE/HARDIN	28	18
CONTRACT NO. 78339				
ILLINOIS FED. AID PROJECT				

NOTE: EXISTING PAVEMENT IS 26' E-E.

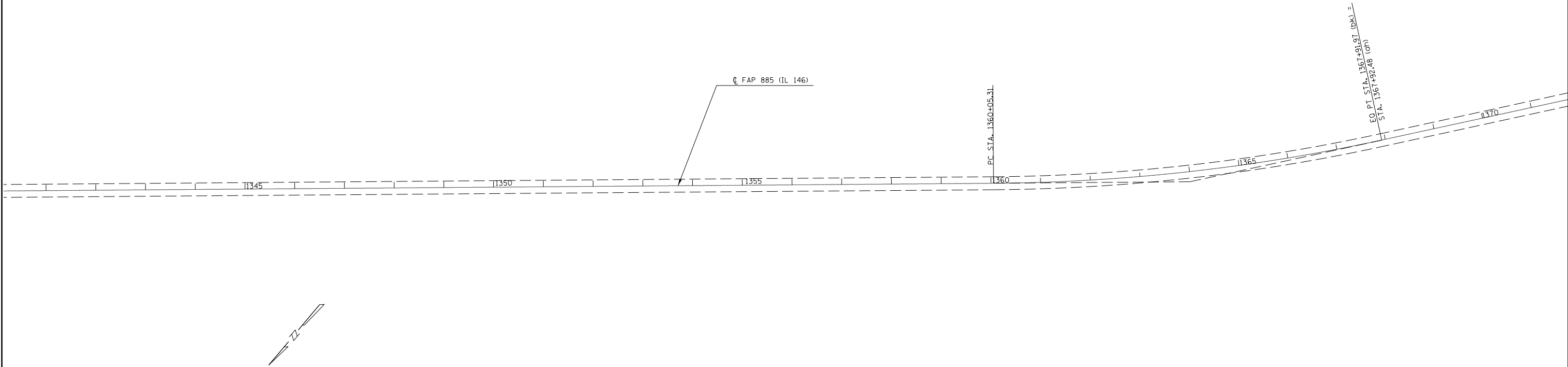
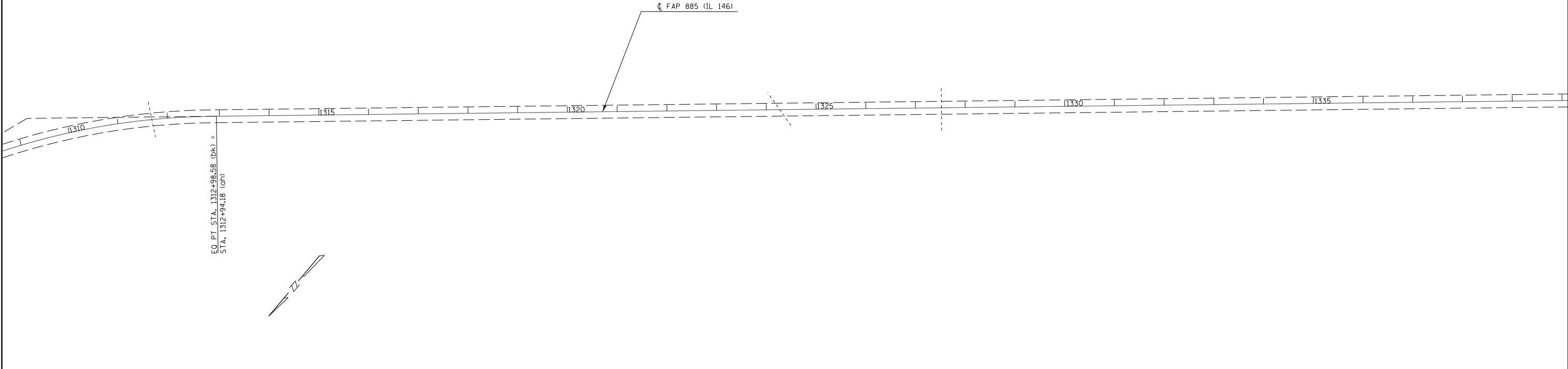

FILE NAME =	USER NAME = mccordkr	DESIGNED -	REVISED -
c:\pwwork\pwwork\mccordkr\0402536\78339-sh1-plan.dgn		DRAWN -	REVISED -
	PLOT SCALE = 200.0000' / in.	CHECKED -	REVISED -
Default	PLOT DATE = 6/27/2014	DATE -	REVISED -

**STATE OF ILLINOIS
DEPARTMENT OF TRANSPORTATION**

PLAN LAYOUT #3

SCALE: SHEET OF SHEETS STA. TO STA.

F.A.P. RTE.	SECTION	COUNTY	TOTAL SHEETS	SHEET NO.
885	7RS-3,6RS-7	POPE/HARDIN	28	19
CONTRACT NO. 78339				
ILLINOIS FED. AID PROJECT				

OMISSION - SN 076-0030 FROM
STA. 1372+42.5 TO STA. 1374+09.5

NOTE: EXISTING PAVEMENT IS 26' E-E.

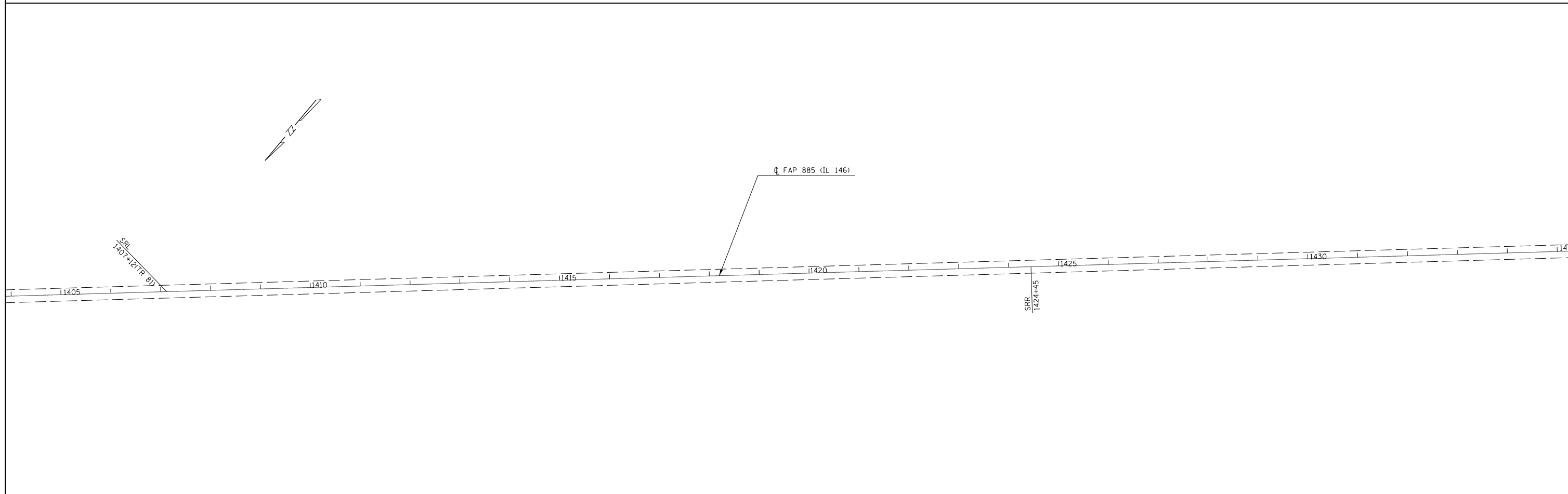
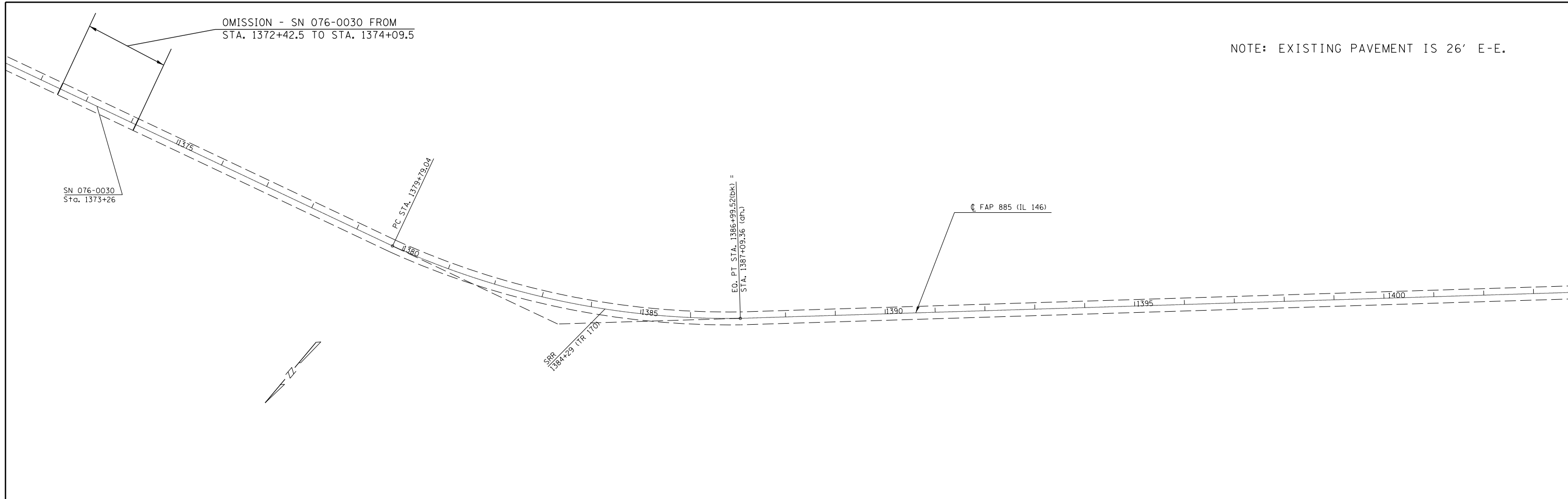

FILE NAME =	USER NAME = mccordkr	DESIGNED -	REVISED -
ei:\pw\work\p\idot\mccordkr\0402536\78339-sh1-plan.dgn		DRAWN -	REVISED -
Default	PLOT SCALE = 200.0000' / in.	CHECKED -	REVISED -
	PLOT DATE = 6/27/2014	DATE -	REVISED -

**STATE OF ILLINOIS
DEPARTMENT OF TRANSPORTATION**

PLAN LAYOUT #4

SCALE: SHEET OF SHEETS STA. TO STA.

F.A.P. RTE.	SECTION	COUNTY	TOTAL SHEETS	SHEET NO.
885	7RS-3,6RS-7	POPE/HARDIN	28	20
CONTRACT NO. 78339				
ILLINOIS FED. AID PROJECT				

NOTE: EXISTING PAVEMENT IS 26' E-E.

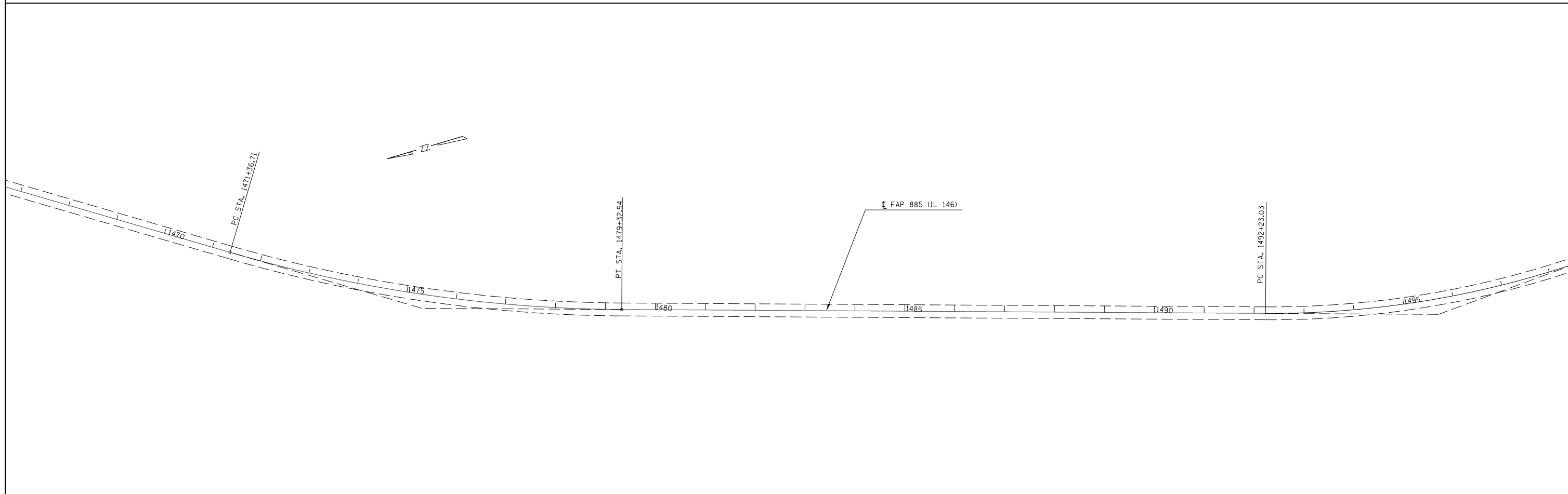
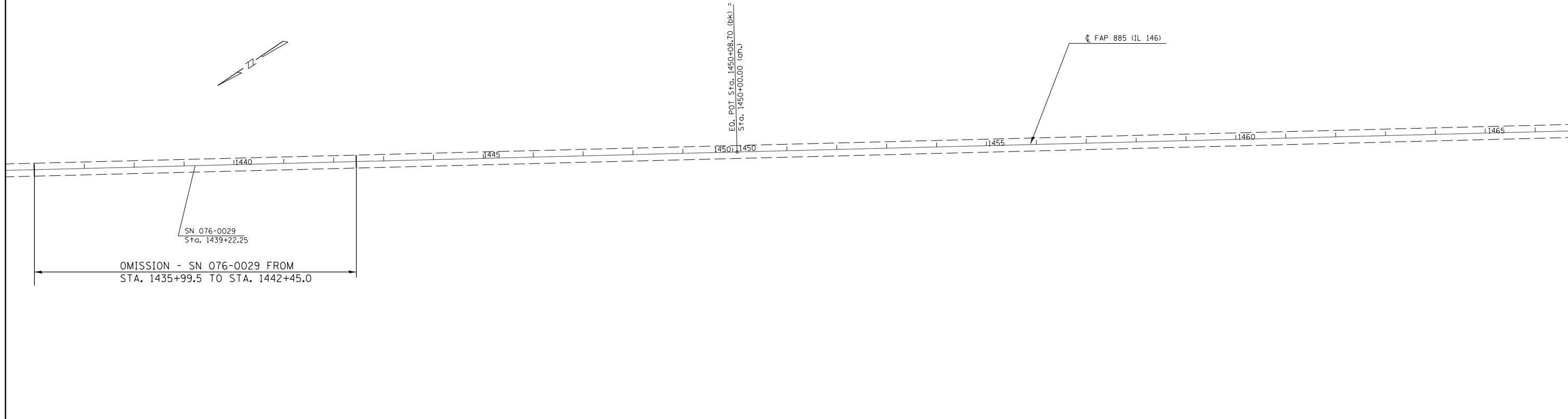

FILE NAME =	USER NAME = mccordkr	DESIGNED -	REVISED -
c:\pwork\work\pwork\mccordkr\0402536\78339-sh1-plan.dgn		DRAWN -	REVISED -
	PLOT SCALE = 200.0000' / in.	CHECKED -	REVISED -
Default	PLOT DATE = 6/27/2014	DATE -	REVISED -

STATE OF ILLINOIS
DEPARTMENT OF TRANSPORTATION

PLAN LAYOUT #5

SCALE: SHEET OF SHEETS STA. TO STA.

F.A.P. RTE.	SECTION	COUNTY	TOTAL SHEETS	SHEET NO.
885	7RS-3,6RS-7	POPE/HARDIN	28	21
			CONTRACT NO. 78339	
ILLINOIS FED. AID PROJECT				

NOTE: EXISTING PAVEMENT IS 26' E-E.

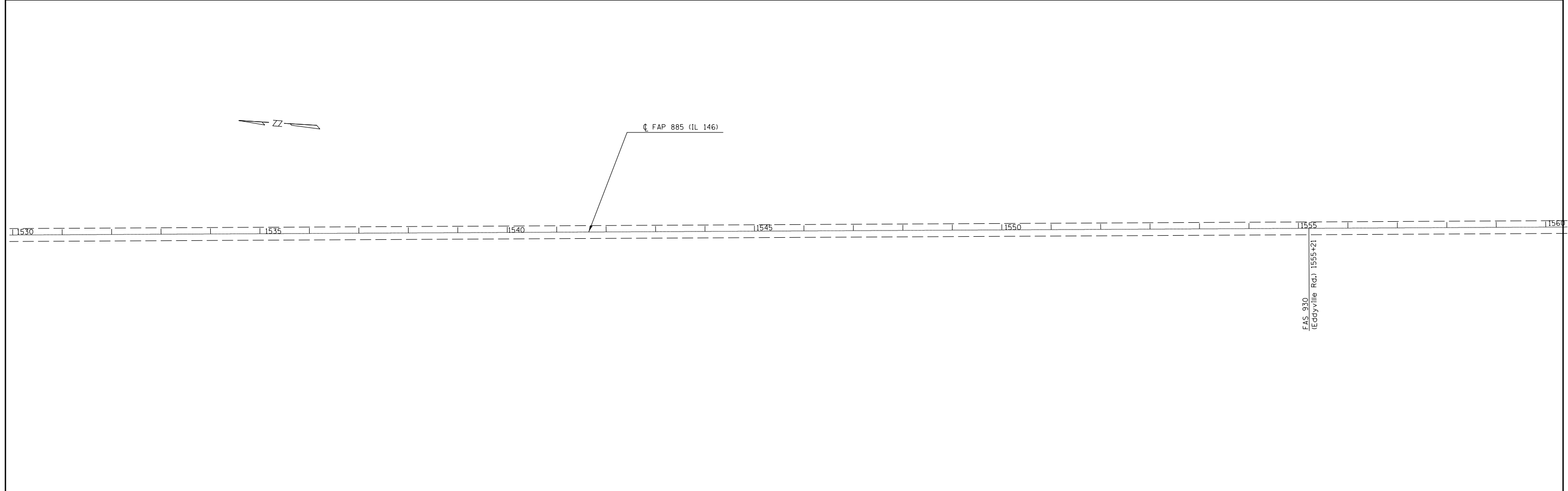
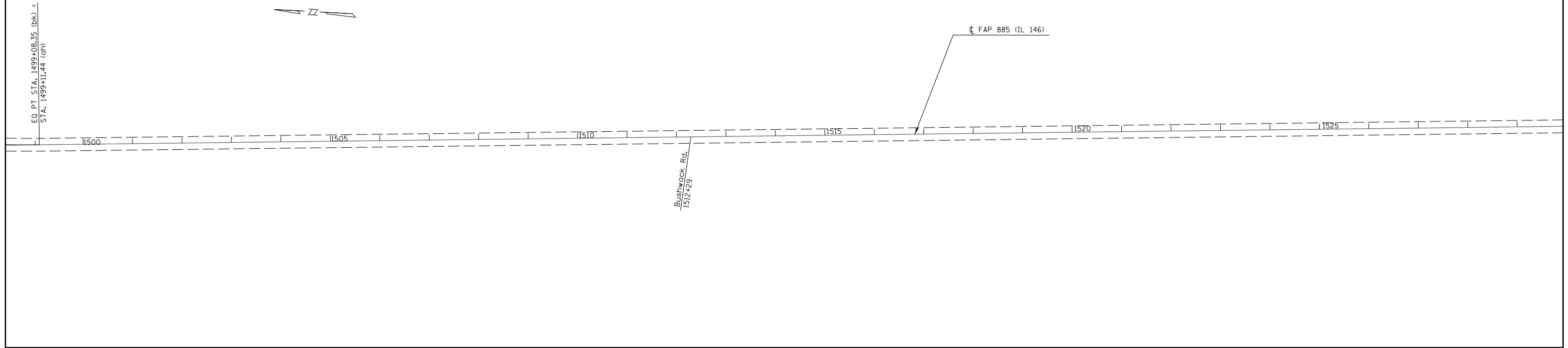

FILE NAME = c:\pwwork\pwwork\mccordkr\0402536\78339-sh1-plan.dgn	USER NAME = mccordkr	DESIGNED -	REVISED -	STATE OF ILLINOIS DEPARTMENT OF TRANSPORTATION	PLAN LAYOUT #6				F.A.P. RTE. 885	SECTION 7RS-3,6RS-7	COUNTY POPE/HARDIN	TOTAL SHEETS 28	SHEET NO. 22
Default	PLOT SCALE = 200.0000' / in.	CHECKED -	REVISED -						SCALE:	SHEET	OF	SHEETS	STA.
	PLOT DATE = 6/27/2014	DATE -	REVISED -		CONTRACT NO. 78339								

NOTE: EXISTING PAVEMENT IS 26' E-E.

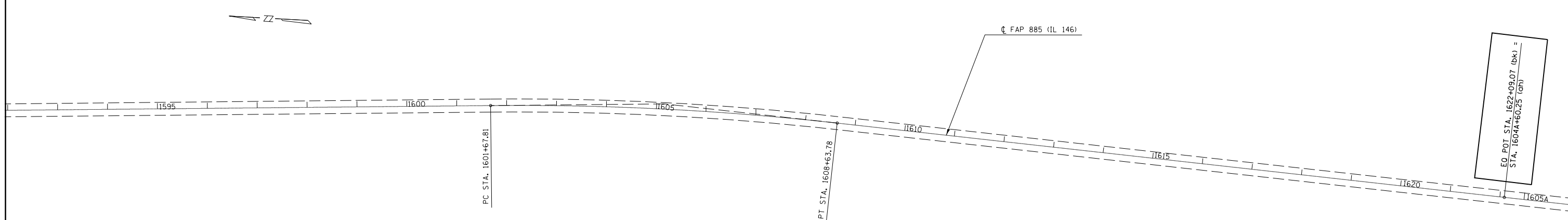
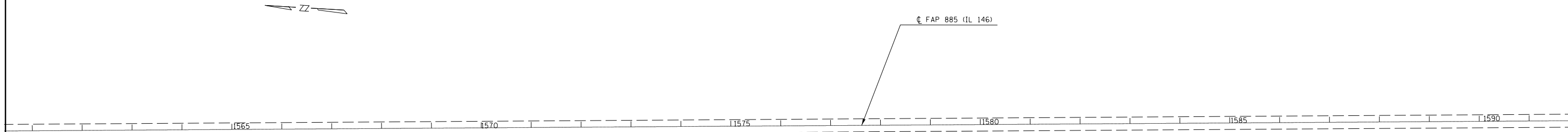

FILE NAME =	USER NAME = mccordkr	DESIGNED -	REVISED -
c:\pwork\work\pwork\mccordkr\0402536\78339-sh1-plan.dgn		DRAWN -	REVISED -
Default	PLOT SCALE = 200.0000' / in.	CHECKED -	REVISED -
	PLOT DATE = 6/27/2014	DATE -	REVISED -

**STATE OF ILLINOIS
DEPARTMENT OF TRANSPORTATION**

PLAN LAYOUT #7

SCALE: SHEET OF SHEETS STA. TO STA.

F.A.P. RTE.	SECTION	COUNTY	TOTAL SHEETS	SHEET NO.
885	7RS-3, 6RS-7	POPE/HARDIN	28	23
			CONTRACT NO. 78339	
ILLINOIS FED. AID PROJECT				

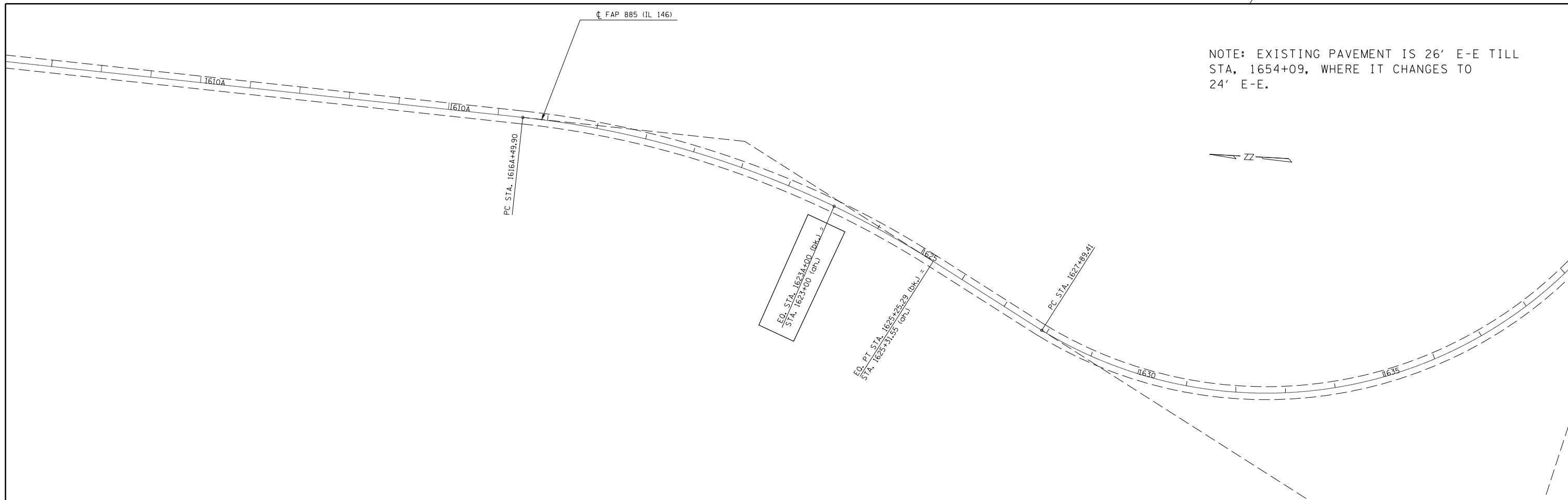

NOTE: EXISTING PAVEMENT IS 26' E-E TILL STA. 1654+09, WHERE IT CHANGES TO 24' E-E.

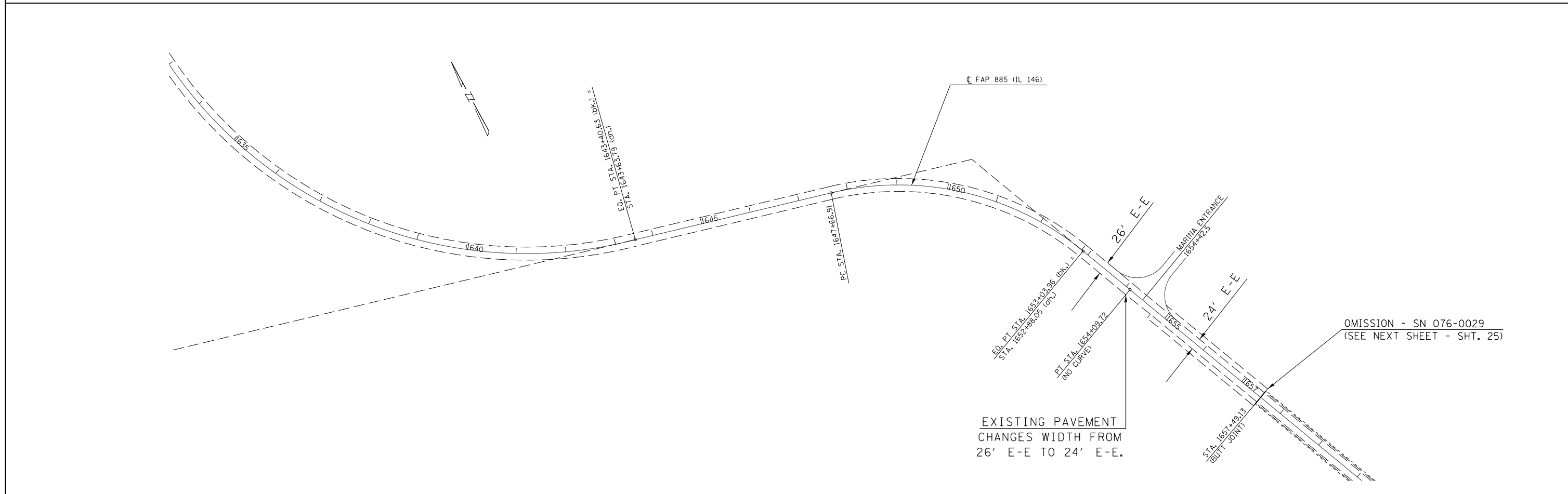

OMISSION - SN 076-0029
(SEE NEXT SHEET - SHT. 25)

EXISTING PAVEMENT
CHANGES WIDTH FROM
26' E-E TO 24' E-E.

FILE NAME =	USER NAME = mccordkr	DESIGNED -	REVISED -
c:\pw\work\p1dot\mccordkr\0402536\78339-sh1-plan.dgn		DRAWN -	REVISED -
	PLOT SCALE = 200.0000' / in.	CHECKED -	REVISED -
Default	PLOT DATE = 6/27/2014	DATE -	REVISED -

**STATE OF ILLINOIS
DEPARTMENT OF TRANSPORTATION**

PLAN LAYOUT #8

SCALE: SHEET OF SHEETS STA. TO STA.

F.A.P. RTE.	SECTION	COUNTY	TOTAL SHEETS	SHEET NO.
885	7RS-3,6RS-7	POPE/HARDIN	28	24
CONTRACT NO. 78339				
ILLINOIS FED. AID PROJECT				

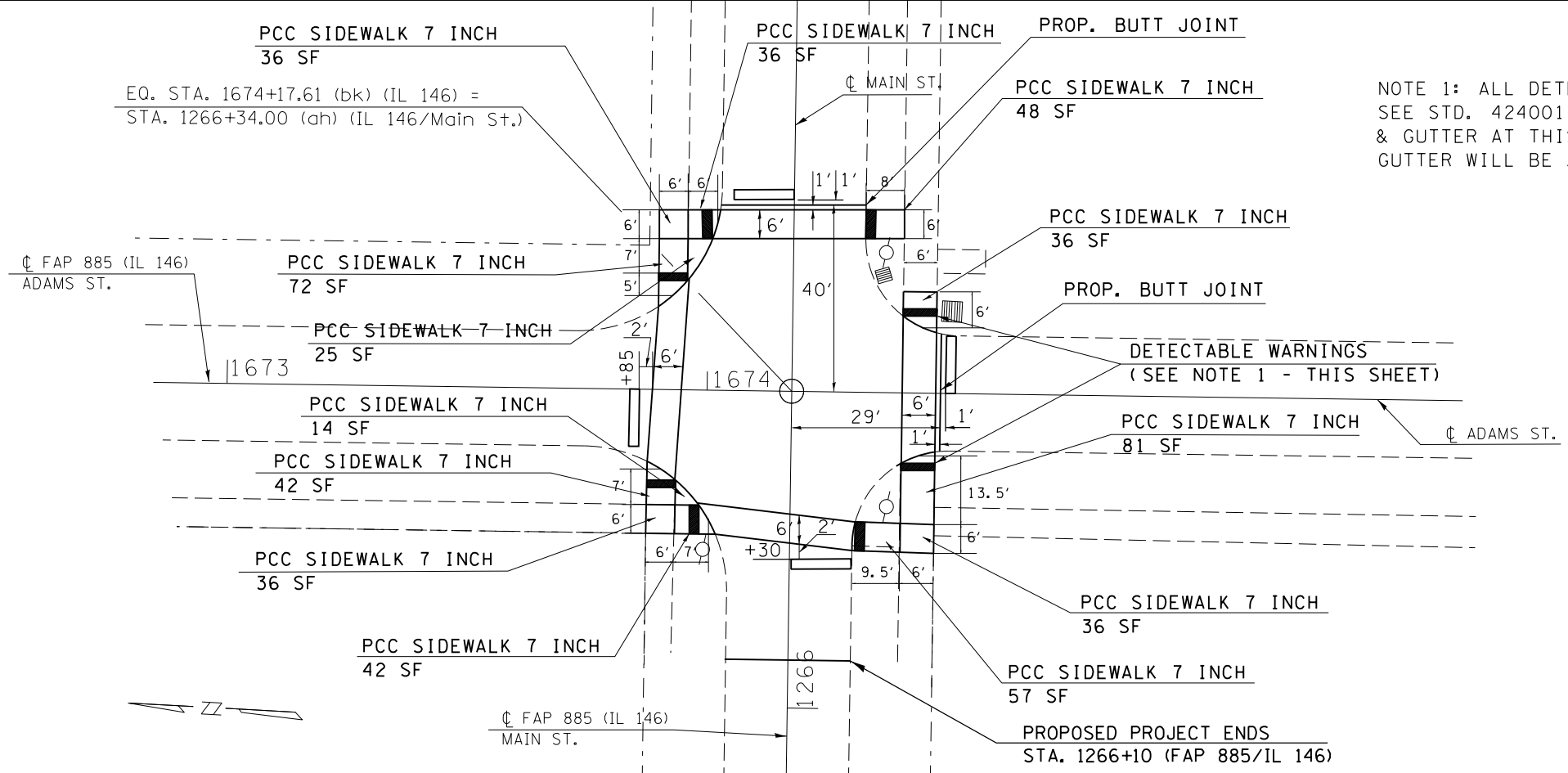
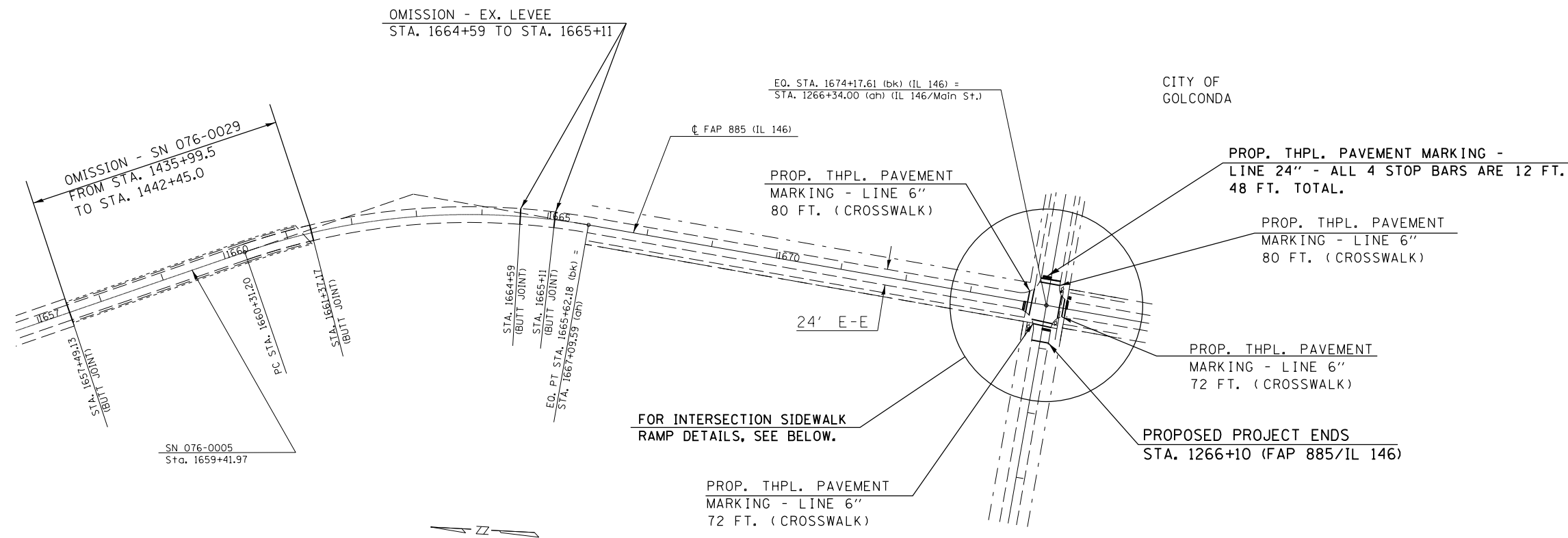

NOTE 1: ALL DETECTABLE WARNINGS ARE 2' x 6'. SEE STD. 424001-07 FOR DETAILS. NO EXISTING CURB & GUTTER AT THIS LOCATION, SO NO NEW CURB & GUTTER WILL BE ADDED.

FILE NAME =	USER NAME = mccordkr	DESIGNED -	REVISED -	STATE OF ILLINOIS DEPARTMENT OF TRANSPORTATION	PLAN LAYOUT #9; DETAIL: NEW RAMPS AT IL 146/MAIN ST. IN GOLCONDA.	F.A.P. RTE.	SECTION	COUNTY	TOTAL SHEETS	SHEET NO.
et:\pw\work\p\id\dot\mccordkr\ad0402536\78339-sh\plan.dgn	PLOT SCALE = 200.0000' / in.	DRAWN -	REVISED -			885	7RS-3,6RS-7	POPE/HARDIN	28	25
Default	PLOT DATE = 6/27/2014	CHECKED -	REVISED -			CONTRACT NO. 78339				
		DATE -	REVISED -			ILLINOIS FED. AID PROJECT				

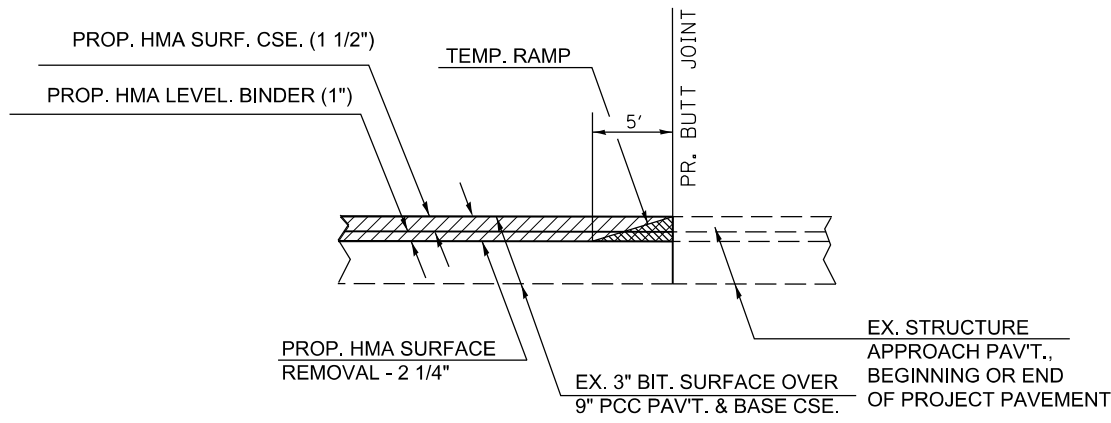

DETAIL FOR BUTT JOINTS
(SEE SPECIAL PROVISIONS
FOR NOTE)

FILE NAME =	USER NAME = mccordkr	DESIGNED -	REVISED -
c:\pwwork\pwwork\mccordkr\0402536\78339-sh:plan.dgn		DRAWN -	REVISED -
Default	PLOT SCALE = 196.9342' / in.	CHECKED -	REVISED -
	PLOT DATE = 6/27/2014	DATE -	REVISED -

STATE OF ILLINOIS
DEPARTMENT OF TRANSPORTATION

DETAIL: BUTT JOINT FOR BEGINNING, ENDING
AND AT STRUCTURES.

SCALE: SHEET OF SHEETS STA. TO STA.

F.A.P. RTE.	SECTION	COUNTY	TOTAL SHEETS	SHEET NO.
885	7RS-3,6RS-7	POPE/HARDIN	28	26
ILLINOIS FED. AID PROJECT			CONTRACT NO. 78339	

TEMPORARY HOT-MIX ASPHALT TRANSITIONS

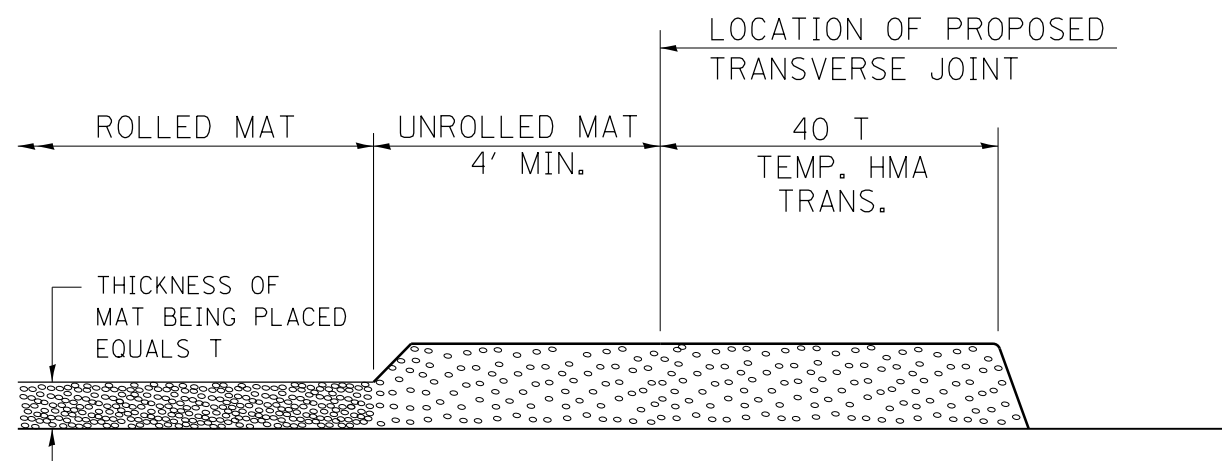

STEP I

1. PLACE HOT-MIX ASPHALT MAT, LENGTH 40 TIMES THE THICKNESS OF THE MAT BEING PLACED PAST THE PROPOSED TRANSVERSE JOINT LOCATION USING NORMAL OPERATING PROCEDURES.
2. EXTREME CARE SHOULD BE TAKEN TO MAINTAIN ENOUGH MATERIAL IN FRONT OF THE SCREED TO MAINTAIN REQUIRED PAVING DEPTH.

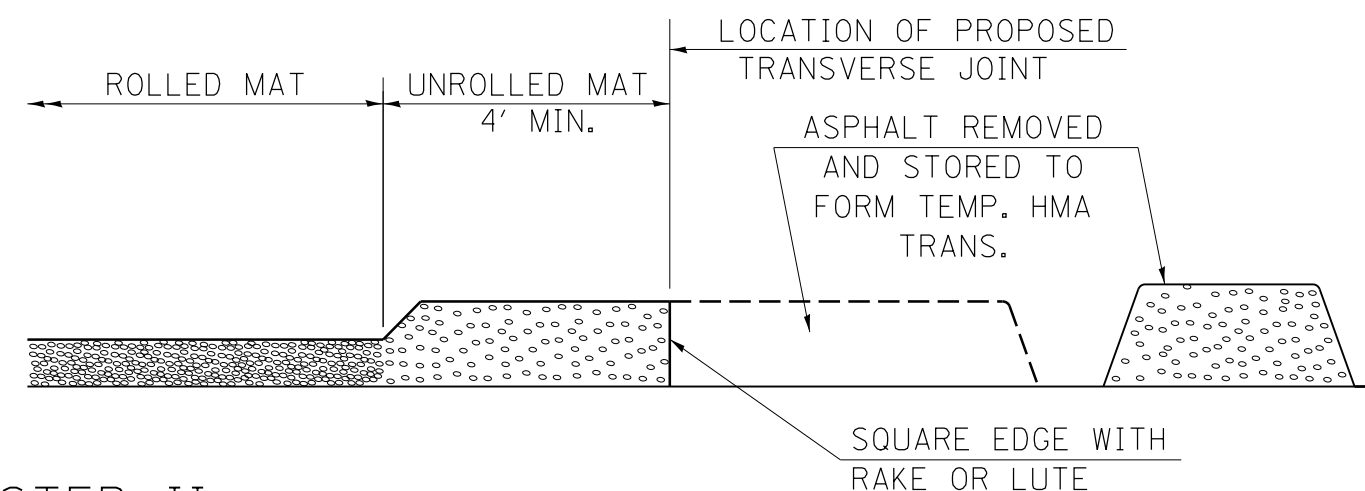

STEP II

1. MOVE THE PAVER OUT OF THE WAY AND REMOVE THE ASPHALT FROM THE AREA OF THE PROPOSED TEMPORARY HOT-MIX ASPHALT TRANSITION.
2. SQUARE UP THE END OF THE MAT WITH A RAKE OR LUTE.
3. NOTE THAT THE MAT WITHIN 4' OF THE END OF JOINT IS NOT TO BE ROLLED AT THIS TIME.

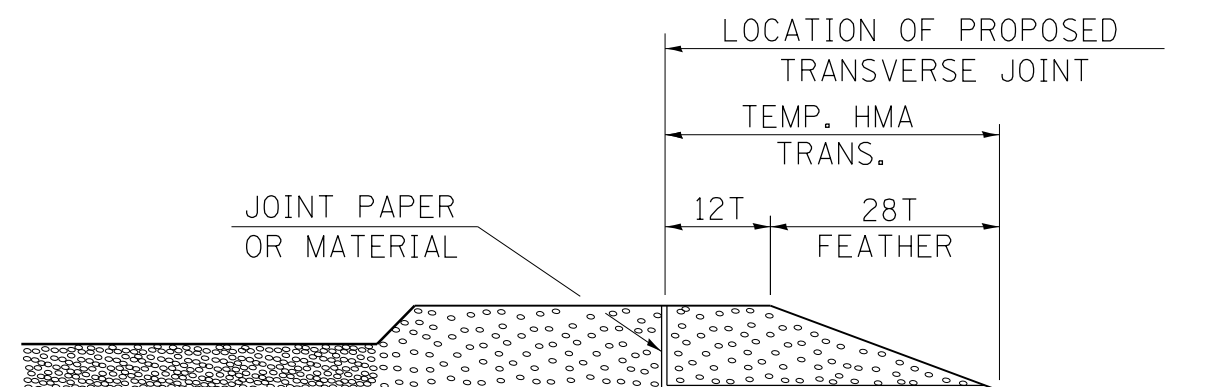

STEP III

1. JOINT PAPER OR OTHER PRESELECTED JOINT MATERIAL IS THEN PLACED IN THE CLEARED AREA AND THE EXCESS ASPHALT USED TO HAND FORM A TRANSITION TO THE DIMENSIONS SHOWN ABOVE.
2. NOTE THAT IN CONSTRUCTING THE TRANSITION, THE MAT DEPTH IS CONTINUED AS PART OF THE TRANSITION BEFORE FORMING THE FEATHER.

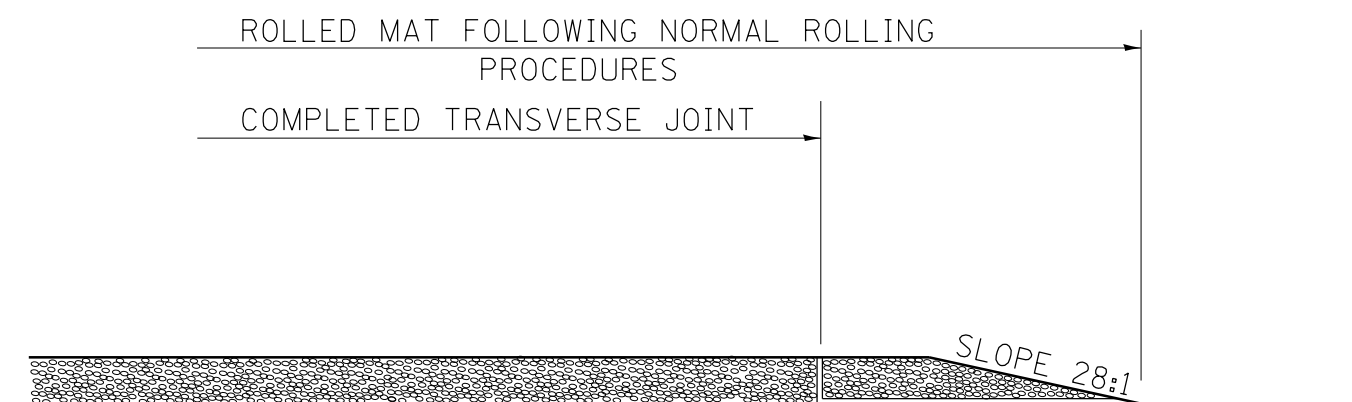

STEP IV

1. COMPLETE TEMPORARY TRANSITION BY ROLLING.
2. TO RESUME PAVING, AT THE JOINT, REMOVE TEMPORARY TRANSITION AND DISPOSE OF THE MATERIAL ACCORDING TO ART. 202.03 OF THE STD. SPECS. (COST INCLUDED IN THE CONTRACT).
3. CONSTRUCTING THE TEMPORARY TRANSITIONS WILL NOT BE PAID FOR SEPARATELY IN ACCORDANCE WITH ARTICLE 406.14 OF THE STANDARD SPECIFICATIONS.

REVISIONS

REDRAWN	2-15-89
REVISED	8-16-94
REVISED	01-09-07
RESIZED	05-8-08
REVISED	05-16-13

STD. 9-26

FILE NAME =	USER NAME = mccordkr	DESIGNED -	REVISED -
es:\pwwork\pwwork\mccordkr\d0402536\78339-sh1-plan.dgn		DRAWN -	REVISED -
		CHECKED -	REVISED -
		DATE -	REVISED -

STATE OF ILLINOIS
DEPARTMENT OF TRANSPORTATION

TEMP. HOT-MIX ASPHALT
TRANSITIONS

SCALE: SHEET NO. OF SHEETS STA. TO STA.

F.A.P. RTE.	SECTION	COUNTY	TOTAL SHEETS	SHEET NO.
885	7RS-3,6RS-7	POPE/HARDIN	28	27
CONTRACT NO. 78339				
ILLINOIS FED. AID PROJECT				

ILLINOIS STANDARD

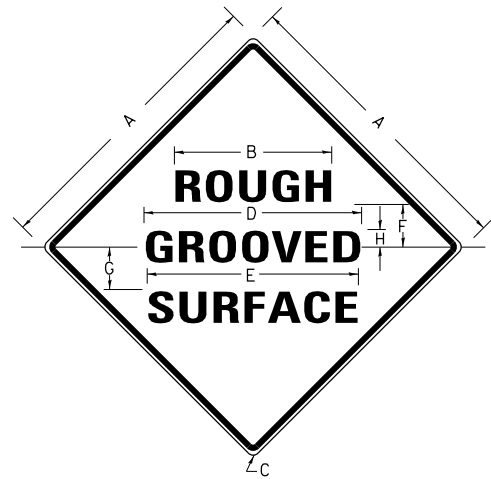

COLORS:

LEGEND AND BORDER- BLACK NON-REFLECTORIZED
BACKGROUND- ORANGE REFLECTORIZED

SIGN SIZE	DIMENSIONS							
	A	B	C	D	E	F	G	H
48x48	48.0	24.1	3.0	34.0	33.0	6.0	13.0	3.5

SIGN SIZE	SERIES LINES			MAR-GIN	BOR-DER	BLANK STD.
	1	2	3			
48x48	7C	7C	7C	0.8	1.2	B4-48D

ALL DIMENSIONS IN INCHES

NOTES:

PRIOR TO ALLOWING TRAFFIC ON ANY PORTION OF THE ROADWAY THAT HAS BEEN COLDMILLED, THE CONTRACTOR SHALL HAVE ERECTED "ROUGH GROOVED SURFACE" SIGNS THAT CONFORM TO THE ABOVE DETAILS. A MINIMUM OF ONE SIGN AT EACH END OF THE IMPROVEMENT WILL BE REQUIRED. THE CONTRACTOR SHALL MAINTAIN THE "ROUGH GROOVED SURFACE" SIGNS UNTIL THE COLDMILLED SURFACE IS COVERED WITH LEVELING BINDER OR SURFACE COURSE.

IF AT ANY TIME THE SIGNS ARE IN PLACE BUT NOT APPLICABLE, THEY SHALL BE TURNED FROM THE VIEW OF MOTORISTS OR COVERED AS DIRECTED BY THE ENGINEER.

THE COST OF FURNISHING, ERECTING, MAINTAINING, AND REMOVING THE REQUIRED SIGNS SHALL BE INCLUDED IN THE CONTRACT.

REVISIONS

REDRAWN	2-15-89
REVISED	4-6-93
REVISED	3-27-08
REVIEWED	5-17-13

STD. 9-39

UNEVEN LANES SIGN

W8-11 (48" x 48")

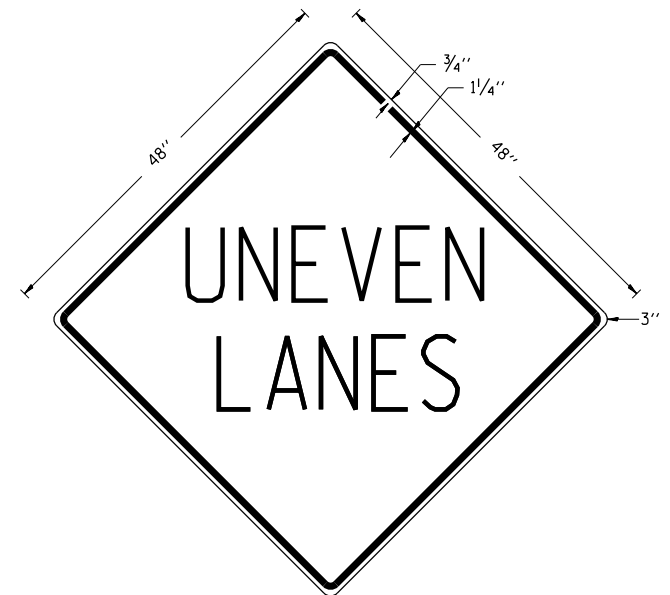

COLORS:

LEGEND AND BORDER - BLACK NON-REFLECTORIZED
BACKGROUND - ORANGE REFLECTORIZED

NOTE: PRIOR TO ALLOWING TRAFFIC ON ANY PORTION OF THE ROADWAY THAT HAS BEEN COLDMILLED OR BEFORE RESURFACING OPERATIONS BEGIN, THE CONTRACTOR SHALL HAVE ERECTED "UNEVEN PAVEMENT" SIGNS THAT CONFORM TO THE ABOVE DETAILS. A MINIMUM OF ONE SIGN AT EACH END OF THE IMPROVEMENT WILL BE REQUIRED. THE CONTRACTOR SHALL MAINTAIN THE "UNEVEN PAVEMENT" SIGNS UNTIL THE RESURFACING OPERATIONS ARE COMPLETED.

IF AT ANY TIME THE SIGNS ARE IN PLACE BUT NOT APPLICABLE, THEY SHALL BE TURNED FROM THE VIEW OF MOTORISTS OR COVERED AS DIRECTED BY THE ENGINEER.

THE COST OF FURNISHING, ERECTING, MAINTAINING, AND REMOVING THE REQUIRED SIGNS SHALL BE INCLUDED IN THE CONTRACT.

REVISIONS

DRAWN	2-15-89
REVISED	4-06-93
REDESIGNED	7-23-04
RESIZED	5-08-08
REVIEWED	5-17-13

STD. 9-41

FILE NAME =	USER NAME = mccordkr	DESIGNED -	REVISED -
et:\pw\work\p1dot\mccordkr\0402536\78339-sh1-pla.dgn		DRAWN -	REVISED -
	PLOT SCALE = 1/8"=1'-0"	CHECKED -	REVISED -
	PLOT DATE = 6/27/2014	DATE -	REVISED -

STATE OF ILLINOIS
DEPARTMENT OF TRANSPORTATION

SIGNS: ROUGH GROOVED SURFACE,
UNEVEN LANES

SCALE: SHEET NO. OF SHEETS STA. TO STA.

F.A.P. RTE.	SECTION	COUNTY	TOTAL SHEETS	SHEET NO.
885	7RS-3,6RS-7	POPE/HARDIN	28	28
CONTRACT NO. 78339				
ILLINOIS FED. AID PROJECT				