

FOR INDEX OF SHEETS, SEE SHEET NO. 2

PROJECT LOCATED IN  
THE VILLAGE OF BURR RIDGE  
IN COOK & DUPAGE COUNTIES

STATE OF ILLINOIS  
DEPARTMENT OF TRANSPORTATION  
DIVISION OF HIGHWAYS  
**PROPOSED  
HIGHWAY PLANS**

FAI 55 (I-55)  
AT COUNTY LINE ROAD  
SECTION 22-1HB-R  
PROJECT : NHPP-TE-0055(009)  
COOK /DUPAGE COUNTY  
BRIDGE SUPERSTRUCTURE  
C-91-591-10

COUNTY LINE ROAD  
POSTED SPEED LIMIT = 45 MPH  
DESIGN SPEED LIMIT = 50 MPH

FUNCTIONAL CLASSIFICATION  
MINOR URBAN ARTERIAL  
2010 ADT = 18,400  
P.V. = 94.2% S.U. & M.U. = 5.8%

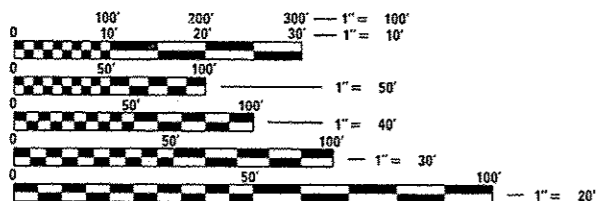

FULL SIZE PLANS HAVE BEEN PREPARED USING STANDARD  
ENGINEERING SCALES. REDUCED SIZED PLANS WILL NOT  
CONFORM TO STANDARD SCALES. IN MAKING MEASUREMENTS  
ON REDUCED PLANS, THE ABOVE SCALES MAY BE USED.

J.U.L.I.E.  
JOINT UTILITY LOCATION INFORMATION FOR EXCAVATION  
1-800-892-0123  
OR 811

PROJECT MANAGER: BRIAN KUTTAB

CONTRACT NO. 60K77

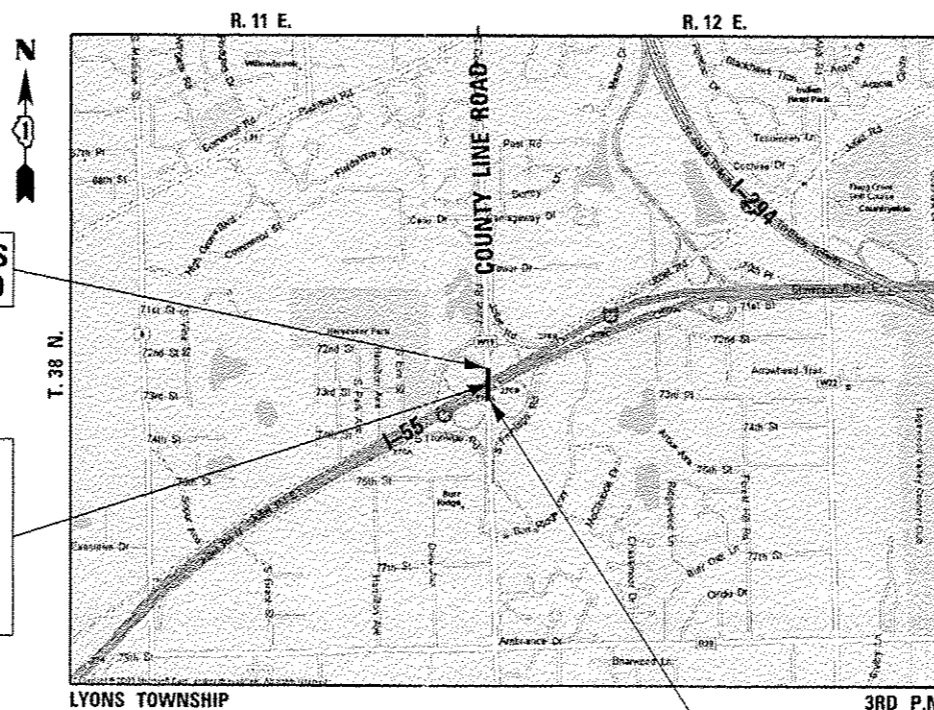

PROJECT ENDS  
STA 66 + 55.00

BRIDGE  
SUPERSTRUCTURE  
STA. 64 + 13.00  
S.N. 016-0587  
COUNTY LINE ROAD  
OVER I-55

LOCATION MAP  
NOT TO SCALE

PROJECT BEGINS  
STA. 61 + 80.00

GROSS LENGTH = 475.00 FT. = 0.090 MILE  
NET LENGTH = 475.00 FT. = 0.090 MILE

F.A.I. RTE.	SECTION	COUNTY	TOTAL SHEETS	SHEET NO.
55	22-1HB-R	COOK/DUPAGE	161	1
FED. ROAD DIST. NO. 1		ILLINOIS	CONTRACT NO. 60K77	

D-91-591-10



LOCATION OF SECTION INDICATED THIS: -

*Marc A. Grigas*  
1/24/13 Exp. 11/30/13  
STRAND ASSOCIATES, INC.  
MARC A. GRIGAS, P.E.  
THIS STAMP APPLIES TO  
DRAWINGS NO. 1-46, 50-59, 61-68,  
73, 74, 78, 131-161

*Anthony J. Standish*  
1/24/13 Exp. 11/30/13  
STRAND ASSOCIATES, INC.  
ANTHONY J. STANDISH, P.E., S.E.  
THIS STAMP APPLIES TO  
DRAWINGS NO. 69-72, 89-130

*Andrew J. Runde*  
1/24/13 Exp. 11/30/13  
STRAND ASSOCIATES, INC.  
ANDREW J. RUNDE, P.E.,  
THIS STAMP APPLIES TO  
DRAWINGS NO. 75-77

*Isaac Yun*  
1/24/2013 Exp. 11/30/2013  
SINGH & ASSOCIATES, INC.  
ISAAC YUN, P.E.  
THIS STAMP APPLIES TO  
DRAWINGS NO. 47-49, 60

*Angela C. Giovannone*  
1/24/2013 Exp. 11/30/2013  
SINGH & ASSOCIATES, INC.  
ANGELA C. GIOVANNONE, P.E.  
THIS STAMP APPLIES TO  
DRAWINGS NO. 84-88

**SA**  
**STRAND**  
ASSOCIATES\*

1170 SOUTH HOUBOLT ROAD  
JOLIET, ILLINOIS 60431  
(815) 744-4200  
IDFPR NO. 184-001273

STATE OF ILLINOIS  
DEPARTMENT OF TRANSPORTATION  
DIVISION OF HIGHWAYS

SUBMITTED *January 25, 2013*

*John Fortman*  
DEPUTY DIRECTOR OF HIGHWAYS, REGION ENGINEER

*Aug 16 2013*  
*John D. Baranelli, P.E.*  
ENGINEER OF DESIGN AND ENVIRONMENT

*Aug 16 2013*  
*Omer Osman, P.E.*  
DIRECTOR OF HIGHWAYS, CHIEF ENGINEER

PRINTED BY THE AUTHORITY  
OF THE STATE OF ILLINOIS