

INDEX OF SHEETS

- 1 COVER SHEET
- 2 INDEX OF SHEETS, STANDARDS, GENERAL NOTES & COMMITMENTS
- 3 SUMMARY OF QUANTITIES
- 4 MAINTENANCE OF TRAFFIC TYPICAL SECTION
- 5-13 MAINTENANCE OF TRAFFIC PLANS
- 14-18 PAVEMENT MARKING PLAN
- * 19-39 STRUCTURAL PLANS
- 40-48 DISTRICT STANDARDS

* INCLUDES 33A. - 33I.

STATE STANDARDS

606001-04	CONCRETE CURB TYPE B AND COMBINATION CONCRETE CURB AND GUTTER
630001-10	STEEL PLATE BEAM GUARDRAIL
635011-02	REFLECTOR MARKER AND MOUNTING DETAILS
701400-04	APPROACH TO LANE CLOSURE, FREEWAY/EXPRESSWAY
701402-09	LANE CLOSURE, FREEWAY/EXPRESSWAY, WITH BARRIER
701411-08	LANE CLOSURE, MULTILANE, AT ENTRANCE OR EXIT RAMP, FOR SPEEDS ≥ 45 MPH
701423-04	LANE CLOSURE, MULTILANE, WITH BARRIER, FOR SPEEDS ≥ 45 MPH TO 55 MPH
701426-05	LANE CLOSURE, MULTILANE, INTERMITTENT OR MOVING OPER., FOR SPEEDS ≥ 45 MPH
701901-02	TRAFFIC CONTROL DEVICES
704001-07	TEMPORARY CONCRETE BARRIER
720001-01	SIGN PANEL MOUNTING DETAILS
720011-01	METAL POSTS FOR SIGNS, MARKERS AND DELINEATORS
728001-01	TELESCOPING STEEL SIGN SUPPORT
729001-01	APPLICATIONS OF TYPE A AND B METAL POSTS (FOR SIGNS AND MARKERS)

DISTRICT STANDARDS (sheets 40-48)

BD24	CURB OR CURB AND GUTTER REMOVAL AND REPLACEMENT
TC10	TRAFFIC CONTROL AND PROTECTION FOR SIDE ROADS, INTERSECTIONS, AND DRIVEWAYS
TC11	TYPICAL APPLICATIONS RAISED REFLECTIVE PAVEMENT MARKERS (SNOW-PLOW RESISTANT)
TC12	MULTI-LANE FREEWAY PAVEMENT MARKING DETAILS
TC13	TYPICAL PAVEMENT MARKINGS
TC16	PAVEMENT MARKING LETTERS AND SYMBOLS FOR TRAFFIC STAGING
TC22	ARTERIAL ROAD INFORMATION SIGN
TC26	DRIVEWAY ENTRANCE SIGNING

COMMITMENTS

NO COMMITMENTS HAVE BEEN MADE FOR THIS PROJECT.

GENERAL NOTES

1. THESE PLANS HAVE BEEN PREPARED FROM INFORMATION ACQUIRED FROM EXISTING PLANS AND NOTES RECEIVED FROM IDOT FIELD MAINTENANCE ENGINEERS.
2. PLAN DIMENSIONS AND DETAILS RELATIVE TO EXISTING PLANS ARE SUBJECT TO VARIATIONS FOUND IN THE FIELD. THE CONTRACTOR SHALL FIELD VERIFY EXISTING DIMENSIONS AND DETAILS AFFECTING NEW CONSTRUCTION AND MAKE NECESSARY ADJUSTMENTS PRIOR TO CONSTRUCTION OR ORDERING MATERIALS. ANY ADJUSTMENTS PROPOSED BY THE CONTRACTOR MUST BE APPROVED BY THE ENGINEER. SUCH VARIATIONS SHALL NOT BE CAUSE FOR ADDITIONAL COMPENSATION FOR A CHANGE IN THE SCOPE OF WORK, HOWEVER, THE CONTRACTOR WILL BE PAID FOR THE QUANTITY ACTUALLY FURNISHED BASED UPON THE UNIT PRICE.
3. QUANTITIES FOR DECK SLAB REPAIR ARE APPROXIMATE. LOCATIONS WILL BE DETERMINED BY THE ENGINEER FOLLOWING REMOVAL OF THE HMA SURFACE COURSE AND SCARIFICATION. ACTUAL REPAIR LOCATIONS SHALL BE SHOWN ON THE AS-BUILT PLANS.
4. FORTY-EIGHT HOURS BEFORE STARTING EXCAVATION, THE CONTRACTOR WILL CALL J.U.L.I.E. (1-800-892-0123) OR 811 FOR LOCATIONS OF THE EXISTING UTILITIES.
5. THE CONTRACTOR WILL NOT BE ALLOWED TO SET UP A YARD OR FIELD OFFICE ON STATE PROPERTY WITHOUT WRITTEN PERMISSION FROM THE DEPARTMENT.
6. SAW CUTTING PRIOR TO ANY REMOVAL ITEMS NOTED ON THE PLANS OR DIRECTED BY THE ENGINEER SHALL BE CONSIDERED INCLUDED IN THE COST OF THE ITEMS BEING REMOVED.
7. DO NOT SCALE PLANS FOR CONSTRUCTION DIMENSIONS.
8. THE CONTRACTOR SHALL USE CARE IN REMOVING OR EXCAVATING NEAR ALL EXISTING ITEMS WHICH WILL REMAIN. ANY DAMAGE DONE TO EXISTING ITEMS BY THE CONTRACTOR SHALL BE REPAIRED AT THE CONTRACTOR'S EXPENSE.
9. WHEN ARTIFICIAL LIGHTING IS UTILIZED IN NIGHT OPERATIONS, THE CONTRACTOR SHALL EXERCISE THE UTMOST PRECAUTIONS IN PREVENTING ADVERSE VISIBILITY TO THE MOTORING PUBLIC AS WELL AS ADJOINING RESIDENTIAL AREAS.
10. THE CONTRACTOR SHALL OBTAIN ALL NECESSARY PERMITS, AS REQUIRED, PRIOR TO COMMENCING WITH CONSTRUCTION.
11. THE CONTRACTOR SHALL CONTACT THE TRAFFIC CONTROL SUPERVISOR, ANDREW SCHUETZE, AT (847) 705-4470 A MINIMUM OF 72 HOURS PRIOR TO THE PLACEMENT OF ANY TEMPORARY TRAFFIC CONTROL DEVICES.
12. THE CONTRACTOR SHALL CONTACT MR. DON CHIARUGI, THE AREA TRAFFIC FIELD TECHNICIAN, AT (847) 741-9857 TWO (2) WEEKS PRIOR TO THE PLACEMENT OF PERMANENT PAVEMENT MARKINGS.
13. ALL DAMAGE TO EXISTING PAVEMENT MARKINGS OUTSIDE THE REMOVAL LINE SHOWN ON THE PLANS SHALL BE REPLACED AT THE CONTRACTOR'S EXPENSE.
14. BEFORE BEGINNING ANY WORK, THE CONTRACTOR SHALL RETAIN ANY RECORD FOR FUTURE REFERENCE. ALL EXISTING PAVEMENT MARKING LINES AND RAISED REFLECTIVE PAVEMENT MARKERS IN ORDER THAT THESE LOCATIONS CAN BE RE-ESTABLISHED FOR STRIPING. EXACT LOCATIONS OF ALL PAVEMENT MARKINGS SHALL BE AS DIRECTED BY THE ENGINEER.
15. THE CONTRACTOR SHALL COORDINATE CONSTRUCTION ACTIVITIES WITH UTILITY COMPANIES AND THE VILLAGE OF SUGAR GROVE.
16. THE CONTRACTOR SHALL BE REQUIRED TO PROVIDE ACCESS TO ABUTTING PROPERTY AT ALL TIMES DURING THE CONSTRUCTION OF THIS PROJECT.
17. AN OPER 2410 FORM REPORTING A WIDTH RESTRICTION DURING CONSTRUCTION SHALL BE SUBMITTED TO IDOT CENTRAL OFFICE IN SPRINGFIELD, BUREAU OF OPERATIONS A MINIMUM OF 21 DAYS PRIOR TO INSTALLING TEMPORARY CONCRETE BARRIER.

18. FOR WORK OUTSIDE THE LIMITS OF BRIDGE APPROACH PAVEMENT, ALL REFERENCES IN THE HIGHWAY STANDARDS AND STANDARD SPECIFICATIONS FOR REINFORCEMENT, DOWEL BARS AND TIE BARS IN PAVEMENT, SHOULDERS, CURB, GUTTER, COMBINATION CURB AND GUTTER AND MEDIAN, AND CHAIR SUPPORTS FOR THE CRC PAVEMENT, SHALL BE EPOXY COATED, UNLESS NOTED IN THE PLAN.



HOT-MIX ASPHALT MIXTURE REQUIREMENTS		
MIXTURE TYPE	AIR VOIDS	LIFT THICKNESS
BRIDGE APPROACH PAVEMENT		
HOT-MIX ASPHALT SURFACE COURSE, MIX "D", N50 (IL 9.5 mm), 2"	4% @ 50 Gyr.	1-1/2"
TEMPORARY PAVEMENT (10")		
HOT-MIX ASPHALT SURFACE COURSE, MIX "D", N50 (IL 9.5 mm), 2"	4% @ 50 Gyr.	2"
TEMPORARY PAVEMENT (HMA BINDER IL-19.0mm), 8"	4% @ 50 Gyr.	2-1/4" MIN.

THE UNIT WEIGHT USED TO CALCULATE ALL HMA SURFACE MIXTURE QUANTITIES IS 112 LBS/SQ YD/IN. THE AC TYPE FOR POLYMERIZED HMA MIXTURES SHALL BE "SBS/SBR PG 76-22" AND FOR NON-POLYMERIZED HMA THE "AC TYPE" SHALL BE "PG 64-22" UNLESS MODIFIED BY DISTRICT ONE SPECIAL PROVISIONS. FOR "PERCENT OF RAP" SEE DISTRICT ONE SPECIAL PROVISIONS. PCC TEMPORARY PAVEMENT SHALL CONSIST OF CLASS PV CONCRETE MEETING THE REQUIREMENTS OF ART. 1020 OF THE STANDARD SPECIFICATIONS; TYPICALLY 10" THICK.

Rev. 9-10-13

Rev.

LIN ENGINEERING LTD. Consulting Engineers 3000 N. Lincoln Ave.	USER NAME : *USER*	DESIGNED - SEW	REVISED -	STATE OF ILLINOIS DEPARTMENT OF TRANSPORTATION	INDEX OF SHEETS, STANDARDS, GENERAL NOTES & COMMITMENTS US ROUTE 30 / IL 56 OVER IL 47			F.A.P. RTE.	SECTION	COUNTY	TOTAL SHEETS	SHEET NO.
	PLOT SCALE : *SCALE*	DRAWN - SEW	REVISED -		SCALE: N/A	SHEET NO. 1 OF 1 SHEETS	STA. TO STA.	573	61 HB-1-7	KANE	48	2
	PLOT DATE : *DATE*	DATE - 11/2011	REVISED -				CONTRACT NO. 60N12					
FED. ROAD DIST. NO. ILLINOIS FED. AID PROJECT												

SUMMARY OF QUANTITIES

CODE NUMBER	ITEM	UNIT	TOTAL QUANTITY	S.N.		0005 ROADWAY
				045-0035	045-0036	
40600100	BITUMINOUS MATERIALS (PRIME COAT)	GALLON	315	123	179	13
40603335	HOT-MIX ASPHALT SURFACE COURSE, MIX "D", N50	TON	135	55	80	
44000157	HOT-MIX ASPHALT SURFACE REMOVAL, 2"	SO YD	605	246	359	
44000500	COMBINATION CURB AND GUTTER REMOVAL	FOOT	320	160	160	
48101620	AGGREGATE SHOULDERS, TYPE B 10"	SO YD	129			129
50102400	CONCRETE REMOVAL	CU YD	29.0	12.9	16.1	
50104650	SLOPE WALL REMOVAL	SO YD	319	215	104	
50157300	PROTECTIVE SHIELD	SO YD	898	383	515	
50300100	FLOOR DRAINS	EACH	24	12	12	
50300255	CONCRETE SUPERSTRUCTURE	CU YD	29.2	13.0	16.2	
50300260	BRIDGE DECK GROOVING	SO YD	1741	720	1021	
50300300	PROTECTIVE COAT	SO YD	424	205	219	
50500405	FURNISHING AND ERECTING STRUCTURAL STEEL	POUND	13570	11270	2300	
50800205	REINFORCEMENT BARS, EPOXY COATED	POUND	2620	1120	1500	
50800515	BAR SPLICERS	EACH	48	24	24	
51100100	SLOPE WALL 4 INCH	SO YD	319	213	106	
52000110	PREFORMED JOINT STRIP SEAL	FOOT	166	70	96	
52100020	ELASTOMERIC BEARING ASSEMBLY, TYPE II	EACH	30	12	18	
52100520	ANCHOR BOLTS, 1"	EACH	60	24	36	
63301235	REMOVE AND REERECT STEEL PLATE BEAM GUARDRAIL, ATTACHED TO STRUCTURES	FOOT	48	24	24	
67000400	ENGINEER'S FIELD OFFICE, TYPE A	CAL MO	6			6
67100100	MOBILIZATION	L SUM	1			1
70100207	TRAFFIC CONTROL AND PROTECTION, STANDARD 701402	EACH	2			2
70100325	TRAFFIC CONTROL AND PROTECTION, STANDARD 701423	EACH	2			2
70100420	TRAFFIC CONTROL AND PROTECTION, STANDARD 701411	EACH	6			6
70103815	TRAFFIC CONTROL SURVEILLANCE	CAL DA	6			6
70106800	CHANGEABLE MESSAGE SIGN	CAL MO	4			4
70301000	WORK ZONE PAVEMENT MARKING REMOVAL	SO FT	4213			4213
70400100	TEMPORARY CONCRETE BARRIER	FOOT	1650.0			1650.0
70400200	RELOCATE TEMPORARY CONCRETE BARRIER	FOOT	1288			1288
70600260	IMPACT ATTENUATORS, TEMPORARY (FULLY REDIRECTIVE, NARROW), TEST LEVEL 3	EACH	3			3
70600250	IMPACT ATTENUATORS, TEMPORARY (NON-REDIRECTIVE), TEST LEVEL 3	EACH	4			4
70600332	IMPACT ATTENUATORS, RELOCATE (FULLY REDIRECTIVE, NARROW), TEST LEVEL 3	EACH	1			1
70600350	IMPACT ATTENUATORS, RELOCATE (NON-REDIRECTIVE), TEST LEVEL 3	EACH	1			1
72000300	SIGN PANEL - TYPE 3	SO FT	94.5	94.5		

CODE NUMBER	ITEM	UNIT	TOTAL QUANTITY	S.N.		0005 ROADWAY
				045-0035	045-0036	
73304000	OVERHEAD SIGN STRUCTURE - BRIDGE MOUNTED	FOOT	13.5	13.5		
78000100	THERMOPLASTIC PAVEMENT MARKING - LETTERS AND SYMBOLS	SO FT	77			77
78000200	THERMOPLASTIC PAVEMENT MARKING - LINE 4"	FOOT	10,847			10,847
78000400	THERMOPLASTIC PAVEMENT MARKING - LINE 6"	FOOT	155			155
78000500	THERMOPLASTIC PAVEMENT MARKING - LINE 8"	FOOT	6,007			6,007
78000600	THERMOPLASTIC PAVEMENT MARKING - LINE 12"	FOOT	395			395
78100100	RAISED REFLECTIVE PAVEMENT MARKER	EACH	162			162
78200530	BARRIER WALL MARKERS, TYPE C	EACH	264			264
78300100	PAVEMENT MARKING REMOVAL	SO FT	8,134			8,134
78300200	RAISED REFLECTIVE PAVEMENT MARKER REMOVAL	EACH	162			162
X0326766	CLEAN & RESEAL RELIEF JOINT	FOOT	136	54	82	
X4400110	TEMPORARY PAVEMENT REMOVAL	SO YD	129			129
X6060082	COMBINATION CONCRETE CURB AND GUTTER, TYPE M-6.12 (SPECIAL)	FOOT	320	160	160	
X7010216 TRAFFIC CONTROL AND PROTECTION (SPECIAL)			L SUM	1		1
X7011015 TRAFFIC CONTROL AND PROTECTION (EXPRESSWAYS)			L SUM	1		1
X7030030	WET REFLECTIVE TEMPORARY TAPE TYPE III, 4 INCH	FOOT	14,404			14,404
X7030045	WET REFLECTIVE TEMPORARY TAPE TYPE III, 8 INCH	FOOT	6367			6367
X7030050 WET REFLECTIVE TEMPORARY TAPE TYPE III, 12 INCH			FOOT	146		146
Z0001800	APPROACH SLAB REPAIR (PARTIAL DEPTH)	SO YD	19	9	10	
Z0001899	JACK AND REMOVE EXISTING BEARINGS	EACH	30	12	18	
Z0001903	STRUCTURAL STEEL REMOVAL	POUND	9570	9570		
Z0001905	STRUCTURAL STEEL REPAIR	POUND	10610	4790	5820	
Z0003600	BEAM STRAIGHTENING	L SUM	1	0.3	0.7	
Z0006020	BRIDGE DECK LATEX CONCRETE OVERLAY 3/2"	SO YD	1807	755	1052	
Z0012152	BRIDGE DECK SCARIFICATION 3/2"	SO YD	1807	755	1052	
Z0012754	STRUCTURAL REPAIR OF CONCRETE (DEPTH EQUAL TO OR LESS THAN 5 INCHES)	SO FT	702	273	429	
Z0012755	STRUCTURAL REPAIR OF CONCRETE (DEPTH GREATER THAN 5 INCHES)	SO FT	77		77	
Z0016002	DECK SLAB REPAIR (FULL DEPTH, TYPE II)	SO YD	54	24	30	
Z0030850	TEMPORARY INFORMATION SIGNING	SO FT	280			280
Z0062456	TEMPORARY PAVEMENT	SO YD	129			129
Z0073300	TEMPORARY SHORING AND CRIBBING	L SUM	1	0.5	0.5	
Z0073351	TEMPORARY SLAB SUPPORT SYSTEM	L SUM	1	1		

• DENOTES SPECIALTY ITEM

Rev. 9-10-13











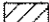

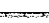
USER NAME - #USER#	DESIGNED - SEW	REVISED -
PLOT SCALE - #SCALE#	DRAWN - SEW	REVISED -
PLOT DATE - #DATE#	CHECKED - ST	REVISED -
	DATE - 11/2011	REVISED -

STATE OF ILLINOIS
DEPARTMENT OF TRANSPORTATION

SUMMARY OF QUANTITIES US ROUTE 30 / IL 56 OVER IL 47		F.A.P. RTE. 573	SECTION 61 HB-1-7	COUNTY KANE	TOTAL SHEETS 48	SHEET NO. 3
SCALE: N/A	SHEET NO. 1 OF 1 SHEETS	STA. TO STA.	FED. ROAD DIST. NO. ILLINOIS FED. AID PROJECT			

LEGEND

-  WORK AREA
-  IMPACT ATTENUATORS, TEMPORARY
-  TEMPORARY CONCRETE BARRIER
-  DRUM WITH STEADY BURN MONODIRECTIONAL LIGHT
-  DIRECTION INDICATOR BARRICADE WITH STEADY BURN MONODIRECTIONAL LIGHT
-  TYPE II BARRICADES OR DRUMS
-  SIGN
-  CHANGEABLE MESSAGE BOARD
-  ARROW BOARD
-  TEMPORARY PAVEMENT

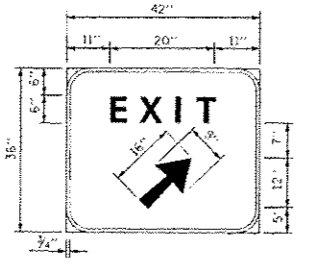
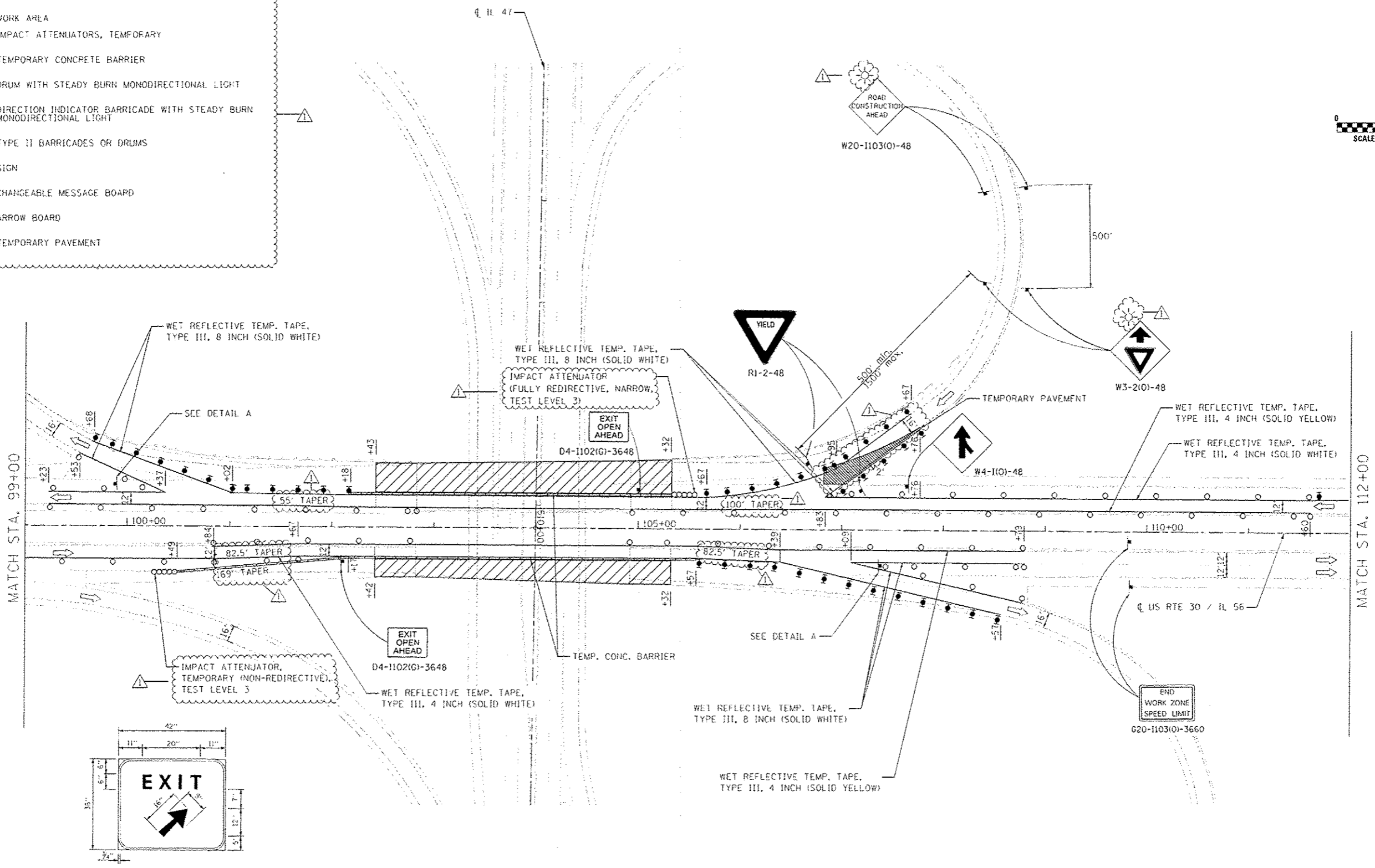
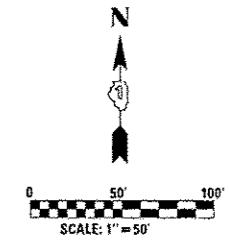

Background - Green
 Border and legend - White
 3/4" size letters
 EXIT SIGN - SPECIAL
DETAIL A



USER NAME - AUSER#	DESIGNED - SEW	REVISED - SL 8/30/2013
PLOT SCALE -	DRAWN - SEW	REVISED -
PLOT DATE - 9/7/2013	CHECKED - ST	REVISED -
	DATE - 11/2011	REVISED -







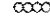

**STATE OF ILLINOIS
 DEPARTMENT OF TRANSPORTATION**

**MAINTENANCE OF TRAFFIC - STAGE 1 - US ROUTE 30 / IL 56
 US ROUTE 30 / IL 56 OVER IL 47**

SCALE: 1"=50' SHEET NO. 2 OF 3 SHEETS STA. 99+00 TO STA. 112+00

F&P, RTE. 573	SECTION 61 HD-1-7	COUNTY KANE	TOTAL SHEETS 48	SHEET NO. 6
FED. ROAD DIST. NO. ILLINOIS		FED. AIG PROJ#		
CONTRACT NO. GON12				

LEGEND

-  WORK AREA
-  IMPACT ATTENUATORS, TEMPORARY
-  TEMPORARY CONCRETE BARRIER
-  DRUM WITH STEADY BURN MONODIRECTIONAL LIGHT
-  DIRECTION INDICATOR BARRICADE WITH STEADY BURN MONODIRECTIONAL LIGHT
-  TYPE II BARRICADES OR DRUMS
-  SIGN
-  CHANGFABLE MESSAGE BOARD
-  ARROW BOARD
-  TEMPORARY PAVEMENT

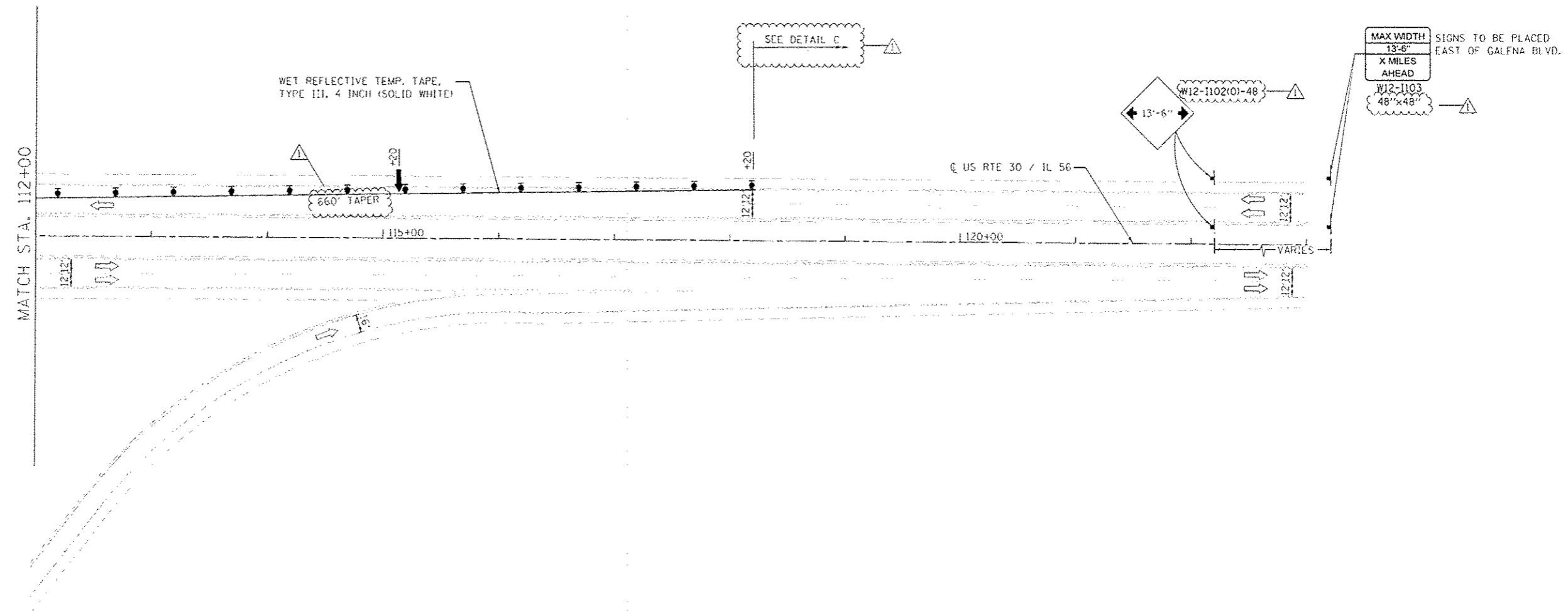
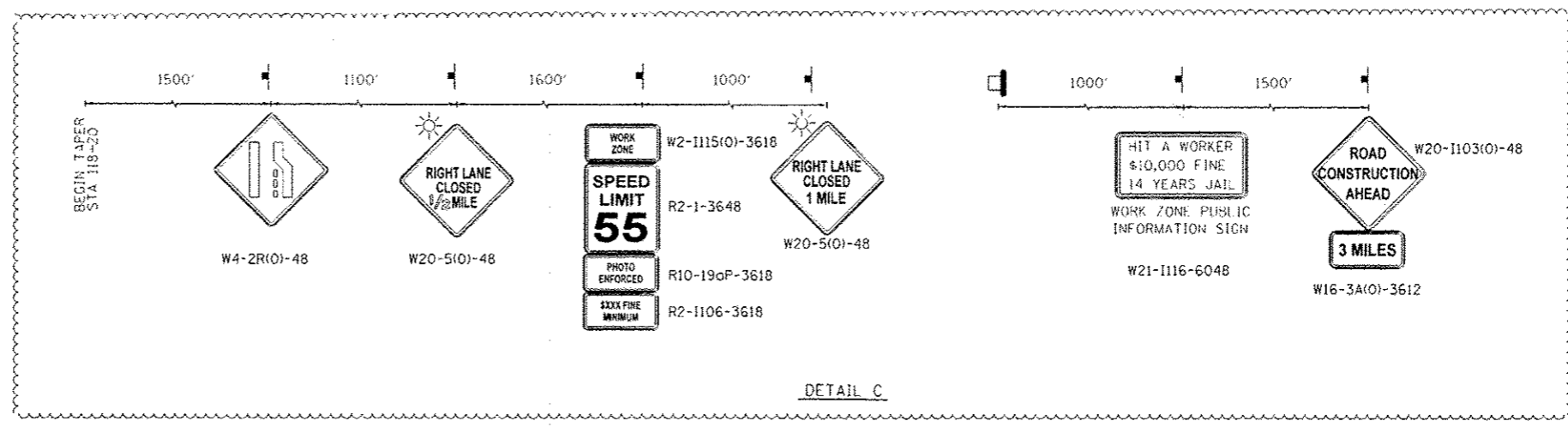

NOTES:
 1. ALL ADVANCE WARNING SIGNS SHALL BE 2 SETS OF SIGNS ONE PLACED IN THE BARRIER MEDIAN WHERE AVAILABLE



USER NAME - #USER#	DESIGNED - SEW	REVISED - SL 8/30/2013
PLLOT SCALE -	BRAWN - SEW	REVISED -
PLLOT DATE - 9/7/2013	CHECKED - ST	REVISED -
	DATE - 11/2011	REVISED -

**STATE OF ILLINOIS
DEPARTMENT OF TRANSPORTATION**

**MAINTENANCE OF TRAFFIC - STAGE I - US ROUTE 30 / IL 56
US ROUTE 30 / IL 56 OVER IL 47**

SCALE: 1"=50' SHEET NO. 3 OF 3 SHEETS STA. 112+00 TO STA. 123+00

F.A.P. RTE. 573	SECTION 61 HB-1-7	COUNTY KANE	TOTAL SHEETS 48	SHEET NO. 7
FED. ROAD DIST. NO. ILLINOIS FED. AID PROJECT			CONTRACT NO. 60N12	

LEGEND

- WORK AREA
- IMPACT ATTENUATORS, TEMPORARY
- TEMPORARY CONCRETE BARRIER
- DRUM WITH STEADY BURN MONODIRECTIONAL LIGHT
- DIRECTION INDICATOR BARRICADE WITH STEADY BURN MONODIRECTIONAL LIGHT
- TYPE II BARRICADES OR DRUMS
- SIGN
- CHANGEABLE MESSAGE BOARD
- ARROW BOARD
- TEMPORARY PAVEMENT

STAGE II CONSTRUCTION:

- CLOSE INSIDE LANES OF US ROUTE 30 / IL 56 AS SHOWN IN THE PLANS AND IN ACCORDANCE WITH HIGHWAY STANDARDS 701400-05, 701402-09, AND 701411-08.
- PERFORM INSIDE LANE STRUCTURAL AND APPROACH REPAIRS AS SHOWN IN THE PLANS.
- REMOVE TEMPORARY PAVEMENT PLACED IN STAGE I ALONG US ROUTE 30 / IL 56 IN ACCORDANCE WITH HIGHWAY STANDARD 701411-08.
- APPLY PERMANENT PAVEMENT MARKINGS AND RAISED REFLECTIVE PAVEMENT MARKERS AS SHOWN IN THE PROPOSED PAVEMENT MARKING PLANS IN ACCORDANCE WITH HIGHWAY STANDARD 701426-04.





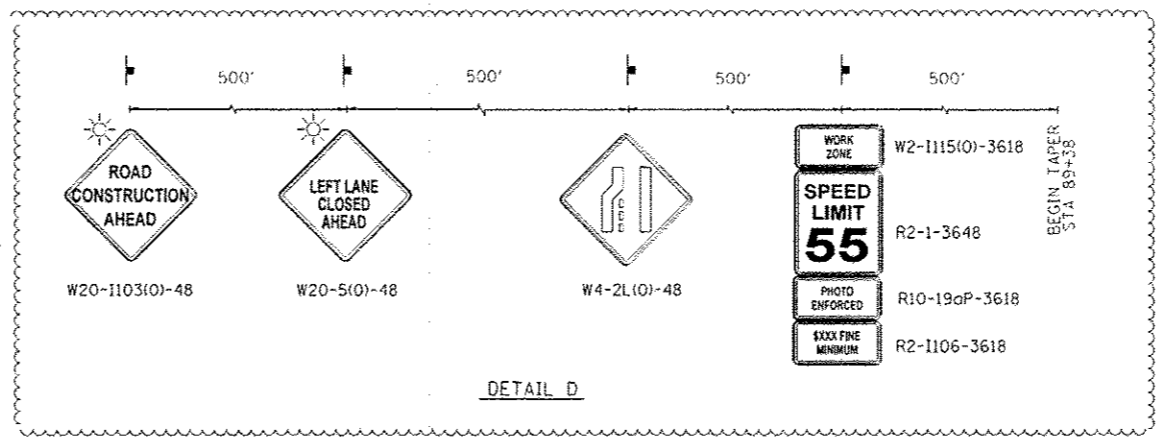
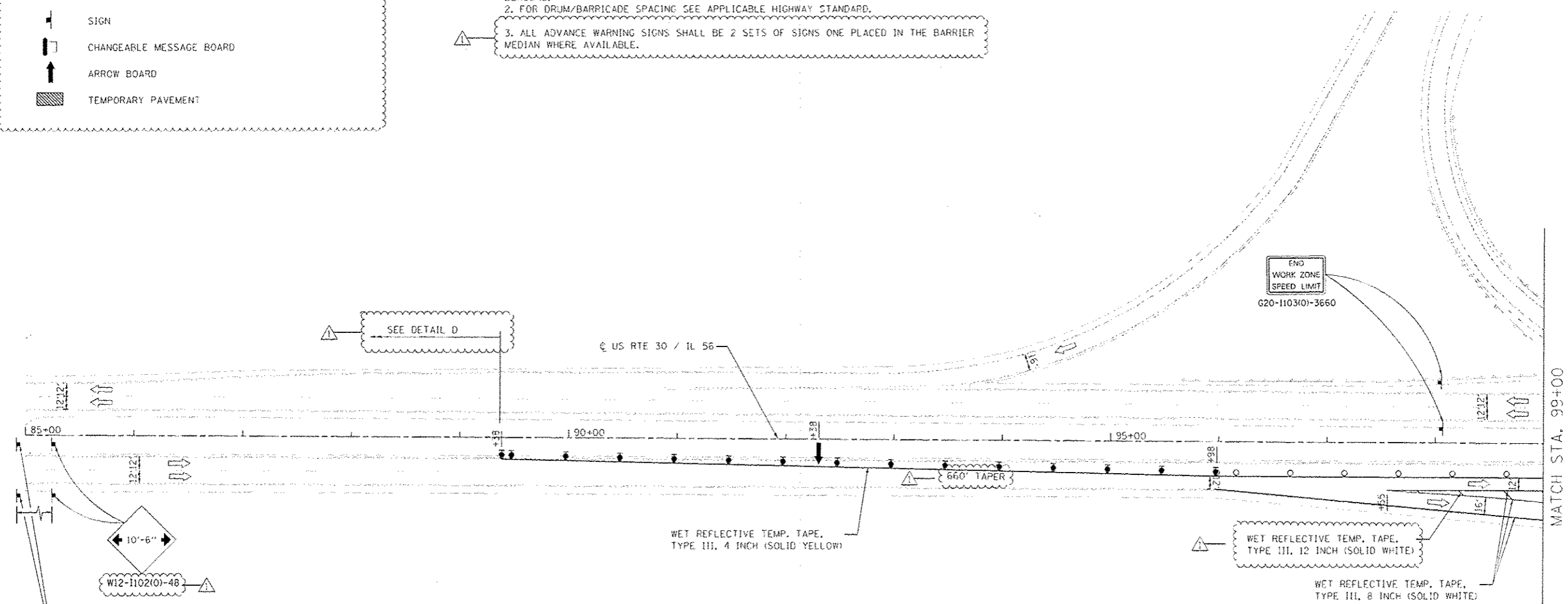
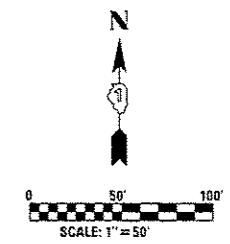



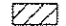

NOTES:

- FIRST TWO WARNING SIGNS IN EACH DIRECTION REQUIRE MONO-DIRECTIONAL FLASHING BEACONS.
- FOR DRUM/BARRICADE SPACING SEE APPLICABLE HIGHWAY STANDARD.
- ALL ADVANCE WARNING SIGNS SHALL BE 2 SETS OF SIGNS ONE PLACED IN THE BARRIER MEDIAN WHERE AVAILABLE.



	USER NAME - KUSER4	DESIGNED - SEW	REVISED - SL 8/30/2013	STATE OF ILLINOIS DEPARTMENT OF TRANSPORTATION	MAINTENANCE OF TRAFFIC - STAGE II - US ROUTE 30 / IL 56 US ROUTE 30 / IL 56 OVER IL 47			F.A.P. R/L	SECTION	COUNTY	TOTAL SHEETS	SHEET NO.
	PLOT SCALE -	CHECKED - ST	REVISED -		573	61 HB-1-7	KANE	48	8			
	PLOT DATE - 9/7/2013	DATE - 11/2011	REVISED -		SCALE: 1"=50' SHEET NO. 1 OF 3 SHEETS STA. 85+00 TO STA. 99+00			CONTRACT NO. 60N12				
					FED. ROAD DIST. NO. 1111015			ILLINOIS FED. AID PROJECT				

LEGEND

-  WORK AREA
-  IMPACT ATTENUATORS, TEMPORARY
-  TEMPORARY CONCRETE BARRIER
-  DRUM WITH STEADY BURN MONODIRECTIONAL LIGHT
-  DIRECTION INDICATOR BARRICADE WITH STEADY BURN MONODIRECTIONAL LIGHT
-  TYPE II BARRICADES OR DRUMS
-  SIGN
-  CHANGEABLE MESSAGE BOARD
-  ARROW BOARD
-  TEMPORARY PAVEMENT

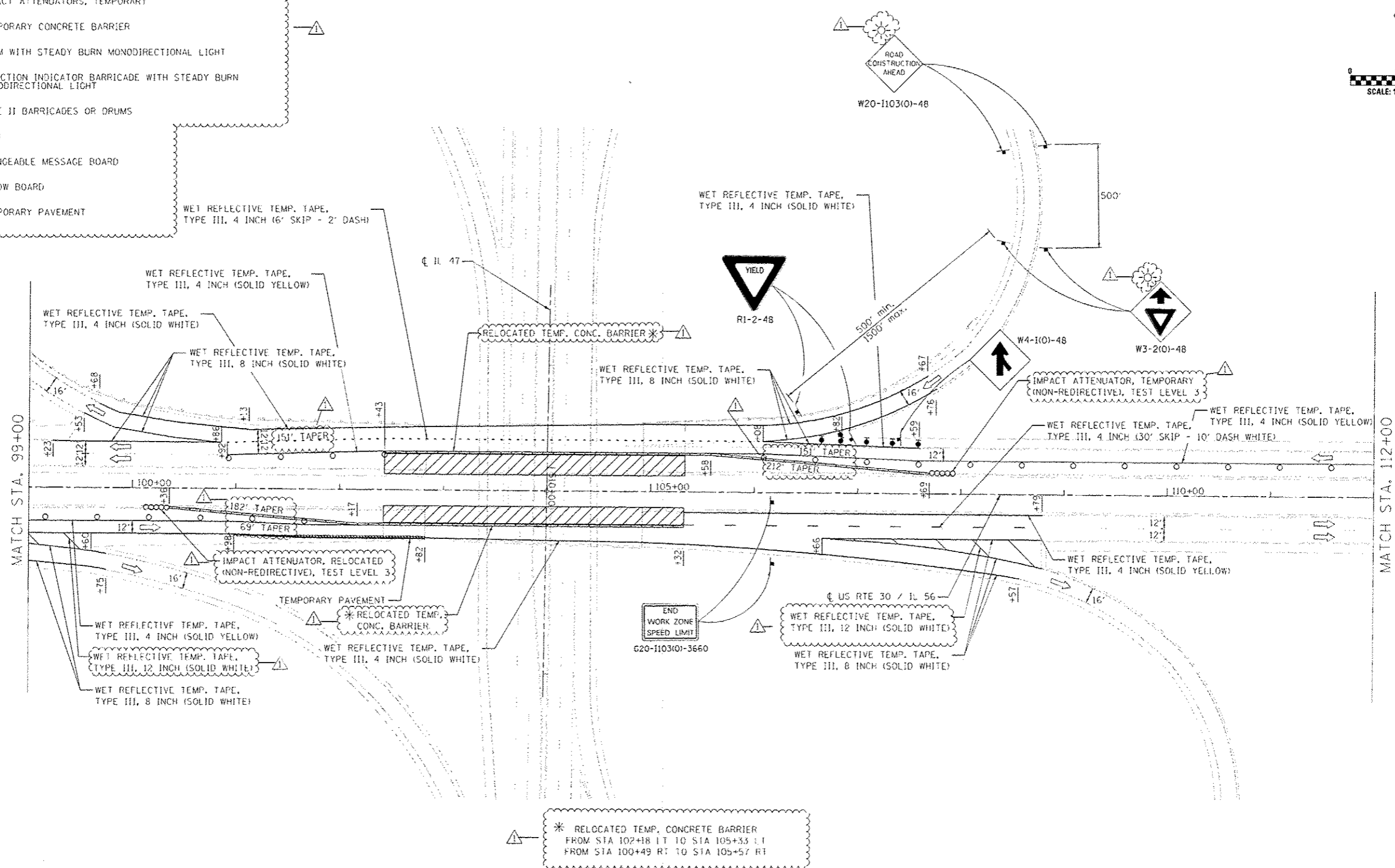
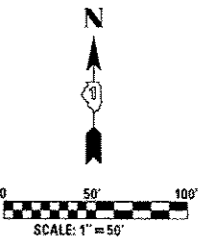

USER NAME - USER1	DESIGNED - SEW	REVISED - 1 SL 8/30/2013
PLLOT SCALE -	DRAWN - SEW	REVISED -
PLLOT DATE - 9/7/2013	CHECKED - ST	REVISED -
	DATE - 11/2011	REVISED -

**STATE OF ILLINOIS
DEPARTMENT OF TRANSPORTATION**

**MAINTENANCE OF TRAFFIC - STAGE II - US ROUTE 30 / IL 56
US ROUTE 30 / IL 56 OVER IL 47**

SCALE: 1"=50' SHEET NO. 2 OF 3 SHEETS STA. 99+00 TO STA. 112+00

F.A.P. RTE. 573	SECTION 61 HD-1-7	COUNTY KANE	TOTAL SHEETS 48	SHEET NO. 9
CONTRACT NO. GON12				
FED. ROAD DIST. NO. ILLINOIS FED. AID PROJECT				

LEGEND

	WORK AREA
	IMPACT ATTENUATORS, TEMPORARY
	TEMPORARY CONCRETE BARRIER
	DRUM WITH STEADY BURN MONODIRECTIONAL LIGHT
	DIRECTION INDICATOR BARRICADE WITH STEADY BURN MONODIRECTIONAL LIGHT
	TYPE II BARRICADES OR DRUMS
	SIGN
	CHANGEABLE MESSAGE BOARD
	ARROW BOARD
	TEMPORARY PAVEMENT

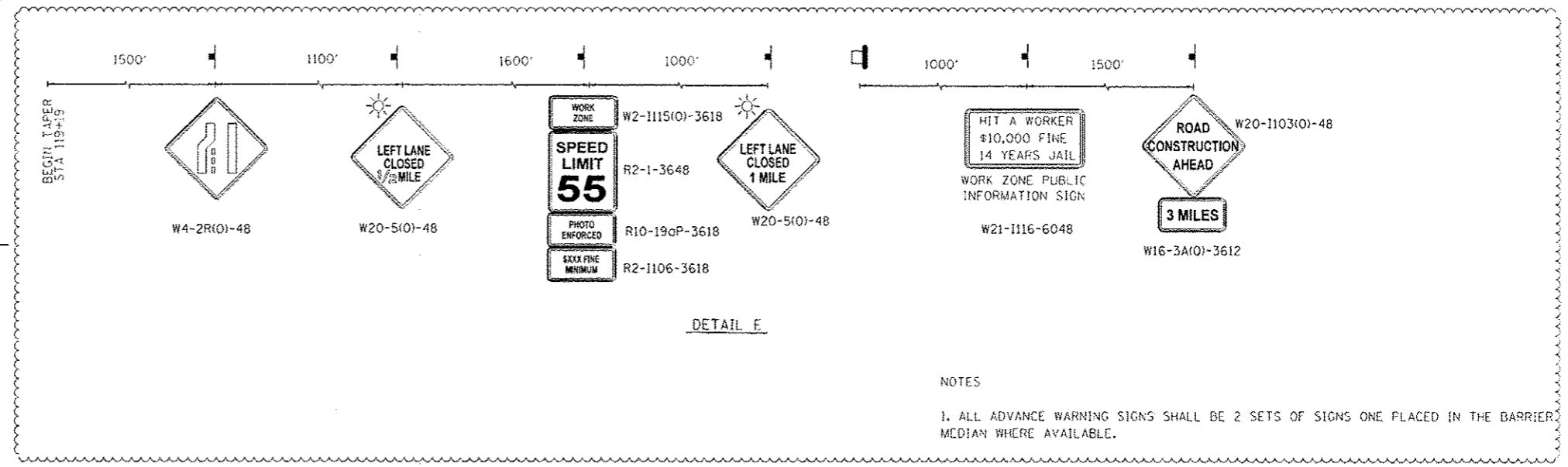
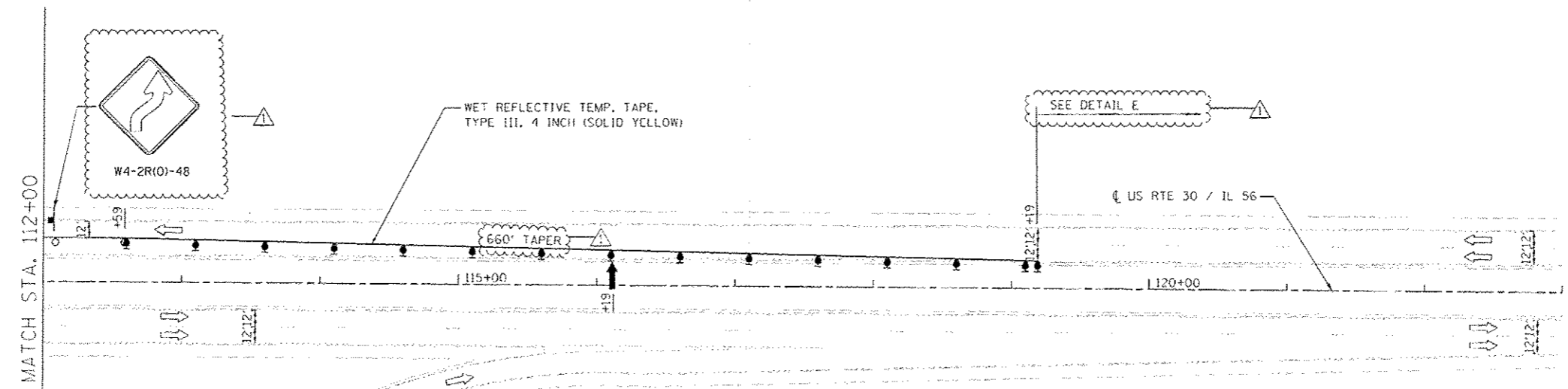
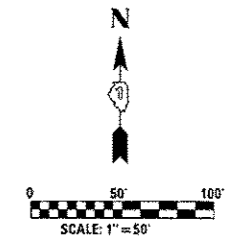

NOTES
 1. ALL ADVANCE WARNING SIGNS SHALL BE 2 SETS OF SIGNS ONE PLACED IN THE BARRIER MEDIUM WHERE AVAILABLE.

	USER NAME - #USE#4	DESIGNED - SEW	REVISED - / SL 8/30/2013
	PLOT SCALE -	DRAWN - SEW	REVISED -
	PLOT DATE - 9/7/2013	CHECKED - ST	REVISED -
		DATE - 11/2011	REVISED -

STATE OF ILLINOIS
 DEPARTMENT OF TRANSPORTATION

MAINTENANCE OF TRAFFIC -- STAGE II -- US ROUTE 30 / IL 56
 US ROUTE 30 / IL 56 OVER IL 47
 SCALE: 1"=50' SHEET NO. 3 OF 3 SHEETS STA. 112+00 TO STA. 123+00

F.A.P. RTE. 573	SECTION 61 HB-1-7	COUNTY KANE	TOTAL SHEETS 48	SHEET NO. 10
CONTRACT NO. 60N12				
FED. ROAD DIST. NO. ILLINOIS FED. AID PROJECT				

LEGEND

	WORK AREA
	IMPACT ATTENUATORS, TEMPORARY
	TEMPORARY CONCRETE BARRIER
	DRUM WITH STEADY BURN MONODIRECTIONAL LIGHT
	DIRECTION INDICATOR BARRICADE WITH STEADY BURN MONODIRECTIONAL LIGHT
	TYPE II BARRICADES OR DRUMS
	SIGN
	CHANGEABLE MESSAGE BOARD
	ARROW BOARD
	TEMPORARY PAVEMENT

STAGE I CONSTRUCTION:

1. REMOVE CONFLICTING EXISTING PAVEMENT MARKING LINES AND RAISED REFLECTIVE PAVEMENT MARKERS UNDER HIGHWAY STANDARDS 701426-04 AND 701411-08.
2. CLOSE OUTSIDE SHOULDERS OF IL 47 AS SHOWN IN THE PLANS AND IN ACCORDANCE WITH HIGHWAY STANDARD 701411-08.
3. PERFORM OUTSIDE LANE STRUCTURAL AND APPROACH REPAIRS AS SHOWN IN THE PLANS.

NOTES:

1. FIRST TWO WARNING SIGNS IN EACH DIRECTION REQUIRE MONO-DIRECTIONAL FLASHING BEACONS.
2. FOR BARRICADE/DRUM SPACING SEE APPLICABLE HIGHWAY STANDARDS.

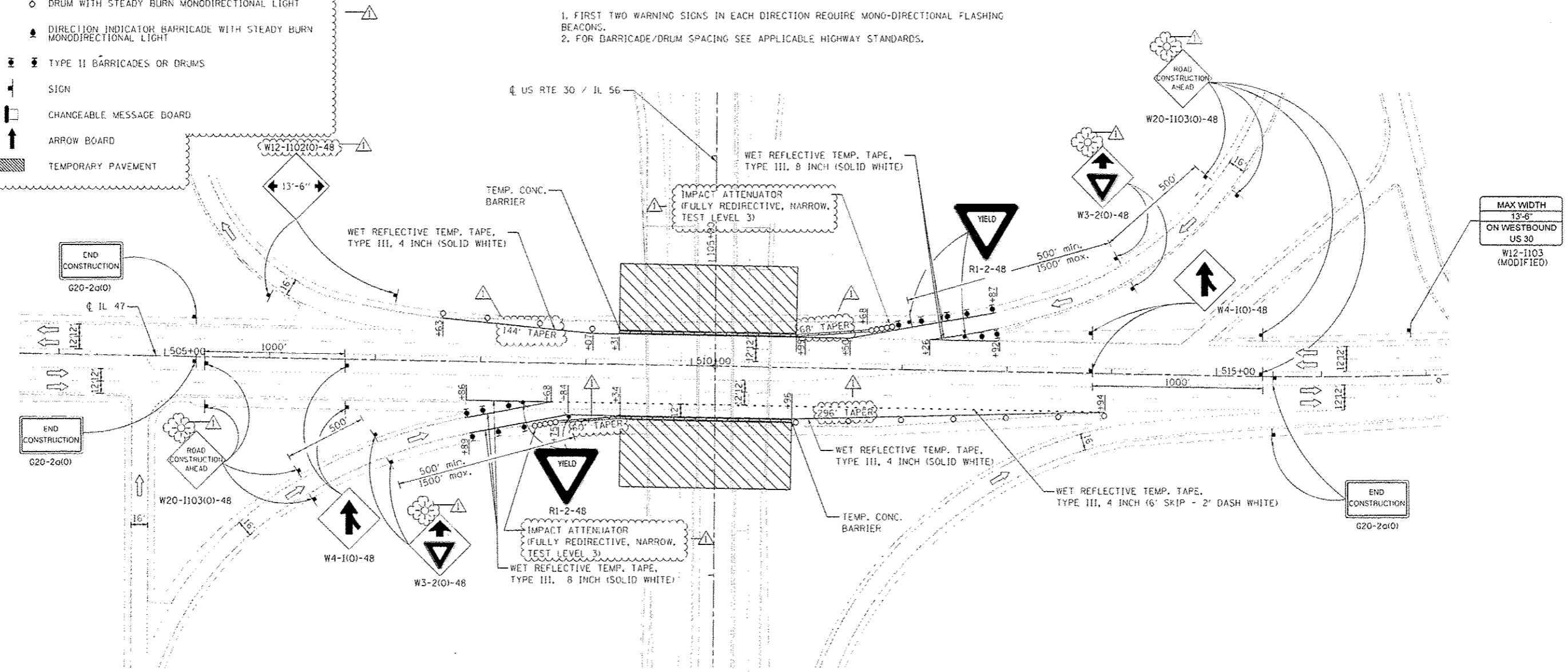
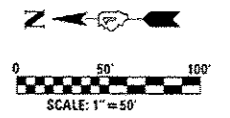





USER NAME - #USER1	DESIGNED - SEW	REVISED - 1/ SL 6/30/2013
DRAWN - SEW	CHECKED - ST	REVISED -
PLOT SCALE -	DATE - 11/2011	REVISED -
PLOT DATE - 9/7/2013		

**STATE OF ILLINOIS
DEPARTMENT OF TRANSPORTATION**

MAINTENANCE OF TRAFFIC - STAGE I - IL 47 US ROUTE 30 / IL 56 OVER IL 47		
SCALE: 1"=50'	SHEET NO. 1 OF 1 SHEETS	STA. 503+62 TO STA. 517+21

F.A.P. RTE. 573	SECTION 61 HR-1-7	COUNTY KANE	TOTAL SHEETS 48	SHEET NO. 11
CONTRACT NO. 60N12				
FED. ROAD DIST. NO. ILLINOIS FED. AID PROJECT				

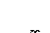
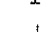
LEGEND

-  WORK AREA
-  IMPACT ATTENUATORS, TEMPORARY
-  TEMPORARY CONCRETE BARRIER
-  DRUM WITH STEADY BURN MONODIRECTIONAL LIGHT
-  DIRECTION INDICATOR BARRICADE WITH STEADY BURN MONODIRECTIONAL LIGHT
-  TYPE II BARRICADES OR DRUMS
-  SIGN
-  CHANGEABLE MESSAGE BOARD
-  ARROW BOARD
-  TEMPORARY PAVEMENT

STAGE II CONSTRUCTION:

1. CLOSE INSIDE LANES OF IL 47 AS SHOWN IN THE PLANS AND IN ACCORDANCE WITH HIGHWAY STANDARD 701423-05.
2. PERFORM INSIDE LANE STRUCTURAL AND APPROACH REPAIRS AS SHOWN IN THE PLANS.
3. APPLY PERMANENT PAVEMENT MARKINGS AND RAISED REFLECTIVE PAVEMENT MARKERS AS SHOWN IN THE PROPOSED PAVEMENT MARKING PLANS IN ACCORDANCE WITH HIGHWAY STANDARD 701426-04.

NOTES:

1. FIRST TWO WARNING SIGNS IN EACH DIRECTION REQUIRE MONO-DIRECTIONAL FLASHING BEACONS.
2. FOR DRUM/BARRICADE SPACING SEE APPLICABLE HIGHWAY STANDARD.
3. ALL ADVANCE WARNING SIGNS SHALL BE 2 SETS OF SIGNS ONE PLACED IN THE BARRIER MEDIUM WHERE AVAILABLE.

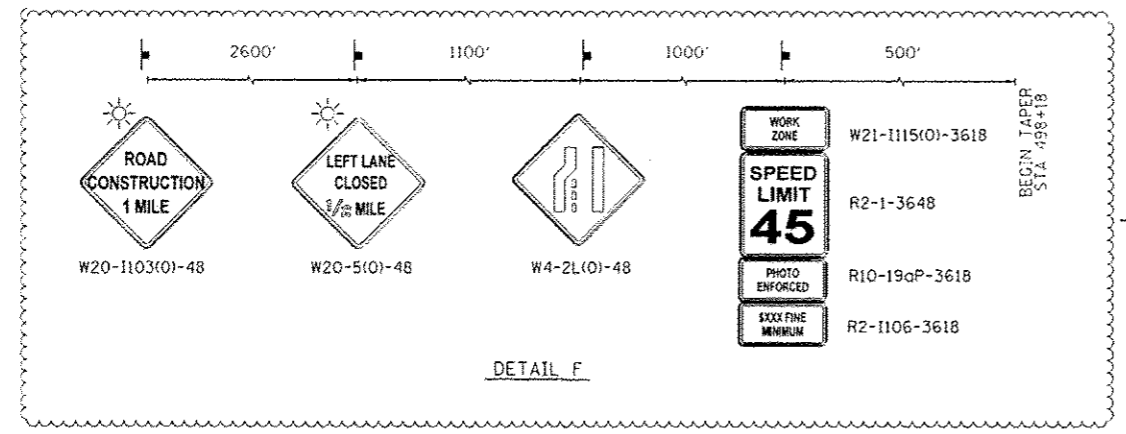
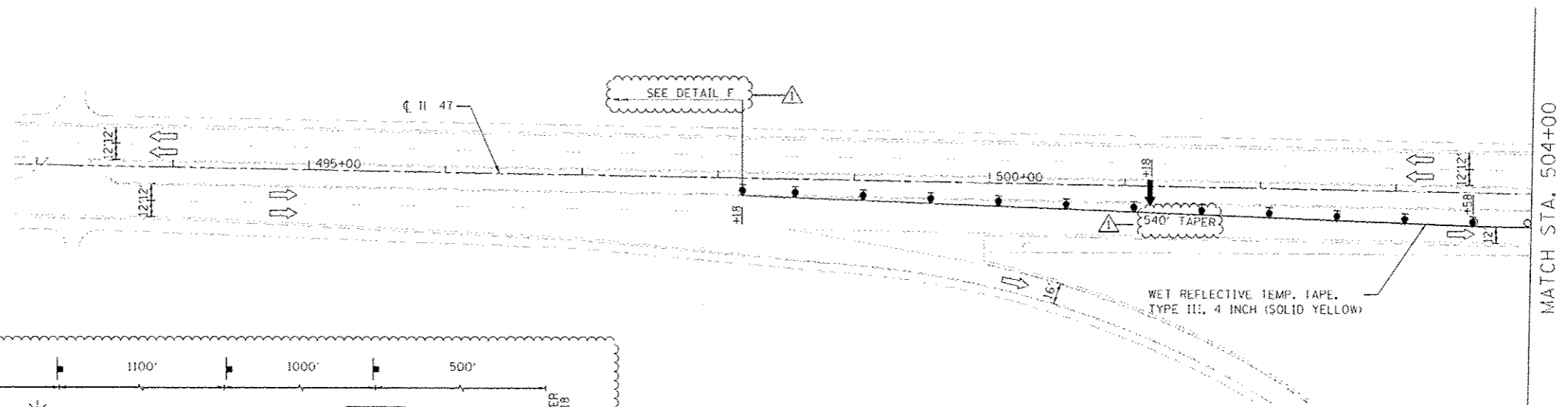
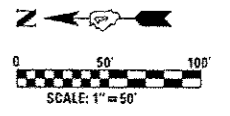

USER NAME - SLUSER4	DESIGNED - SEW	REVISED - / SL 8/30/2013
PL01 SCALE -	DRAWN - SEW	REVISED -
PL01 DATE - 9/7/2013	CHECKED - ST	REVISED -
	DATE - 11/2011	REVISED -

**STATE OF ILLINOIS
DEPARTMENT OF TRANSPORTATION**

**MAINTENANCE OF TRAFFIC - STAGE II - IL 47
US ROUTE 30 / IL 56 OVER IL 47**

SCALE: 1"=50' SHEET NO. 1 OF 2 SHEETS STA. 492+84 TO STA. 504+00

F.A.P. RTE.	SECTION	COUNTY	TOTAL SHEETS	SHEET NO.
573	61 HD-1-7	KANE	48	12
CONTRACT NO. 60N12				
FED. ROAD DIST. NO. ILLINOIS FED. AID PROJECT				

LEGEND

- WORK AREA
- IMPACT ATTENUATORS, TEMPORARY (FULLY REDIRECTIVE, NARROW), TEST LEVEL 3
- TEMPORARY CONCRETE BARRIER
- DRUM WITH STEADY BURN MONODIRECTIONAL LIGHT
- DIRECTION INDICATOR BARRICADE WITH STEADY BURN MONODIRECTIONAL LIGHT
- TYPE II BARRICADES OR DRUMS
- SIGN
- CHANGEABLE MESSAGE BOARD
- ARROW BOARD
- TEMPORARY PAVEMENT

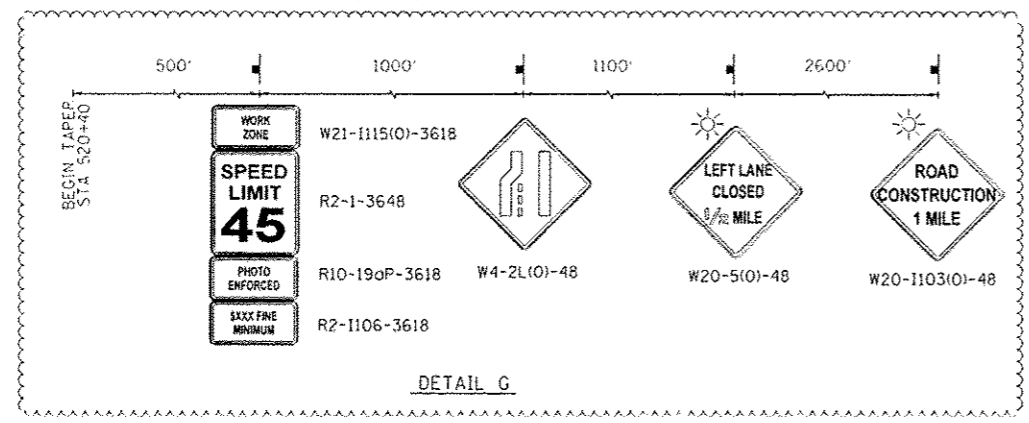
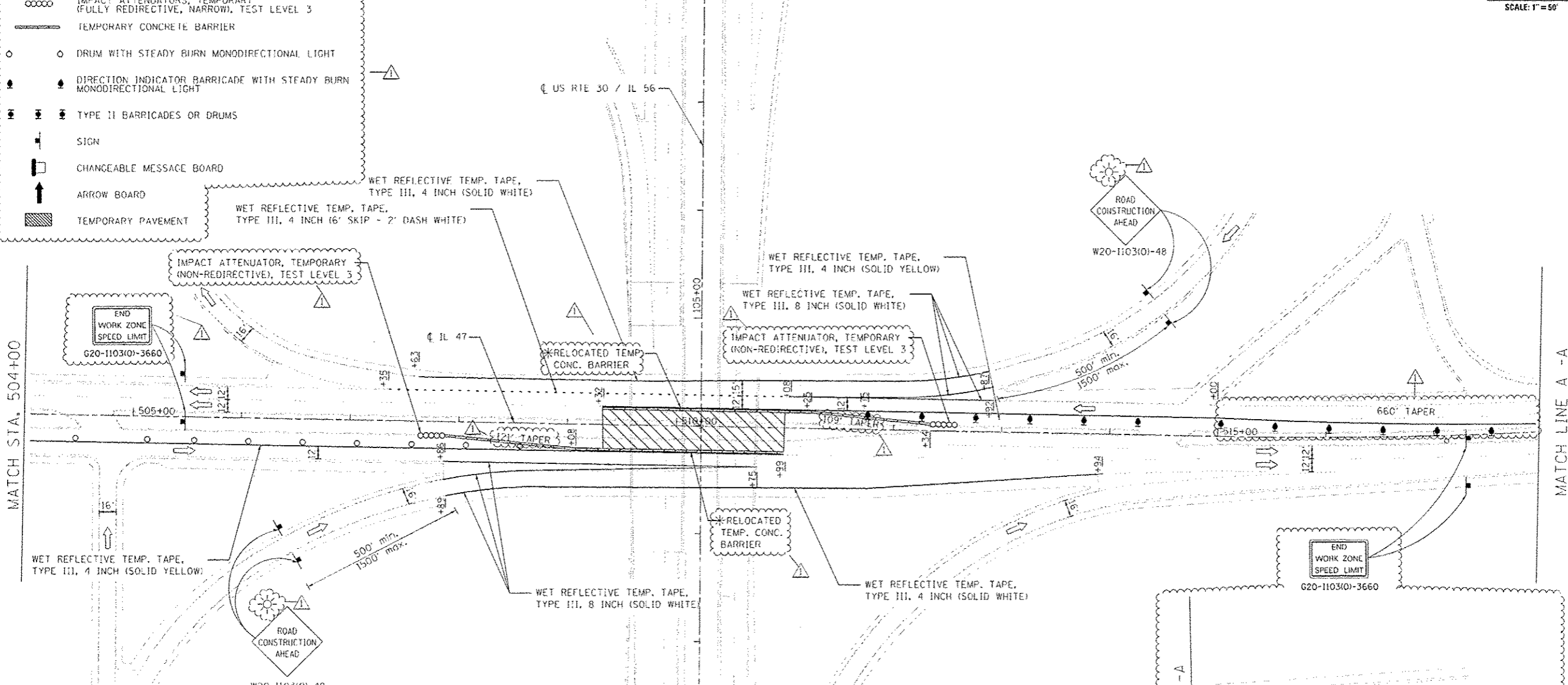
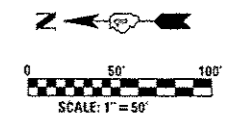

* RELOCATE TEMP. CONCRETE BARRIER
 FROM STA 509+31 LT TO STA 511+68 LT
 FROM STA 508+75 RT TO STA 510+96 RT

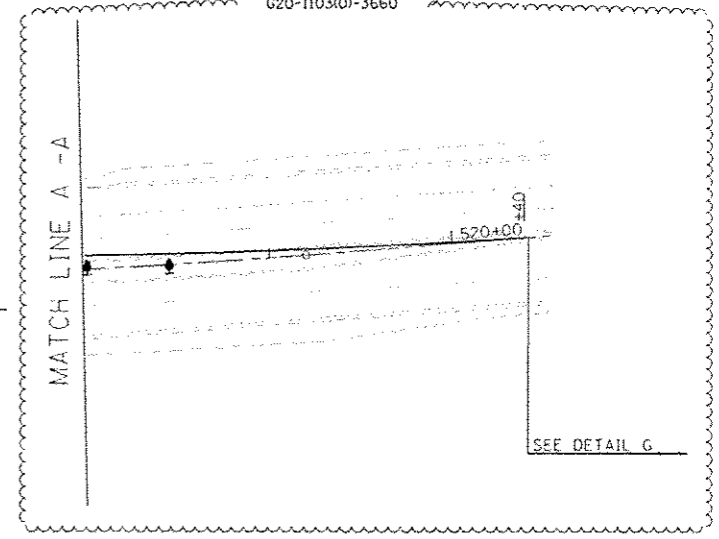

NOTES

1. ALL ADVANCE WARNING SIGNS SHALL BE 2 SETS OF SIGNS ONE LOCATED IN THE BARRIER MEDIAN WHERE AVAILABLE.

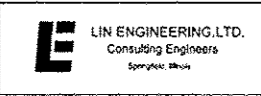

USER NAME - KUSERS	DESIGNED - SEW	REVISED - SL 8/30/2013
PLT SCALE -	DRAWN - SEW	REVISED -
PLT DATE - 9/2/2013	CHECKED - ST	REVISED -
	DATE - 11/2011	REVISED -

STATE OF ILLINOIS
 DEPARTMENT OF TRANSPORTATION

MAINTENANCE OF TRAFFIC - STAGE II - IL 47		F.A.P. RTE.	SECTION	COUNTY	TOTAL SHEETS	SHEET NO.
US ROUTE 30 / IL 56 OVER IL 47		573	61 MB-1-7	KANE13	48	13
SCALE: 1"=50'	SHEET NO. 2 OF 2 SHEETS	STA. 504+00 TO STA. 520+40	CONTRACT NO. 60N12			
FED. ROAD DIST. NO. [ILLINOIS] FED. AID PROJECT						

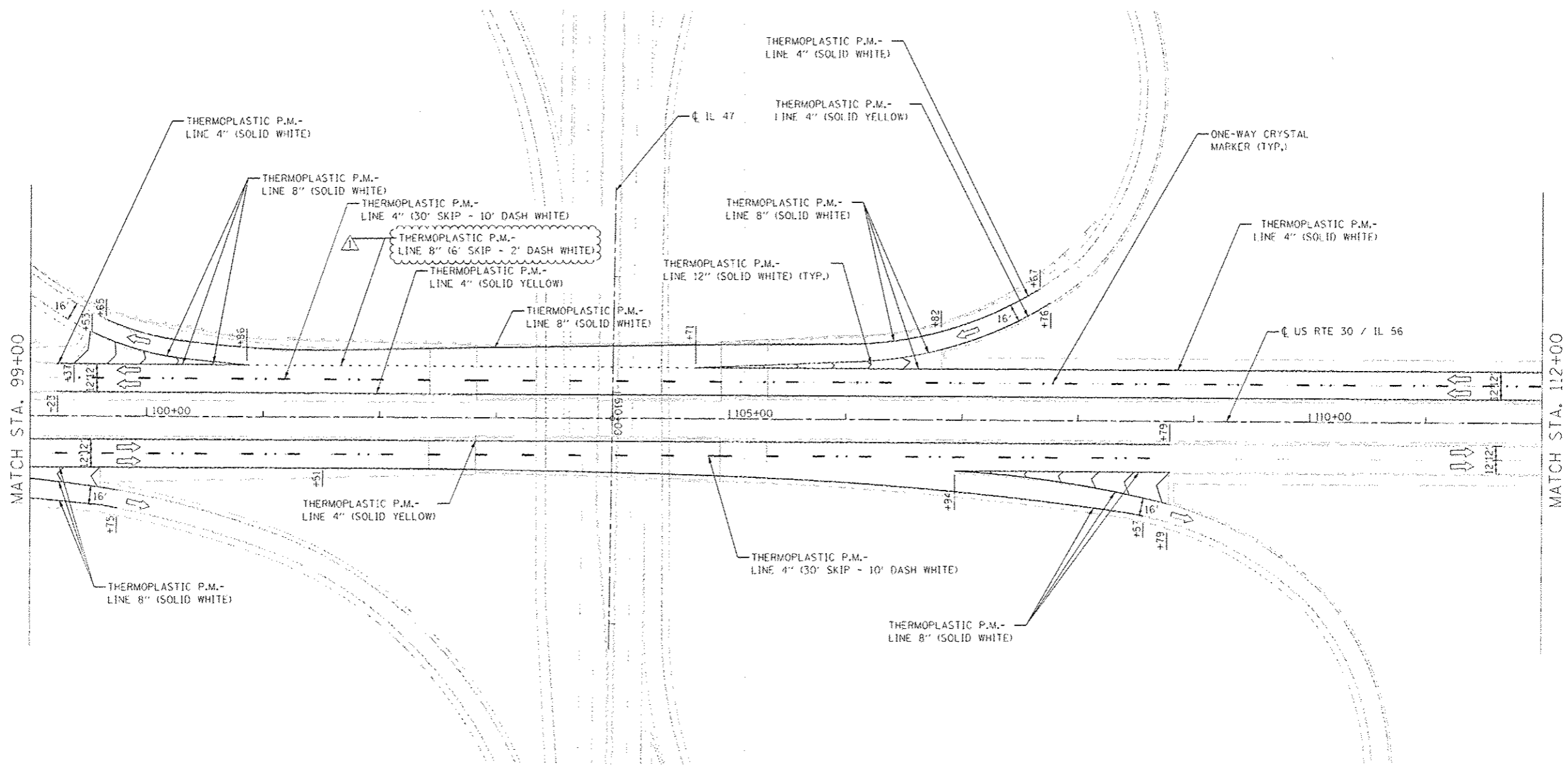
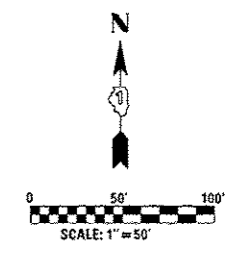

USER NAME - #4USERS	DESIGNED - SEW	REVISED - Δ SL 8/30/2013
	DRAWN - SEW	REVISED -
PLOT SCALE -	CHECKED - ST	REVISED -
PLOT DATE - 9/7/2013	DATE - 11/2011	REVISED -

**STATE OF ILLINOIS
DEPARTMENT OF TRANSPORTATION**

**PAVEMENT MARKING PLAN - US ROUTE 30 / IL 56
US ROUTE 30 / IL 56 OVER IL 47**

SCALE: 1"=50' SHEET NO. 2 OF 3 SHEETS STA. 99+00 TO STA. 112+00

F.P. REC. 573	SECTION 61 HB-1-7	COUNTY KANE	TOTAL SHEETS 48	SHEET NO. 15
FED. ROAD DIST. NO. ILLINOIS FED. AID PROJECT				
CONTRACT NO. 60N12				

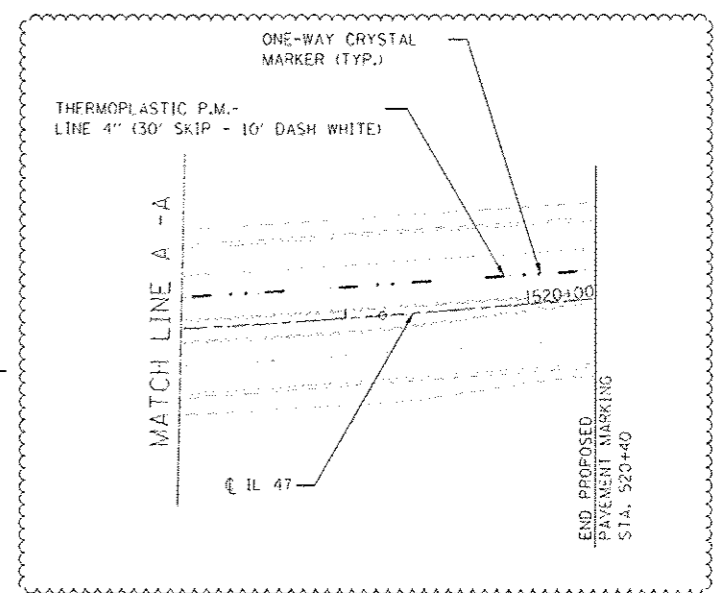
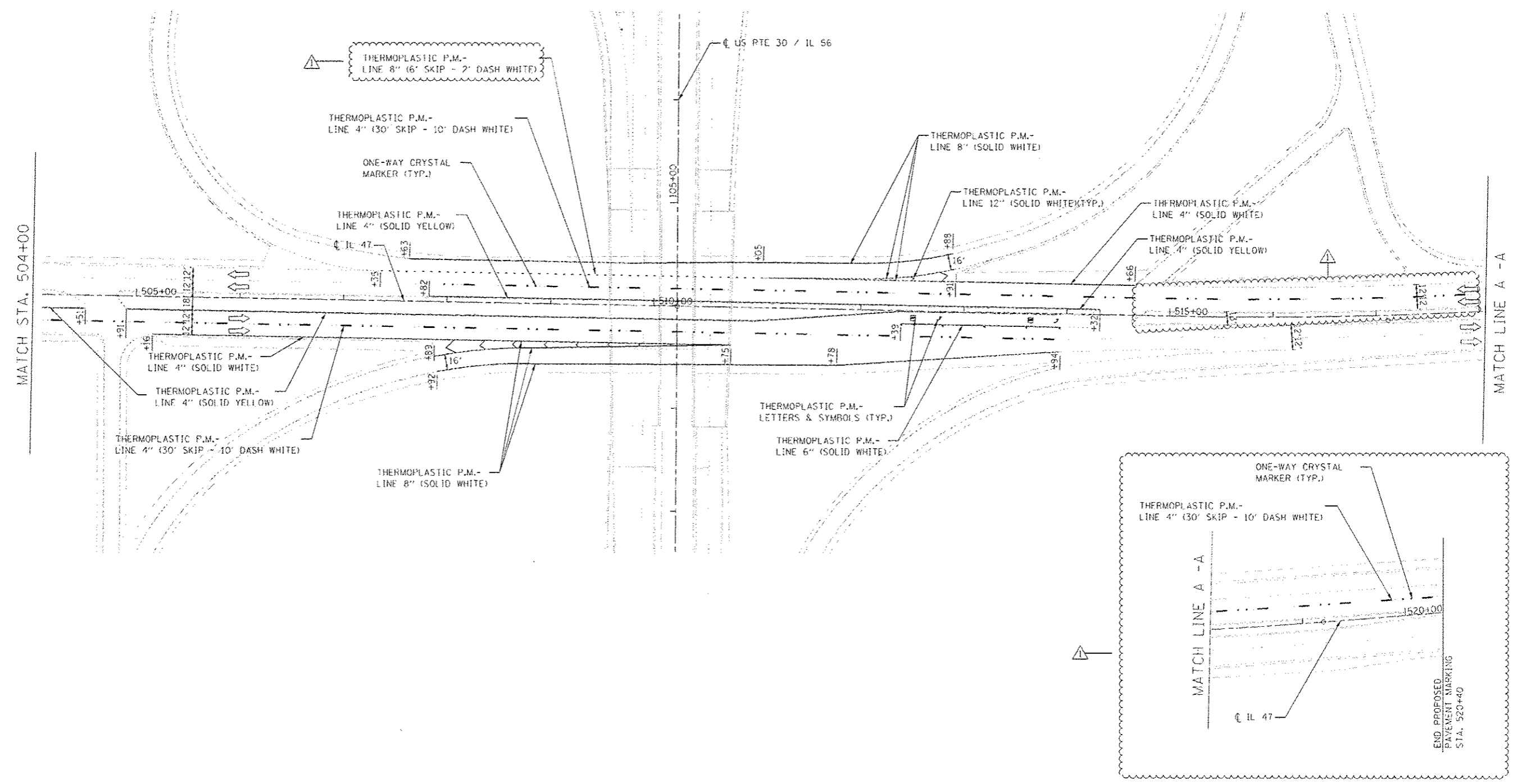
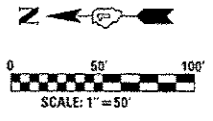

	USER NAME - MUSERA	DESIGNED - SEW	REVISED - Δ SL 8/30/2013
		DRAWN - SEW	REVISED -
	PLOT SCALE -	CHECKED - ST	REVISED -
	PLOT DATE - 9/7/2013	DATE - 11/2011	REVISED -

STATE OF ILLINOIS
DEPARTMENT OF TRANSPORTATION

PAVEMENT MARKING PLAN - IL 47 US ROUTE 30 / IL 56 OVER IL 47		
SCALE: 1"=50'	SHEET NO. 2 OF 2 SHEETS	STA. 504+00 TO STA. 520+40

F.A.P. RTE. 573	SECTION 61 HB-1-7	COUNTY KANE	TOTAL SHEETS 48	SHEET NO. 18
FED. ROAD DIST. NO. ILLINOIS FED. AID PROJECT			CONTRACT NO. 60N12	