

F.A. RTE.	SECTION	COUNTY	TOTAL SHEETS	SHEET NO.
VAR.	2013-027-1	*	*26	1

* COOK, DU PAGE, LAKE, KANE, McHENRY AND WILL
 D-91-346-13 *26-1-25

09-20-13 LETTING ITEM 010

STATE OF ILLINOIS
 DEPARTMENT OF TRANSPORTATION
 DIVISION OF HIGHWAYS

**PROPOSED
 HIGHWAY PLANS**

FOR INDEX OF SHEETS, SEE SHEET NO. 2

ROUTE: VARIOUS DISTRICT ONE
 SECTION: 2013-027-1
 EXPRESSWAY & ARTERIAL HIGHWAY CLEANING (SWEEPING)
 COUNTY: VARIOUS (COOK, DUPAGE, LAKE, KANE, McHENRY AND WILL)
 C-91-346-13

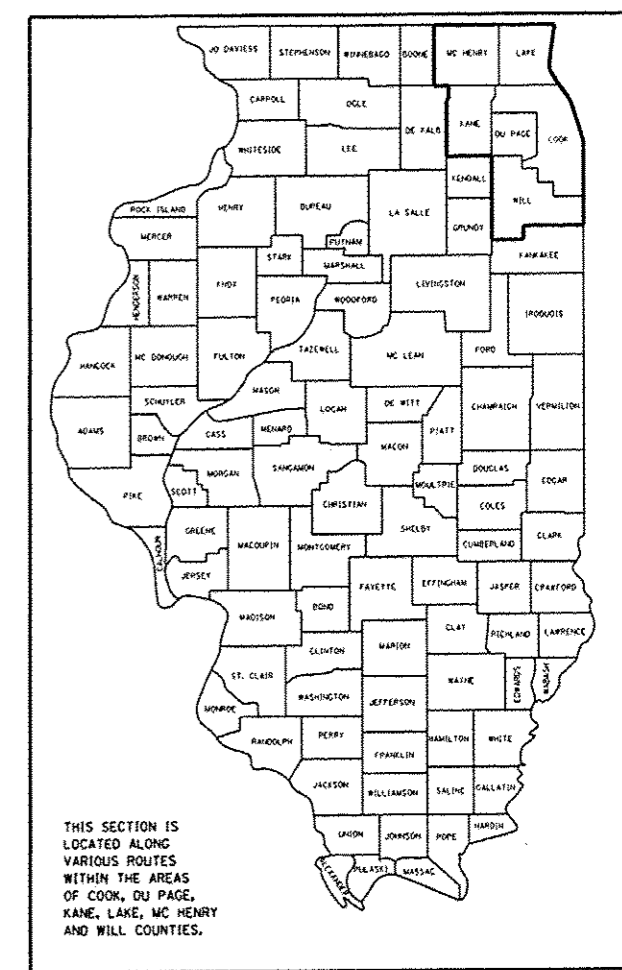

LOCATION MAPS - SEE INDEX OF SHEETS

STATE OF ILLINOIS
 DEPARTMENT OF TRANSPORTATION
 DIVISION OF HIGHWAYS

SUBMITTED July 9 2013
John Furlong
 DEPUTY DIRECTOR OF HIGHWAYS, REGION ENGINEER

Aug 16 2013
John D. Baranzelli
 ENGINEER OF DESIGN AND ENVIRONMENT

Aug 16 2013
Omer Osman
 DIRECTOR OF HIGHWAYS, CHIEF ENGINEER

J.U.L.I.E.
 JOINT UTILITY LOCATION INFORMATION FOR EXCAVATION
 1-800-892-0123

CONTRACT NO. 60W62

PRINTED BY THE AUTHORITY
 OF THE STATE OF ILLINOIS

DISTRICT ONE / BUREAU OF DESIGN
 PLAN PREPARATION ENGINEER: I. RAYYAN / J. MIDY (847) 221-3056

INDEX OF SHEETS

1. TITLE SHEET
2. INDEX OF SHEETS
APPLICABLE STATE STANDARDS
3. SUMMARY OF QUANTITIES
SCHEDULE OF CLEANING STARTING DATES
4. EXPRESSWAY TYPICAL SECTIONS
5. ARTERIAL TYPICAL SECTIONS
6. LIMITS OF SIGN CLEANING
7. EXPRESSWAY CLEANING: I-290 EXTENSION/ ILL 53, EDENS,
KENNEDY & ELGIN-O'HARE
8. EXPRESSWAY CLEANING: EISENHOWER, STEVENSON, I-55 & DAN RYAN
9. EXPRESSWAY CLEANING: BISHOP FORD, KINGERY, I-55, I-57 & I-80
10. ARTERIAL CLEANING: MCHENRY COUNTY
WOODSTOCK TEAM SECTION
11. ARTERIAL CLEANING: LAKE COUNTY
GRAYSLAKE TEAM SECTION
12. ARTERIAL CLEANING: LAKE COUNTY
GURNEE TEAM SECTION
13. ARTERIAL CLEANING: KANE COUNTY
ST. CHARLES TEAM SECTION
14. ARTERIAL CLEANING: COOK COUNTY
ARLINGTON HEIGHTS TEAM SECTION
15. ARTERIAL CLEANING: COOK COUNTY
NORTHBROOK TEAM SECTION
16. ARTERIAL CLEANING: COOK COUNTY
NORTHSIDE TEAM SECTION
17. ARTERIAL CLEANING: COOK COUNTY
RODENBURG TEAM SECTION
18. ARTERIAL CLEANING: COOK COUNTY
HILLSIDE TEAM SECTION
19. ARTERIAL CLEANING: COOK COUNTY
HARVEY TEAM SECTION
20. ARTERIAL CLEANING: COOK COUNTY
ALSIP TEAM SECTION
21. ARTERIAL CLEANING: DUPAGE COUNTY
NAPERVILLE TEAM SECTION
22. ARTERIAL CLEANING: DUPAGE COUNTY
OAKBROOK TEAM SECTION
23. ARTERIAL CLEANING: WILL COUNTY
JOLIET TEAM SECTION
24. ARTERIAL CLEANING: WILL COUNTY
NEW LENOX TEAM SECTION
- ~~25. DISTRICT ONE DETAILS: TRAFFIC CONTROL DEVICES FOR
HIGHWAY AND SIGN CLEANING OPERATIONS DAY TIME ONLY~~
26. TRAFFIC CONTROL DETAILS FOR FREEWAY SHOULDER CLOSURES
AND PARTIAL RAMP CLOSURES (TC-17)

STATE STANDARDS

- 701001-02 OFF-ROAD OPERATION 2L, 2W, 15' MIN. AWAY FOR SPEEDS >45 MPH
- 701006-04 OFF-ROAD OPERATION 2L, 2W, 15' TO PAVEMENT EDGE FOR SPEEDS >45 MPH
- 701011-03 OFF-ROAD MOVING OPERATION 2L, 2W, DAY ONLY
- 701101-03 OFF-ROAD OPERATIONS, MULTILANE, 15' TO 24" FROM PAVEMENT EDGE
- 701301-04 LANE CLOSURE, 2L 2W, SHORT TIME OPERATIONS
- 701311-03 LANE CLOSURE, 2L 2W, MOVING OPERATIONS - DAY ONLY
- 701400-06 APPROACH TO LANE CLOSURE, FREEWAY/EXPRESSWAY
- 701401-07 LANE CLOSURE, FREEWAY/EXPRESSWAY
- 701411-08 LANE CLOSURE, MULTILANE AT ENTERANCE/EXIT RAMP FOR SPEEDS >45 MPH
- 701426-05 LANE CLOSURE, MULTILANE INTERMITTENT OR MOVING OPERATION FOR SPEEDS >45 MPH
- 701901-02 TRAFFIC CONTROL DEVICES
- 701427-01**

CONTRACT NO. 60W62				
F.A. RTE.	SECTION	COUNTY	TOTAL SHEETS	SHEET NO.
VAR.	2013-027-1	*	26	2
STA.	TO STA.			
FED. ROAD DIST. NO.	ILLINOIS	FED. AID PROJECT		

*COOK, DU PAGE, KANE,
LAKE, MC HENRY AND WILL

REVISIONS		ILLINOIS DEPARTMENT OF TRANSPORTATION
NAME	DATE	
		INDEX OF SHEETS AND STATE STANDARDS

SCALE: VERT. DATE HORIZ. DRAWN BY CHECKED BY

Rev.

PLOT DATE: 7/10/2013
 FILE NAME: S:\Projects\2013\20130710\20130710.dgn
 PLOT SCALE: 1/8"=1'-0"
 USER NAME: midya

F.A. RTE.	SECTION	COUNTY	TOTAL SHEETS	SHEET NO.
VAR.	2013-027-1	*	26	3
STA.		TO STA.		
FED. ROAD DIST. NO.		ILLINOIS FED. AID PROJECT		

* COOK, DU PAGE, KANE, LAKE, MC HENRY AND WILL

SUMMARY OF QUANTITIES

URBAN
100% STATE
0044

CODE NO.	ITEM	UNIT	MAIN QUANTITY
Z0010617	SUPPLEMENTAL SWEEPING	MILE	1517
X0329915	FULL EXPRESSWAY CLEANING CYCLE	EACH	12
X0330600	FULL ARTERIAL CLEANING CYCLE	EACH	3
X0414200	SIGN CLEANING CYCLE	EACH	1
X0326643	LITTER PICKING	MILE	2145

EXPRESSWAY CLEANING SCHEDULE OF STARTING DATES - 2014 (SEE NOTE 7)

1st FULL CLEANING CYCLE	----	MARCH 1
2nd FULL CLEANING CYCLE	----	MAY 1
3rd FULL CLEANING CYCLE	----	MAY 20
4th FULL CLEANING CYCLE	----	JUNE 9
5th FULL CLEANING CYCLE	----	JUNE 28
6th FULL CLEANING CYCLE	----	JULY 17
7th FULL CLEANING CYCLE	----	AUGUST 5
8th FULL CLEANING CYCLE	----	AUGUST 25
9th FULL CLEANING CYCLE	----	SEPTEMBER 14
10th FULL CLEANING CYCLE	----	OCTOBER 3
11th FULL CLEANING CYCLE	----	OCTOBER 22
12th FULL CLEANING CYCLE	----	NOVEMBER 10

(RECOMMENDED TO BE COMPLETED ON OR BEFORE NOVEMBER 30)

EXPRESSWAY CLEANING SCHEDULE OF STARTING DATES - 2015 (SEE NOTE 7)

1st FULL CLEANING CYCLE	----	MARCH 1
2nd FULL CLEANING CYCLE	----	MAY 1
3rd FULL CLEANING CYCLE	----	MAY 20
4th FULL CLEANING CYCLE	----	JUNE 9
5th FULL CLEANING CYCLE	----	JUNE 28
6th FULL CLEANING CYCLE	----	JULY 17
7th FULL CLEANING CYCLE	----	AUGUST 5
8th FULL CLEANING CYCLE	----	AUGUST 25
9th FULL CLEANING CYCLE	----	SEPTEMBER 14
10th FULL CLEANING CYCLE	----	OCTOBER 3
11th FULL CLEANING CYCLE	----	OCTOBER 22
12th FULL CLEANING CYCLE	----	NOVEMBER 10

(RECOMMENDED TO BE COMPLETED ON OR BEFORE NOVEMBER 30)

ARTERIAL CLEANING SCHEDULE OF ANTICIPATED STARTING DATES - 2014 (SEE NOTE 7)

INITIAL CLEANING CYCLE	----	MARCH 1
1st FULL CLEANING CYCLE	----	JUNE 25
2nd FULL CLEANING CYCLE	----	SEPTEMBER 12 (RECOMMENDED TO BE COMPLETED ON OR BEFORE NOVEMBER 30)

ARTERIAL CLEANING SCHEDULE OF ANTICIPATED STARTING DATES - 2015 (SEE NOTE 7)

INITIAL CLEANING CYCLE	----	MARCH 1
1st FULL CLEANING CYCLE	----	JUNE 25
2nd FULL CLEANING CYCLE	----	SEPTEMBER 12 (RECOMMENDED TO BE COMPLETED ON OR BEFORE NOVEMBER 30)

SIGN CLEANING CYCLES SCHEDULE OF STARTING DATES - 2014 (SEE NOTE 7)

SIGN CLEANING CYCLE	----	MARCH 1
---------------------	------	---------

SIGN CLEANING CYCLES SCHEDULE OF STARTING DATES - 2015 (SEE NOTE 7)

SIGN CLEANING CYCLE	----	MARCH 1
---------------------	------	---------

NOTES:

- SCHEDULE MAY VARY AS DIRECTED BY THE ENGINEER.
- THE CONTRACTOR MAY NOT START CLEANING CYCLES BEFORE THE DATES SCHEDULED IN THE PLANS WITHOUT WRITTEN AUTHORIZATION FROM THE ENGINEER.
- NO WORK WILL BE ALLOWED DURING ANY LEGAL HOLIDAY PERIOD.
- ALL SCHEDULES OF ANTICIPATED STARTING DATES SHOWN ARE TENTATIVE AS DETERMINE BY THE DEPARTMENT'S OPERATIONAL NEEDS.
- NO DAILY CONTRACTOR WORK REQUESTS/ SCHEDULING SHALL BE AUTHORIZED OR APPROVED TO START WHEN IT IS DETERMINED BY THE ENGINEER THAT WEATHER CONDITIONS WILL BE UNFAVORABLE. APPROVAL OF ALL DAILY CONTRACTOR WORK SCHEDULE REQUESTES SHALL BE SOLELY DETERMINED BY THE ENGINEER AND OR PROJECT SUPERVISOR.
- ALL LANE AND SHOULDER CLOSURES SHALL BE IMMEDIATELY REMOVED DURING ALL ADVERSE WEATHER CONDITIONS WITHOUT EXCEPTION INCLUDING BUT NOT LIMITED TO RAIN, WET ROAD SURFACE (SPRAY FROM TIRES), MIST, DRIZZLE, SLEET, SNOW, FOG AND ANY OTHER CIRCUMSTANCE DETERMINED UNSAFE BY THE ENGINEER. THE CONTRACTOR SHALL IMPLEMENT THIS CONTRACT REQUIREMENT IMMEDIATELY WITHOUT WAITING FOR DEPARTMENT INSTRUCTIONS.
- NO WORK WILL BE ALLOWED DAY OR NIGHT ON THE FOLLOWING DATES UNLESS IT IS CONSIDERED AN EMERGENCY, IMMEDIATE HAZARD OR ANY WORK AS DESIGNATED BY THE DEPARTMENT THAT REQUIRES FIRST PRIORITY CORRECTIVE ACTION:

2014:	APRIL 18 - APRIL 21	EASTER HOLIDAY
	MAY 22 - MAY 28	MEMORIAL DAY HOLIDAY
	JULY 2 - JULY 8	INDEPENDENCE DAY HOLIDAY
	AUGUST 28 - SEPTEMBER 3	LABOR DAY HOLIDAY
	NOVEMBER 26 - NOVEMBER 30	THANKSGIVING HOLIDAY
	DECEMBER 23 - JANUARY 1	CHRISTMAS/NEW YEAR'S HOLIDAY
2015:	APRIL 3 - APRIL 6	EASTER HOLIDAY
	MAY 21 - MAY 27	MEMORIAL DAY HOLIDAY
	JULY 1 - JULY 7	INDEPENDENCE DAY HOLIDAY
	SEPTEMBER 3 - SEPTEMBER 9	LABOR DAY HOLIDAY
	NOVEMBER 25 - NOVEMBER 29	THANKSGIVING HOLIDAY
	DECEMBER 23 - JANUARY 1	CHRISTMAS/NEW YEAR'S HOLIDAY

REVISIONS		ILLINOIS DEPARTMENT OF TRANSPORTATION
NAME	DATE	
		SUMMARY OF QUANTITIES AND SCHEDULE OF STARTING DATES

SCALE: VERT. DATE HORIZ. DRAWN BY
CHECKED BY

F.A. RTE.	SECTION	COUNTY	TOTAL SHEETS	SHEET NO.
VAR.	2013-027-1	*	26	5
STA.		TO STA.		
FED. ROAD DIST. NO.	ILLINOIS	FED. AID PROJECT		

* COOK, DU PAGE, KANE, LAKE, MC HENRY AND WILL

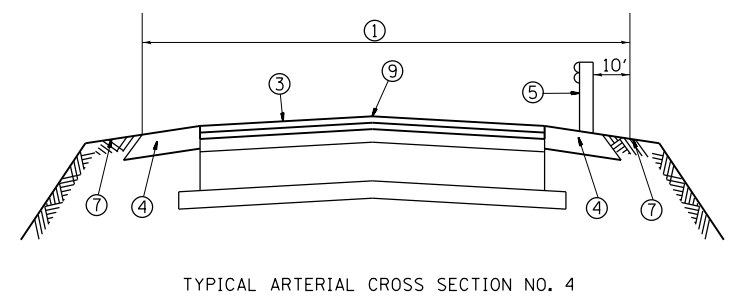
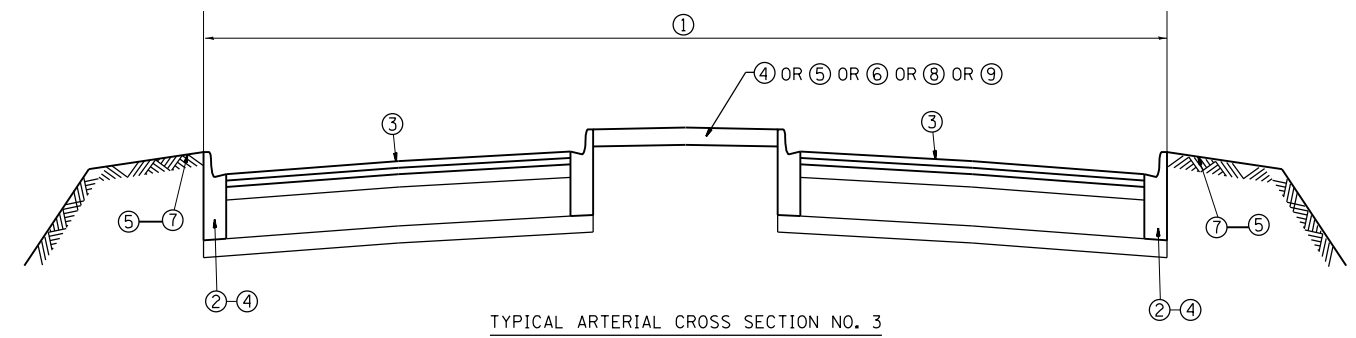
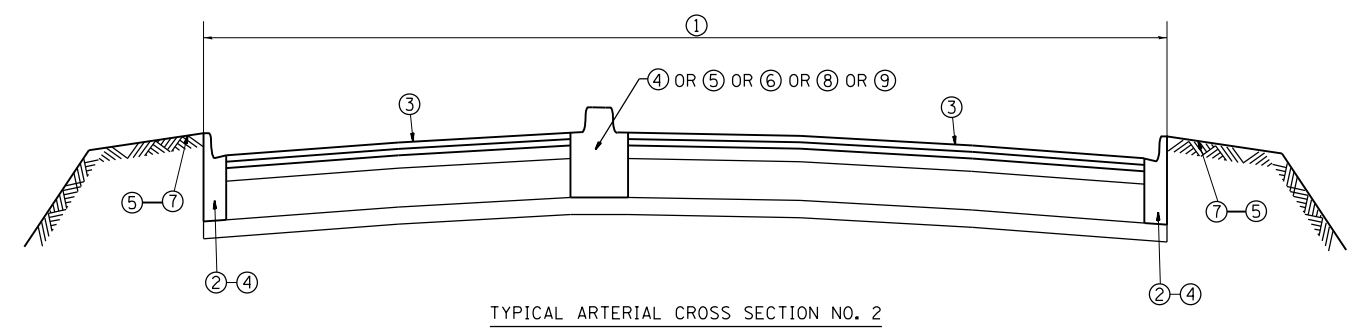
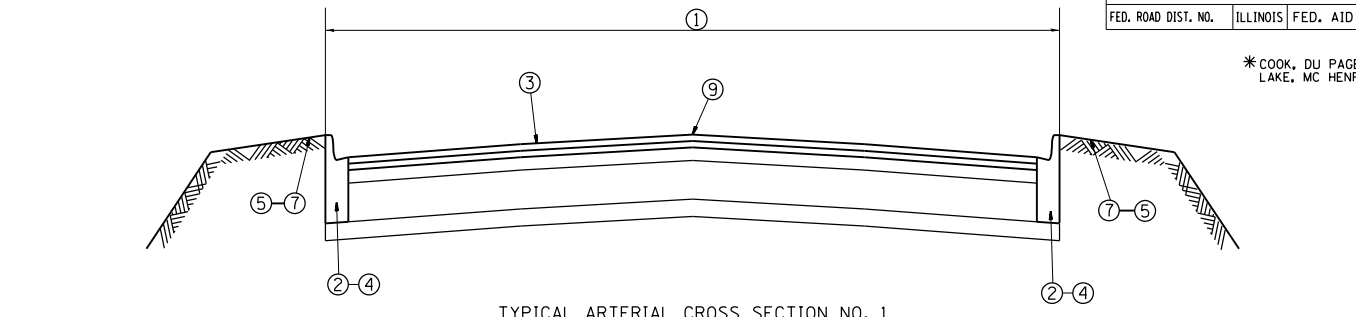
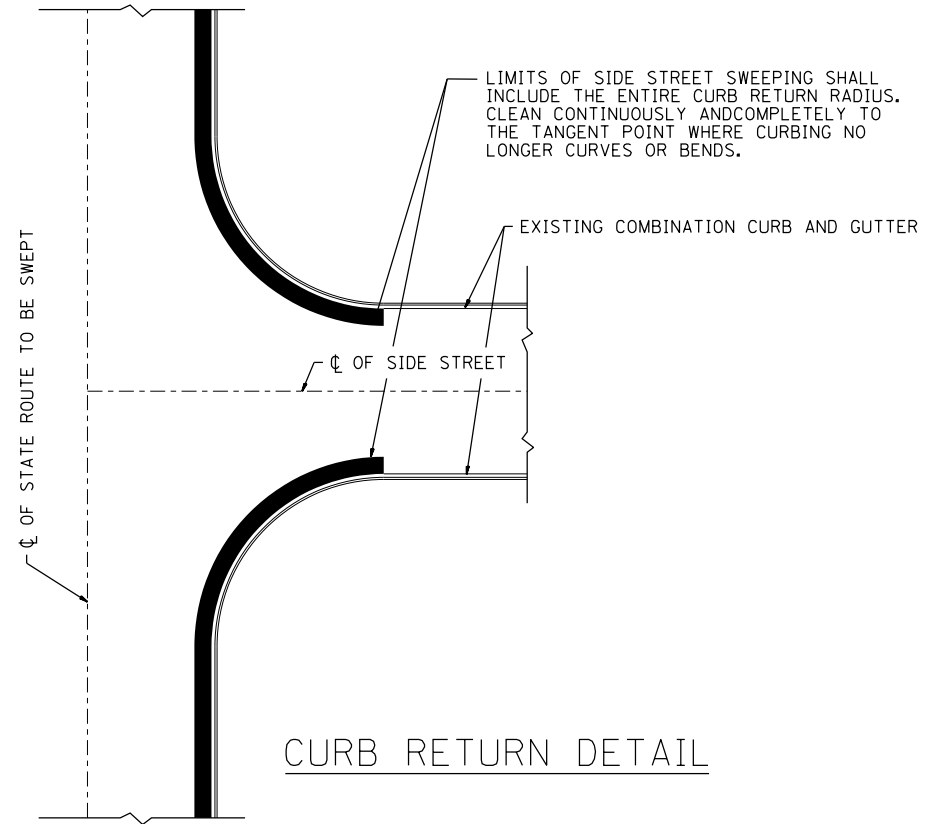

LEGEND

- ① AREA OF ROADWAY CLEANING AND RUBBISH REMOVAL
- ② CURB AND GUTTER
- ③ TRAVELED ROADWAY
- ④ STABILIZED SHOULDER OR MEDIAN
- ⑤ STEEL PLATE GUARDRAIL (SEE NOTE 1)
- ⑥ CONCRETE BARRIER
- ⑦ NON STABILIZED AREA
- ⑧ RAISED CONCRETE MEDIAN
- ⑨ ALL EXISTING TURF MEDIANS

NOTES:

- 1) ALL LOCATIONS OF GUARDRAIL SHALL BE CLEANED BY HAND LABORING UNDERNEATH AND 10 FEET BEHIND STABILIZED AND NON STABILIZED AREAS. THIS WORK SHALL BE CONSIDERED AS INCLUDED IN THE CONTRACT UNIT PRICE FOR ALL FULL CLEANING CYCLES.
- 2) SLOPE WALLS UNDER BRIDGES ARE NOT INCLUDED IN AREAS TO BE CLEANED.
- 3) ALL ARTERIAL INTERCHANGES, INTERSECTIONS, RAMPS AND CROSSOVERS SHALL BE CLEANED

REVISIONS	
NAME	DATE

ILLINOIS DEPARTMENT OF TRANSPORTATION
 EXPRESSWAY AND ARTERIAL HIGHWAY
 CLEANING (SWEEPING)
**TYPICAL
 ARTERIAL CROSS SECTIONS
 AND CURB RETURN DETAIL**
 SCALE: VERT. _____
 HORIZ. _____
 DATE _____ DRAWN BY _____
 CHECKED BY _____

PLOT DATE = 7/9/2013
 FILE NAME = c:\pwworkspace\mudja\0136184\SweepingContract2009.dgn
 PLOT SCALE = 1/8"=1'-0"
 USER NAME = mudja

F.A. RTE.	SECTION	COUNTY	TOTAL SHEETS	SHEET NO.
VAR.	2013-027-1	*	26	4
STA.		TO STA.		
FED. ROAD DIST. NO.	ILLINOIS	FED. AID PROJECT		

* COOK, DU PAGE, KANE, LAKE, MC HENRY AND WILL

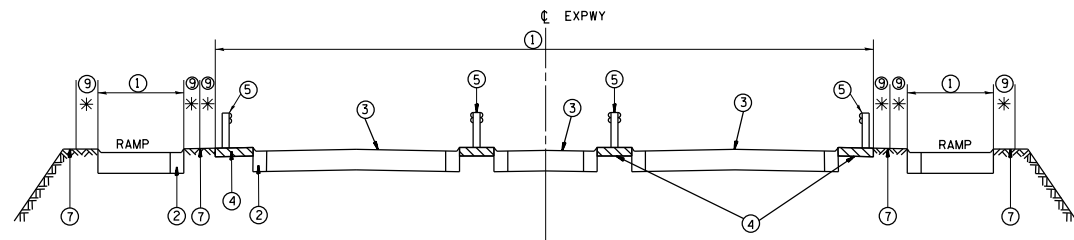

TYPICAL EXPRESSWAY CROSS-SECTION NO. 1

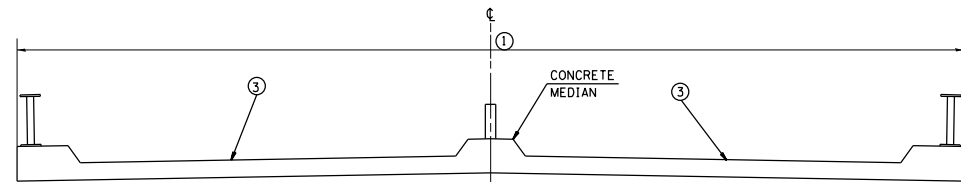

TYPICAL CROSS-SECTION OF ELEVATED ROADWAY

TYPICAL EXPRESSWAY CROSS-SECTION NO. 2

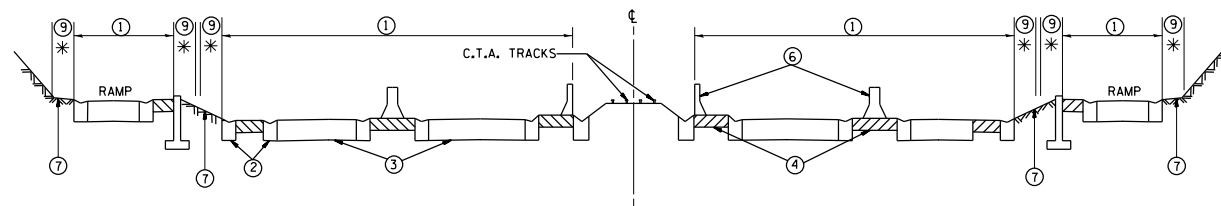

TYPICAL EXPRESSWAY CROSS-SECTION NO. 3

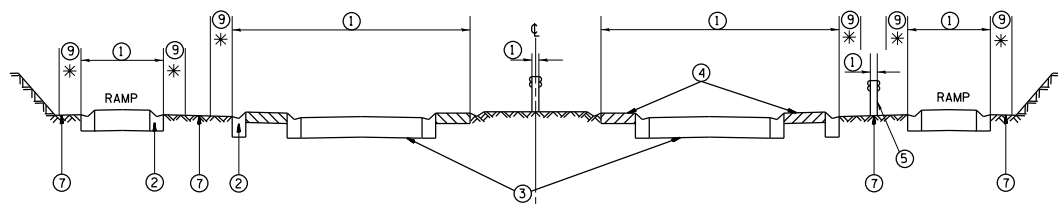

TYPICAL EXPRESSWAY CROSS-SECTION NO. 4

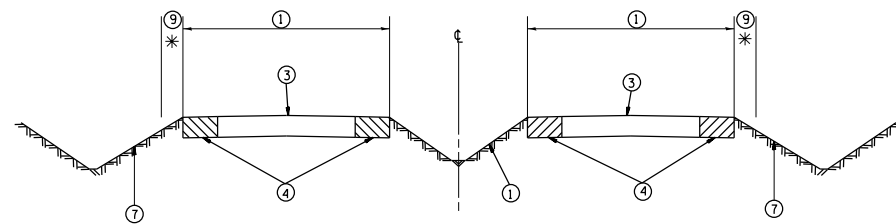

TYPICAL EXPRESSWAY CROSS-SECTION NO. 5

LEGEND

- ① AREA OF ROADWAY CLEANING AND RUBBISH REMOVAL
- ② CURB AND GUTTER
- ③ TRAVELED ROADWAY
- ④ STABILIZED SHOULDER OR MEDIAN OR SIDEWALK
- ⑤ STEEL PLATE GUARD RAIL (SEE NOTE A)
- ⑥ CONCRETE BARRIER
- ⑦ NON STABILIZED SURFACE
- ⑧ RAISED CONCRETE MEDIAN
- ⑨ LITTER PICKING

NOTE:

- A) ALL LOCATIONS OF GUARDRAIL SHALL BE CLEANED BY HAND LABORING UNDERNEATH AND 10 FEET BEHIND STABILIZED AND NON STABILIZED AREAS. THIS WORK SHALL BE CONSIDERED AS INCLUDED IN THE CONTRACT UNIT PRICE FOR ALL FULL CLEANING CYCLES.
- B) SLOPE WALLS UNDER BRIDGES ARE NOT INCLUDED IN AREAS TO BE CLEANED.
- C) DEBRIS SHALL BE REMOVED FROM ALL STABILIZED AREAS, UNDER AND 10 FEET BEHIND ALL GUARDRAIL AND ALL AGGREGATE/ STONE SHOULDERS REGARDLESS OF WIDTH.

LEGEND

* : 10' (TYP.)

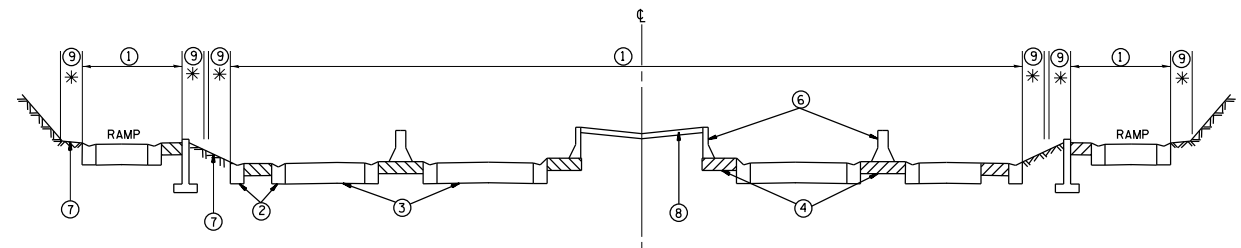

TYPICAL EXPRESSWAY CROSS-SECTION NO. 6

PLOT DATE = 7/9/2013
 FILE NAME = c:\pwork\pwork\mud\p\0136184\SweepingContract2009.dgn
 PLOT SCALE = 1/8"=1'-0"
 USER NAME = midup

REVISIONS	
NAME	DATE

ILLINOIS DEPARTMENT OF TRANSPORTATION

TYPICAL EXPRESSWAY CROSS-SECTIONS

SCALE: VERT. HORIZ.
 DATE

DRAWN BY
 CHECKED BY

F.A. RTE.	SECTION	COUNTY	TOTAL SHEETS	SHEET NO.
VAR.	2013-027-I	*	26	6
STA.		TO STA.		
FED. ROAD DIST. NO.	ILLINOIS	FED. AID PROJECT		

* COOK, DU PAGE, KANE, LAKE, MC HENRY AND WILL

EXPRESSWAY PARTNERSHIP RECOGNITION SIGN LOCATIONS

NO.	SPONSOR	LOCATION
1	MID-TOWN TENNIS	KENNEDY, OUTBOUND, NORTH AVE. TO FULLERTON
2	U.S. CELLULAR	KENNEDY, OUTBOUND, HARLEM TO CANFIELD
3	UNILOCK	KENNEDY, OUTBOUND, CANFIELD TO CUMBERLAND
4	MONARCH STEEL	KENNEDY, INBOUND, CUMBERLAND TO CANFIELD
5	MIDWEST GROUNDCOVERS/TRADING	KENNEDY, INBOUND, NAGLE TO CENTRAL
6	CHICAGO CUBS	KENNEDY, INBOUND, IRVING PARK TO BELMONT
7	900 N. MICHIGAN SHOPS	KENNEDY, INBOUND, FULLERTON TO NORTH
8	CHICAGO BEARS	KENNEDY, INBOUND, NORTH AVE. TO OGDEN
9	MILLER BREWING	KENNEDY, OUTBOUND, AT OGDEN ENTRANCE
10	CHICAGO BULLS	KENNEDY, OUTBOUND, AT MILWAUKEE EXIT
11	McGRATH LEXUS	KENNEDY, OUTBOUND, AT DIVISION
12	HOME DEPOT, INC.	KENNEDY, OUTBOUND, AT NORTH AVE.
13	A. FINKL & SONS/GENERAL IRON	KENNEDY, OUTBOUND, AT ARMITAGE
14	BUCKTOWN GARDEN CLUB	KENNEDY, OUTBOUND, AT CORTLAND/ASHLAND
15	GUSTITUS GROUP	KENNEDY, OUTBOUND, AT FULLERTON
16	LINCOLN PARK YOUNG PROFESSIONALS	KENNEDY, IN/OUTBOUND, AT DAMEN
17	UBS	KENNEDY, OUTBOUND, AT IRVING PARK
18	EDWARD FOX PHOTOGRAPHY	KENNEDY, OUTBOUND, AT LAWERENCE
19	ESURANCE	KENNEDY, OUTBOUND, AT BRYN MAWR EXIT
20	McGINTY BROTHERS	KENNEDY, OUTBOUND, AT CUMBERLAND EXIT (WEST SIDE)
21	MARILYN MIGLIN LP	KENNEDY, OUTBOUND, AT CUMBERLAND EXIT (EAST SIDE)
22	Dr. FISHMAN	KENNEDY, OUTBOUND AT ADDISON ENTRANCE RAMP
23	GALLERIA MARCHETTI	KENNEDY, OUTBOUND AT ONTARIO ENTRANCE
24	TRIBE AGENCY	KENNEDY, OUTBOUND AT DAMEN AVE. ENTRANCE
25	GOLUP AND COMPANY	KENNEDY, INBOUND, MILWAUKEE TO OGDEN
26	MESIROW FINANCIAL	KENNEDY, INBOUND, AT MILWAUKEE ENTRANCE
27	GALE STREET INN	KENNEDY, INBOUND, AT AUSTIN EXIT
28	EDWARD FOX PHOTOGRAPHY	KENNEDY, INBOUND, AT PULASKI ENTRANCE
29	MARMOM GROUP, INC.	KENNEDY, INBOUND AT FULLERTON
30	A. FINKL & SONS/GENERAL IRON	KENNEDY, INBOUND, AT ARMITAGE
31	GOOSE ISLAND BEER COMPANY	KENNEDY, INBOUND, AT NORTH AVE ENTRANCE
32	SAM'S WINE AND SPIRITS	KENNEDY, INBOUND, AT NORTH AVE EXIT
33	CHRISTY WEBBER & CO.	KENNEDY, INBOUND, AT DIVISION
34	THE JOHN BUCK COMPANY	KENNEDY, INBOUND, AT OGDEN EXIT
35	YELLOW CAB	KENNEDY, SOUTHBOUND, GRAND TO HUBBARD
36	ESURANCE	KENNEDY, SOUTHBOUND, FULTON TO LAKE
37	CLEAR CHANNEL	KENNEDY, SOUTHBOUND, RANDOLPH TO WASHINGTON
38	HORSESHOE CASINO	KENNEDY, SOUTHBOUND, WASHINGTON TO MADISON
39	RPM ADVERTISING	KENNEDY, SOUTHBOUND, MADISON TO MONROE
40	CHICAGO FIREHOUSE	KENNEDY, SOUTHBOUND, MONROE TO ADAMS
41	EMERALD	KENNEDY, SOUTHBOUND, LAKE TO RANDOLPH
42	ENVIRONMENTAL DESIGN INT.	KENNEDY, SOUTHBOUND, ADAMS TO JACKSON
43	GIORDANO'S	KENNEDY, SOUTHBOUND, JACKSON TO VAN BUREN
44	BOND COMPANIES	KENNEDY, NORTHBOUND, HUBBARD TO GRAND
45	CHIPOTLE	KENNEDY, NORTHBOUND, ADAMS TO MONROE
46	FIJI WATER	KENNEDY, NORTHBOUND, MONROE TO MADISON
47	FIORETTI & LOWER LTD.	KENNEDY, NORTHBOUND, MADISON TO WASHINGTON
48	THE FAIRMONT HOTEL	KENNEDY, NORTHBOUND, WASHINGTON TO RANDOLPH
49	TOYOTA	KENNEDY, NORTHBOUND, JACKSON TO ADAMS
50	NBC	KENNEDY, NORTHBOUND, RANDOLPH TO LAKE
51	CHCA/NCA	KENNEDY, NORTHBOUND, LAKE TO WAYMAN
52	CONCIERGE PREFERRED	KENNEDY, NORTHBOUND, HUBBARD TO GRAND
53	HOER LANDSCAPE ARCHITECTURE	EDENS, OUTBOUND, JUNCTION TO FOSTER MILE
54	WHOLE FOODS	EDENS, IN/OUTBOUND, AT PETERSON EXIT/ENTRANCE RAMP
55	LIFE SOURCE	EDENS, OUTBOUND, FOSTER EXIT/ ENTRANCE
56	POTBELLY	EDENS, OUTBOUND, PETERSON TO DEVON
57	UNILOCK	EDENS, INBOUND, FOSTER TO JUNCTION MILE
58	NATIONAL CITY BANK	EISENHOWER, OUTBOUND, HALSTED TO ASHLAND
59	ARAMARK	EISENHOWER, OUTBOUND, WESTERN TO KEDZIE
60	COM ED	EISENHOWER, OUTBOUND, PULASKI TO CICERO
61	CHICAGO PARK DISTRICT	EISENHOWER, OUTBOUND, CICERO TO AUSTIN
62	FTD	EISENHOWER, INBOUND, KEDZIE TO WESTERN
63	UNILOCK	EISENHOWER, INBOUND, CICERO TO PULASKI
64	AMERICAN MEDICAL ASSOC.	EISENHOWER, INBOUND, LEAVITT TO DAMEN
65	RUBLOFF	EISENHOWER, INBOUND, ASHLAND TO HALSTED

NO.	SPONSOR	LOCATION
66	CHICAGO PARK DISTRICT	EISENHOWER, OUTBOUND, AT CENTRAL (EXIT/ENTRANCE RAMP)
67	CLASSIC COLOR	EISENHOWER, AT CENTRAL (MEDIANS)
68	CHINATOWN CHAMBER OF COMERCE	STEVENSON, OUTBOUND, AT STATE ST. EXIT
69	MIDWEST GENERATION	STEVENSON, OUTBOUND, AT PULASKI EXIT
70	SOUTHWEST AIRLINES	STEVENSON, OUTBOUND, AT CICERO ENTRANCE
71	CANADIAN NAT'L/ILL. CENTRAL RR	STEVENSON, INBOUND, AT CICERO
72	CHICAGO WHITE SOX	DAN RYAN, OUTBOUND, 31st ST. TO 39th ST.
73	ILL. SPORTS FACILITIES AUTHORITY	DAN RYAN, OUTBOUND, 39th ST. TO 47th ST.
74	ILLINOIS INSTITUTE OF TECHNOLOGY	DAN RYAN, INBOUND, 39th ST. TO 31st ST.
75	HORSESHOE CASINO	DAN RYAN, POLK ST. MEDIANS
76	UNITED SERVICE COMPANIES	OHIO INTERCHANGE, NORTHBOUND INTERIOR
77	IO PIN	KENNEDY, SOUTHBOUND, AT OHIO ST. EXIT, EASTSIDE
78	HYATT HOTELS & RESORTS	OHIO INTERCHANGE, SOUTHBOUND INTERIOR
79	NEIGHBORS OF RIVER WEST	OHIO INTERCHANGE, ONTARIO ENTRANCE, SOUTH SIDE
80	TUSCANY RESTRAUNT	OHIO INTERCHANGE, ONTARIO ENTRANCE, NORTH SIDE
81	KINSELLA LANDSCAPE	OHIO INTERCHANGE, SOUTHEAST RAMP
82	BP	EDENS/KENNEDY JUNCTION
83	WASTE MANAGMENT	BISHOP FORD, AT 111th ST., WEST SIDE
84	MCCORMICK GATEWAY SCULPTURE	CERMAK/MARTIN LUTHER KING DRIVE
85	HARRY CARAY'S/ DePORTER GATEWAY	OHIO/ORLEANS TRIANGLE, INBOUND
86	ALPER SERVICES	KENNEDY EXPRESSWAY OHIO INTERCHANGE

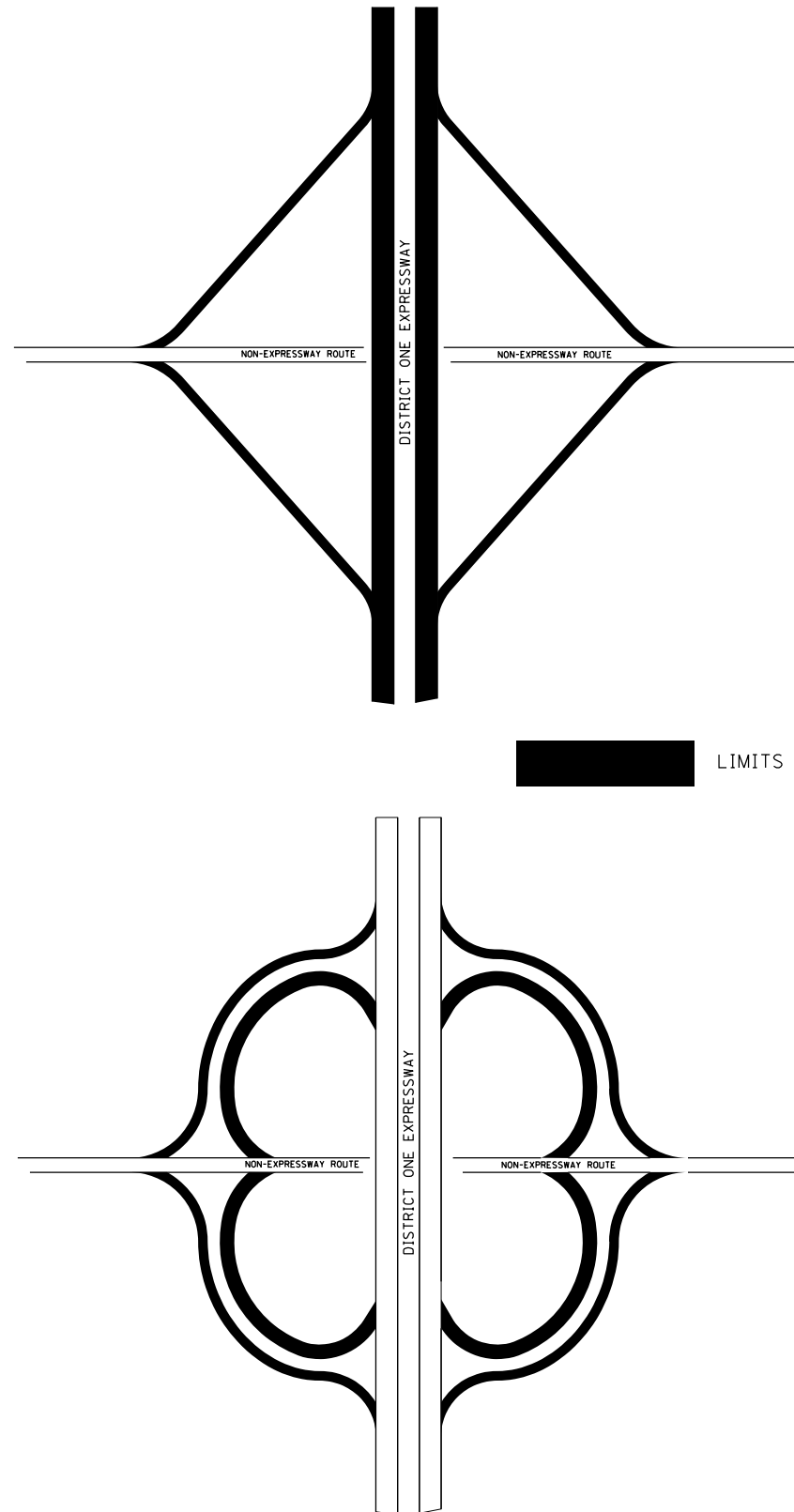

LIMITS OF SIGN CLEANING

REVISIONS	
NAME	DATE

ILLINOIS DEPARTMENT OF TRANSPORTATION
EXPRESSWAY AND ARTERIAL HIGHWAY
CLEANING (SWEEPING)

LIMITS OF
SIGN CLEANING

SCALE: VERT.
HORIZ.
DATE

DRAWN BY
CHECKED BY

F.A. RTE.	SECTION	COUNTY	TOTAL SHEETS	SHEET NO.
VAR.	2013-027-I	*	26	7
STA.		TO STA.		
FED. ROAD DIST. NO.	ILLINOIS	FED. AID PROJECT		

* COOK, DU PAGE, KANE, LAKE, MC HENRY AND WILL

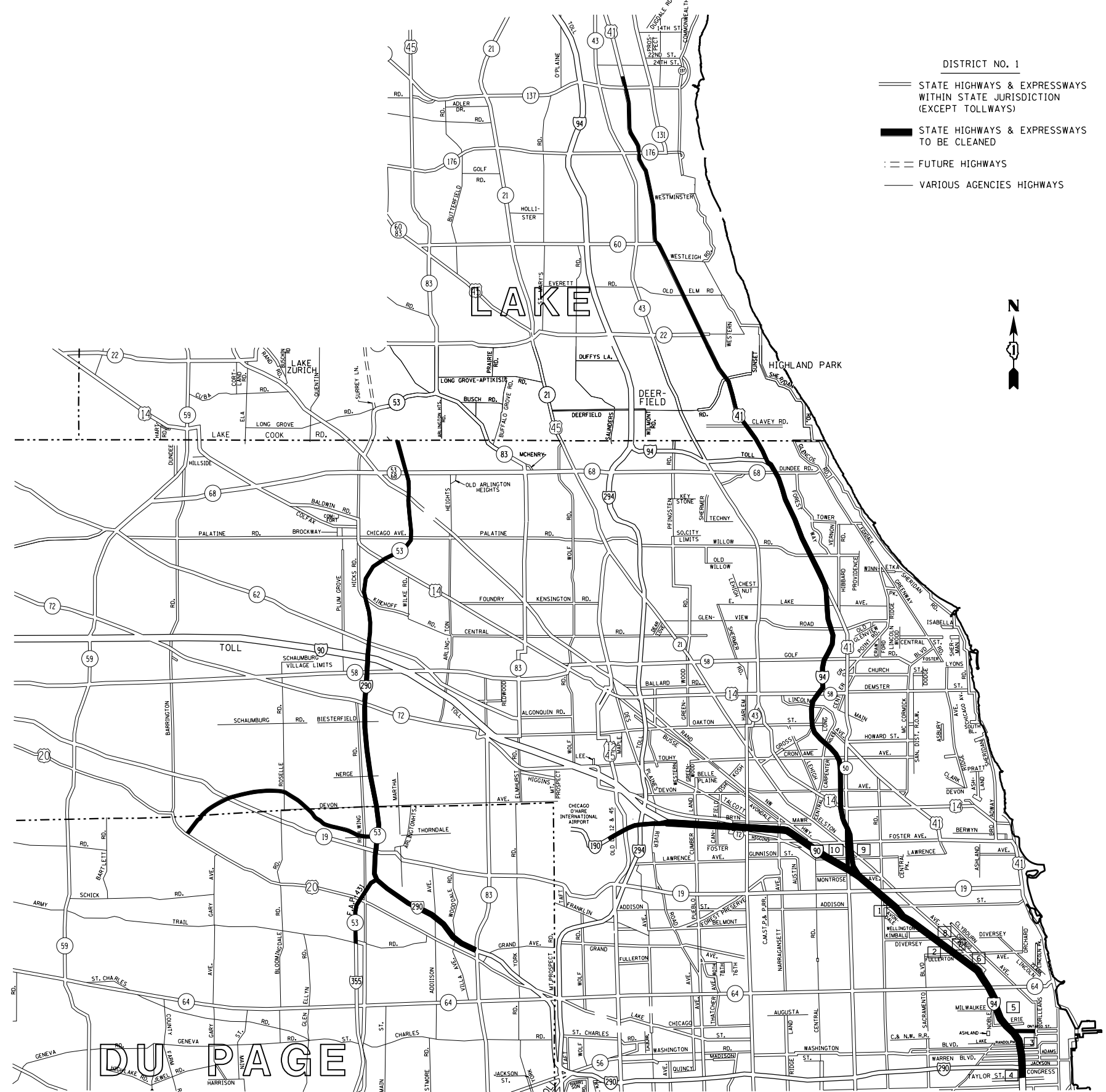

DISTRICT NO. 1

STATE HIGHWAYS & EXPRESSWAYS WITHIN STATE JURISDICTION (EXCEPT TOLLWAYS)

STATE HIGHWAYS & EXPRESSWAYS TO BE CLEANED

FUTURE HIGHWAYS

VARIOUS AGENCIES HIGHWAYS

DAY CLEANING ONLY

I-290 Extension/ILL.53/Elgin-O'Hare Expressway
 I-290 from Illinois 83 to Northwest Tollway, Illinois 53 from Northwest Tollway to Lake Cook Road including I-355 from I-290 to Army Trail Road and the Elgin-O'Hare Expressway from the east side of the bridge over I-290 to U.S. Route 20.

Edens Expressway
 Interstate 94 from Montrose to Dundee Road and U.S. 41 from Dundee Road to 700 lineal feet north of Illinois 137 including two ramps at Clavey Road, two ramps at West Park Avenue, four ramps at Deerpath Road and the entire US 41/Deerfield Road Interchange. Also included is Tower Road from Edens Expressway to Forestway Drive.

NIGHT CLEANING ONLY

Kennedy Expressway
 Interstate 90/94 from Taylor Street to Interstate 90/94 junction at Edens Expressway, Interstate 90 from Interstate 90/94 junction at Edens Expressway to Interstate 90/190, Interstate 190 from Interstate 90/190 junction to the east limits of O'Hare International Airport, Interstate 90 from the Interstate 90/190 junction to the tollway turnaround, the Ohio Street Feeder, from Orleans Street to Interstate 90/94 and all accident investigation sites located along Interstate 90/94.

ACCIDENT INVESTIGATION SITES:

1. INBOUND INTERSTATE 90/94 AT ADDISON STREET OFF RAMP.
2. INBOUND INTERSTATE 90/94 ALONG FULLERTON AVENUE UNDER INTERSTATE 90/94.
3. INBOUND INTERSTATE 90/94 IN THE OHIO STREET INFIELD.
4. INTERSTATE 90/94 AT POLK AVENUE.
5. OUTBOUND INTERSTATE 90/94 ALONG DIVISION STREET OFF RAMP.
6. OUTBOUND INTERSTATE 90/94 ALONG INTERSTATE 90/94 AT DAMEN AVENUE.
7. OUTBOUND INTERSTATE 90/94 ALONG FULLERTON AVENUE UNDER INTERSTATE 90/94.
8. OUTBOUND INTERSTATE 90/94 ALONG KIMBALL STREET OFF RAMP.
9. OUTBOUND INTERSTATE 94 ALONG FOSTER AVENUE OFF RAMP.
10. OUTBOUND INTERSTATE 90/94 JUST BEFORE LAWRENCE AVENUE OFF RAMP.

PLOT DATE = 7/9/2013
 FILE NAME = c:\pwworkspace\mudjo\0136184\SweepingContr.ac2009.dgn
 PLOT SCALE = 1/85,8824 / in.
 USER NAME = midjup

REVISIONS	
NAME	DATE

ILLINOIS DEPARTMENT OF TRANSPORTATION

EXPRESSWAY CLEANING LOCATION MAP
 I-290 EXTENSION/ILL. 53, EDENS, KENNEDY & ELGIN-O'HARE

SCALE: VERT. / HORIZ.
 DATE / DRAWN BY / CHECKED BY

F.A. RTE.	SECTION	COUNTY	TOTAL SHEETS	SHEET NO.
VAR.	2013-027-I	*	26	8
STA.	TO STA.			
FED. ROAD DIST. NO.	ILLINOIS	FED. AID PROJECT		

* COOK, DU PAGE, KANE, LAKE, MC HENRY AND WILL

DAY CLEANING ONLY

Eisenhower Expressway

Interstate 290 from Wells St. to Austin Blvd. in its entirety, from Austin Blvd. to 25th Ave. right hand side and all ramps, the eastbound collector-distributor lanes and all ramps at the U.S. 12/20/45 (Mannheim Rd.) interchange and to Roosevelt Rd. on its extension and Lower Wacker Dr. from Lake St. to the Eisenhower Expressway.

Stevenson Expressway

Interstate 55 (Stevenson Expressway) from Lake Shore Drive to the Cook-DuPage county line, including First Avenue, from 43rd Street to Archer Avenue, and all accident investigation sites.

I 55 Expressway

Interstate 55 from Cook-DuPage county line to WILL - GRUNDY CO LINE, including all ramps to and from Illinois Route 53. Also included are the ramps and collector-distributor lanes at the Route 83 Interchange; and the ramps to and from Joliet Road from I-55 to east of the N.B. Tollway bridge and the Ramps from NB I-55 to NB Tollway and from SB Tollway to NB I-55 (Limits of cleaning on these Ramps are from I-55 to the first median crossover North of Joliet Rd.) and all accident investigation sites. ALL I-55 RAMPS AND INTERCHANGES TO BE CLEANED AND BLOGETT RD. FROM KELLY RD. TO RAILROAD.

ACCIDENT INVESTIGATION SITES:

FOR LOCATIONS 1-10, SEE INNER CITY EXPRESSWAY (NORTH SECTION)

- 11. INBOUND INTERSTATE 55 AT HALSTED STREET
- 12. OUTBOUND INTERSTATE 55 AT THROOP STREET
- 13. INBOUND INTERSTATE 55 AT WOOD STREET. (LOCATED UNDER I-55)
- 14. OUTBOUND INTERSTATE 55 AT KEDZIE AVENUE
- 15. INTERSTATE 90/94 AT 87th STREET (NORTHBOUND AND SOUTHBOUND)
- 16. INTERSTATE 90/94 AT 71st STREET (NORTHBOUND AND SOUTHBOUND)
- 17. INTERSTATE 90/94 AT POLK STREET
- 18. INTERSTATE 90/94 AT KING DRIVE

NIGHT CLEANING ONLY

Eisenhower Expressway

Interstate 290 from Austin Blvd. to 25th Ave. left hand side only and from 25th Ave. to Ill. 83 including the ramps in its entirety except the eastbound collector-distributor lanes at the U.S. 12/20/45 Interchange and to Roosevelt Rd. on its extension.

Dan Ryan Expressway

Interstate 94 from Taylor Street to Cottage Grove Avenue, Interstate 57 from Interstate 94 to Halsted Street and Franklin Street connector from 22nd Street to Interstate 94

DISTRICT NO. 1

- STATE HIGHWAYS & EXPRESSWAYS WITHIN STATE JURISDICTION (EXCEPT TOLLWAYS)
- STATE HIGHWAYS & EXPRESSWAYS TO BE CLEANED
- FUTURE HIGHWAYS
- VARIOUS AGENCIES HIGHWAYS

REVISIONS		ILLINOIS DEPARTMENT OF TRANSPORTATION
NAME	DATE	
		EXPRESSWAY CLEANING LOCATION MAP EISENHOWER, STEVENSON, DAN RYAN & I-55 SCALE: VERT. / HORIZ. DATE: / / DRAWN BY: / CHECKED BY:

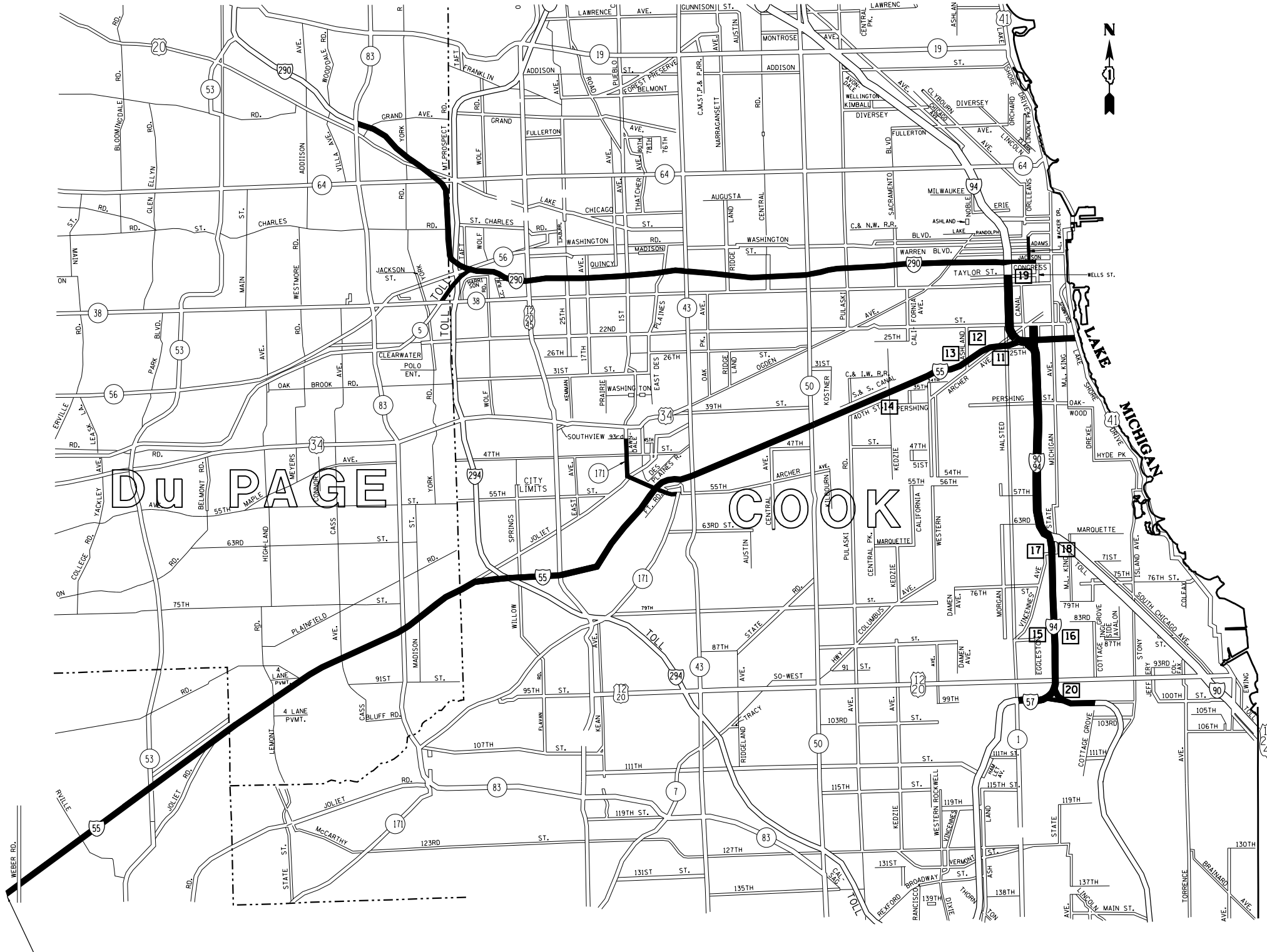

CONTINUED ON SHEET NO. 9

DATE: 7/9/2013
 FILE NAME: c:\pwworkspace\mduj\13618184\SweepingContr.ctb
 PLOT SCALE: 1/8" = 1'-0"
 USER NAME: mdjup

F.A. RTE.	SECTION	COUNTY	TOTAL SHEETS	SHEET NO.
VAR.	2013-027-1	*	26	9
STA.		TO STA.		
FED. ROAD DIST. NO.	ILLINOIS	FED. AID PROJECT		

* COOK, DU PAGE, KANE, LAKE, MC HENRY AND WILL

CONTINUED ON SHEET NO. 8

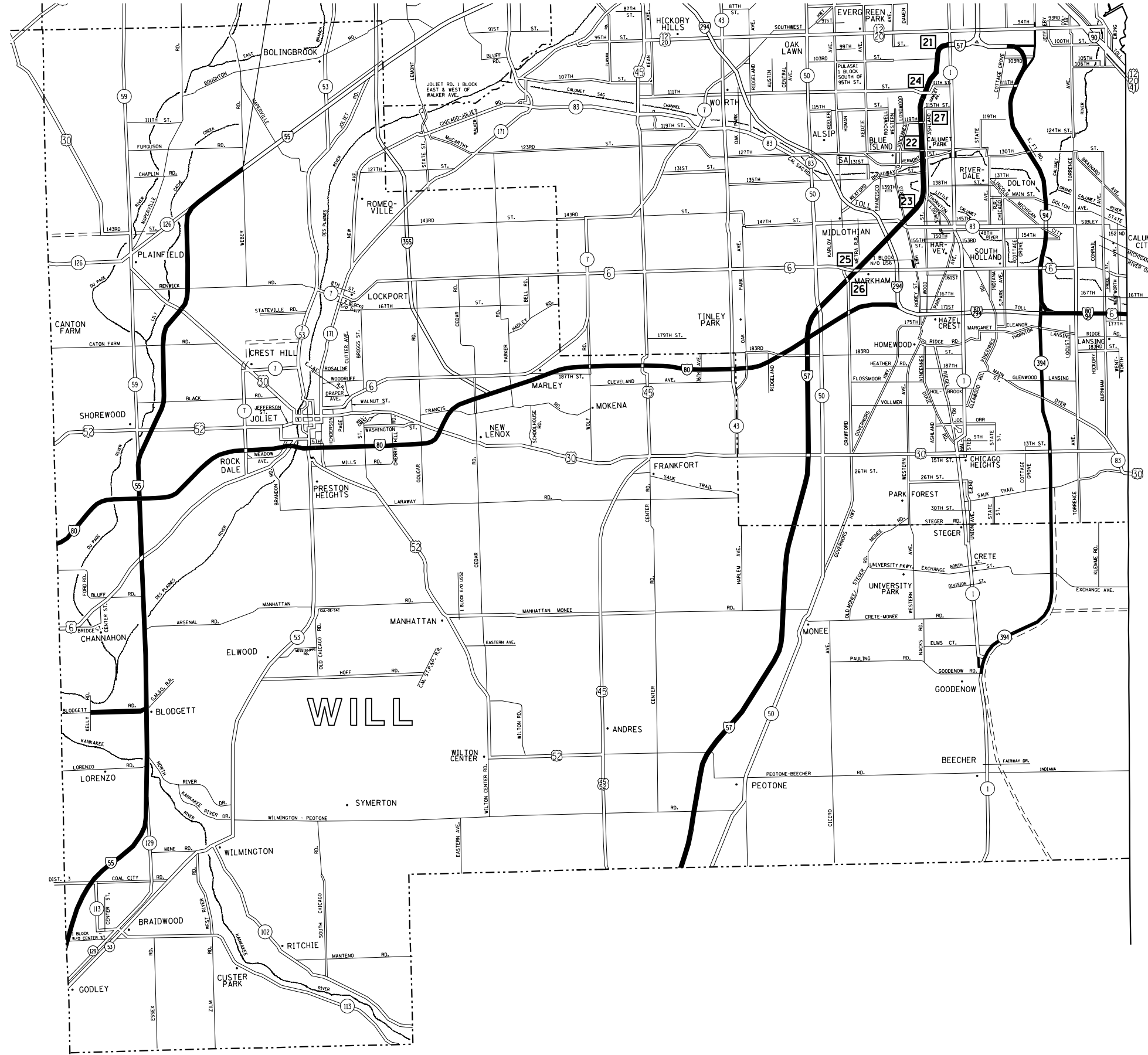

DAY CLEANING ONLY

Bishop Ford/Kingery Expressway
 Interstate 94 from Cottage Grove Avenue to the Indiana State line excluding northbound left hand side from Cottage Grove Ave. to 103rd St., Illinois 394 from Interstate 94 to Goodenow rd. and the entire Stony Island Avenue - 103rd Street Interchange. Interstate 80 from Interstate 94 to Interstate 294.

I-57 Expressway
 Interstate 57 from Halsted Street to the Will/ Kankakee County Lines including the entire I-57 - I-80 Interchange and all accident investigation sites.

- 21 - 23 INTERSTATE 57-3 LOCATIONS IN THE MEDIAN BETWEEN HALSTED AND 147th ST.
- 24 OUTBOUND INTERSTATE 57 AT 111th STREET EXIT RAMP
- 25 - 26 INTERSTATE 57 - 2 LOCATIONS ON THE 167th STREET RAMPS
- 27 INTERSTATE 57 - IN THE MEDIAN AT 119th STREET

I-80 Expressway
 Interstate 80 from Interstate 294 to the Will - Kendall County line. Including all ramps.
 Note: Include the following two (2) ramps at Interstate 294
 1. Southbound Interstate 294 to westbound Interstate 80
 2. Eastbound Interstate 80 to northbound Interstate 294.

NIGHT CLEANING ONLY

Bishop Ford Expressway
 Interstate 94 from 103rd St. to Cottage Grove Ave. northbound left hand side only.

- DISTRICT NO. 1
- STATE HIGHWAYS & EXPRESSWAYS WITHIN STATE JURISDICTION (EXCEPT TOLLWAYS)
 - STATE HIGHWAYS & EXPRESSWAYS TO BE CLEANED
 - FUTURE HIGHWAYS
 - VARIOUS AGENCIES HIGHWAYS

INDIANA

PLOT DATE = 7/9/2013
 FILE NAME = c:\pwork\pwork\mud\joe\01361818A\SweepingContrac22009.dgn
 PLOT SCALE = 1/8"=1'-0"
 USER NAME = midup

REVISIONS	
NAME	DATE

ILLINOIS DEPARTMENT OF TRANSPORTATION

EXPRESSWAY CLEANING LOCATION MAP
 BISHOP FORD, KINGERY, I-55, I-57 AND I-80

SCALE: VERT. DATE
 HORIZ. DATE

DRAWN BY
 CHECKED BY

F.A. RTE.	SECTION	COUNTY	TOTAL SHEETS	SHEET NO.
VAR.	2013-027-I	*	26	10
STA.	TO STA.			
FED. ROAD DIST. NO.	ILLINOIS	FED. AID PROJECT		

* COOK, DU PAGE, KANE, LAKE, MC HENRY AND WILL

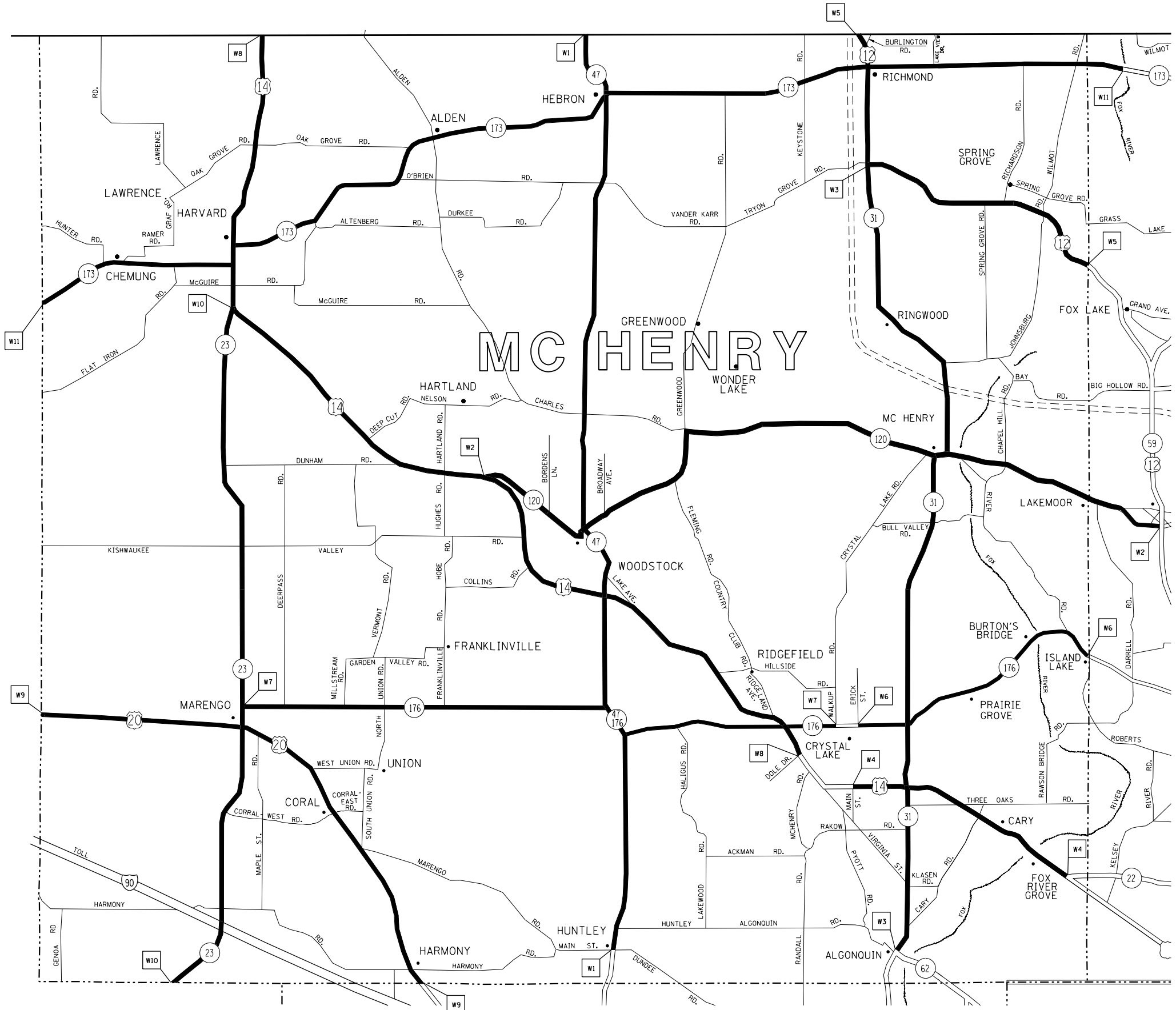

TEAM SECTION	KEY LOCATIONS
WOODSTOCK	W1 - W11

- DISTRICT NO. 1
- STATE HIGHWAYS & EXPRESSWAYS WITHIN STATE JURISDICTION (EXCEPT TOLLWAYS)
 - STATE HIGHWAYS & EXPRESSWAYS TO BE CLEANED
 - FUTURE HIGHWAYS
 - VARIOUS AGENCIES HIGHWAYS

REVISIONS	
NAME	DATE

ILLINOIS DEPARTMENT OF TRANSPORTATION

ARTERIAL CLEANING LOCATION MAP

MC HENRY COUNTY

WOODSTOCK TEAM SECTION

SCALE: VERT. / HORIZ.

DATE

DRAWN BY

CHECKED BY

PLOT DATE = 7/9/2013
 FILE NAME = c:\pwworkspace\mudjo\0136184\SweepingContract2009.dgn
 PLOT SCALE = 1/8"=1'-0"
 USER NAME = midcup

F.A. RTE.	SECTION	COUNTY	TOTAL SHEETS	SHEET NO.
VAR.	2013-027-1	*	26	11
STA.		TO STA.		
FED. ROAD DIST. NO.	ILLINOIS	FED. AID PROJECT		

* COOK, DU PAGE, KANE, LAKE, MC HENRY AND WILL

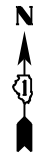

TEAM SECTION	KEY LOCATIONS
GRAYSLAKE	G1 - G21

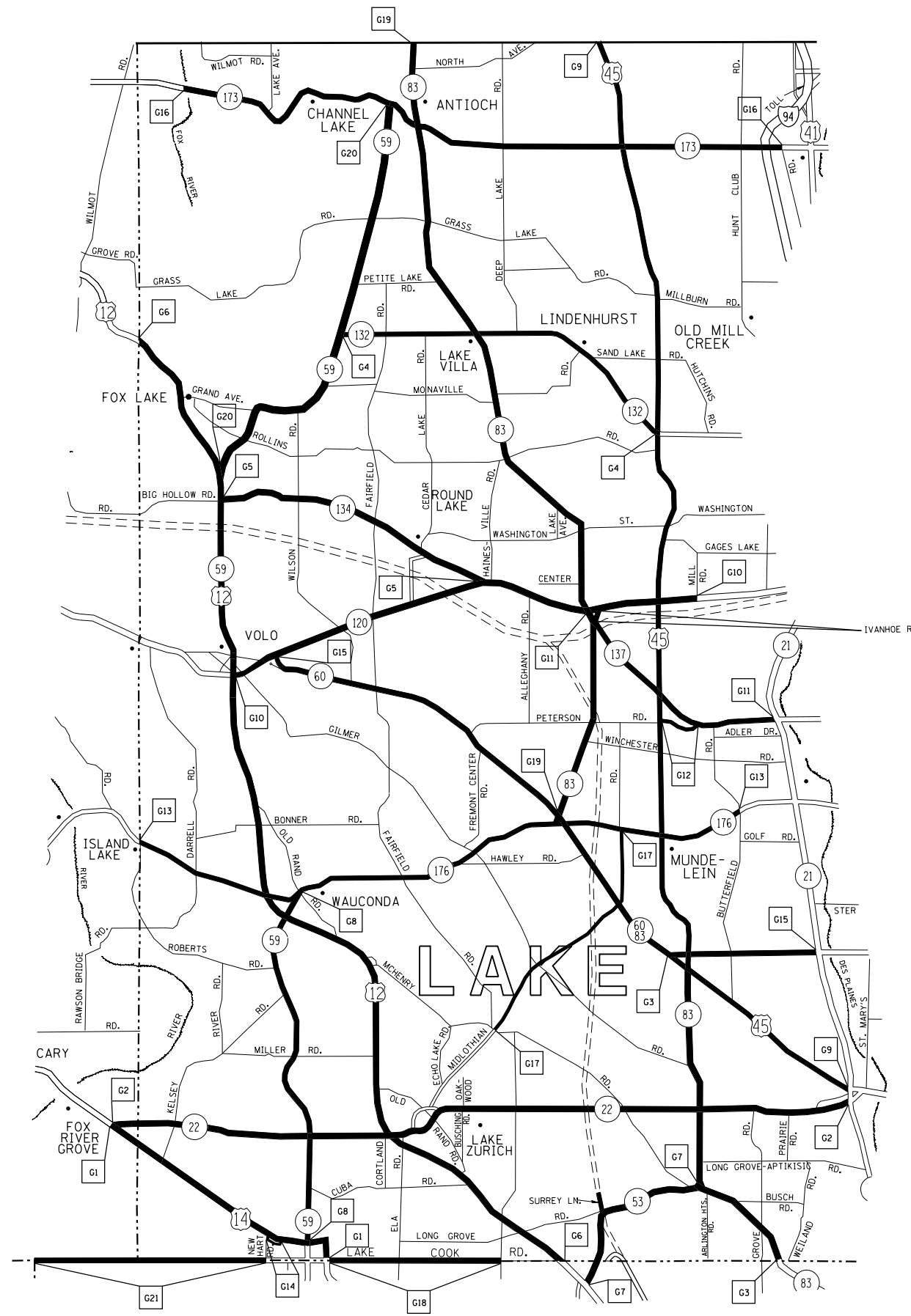

- DISTRICT NO. 1
- ==== STATE HIGHWAYS & EXPRESSWAYS WITHIN STATE JURISDICTION (EXCEPT TOLLWAYS)
 - ==== STATE HIGHWAYS & EXPRESSWAYS TO BE CLEANED
 - FUTURE HIGHWAYS
 - VARIOUS AGENCIES HIGHWAYS

REVISIONS	
NAME	DATE

ILLINOIS DEPARTMENT OF TRANSPORTATION

ARTERIAL CLEANING
LOCATION MAP
LAKE COUNTY
GRAYSLAKE TEAM SECTION

SCALE: VERT. / HORIZ.
DATE

DRAWN BY / CHECKED BY

PLOT DATE = 7/9/2013
FILE NAME = c:\pwworkspace\mudje\0136184\SweepingContract2009.dgn
PLOT SCALE = 1/8"=1'-0"
USER NAME = midup

F.A. RTE.	SECTION	COUNTY	TOTAL SHEETS	SHEET NO.
VAR.	2013-027-1	*	26	12
STA.		TO STA.		
FED. ROAD DIST. NO.	ILLINOIS	FED. AID PROJECT		

* COOK, DU PAGE, KANE, LAKE, MC HENRY AND WILL



TEAM SECTION	KEY LOCATIONS
GURNEE	GUI1 - GUI19

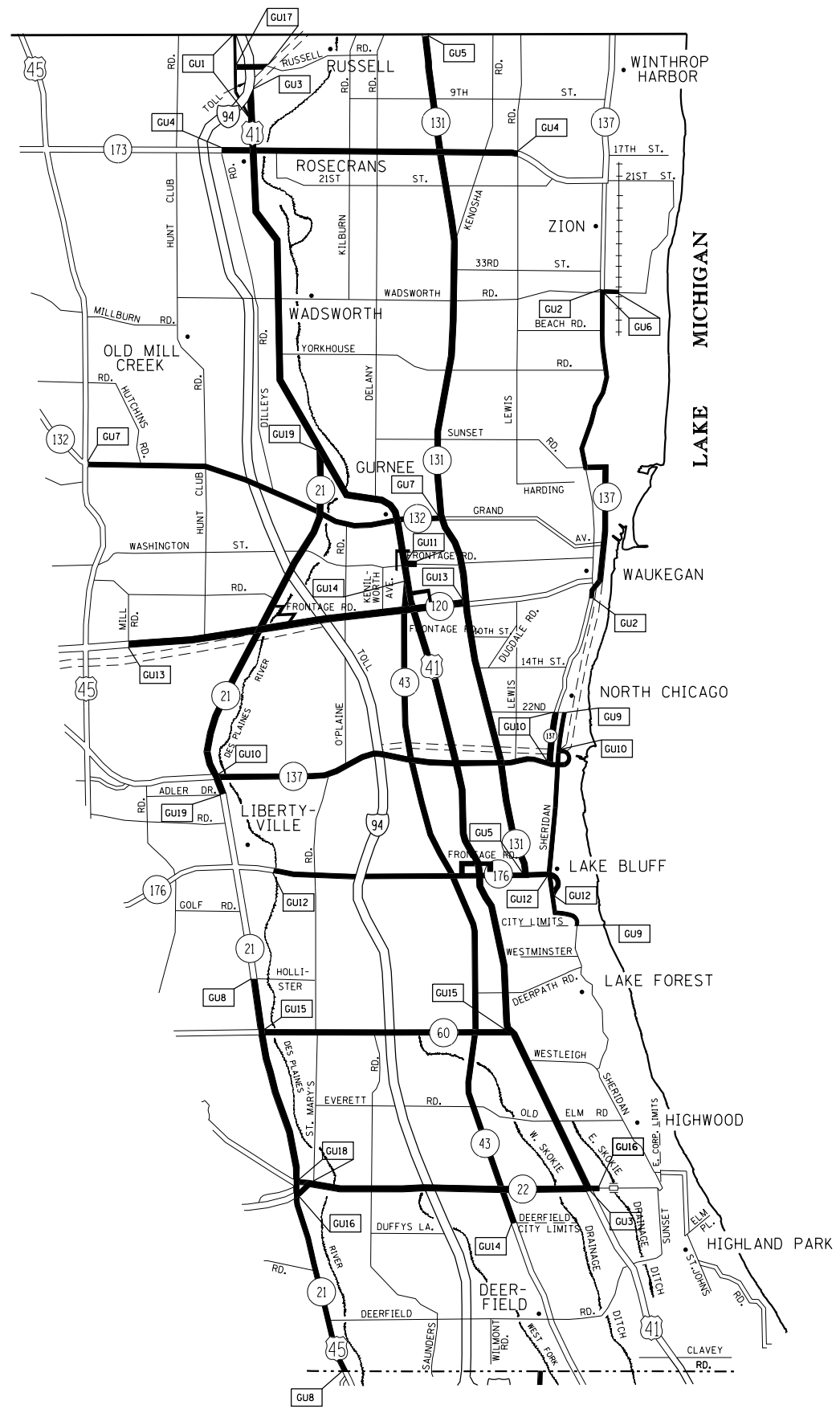

- DISTRICT NO. 1
- ==== STATE HIGHWAYS & EXPRESSWAYS WITHIN STATE JURISDICTION (EXCEPT TOLLWAYS)
 - ==== STATE HIGHWAYS & EXPRESSWAYS TO BE CLEANED
 - FUTURE HIGHWAYS
 - VARIOUS AGENCIES HIGHWAYS

REVISIONS	
NAME	DATE

ILLINOIS DEPARTMENT OF TRANSPORTATION
**ARTERIAL CLEANING
 LOCATION MAP
 LAKE COUNTY
 GURNEE TEAM SECTION**

SCALE: VERT. _____
 HORIZ. _____
 DATE _____

DRAWN BY _____
 CHECKED BY _____

PLOT DATE = 7/9/2013
 FILE NAME = c:\pwworkspace\mudjo\0136184\SweepingContract2009.dgn
 PLOT SCALE = 1/8"=1'-0"
 USER NAME = midjup

F.A. RTE.	SECTION	COUNTY	TOTAL SHEETS	SHEET NO.
VAR.	2013-027-1	*	26	13
STA.		TO STA.		
FED. ROAD DIST. NO.	ILLINOIS	FED. AID PROJECT		

* COOK, DU PAGE, KANE, LAKE, MC HENRY AND WILL

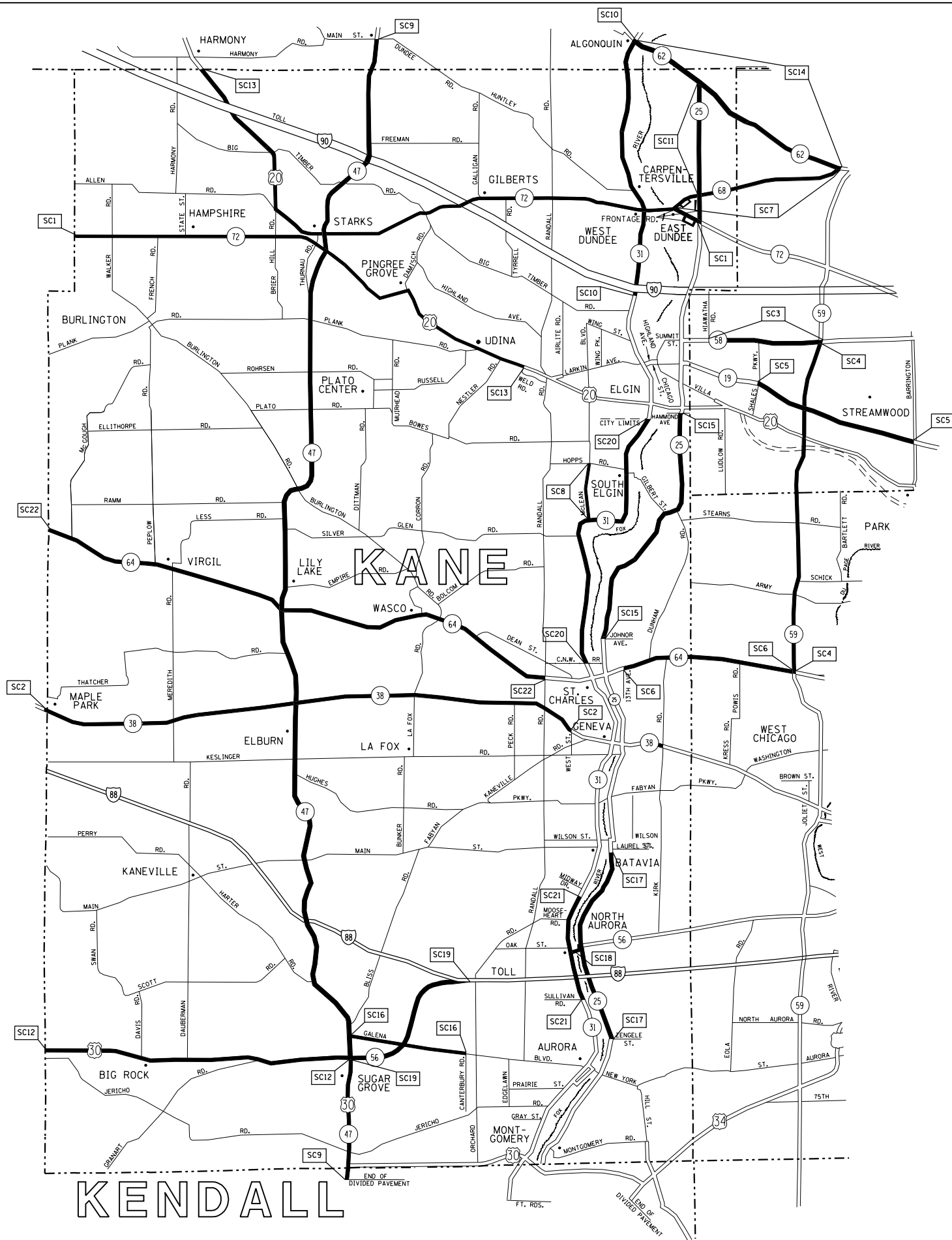

TEAM SECTION	KEY LOCATIONS
ST. CHARLES	SC1 - SC22

- DISTRICT NO. 1
- STATE HIGHWAYS & EXPRESSWAYS WITHIN STATE JURISDICTION (EXCEPT TOLLWAYS)
 - STATE HIGHWAYS & EXPRESSWAYS TO BE CLEANED
 - FUTURE HIGHWAYS
 - VARIOUS AGENCIES HIGHWAYS

REVISIONS	
NAME	DATE

ILLINOIS DEPARTMENT OF TRANSPORTATION
**ARTERIAL CLEANING
 LOCATION MAP
 KANE COUNTY
 ST. CHARLES TEAM SECTION**
 SCALE: VERT. _____
 DATE _____ HORIZ. _____
 DRAWN BY _____
 CHECKED BY _____

PLOT DATE = 7/9/2013
 FILE NAME = c:\pwworkspace\mudjo\0136184\SweepingContrac2009.dgn
 PLOT SCALE = 1/8"=1'-0"
 USER NAME = midjup

F.A. RTE.	SECTION	COUNTY	TOTAL SHEETS	SHEET NO.
VAR.	2013-027-1	*	26	14
STA.		TO STA.		
FED. ROAD DIST. NO.	ILLINOIS	FED. AID PROJECT		

* COOK, DU PAGE, KANE, LAKE, MC HENRY AND WILL

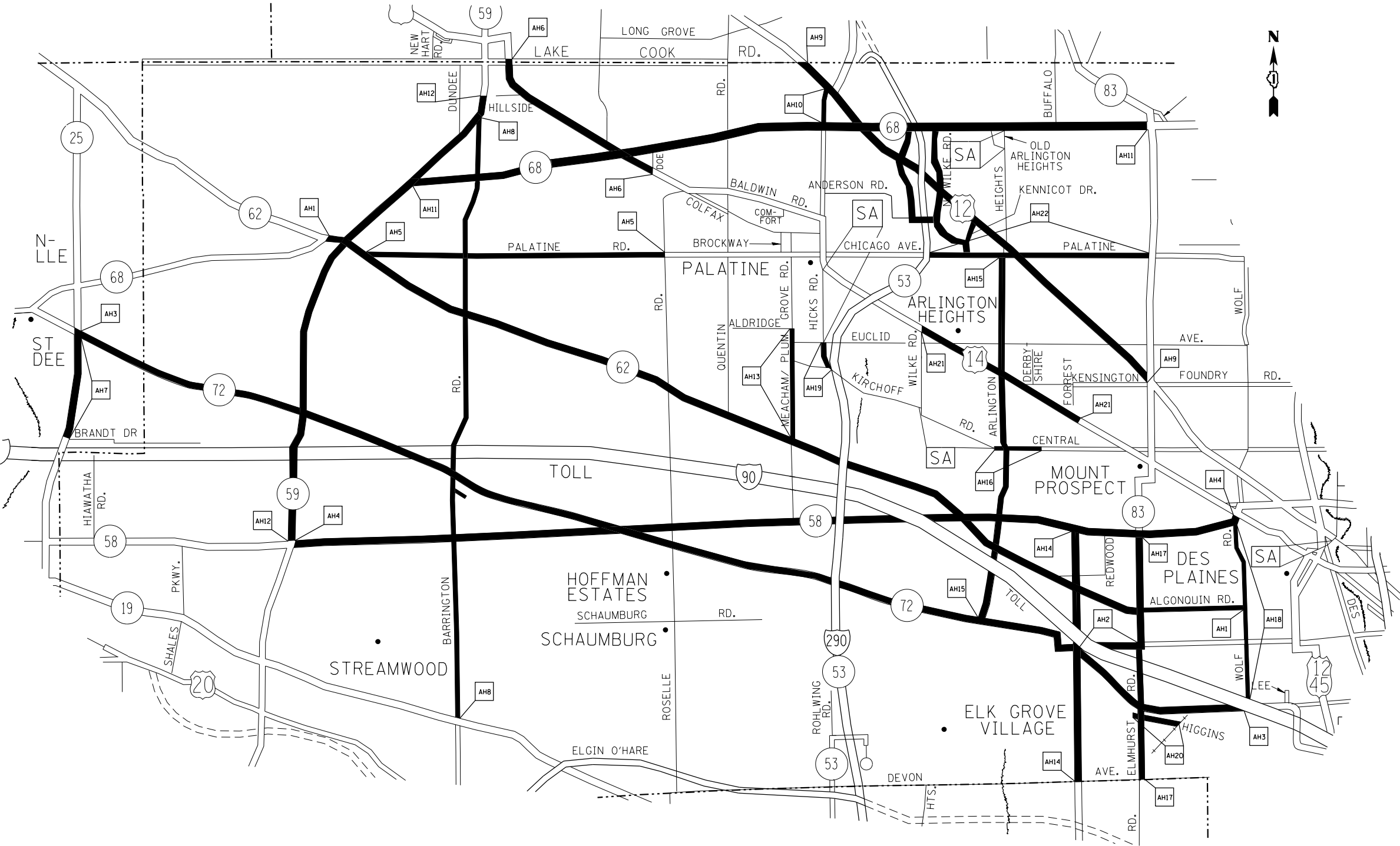

TEAM SECTION ARLINGTON HTS. KEY LOCATIONS AH1-AH22

NOTE:
KEY LOCATION *AH5 INCLUDES IL 53 FRONTAGE RDS. AS DEFINED IN THE SPECIAL PROVISIONS

- DISTRICT NO. 1
- STATE HIGHWAYS & EXPRESSWAYS WITHIN STATE JURISDICTION (EXCEPT TOLLWAYS)
 - STATE HIGHWAYS & EXPRESSWAYS TO BE CLEANED
 - - - FUTURE HIGHWAYS
 - VARIOUS AGENCIES HIGHWAYS

PLOT DATE = 7/9/2013
FILE NAME = c:\pwork\arlington\mud\p01361818A\SweepingContract2009.dgn
PLOT SCALE = 1/8"=1'-0"
USER NAME = midup

REVISIONS	
NAME	DATE

ILLINOIS DEPARTMENT OF TRANSPORTATION
ARTERIAL CLEANING LOCATION MAP
COOK COUNTY
ARLINGTON HTS TEAM SECTION

SCALE: VERT. / HORIZ.
DATE

DRAWN BY / CHECKED BY

F.A. RTE.	SECTION	COUNTY	TOTAL SHEETS	SHEET NO.
VAR.	2013-027-1	*	26	15
STA.		TO STA.		
FED. ROAD DIST. NO.	ILLINOIS	FED. AID PROJECT		

* COOK, DU PAGE, KANE, LAKE, MC HENRY AND WILL



TEAM SECTION	KEY LOCATIONS
NORTHBROOK	NB1-NB50

- DISTRICT NO. 1
- STATE HIGHWAYS & EXPRESSWAYS WITHIN STATE JURISDICTION (EXCEPT TOLLWAYS)
 - STATE HIGHWAYS & EXPRESSWAYS TO BE CLEANED
 - - - FUTURE HIGHWAYS
 - VARIOUS AGENCIES HIGHWAYS

REVISIONS	
NAME	DATE

ILLINOIS DEPARTMENT OF TRANSPORTATION

ARTERIAL CLEANING
LOCATION MAP
COOK COUNTY
NORTHBROOK TEAM SECTION

SCALE: VERT. / HORIZ.
DATE

DRAWN BY
CHECKED BY

PLOT DATE = 7/9/2013
FILE NAME = c:\pwork\ar\pwork\midj\midj\0136184\SweepingContr.ctb
PLOT SCALE = 1/8" = 100'
USER NAME = midjup

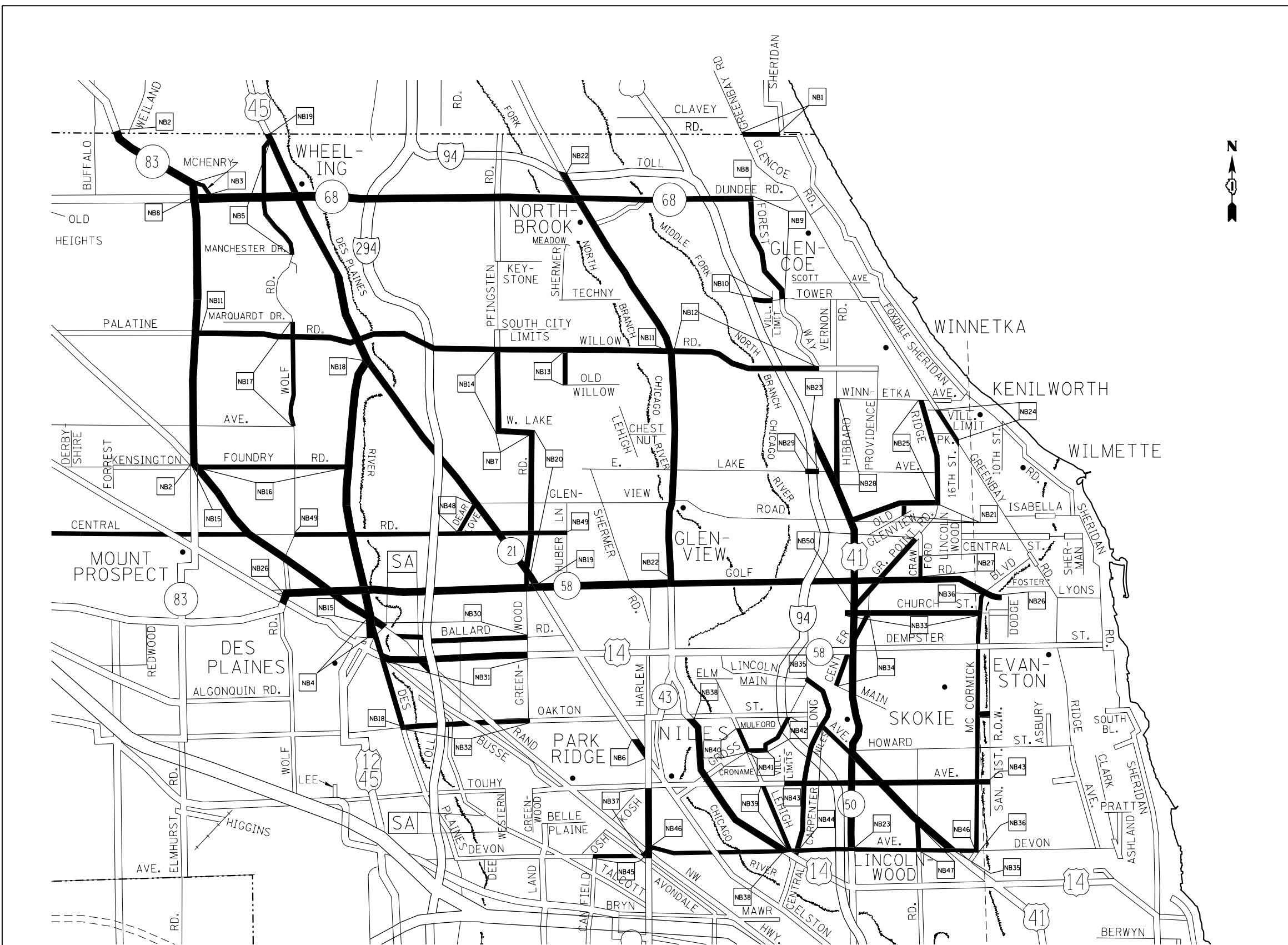

F.A. RTE.	SECTION	COUNTY	TOTAL SHEETS	SHEET NO.
VAR.	2013-027-1	*	26	16
STA.		TO STA.		
FED. ROAD DIST. NO.	ILLINOIS	FED. AID PROJECT		

* COOK, DU PAGE, KANE, LAKE, MC HENRY AND WILL

TEAM SECTION
NORTHSIDE

KEY LOCATIONS
NS1-NS42

- DISTRICT NO. 1
- STATE HIGHWAYS & EXPRESSWAYS WITHIN STATE JURISDICTION (EXCEPT TOLLWAYS)
 - STATE HIGHWAYS & EXPRESSWAYS TO BE CLEANED
 - - - FUTURE HIGHWAYS
 - VARIOUS AGENCIES HIGHWAYS

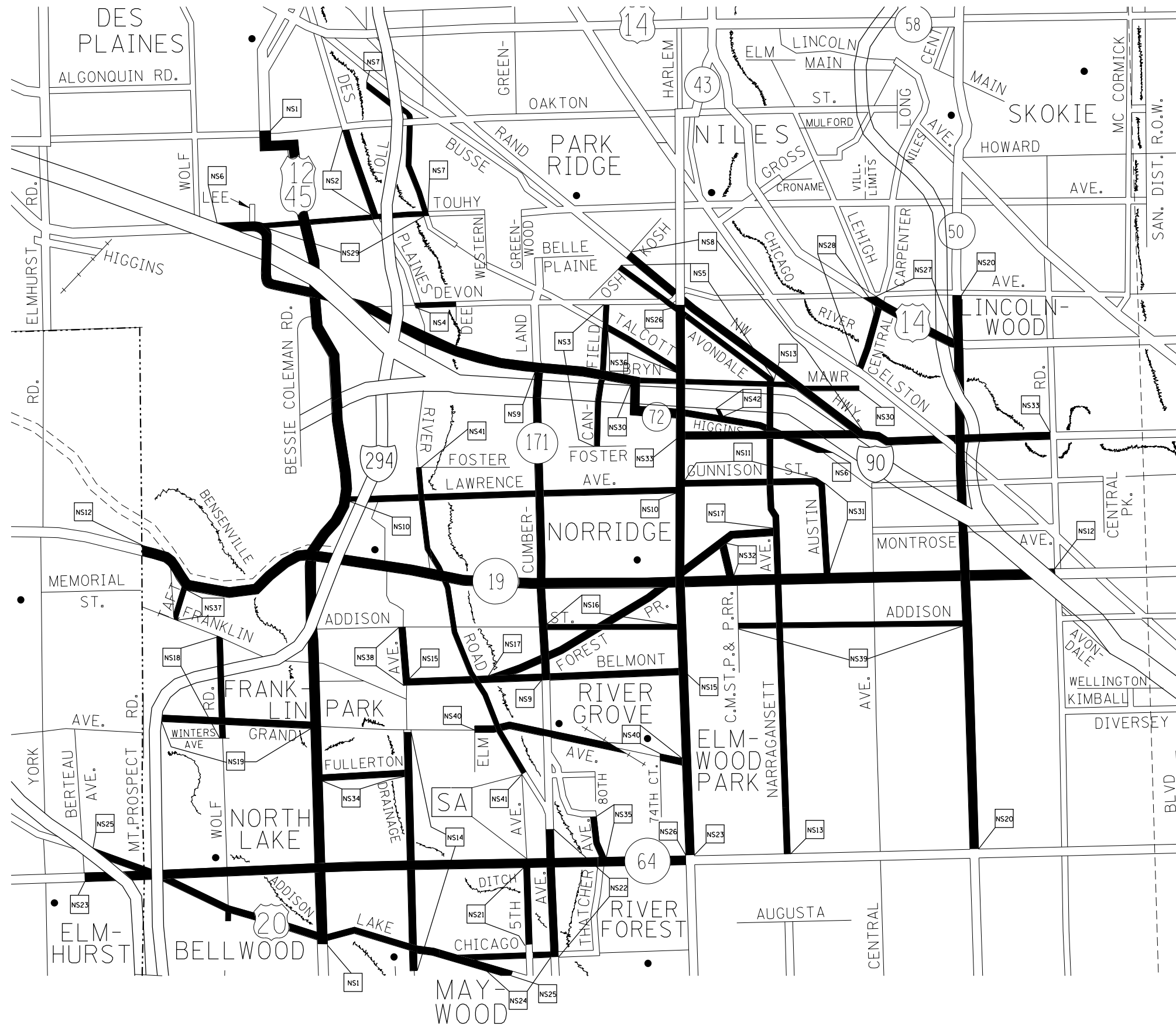

PLOT DATE = 7/9/2013
 FILE NAME = c:\pwork\pwork\mod\mod\0136184\SweepingContr.ctb
 PLOT SCALE = 1/8"=1'-0"
 USER NAME = midup

REVISIONS	
NAME	DATE

ILLINOIS DEPARTMENT OF TRANSPORTATION

ARTERIAL CLEANING
LOCATION MAP
COOK COUNTY NORTH
NORTHSIDE TEAM SECTION

SCALE: VERT. / HORIZ.
DATE

DRAWN BY
CHECKED BY

F.A. RTE.	SECTION	COUNTY	TOTAL SHEETS	SHEET NO.
VAR.	2013-027-1	*	26	17
STA.		TO STA.		
FED. ROAD DIST. NO.	ILLINOIS	FED. AID PROJECT		

* COOK, DU PAGE, KANE, LAKE, MC HENRY AND WILL

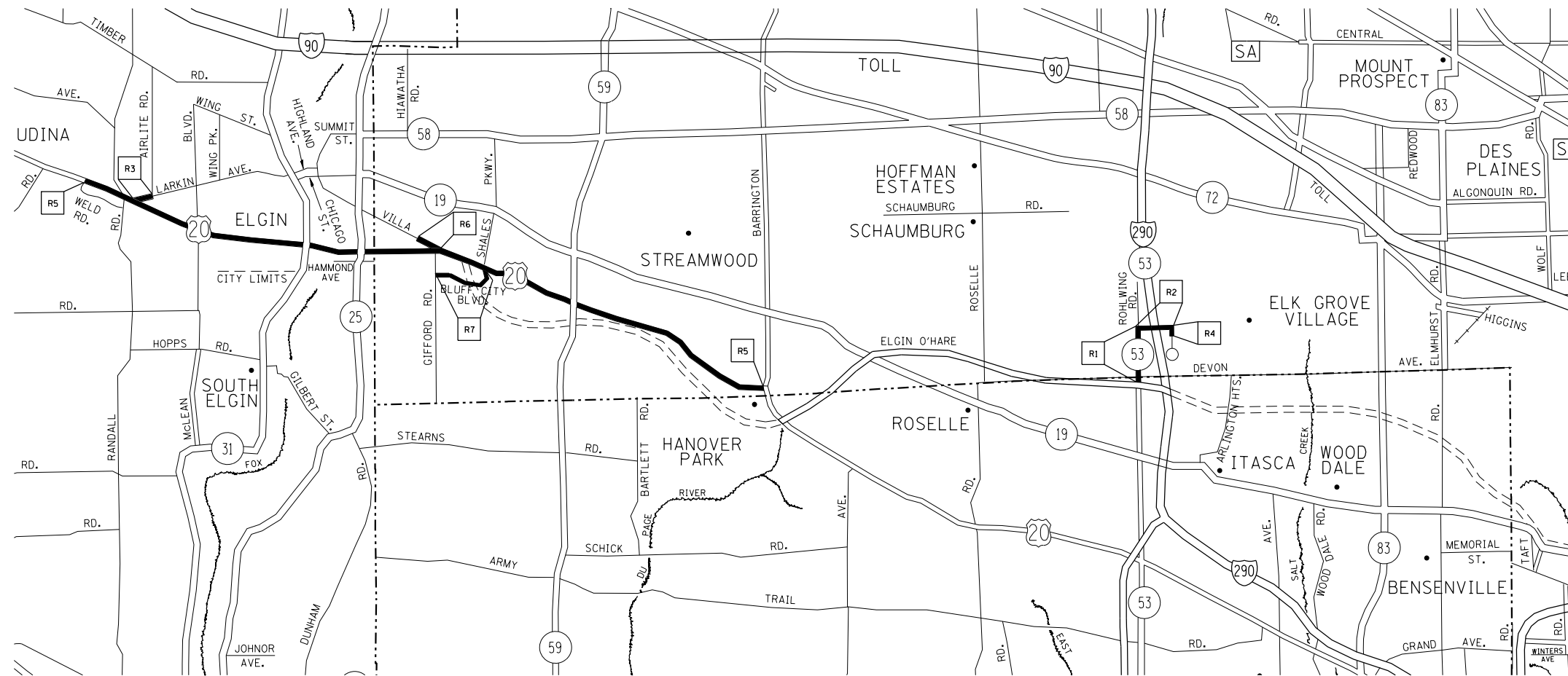

TEAM SECTION RODENBURG KEY LOCATIONS R1-R7

- DISTRICT NO. 1
- STATE HIGHWAYS & EXPRESSWAYS WITHIN STATE JURISDICTION (EXCEPT TOLLWAYS)
 - STATE HIGHWAYS & EXPRESSWAYS TO BE CLEANED
 - - - FUTURE HIGHWAYS
 - VARIOUS AGENCIES HIGHWAYS

REVISIONS	
NAME	DATE

ILLINOIS DEPARTMENT OF TRANSPORTATION

ARTERIAL CLEANING
LOCATION MAP
COOK COUNTY
RODENBURG TEAM SECTION

SCALE: VERT. DRAWN BY
 HORIZ. CHECKED BY
DATE

PLOT DATE = 7/9/2013
FILE NAME = c:\pwworkspace\mudje\0136184\SweepingContract2009.dgn
PLOT SCALE = 1/8"=1'-0"
USER NAME = mudje

F.A. RTE.	SECTION	COUNTY	TOTAL SHEETS	SHEET NO.
VAR.	2013-027-1	*	26	18
STA.		TO STA.		
FED. ROAD DIST. NO.	ILLINOIS	FED. AID PROJECT		

* COOK, DU PAGE, KANE, LAKE, MC HENRY AND WILL

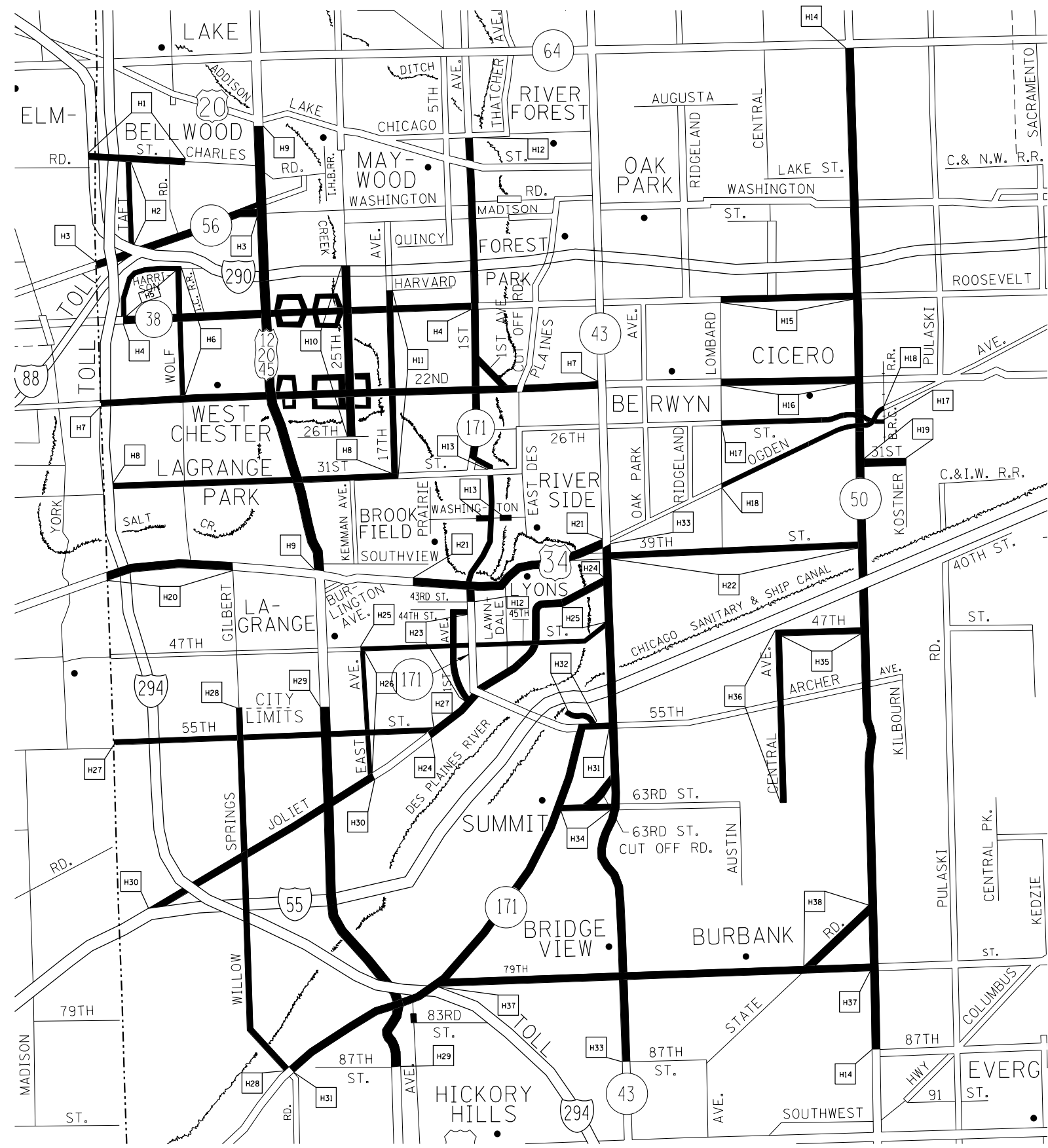

TEAM SECTION	KEY LOCATIONS
HILLSIDE	H1-H38

- DISTRICT NO. 1
- STATE HIGHWAYS & EXPRESSWAYS WITHIN STATE JURISDICTION (EXCEPT TOLLWAYS)
 - STATE HIGHWAYS & EXPRESSWAYS TO BE CLEANED
 - FUTURE HIGHWAYS
 - VARIOUS AGENCIES HIGHWAYS

PLOT DATE = 7/9/2013
 FILE NAME = c:\pwork\ar\pwork\mud\p\0136184\SweepingContract2009.dgn
 PLOT SCALE = 1/85,8824 / in.
 USER NAME = midup

REVISIONS	
NAME	DATE

ILLINOIS DEPARTMENT OF TRANSPORTATION
ARTERIAL CLEANING LOCATION MAP
 COOK COUNTY
 HILLSIDE TEAM SECTION

SCALE: VERT. / HORIZ.
 DATE

DRAWN BY
 CHECKED BY

F.A. RTE.	SECTION	COUNTY	TOTAL SHEETS	SHEET NO.
VAR.	2013-027-1	*	26	19
STA.	TO STA.			
FED. ROAD DIST. NO.	ILLINOIS	FED. AID PROJECT		

* COOK, DU PAGE, KANE, LAKE, MC HENRY AND WILL

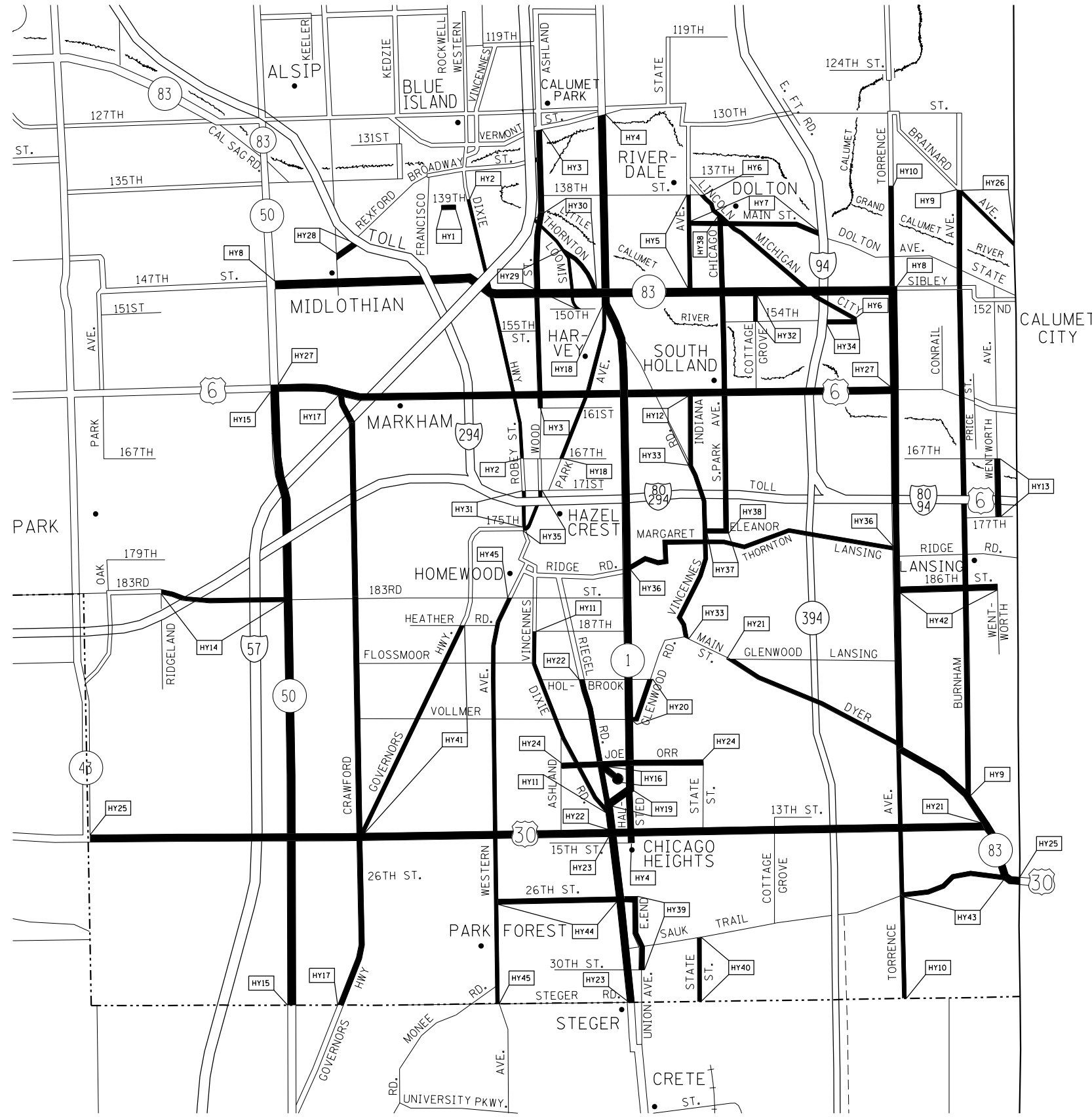

TEAM SECTION	KEY LOCATIONS
HARVEY	HY1-HY45

- DISTRICT NO. 1
- STATE HIGHWAYS & EXPRESSWAYS WITHIN STATE JURISDICTION (EXCEPT TOLLWAYS)
 - STATE HIGHWAYS & EXPRESSWAYS TO BE CLEANED
 - - - FUTURE HIGHWAYS
 - VARIOUS AGENCIES HIGHWAYS

REVISIONS	
NAME	DATE

ILLINOIS DEPARTMENT OF TRANSPORTATION

ARTERIAL CLEANING
LOCATION MAP
COOK COUNTY
HARVEY TEAM SECTION

SCALE: VERT. / HORIZ.
DATE

DRAWN BY
CHECKED BY

PLOT DATE = 7/9/2013
FILE NAME = c:\pwworkspace\mudjo\0136184\Sheeting\Contr.ctb
PLOT SCALE = 1/8" = 100'
USER NAME = midjup

F.A. RTE.	SECTION	COUNTY	TOTAL SHEETS	SHEET NO.
VAR.	2013-027-1	*	26	20
STA.		TO STA.		
FED. ROAD DIST. NO.	ILLINOIS	FED. AID PROJECT		

* COOK, DU PAGE, KANE, LAKE, MC HENRY AND WILL

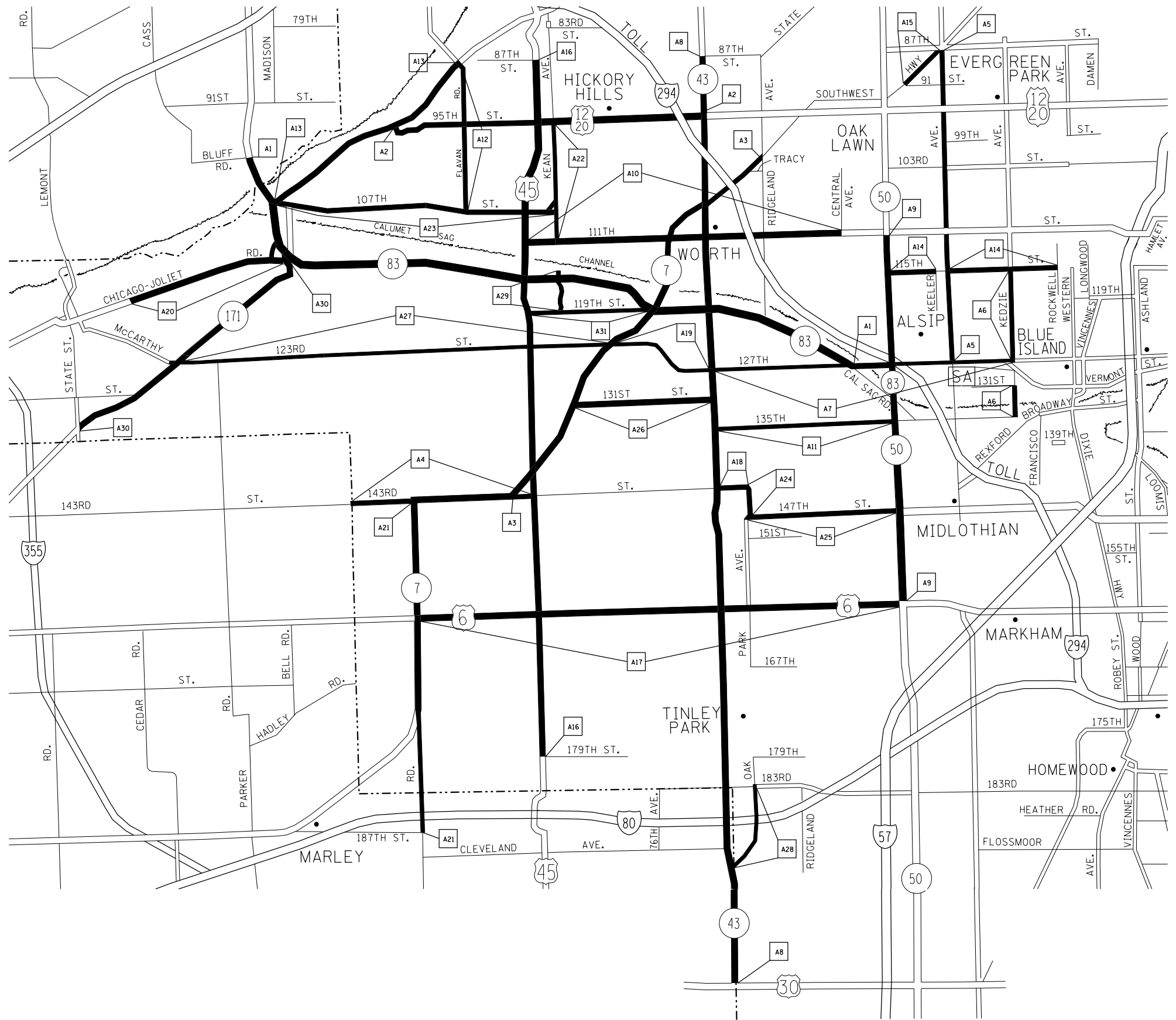

TEAM SECTION	KEY LOCATIONS
ALSIP	A1-A31

- DISTRICT NO. 1
- STATE HIGHWAYS & EXPRESSWAYS WITHIN STATE JURISDICTION (EXCEPT TOLLWAYS)
 - STATE HIGHWAYS & EXPRESSWAYS TO BE CLEANED
 - FUTURE HIGHWAYS
 - VARIOUS AGENCIES HIGHWAYS

REVISIONS	
NAME	DATE

ILLINOIS DEPARTMENT OF TRANSPORTATION

ARTERIAL CLEANING
LOCATION MAP
COOK COUNTY
ALSIP TEAM SECTION

SCALE: VERT. DATE HORIZ. DATE

DRAWN BY CHECKED BY

PLOT DATE = 7/9/2013
FILE NAME = c:\p\work\pavado\mudjo\0136184\SweepingContr.ctb2009.dgn
PLOT SCALE = 1/8"=1'-0"
USER NAME = midjup

F.A. RTE.	SECTION	COUNTY	TOTAL SHEETS	SHEET NO.
VAR.	2013-027-1	*	26	21
STA.		TO STA.		
FED. ROAD DIST. NO.	ILLINOIS	FED. AID PROJECT		

* COOK, DU PAGE, KANE, LAKE, MC HENRY AND WILL

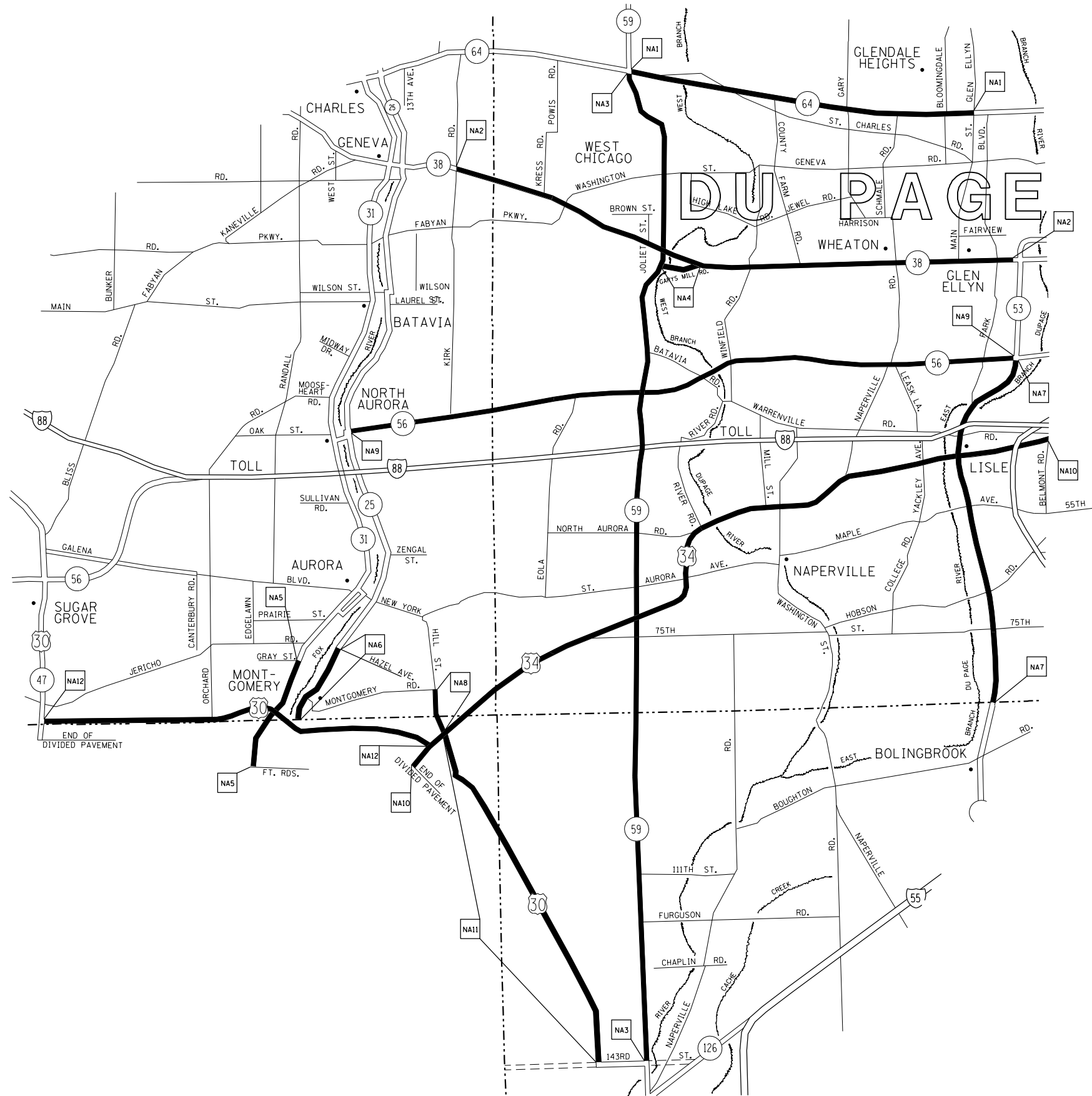

TEAM SECTION
NAPERVILLE

KEY LOCATIONS
NA1-NA12

- DISTRICT NO. 1
- STATE HIGHWAYS & EXPRESSWAYS WITHIN STATE JURISDICTION (EXCEPT TOLLWAYS)
 - STATE HIGHWAYS & EXPRESSWAYS TO BE CLEANED
 - - - FUTURE HIGHWAYS
 - VARIOUS AGENCIES HIGHWAYS

REVISIONS	
NAME	DATE

ILLINOIS DEPARTMENT OF TRANSPORTATION

ARTERIAL CLEANING
LOCATION MAP
DU PAGE COUNTY
NAPERVILLE TEAM SECTION

SCALE: VERT. _____
HORIZ. _____

DATE _____

DRAWN BY _____
CHECKED BY _____

PLOT DATE = 7/9/2013
FILE NAME = c:\pwork\pwork\pwork\mdu\p6136184\SweepingContrac2009.dgn
PLOT SCALE = 1/8"=1'-0"
USER NAME = midup

F.A. RTE.	SECTION	COUNTY	TOTAL SHEETS	SHEET NO.
VAR.	2013-027-1	*	26	22
STA.		TO STA.		
FED. ROAD DIST. NO.	ILLINOIS	FED. AID PROJECT		

* COOK, DU PAGE, KANE, LAKE, MC HENRY AND WILL



TEAM SECTION	KEY LOCATIONS
OAKBROOK	OBI1-OBI13

- DISTRICT NO. 1
- STATE HIGHWAYS & EXPRESSWAYS WITHIN STATE JURISDICTION (EXCEPT TOLLWAYS)
 - STATE HIGHWAYS & EXPRESSWAYS TO BE CLEANED
 - - - FUTURE HIGHWAYS
 - VARIOUS AGENCIES HIGHWAYS

REVISIONS	
NAME	DATE

ILLINOIS DEPARTMENT OF TRANSPORTATION

ARTERIAL CLEANING
LOCATION MAP
DU PAGE COUNTY
OAKBROOK TEAM SECTION

SCALE: VERT. / HORIZ.
DATE

DRAWN BY / CHECKED BY

PLOT DATE = 7/9/2013
FILE NAME = c:\pwork\pwork\mudjo\013618184\SweepingContract2009.dgn
PLOT SCALE = 1/8"=1'-0"
USER NAME = midup

F.A. RTE.	SECTION	COUNTY	TOTAL SHEETS	SHEET NO.
VAR.	2013-027-1	*	26	24
STA.		TO STA.		
FED. ROAD DIST. NO.	ILLINOIS	FED. AID PROJECT		

* COOK, DU PAGE, KANE, LAKE, MC HENRY AND WILL

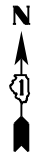

TEAM SECTION	KEY LOCATIONS
NEW LENOX	NL1 - NL19

- DISTRICT NO. 1
- STATE HIGHWAYS & EXPRESSWAYS WITHIN STATE JURISDICTION (EXCEPT TOLLWAYS)
 - STATE HIGHWAYS & EXPRESSWAYS TO BE CLEANED
 - - - FUTURE HIGHWAYS
 - VARIOUS AGENCIES HIGHWAYS

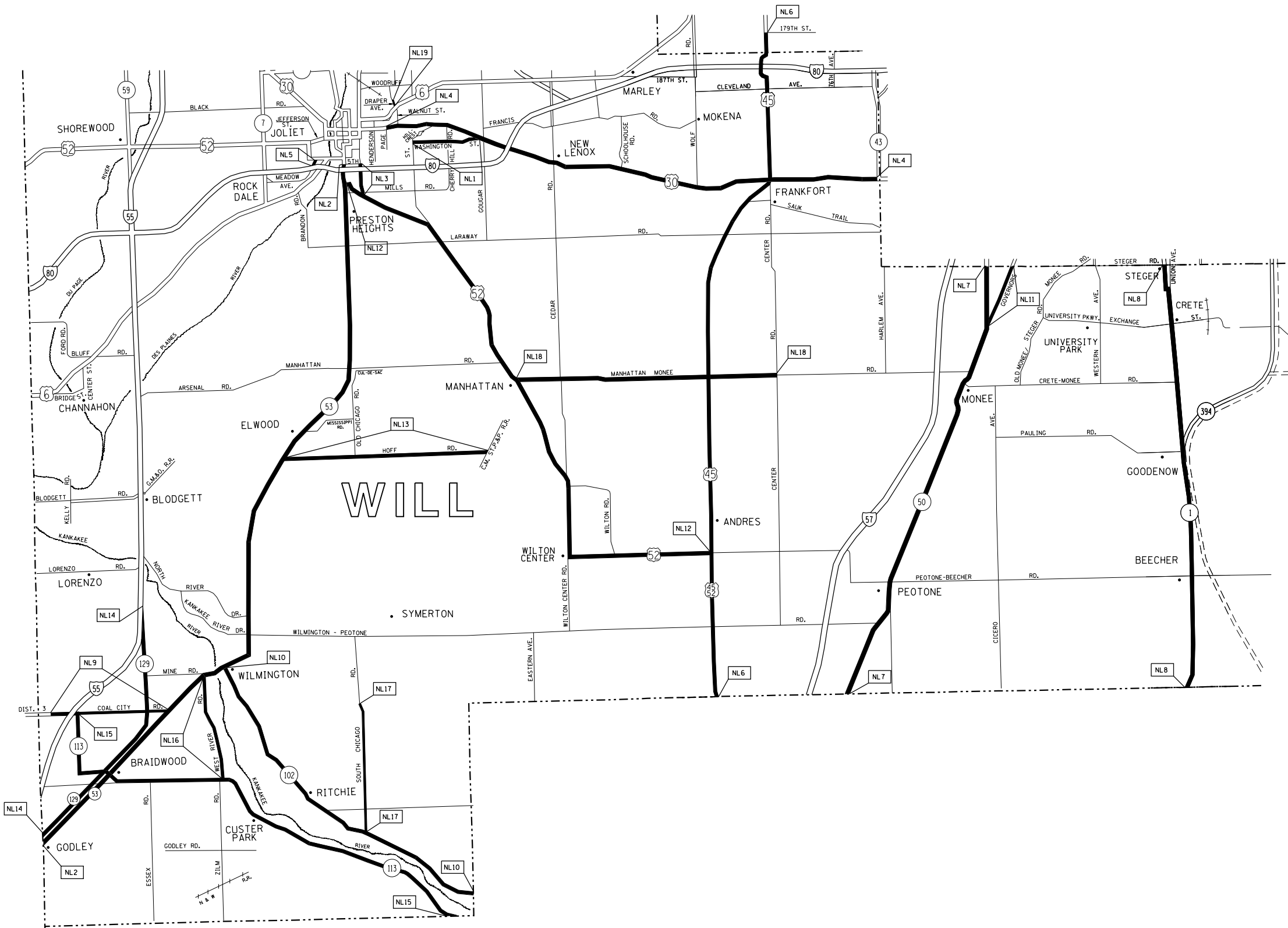

PLOT DATE = 7/9/2013
 FILE NAME = c:\pwork\pwork\mud\je\013618184\SweepingContr.ac22009.dgn
 PLOT SCALE = 1:100,000
 USER NAME = midup

REVISIONS	
NAME	DATE

ILLINOIS DEPARTMENT OF TRANSPORTATION

ARTERIAL CLEANING
 LOCATION MAP
 WILL COUNTY
 NEW LENOX TEAM SECTION

SCALE: VERT. / HORIZ.
 DATE

DRAWN BY / CHECKED BY

PARTIAL RAMP CLOSURE DETAILS

SHOULDER CLOSURE DETAILS

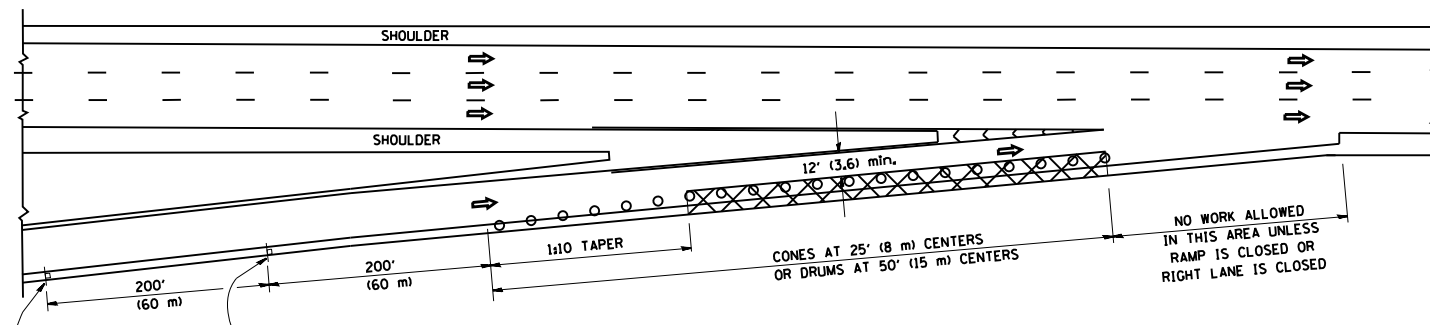

TYPICAL ENTRANCE RAMP

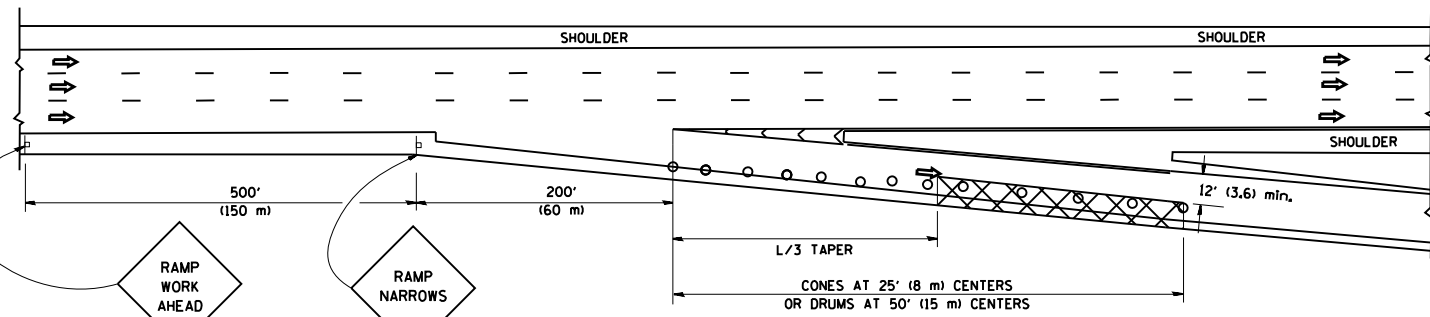

TYPICAL EXIT RAMP

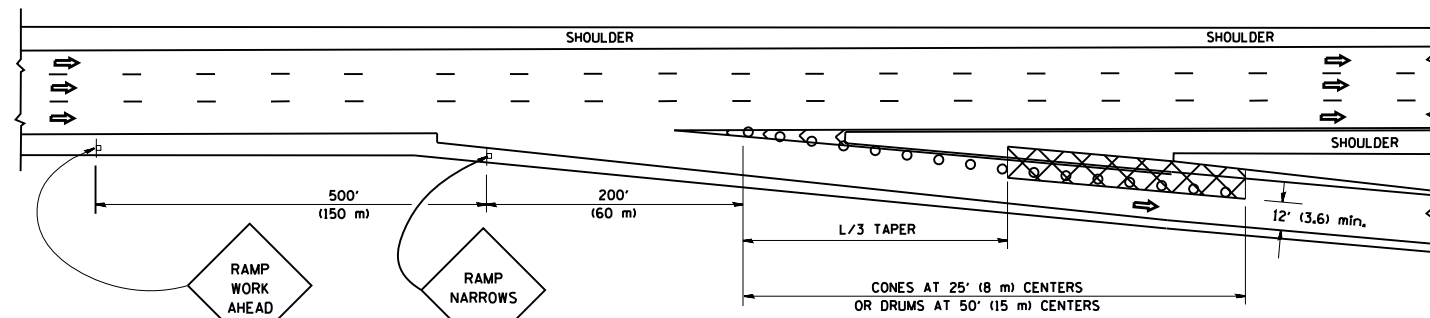

TYPICAL EXIT RAMP

SYMBOLS

- ACTIVE WORK AREA
- SIGN ON PORTABLE OR PERMANENT SUPPORT
- FLAGGER WITH CONTROL SIGN
- TYPE II BARRICADE, DRUM OR VERTICAL BARRICADE WITH STEADY BURN MONO-DIRECTIONAL LIGHT
- CONE, DRUM OR BARRICADE

GENERAL NOTES

1. THE "L" DISTANCE EQUALS:

SPEED LIMIT	FORMULAS
45 mph (80 km/h) OR GREATER:	METRIC ENGLISH
	$L=0.65(WXS)$ $L=(WXS)$

W = WIDTH OF OFFSET IN FEET (METERS)
S = NORMAL POSTED SPEED MPH (KM/H)
2. PLASTIC DRUMS WITH HIGH PERFORMANCE REFLECTIVE SHEETING AND STEADY BURNING LIGHTS ARE REQUIRED FOR ALL NIGHTIME CLOSURES.
3. ALL SIGNS SHALL BE POST MOUNTED IF THE CLOSURE TIME EXCEEDS FOUR DAYS.
4. FLASHING LIGHTS SHALL BE USED DURING THE HOURS OF DARKNESS AND SHALL BE INSTALLED ABOVE THE FIRST TWO SETS OF SIGNS.

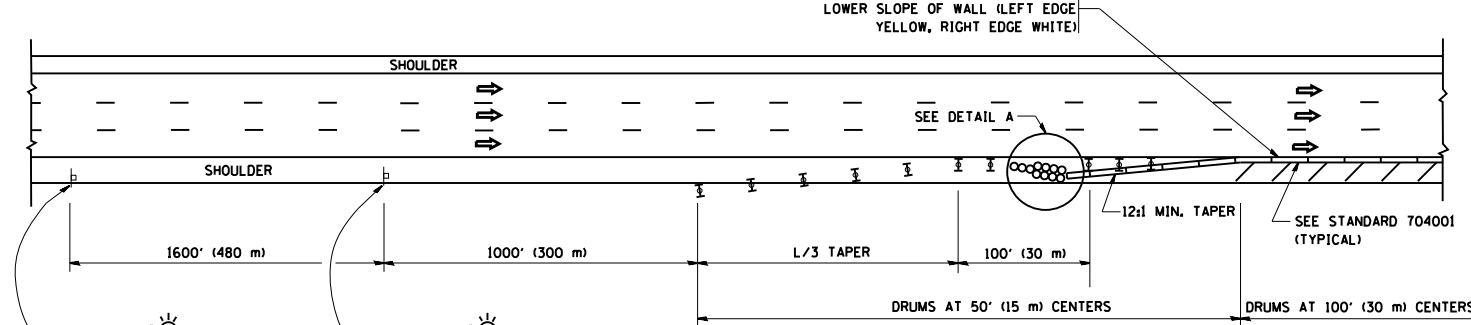

PERMANENT SHOULDER CLOSURE

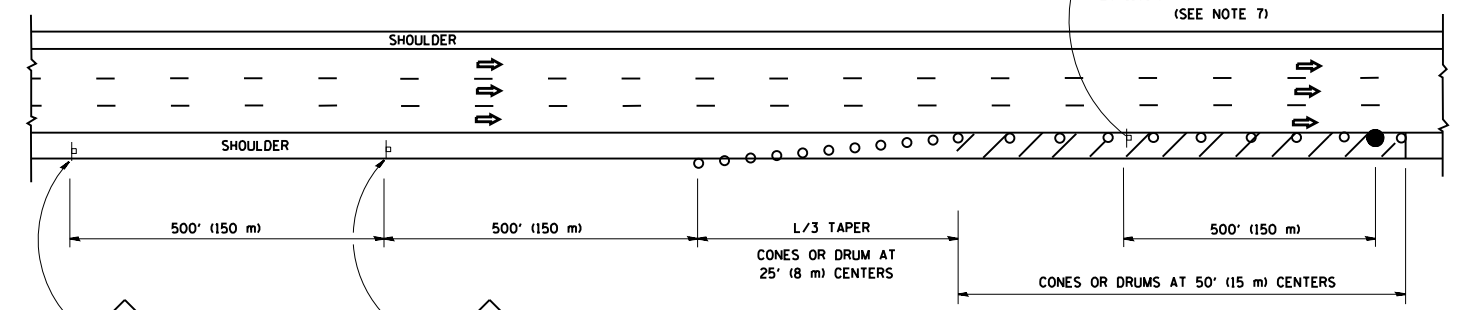

DAYTIME SHOULDER CLOSURE

THIS DETAIL IS USED WHERE:
1. VEHICLES, EQUIPMENT, WORKERS OR THEIR ACTIVITIES ENCROACH IN AN AREA CLOSER THAN 15' (4.5 m) TO THE EDGE OF PAVEMENT FOR A PERIOD IN EXCESS OF 15 MINUTES.

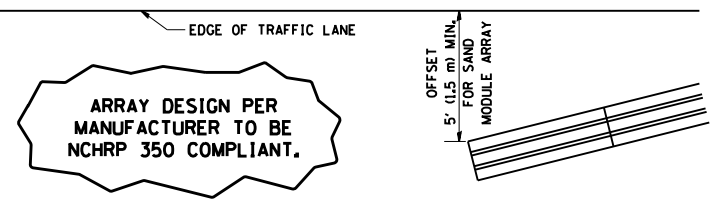

**DETAIL "A"
IMPACT ATTENUATOR, TEMPORARY
(SEE NOTE 5)**

5. THE IMPACT ATTENUATOR, TEMPORARY IS NOT REQUIRED WHEN THE TEMPORARY CONCRETE BARRIER WALL IS PROTECTED BY OR IS TIED INTO THE EXISTING GUARDRAIL. IF OFFSET IS LESS THAN 5 FEET USE NARROW USE TYPE DEVICE TO MEET NCHRP350.
6. AUTHORIZATION FROM THE DISTRICT'S BUREAU OF TRAFFIC IS REQUIRED FOR ALL FREEWAY CLOSURES.
7. THE FLAGGER AND FLAGGER SIGN ARE REQUIRED AT THE ABOVE WORK SITES WHEN:
 - a. FOUR OR MORE WORK VEHICLES ENTER THE TRAFFIC LANES IN A ONE HOUR PERIOD.
 - b. THE WORK ACTIVITY REQUIRES FREQUENT ENCROACHMENT INTO THE LANE OPEN TO TRAFFIC.

THE FLAGGER SHALL BE STATIONED APPROXIMATELY 100' (30 m) TO 200' (60 m) IN ADVANCE OF THE WORKERS.

ALL DIMENSIONS ARE IN INCHES (MILLIMETERS) UNLESS OTHERWISE SHOWN.

FILE NAME =	USER NAME = midyja	DESIGNED -	REVISED - 04-03	STATE OF ILLINOIS DEPARTMENT OF TRANSPORTATION	TRAFFIC CONTROL DETAILS FOR FREEWAY SHOULDER CLOSURES AND PARTIAL RAMP CLOSURES			F.A. RTE.	SECTION	COUNTY	TOTAL SHEETS	SHEET NO.	
et:\pw\work\p1dot\midyja\dms92836\DistStd.dgn		DRAWN - D.W.S.	REVISED - J.A.F. 12-06		SCALE: NONE	SHEET NO. 1 OF 1 SHEETS	STA.	TO STA.	VAR.	2013-027-1	VARIOUS	26	26
PLOT SCALE = 100.0000' / 1"		CHECKED -	REVISED - S.P.B. 01-07						TC-17		CONTRACT NO. 60W62		
PLOT DATE = 7/10/2013		DATE - 11-96	REVISED - S.P.B. 12-09						FED. ROAD DIST. NO. 1	ILLINOIS	FED. AID PROJECT		