

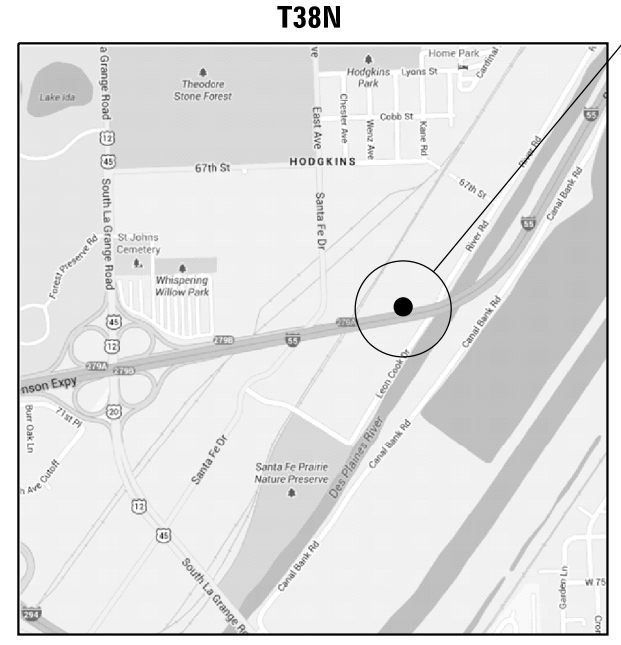

R12E



**LOCATION 8: I-55 (STEVENSON EXPRESSWAY), WB**  
 0.69 MILES EAST OF LAGRANGE RD. OVERPASS, RIGHT SIDE

**VILLAGE OF HODGKINS  
 LYONS TOWNSHIP  
 COOK COUNTY**

**BILL OF MATERIAL**

| ITEM               | UNIT     | QUANTITY |
|--------------------|----------|----------|
| CONCRETE REMOVAL   | Cu. Yds. | 1.8      |
| CONCRETE STRUCTURE | Cu. Yds. | 2.4      |
| TIE BARS           | Each     | 13       |
| SAW CUTS           | Foot     | 7        |
| PROTECTIVE COAT    | Sq. Yds. | 8.3      |
|                    |          |          |
|                    |          |          |

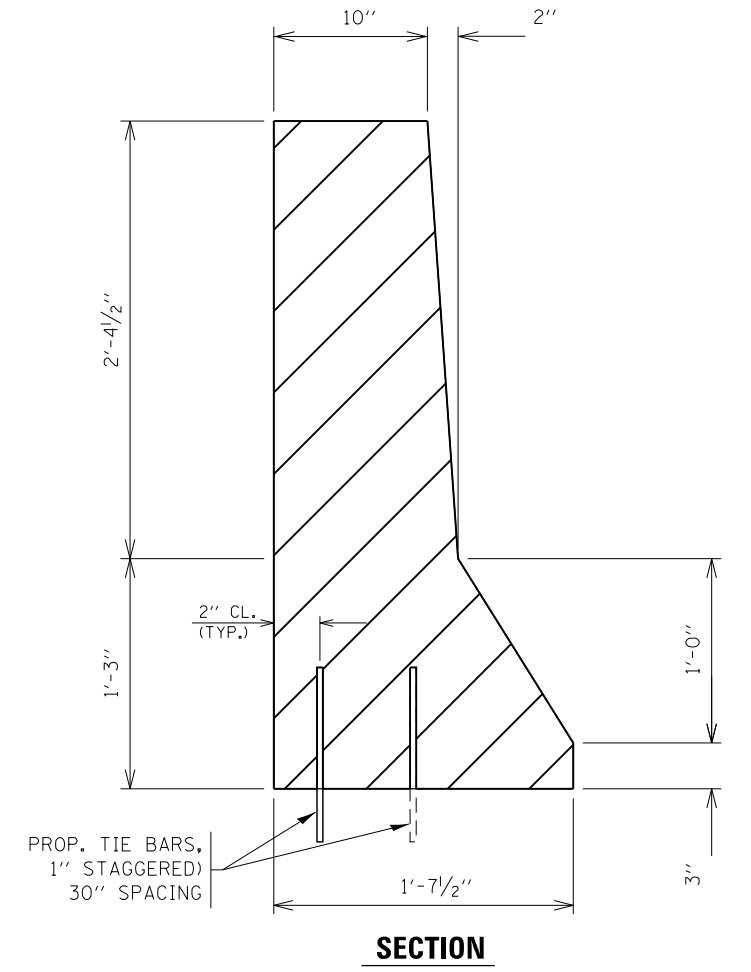

FULL DEPTH REPAIR  
 REPLACE 16' OF BARRIER WALL  
 FOR MORE DETAILS, SEE SHEET #5

**TRAFFIC DATA:**  
 SPEED LIMIT: 55 MPH  
 2012 ADT: 146900

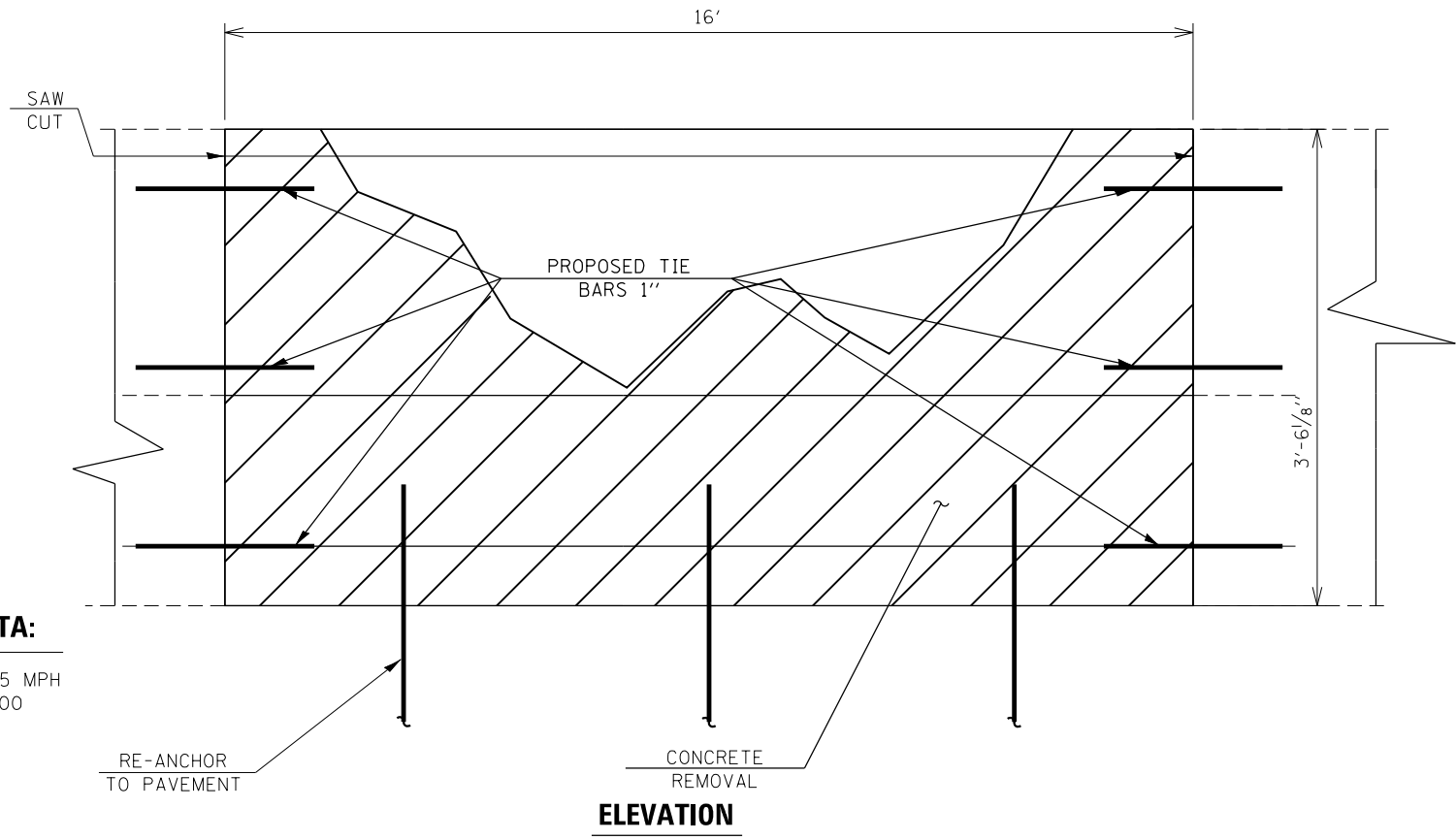

|  |                                |            |           |
|--|--------------------------------|------------|-----------|
| FILE NAME =  | USER NAME = SEYMORECP          | DESIGNED - | REVISED - |
| et:\pw\work\p\dot\seymorecp\d0348982\0189013-sh-t-plan.dgn |                                | DRAWN -    | REVISED - |
| Default  | PLOT SCALE = 100.0000' / 1\"/> |            |           |
|  | PLOT DATE = 7/11/2013          | CHECKED -  | REVISED - |
|  |                                | DATE -     | REVISED - |

**STATE OF ILLINOIS  
 DEPARTMENT OF TRANSPORTATION**

|                                    |       |           |              |
|------------------------------------|-------|-----------|--------------|
| <b>LOCATION 8</b>                  |       |           |              |
| <b>I-55 (STEVENSON EXPRESSWAY)</b> |       |           |              |
| SCALE:                             | SHEET | OF SHEETS | STA. TO STA. |

|                           |           |         |                    |           |
|---------------------------|-----------|---------|--------------------|-----------|
| F.A. RTE.                 | SECTION   | COUNTY  | TOTAL SHEETS       | SHEET NO. |
| VAR.                      | 2013-0411 | VARIOUS | 44                 | 22        |
|                           |           |         | CONTRACT NO. 60W86 |           |
| ILLINOIS FED. AID PROJECT |           |         |                    |           |