

EXISTING HORIZONTAL & VERTICAL CONTROL

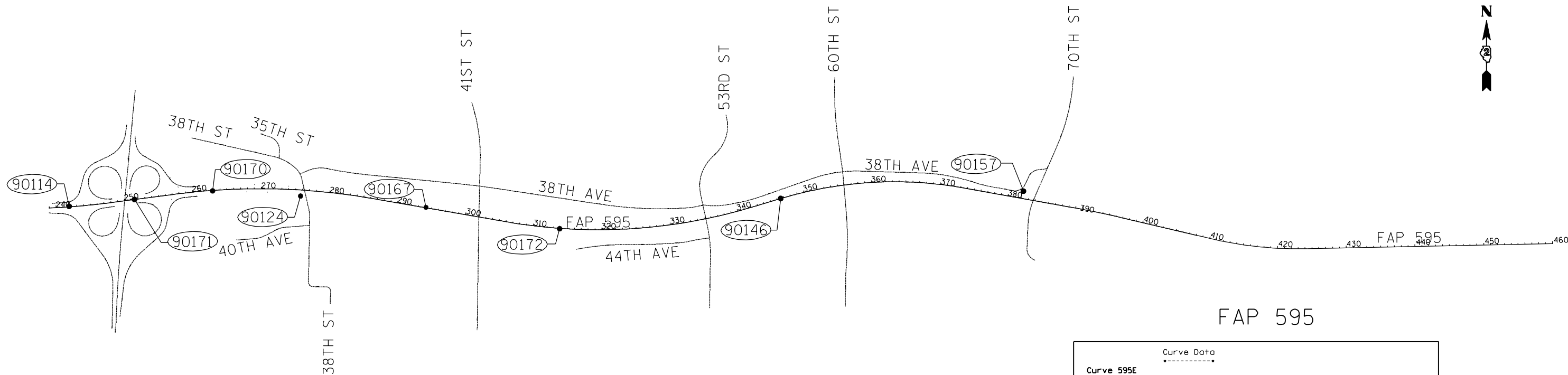

FAP 595

FAP 595

Chain FAP595 contains:
1 CUR 595A CUR 595B CUR 595C CUR 595D CUR 595E CUR 1850 CUR 1860 91

Beginning chain FAP595 description

Point 1 N 1,750,098.2544 E 2,202,280.5463 Sta 205+77.54

Course from 1 to PC 595A S 89° 33' 57.68" E Dist 19.8706'

Curve Data

Curve 595C
P.I. Station 271+73.85 N 1,750,366.6497 E 2,208,848.7994
Delta = 17° 25' 50.99" (RT)
Degree = 0° 35' 59.99"
Tangent = 1,463.8838'
Length = 2,905.1515'
Radius = 9,549.3400'
External = 111.5528'
Long Chord = 2,893.9611'
Mid. Ord. = 110.2647'
P.C. Station 257+09.97 N 1,750,173.7265 E 2,207,397.6839
P.T. Station 286+15.12 N 1,750,116.0259 E 2,210,291.0696
C.C. N 1,740,707.6773 E 2,208,656.1779

Course from PT 595C to PC 595D S 80° 08' 31.67" E Dist 1,987.2744'

Curve Data

Curve 595D
P.I. Station 324+35.80 N 1,749,461.9072 E 2,214,055.3415
Delta = 26° 26' 35.68" (LT)
Degree = 0° 44' 03.23"
Tangent = 1,833.4080'
Length = 3,601.4971'
Radius = 7,803.5277'
External = 212.4831'
Long Chord = 3,569.6184'
Mid. Ord. = 206.8508'
P.C. Station 306+02.40 N 1,749,775.7952 E 2,212,249.0029
P.T. Station 342+03.89 N 1,749,985.2420 E 2,215,812.4714
C.C. N 1,757,464.1076 E 2,213,585.0034

Course from PT 595D to PC 595E N 73° 24' 52.65" E Dist 472.1001'

Curve Data

Curve 595E
P.I. Station 360+41.64 N 1,750,509.8156 E 2,217,573.7607
Delta = 26° 48' 45.60" (RT)
Degree = 1° 00' 00.00"
Tangent = 1,365.6478'
Length = 2,681.2676'
Radius = 5,729.5800'
External = 160.5033'
Long Chord = 2,656.8685'
Mid. Ord. = 156.1296'
P.C. Station 346+75.99 N 1,750,120.0000 E 2,216,264.9301
P.T. Station 373+57.26 N 1,750,267.3400 E 2,218,917.7099
C.C. N 1,744,628.7965 E 2,217,900.4027

Course from PT 595E to PC 1850 S 79° 46' 21.75" E Dist 1,613.2909'

Curve Data

Curve 1850
P.I. Station 393+18.78 N 1,749,919.0659 E 2,220,848.0599
Delta = 3° 01' 34.26" (RT)
Degree = 0° 26' 04.62"
Tangent = 348.2254'
Length = 696.2888'
Radius = 13,183.0744'
External = 4.5983'
Long Chord = 696.2079'
Mid. Ord. = 4.5967'
P.C. Station 389+70.55 N 1,749,980.8945 E 2,220,505.3674
P.T. Station 396+66.84 N 1,749,839.2319 E 2,221,187.0104
C.C. N 1,737,007.2840 E 2,218,164.6659

Course from PT 1850 to PC 1860 S 76° 44' 47.48" E Dist 1,327.8899'

Curve Data

Curve 1860
P.I. Station 417+18.13 N 1,749,368.9551 E 2,223,183.6615
Delta = 14° 28' 28.67" (LT)
Degree = 1° 00' 20.95"
Tangent = 723.3964'
Length = 1,439.0899'
Radius = 5,696.4344'
External = 45.7487'
Long Chord = 1,435.2661'
Mid. Ord. = 45.3843'
P.C. Station 409+94.73 N 1,749,534.8006 E 2,222,479.5324
P.T. Station 424+33.82 N 1,749,384.3718 E 2,223,906.8936
C.C. N 1,755,079.5124 E 2,223,785.4939

Course from PT 1860 to 91 N 88° 46' 43.85" E Dist 3,577.0147'

Point 91 N 1,749,460.6034 E 2,227,483.0959 Sta 460+10.83

Ending chain FAP595 description

FILE NAME =	USER NAME = espino	DESIGNED -	REVISED -
n:\proj\0003393.00\contract.1\design\Misc	Sheets\0264884-sht-ATB.dgn	DRAWN -	REVISED -
	PLOT SCALE = 100.0000' / IN.	CHECKED -	REVISED -
	PLOT DATE = 3/11/2013	DATE -	REVISED -

STATE OF ILLINOIS
DEPARTMENT OF TRANSPORTATION

EXISTING HORIZONTAL & VERTICAL CONTROL

SCALE: SHEET NO. OF SHEETS STA. TO STA.

F.A.P. RTE.	SECTION	COUNTY	TOTAL SHEETS	SHEET NO.
595	(142-1)R & 142-1)B	ROCK ISLAND	507	72
CONTRACT NO. 64B84				
ILLINOIS FED. AID PROJECT				