

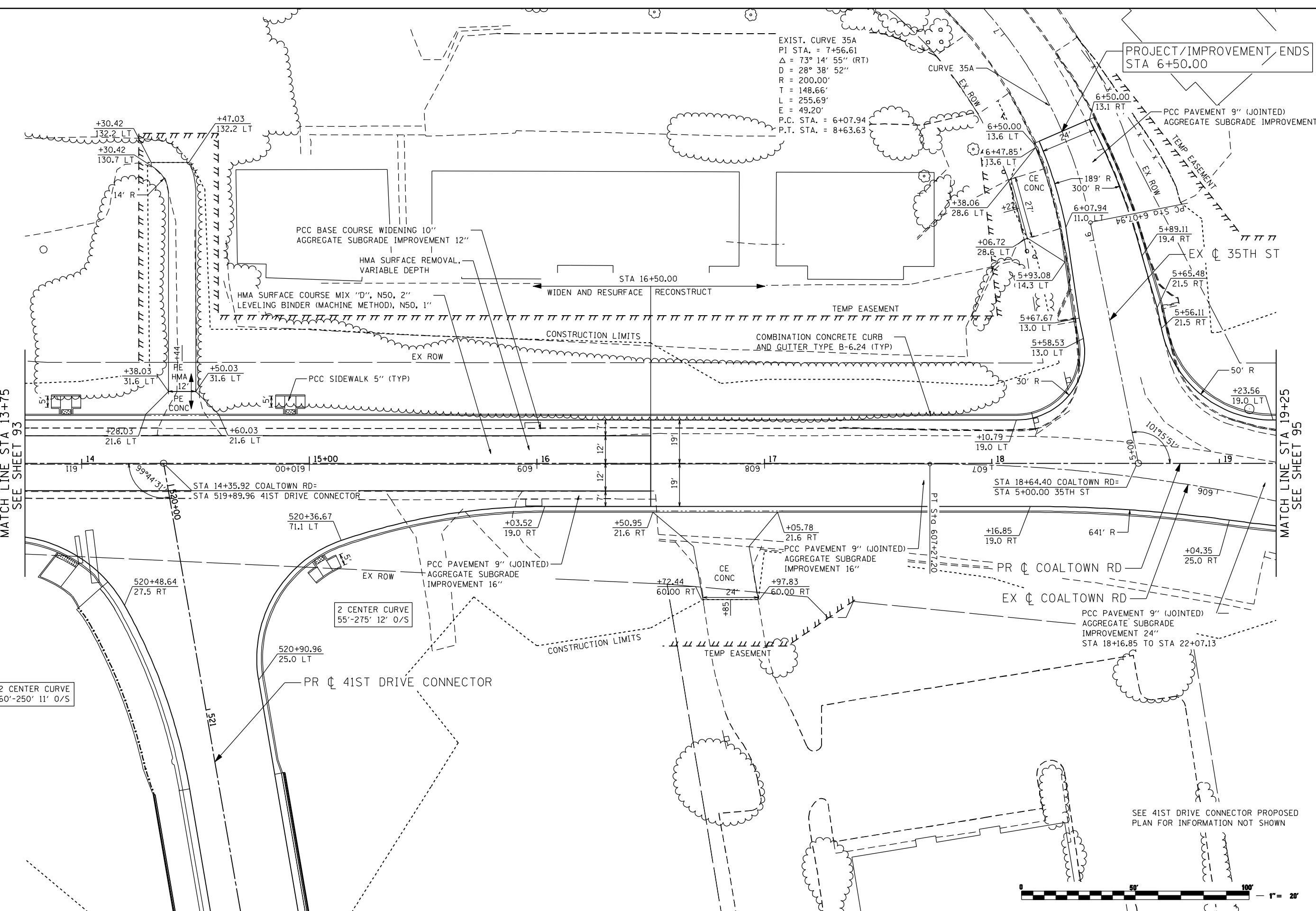

PROJECT/IMPROVEMENT ENDS  
STA 6+50.00

EXIST. CURVE 35A  
PI STA. = 7+56.61  
Δ = 73° 14' 55" (RT)  
D = 28° 38' 52"  
R = 200.00'  
T = 148.66'  
L = 255.69'  
E = 49.20'  
P.C. STA. = 6+07.94  
P.T. STA. = 8+63.63



MATCH LINE STA 13+75  
SEE SHEET 93

MATCH LINE STA 19+25  
SEE SHEET 95

2 CENTER CURVE  
60'-250' 11' 0/S

2 CENTER CURVE  
55'-275' 12' 0/S

SEE 41ST DRIVE CONNECTOR PROPOSED  
PLAN FOR INFORMATION NOT SHOWN



FILE NAME: c:\projects\08001393\08\contract.ctb\design\proposed\plan\0264884-ent-plan-CTR\_02.dgn

**Ciorba Group, Inc.**  
CONSULTING ENGINEERS  
5507 North Cumberland Avenue, Suite 402  
Chicago, Illinois 60656  
Tel. 773.776.4009 Fax 773.776.4014

USER NAME = espino	DESIGNED -	REVISED -
PLOT SCALE = 48.0000" / IN.	DRAWN -	REVISED -
PLOT DATE = 3/11/2013	CHECKED -	REVISED -
DATE = 3/11/2013	REVISIONS -	REVISED -

STATE OF ILLINOIS  
DEPARTMENT OF TRANSPORTATION

COALTOWN ROAD  
PROPOSED PLAN

SCALE: SHEET NO. OF SHEETS STA. TO STA.

F.A.P. RTE. 595	SECTION (142-1JR & 142-1HB)	COUNTY ROCK ISLAND	TOTAL SHEETS 507	SHEET NO. 94
ILLINOIS FED. AID PROJECT			CONTRACT NO. 64B84	