







**EROSION CONTROL LEGEND**

-  MULCH, METHOD 2 AND TEMPORARY SEEDING
-  MULCH, METHOD 3 AND TEMPORARY SEEDING
-  TEMPORARY EROSION CONTROL BLANKET AND TEMPORARY SEEDING
-  INLET & PIPE PROTECTION OR INLET PROTECTION, SPECIAL
-  INLET FILTER
-  TEMPORARY DITCH CHECKS
-  PERIMETER EROSION BARRIER
-  TREE PROTECTION (PAID AS TEMPORARY FENCE)

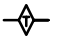
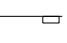

STONE RIPRAP, CLASS A3  
(5.9 SQ YD) TO REMAIN

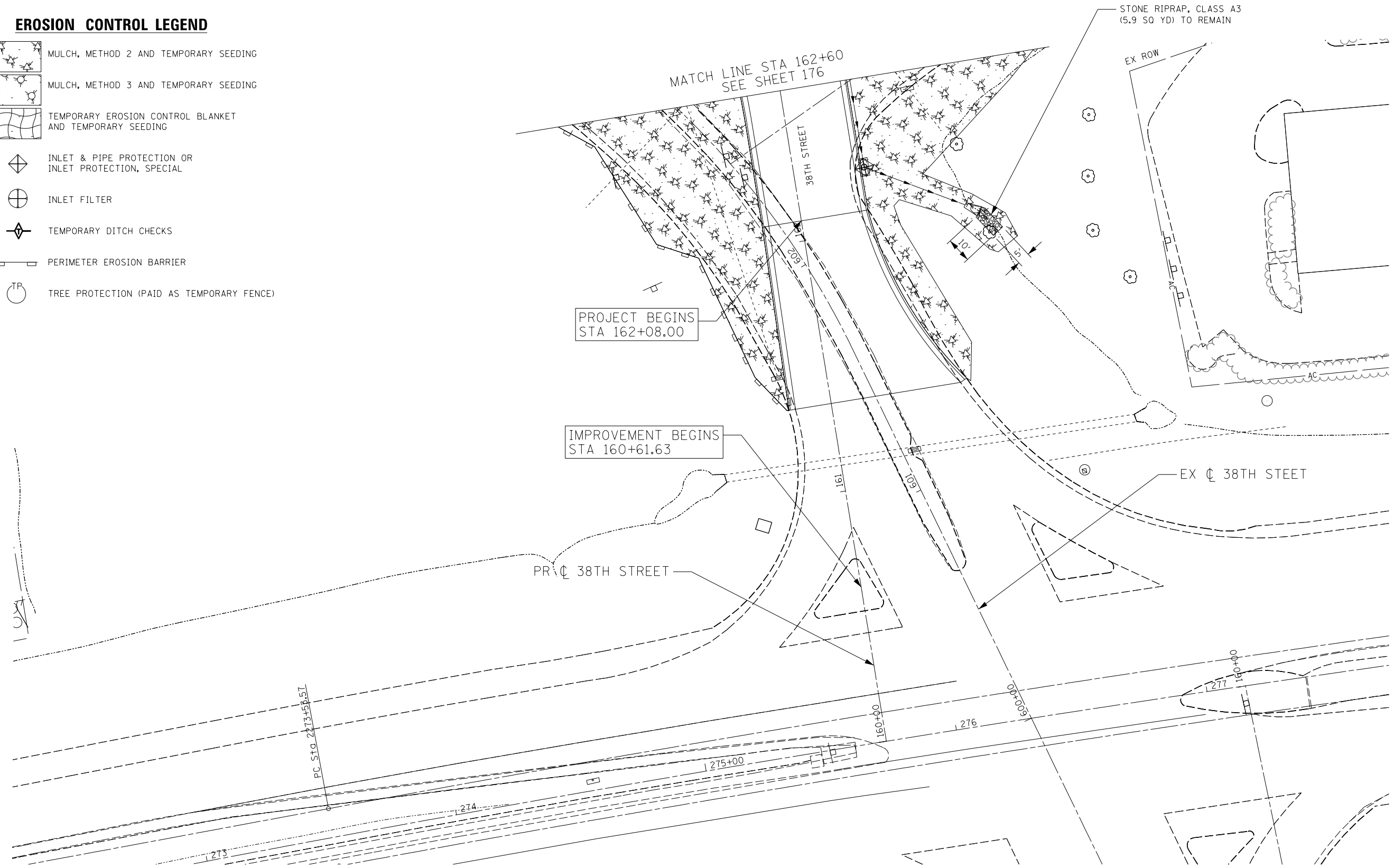

**Lin Engineering, Ltd.**  
Consulting Engineers  
Springfield, Illinois

|                              |                  |           |
|------------------------------|------------------|-----------|
| USER NAME = Plotted by LinZl | DESIGNED - RWK   | REVISED - |
| DRAWN - RWK                  | REVISIONS -      |           |
| PLOT SCALE = 40.0000' / in.  | CHECKED - ST     | REVISED - |
| PLOT DATE = 3/11/2013        | DATE - 3/11/2013 | REVISED - |

**STATE OF ILLINOIS  
DEPARTMENT OF TRANSPORTATION**

**38TH STREET  
TEMPORARY EROSION CONTROL**  
SCALE: 1"=20' SHEET NO. 17 OF 17 SHEETS STA. 160+00 TO STA. 162+60

| F.A.P. RTE.                                     | SECTION             | COUNTY      | TOTAL SHEETS       | SHEET NO. |
|---|---------------------|-------------|--------------------|-----------|
| 595   | (142-1R-1, 142-1HB) | ROCK ISLAND | 507                | 178       |
| FED. ROAD DIST. NO. 2 ILLINOIS FED. AID PROJECT |                     |             | CONTRACT NO. 64B84 |           |