

# TRAFFIC SIGNAL REMOVAL PLAN

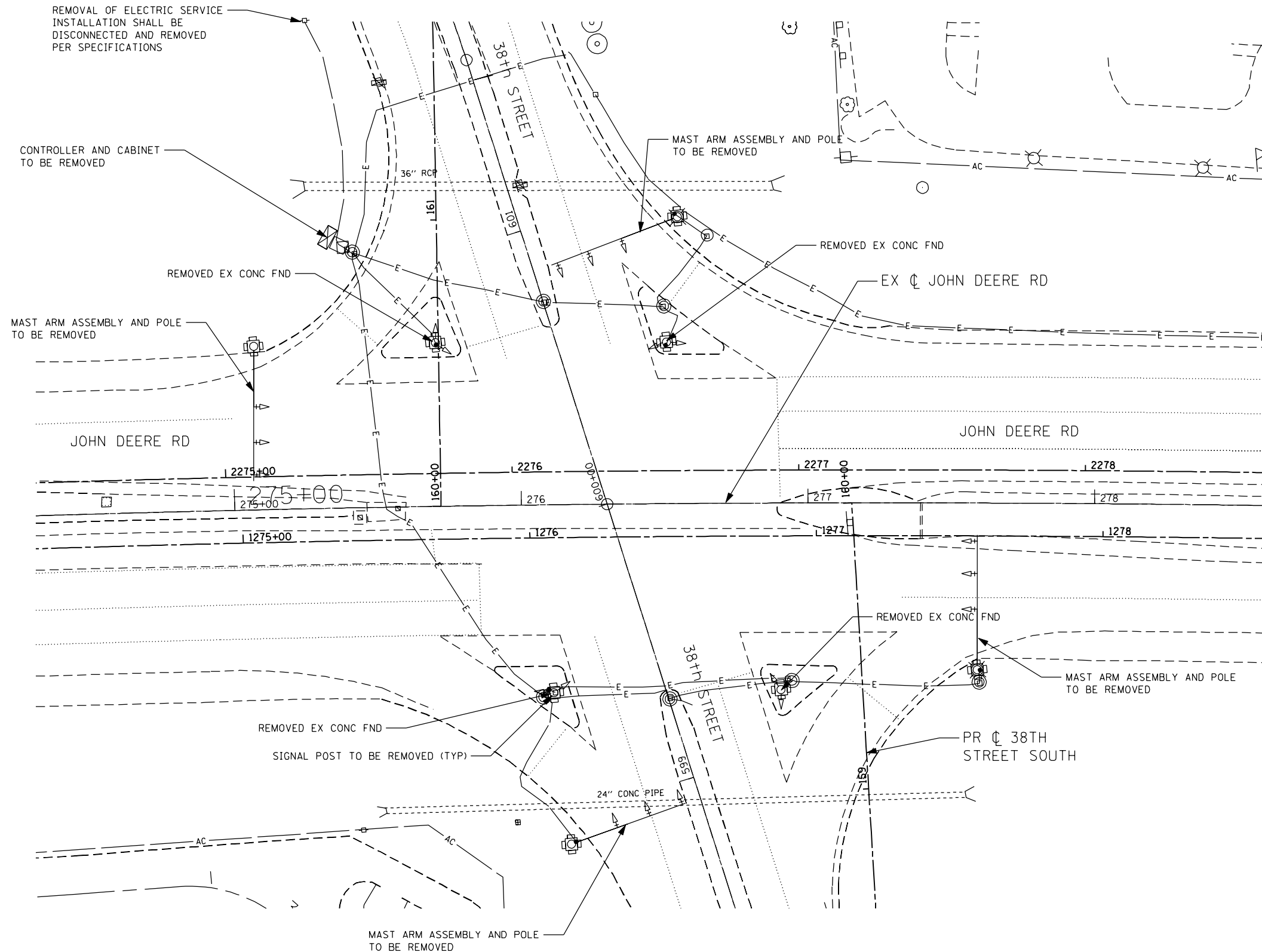

## REMOVAL NOTES

THE FOLLOWING ITEMS SHALL BE REMOVED BY THE CONTRACTOR AND SHALL BE DISPOSED OF BY THEM OUTSIDE OF THE RIGHT-OF-WAY AT THEIR EXPENSE. THE SALVAGE VALUE OF THE REMOVED EQUIPMENT SHALL BE REFLECTED IN THE CONTRACT BID PRICE. SEE THE SPECIAL PROVISION FOR DISPOSITION OF SALVAGED TRAFFIC SIGNAL EQUIPMENT.

- 1 EACH CONTROLLER (IDOT)
- 1 EACH CABINET (CITY OF MOLINE)
- 4 EACH COMBINATION MAST ARM ASSEMBLY AND POLE (CITY OF MOLINE)
- 4 EACH SIGNAL POST (CITY OF MOLINE)
- 19 EACH SIGNAL HEAD, 1-FACE, 3-SECTION (CITY OF MOLINE)
- 12 EACH TRAFFIC SIGNAL BACK PLATES
- 1 EACH SIGNAL HEAD, 1-FACE, 4-SECTION (CITY OF MOLINE)
- 8 EACH CONCRETE FOUNDATIONS
- 10 EACH HANDHOLES
- 1 EACH REMOVAL OF ELECTRIC SERVICE INSTALLATION
- 1 LSUM ELECTRIC CABLE

ITEMS BORDERED SHALL BE RETURNED TO THE LISTED OWNER.



2600 Warrenville Road, Suite 203, Downers Grove, IL 60515  
630.705.0110 voice, 630.839.3566 fax  
www.mps-il.com

**MILLENNIA PROFESSIONAL SERVICES**

DESIGNED - TVN	REVISED -
DRAWN - CJD	REVISED -
CHECKED - RPD	REVISED -
DATE - 3/11/2013	REVISED -

**STATE OF ILLINOIS  
DEPARTMENT OF TRANSPORTATION**

**JOHN DEERE ROAD AT 38th STREET  
TRAFFIC SIGNAL REMOVAL PLAN**

SCALE: 1"=20' SHEET NO. OF SHEETS STA. TO STA.

F.A.P. RTE.	SECTION	COUNTY	TOTAL SHEETS	SHEET NO.
595	(142-1)R & 142-1)B	ROCK ISLAND	507	289
CONTRACT NO. 64B84				

FED. ROAD DIST. NO. 1 ILLINOIS FED. AID PROJECT

IREM-01