

Benchmark: "O" in the word "open" on Fire Hydrant
Sta. 294+65.77, (I.L. Rte 5) Offset 108.75' Rt., Elev. 579.42

Existing Structure: None.

Bicycle Railing, Special

Begin Retaining Wall
Sta. 521+33.00
Elev. 593.53

Flow line
Elev. 589.10
12" Conc. Pipe

4' I.D. Manhole
Sta. 522+20.00

323'-5 1/8"
Measured along Front Face Precast Concrete Panels

Sta. 524+47.24
Elev. 596.08

Bicycle Railing
(R-29)

Bridge Fence
Railing (R-33)

Proposed Grade
Line 41st Drive
Connector

Sta. 521+33.00
Elev. 591.48

Existing
Grade Line

Prop. Grade
at Front Face
of Wall Panels

Bottom of
Manhole
Elev. 588.33

Top of Exposed
Panel Line

Top of Coping or Moment Slab

Proposed Grade Line
41st Drive Connector

Sta. 524+47.24
Elev. 594.08

Sta. 524+47.24
Elev. 586.94

Structure
No. 081-0176

Sta. 524+56.43
Elev. 586.94

Proposed
Ground Line

Prop.
24" RCP

Temporary
Soil Retention
System

Sta. 524+65.00
Elev. 556.0

Sta. 521+33.00
Elev. 560.0

Estimated Top of Rock

ELEVATION
(Looking East)

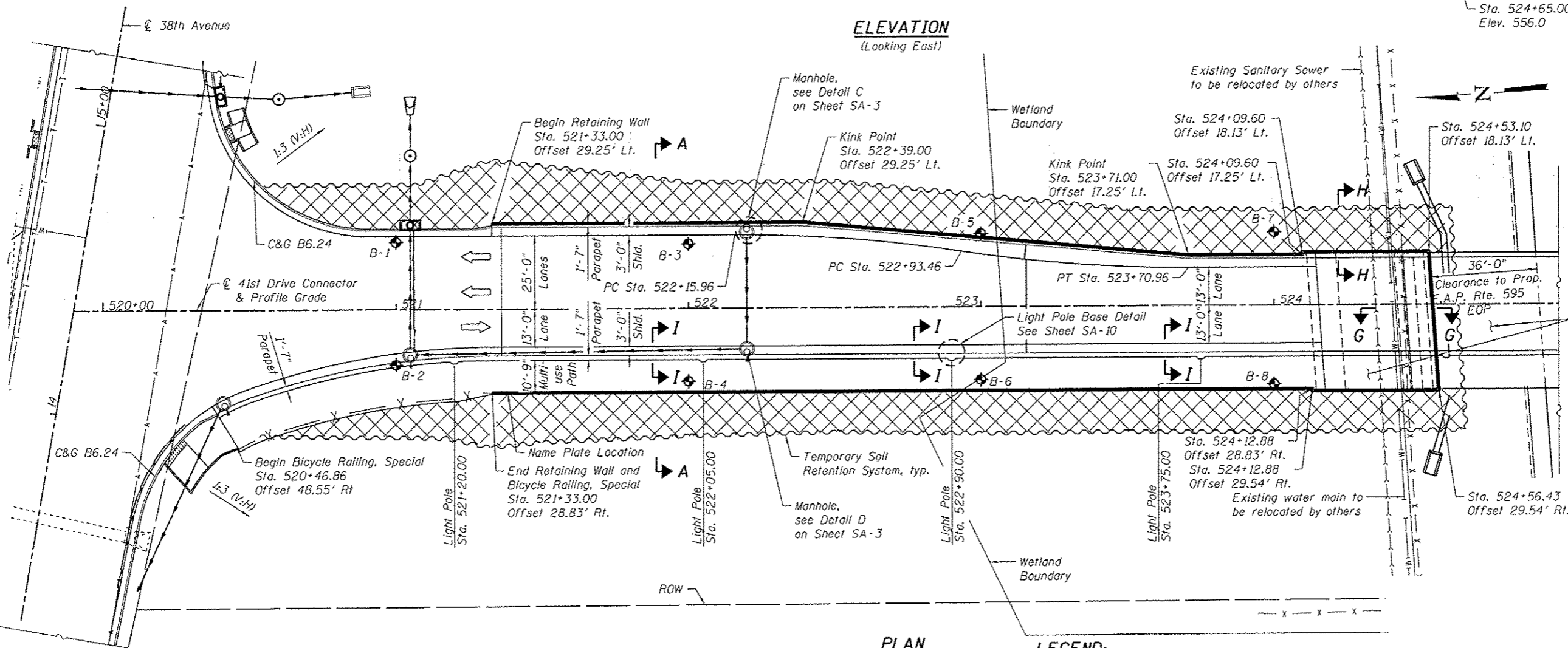

PLAN

LEGEND:

Soil Boring

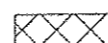

Removal and Disposal of Unsuitable Materials. Rockfill is to be placed up to the top of existing ground or bottom of MSE Wall leveling pad, whichever is lower. See Roadway plans for Removal and Disposal of Unsuitable Materials and Rock Fill quantities.

* Cross hatching not shown under roadway and path for clarity.

APPROVED
For Structural Adequacy Only

David C. Ramsey
Engineer of Bridges & Structures

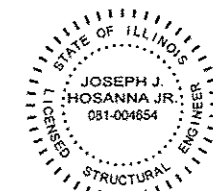

DATE: 3/11/2013
SEAL EXPIRES: 11/30/2014

DESIGN SPECIFICATIONS
2012 AASHTO LRFD Bridge
Design Specifications, 6th Edition
with 2012 Interims

DESIGN STRESSES

FIELD UNITS

f'c = 3,500 psi
fy = 60,000 psi (Reinforcement)

PRECAST UNITS

f'c = 4,500 psi (Precast Face Panels)

NOTES:

- For Sections A-A & G-G see Sheet SA-3. For Section H-H & I-I see Sheet SA-10.
- Offsets are measured from the centerline of 41st Drive Connector to the front face of wall.
- Ashlar stone formliner to be used on MSE wall panels.

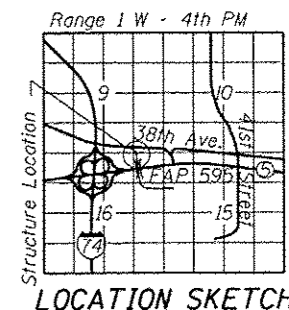

LOCATION SKETCH

GENERAL PLAN & ELEVATION
F.A.P. RTE. 595 - SEC. (142-1)R-1 AND 142-1)B
ROCK ISLAND COUNTY
STATION 521+33.00 TO 524+56.43
STRUCTURE NO. 081-7002



USER NAME = rdenley	DESIGNED - APD	REVISD -
	CHECKED - BWS	REVISD -
PLOT SCALE = 40:0 1" = 20'	DRAWN - RD	REVISD -
PLOT DATE = 3/21/2013	CHECKED - JJH	REVISD -

STATE OF ILLINOIS
DEPARTMENT OF TRANSPORTATION

SHEET NO. SA-1 OF SA-16 SHEETS

F.A.P. RTE.	SECTION	COUNTY	TOTAL SHEETS	SHEET NO.
595	(142-1)R-1 AND 142-1)B	ROCK ISLAND	507	327
				CONTRACT NO. 64884
ILLINOIS FED. AID PROJECT				