

NOTES:

1. REMOVE EXISTING SHOULDER AND PLACE HMA PAVEMENT FULL-DEPTH AS SHOWN IN THE PLANS UNDER HIGHWAY STANDARD 701326. REMOVE CONFLICTING PAVEMENT MARKINGS AT IL 92 / 140th STREET INTERSECTION AND APPLY TEMPORARY PAVEMENT MARKINGS AS SHOWN IN THE PLANS UNDER 701326.
2. AFTER PROJECT COMPLETION REMOVE DETOUR SIGNAGE/BARRICADES. REMOVE TEMPORARY PAVEMENT MARKINGS AND REAPPLY PERMANENT PAVEMENT MARKINGS TO CORRESPOND TO EXISTING PAVEMENT MARKING CONFIGURATION AT IL 92 / 140th STREET INTERSECTION UNDER HIGHWAY STANDARD 701201.
3. HMA PAVEMENT FULL DEPTH SHALL CONSIST OF 1.5" HOT-MIX ASPHALT SURFACE COURSE WITH 7" HOT-MIX ASPHALT BINDER COURSE.
4. RECONSTRUCTED PRIVATE ENTRANCES SHALL CONSIST OF 8" AGGREGATE BASE COURSE TYP B AND 2" INCIDENTAL HOT-MIX ASPHALT SURFACING.
5. RELOCATE SIGN PANEL ASSEMBLY - TYPE A SHALL BE RELOCATED TO A LOCATION SPECIFIED BY THE ENGINEER.

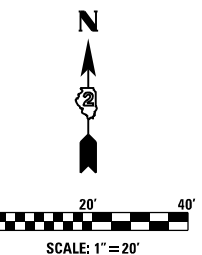
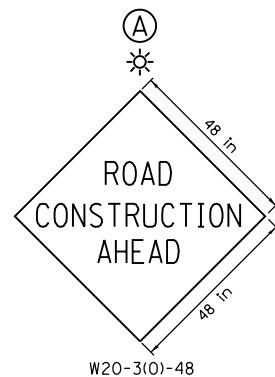
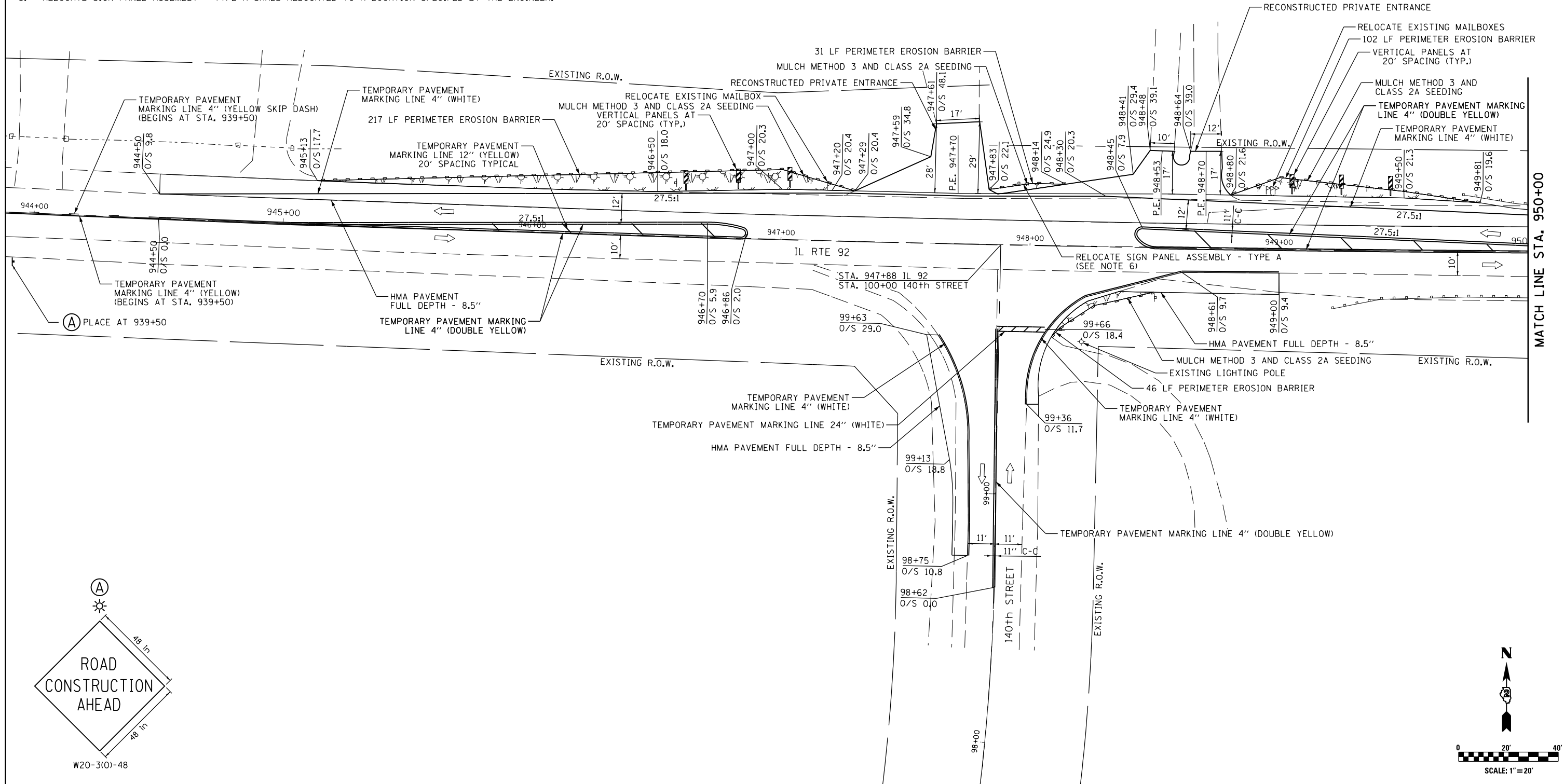

LE LIN ENGINEERING, LTD.
Consulting Engineers
Chatham, Illinois

USER NAME = *USER*	DESIGNED -	REVISED -
PLOT SCALE = *SCALE*	DRAWN -	REVISED -
PLOT DATE = *DATE*	CHECKED -	REVISED -
	DATE -	REVISED -

**STATE OF ILLINOIS
DEPARTMENT OF TRANSPORTATION**

**IL 92 OVER BIG BRANCH CREEK
ROAD CLOSURE / INTERSECTION IMPROVEMENTS**

SCALE: 1"=20' SHEET NO. 1 OF 2 SHEETS STA. TO STA.

F.A.P. RTE.	SECTION	COUNTY	TOTAL SHEETS	SHEET NO.
599	103MFT-BR	ROCK ISLAND	88	26
CONTRACT NO. 64D18				
ILLINOIS FED. AID PROJECT				