

PLAN	SURVEYED	DATE
	PLOTTED	BY
	GRADES CHECKED	
	ALIGNMENT CHECKED	
	STRUCTURE NOTATIONS CHECKED	
	FILE NAME	

PROFILE	SURVEYED	DATE
	PLOTTED	BY
	GRADES CHECKED	
	ALIGNMENT CHECKED	
	STRUCTURE NOTATIONS CHECKED	
	FILE NAME	

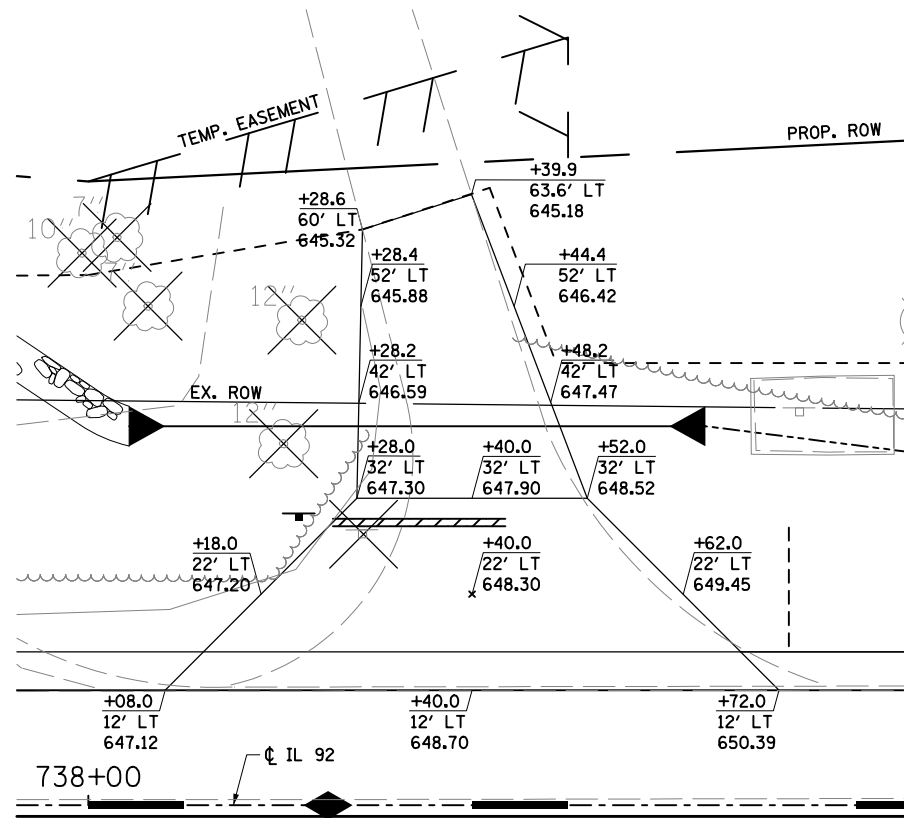

INTERSECTION GRADING AT CUB SCOUT ROAD

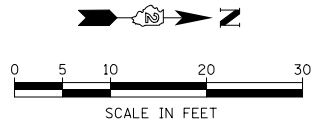
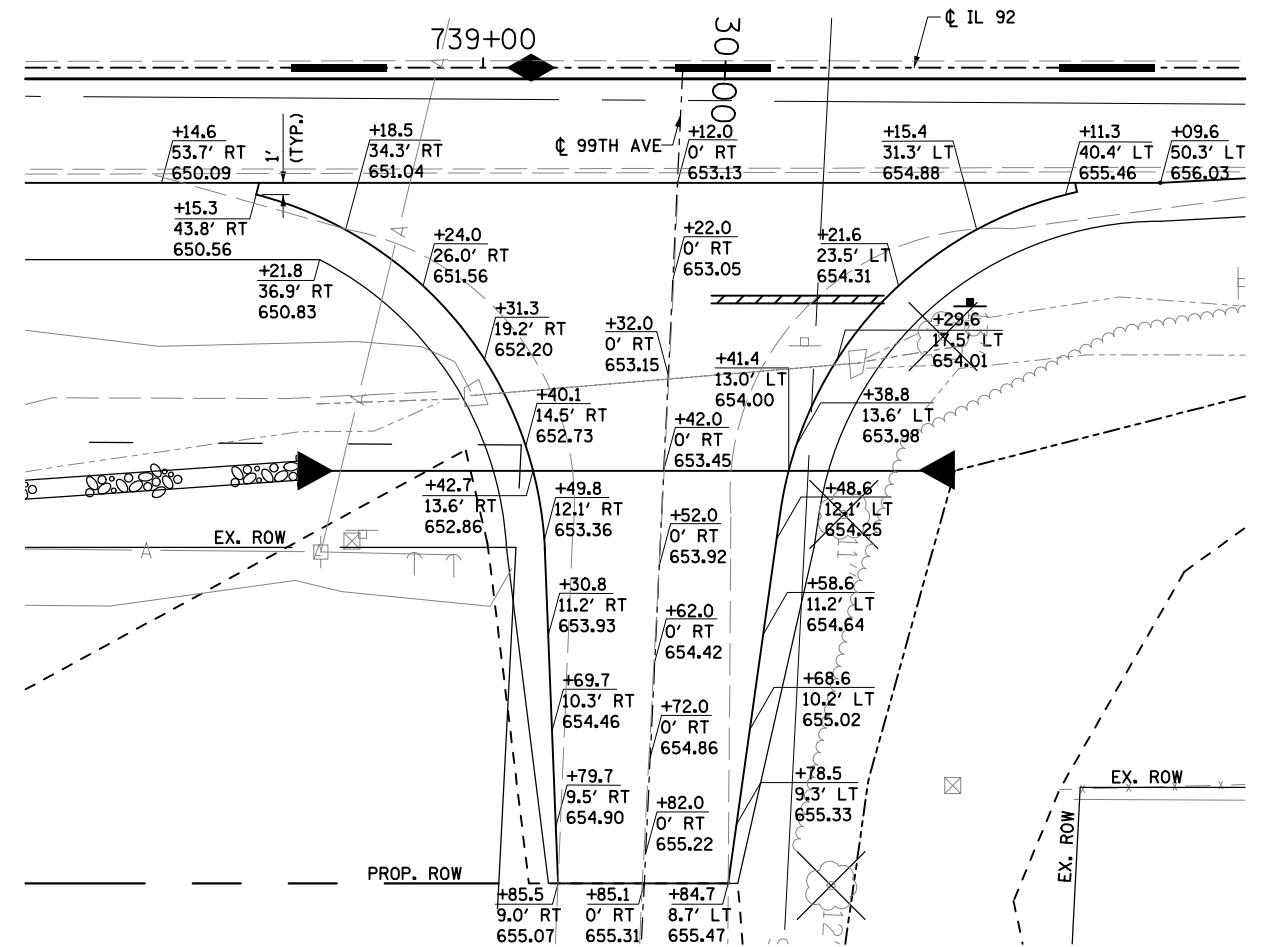
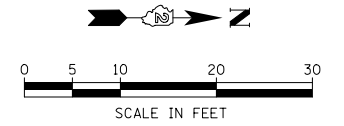

INTERSECTION GRADING AT 99TH AVE.

FILE NAME = D206907_sht_1.mt_01.dgn



USER NAME = mszmurlo	DESIGNED KAC	REVISED
	DRAWN KMB	REVISED
PLOT SCALE = 20.0000' / in.	CHECKED KAC	REVISED
PLOT DATE = 6/19/2013	DATE 05-03-2013	REVISED

**STATE OF ILLINOIS
DEPARTMENT OF TRANSPORTATION**

**IL 92 OVER BIG BRANCH CREEK
INTERSECTION GRADING**

SCALE: 1" = 10' SHEET NO. OF SHEETS STA. TO STA.

F.A.P. RTE.	SECTION	COUNTY	TOTAL SHEETS	SHEET NO.
599	103MFT-BR	ROCK ISLAND	88	31
CONTRACT NO. 64D18				
FED. ROAD DIST. NO. ILLINOIS FED. AID PROJECT				