

Notes:  
 See sheet 13 of 20 for Sections C-C & D-D and View E-E.  
 $a_3(E)$  and  $a_4(E)$  bar spacings measured along  $\varnothing$  Rdwy.  
 The joint opening shall be determined per Article 520.04 except that on jointless structures, the distance described as the bridge length between the nearest fixed bearings each way from the joint shall be taken as half the bridge length plus the approach slab length. The minimum dimension shall be  $1\frac{1}{2}$ " for installation purposes.  
 See Sheet 13 of 20 for Bill of Material.

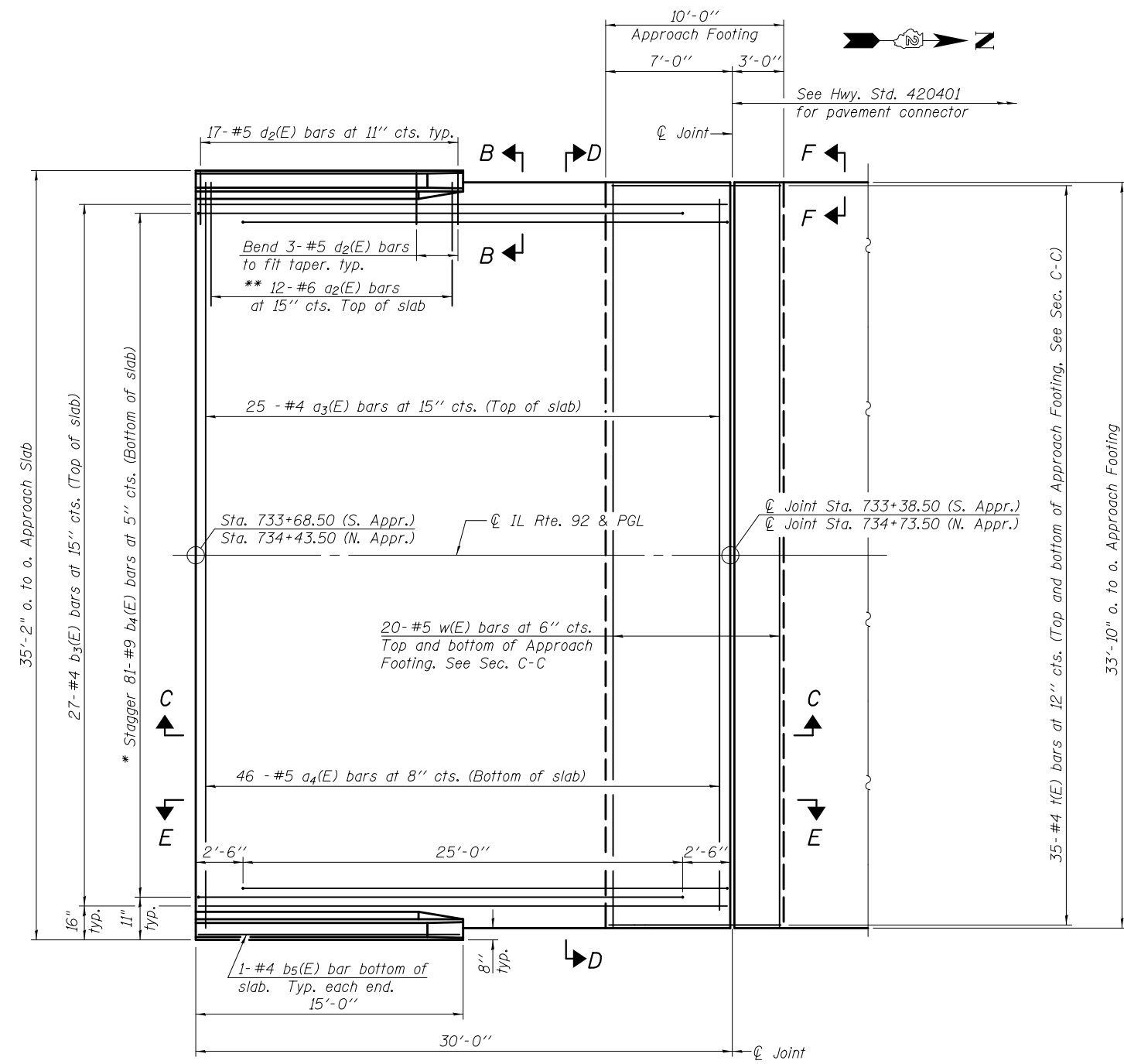

**PLAN**

North Approach shown, South Approach similar.

\* Tilt #9  $b_3(E)$  bars as required to maintain clearance.  
 \*\* Space between  $a_3(E)$  bars, typ. ea. parapet.

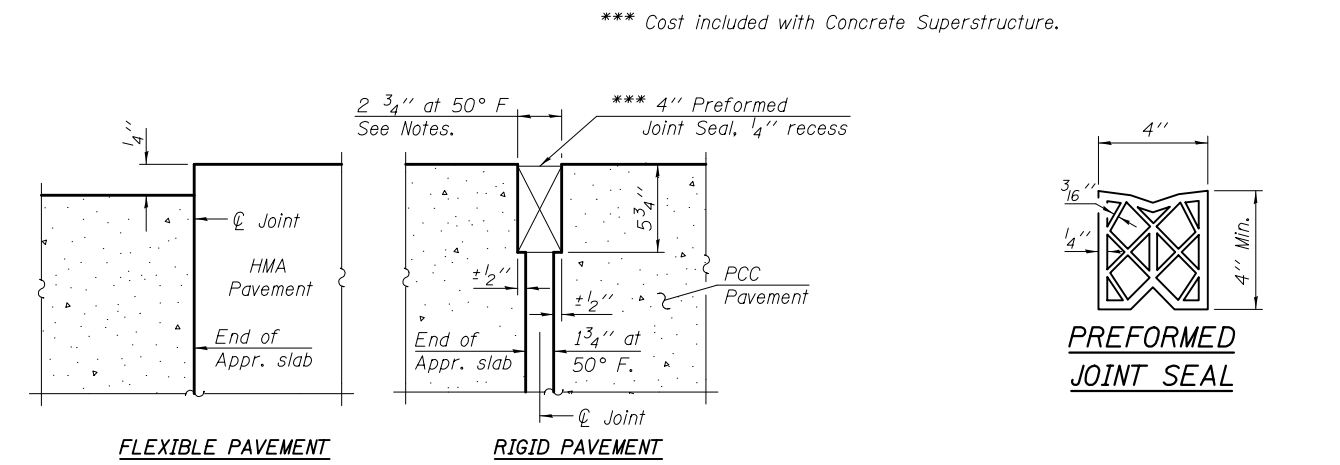

**DETAIL A**

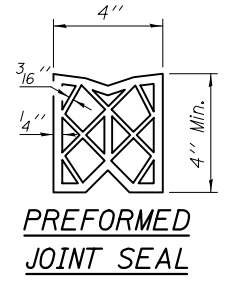

**PREFORMED JOINT SEAL**

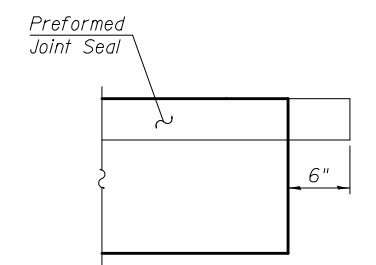

**VIEW F-F**

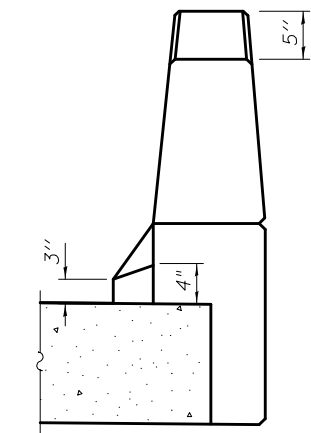

**VIEW B-B**

(Sheet 1 of 2)

6/19/2013 5:32:09 PM 0810196\_64D18\_012\_APPR01.dgn



DESIGNED - MWS	REVISED -
CHECKED - TAY	REVISED -
DRAWN - MWS	REVISED -
CHECKED - BJM	REVISED -

**STATE OF ILLINOIS  
 DEPARTMENT OF TRANSPORTATION**

**BRIDGE APPROACH SLAB DETAILS  
 STRUCTURE NO. 081-0196**

SHEET NO. 12 OF 20 SHEETS

F.A.P.	SECTION	COUNTY	TOTAL SHEETS	SHEET NO.
599	103MFT-BR	ROCK ISLAND	88	43
CONTRACT NO. 64D18				

ILLINOIS FED. AID PROJECT