

STATE OF ILLINOIS  
DEPARTMENT OF PUBLIC WORKS AND BUILDINGS  
DIVISION OF HIGHWAYS  
**PLANS FOR PROPOSED  
STATE BOND ISSUE HIGHWAY**

**INDEX TO SHEETS.**

Sheet No.	Title
2	Standards 1906, 1873 (with Cover)
3	Standards 1235, 1233
4	Details of Alignment Plan of Route 82 with Route 88 and Intersecting Street, Detail of Special Shoulder, Detail of Road Markings
5	Standards 1465, 1470
6	Plan & Profile sta: 413+00 - sta: 450+00
7	" " " " sta: 450+00 - sta: 505+00
8	" " " " sta: 505+00 - sta: 535+00
9	" " " " sta: 535+00 - sta: 555+00
10	" " " " sta: 555+00 - sta: 655+00
11	" " " " sta: 655+00 - sta: 684+67.5
12	" " " " sta: 684+67.5 - sta: 685.3
13	" " " " sta: 685.3 - sta: 30+00
14	" " " " sta: 30+00 - sta: 30+00
15	" " " " sta: 30+00 - sta: 150+00
16	" " " " sta: 150+00 - sta: 177+46
16-18	Inclusive, Cross Sections
19	Special Culverts sta: 447+53, 478+53, 478+53, 474+20
20	" " " " sta: 474+20, 471+16, 461+00, 500+16
21	" " " " sta: 500+16, 521+00, 521+00, 521+00
22	" " " " sta: 521+00, 649+00, 652+27.0, 652+18
23	" " " " sta: 652+18, 649+00, 650+00, 650+00
24	" " " " sta: 650+00, 24+62
25	" " " " sta: 650+00, 24+62
26	Standards 1471, 1102
27	Standards 1494, 1263

**ROUTE 82, SECTION 141 & 141-B, WHITESIDE COUNTY.**

SCALES  
PLAN 1 INCH = 100 FT.  
PROFILE, HOR. 1 INCH = 100 FT.  
PROFILE, VERT. 1 INCH = 16 FT.  
CROSS-SECTION 1 INCH = 4 FT.

From a point near the S.W. corner of the S.E. 1/4 of the S.E. 1/4 of section 27, T.20 N., R. 6 E., of the 4<sup>th</sup> P.M.  
To a point near the S.E. corner of section 20, T. 20 N., R. 7 E. of the 4<sup>th</sup> P.M.  
and  
To a point near the S.W. corner of the N.W. 1/4 of section 14, T. 19 N., R. 6 E., of 4<sup>th</sup> P.M.



SECTION 141-B

Sheet No.	Title
13	Plan & Profile sta: 30+00 - sta: 30+00
14	" " " " sta: 30+00 - sta: 150+00
15	Special Bridge sta: 07+00 - sheet 1 of 2 sheets
16	" " " " sta: 07+00 - sheet 2 of 2 sheets
17	" " " " sta: 32+00 - sheet 1 of 3 sheets
18	" " " " sta: 32+00 - sheet 2 of 3 sheets
19	" " " " sta: 32+00 - sheet 3 of 3 sheets

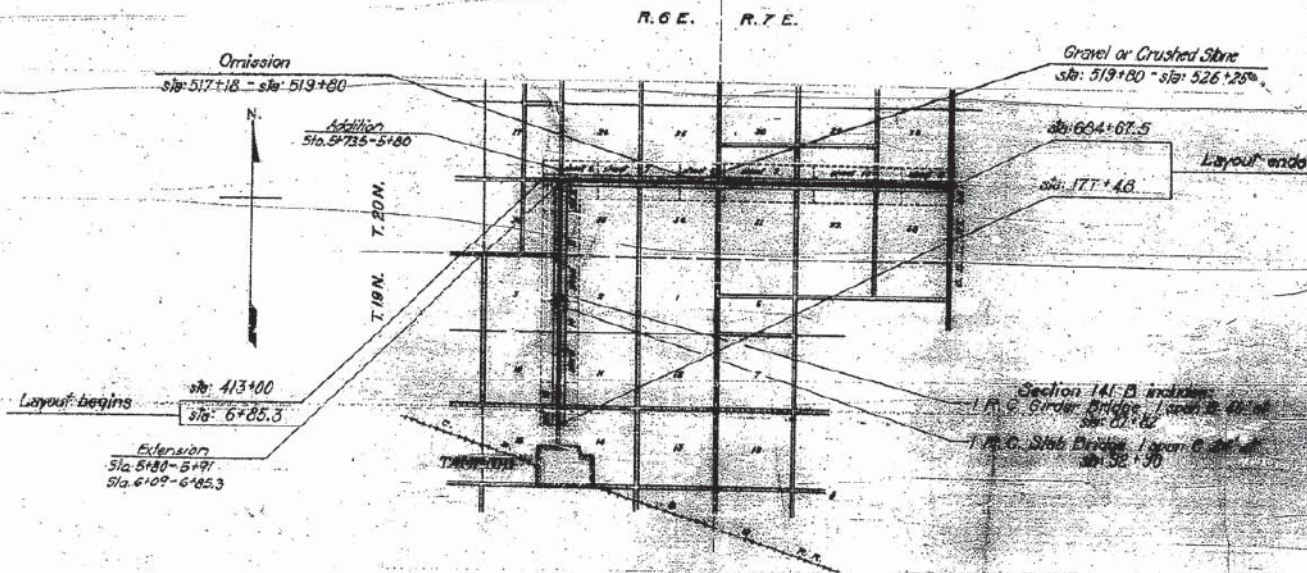

Symbol	Description
---	STATE LINE
---	COUNTY LINE
---	CITY, VILLAGE OR TOWN
---	TOWNSHIP LINE
---	SECTION LINE
---	GRANT LINE
---	SECTION CORNER
---	FENCE LINE
---	UNFENCED PROPERTY
---	RIGHT OF WAY LINE
---	GUARD RAIL
---	STEAM RAILROAD
---	ELECTRIC RAILROAD
---	RETAINING WALL
---	BASE ON SURVEY LINE
---	LEVEE
---	CULVERT
---	STORM SEWER
---	TILE DRAIN
---	DROP INLET
---	TROLLEY POLE
---	POWER POLE
---	TELEPHONE OR TELEGRAPH POLE
---	MARSH
---	HEDGE

**LAYOUT**  
Approximate scale 1 inch = 1 mile  
Net length of layout 43,368.2 ft. = 8.273 mi.

STATE OF ILLINOIS DEPARTMENT OF PUBLIC WORKS AND BUILDINGS DIVISION OF HIGHWAYS	
DESIGNED	December 1, 1932
EXAMINED	O. F. Gault
APPROVED	December 7, 1932
APPROVED	December 7, 1932
APPROVED	December 7, 1932
APPROVED	December 7, 1932

WHITESIDE COUNTY SECTION 141-B ROUTE 82

DATE - DECEMBER 7, 1932