

INDEX OF SHEETS

- 1. COVER SHEET
INDEX OF SHEETS
STANDARDS
- 2. GENERAL NOTES
TYPICAL SECTIONS
- 3. SUMMARY OF QUANTITIES
MISCELLANEOUS QUANTITIES
- 4. PLAN & PROFILE
- 5.-13. BRIDGE PLANS
- 14.-15. CROSS SECTIONS
- 16. TYPICAL APPLICATIONS OF TRAFFIC CONTROL DEVICES

STANDARDS :

- 1686-4 STANDARD SYMBOLS AND ABBREVIATIONS
- 2115-2 NAME PLATE FOR BRIDGES
- 2117-1 BITUMINOUS PATCHING DETAILS
- 2135 PERMANENT SURVEY MARKERS
- 2230-13 STEEL PLATE BEAM GUARD RAIL TYPE A, B, C, & D
- 2149-11 DELINEATORS
- 2359-1 WIDENING AND SHOULDERS FOR PAVEMENT RESURFACING
- 2299-9 TRAFFIC CONTROL DEVICE
- 2300-2 FLAGGER TRAFFIC CONTROL SIGN
- 2301-4 TRAFFIC CONTROL STANDARD
- 2302-4 TRAFFIC CONTROL STANDARD
- 2305-4 TRAFFIC CONTROL STANDARD
- 2336-3 TRAFFIC BARRIER TERMINAL TYPE I & IA
- 2340-3 TRAFFIC BARRIER TERMINAL TYPE S & SA
- 2350-2 METAL POSTS FOR SIGNS, MARKERS & DELINEATORS
- 2296-5 TRAFFIC CONTROL DEVICES
- 2382-1 BRIDGE APPROACH PAVEMENT
- 2383-1 TEMPORARY CONCRETE BARRIER
- 2388-1 TRAFFIC BARRIER TERMINAL TYPE II
- 2443-3 PAVEMENT WIDTH TRANSITION
- 2381 EROSION CONTROL
- 2323-5 JOINTS

DESIGN DESIGNATION
250(02) COLLECTOR 0.168 (BIT 20)

CONTRACT NO. 35392

TAMPICO TOWNSHIP
"CALL J.U.L.I.E.
BEFORE YOU DIG,
800-892-0123"

**STATE OF ILLINOIS
DEPARTMENT OF TRANSPORTATION
DIVISION OF HIGHWAYS
PLANS FOR PROPOSED
FEDERAL AID SECONDARY HIGHWAY**

SCALES { PLAN INCH = 20'
PROFILE HOR. INCH = 20'
PROFILE VERT. INCH = 2'
CROSS SECTIONS INCH = 5'

**F.A.S. ROUTE 200
SECTION 141 BR
PROJECT BR-S-200(104)
WHITESIDE COUNTY**

C-92-097-01

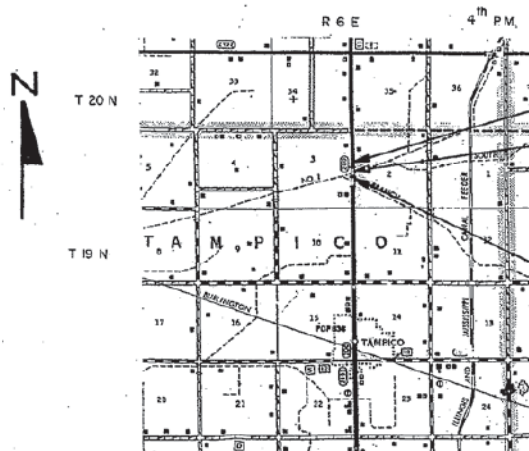

LAYOUT
SCALE 1" = 1 MILE

NET LENGTH OF SECTION 141 BR = 389.41 FT. = 0.074 MI.

LENGTH OF PROJECT = 389.41 FT. = 0.074 MI.

STATE	SECTION	COUNTY	TOTAL SHEETS
ILLINOIS	141 BR	WHITESIDE	16
PROJECT NO. P-92-041-80			1

P-92-041-80

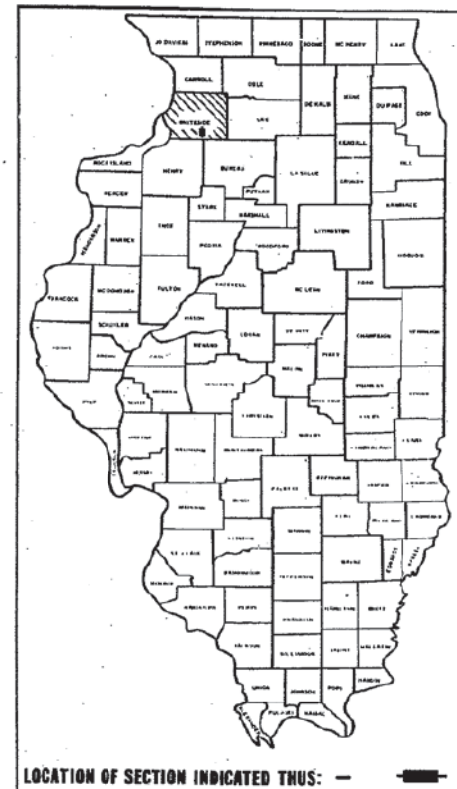

LOCATION OF SECTION INDICATED THUS: —

PROJECT BR-S-200(104)

SECTION 141 BR BEGINS
STATION 85+87.67

SECTION 141 BR INCLUDES THE REHABILITATION OF THE EXISTING SUBSTRUCTURE AND A NEW PRECAST/PRESTRESSED CONCRETE DECK-BEAM SUPERSTRUCTURE (CARRYING ILL. ROUTE 172 OVER COUNTY DITCH NO. 1) 1 SPAN AT 44'-11" EXISTING STRUCTURE NO. 098-0044

PROJECT BR-S-200(104)

SECTION 141 BR ENDS
STATION 89+77.08

**STATE OF ILLINOIS
DEPARTMENT OF TRANSPORTATION
DIVISION OF HIGHWAYS**

SUBMITTER: Jan 20, 1982

EXAMINER: Feb 11, 1982 DISTRICT ENGINEER

PASSED: Feb 11, 1982 CHIEF OF PLANS AND CONTRACTS

APPROVED: Feb 11, 1982 CHIEF OF RECORDS



DONOHUE & ASSOCIATES, INC.

D.A. 11840(82)

FILE NAME =	USER NAME = *USER*	DESIGNED - RAC	REVISED -
*FILE#		DRAWN - LCR	REVISED -
	PLOT SCALE = *SCALE*	CHECKED - DAZ	REVISED -
	PLOT DATE = *DATE*	DATE - 06-21-13	REVISED -

**STATE OF ILLINOIS
DEPARTMENT OF TRANSPORTATION**



Zroka Engineering, P.C.
4216 North Hermitage
Chicago, IL 60613

**EXISTING BRIDGE PLANS - 1982
FOR INFORMATION ONLY**

SCALE: SHEET OF SHEETS STA. 283+43 TO STA. 293+50

F.A.S. RTE.	SECTION	COUNTY	TOTAL SHEETS	SHEET NO.
200	141B-2	WHITESIDE	77	48
			CONTRACT NO. 64D81	
ILLINOIS FED. AID PROJECT				